

BEFORE THE VIRGINIA GAS AND OIL BOARD

APPLICANT: Pocahontas Gas LLC

DIVISION OF GAS AND OIL  
DOCKET NO: VGOB 23-1121-4277-01

RELIEF SOUGHT: Modification of Board Order in  
Docket No. VGOB-23-1121-4277-01

HEARING DATE: April 15, 2025

UNIT NUMBER: Buchanan No1 VS-18

IN BUCHANAN COUNTY, VIRGINIA

MISCELLANEOUS PETITION

1. **Parties:** Applicant is Pocahontas Gas LLC, 1825 Front St, Suite 104, Richlands, Virginia 24641. Respondents are listed on Exhibits "B" and "B-2" attached hereto and made a part hereof. Set forth in Exhibits "B" and "B-2" are the names and last-known addresses of each owner of record identified by the Applicant as having or claiming an interest in the coalbed methane gas underlying the drilling unit known as Buchanan No.1 VS-18. Exhibit B-2 lists the Respondents that are owners and/or claimants in the proposed unit Buchanan No 1 South 1 Panel SGU sought to be created by the Application filed in Docket No. 25-0415-4304. Exhibit B lists the owners and claimants pooled who will have acreage remaining in the VS-18 Unit if this Petition is approved. Each of the individuals named in Exhibits "B" and "B-2" if living, is made a party hereto. If any such individual is deceased, then the known and unknown heirs, executors, administrators, devisees, trustees and assigns, both immediate and remote, of any such deceased individual are made parties hereto. Each of the legal entities named in Exhibit "B", if such entity continues to have legal existence, is made a party hereto. If any such legal entity is dissolved, then the known and unknown successors, trustees, and assigns, both immediate and remote, of such entity are made parties hereto.

2. **Facts:**

- a. If the Application in Docket No. 25-0415-4304 is approved, some of the Respondents listed in the Exhibit B filed in re Docket No. 23-1121-4277 will have their acreage transferred in whole or in part to the Sealed Gob Unit created by Docket No. 25-0415-4304. See Petition and Exhibits filed in re Docket No. 25-0415-4304 which are incorporated herein by reference. The Respondents listed in Revised Exhibit B hereto will continue to have interest in the VS-18 Unit as modified therein.
- b. The undersigned certifies that the matters set forth in this application, to the best of her knowledge, information and belief, are true and correct.
- c. The sealed gob drilling unit sought to be created by the Application filed in Docket No. 25-0415-4304 is entirely within the boundaries of the BUCHANAN NO.1 VS-18 Unit created and pooled by the Board Order entered on the 24<sup>th</sup> day of June 2024 in re Docket No. VGOB-23-1121-4277.
- d. This Application seeks to modify the Board's Order creating and pooling the BUCHANAN NO.1 VS-18 Unit by (1) extracting the acreage within the unit to be known as Buchanan No.1 South 1 Panel SGU unit from the acreage that is currently within the BUCHANAN NO.1 VS-18 Unit and (2) to modify the VS-18 division of royalty interest percentages of the royalty owners and/or claimants with acreage remaining in VS-18 accordingly. Attached hereto is a revised Exhibit B for the acreage which will remain in the BUCHANAN NO.1 VS-18 Unit.
- e. Simultaneously with filing of this application pursuant to Va. Code Ann. § 45.2-1622.A. Applicant is providing notice by certified mail, return receipt requested to each person named as an Owner/Claimant in the Exhibit B having or claiming an interest in the coalbed methane gas, underlying the Subject Lands pooled herein. Applicant hereby notifies the board that where the identity or location of any person is shown as "unknown" on Exhibit "B", then Applicant is unable to provide said person with written notice of the application herein by mail.

3. **Legal Authority:** Va. Code Ann. § 45.2-1600, *et seq.* 4 VAC 25-160-140 and such other regulations promulgated pursuant to law as may pertain hereto.

4. **Relief Sought:** Applicant requests the Board issue an order providing as follows:
- a. Extracting the acreage within a sealed drilling unit consisting of 298.43 +/- acres from the VS-18 Drilling Unit. The acreage to be extracted is described and depicted in Exhibit "A" annexed hereto and is bounded as follows: Beginning at a point, Virginia State Plane NAD 83 coordinate of N: 3593834.13 E: 10485609.83 (southwest corner of Buchanan Mine #1 Sealed Gob Unit South 1 Panel); thence S 89°43'34" E 1413.36 feet to a point, Virginia State Plane NAD 83 coordinate of N: 3593827.37 E: 10487023.18 (southeast corner of Buchanan Mine #1 Sealed Gob Unit South 1 Panel); thence N 43°58'55" W 93.33 feet to a point, Virginia State Plane NAD 83 coordinate of N: 3593894.52 E: 10486958.37; thence N: 01°38'34" E 9743.31 feet to a point, Virginia State Plane NAD 83 coordinate of N: 3603633.83 E: 10487237.70 (northeast corner of Buchanan Mine #1 Sealed Gob Unit South 1 Panel); thence N 39°28'40" W 229.37 feet to a point, Virginia State Plane NAD 83 coordinate of N: 3603456.78 E: 10487091.87; thence N 88°23'00" W 1206.00 feet a point of beginning, containing +/- **298.43** acres
  - b. Re-establishing the percentages for division of interest for production, revenue and costs in accordance with those percentages as are set forth at Revised Exhibit "B" hereto.
  - c. Granting such other relief as is merited by the evidence and is just and equitable, whether or not such relief has been specifically requested herein.

DATED: March 5, 2025

**Pocahontas Gas LLC**  
Applicant

By:   
**Kelli Berry**  
**Sr Analyst – Land Records, Pooling, Division Orders**  
Pocahontas Gas LLC  
1825 Front Street, Suite 104  
Richlands, Virginia 24641

32 33 34 35 36 37 38 39 40 41 42 43

X  
Y  
Z  
AA  
BB  
CC

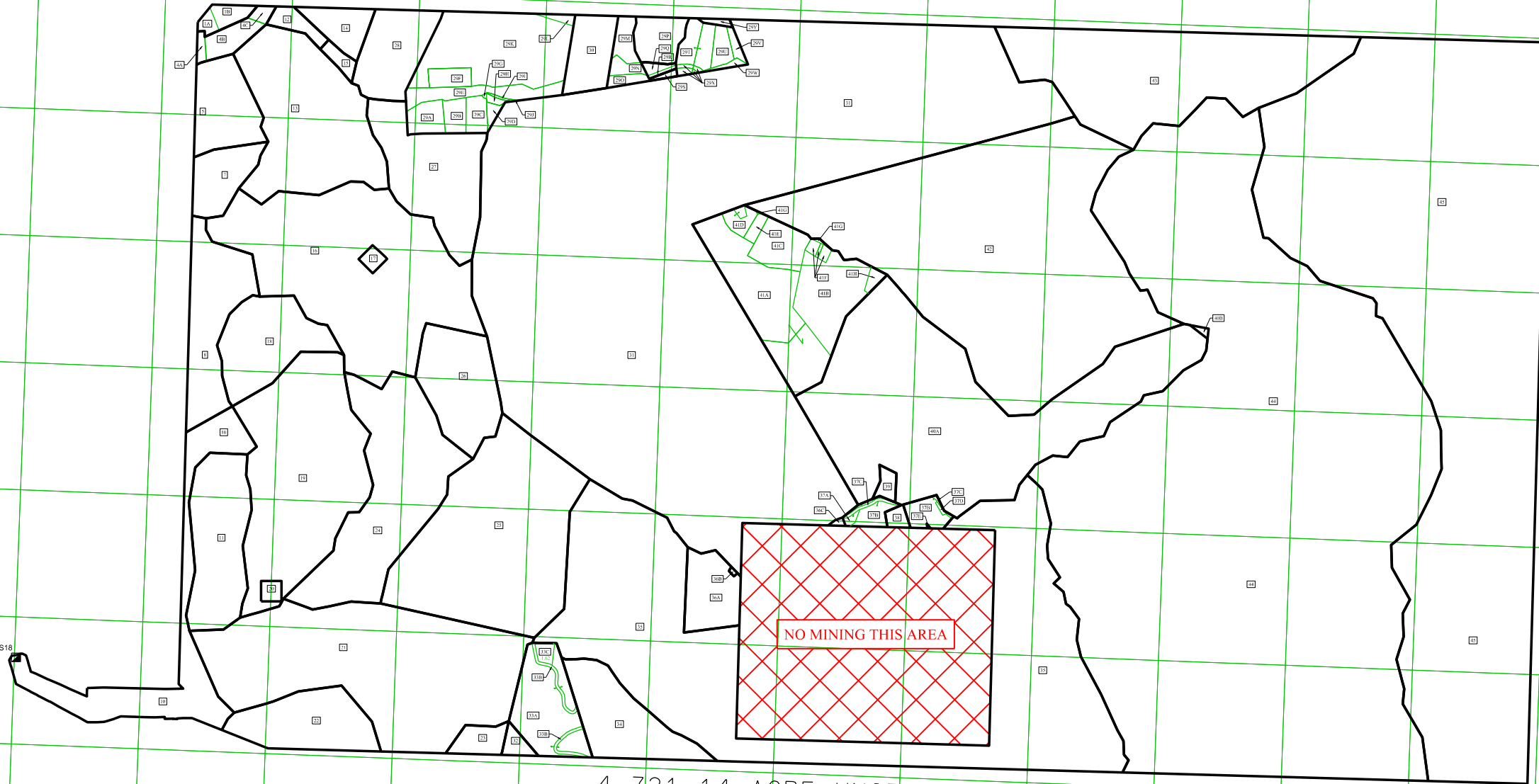

4,721.14 ACRE UNIT

PROPERTY LINES SHOWN ON THIS PLAT WERE TAKEN FROM DEED DESCRIPTIONS AND CHAIN OF TITLE PROVIDED BY POCAHONTAS GAS LLC AND DOES NOT REPRESENT A CURRENT FIELD SURVEY. SEAL HEREON DOES NOT CERTIFY PROPERTY LINE ACCURACY.

Licensed Professional Surveyor

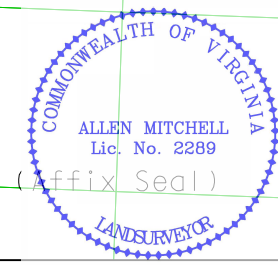

### VENT SHAFT 18

VGOB 23-1121-4277-01

DRAWN BY: PD	DATE: MARCH 11, 2025
SCALE: N.T.S.	EXHIBIT A
VIRGINIA STATE PLANE NAD83 SOUTH ZONE	

**Pocahontas Gas LLC**  
**VS18 (4,721.14 acre unit)**  
**Tract Identifications**

- 1A. Coal Mountain Mining Company, LLP (67.00 Acre Tract) – Coal  
Buchanan Mining Company LLC – Below Drainage Coal Leased  
RAMACO Resources Land Holdings, LLC – Coal In Tiller and Above Leased  
Patricia Cook, et al – Surface, Oil, and Gas  
Pocahontas Gas LLC – Oil, Gas and CBM Leased  
1.75 Acres                      0.3022%
- 1B. Coal Mountain Mining Company, LLP (67.00 Acre Tract) – Coal  
Buchanan Mining Company LLC – Below Drainage Coal Leased  
RAMACO Resources Land Holdings, LLC – Coal In Tiller and Above Leased  
Pocahontas Gas LLC – Oil, Gas and CBM  
3.59 Acres                      0.0715%
2.     **Transferred to Buch No 1 South 1 Panel SGU**
3.     **Transferred to Buch No 1 South 1 Panel SGU**
- 4A. Coal Mountain Mining Company, LLP (31.00 Acre Tract) – Coal and Gas  
Buchanan Mining Company LLC – Below Drainage Coal Leased  
RAMACO Resources Land Holdings, LLC – Coal In Tiller and Above Leased  
Gary Davis, et al – Minerals less Coal and Gas  
1.32 Acres                      0.1795%
- 4B. Coal Mountain Mining Company, LLP (31.00 Acre Tract) – Coal and Gas  
Buchanan Mining Company LLC – Below Drainage Coal Leased  
RAMACO Resources Land Holdings, LLC – Coal In Tiller and Above Leased  
Pocahontas Gas LLC – CBM Leased  
Elbert Boyd Heirs – Minerals less Coal and Gas  
6.70 Acres                      0.1335%
- 4C. Coal Mountain Mining Company, LLP (31.00 Acre Tract) – Coal  
Buchanan Mining Company LLC – Below Drainage Coal Leased  
RAMACO Resources Land Holdings, LLC – Coal In Tiller and Above Leased  
Pocahontas Gas LLC – Oil, Gas and CBM  
1.57 Acres                      0.0313%
5. Coal Mountain Mining Company, LLP (94.00 Acre Tract) – Coal  
Buchanan Mining Company LLC – Below Drainage Coal Leased  
RAMACO Resources Land Holdings, LLC – Coal In Tiller and Above Leased  
Pocahontas Gas LLC – Oil, Gas and CBM  
26.20 Acres                      0.9143%
6.     **Transferred to Buch No 1 South 1 Panel SGU**

"This title block is for general informational purposes only and does not reflect an analysis of the severance deed and its effect upon coal bed methane ownership and should not be relied upon for such purpose."

**Pocahontas Gas LLC**  
**VS18 (4,721.14 acre unit)**  
**Tract Identifications**

7. Coal Mountain Mining Company, LLP (94.00 Acre Tract) – Coal  
Buchanan Mining Company LLC – Below Drainage Coal Leased  
RAMACO Resources Land Holdings, LLC – Coal in Tiller and Above Leased  
Allie Davis Clowers, et al – Oil and Gas  
17.47 Acres     0.8248%
  
8. Coal Mountain Mining Company, LLP (331.00 Acre Tract) – All Minerals  
Buchanan Mining Company LLC – Below Drainage Coal Leased  
RAMACO Resources Land Holdings, LLC – Coal in Tiller and Above Leased  
Pocahontas Gas LLC – Oil, Gas, and CBM Leased  
41.68 Acres     3.0488%
  
9. **Transferred to Buch No 1 South 1 Panel SGU**
  
10. Coal Mountain Mining Company, LLP (346.00 Acres Tract 290) - Minerals  
Buchanan Mining Company LLC – Below Drainage Coal Leased  
RAMACO Resources Land Holdings, LLC – Coal in the Tiller and Above Leased  
Pocahontas Gas LLC – Oil, Gas, and CBM Leased  
56.40 Acres     3.1267%
  
11. Coal Mountain Mining Company, L.L.P. (35.00 Acres Tract 30) – All Minerals  
Buchanan Mining Company LLC – Below Drainage Coal Leased  
RAMACO Resources Land Holdings, LLC – Coal in Tiller and Above Leased  
Pocahontas Gas LLC – Oil, Gas, and CBM Leased  
46.79 Acres     0.9322%
  
12. Buchanan Mining Company, LLC – Coal  
Pocahontas Gas LLC – Oil, Gas, and CBM  
5.17 Acres     0.1030%
  
13. Coal Mountain Mining Company, L.L.P. (79.00 Acres) – All Minerals  
Buchanan Mining Company LLC – Below Drainage Coal Leased  
RAMACO Resources Land Holdings, LLC – Coal in Tiller and Above Leased  
Pocahontas Gas LLC – Oil, Gas, and CBM Leased  
86.43 Acres     1.7219%
  
14. Buchanan Mining Company LLC, et al – Coal  
Island Creek Coal Company – Coal Below Tiller Seam Leased  
Buchanan Mining Company LLC, et al – P3 Seam Leased  
Mountaineer Metallurgical Holdings LLC – Tiller and Above Coal Leased  
Weyerhaeuser NR Company, et al – Oil, Gas, and CBM  
Pocahontas Gas LLC – CBM Leased  
11.23 Acres     0.2237%

"This title block is for general informational purposes only and does not reflect an analysis of the severance deed and its effect upon coal bed methane ownership and should not be relied upon for such purpose."

**Pocahontas Gas LLC**  
**VS18 (4,721.14 acre unit)**  
**Tract Identifications**

15. Commonwealth of Virginia – All minerals except P-3 Seam  
Buchanan Mining Company LLC – Coal in P-3 Seam  
Pocahontas Gas LLC – Oil and Gas in P-3 Seam  
3.01 Acres      0.0600%
  
16. Coal Mountain Mining Company, L.L.P. (182.00 Acres) – All Minerals  
Buchanan Mining Company LLC – Below Drainage Coal Leased  
RAMACO Resources Land Holdings, LLC – Coal in Tiller and Above Leased  
Pocahontas Gas LLC – Oil, Gas, and CBM Leased  
152.88 Acres    3.0456%
  
17. Buchanan Mining Company LLC – Coal  
Pocahontas Gas LLC – Oil, Gas, and CBM  
2.00 Acres      0.0398%
  
18. Coal Mountain Mining Company, L.L.P. (35.00 Acres Tract 8) – Fee  
Buchanan Mining Company LLC – Below Drainage Coal Leased  
RAMACO Resources Land Holdings, LLC – Coal in Tiller and Above Leased  
Pocahontas Gas LLC – Oil, Gas, and CBM Leased  
38.14 Acres      0.7599%
  
19. Coal Mountain Mining Company, L.L.P. (182.00 Acres) – All Minerals  
Buchanan Mining Company LLC – Below Drainage Coal Leased  
RAMACO Resources Land Holdings, LLC – Coal in Tiller and Above Leased  
Pocahontas Gas LLC – Oil, Gas, and CBM Leased  
115.45 Acres    2.3001%
  
20. Thomas P. Stilwell – Fee  
2.07 Acres      0.0412%
  
21. Coal Mountain Mining Company, L.L.P. (160.00 Acres Tract 34) – All Minerals  
Buchanan Mining Company LLC – Below Drainage Coal Leased  
RAMACO Resources Land Holdings, LLC – Coal in Tiller and Above Leased  
Pocahontas Gas LLC – Oil, Gas, and CBM Leased  
162.41 Acres    3.2355%
  
22. Coal Mountain Mining Company, L.L.P. (181.00 Acres Tract 35) – All Minerals  
Buchanan Mining Company LLC – Below Drainage Coal Leased  
RAMACO Resources Land Holdings, LLC – Coal in Tiller and Above Leased  
Pocahontas Gas LLC – Oil, Gas, and CBM Leased  
35.17 Acres      0.7007%

"This title block is for general informational purposes only and does not reflect an analysis of the severance deed and its effect upon coal bed methane ownership and should not be relied upon for such purpose."

**Pocahontas Gas LLC**  
**VS18 (4,721.14 acre unit)**  
**Tract Identifications**

- 23. Coal Mountain Mining Company, L.L.P. (177.00 Acres Tract 36) – Coal  
Buchanan Mining Company LLC – Below Drainage Coal Leased  
RAMACO Resources Land Holdings, LLC – Coal in Tiller and Above Leased  
Pocahontas Gas LLC, et al (GW McGlothlin 47.90)– Oil and Gas (98.5119% Owned)  
7.12 Acres      0.1419%
  
- 24. Coal Mountain Mining Company, L.L.P. (102.00 Acres Tract 32) – All Minerals  
Buchanan Mining Company LLC – Below Drainage Coal Leased  
RAMACO Resources Land Holdings, LLC – Coal in Tiller and Above Leased  
Pocahontas Gas LLC – Oil, Gas, and CBM Leased  
91.31 Acres      1.8191%
  
- 25. Coal Mountain Mining Company, L.L.P. (122.00 Acres Tract 33) – All Minerals  
Buchanan Mining Company LLC – Below Drainage Coal Leased  
RAMACO Resources Land Holdings, LLC – Coal in Tiller and Above Leased  
Pocahontas Gas LLC – Oil, Gas, and CBM Leased  
134.88 Acres      2.6870%
  
- 26. Coal Mountain Mining Company, L.L.P. (44.75 Acres Tract 11) – Coal  
Buchanan Mining Company LLC – Below Drainage Coal Leased  
RAMACO Resources Land Holdings, LLC – Coal in Tiller and Above Leased  
Connie L. Davidson – Oil, Gas and CBM  
Pocahontas Gas LLC – Oil, Gas, and CBM Leased  
39.28 Acres      0.7826%
  
- 27. Coal Mountain Mining Company, L.L.P. (53.00 Acres Tract 33) – All Minerals  
Buchanan Mining Company LLC – Below Drainage Coal Leased  
RAMACO Resources Land Holdings, LLC – Coal in Tiller and Above Leased  
Pocahontas Gas LLC – Oil, Gas, and CBM Leased  
52.15 Acres      1.0390%
  
- 28. Buchanan Mining Company LLC, et al – Coal  
Island Creek Coal Company – Coal Below Tiller Seam Leased  
Buchanan Mining Company LLC, et al – P3 Seam Leased  
Revelation Energy, LLC – Tiller and Above Coal Leased  
Weyerhaeuser NR Company, et al – Oil, Gas and CBM  
Pocahontas Gas LLC – CBM Leased  
27.30 Acres      0.5439%
  
- 29A. Hurt-McGuire Heirs Trust (628.44 Acre Tract) – Coal  
Buchanan Mining Company LLC – Below Drainage Coal Leased  
RAMACO Resources Land Holdings, LLC – Coal in Tiller and Above Leased  
Janice Davis, et vir – Surface, Oil and Gas  
5.59 Acres      0.1114%

"This title block is for general informational purposes only and does not reflect an analysis of the severance deed and its effect upon coal bed methane ownership and should not be relied upon for such purpose."

**Pocahontas Gas LLC**  
**VS18 (4,721.14 acre unit)**  
**Tract Identifications**

- 29B. Hurt-McGuire Heirs Trust (628.44 Acre Tract) – Coal  
Buchanan Mining Company LLC – Below Drainage Coal Leased  
RAMACO Resources Land Holdings, LLC – Coal in Tiller and Above Leased  
William L. Engardio – Surface, Oil and Gas  
3.74 Acres      0.0745%
- 29C. Hurt-McGuire Heirs Trust (628.44 Acre Tract) – Coal  
Buchanan Mining Company LLC – Below Drainage Coal Leased  
RAMACO Resources Land Holdings, LLC – Coal in Tiller and Above Leased  
Pocahontas Gas LLC – Surface, Oil and Gas  
3.80 Acres      0.0757%
- 29D. Hurt-McGuire Heirs Trust (628.44 Acre Tract) – Coal  
Buchanan Mining Company LLC – Below Drainage Coal Leased  
RAMACO Resources Land Holdings, LLC – Coal in Tiller and Above Leased  
Danny Wayne Hinkle – Surface, Oil and Gas  
1.24 Acres      0.0247%
- 29E. Hurt-McGuire Heirs Trust (628.44 Acre Tract) – Coal  
Buchanan Mining Company LLC – Below Drainage Coal Leased  
RAMACO Resources Land Holdings, LLC – Coal in Tiller and Above Leased  
Commonwealth of Virginia (US 460) – Surface, Oil and Gas  
9.87 Acres      0.1966%
- 29F. Hurt-McGuire Heirs Trust (628.44 Acre Tract) – Coal  
Buchanan Mining Company LLC – Below Drainage Coal Leased  
RAMACO Resources Land Holdings, LLC – Coal in Tiller and Above Leased  
Russell V. Presley, et ux – Surface, Oil and Gas  
3.97 Acres      0.0791%
- 29G. Hurt-McGuire Heirs Trust (628.44 Acre Tract) – Coal  
Buchanan Mining Company LLC – Below Drainage Coal Leased  
RAMACO Resources Land Holdings, LLC – Coal in Tiller and Above Leased  
JADCO Inc. – Surface, Oil and Gas  
0.08 Acres      0.0016%
- 29H. Hurt-McGuire Heirs Trust (628.44 Acre Tract) – Coal  
Buchanan Mining Company LLC – Below Drainage Coal Leased  
RAMACO Resources Land Holdings, LLC – Coal in Tiller and Above Leased  
JADCO Inc. – Surface, Oil and Gas  
0.61 Acres      0.0122%

"This title block is for general informational purposes only and does not reflect an analysis of the severance deed and its effect upon coal bed methane ownership and should not be relied upon for such purpose."

**Pocahontas Gas LLC**  
**VS18 (4,721.14 acre unit)**  
**Tract Identifications**

- 29I. Hurt-McGuire Heirs Trust (628.44 Acre Tract) – Coal  
Buchanan Mining Company LLC – Below Drainage Coal Leased  
RAMACO Resources Land Holdings, LLC – Coal in Tiller and Above Leased  
JADCO Inc. – Surface, Oil and Gas  
0.23 Acres      0.0046%
- 29J. Hurt-McGuire Heirs Trust (628.44 Acre Tract) – Coal  
Buchanan Mining Company LLC – Below Drainage Coal Leased  
RAMACO Resources Land Holdings, LLC – Coal in Tiller and Above Leased  
Pocahontas Gas LLC – Oil and Gas  
0.02 Acres      0.0004%
- 29K. Hurt-McGuire Heirs Trust (628.44 Acre Tract) – Coal  
Buchanan Mining Company LLC – Below Drainage Coal Leased  
RAMACO Resources Land Holdings, LLC – Coal in Tiller and Above Leased  
Pocahontas Gas LLC – Oil, Gas and CBM  
47.18 Acres      0.9400%
- 29L. Hurt-McGuire Heirs Trust (628.44 Acre Tract) – Coal  
Buchanan Mining Company LLC – Below Drainage Coal Leased  
RAMACO Resources Land Holdings, LLC – Coal in Tiller and Above Leased  
Joel and Brenda Burke – Surface, Oil and Gas  
1.16 Acres      0.0231%
- 29M. Hurt-McGuire Heirs Trust (628.44 Acre Tract) – Coal  
Buchanan Mining Company LLC – Below Drainage Coal Leased  
RAMACO Resources Land Holdings, LLC – Coal in Tiller and Above Leased  
Pocahontas Gas LLC – Oil, Gas and CBM  
4.54 Acres      0.0904%
- 29N. Hurt-McGuire Heirs Trust (628.44 Acre Tract) – Coal  
Buchanan Mining Company LLC – Below Drainage Coal Leased  
RAMACO Resources Land Holdings, LLC – Coal in Tiller and Above Leased  
Pocahontas Gas LLC – Surface, Oil and Gas  
2.33 Acres      0.0464%
- 29O. Hurt-McGuire Heirs Trust (628.44 Acre Tract) – Coal  
Buchanan Mining Company LLC – Below Drainage Coal Leased  
RAMACO Resources Land Holdings, LLC – Coal in Tiller and Above Leased  
Commonwealth of Virginia (US 460) – Oil and Gas  
1.98 Acres      0.0394%

"This title block is for general informational purposes only and does not reflect an analysis of the severance deed and its effect upon coal bed methane ownership and should not be relied upon for such purpose."

**Pocahontas Gas LLC**  
**VS18 (4,721.14 acre unit)**  
**Tract Identifications**

- 29P. Hurt-McGuire Heirs Trust (628.44 Acre Tract) – Coal  
Buchanan Mining Company LLC – Below Drainage Coal Leased  
RAMACO Resources Land Holdings, LLC – Coal in Tiller and Above Leased  
Pocahontas Gas LLC – Oil, Gas and CBM  
10.54 Acres      0.2100%
- 29Q. Hurt-McGuire Heirs Trust (628.44 Acre Tract) – Coal  
Buchanan Mining Company LLC – Coal Below Tiller Seam Leased  
RAMACO Resources Land Holdings, LLC – Coal in Tiller and Above Leased  
Pocahontas Gas LLC – Oil and Gas  
1.21 Acres      0.0241%
- 29R. Hurt-McGuire Heirs Trust (628.44 Acre Tract) – Coal  
Buchanan Mining Company LLC – Coal Below Tiller Seam Leased  
RAMACO Resources Land Holdings, LLC – Coal in Tiller and Above Leased  
Commonwealth of Virginia (SR 727) – Oil and Gas  
0.50 Acres      0.0100%
- 29S. Hurt-McGuire Land Trust (628.44 Acre Tract) – Coal  
Buchanan Mining Company LLC – Coal Below Tiller Seam Leased  
RAMACO Resources Land Holdings, LLC – Coal in Tiller and Above Leased  
Commonwealth of Virginia (SR 727) – Oil and Gas  
0.68 Acres      0.0135%
- 29T. Hurt-McGuire Heirs Trust (628.44 Acre Tract) – Coal  
Buchanan Mining Company LLC – Coal Below Tiller Seam Leased  
RAMACO Resources Land Holdings, LLC – Coal in Tiller and Above Leased  
Donald Ray Young – Oil and Gas  
7.31 Acres      0.1456%
- 29U. Hurt-McGuire Heirs Trust (628.44 Acre Tract) – Coal  
Buchanan Mining Company LLC – Coal Below Tiller Seam Leased  
RAMACO Resources Land Holdings, LLC – Coal in Tiller and Above Leased  
Patrick Counts – Oil and Gas  
3.39 Acres      0.0675%
- 29V. Hurt-McGuire Heirs Trust (628.44 Acre Tract) – Coal  
Buchanan Mining Company LLC – Coal Below Tiller Seam Leased  
RAMACO Resources Land Holdings, LLC – Coal in Tiller and Above Leased  
Pocahontas Gas LLC – Oil and Gas  
1.49 Acres      0.0297%

"This title block is for general informational purposes only and does not reflect an analysis of the severance deed and its effect upon coal bed methane ownership and should not be relied upon for such purpose."

**Pocahontas Gas LLC**  
**VS18 (4,721.14 acre unit)**  
**Tract Identifications**

- 29W. Hurt-McGuire Heirs Trust (628.44 Acre Tract) – Coal  
Buchanan Mining Company LLC – Coal Below Tiller Seam Leased  
RAMACO Resources Land Holdings, LLC – Coal in Tiller and Above Leased  
Grady McGlothlin, et ux – Oil and Gas  
0.90 Acres      0.0179%
- 29X. Hurt-McGuire Heirs Trust (628.44 Acre Tract) – Coal  
Buchanan Mining Company LLC – Coal Below Tiller Seam Leased  
RAMACO Resources Land Holdings, LLC – Coal in Tiller and Above Leased  
Commonwealth of Virginia (SR 727) – Oil and Gas  
1.10 Acres      0.0219%
- 29Y. Hurt-McGuire Heirs Trust (628.44 Acre Tract) – Coal  
Buchanan Mining Company LLC – Coal Below Tiller Seam Leased  
RAMACO Resources Land Holdings, LLC – Coal in Tiller and Above Leased  
Oris Ellis Cantrell Heirs – Oil and Gas  
0.89 Acres      0.0177%
30. Buchanan Mining Company LLC, et al (Big Vein Tract) – All Minerals  
Island Creek Coal Company – Coal Below Tiller Seam Leased  
Buchanan Mining Company LLC – P3 Seam of Coal Sub-Leased  
Revelation Energy, LLC – Tiller and Above Coal Leased  
Weyerhaeuser NR Company, et al – Oil, Gas and CBM  
Pocahontas Gas LLC – CBM Leased  
16.35 Acres      0.3257%
31. Commonwealth Coal Corporation (965.00 Acre Tract 2) – All Minerals  
Buchanan Mining Company LLC – Below Drainage Coal Leased  
RAMACO Resources Land Holdings, LLC – Coal in Tiller and Above Leased  
Pocahontas Gas LLC – Oil, Gas and CBM Leased  
779.46 Acres      15.5282%
32. Coal Mountain Mining Company, L.L.P. (319.00 Acre Tract 56) – All Minerals  
Buchanan Mining Company LLC – Below Drainage Coal Leased  
RAMACO Resources Land Holdings, LLC – Above Drainage Coal Leased  
Pocahontas Gas LLC – Oil, Gas, and CBM Leased  
Map 63A Parcel 5  
3.14 Acres      0.0626%

"This title block is for general informational purposes only and does not reflect an analysis of the severance deed and its effect upon coal bed methane ownership and should not be relied upon for such purpose."

**Pocahontas Gas LLC**  
**VS18 (4,721.14 acre unit)**  
**Tract Identifications**

- 33A. Coal Mountain Mining Company, L.L.P. (40.00 Acre Tract 37) – Coal  
Buchanan Mining Company LLC – Below Drainage Coal Leased  
RAMACO Resources Land Holdings, LLC – Above Drainage Coal Leased  
Granville McGlothlin Heirs, et al – Oil and Gas (98.5119% Owned)  
Pocahontas Gas LLC – CBM Leased  
Map 63A Parcel 3  
26.89 Acres      0.5357%
- 33B. Coal Mountain Mining Company, L.L.P. (40.00 Acre Tract 37) – Coal  
Buchanan Mining Company LLC – Below Drainage Coal Leased  
RAMACO Resources Land Holdings, LLC – Above Drainage Coal Leased  
Commonwealth of Virginia – Oil and Gas  
Map 63A Parcel 0  
2.31 Acres      0.0460%
- 33C. Coal Mountain Mining Company, L.L.P. (40.00 Acre Tract 37) – Coal  
Buchanan Mining Company LLC – Below Drainage Coal Leased  
RAMACO Resources Land Holdings, LLC – Above Drainage Coal Leased  
Jimmy Lee McGlothlin – Oil and Gas  
Map 63A Parcel 2  
1.62 Acres      0.0323%
34. Coal Mountain Mining Company, L.L.P. (319.00 Acre Tract 38) – All Minerals  
Buchanan Mining Company LLC – Below Drainage Coal Leased  
RAMACO Resources Land Holdings, LLC – Above Drainage Coal Leased  
Pocahontas Gas LLC – Oil, Gas, and CBM Leased  
Map 34A Parcel 37  
36.48 Acres      0.7268%
35. Commonwealth Coal Corporation (May & Painter Tract 1497.62 Acre Tract) – Fee  
Buchanan Mining Company LLC – Below Drainage Coal Leased  
RAMACO Resources Land Holdings, LLC – Coal in Tiller and Above Leased  
Pocahontas Gas LLC – Oil, Gas and CBM Leased  
Map 84A Parcel 122A  
301.98 Acres      6.0161%
- 36A. Commonwealth Coal Corporation (67.45 Acre Tract 6) – Coal  
Buchanan Mining Company LLC – Below Drainage Coal Leased  
RAMACO Resources Land Holdings, LLC – Coal in Tiller and Above Leased  
Bernard Shortt, et al – Oil and Gas  
Map 64A Parcel 35  
19.31 Acres      0.3847%

"This title block is for general informational purposes only and does not reflect an analysis of the severance deed and its effect upon coal bed methane ownership and should not be relied upon for such purpose."

**Pocahontas Gas LLC**  
**VS18 (4,721.14 acre unit)**  
**Tract Identifications**

- 36B. Commonwealth Coal Corporation (67.45 Acre Tract 6) – Coal  
Buchanan Mining Company LLC – Below Drainage Coal Leased  
RAMACO Resources Land Holdings, LLC – Coal in Tiller and Above Leased  
Bernard Shortt, et al – Oil and Gas  
Map 64A Parcel 35A  
0.19 Acres      0.0038%
- 36C. Commonwealth Coal Corporation (67.45 Acre Tract 6) – Coal  
Buchanan Mining Company LLC – Below Drainage Coal Leased  
RAMACO Resources Land Holdings, LLC – Coal in Tiller and Above Leased  
Robert Rose, et ux or Tom Short Heirs – Oil and Gas  
Map 64A Parcel 34  
0.42 Acres      0.0084%
- 37A. Commonwealth Coal Corporation (29.23 Acre Tract 7) – Coal  
Buchanan Mining Company LLC – Below Drainage Coal Leased  
RAMACO Resources Land Holdings, LLC – Above Drainage Coal Leased  
Robert Rose, et ux or Tom Short Heirs – Oil and Gas  
0.76 Acres      0.0151%
- 37B. Commonwealth Coal Corporation (29.23 Acre Tract 7) – Coal  
Buchanan Mining Company LLC – Below Drainage Coal Leased  
RAMACO Resources Land Holdings, LLC – Above Drainage Coal Leased  
Walter Short, et al – Oil and Gas  
Map 64A Parcel 33  
8.89 Acres      0.1771%
- 37C. Commonwealth Coal Corporation (29.23 Acre Tract 7) – Coal  
Buchanan Mining Company LLC – Below Drainage Coal Leased  
RAMACO Resources Land Holdings, LLC – Above Drainage Coal Leased  
Commonwealth of VA – Oil and Gas  
Map 64A Parcel 0  
1.01 Acres      0.0201%
- 37D. Commonwealth Coal Corporation (29.23 Acre Tract 7) – Coal  
Buchanan Mining Company LLC – Below Drainage Coal Leased  
RAMACO Resources Land Holdings, LLC – Above Drainage Coal Leased  
Walter Short, et al – Oil and Gas  
Map 64A Parcel 32  
0.20 Acres      0.0040%

"This title block is for general informational purposes only and does not reflect an analysis of the severance deed and its effect upon coal bed methane ownership and should not be relied upon for such purpose."

**Pocahontas Gas LLC**  
**VS18 (4,721.14 acre unit)**  
**Tract Identifications**

- 37E. Commonwealth Coal Corporation (29.23 Acre Tract 7) – Coal  
Buchanan Mining Company LLC – Below Drainage Coal Leased  
RAMACO Resources Land Holdings, LLC – Coal in Tiller and Above Leased  
Walter Short, et al – All Minerals except Coal  
Map 64A Parcel 33A  
0.04 Acres      0.0008%
38. Commonwealth Coal Corporation (3.00 Acre Tract 6) – All Minerals  
Buchanan Mining Company LLC – Below Drainage Coal Leased  
RAMACO Resources Land Holdings, LLC – Coal in Tiller and Above Leased  
Pocahontas Gas LLC – Oil, Gas and CBM Leased  
Map 64A Parcel 33B  
2.04 Acres      0.0406%
39. Commonwealth Coal Corporation (2.25 Acre Tract 11) – All Minerals  
Buchanan Mining Company LLC – Below Drainage Coal Leased  
RAMACO Resources Land Holdings, LLC – Above Drainage Coal Leased  
Pocahontas Gas LLC – Oil, Gas and CBM Leased  
2.65 Acres      0.0528%
- 40A. Commonwealth Coal Corporation (T.D. Chambers 222.25 Acre Tract 5) – All Minerals except Oil  
Buchanan Mining Company LLC – Below Drainage Coal Leased  
RAMACO Resources Land Holdings, LLC – Above Drainage Coal Leased  
Pocahontas Gas LLC – Gas and CBM Leased  
212.51 Acres    4.2336%
- 40B. Commonwealth Coal Corporation (T.D. Chambers 222.25 Acre Tract 5) – All Minerals except Oil  
Buchanan Mining Company LLC – Below Drainage Coal Leased  
RAMACO Resources Land Holdings, LLC – Above Drainage Coal Leased  
Pocahontas Gas LLC – Gas and CBM Leased  
0.49 Acres      0.0098%
- 41A. Commonwealth Coal Corporation (87.13 Acre Tract 3) – Coal  
Buchanan Mining Company LLC – Below Drainage Coal Leased  
RAMACO Resources Land Holdings, LLC – Coal in Tiller and Above Leased  
Gary Addison, et al – Oil and Gas  
Pocahontas Gas LLC – Oil, Gas and CBM Leased  
43.66 Acres      0.8698%
- 41B. Commonwealth Coal Corporation (87.13 Acre Tract 3) – Coal  
Buchanan Mining Company LLC – Below Drainage Coal Leased  
RAMACO Resources Land Holdings, LLC – Coal in Tiller and Above Leased  
Curtis Wade Heirs – Oil and Gas  
23.97 Acres      0.4775%

"This title block is for general informational purposes only and does not reflect an analysis of the severance deed and its effect upon coal bed methane ownership and should not be relied upon for such purpose."

**Pocahontas Gas LLC**  
**VS18 (4,721.14 acre unit)**  
**Tract Identifications**

- 41C. Commonwealth Coal Corporation (87.13 Acre Tract 3) – Coal  
Buchanan Mining Company LLC – Below Drainage Coal Leased  
RAMACO Resources Land Holdings, LLC – Coal in Tiller and Above Leased  
Gerald K. Short – Oil and Gas  
10.72 Acres     0.2136%
- 41D. Commonwealth Coal Corporation (87.13 Acre Tract 3) – Coal  
Buchanan Mining Company LLC – Below Drainage Coal Leased  
RAMACO Resources Land Holdings, LLC – Coal in Tiller and Above Leased  
Rondal Wade, et al – Oil and Gas  
3.41 Acres     0.0679%
- 41E. Commonwealth Coal Corporation (87.13 Acre Tract 3) – Coal  
Buchanan Mining Company LLC – Below Drainage Coal Leased  
RAMACO Resources Land Holdings, LLC – Coal in Tiller and Above Leased  
Jimmy Wade, et ux – Oil and Gas  
1.72 Acres     0.0343%
- 41F. Commonwealth Coal Corporation (87.13 Acre Tract 3) – Coal  
Buchanan Mining Company LLC – Below Drainage Coal Leased  
RAMACO Resources Land Holdings, LLC – Coal in Tiller and Above Leased  
Evelyn Sprinkle Brown Heirs – Oil and Gas  
1.66 Acres     0.0331%
- 41G. Commonwealth Coal Corporation (87.13 Acre Tract 3) – Coal  
Buchanan Mining Company LLC – Below Drainage Coal Leased  
RAMACO Resources Land Holdings, LLC – Coal in Tiller and Above Leased  
Commonwealth of Virginia – Oil and Gas  
0.25 Acres     0.0050%
- 41H. Commonwealth Coal Corporation (87.13 Acre Tract 3) – Coal  
Buchanan Mining Company LLC – Below Drainage Coal Leased  
RAMACO Resources Land Holdings, LLC – Coal in Tiller and Above Leased  
Elmer Burke, et ux – Oil and Gas  
1.45 Acres     0.0289%
42. Commonwealth Coal Corporation (299.72 Acre Tract 4) – All Minerals  
Buchanan Mining Company LLC – Below Drainage Coal Leased  
RAMACO Resources Land Holdings, LLC – Coal in Tiller and Above Leased  
Pocahontas Gas LLC – Oil, Gas and CBM Leased  
301.84 Acres     6.0133%

"This title block is for general informational purposes only and does not reflect an analysis of the severance deed and its effect upon coal bed methane ownership and should not be relied upon for such purpose."

**Pocahontas Gas LLC**  
**VS18 (4,721.14 acre unit)**  
**Tract Identifications**

- 43. Coal Mountain Mining Company, L.L.P. (1140.00 Acre Tract 27) – All Minerals  
Buchanan Mining Company LLC – Below Drainage Coal Leased  
RAMACO Resources Land Holdings, LLC – Above Drainage Coal Leased  
Pocahontas Gas LLC – Oil, Gas and CBM Leased  
125.72 Acres 2.5047%
  
- 44. Commonwealth Coal Corporation (1027.00 Acre Tract 8) – All Minerals  
Buchanan Mining Company LLC – Below Drainage Coal Leased  
RAMACO Resources Land Holdings, LLC – Coal in Tiller and Above Leased  
Pocahontas Gas LLC – Oil, Gas and CBM Leased  
Map 64A Parcel 17  
882.64 Acres 17.5838%
  
- 45. Coal Mountain Mining Company, L.L.P. (1186.00 Acre Tract 39) – Fee  
Buchanan Mining Company LLC – Below Drainage Coal Leased  
RAMACO Resources Land Holdings, LLC – Coal in Tiller and Above Leased  
Pocahontas Gas LLC – Oil, Gas and CBM Leased  
Map 65A Parcel 10  
623.54 Acres 12.4221%

"This title block is for general informational purposes only and does not reflect an analysis of the severance deed and its effect upon coal bed methane ownership and should not be relied upon for such purpose."

Revised Exhibit B  
 VS18  
 Docket #VGOB 23-1121-4277-01  
 List of all Owners/Claimants  
 (4,721.14 Acre Unit)

	Acres in Unit	Interest in Unit
<b>I. COAL OWNERSHIP</b>		
<b><u>Tract #1 - 5.34 acres</u></b>		
(1) Coal Mountain Mining Company LLP P.O. Box 675 Tazewell, VA 24651	5.34 acres	0.1131%
<b><u>Tract #2 - Transferred to Buch No 1 South 1 Panel SGU</u></b>		
<b><u>Tract #3 - Transferred to Buch No 1 South 1 Panel SGU</u></b>		
<b><u>Tract #4 - 9.59 acres</u></b>		
(1) Coal Mountain Mining Company LLP P.O. Box 675 Tazewell, VA 24651	9.59 acres	0.2031%
<b><u>Tract #5 - 26.20 Acres</u></b>		
(1) Coal Mountain Mining Company LLP P.O. Box 675 Tazewell, VA 24651	26.20 acres	0.5550%
<b><u>Tract #6 - Transferred to Buch No 1 South 1 Panel SGU</u></b>		
<b><u>Tract #7 - 17.47 Acres</u></b>		
(1) Coal Mountain Mining Company LLP P.O. Box 675 Tazewell, VA 24651	17.47 acres	0.3700%
<b><u>Tract #8 - 41.68 Acres</u></b>		
(1) Coal Mountain Mining Company LLP P.O. Box 675 Tazewell, VA 24651	41.68 acres	0.8828%
<b><u>Tract #9 - Transferred to Buch No 1 South 1 Panel SGU</u></b>		
<b><u>Tract #10 - 56.40 Acres</u></b>		
(1) Coal Mountain Mining Company LLP P.O. Box 675 Tazewell, VA 24651	56.40 acres	1.1946%
<b><u>Tract #11 - 46.79 Acres</u></b>		
(1) Coal Mountain Mining Company LLP P.O. Box 675 Tazewell, VA 24651	46.79 acres	0.9911%
<b><u>Tract #12 - 5.17 Acres</u></b>		
(1) Buchanan Mining Company LLC PO Drawer L Oakwood, VA 24631	5.17 acres	0.1095%
<b><u>Tract #13 - 86.43 Acres</u></b>		
(1) Coal Mountain Mining Company LLP P.O. Box 675 Tazewell, VA 24651	86.43 acres	1.8307%

**Revised Exhibit B**  
**VS18**  
**Docket #VGOB 23-1121-4277-01**  
**List of all Owners/Claimants**  
**(4,721.14 Acre Unit)**

	Acres in Unit	Interest in Unit
<b><u>Tract #14 - 11.23 acres</u></b>		
(1) Buchanan Mining Company LLC, et al	11.23 acres	0.2379%
(a) Yukon Pocahontas Coal Company P.O. Box 187 Tazewell, VA 24651	5.6150 acres 1/2 of 11.23 acres	0.1189%
(b) Buchanan Coal Company P.O. Box 187 Tazewell, VA 24651	1.2478 acres 1/9 of 11.23 acres	0.0264%
(c) Sayers-Pocahontas Coal Company P.O. Box 187 Tazewell, VA 24651	0.6239 acres 1/18 of 11.23 acres	0.0132%
(d) Buchanan Mining Company LLC* PO Drawer L Oakwood, VA 24630	3.7433 acres 1/3 of 11.23 acres	0.0793%
<i>Note: Weyerhaeuser Company (previously Plum Creek Timberlands) retained their CBM interest</i>		
<b><u>Tract #15 - 3.01 Acres</u></b>		
<i>Coal except P-3 Seam:</i>		
(1) Commonwealth of Virginia Department of Highways 2111 Bonham Road Bristol, VA 24201	3.01 acres	0.0638%
<i>P-3 Seam of Coal:</i>		
(2) Buchanan Mining Company LLC PO Drawer L Oakwood, VA 24630	3.01 acres	0.0638%
<b><u>Tract #16 - 152.88 Acres</u></b>		
(1) Coal Mountain Mining Company LLP P.O. Box 675 Tazewell, VA 24651	152.88 acres	3.2382%
<b><u>Tract #17 - 2.00 Acres</u></b>		
(1) Buchanan Mining Company LLC PO Drawer L Oakwood, VA 24630	2.00 acres	0.0424%
<b><u>Tract #18 - 38.14 Acres</u></b>		
(1) Coal Mountain Mining Company LLP P.O. Box 675 Tazewell, VA 24651	38.14 acres	0.8079%
<b><u>Tract #19 - 115.45 Acres</u></b>		
(1) Coal Mountain Mining Company LLP P.O. Box 675 Tazewell, VA 24651	115.45 acres	2.4454%
<b><u>Tract #20 - 2.07 Acres</u></b>		
(1) Thomas P. Stilwell 1898 Old Kentucky Turnpike Road Raven, VA 24639	2.07 acres	0.0438%

**Revised Exhibit B**  
**VS18**  
**Docket #VGOB 23-1121-4277-01**  
**List of all Owners/Claimants**  
**(4,721.14 Acre Unit)**

	Acres in Unit	Interest in Unit
<b><u>Tract #21 - 162.41 Acres</u></b>		
(1) Coal Mountain Mining Company LLP P.O. Box 675 Tazewell, VA 24651	162.41 acres	3.4401%
<b><u>Tract #22 - 35.17 Acres</u></b>		
(1) Coal Mountain Mining Company LLP P.O. Box 675 Tazewell, VA 24651	35.17 acres	0.7449%
<b><u>Tract #23 - 7.12 Acres</u></b>		
(1) Coal Mountain Mining Company LLP P.O. Box 675 Tazewell, VA 24651	7.12 acres	0.1508%
<b><u>Tract #24 - 91.31 Acres</u></b>		
(1) Coal Mountain Mining Company LLP P.O. Box 675 Tazewell, VA 24651	91.31 acres	1.9341%
<b><u>Tract #25 - 134.88 Acres</u></b>		
(1) Coal Mountain Mining Company LLP P.O. Box 675 Tazewell, VA 24651	134.88 acres	2.8569%
<b><u>Tract #26 - 39.28 Acres</u></b>		
(1) Coal Mountain Mining Company LLP P.O. Box 675 Tazewell, VA 24651	39.28 acres	0.8320%
<b><u>Tract #27 - 52.15 Acres</u></b>		
(1) Coal Mountain Mining Company LLP P.O. Box 675 Tazewell, VA 24651	52.15 acres	1.1046%
<b><u>Tract #28 - 27.30 Acres</u></b>		
(1) Buchanan Mining Company LLC, et al	27.30 acres	0.5783%
(a) Yukon Pocahontas Coal Company P.O. Box 187 Tazewell, VA 24651	13.6500 acres 1/2 of 27.30 acres	0.2891%
(b) Buchanan Coal Company P.O. Box 187 Tazewell, VA 24651	3.0333 acres 1/9 of 27.30 acres	0.0643%
(c) Sayers-Pocahontas Coal Company P.O. Box 187 Tazewell, VA 24651	1.5167 acres 1/18 of 27.30 acres	0.0321%
(d) Buchanan Mining Company LLC* PO Drawer L Oakwood, VA 24630	9.1000 acres 1/3 of 27.30 acres	0.1928%

*Note: Weyerhaeuser Company (previously Plum Creek Timberlands) retained their CBM interest*

**Revised Exhibit B**  
**VS18**  
**Docket #VGOB 23-1121-4277-01**  
**List of all Owners/Claimants**  
**(4,721.14 Acre Unit)**

	Acres in Unit	Interest in Unit
<b><u>Tract #29 - 114.35 Acres</u></b>		
(1) McGuire Hurt Heirs Trust c/o Charles Green 15519 Lookout Ridge Bristol, VA 24202-5080	114.35 acres	2.4221%
<b><u>Tract #30 - 16.35 Acres</u></b>		
(1) Buchanan Mining Company LLC, et al	16.35 acres	0.3463%
(a) Yukon Pocahontas Coal Company P.O. Box 187 Tazewell, VA 24651	8.1750 acres 1/2 of 16.35 acres	0.1732%
(b) Buchanan Coal Company P.O. Box 187 Tazewell, VA 24651	1.8167 acres 1/9 of 16.35 acres	0.0385%
(c) Sayers-Pocahontas Coal Company P.O. Box 187 Tazewell, VA 24651	0.9083 acres 1/18 of 16.35 acres	0.0192%
(d) Buchanan Mining Company LLC* PO Drawer L Oakwood, VA 24630	5.4500 acres 1/3 of 16.35 acres	0.1154%
<i>Note: Weyerhaeuser Company (previously Plum Creek Timberlands) retained their CBM interest</i>		
<b><u>Tract #31 - 779.46 Acres</u></b>		
(1) Commonwealth Coal Corporation PO Box 1269 Bristol, VA 24203	779.46 acres	16.5100%
<b><u>Tract #32 - 3.14 Acres</u></b>		
(1) Coal Mountain Mining Company LLP P.O. Box 675 Tazewell, VA 24651	3.14 acres	0.0665%
<b><u>Tract #33 - 30.82 Acres</u></b>		
(1) Coal Mountain Mining Company LLP P.O. Box 675 Tazewell, VA 24651	30.82 acres	0.6528%
<b><u>Tract #34 - 36.48 Acres</u></b>		
(1) Coal Mountain Mining Company LLP P.O. Box 675 Tazewell, VA 24651	36.48 acres	0.7727%
<b><u>Tract #35 - 301.98 Acres</u></b>		
(1) Commonwealth Coal Corporation PO Box 1269 Bristol, VA 24203	301.98 acres	6.3963%
<b><u>Tract #36 - 19.92 Acres</u></b>		
(1) Commonwealth Coal Corporation PO Box 1269 Bristol, VA 24203	19.92 acres	0.4219%

Revised Exhibit B  
 VS18  
 Docket #VGOB 23-1121-4277-01  
 List of all Owners/Claimants  
 (4,721.14 Acre Unit)

	Acres in Unit	Interest in Unit
<b><u>Tract #37 - 10.90 Acres</u></b>		
(1) Commonwealth Coal Corporation PO Box 1269 Bristol, VA 24203	10.90 acres	0.2309%
<b><u>Tract #38 - 2.04 Acres</u></b>		
(1) Commonwealth Coal Corporation PO Box 1269 Bristol, VA 24203	2.04 acres	0.0432%
<b><u>Tract #39 - 2.65 Acres</u></b>		
(1) Commonwealth Coal Corporation PO Box 1269 Bristol, VA 24203	2.65 acres	0.0561%
<b><u>Tract #40 - 213.00 Acres</u></b>		
(1) Commonwealth Coal Corporation PO Box 1269 Bristol, VA 24203	213.00 acres	4.5116%
<b><u>Tract #41 - 86.84 Acres</u></b>		
(1) Commonwealth Coal Corporation PO Box 1269 Bristol, VA 24203	86.84 acres	1.8394%
<b><u>Tract #42 - 301.84 Acres</u></b>		
(1) Commonwealth Coal Corporation PO Box 1269 Bristol, VA 24203	301.84 acres	6.3934%
<b><u>Tract #43 - 125.72 Acres</u></b>		
(1) Coal Mountain Mining Company LLP P.O. Box 675 Tazewell, VA 24651	125.72 acres	2.6629%
<b><u>Tract #44 - 882.64 Acres</u></b>		
(1) Commonwealth Coal Corporation PO Box 1269 Bristol, VA 24203	882.64 acres	18.6955%
<b><u>Tract #45 - 623.54 Acres</u></b>		
(1) Coal Mountain Mining Company LLP P.O. Box 675 Tazewell, VA 24651	623.54 acres	13.2074%

**II. OIL & GAS OWNERSHIP**

**Tract #1A - 1.75 Acres**

(1) Patricia Smith Cook, et al		
(a) Mildred Ratliff Smith (DOD 1/26/2021)	1.75 acres	0.0371%

*Conveyed by Deed of Gift dated 11/8/2016 and recorded 12/2/2016  
 by Instrument 160002211, Life Estate reserved to Mildred R. Smith*

Remainder:

**Revised Exhibit B**  
**VS18**  
**Docket #VGOB 23-1121-4277-01**  
**List of all Owners/Claimants**  
**(4,721.14 Acre Unit)**

	Acres in Unit	Interest in Unit
(a.1) Patricia Smith Cook 728 W. Locust Street Johnson City, TN 37604	0.5833 acres 1/3 of 1.75 acres	0.0124%
(a.2) Linda Kay Ratliff Smith PO Box 192 Hurley, VA 24620	0.5833 acres 1/3 of 1.75 acres	0.0124%
(a.3) Sandra Smith Spears 69 Carefree Lane Kilmarnock, VA 22485	0.5833 acres 1/3 of 1.75 acres	0.0124%
<b><u>Tract #1B - 3.59 Acres</u></b>		
(1) Pocahontas Gas LLC 1000 Horizon Vue Drive, Ste 400 Canonsburg, PA 15317	3.59 acres	0.0760%
<b><u>Tract #2 - Transferred to Buch No 1 South 1 Panel SGU</u></b>		
<b><u>Tract #3 - Transferred to Buch No 1 South 1 Panel SGU</u></b>		
<b><u>Tract #4A - 1.32 Acres</u></b>		
(1) Coal Mountain Mining Company LLP P.O. Box 675 Tazewell, VA 24651	1.32 acres	0.0280%
<b><u>Tract #4B - 6.70 Acres</u></b>		
(1) Coal Mountain Mining Company LLP P.O. Box 675 Tazewell, VA 24651	6.70 acres	0.1419%
<b><u>Tract #4C - 1.57 Acres</u></b>		
(1) Coal Mountain Mining Company LLP P.O. Box 675 Tazewell, VA 24651	1.57 acres	0.0333%
<b><u>Tract #5 - 26.20 Acres</u></b>		
(1) Pocahontas Gas LLC 1000 Horizon Vue Drive, Ste 400 Canonsburg, PA 15317	26.20 acres	0.5550%
<b><u>Tract #6 - Transferred to Buch No 1 South 1 Panel SGU</u></b>		
<b><u>Tract #7 - 17.47 Acres</u></b>		
<i>Note: CBM ownership was adjudicated to the prevailing plaintiffs under Case no. CL 11-0497-00 The Corrected Final Order was executed September 29, 2011 and plaintiffs were awarded 100% of the Coalbed Methane Gas underlying this tract.</i>		
(1) Loya Edgar Davis Compton Heirs, Devisees, Successors or Assigns <i>(71.75 acre tract)</i>	17.47 acres	0.3700%
(a) Allie Davis Clowers 150 County Road 161 Riceville, TN 37370	2.18 acres 1/8 of 17.47 acres	0.0463%
(b) Buford Davis Heirs, Devisees, Successors, or Assigns		
(b.1) Doris Davis 827 Green Acres Street Pounding Mill, VA 24637	2.18 acres 1/8 of 17.47 acres	0.0463%

**Revised Exhibit B**  
**VS18**  
**Docket #VGOB 23-1121-4277-01**  
**List of all Owners/Claimants**  
**(4,721.14 Acre Unit)**

	Acres in Unit	Interest in Unit
(c) Billy D. Davis Heirs, Devisees, Successors or Assigns		
(c.1) Billy Michael Davis 1839 W. Market Street Smithfield, NC 27577	1.09 acres 1/16 of 17.47 acres	0.0231%
(c.2) Lisa Diane Davis 1839 W Market Street Smithfield, NC 27577	1.09 acres 1/16 of 17.47 acres	0.0231%
(d) Joe Darrell Davis 1752 Sandy Gap Rd. Raven, VA 24639	2.18 acres 1/8 of 17.47 acres	0.0463%
(e) Bobby Davis 101 Able Road Cedar Bluff, VA 24609	2.18 acres 1/8 of 17.47 acres	0.0463%
(f) Gary Davis 1189 Point Road Raven, VA 24639	2.18 acres 1/8 of 17.47 acres	0.0463%
(g) Larry Wayne Davis PO Box 183 Pounding Mill, VA 24637	2.18 acres 1/8 of 17.47 acres	0.0463%
(h) Jimmy A. Davis Heirs, Devisees, Successors or Assigns		
(h.1) Dorothy Davis, Sandy Barnette, Mark Davis, and Jimmy Davis, Jr. <i>Conveyed to (h.2) as tenants in entirety with right of survivorship, Instrument# 100001037 dated 4/20/2010</i>		
(h.2) Larry Wayne and Jacqueline Davis, TE PO Box 183 Pounding Mill, VA 24637	2.18 acres 1/8 of 17.47 acres	0.0463%
<b><u>Tract #8 - 41.68 Acres</u></b>		
(1) Coal Mountain Mining Company LLP P.O. Box 675 Tazewell, VA 24651	41.68 acres	0.8828%
<b><u>Tract #9 - Transferred to Buch No 1 South 1 Panel SGU</u></b>		
<b><u>Tract #10 - 56.40 Acres</u></b>		
(1) Coal Mountain Mining Company LLP P.O. Box 675 Tazewell, VA 24651	56.40 acres	1.1946%
<b><u>Tract #11 - 46.79 Acres</u></b>		
(1) Coal Mountain Mining Company LLP P.O. Box 675 Tazewell, VA 24651	46.79 acres	0.9911%
<b><u>Tract #12 - 5.17 Acres</u></b>		
(1) Pocahontas Gas LLC 1000 Horizon Vue Drive, Ste 400 Canonsburg, PA 15317	5.17 acres	0.1095%
<b><u>Tract #13 - 86.43 Acres</u></b>		
(1) Coal Mountain Mining Company LLP P.O. Box 675 Tazewell, VA 24651	86.43 acres	1.8307%

Revised Exhibit B  
 VS18  
 Docket #VGOB 23-1121-4277-01  
 List of all Owners/Claimants  
 (4,721.14 Acre Unit)

	Acres in Unit	Interest in Unit
<b><u>Tract #14 - 11.23 Acres</u></b>		
(1) Weyerhaeuser Company, et al	11.23 acres	0.2379%
(a) Yukon Pocahontas Coal Company P.O. Box 187 Tazewell, VA 24651	5.6150 acres 1/2 of 11.23 acres	0.1189%
(b) Buchanan Coal Company P.O. Box 187 Tazewell, VA 24651	1.2478 acres 1/9 of 11.23 acres	0.0264%
(c) Sayers-Pocahontas Coal Company P.O. Box 187 Tazewell, VA 24651	0.6239 acres 1/18 of 11.23 acres	0.0132%
(d) Weyerhaeuser Forest Holdings, Inc. PO Box 750121 Atlanta, GA 30374-7921	3.7433 acres 1/3 of 11.23 acres	0.0793%
<b><u>Tract #15 - 3.01 Acres</u></b>		
(1) Commonwealth of Virginia Department of Highways 2111 Bonham Road Bristol, VA 24201	3.01 acres	0.0638%
<b><u>Tract #16 - 152.88 Acres</u></b>		
(1) Coal Mountain Mining Company LLP P.O. Box 675 Tazewell, VA 24651	152.88 acres	3.2382%
<b><u>Tract #17 - 2.00 Acres</u></b>		
(1) Pocahontas Gas LLC 1000 Horizon Vue Drive, Ste 400 Canonsburg, PA 15317	2.00 acres	0.0424%
<b><u>Tract #18 - 38.14 Acres</u></b>		
(1) Coal Mountain Mining Company LLP P.O. Box 675 Tazewell, VA 24651	38.14 acres	0.8079%
<b><u>Tract #19 - 115.45 Acres</u></b>		
(1) Coal Mountain Mining Company LLP P.O. Box 675 Tazewell, VA 24651	115.45 acres	2.4454%
<b><u>Tract #20 - 2.07 Acres</u></b>		
(1) Thomas P. Stilwell 1898 Old Kentucky Turnpike Road Raven, VA 24639	2.07 acres	0.0438%
<b><u>Tract #21 - 162.41 Acres</u></b>		
(1) Coal Mountain Mining Company LLP P.O. Box 675 Tazewell, VA 24651	162.41 acres	3.4401%
<b><u>Tract #22 - 35.17 Acres</u></b>		
(1) Coal Mountain Mining Company LLP P.O. Box 675 Tazewell, VA 24651	35.17 acres	0.7449%

**Revised Exhibit B**  
**VS18**  
**Docket #VGOB 23-1121-4277-01**  
**List of all Owners/Claimants**  
**(4,721.14 Acre Unit)**

	Acres in Unit	Interest in Unit
<b><u>Tract #23 - 7.12 Acres</u></b>		
(1) Pocahontas Gas LLC, et al <i>(47.90 Acre Tract)</i>	7.12 acres	0.1508%
(a) Pocahontas Gas LLC 1000 Horizon Vue Drive, Ste 400 Canonsburg, PA 15317	7.014 acres 331/336 of 7.12 acres	0.1486%
(b) Ruie McGlothlin Heirs, Devisees, Successors, or Assigns		
(b.1) Junior C. McGlothlin Heirs, Devisees, Successors, or Assigns		
(b.1.1) Janet E. McGlothlin Heirs, Devisees, Successors, or Assigns		
(b.1.1.1) Johnny Dwight McGlothlin 820 Baptist Valley Road Cedar Bluff, VA 24609	0.011 acres 1/672 of 7.12 acres	0.0002%
(b.2) Helen Adams Heirs, Devisees, Successors, or Assigns <i>(Documentation Pending)</i>	0.032 acres 1/224 of 7.12 acres	0.0007%
(b.2.1) Bernie Gene Adams 14309 Phoenix Road Phoenix, MD 21131		
(b.2.2) Michael Adams 220 E Lakeview Street Umatilla, FL 32784		
(b.3) Ruby Lee Zwald Heirs, Devisees, Successors, or Assigns		
(b.3.1) Walter Lawrence Finney Heirs, Devisees, Successors, or Assigns		
(b.3.1.1) Shelby Ann Finney <i>Conveyed to Cheryl Keen Tucker and Bernie Gene Adams as tenants in common, RC - Instr# 220001375, BC - Instr# 220000738, TC - Instr# 220001829, all dated 6/6/2022</i>		
(b.3.1.1.1) Cheryl Keen Tucker 170 Charleston Place Daleville, VA 24083	0.016 acres 1/448 of 7.12 acres	0.0003%
(b.3.1.1.2) Bernie Gene Adams 14309 Phoenix Road Phoenix, MD 21131	0.016 acres 1/448 of 7.12 acres	0.0003%
(b.4) Mary R. Barnett Heirs, Devisees, Successors, or Assigns		
(b.4.1) Cheryl Keen Tucker 170 Charleston Place Daleville, VA 24083	0.032 acres 1/224 of 7.12 acres	0.0007%
<b><u>Tract #24 - 91.31 Acres</u></b>		
(1) Coal Mountain Mining Company LLP P.O. Box 675 Tazewell, VA 24651	91.31 acres	1.9341%

**Revised Exhibit B**  
**VS18**  
**Docket #VGOB 23-1121-4277-01**  
**List of all Owners/Claimants**  
**(4,721.14 Acre Unit)**

	Acres in Unit	Interest in Unit
<b><u>Tract #25 - 134.88 Acres</u></b>		
(1) Coal Mountain Mining Company LLP P.O. Box 675 Tazewell, VA 24651	134.88 acres	2.8569%
<b><u>Tract #26 - 39.28 Acres</u></b>		
(1) Connie Davidson 127 Apache Lane, Apt 25 Marion, VA 24354	39.28 acres	0.8320%
<b><u>Tract #27 - 52.15 Acres</u></b>		
(1) Coal Mountain Mining Company LLP P.O. Box 675 Tazewell, VA 24651	52.15 acres	1.1046%
<b><u>Tract #28 - 27.30 Acres</u></b>		
(1) Weyerhaeuser Company, et al	27.30 acres	0.5783%
(a) Yukon Pocahontas Coal Company P.O. Box 187 Tazewell, VA 24651	13.6500 acres 1/2 of 27.30 acres	0.2891%
(b) Buchanan Coal Company P.O. Box 187 Tazewell, VA 24651	3.0333 acres 1/9 of 27.30 acres	0.0643%
(c) Sayers-Pocahontas Coal Company P.O. Box 187 Tazewell, VA 24651	1.5167 acres 1/18 of 27.30 acres	0.0321%
(d) Weyerhaeuser Forest Holdings, Inc. PO Box 750121 Atlanta, GA 30374-7921	9.1000 acres 1/3 of 27.30 acres	0.1928%
<b><u>Tract #29A - 5.59 Acres</u></b>		
(1) Janice L. & Jeremy W. Davis, TE 1011 Betsy Branch Road Raven, VA 24639	5.59 acres	0.1184%
<b><u>Tract #29B - 3.74 Acres</u></b>		
(1) William & Hannalore Engardio, T/E 3187 Riverside Drive Raven, VA 24639	3.74 acres	0.0792%
<b><u>Tract #29C - 3.80 Acres</u></b>		
(1) Pocahontas Gas LLC 1000 Horizon Vue Drive, Ste 400 Canonsburg, PA 15317	3.80 acres	0.0805%
<b><u>Tract #29D - 1.24 Acres</u></b>		
(1) Danny Wayne Hinkle PO Box 571 Oakwood, VA 24631	1.24 acres	0.0263%
<b><u>Tract #29E - 9.87 Acres</u></b>		
(1) Commonwealth of Virginia Department of Transportation 2111 Bonham Road Bristol, VA 24201	9.87 acres	0.2091%

Revised Exhibit B  
 VS18  
 Docket #VGOB 23-1121-4277-01  
 List of all Owners/Claimants  
 (4,721.14 Acre Unit)

	Acres in Unit	Interest in Unit
<b><u>Tract #29F - 3.97 Acres</u></b>		
(1) Russell V. and Anita Presley, TE PO Box 463 Keen Mountain, VA 24624	3.97 acres	0.0841%
<b><u>Tract #29G - 0.08 Acres</u></b>		
(1) Jadco, Inc. 3081 Riverside Drive Raven, VA 24639	0.08 acres	0.0017%
<b><u>Tract #29H - 0.61 Acres</u></b>		
(1) Jadco, Inc. 3081 Riverside Drive Raven, VA 24639	0.61 acres	0.0129%
<b><u>Tract #29I - 0.23 Acres</u></b>		
(1) Jadco, Inc. 3081 Riverside Drive Raven, VA 24639	0.23 acres	0.0049%
<b><u>Tract #29J - 0.02 Acres</u></b>		
(1) Pocahontas Gas LLC 1000 Horizon Vue Drive, Ste 400 Canonsburg, PA 15317	0.02 acres	0.0004%
<b><u>Tract #29K - 47.18 Acres</u></b>		
(1) Pocahontas Gas LLC 1000 Horizon Vue Drive, Ste 400 Canonsburg, PA 15317	47.18 acres	0.9993%
<b><u>Tract #29L - 1.16 Acres</u></b>		
(1) Joel D. & Brenda L. Burke PO Box 33 Rowe, VA 24646	1.16 acres	0.0246%
<b><u>Tract #29M - 4.54 Acres</u></b>		
(1) Pocahontas Gas LLC 1000 Horizon Vue Drive, Ste 400 Canonsburg, PA 15317	4.54 acres	0.0962%
<b><u>Tract #29N - 2.33 Acres</u></b>		
(1) Pocahontas Gas LLC 1000 Horizon Vue Drive, Ste 400 Canonsburg, PA 15317	2.33 acres	0.0494%
<b><u>Tract #29O - 1.98 Acres</u></b>		
(1) Commonwealth of Virginia Department of Transportation 2111 Bonham Road Bristol, VA 24201	1.98 acres	0.0419%
<b><u>Tract #29P - 10.54 Acres</u></b>		
(1) Pocahontas Gas LLC 1000 Horizon Vue Drive, Ste 400 Canonsburg, PA 15317	10.54 acres	0.2233%

Revised Exhibit B  
 VS18  
 Docket #VGOB 23-1121-4277-01  
 List of all Owners/Claimants  
 (4,721.14 Acre Unit)

	Acres in Unit	Interest in Unit
<b><u>Tract #29Q - 1.21 Acres</u></b>		
(1) Pocahontas Gas LLC 1000 Horizon Vue Drive, Ste 400 Canonsburg, PA 15317	1.21 acres	0.0256%
<b><u>Tract #29R - 0.50 Acres</u></b>		
(1) Commonwealth of Virginia Department of Transportation 2111 Bonham Road Bristol, VA 24201	0.50 acres	0.0106%
<b><u>Tract #29S - 0.68 Acres</u></b>		
(1) Commonwealth of Virginia Department of Transportation 2111 Bonham Road Bristol, VA 24201	0.68 acres	0.0144%
<b><u>Tract #29T - 7.31 Acres</u></b>		
(1) Donald Ray Young 1066 E Cross Roads Drive Lebanon, VA 24266	7.31 acres	0.1548%
<b><u>Tract #29U - 3.39 Acres</u></b>		
(1) Patrick Counts 1665 Riverside Drive Raven, VA 24639	3.39 acres	0.0718%
<b><u>Tract #29V - 1.49 Acres</u></b>		
(1) Pocahontas Gas LLC 1000 Horizon Vue Drive, Ste 400 Canonsburg, PA 15317	1.49 acres	0.0316%
<b><u>Tract #29W - 0.90 Acres</u></b>		
(1) Grady W. & Pauline J. McGlothlin PO Box 955 Raven, VA 24639	0.90 acres	0.0191%
<b><u>Tract #29X - 1.10 Acres</u></b>		
(1) Commonwealth of Virginia Department of Transportation 2111 Bonham Road Bristol, VA 24201	1.10 acres	0.0233%
<b><u>Tract #29Y - 0.89 Acres</u></b>		
(1) Oris Cantrell Heirs, Devisees, Successors, or Assigns	0.89 acres	0.0189%
(a) Amy Mae Hess PO Box 922 Vansant, VA 24656	0.2225 acres 1/4 of 0.89 acres	0.0047%
(b) Jamie Cantrell 282 Westview Street Pounding Mill, VA 24637	0.2225 acres 1/4 of 0.89 acres	0.0047%
(c) Penny Falck 2390 Glade Drive Christiansburg, VA 24073	0.2225 acres 1/4 of 0.89 acres	0.0047%

**Revised Exhibit B**  
**VS18**  
**Docket #VGOB 23-1121-4277-01**  
**List of all Owners/Claimants**  
**(4,721.14 Acre Unit)**

	Acres in Unit	Interest in Unit
(d) Cathleen Arrington 7342 Pine Street Radford, VA 24141	0.2225 acres 1/4 of 0.89 acres	0.0047%
<b><u>Tract #30 - 16.35 Acres</u></b>		
(1) Weyerhaeuser Company, et al	16.35 acres	0.3463%
(a) Yukon Pocahontas Coal Company P.O. Box 187 Tazewell, VA 24651	8.1750 acres 1/2 of 16.35 acres	0.1732%
(b) Buchanan Coal Company P.O. Box 187 Tazewell, VA 24651	1.8167 acres 1/9 of 16.35 acres	0.0385%
(c) Sayers-Pocahontas Coal Company P.O. Box 187 Tazewell, VA 24651	0.9083 acres 1/18 of 16.35 acres	0.0192%
(d) Weyerhaeuser Forest Holdings, Inc. PO Box 750121 Atlanta, GA 30374-7921	5.4500 acres 1/3 of 16.35 acres	0.1154%
<b><u>Tract #31 - 779.46 Acres</u></b>		
(1) Commonwealth Coal Corporation PO Box 1269 Bristol, VA 24203	779.46 acres	16.5100%
<b><u>Tract #32 - 3.14 Acres</u></b>		
(1) Coal Mountain Mining Company LLP P.O. Box 675 Tazewell, VA 24651	3.14 acres	0.0665%
<b><u>Tract #33A - 26.89 Acres</u></b>		
(1) Pocahontas Gas LLC, et al <i>(37.00 Acre Tract)</i>	26.89 acres	0.5696%
(a) Pocahontas Gas LLC 1000 Horizon Vue Drive, Ste 400 Canonsburg, PA 15317	26.490 acres 331/336 of 26.89 acres	0.5611%
(b) Ruie McGlothlin Heirs, Devisees, Successors, or Assigns		
(b.1) Junior C. McGlothlin Heirs, Devisees, Successors, or Assigns		
(b.1.1) Janet E. McGlothlin Heirs, Devisees, Successors, or Assigns		
(b.1.1.1) Johnny Dwight McGlothlin 820 Baptist Valley Road Cedar Bluff, VA 24609	0.040 acres 1/672 of 26.89 acres	0.0008%
(b.2) Helen Adams Heirs, Devisees, Successors, or Assigns <i>(Documentation Pending)</i>	0.120 acres 1/224 of 26.89 acres	0.0025%
(b.2.1) Bernie Gene Adams 14309 Phoenix Road Phoenix, MD 21131		
(b.2.2) Michael Adams 220 E Lakeview Street Umatilla, FL 32784		

**Revised Exhibit B**  
**VS18**  
**Docket #VGOB 23-1121-4277-01**  
**List of all Owners/Claimants**  
**(4,721.14 Acre Unit)**

	Acres in Unit	Interest in Unit
(b.3) Ruby Lee Zwald Heirs, Devisees, Successors, or Assigns		
(b.3.1) Walter Lawrence Finney Heirs, Devisees, Successors, or Assigns		
(b.3.1.1) Shelby Ann Finney <i>Conveyed to Cheryl Keen Tucker and Bernie Gene Adams as tenants in common, RC - Instr# 220001375, BC - Instr# 220000738, TC - Instr# 220001829, all dated 6/6/2022</i>		
(b.3.1.1.1) Cheryl Keen Tucker 170 Charleston Place Daleville, VA 24083	0.060 acres 1/448 of 26.89 acres	0.0013%
(b.3.1.1.2) Bernie Gene Adams 14309 Phoenix Road Phoenix, MD 21131	0.060 acres 1/448 of 26.89 acres	0.0013%
(b.4) Mary R. Barnett Heirs, Devisees, Successors, or Assigns		
(b.4.1) Cheryl Keen Tucker 170 Charleston Place Daleville, VA 24083	0.120 acres 1/224 of 26.89 acres	0.0025%
<b><u>Tract #33B - 2.31 Acres</u></b>		
(1) Commonwealth of Virginia Department of Transportation 2111 Bonham Road Bristol, VA 24201	2.31 acres	0.0489%
<b><u>Tract #33C - 1.62 Acres</u></b>		
(1) Jimmy Lee McGlothlin PO Box 987 Raven, VA 24639	1.62 acres	0.0343%
<b><u>Tract #34 - 36.48 Acres</u></b>		
(1) Coal Mountain Mining Company LLP P.O. Box 675 Tazewell, VA 24651	36.48 acres	0.7727%
<b><u>Tract #35 - 301.98 Acres</u></b>		
(1) Commonwealth Coal Corporation PO Box 1269 Bristol, VA 24203	301.98 acres	6.3963%
<b><u>Tract #36A - 19.31 Acres</u></b>		
(1) Bernard Shortt, et al	19.31 acres	0.4090%
(a) Roy Bernard and Linda Ruth Shortt Roy Bernard Shortt ( <i>DOD 11/2/2024</i> )		
Linda Ruth Shortt 642 Shortts Road Raven, VA 24639	<i>Life Estate</i>	
(b) Joshua Andrew Shortt* ( <i>DOD 8/25/2021</i> )		
(c) Barney Andrew Shortt* 728 Shortts Road Raven, VA 24639	9.655 acres 1/2 of 19.31 acres	0.2045%

**Revised Exhibit B**  
**VS18**  
**Docket #VGOB 23-1121-4277-01**  
**List of all Owners/Claimants**  
**(4,721.14 Acre Unit)**

	Acres in Unit	Interest in Unit
(d) Janet Shortt* 728 Shortts Road Raven, VA 24639 <i>*Josua Andrew Shortt, Barney Andrew Shortt, and Janet Shortt were conveyed ownership as joint tenants with right of survivorship</i>	9.655 acres 1/2 of 19.31 acres	0.2045%
<b><u>Tract #36B - 0.19 Acres</u></b>		
(1) Barney Shortt, et al		
(a) Roy Bernard and Linda Ruth Shortt Roy Bernard Shortt (DOD 11/2/2024)		
Linda Ruth Shortt 642 Shortts Road Raven, VA 24639	<i>Life Estate</i>	
(b) Barney Andrew and Janet Shortt** 728 Shortts Road Raven, VA 24639 <i>**Tenants in entirety with right of survivorship</i>	0.19 acres	0.0040%
<b><u>Tract #36C - 0.42 Acres</u></b>		
<i>***Cloud on Title - When Tom Short acquired title to the parent tract of which this property is a portion, he also obtained title to the gas and oil. He then conveyed the property to his wife (Bertha) and reserved all minerals in DB 190/119. Bertha later conveyed back to Tom in DB 217/438, with the same reservation language, though she owned no mineral to reserve. Tom again conveyed to Bertha in DB 281/12, reserving all mineral. Bertha again conveyed to Tom in DB 331/248, and again reserved mineral she did not own. Tom Short and Bertha Short conveyed to Walter M. Short and Jeanette H. Short, in DB 342/400, a 3.2 acre parcel, referencing as the source of title DB 331/248 wherein Bertha reserved mineral she did not own, as the mineral reservation language. The intent of Bertha and Tom Short may have been to reserve all mineral, however, the source reservation language reference within DB 342/400 fails. Correction deeds are necessary to vest title to the oil and gas in either the heirs of Tom Short, or the current surface owners, Robert and Jackie Rose.</i>		
(1) Walter Shortt, et al	0.42 acres	0.0089%
(a) Tommy Arnold Shortt PO Box 1228 Richlands, VA 24641	0.0382 acres 1/11 of 0.42 acres	0.0008%
(b) Walter Mervin Shortt Heirs, Devisees, Successors, or Assigns		
(b.1) Mervin Shortt 815 W Thornwood Drive South Elgin, IL 60177	0.0127 acres 1/33 of 0.42 acres	0.0003%
(b.2) Linda F. Grasso 4016 Silk Oak Lane Palm Harbor, FL 34685	0.0127 acres 1/33 of 0.42 acres	0.0003%
(b.3) Larry Walter Short	<i>pre-deceased</i>	
(b.3.1) Larry Short, Jr. 436 Waverly Street Kingsford, MI 49802	0.0064 acres 1/66 of 0.42 acres	0.0001%
(b.3.2) Tamara Beth Ham 108 Chesterfield Drive Pinehurst, NC 28374	0.0064 acres 1/66 of 0.42 acres	0.0001%
(c) Harold B. Shortt Heirs, Devisees, Successors, or Assigns		
(c.1) Charlene Shortt PO Box 1818 Cedar Bluff, VA 24609	0.0382 acres 1/11 of 0.42 acres	0.0008%

**Revised Exhibit B**  
**VS18**  
**Docket #VGOB 23-1121-4277-01**  
**List of all Owners/Claimants**  
**(4,721.14 Acre Unit)**

	Acres in Unit	Interest in Unit
(d) Glenward Jason Shortt 128 And Street Pounding Mill, VA 24637	0.0382 acres 1/11 of 0.42 acres	0.0008%
(e) Ballard Charlie Shortt Heirs, Deivsees, Successors, or Assigns		
(h.1) Earlean Shortt Heirs, Deivsees, Successors, or Assigns <i>(Documentation Pending)</i>	0.0382 acres 1/11 of 0.42 acres	0.0008%
(h.1.1) Becky Harris 105 Windlass Court Moneta, VA 24121		
(f) Dorothy Short Keene 279 Townview Drive Lebanon, VA 24266	0.0382 acres 1/11 of 0.42 acres	0.0008%
(g) Maudie Short Bronson Heirs, Deivsees, Successors, or Assigns		
(g.1) Kenneth Wingo 1509 East Blow Road Signal Mountain, TN 37377	0.0382 acres 1/11 of 0.42 acres	0.0008%
(h) Effie Shortt Heirs, Deivsees, Successors, or Assigns		
(h.1) Garnie Jean Thomas PO Box 745 Doran, VA 24612	0.0382 acres 1/11 of 0.42 acres	0.0008%
(i) Garnie Jean Thomson <i>Conveyed 11/26/1997 to Harold Short and Glenward Short as JTWROS, DB 472/104</i>		
(i.1) Harold B. Shortt <i>(DOD 1/6/2017)</i>		
(i.2) Glenward Jason Short 128 And Street Pounding Mill, VA 24637	0.0382 acres 1/11 of 0.42 acres	0.0008%
(j) Otis Herbert Shortt Heirs, Deivsees, Successors, or Assigns <i>(Documentation Pending)</i>	0.0382 acres 1/11 of 0.42 acres	0.0008%
(k) Raymond B. Short Heirs, Deivsees, Successors, or Assigns		
(k.1) Delcie Norene Short Heirs, Deivsees, Successors, or Assigns		
(k.1.1) Grover Cleveland Elswick 5220 Looking Glass Trail Denver, NC 28037	0.0191 acres 1/22 of 0.42 acres	0.0004%
(k.1.2) Heather Norene Thornburg 1515 Town N Country Drive Wilkesboro, NC 28697	0.0191 acres 1/22 of 0.42 acres	0.0004%
<b>OR</b>		
(1) Robert and Jackie Rose 1008 Shortts Road Raven, VA 24639	0.42 acres	0.0089%

**Revised Exhibit B**  
**VS18**  
**Docket #VGOB 23-1121-4277-01**  
**List of all Owners/Claimants**  
**(4,721.14 Acre Unit)**

	Acres in Unit	Interest in Unit
<b><u>Tract #37A - 0.76 Acres</u></b>		
<i>***Cloud on Title - When Tom Short acquired title to the parent tract of which this property is a portion, he also obtained title to the gas and oil. He then conveyed the property to his wife (Bertha) and reserved all minerals in DB 190/119. Bertha later conveyed back to Tom in DB 217/438, with the same reservation language, though she owned no mineral to reserve. Tom again conveyed to Bertha in DB 281/12, reserving all mineral. Bertha again conveyed to Tom in DB 331/248, and again reserved mineral she did not own. Tom Short and Bertha Short conveyed to Walter M. Short and Jeanette H. Short, in DB 342/400, a 3.2 acre parcel, referencing as the source of title DB 331/248 wherein Bertha reserved mineral she did not own, as the mineral reservation language. The intent of Bertha and Tom Short may have been to reserve all mineral, however, the source reservation language reference within DB 342/400 fails. Correction deeds are necessary to vest title to the oil and gas in either the heirs of Tom Short, or the current surface owners, Robert and Jackie Rose.</i>		
(1) Walter Shortt, et al	0.76 acres	0.0161%
(a) Tommy Arnold Shortt PO Box 1228 Richlands, VA 24641	0.0691 acres 1/11 of 0.76 acres	0.0015%
(b) Walter Mervin Shortt Heirs, Devisees, Successors, or Assigns		
(b.1) Mervin Shortt 815 W Thornwood Drive South Elgin, IL 60177	0.0230 acres 1/33 of 0.76 acres	0.0005%
(b.2) Linda F. Grasso 4016 Silk Oak Lane Palm Harbor, FL 34685	0.0230 acres 1/33 of 0.76 acres	0.0005%
(b.3) Larry Walter Short	<i>pre-deceased</i>	
(b.3.1) Larry Short, Jr. 436 Waverly Street Kingsford, MI 49802	0.0115 acres 1/66 of 0.76 acres	0.0002%
(b.3.2) Tamara Beth Ham 108 Chesterfield Drive Pinehurst, NC 28374	0.0115 acres 1/66 of 0.76 acres	0.0002%
(c) Harold B. Shortt Heirs, Devisees, Successors, or Assigns		
(c.1) Charlene Shortt PO Box 1818 Cedar Bluff, VA 24609	0.0691 acres 1/11 of 0.76 acres	0.0015%
(d) Glenward Jason Shortt 128 And Street Pounding Mill, VA 24637	0.0691 acres 1/11 of 0.76 acres	0.0015%
(e) Ballard Charlie Shortt Heirs, Devisees, Successors, or Assigns		
(h.1) Earlean Shortt Heirs, Devisees, Successors, or Assigns <i>(Documentation Pending)</i>	0.0691 acres 1/11 of 0.76 acres	0.0015%
(h.1.1) Becky Harris 105 Windlass Court Moneta, VA 24121		
(f) Dorothy Short Keene 279 Townview Drive Lebanon, VA 24266	0.0691 acres 1/11 of 0.76 acres	0.0015%
(g) Maudie Short Bronson Heirs, Devisees, Successors, or Assigns		

**Revised Exhibit B**  
**VS18**  
**Docket #VGOB 23-1121-4277-01**  
**List of all Owners/Claimants**  
**(4,721.14 Acre Unit)**

	Acres in Unit	Interest in Unit
(g.1) Kenneth Wingo 1509 East Blow Road Signal Mountain, TN 37377	0.0691 acres 1/11 of 0.76 acres	0.0015%
(h) Effie Shortt Heirs, Devisees, Successors, or Assigns		
(h.1) Garnie Jean Thomas PO Box 745 Doran, VA 24612	0.0691 acres 1/11 of 0.76 acres	0.0015%
(i) Garnie Jean Thomson	<i>Conveyed 11/26/1997 to Harold Short and Glenward Short as JTWROS, DB 472/104</i>	
(i.1) Harold B. Shortt	<i>(DOD 1/6/2017)</i>	
(i.2) Glenward Jason Short 128 And Street Pounding Mill, VA 24637	0.0691 acres 1/11 of 0.76 acres	0.0015%
(j) Otis Herbert Shortt Heirs, Devisees, Successors, or Assigns <i>(Documentation Pending)</i>	0.0691 acres 1/11 of 0.76 acres	0.0015%
(k) Raymond B. Short Heirs, Devisees, Successors, or Assigns		
(k.1) Delcie Norene Short Heirs, Devisees, Successors, or Assigns		
(k.1.1) Grover Cleveland Elswick 5220 Looking Glass Trail Denver, NC 28037	0.0345 acres 1/22 of 0.76 acres	0.0007%
(k.1.2) Heather Norene Thornburg 1515 Town N Country Drive Wilkesboro, NC 28697	0.0345 acres 1/22 of 0.76 acres	0.0007%
<b>OR</b>		
(1) Robert and Jackie Rose 1008 Shortts Road Raven, VA 24639	0.76 acres	0.0161%
<b><u>Tract #37B - 8.89 Acres</u></b>		
(1) Walter Shortt, et al	8.89 acres	0.1883%
(a) Tommy Arnold Shortt PO Box 1228 Richlands, VA 24641	0.8082 acres 1/11 of 8.89 acres	0.0171%
(b) Walter Mervin Shortt Heirs, Devisees, Successors, or Assigns		
(b.1) Mervin Shortt 815 W Thornwood Drive South Elgin, IL 60177	0.2694 acres 1/33 of 8.89 acres	0.0057%
(b.2) Linda F. Grasso 4016 Silk Oak Lane Palm Harbor, FL 34685	0.2694 acres 1/33 of 8.89 acres	0.0057%
(b.3) Larry Walter Short	<i>pre-deceased</i>	
(b.3.1) Larry Short, Jr. 436 Waverly Street Kingsford, MI 49802	0.1347 acres 1/66 of 8.89 acres	0.0029%

**Revised Exhibit B**  
**VS18**  
**Docket #VGOB 23-1121-4277-01**  
**List of all Owners/Claimants**  
**(4,721.14 Acre Unit)**

	Acres in Unit	Interest in Unit
(b.3.2) Tamara Beth Ham 108 Chesterfield Drive Pinehurst, NC 28374	0.1347 acres 1/66 of 8.89 acres	0.0029%
(c) Harold B. Shortt Heirs, Devisees, Successors, or Assigns		
(c.1) Charlene Shortt PO Box 1818 Cedar Bluff, VA 24609	0.8082 acres 1/11 of 8.89 acres	0.0171%
(d) Glenward Jason Shortt 128 And Street Pounding Mill, VA 24637	0.8082 acres 1/11 of 8.89 acres	0.0171%
(e) Ballard Charlie Shortt Heirs, Devisees, Successors, or Assigns		
(h.1) Earlean Shortt Heirs, Devisees, Successors, or Assigns <i>(Documentation Pending)</i>	0.8082 acres 1/11 of 8.89 acres	0.0171%
(h.1.1) Becky Harris 105 Windlass Court Moneta, VA 24121		
(f) Dorothy Short Keene 279 Townview Drive Lebanon, VA 24266	0.8082 acres 1/11 of 8.89 acres	0.0171%
(g) Maudie Short Bronson Heirs, Devisees, Successors, or Assigns		
(g.1) Kenneth Wingo 1509 East Blow Road Signal Mountain, TN 37377	0.8082 acres 1/11 of 8.89 acres	0.0171%
(h) Effie Shortt Heirs, Devisees, Successors, or Assigns		
(h.1) Garnie Jean Thomas PO Box 745 Doran, VA 24612	0.8082 acres 1/11 of 8.89 acres	0.0171%
(j) Garnie Jean Thomson <i>Conveyed 11/26/1997 to Harold Short and Glenward Short as JTWR0S, DB 472/104</i>		
(i.1) Harold B. Shortt <i>(DOD 1/6/2017)</i>		
(i.2) Glenward Jason Short 128 And Street Pounding Mill, VA 24637	0.8082 acres 1/11 of 8.89 acres	0.0171%
(j) Otis Herbert Shortt Heirs, Devisees, Successors, or Assigns <i>(Documentation Pending)</i>	0.8082 acres 1/11 of 8.89 acres	0.0171%
(k) Raymond B. Short Heirs, Devisees, Successors, or Assigns		
(k.1) Delcie Norene Short Heirs, Devisees, Successors, or Assigns		
(k.1.1) Grover Cleveland Elswick 5220 Looking Glass Trail Denver, NC 28037	0.4041 acres 1/22 of 8.89 acres	0.0086%

**Revised Exhibit B**  
**VS18**  
**Docket #VGOB 23-1121-4277-01**  
**List of all Owners/Claimants**  
**(4,721.14 Acre Unit)**

	Acres in Unit	Interest in Unit
(k.1.2) Heather Norene Thornburg 1515 Town N Country Drive Wilkesboro, NC 28697	0.4041 acres 1/22 of 8.89 acres	0.0086%
<b><u>Tract #37C - 1.01 Acres</u></b>		
(1) Commonwealth of Virginia Department of Transportation 2111 Bonham Road Bristol, VA 24201	1.01 acres	0.0214%
<b><u>Tract #37D - 0.20 Acres</u></b>		
(1) Walter Shortt, et al	0.20 acres	0.0042%
(a) Tommy Arnold Shortt PO Box 1228 Richlands, VA 24641	0.0182 acres 1/11 of 0.20 acres	0.0004%
(b) Walter Mervin Shortt Heirs, Devisees, Successors, or Assigns		
(b.1) Mervin Shortt 815 W Thornwood Drive South Elgin, IL 60177	0.0061 acres 1/33 of 0.20 acres	0.0001%
(b.2) Linda F. Grasso 4016 Silk Oak Lane Palm Harbor, FL 34685	0.0061 acres 1/33 of 0.20 acres	0.0001%
(b.3) Larry Walter Short	<i>pre-deceased</i>	
(b.3.1) Larry Short, Jr. 436 Waverly Street Kingsford, MI 49802	0.0030 acres 1/66 of 0.20 acres	0.0001%
(b.3.2) Tamara Beth Ham 108 Chesterfield Drive Pinehurst, NC 28374	0.0030 acres 1/66 of 0.20 acres	0.0001%
(c) Harold B. Shortt Heirs, Devisees, Successors, or Assigns		
(c.1) Charlene Shortt PO Box 1818 Cedar Bluff, VA 24609	0.0182 acres 1/11 of 0.20 acres	0.0004%
(d) Glenward Jason Shortt 128 And Street Pounding Mill, VA 24637	0.0182 acres 1/11 of 0.20 acres	0.0004%
(e) Ballard Charlie Shortt Heirs, Devisees, Successors, or Assigns		
(h.1) Earlean Shortt Heirs, Devisees, Successors, or Assigns <i>(Documentation Pending)</i>	0.0182 acres 1/11 of 0.20 acres	0.0004%
(h.1.1) Becky Harris 105 Windlass Court Moneta, VA 24121		
(f) Dorothy Short Keene 279 Townview Drive Lebanon, VA 24266	0.0182 acres 1/11 of 0.20 acres	0.0004%

**Revised Exhibit B**  
**VS18**  
**Docket #VGOB 23-1121-4277-01**  
**List of all Owners/Claimants**  
**(4,721.14 Acre Unit)**

	Acres in Unit	Interest in Unit
(g) Maudie Short Bronson Heirs, Devisees, Successors, or Assigns		
(g.1) Kenneth Wingo 1509 East Blow Road Signal Mountain, TN 37377	0.0182 acres 1/11 of 0.20 acres	0.0004%
(h) Effie Shortt Heirs, Devisees, Successors, or Assigns		
(h.1) Garnie Jean Thomas PO Box 745 Doran, VA 24612	0.0182 acres 1/11 of 0.20 acres	0.0004%
(i) Garnie Jean Thomson <i>Conveyed 11/26/1997 to Harold Short and Glenward Short as JTWROS, DB 472/104</i>		
(i.1) Harold B. Shortt <i>(DOD 1/6/2017)</i>		
(i.2) Glenward Jason Short 128 And Street Pounding Mill, VA 24637	0.0182 acres 1/11 of 0.20 acres	0.0004%
(j) Otis Herbert Shortt Heirs, Devisees, Successors, or Assigns <i>(Documentation Pending)</i>	0.0182 acres 1/11 of 0.20 acres	0.0004%
(k) Raymond B. Short Heirs, Devisees, Successors, or Assigns		
(k.1) Delcie Norene Short Heirs, Devisees, Successors, or Assigns		
(k.1.1) Grover Cleveland Elswick 5220 Looking Glass Trail Denver, NC 28037	0.0091 acres 1/22 of 0.20 acres	0.0002%
(k.1.2) Heather Norene Thornburg 1515 Town N Country Drive Wilkesboro, NC 28697	0.0091 acres 1/22 of 0.20 acres	0.0002%
<b><u>Tract #37E - 0.04 Acres</u></b>		
(1) Walter Shortt, et al	0.04 acres	0.0008%
(a) Tommy Arnold Shortt PO Box 1228 Richlands, VA 24641	0.0036 acres 1/11 of 0.04 acres	0.0001%
(b) Walter Mervin Shortt Heirs, Devisees, Successors, or Assigns		
(b.1) Mervin Shortt 815 W Thornwood Drive South Elgin, IL 60177	0.0012 acres 1/33 of 0.04 acres	0.0000%
(b.2) Linda F. Grasso 4016 Silk Oak Lane Palm Harbor, FL 34685	0.0012 acres 1/33 of 0.04 acres	0.0000%
(b.3) Larry Walter Short	<i>pre-deceased</i>	
(b.3.1) Larry Short, Jr. 436 Waverly Street Kingsford, MI 49802	0.0006 acres 1/66 of 0.04 acres	0.0000%

**Revised Exhibit B**  
**VS18**  
**Docket #VGOB 23-1121-4277-01**  
**List of all Owners/Claimants**  
**(4,721.14 Acre Unit)**

	Acres in Unit	Interest in Unit
(b.3.2) Tamara Beth Ham 108 Chesterfield Drive Pinehurst, NC 28374	0.0006 acres 1/66 of 0.04 acres	0.0000%
(c) Harold B. Shortt Heirs, Devisees, Successors, or Assigns		
(c.1) Charlene Shortt PO Box 1818 Cedar Bluff, VA 24609	0.0036 acres 1/11 of 0.04 acres	0.0001%
(d) Glenward Jason Shortt 128 And Street Pounding Mill, VA 24637	0.0036 acres 1/11 of 0.04 acres	0.0001%
(e) Ballard Charlie Shortt Heirs, Devisees, Successors, or Assigns		
(h.1) Earlean Shortt Heirs, Devisees, Successors, or Assigns <i>(Documentation Pending)</i>	0.0036 acres 1/11 of 0.04 acres	0.0001%
(h.1.1) Becky Harris 105 Windlass Court Moneta, VA 24121		
(f) Dorothy Short Keene 279 Townview Drive Lebanon, VA 24266	0.0036 acres 1/11 of 0.04 acres	0.0001%
(g) Maudie Short Bronson Heirs, Devisees, Successors, or Assigns		
(g.1) Kenneth Wingo 1509 East Blow Road Signal Mountain, TN 37377	0.0036 acres 1/11 of 0.04 acres	0.0001%
(h) Effie Shortt Heirs, Devisees, Successors, or Assigns		
(h.1) Garnie Jean Thomas PO Box 745 Doran, VA 24612	0.0036 acres 1/11 of 0.04 acres	0.0001%
(i) Garnie Jean Thomson <i>Conveyed 11/26/1997 to Harold Short and Glenward Short as JTWROS, DB 472/104</i>		
(i.1) Harold B. Shortt <i>(DOD 1/6/2017)</i>		
(i.2) Glenward Jason Short 128 And Street Pounding Mill, VA 24637	0.0036 acres 1/11 of 0.04 acres	0.0001%
(j) Otis Herbert Shortt Heirs, Devisees, Successors, or Assigns <i>(Documentation Pending)</i>	0.0036 acres 1/11 of 0.04 acres	0.0001%
(k) Raymond B. Short Heirs, Devisees, Successors, or Assigns		
(k.1) Delcie Norene Short Heirs, Devisees, Successors, or Assigns		
(k.1.1) Grover Cleveland Elswick 5220 Looking Glass Trail Denver, NC 28037	0.0018 acres 1/22 of 0.04 acres	0.0000%

**Revised Exhibit B**  
**VS18**  
**Docket #VGOB 23-1121-4277-01**  
**List of all Owners/Claimants**  
**(4,721.14 Acre Unit)**

	Acres in Unit	Interest in Unit
(k.1.2) Heather Norene Thornburg 1515 Town N Country Drive Wilkesboro, NC 28697	0.0018 acres 1/22 of 0.04 acres	0.0000%
<b><u>Tract #38 - 2.04 Acres</u></b>		
(1) Commonwealth Coal Corporation PO Box 1269 Bristol, VA 24203	2.04 acres	0.0432%
<b><u>Tract #39 - 2.65 Acres</u></b>		
(1) Commonwealth Coal Corporation PO Box 1269 Bristol, VA 24203	2.65 acres	0.0561%
<b><u>Tract #40A - 212.51 Acres</u></b>		
(1) Commonwealth Coal Corporation PO Box 1269 Bristol, VA 24203	212.51 acres	4.5012%
<b><u>Tract #40B - 0.49 Acres</u></b>		
(1) Commonwealth Coal Corporation PO Box 1269 Bristol, VA 24203	0.49 acres	0.0104%
<b><u>Tract #41A - 43.66 Acres</u></b>		
(1) Gary Addison, et al		
(a) Doris Addison 1305 Terrace Court Sykesville, MD 21784	43.66 acres	0.9248%
	<i>Life Estate</i>	
<i>By Instrument #230000095 Gary Curtis Addison, Warren Drew Addison, Lucinda Margaret Wasserman, and Anna Marie Hooper (Assignors) assign all right to royalties due to Assignors to Doris Betty Addison as Assignee for and during her natural life</i>		
<i>By Instrument #230000096 Doris Betty Addison, Gary Curtis Addison, Warren Drew Addison, Lucinda Margaret Wasserman, and Anna Marie Hooper (Grantors) and Doris Betty Addison (hereinafter called Life Tenant) and Gary Curtis Addison, Warren Drew Addison, Lucinda Margaret Wasserman, and Anna Marie Hooper (hereinafter called Remainderman) executed a Deed of Correction for the purpose of clarifying the intent of the parties to Instrument 090001401 was to grant and convey unto the Life Tenant all minerals together with all rents and royalties generated by the same, and further grant and convey unto the Remainderman as joint tenants with rights of survivorship a remainder interest in the properties together with the right with the Life Tenant to receive equal portions of any monies paid as reimbursement for damages to said property.</i>		
(b) Gary Addison 1305 Terrace Court Sykesville, MD 21784		
(c) Warren Addison 1305 Terrace Court Sykesville, MD 21784		
(d) Anna Marie Hooper 2219 Sykesville Rd #2 Westminster, MD 21157		
(e) Lucinda Wasserman 3801 Rinehart Road Westminster, MD 21158		
<b><u>Tract #41B - 23.97 Acres</u></b>		
(1) Curtis Elster Wade Heirs	23.97 acres	0.5077%
(a) Laura B. Wade Heirs, Devisees, Successors, or Assigns		

**Revised Exhibit B**  
**VS18**  
**Docket #VGOB 23-1121-4277-01**  
**List of all Owners/Claimants**  
**(4,721.14 Acre Unit)**

	Acres in Unit	Interest in Unit
(a.1) Curtis R. Wade 926 High Point Drive Mount Dora, FL 32757	3.4243 acres 1/7 of 23.97 acres	0.0725%
(a.2) Barbara W. Hendrix 127 W Meldody Drive Jesup, GA 31545	3.4243 acres 1/7 of 23.97 acres	0.0725%
(a.3) Susan J. Wade 6745 N Richmond Street Chicago, IL 60645	3.4243 acres 1/7 of 23.97 acres	0.0725%
(a.4) Lydia R. Freund 734 Norton Avenue Mundelein, IL 60060	3.4243 acres 1/7 of 23.97 acres	0.0725%
(a.5) Thelma Josie Wade 16330 Old Timber Road Abingdon, VA 24210	3.4243 acres 1/7 of 23.97 acres	0.0725%
(a.6) Julia W. Beckham 12500 Virtudes Street Coral Gables, FL 33156	3.4243 acres 1/7 of 23.97 acres	0.0725%
(a.7) Nathan Wade 113 Hillrose Avenue Greenville, SC 29609	3.4243 acres 1/7 of 23.97 acres	0.0725%
<b><u>Tract #41C - 10.72 Acres</u></b>		
(1) Gerald K. Shortt 1475 Shortts Road Raven, VA 24639	10.72 acres	0.2271%
<b><u>Tract #41D - 3.41 Acres</u></b>		
(1) Rondal & Freda Wade, TE 1053 Short Hill Road Raven, VA 24639	3.41 acres	0.0722%
<b><u>Tract #41E - 1.72 Acres</u></b>		
(1) Jimmy & Linda Wade, TE 1333 Short Hill Road Raven, VA 24639	1.72 acres	0.0364%
<b><u>Tract #41F - 1.66 Acres</u></b>		
(1) Evelyn Sprinkle Brown Heirs, Devises, Successors, or Assigns	1.66 acres	0.0352%
(a) Dianne Creed 18593 Ironwood Loop Abingdon, VA 24210	0.5533 acres 1/3 of 1.66 acres	0.0117%
(b) William Richard Brown 1907 Riverside Drive Raven, VA 24639	0.5533 acres 1/3 of 1.66 acres	0.0117%
(c) Dorothy Wallace 410 First Street Spencer, NC 28159	0.5533 acres 1/3 of 1.66 acres	0.0117%

**Revised Exhibit B**  
**VS18**  
**Docket #VGOB 23-1121-4277-01**  
**List of all Owners/Claimants**  
**(4,721.14 Acre Unit)**

	Acres in Unit	Interest in Unit
<b><u>Tract #41G - 0.25 Acres</u></b>		
(1) Commonwealth of Virginia Department of Transportation 2111 Bonham Road Bristol, VA 24201	0.25 acres	0.0053%
<b><u>Tract #41H - 1.45 Acres</u></b>		
(1) Elmer & Elsie Burke, TE 1759 Riverside Dr Raven, VA 24639	1.45 acres	0.0307%
<b><u>Tract #42 - 301.84 Acres</u></b>		
(1) Commonwealth Coal Corporation PO Box 1269 Bristol, VA 24203	301.84 acres	6.3934%
<b><u>Tract #43 - 125.72 Acres</u></b>		
(1) Coal Mountain Mining Company LLP P.O. Box 675 Tazewell, VA 24651	125.72 acres	2.6629%
<b><u>Tract #44 - 882.64 Acres</u></b>		
(1) Commonwealth Coal Corporation PO Box 1269 Bristol, VA 24203	882.64 acres	18.6955%
<b><u>Tract #45 - 623.54 Acres</u></b>		
(1) Coal Mountain Mining Company LLP P.O. Box 675 Tazewell, VA 24651	623.54 acres	13.2074%

Exhibit B2  
 VS18 - Revised Unit  
 Docket #VGOB 23-1121-4277-01  
 List of Respondents/Tracts to be Dismissed  
 (4,721.14 Acre Unit - Revised Acres)

	Acres in Unit	(Based on Original Acres) Interest in Unit	Reason for Dismissal
<b>II. OIL &amp; GAS OWNERSHIP</b>			
<u><b>Tract #2 - 15.14 Acres</b></u>			
(1) Gary Davis, et al	15.14 acres	0.3016%	<b>Transferred to Buch No. 1 South 1 Panel SGU</b>
(a) Gary Davis 1189 Point Road Raven, VA 24639	6.056 acres 2/5 of 15.14 acres	0.1206%	
(b) Larry Wayne Davis PO Box 183 Pounding Mill, VA 24637	3.028 acres 1/5 of 15.14 acres	0.0603%	
(c) Buford R. Davis	<i>Conveyed January 9, 2020, Instrument# 20-0023</i>		
(c.1) Ricky Davis 532 Indian Hills Drive Cedar Bluff, VA 24609	3.028 acres 1/5 of 15.14 acres	0.0603%	
(d) Ruth M. Boyd Heirs, Devisees, Successors, or Assigns <i>(Documentation Pending)</i>	3.028 acres 1/5 of 13.18 acres	0.0603%	
(d.1) Gwenda Ligett 402 North Marshall Road Middletown, OH 45042			
(d.2) Wanda Zahn 138 Sweet Briar Drive Batavia, OH 45103			
(d.3) Candace Sue McCroy 3236 N Talbot Ave, Apt 3 Erlanger, KY 41018			
<u><b>Tract #3 - 1.67 Acres</b></u>			
(1) Gary Davis, et al	1.67 acres	0.0333%	<b>Transferred to Buch No. 1 South 1 Panel SGU</b>
(a) Gary C. Davis 1189 Point Road Raven, VA 24639	0.223 acres 2/15 of 1.67 acres	0.0044%	
(b) Patsy Davis Heirs, Devisees, Successors, or Assigns			
(b.1) Gary C. Davis 1189 Point Road Raven, VA 24639	0.223 acres 2/15 of 1.67 acres	0.0044%	
(c) Larry Wayne Davis PO Box 183 Pounding Mill, VA 24637	0.223 acres 2/15 of 1.67 acres	0.0044%	
(d) Buford R. Davis	<i>Conveyed January 9, 2020, Instrument# 20-0023</i>		
(d.1) Ricky Davis 532 Indian Hills Drive Cedar Bluff, VA 24609	0.223 acres 2/15 of 1.67 acres	0.0044%	
(e) Jacqueline Davis PO Box 183 Pounding Mill, VA 24637	0.223 acres 2/15 of 1.67 acres	0.0044%	

**Exhibit B2**  
**VS18 - Revised Unit**  
**Docket #VGOB 23-1121-4277-01**  
**List of Respondents/Tracts to be Dismissed**  
**(4,721.14 Acre Unit - Revised Acres)**

	(Based on Original Acres)	
	Acres in Unit	Interest in Unit
		Reason for Dismissal
(f) Doris Davis 827 Green Acres Street Pounding Mill, VA 24637	0.223 acres 2/15 of 1.67 acres	0.0044%
(g) Ruth M. Boyd Heirs, Devisees, Successors, or Assigns <i>(Documentation Pending)</i>	0.334 acres 1/5 of 1.67 acres	0.0067%
(g.1) Gwenda Ligett 402 North Marshall Road Middletown, OH 45042		
(g.2) Wanda Zahn 138 Sweet Briar Drive Batavia, OH 45103		
(g.3) Candace Sue McCroy 3236 N Talbot Ave, Apt 3 Erlanger, KY 41018		

**Tract #6 - 0.88 Acres**

*Note: CBM ownership was adjudicated to the prevailing plaintiffs under Case no. CL 11-0497-00  
The Corrected Final Order was executed September 29, 2011 and plaintiffs were awarded 100% of the  
Coalbed Methane Gas underlying this tract.*

<b>(1)</b> Loya Edgar Davis Compton Heirs, Devisees, Successors or Assigns <i>(6 Acre Tract)</i>	0.88 acres	0.0175%	<b>Transferred to Buch No. 1 South 1 Panel SGU</b>
(a) Allie I. Davis Clowers 150 County Road 161 Riceville, TN 37370	0.11 acres 1/8 of 0.88 acres	0.0022%	
(b) Buford Davis Heirs, Devisees, Successors, or Assigns			
(b.1) Doris Davis 827 Green Acres Street Pounding Mill, VA 24637	0.11 acres 1/8 of 0.88 acres	0.0022%	
(c) Billy D. Davis Heirs, Devisees, Successors or Assigns			
(c.1) Billy Michael Davis 1839 W. Market Street Smithfield, NC 27577	0.06 acres 1/16 of 0.88 acres	0.0011%	
(c.2) Lisa Diane Davis 1839 W. Market Street Smithfield, NC 27577	0.06 acres 1/16 of 0.88 acres	0.0011%	
(d) Joe Darrell Davis 1752 Sandy Gap Rd. Raven, VA 24639	0.11 acres 1/8 of 0.88 acres	0.0022%	
(e) Bobby Davis 101 Able Road Cedar Bluff, VA 24609	0.11 acres 1/8 of 0.88 acres	0.0022%	
(f) Gary Davis 1189 Point Road Raven, VA 24639	0.11 acres 1/8 of 0.88 acres	0.0022%	

Exhibit B2  
 VS18 - Revised Unit  
 Docket #VGOB 23-1121-4277-01  
 List of Respondents/Tracts to be Dismissed  
 (4,721.14 Acre Unit - Revised Acres)

	(Based on Original Acres)	
	Acres in Unit	Interest in Unit
		Reason for Dismissal
(g) Larry Wayne Davis PO Box 183 Pounding Mill, VA 24637	0.11 acres 1/8 of 0.88 acres	0.0022%
(h) Jimmy A. Davis Heirs, Devisees, Successors or Assigns		
(h.1) Dorothy Davis, Sandy Barnette, Mark Davis, and Jimmy Davis, Jr. <i>Conveyed to (h.2) as tenants in entirety with right of survivorship, Instrument# 100001037 dated 4/20/2010</i>		
(h.2) Larry Wayne & Jackie Davis, TE PO Box 183 Pounding Mill, VA 24637	0.11 acres 1/8 of 0.88 acres	0.0022%
<b><u>Tract #9 - 4.10 Acres</u></b>		
(1) Coal Mountain Mining Company LLP P.O. Box 675 Tazewell, VA 24651	4.10 acres	0.0817%
		<b>Transferred to Buch No. 1 South 1 Panel SGU</b>
<b><u>Tract #23 - 7.12 Acres</u></b>		
(1) Pocahontas Gas LLC, et al <i>(47.90 Acre Tract)</i>	7.12 acres	0.1418%
(b) Ruie McGlothlin Heirs, Devisees, Successors, or Assigns		
(b.3) Ruby Lee Zwald Heirs, Devisees, Successors, or Assigns		
(b.3.1) Walter Lawrence Finney Heirs, Devisees, Successors, or Assigns		
(b.3.1.1) Shelby Ann Finney		<b>Deeded Interest</b>
<b><u>Tract #33A - 26.89 Acres</u></b>		
(1) Pocahontas Gas LLC, et al <i>(37.00 Acre Tract)</i>	26.89 acres	0.5357%
(b.3) Ruby Lee Zwald Heirs, Devisees, Successors, or Assigns		
(b.3.1) Walter Lawrence Finney Heirs, Devisees, Successors, or Assigns		
(b.3.1.1) Shelby Ann Finney		<b>Deeded Interest</b>

Exhibit B3  
 VS18  
 Docket #VGOB 23-1121-4277-01  
 List of all unleased Owners/Claimants  
 (4,721.14 Acre Unit)

	Acres in Unit	Interest in Unit
<b>II. OIL &amp; GAS OWNERSHIP</b>		
<b><u>Tract #2 - Transferred to Buch No 1 South 1 Panel SGU</u></b>		
<b><u>Tract #3 - Transferred to Buch No 1 South 1 Panel SGU</u></b>		
<b><u>Tract #6 - Transferred to Buch No 1 South 1 Panel SGU</u></b>		
<b><u>Tract #7 - 17.47 Acres</u></b>		
<i>Note. CBM ownership was adjudicated to the prevailing plaintiffs under Case no. CL 11-0497-00    The Corrected Final Order was executed September 29, 2011 and plaintiffs were awarded 100% of the Coalbed Methane Gas underlying this tract.</i>		
(1) Loya Edgar Davis Compton Heirs, Deviseses, Successors or Assigns (71.75 acre tract)	17.47 acres	0.3700%
(a) Allie Davis Clowers 150 County Road 161 Riceville, TN 37370	2.18 acres 1/8 of 17.47 acres	0.0463%
(b) Buford Davis Heirs, Deviseses, Successors, or Assigns		
(b.1) Doris Davis 827 Green Acres Street Pounding Mill, VA 24637	2.18 acres 1/8 of 17.47 acres	0.0463%
(c) Billy D. Davis Heirs, Deviseses, Successors or Assigns		
(c.1) Billy Michael Davis 1839 W. Market Street Smithfield, NC 27577	1.09 acres 1/16 of 17.47 acres	0.0231%
(c.2) Lisa Diane Davis 1839 W Market Street Smithfield, NC 27577	1.09 acres 1/16 of 17.47 acres	0.0231%
(d) Joe Darrell Davis 1752 Sandy Gap Rd. Raven, VA 24639	2.18 acres 1/8 of 17.47 acres	0.0463%
(e) Bobby Davis 101 Able Road Cedar Bluff, VA 24609	2.18 acres 1/8 of 17.47 acres	0.0463%
(f) Gary Davis 1189 Point Road Raven, VA 24639	2.18 acres 1/8 of 17.47 acres	0.0463%
(g) Larry Wayne Davis PO Box 183 Pounding Mill, VA 24637	2.18 acres 1/8 of 17.47 acres	0.0463%
(h) Jimmy A. Davis Heirs, Deviseses, Successors or Assigns		
(h.1) Dorothy Davis, Sandy Barnette, Mark Davis, and Jimmy Davis, Jr. <i>Conveyed to (h.2) as tenants in entirety with right of survivorship, Instrument# 100001037 dated 4/20/2010</i>		

**Exhibit B3**  
**VS18**  
**Docket #VGOB 23-1121-4277-01**  
**List of all unleased Owners/Claimants**  
**(4,721.14 Acre Unit)**

	Acres in Unit	Interest in Unit
(h.2) Larry Wayne and Jacqueline Davis, TE PO Box 183 Pounding Mill, VA 24637	2.18 acres 1/8 of 17.47 acres	0.0463%
Total Tract Acres 17.47 Total Tract Percentage 0.3700%		
<b><u>Tract #15 - 3.01 Acres</u></b>		
(1) Commonwealth of Virginia Department of Highways 2111 Bonham Road Bristol, VA 24201	3.01 acres	0.0638%
<b><u>Tract #20 - 2.07 Acres</u></b>		
(1) Thomas P. Stilwell 1898 Old Kentucky Turnpike Road Raven, VA 24639	2.07 acres	0.0438%
<b><u>Tract #23 - 7.12 Acres</u></b>		
(1) Pocahontas Gas LLC, et al <i>(47.90 Acre Tract)</i>	7.12 acres	0.1508%
(b) Ruie McGlothlin Heirs, Devisees, Successors, or Assigns		
(b.1) Junior C. McGlothlin Heirs, Devisees, Successors, or Assigns		
(b.1.1) Janet E. McGlothlin Heirs, Devisees, Successors, or Assigns		
(b.1.1.1) Johnny Dwight McGlothlin 820 Baptist Valley Road Cedar Bluff, VA 24609	0.01 acres 1/672 of 7.12 acres	0.0002%
(b.2) Helen Adams Heirs, Devisees, Successors, or Assigns <i>(Documentation Pending)</i>	0.03 acres 1/224 of 7.12 acres	0.0007%
(b.2.1) Bernie Gene Adams 14309 Phoenix Road Phoenix, MD 21131		
(b.2.2) Michael Adams 220 E Lakeview Street Umatilla, FL 32784		
(b.3) Ruby Lee Zwald Heirs, Devisees, Successors, or Assigns		
(b.3.1) Walter Lawrence Finney Heirs, Devisees, Successors, or Assigns		
(b.3.1.1) Shelby Ann Finney <i>Conveyed to Cheryl Keen Tucker and Bernie Gene Adams as tenants in common, RC - Instr# 220001375, BC - Instr# 2200000738, TC - Instr# 220001829, all dated 6/6/2022</i>		
(b.3.1.1.1) Cheryl Keen Tucker 170 Charleston Place Daleville, VA 24083	0.02 acres 1/448 of 7.12 acres	0.0003%
(b.3.1.1.2) Bernie Gene Adams 14309 Phoenix Road Phoenix, MD 21131	0.02 acres 1/448 of 7.12 acres	0.0003%

Exhibit B3  
 VS18  
 Docket #VGOB 23-1121-4277-01  
 List of all unleased Owners/Claimants  
 (4,721.14 Acre Unit)

	Acres in Unit	Interest in Unit
(b.4) Mary R. Barnett Heirs, Deviseses, Successors, or Assigns		
(b.4.1) Cheryl Keen Tucker 170 Charleston Place Daleville, VA 24083	0.03 acres 1/224 of 7.12 acres	0.0007%
Total Tract Acres 0.11 Total Tract Percentage 0.0022%		
<b><u>Tract #29A - 5.59 Acres</u></b>		
(1) Janice L. & Jeremy W. Davis, TE 1011 Betsy Branch Road Raven, VA 24639	5.59 acres	0.1184%
<b><u>Tract #29B - 3.74 Acres</u></b>		
(1) William & Hannalore Engardio, T/E 3187 Riverside Drive Raven, VA 24639	3.74 acres	0.0792%
<b><u>Tract #29D - 1.24 Acres</u></b>		
(1) Danny Wayne Hinkle PO Box 571 Oakwood, VA 24631	1.24 acres	0.0263%
<b><u>Tract #29E - 9.87 Acres</u></b>		
(1) Commonwealth of Virginia Department of Transportation 2111 Bonham Road Bristol, VA 24201	9.87 acres	0.2091%
<b><u>Tract #29F - 3.97 Acres</u></b>		
(1) Russell V. and Anita Presley, TE PO Box 463 Keen Mountain, VA 24624	3.97 acres	0.0841%
<b><u>Tract #29G - 0.08 Acres</u></b>		
(1) Jadco, Inc. 3081 Riverside Drive Raven, VA 24639	0.08 acres	0.0017%
<b><u>Tract #29H - 0.61 Acres</u></b>		
(1) Jadco, Inc. 3081 Riverside Drive Raven, VA 24639	0.61 acres	0.0129%
<b><u>Tract #29I - 0.23 Acres</u></b>		
(1) Jadco, Inc. 3081 Riverside Drive Raven, VA 24639	0.23 acres	0.0049%
<b><u>Tract #29L - 1.16 Acres</u></b>		
(1) Joel D. & Brenda L. Burke PO Box 33 Rowe, VA 24646	1.16 acres	0.0246%

Exhibit B3  
 VS18  
 Docket #VGOB 23-1121-4277-01  
 List of all unleased Owners/Claimants  
 (4,721.14 Acre Unit)

	Acres in Unit	Interest in Unit
<b><u>Tract #29O - 1.98 Acres</u></b>		
(1) Commonwealth of Virginia Department of Transportation 2111 Bonham Road Bristol, VA 24201	1.98 acres	0.0419%
<b><u>Tract #29R - 0.50 Acres</u></b>		
(1) Commonwealth of Virginia Department of Transportation 2111 Bonham Road Bristol, VA 24201	0.50 acres	0.0106%
<b><u>Tract #29S - 0.68 Acres</u></b>		
(1) Commonwealth of Virginia Department of Transportation 2111 Bonham Road Bristol, VA 24201	0.68 acres	0.0144%
<b><u>Tract #29U - 3.39 Acres</u></b>		
(1) Patrick Counts 1665 Riverside Drive Raven, VA 24639	3.39 acres	0.0718%
<b><u>Tract #29W - 0.90 Acres</u></b>		
(1) Grady W. & Pauline J. McGlothlin PO Box 955 Raven, VA 24639	0.90 acres	0.0191%
<b><u>Tract #29X - 1.10 Acres</u></b>		
(1) Commonwealth of Virginia Department of Transportation 2111 Bonham Road Bristol, VA 24201	1.10 acres	0.0233%
<b><u>Tract #29Y - 0.89 Acres</u></b>		
(1) Oris Cantrell Heirs, Devisees, Successors, or Assigns	0.89 acres	0.0189%
(a) Amy Mae Hess PO Box 922 Vansant, VA 24656	0.2225 acres 1/4 of 0.89 acres	0.0047%
(b) Jamie Cantrell 282 Westview Street Pounding Mill, VA 24637	0.2225 acres 1/4 of 0.89 acres	0.0047%
(c) Penny Falck 2390 Glade Drive Christiansburg, VA 24073	0.2225 acres 1/4 of 0.89 acres	0.0047%
(d) Cathleen Arrington 7342 Pine Street Radford, VA 24141	0.2225 acres 1/4 of 0.89 acres	0.0047%
Total Tract Acres 0.89 Total Tract Percentage 0.0189%		

**Exhibit B3**  
**VS18**  
**Docket #VGOB 23-1121-4277-01**  
**List of all unleased Owners/Claimants**  
**(4,721.14 Acre Unit)**

	Acres in Unit	Interest in Unit
<b><u>Tract #33A - 26.89 Acres</u></b>		
(1) Pocahontas Gas LLC, et al <i>(37.00 Acre Tract)</i>	26.89 acres	0.5696%
(b) Ruie McGlothlin Heirs, Devisees, Successors, or Assigns		
(b.1) Junior C. McGlothlin Heirs, Devisees, Successors, or Assigns		
(b.1.1) Janet E. McGlothlin Heirs, Devisees, Successors, or Assigns		
(b.1.1.1) Johnny Dwight McGlothlin 820 Baptist Valley Road Cedar Bluff, VA 24609	0.040 acres 1/672 of 26.89 acres	0.0008%
(b.2) Helen Adams Heirs, Devisees, Successors, or Assigns <i>(Documentation Pending)</i>	0.120 acres 1/224 of 26.89 acres	0.0025%
(b.2.1) Bernie Gene Adams 14309 Phoenix Road Phoenix, MD 21131		
(b.2.2) Michael Adams 220 E Lakeview Street Umatilla, FL 32784		
(b.3) Ruby Lee Zwald Heirs, Devisees, Successors, or Assigns		
(b.3.1) Walter Lawrence Finney Heirs, Devisees, Successors, or Assigns		
(b.3.1.1) Shelby Ann Finney <i>Conveyed to Cheryl Keen Tucker and Bernie Gene Adams as tenants in common, RC - Instr# 220001375, BC - Instr# 2200000738, TC - Instr# 220001829, all dated 6/6/2022</i>		
(b.3.1.1.1) Cheryl Keen Tucker 170 Charleston Place Daleville, VA 24083	0.060 acres 1/448 of 26.89 acres	0.0013%
(b.3.1.1.2) Bernie Gene Adams 14309 Phoenix Road Phoenix, MD 21131	0.060 acres 1/448 of 26.89 acres	0.0013%
(b.4) Mary R. Barnett Heirs, Devisees, Successors, or Assigns		
(b.4.1) Cheryl Keen Tucker 170 Charleston Place Daleville, VA 24083	0.120 acres 1/224 of 26.89 acres	0.0025%
Total Tract Acres 0.40 Total Tract Percentage 0.0085%		
<b><u>Tract #33B - 2.31 Acres</u></b>		
(1) Commonwealth of Virginia Department of Transportation 2111 Bonham Road Bristol, VA 24201	2.31 acres	0.0489%

**Exhibit B3**  
**VS18**  
**Docket #VGOB 23-1121-4277-01**  
**List of all unleased Owners/Claimants**  
**(4,721.14 Acre Unit)**

	Acres in Unit	Interest in Unit
<b><u>Tract #33C - 1.62 Acres</u></b>		
(1) Jimmy Lee McGlothlin PO Box 987 Raven, VA 24639	1.62 acres	0.0343%
<b><u>Tract #36A - 19.31 Acres</u></b>		
(1) Bernard Shortt, et al	19.31 acres	0.4090%
(a) Roy Bernard and Linda Ruth Shortt 642 Shortts Road Raven, VA 24639	<i>Life Estate</i>	
(b) Joshua Andrew Shortt* ( <i>DOD 8/25/2021</i> )		
(c) Barney Andrew Shortt* 728 Shortts Road Raven, VA 24639	9.655 acres 1/2 of 19.31 acres	0.2045%
(d) Janet Shortt* 728 Shortts Road Raven, VA 24639	9.655 acres 1/2 of 19.31 acres	0.2045%
<i>*Joshua Andrew Shortt, Barney Andrew Shortt, and Janet Shortt were conveyed ownership as joint tenants with right of survivorship</i>		
Total Tract Acres 19.31 Total Tract Percentage 0.4090%		
<b><u>Tract #36B - 0.19 Acres</u></b>		
(1) Barney Shortt, et al		
(a) Roy Bernard and Linda Ruth Shortt 642 Shortts Road Raven, VA 24639	<i>Life Estate</i>	
(b) Barney Andrew and Janet Shortt** 728 Shortts Road Raven, VA 24639	0.19 acres	0.0040%
<i>**Tenants in entirety with right of survivorship</i>		
<b><u>Tract #36C - 0.42 Acres</u></b>		
<i>***Cloud on Title - When Tom Short acquired title to the parent tract of which this property is a portion, he also obtained title to the gas and oil. He then conveyed the property to his wife (Bertha) and reserved all minerals in DB 190/119. Bertha later conveyed back to Tom in DB 217/438, with the same reservation language, though she owned no mineral to reserve. Tom again conveyed to Bertha in DB 281/12, reserving all mineral. Bertha again conveyed to Tom in DB 331/248, and again reserved mineral she did not own. Tom Short and Bertha Short conveyed to Walter M. Short and Jeanette H. Short, in DB 342/400, a 3.2 acre parcel, referencing as the source of title DB 331/248 wherein Bertha reserved mineral she did not own, as the mineral reservation language. The intent of Bertha and Tom Short may have been to reserve all mineral, however, the source reservation language reference within DB 342/400 fails. Correction deeds are necessary to vest title to the oil and gas in either the heirs of Tom Short, or the current surface owners, Robert and Jackie Rose.</i>		
(1) Walter Shortt, et al	0.42 acres	0.0089%
(a) Tommy Arnold Shortt PO Box 1228 Richlands, VA 24641	0.0382 acres 1/11 of 0.42 acres	0.0008%
(b) Walter Mervin Shortt Heirs, Devisees, Successors, or Assigns		
(b.1) Mervin Shortt 815 W Thornwood Drive South Elgin, IL 60177	0.0127 acres 1/33 of 0.42 acres	0.0003%

**Exhibit B3**  
**VS18**  
**Docket #VGOB 23-1121-4277-01**  
**List of all unleased Owners/Claimants**  
**(4,721.14 Acre Unit)**

	Acres in Unit	Interest in Unit
(b.2) Linda F. Grasso 4016 Silk Oak Lane Palm Harbor, FL 34685	0.0127 acres 1/33 of 0.42 acres	0.0003%
(b.3) Larry Walter Short	<i>pre-deceased</i>	
(b.3.1) Larry Short, Jr. 436 Waverly Street Kingsford, MI 49802	0.0064 acres 1/66 of 0.42 acres	0.0001%
(b.3.2) Tamara Beth Ham 108 Chesterfield Drive Pinehurst, NC 28374	0.0064 acres 1/66 of 0.42 acres	0.0001%
(c) Harold B. Shortt Heirs, Devisees, Successors, or Assigns		
(c.1) Charlene Shortt PO Box 1818 Cedar Bluff, VA 24609	0.0382 acres 1/11 of 0.42 acres	0.0008%
(d) Glenward Jason Shortt 128 And Street Pounding Mill, VA 24637	0.0382 acres 1/11 of 0.42 acres	0.0008%
(e) Ballard Charlie Shortt Heirs, Devisees, Successors, or Assigns		
(h.1) Earlean Shortt Heirs, Devisees, Successors, or Assigns <i>(Documentation Pending)</i>	0.0382 acres 1/11 of 0.42 acres	0.0008%
(h.1.1) Becky Harris 105 Windlass Court Moneta, VA 24121		
(f) Dorothy Short Keene 279 Townview Drive Lebanon, VA 24266	0.0382 acres 1/11 of 0.42 acres	0.0008%
(g) Maudie Short Bronson Heirs, Devisees, Successors, or Assigns		
(g.1) Kenneth Wingo 1509 East Blow Road Signal Mountain, TN 37377	0.0382 acres 1/11 of 0.42 acres	0.0008%
(h) Effie Shortt Heirs, Devisees, Successors, or Assigns		
(h.1) Garnie Jean Thomas PO Box 745 Doran, VA 24612	0.0382 acres 1/11 of 0.42 acres	0.0008%
(i) Garnie Jean Thomson	<i>Conveyed 11/26/1997 to Harold Shortt and Glenward Shortt as JTWRROS, DB 472/104</i>	
(i.1) Harold B. Shortt	<i>(DOD 1/6/2017)</i>	
(i.2) Glenward Jason Shortt 128 And Street Pounding Mill, VA 24637	0.0382 acres 1/11 of 0.42 acres	0.0008%
(j) Otis Herbert Shortt Heirs, Devisees, Successors, or Assigns <i>(Documentation Pending)</i>	0.0382 acres 1/11 of 0.42 acres	0.0008%

**Exhibit B3**  
**VS18**  
**Docket #VGOB 23-1121-4277-01**  
**List of all unleased Owners/Claimants**  
**(4,721.14 Acre Unit)**

	Acres in Unit	Interest in Unit
(k) Raymond B. Short Heirs, Devisees, Successors, or Assigns		
(k.1) Delcie Norene Short Heirs, Devisees, Successors, or Assigns		
(k.1.1) Grover Cleveland Elswick 5220 Looking Glass Trail Denver, NC 28037	0.0191 acres 1/22 of 0.42 acres	0.0004%
(k.1.2) Heather Norene Thornburg 1515 Town N Country Drive Wilkesboro, NC 28697	0.0191 acres 1/22 of 0.42 acres	0.0004%
<b>OR</b>		
(1) Robert and Jackie Rose 1008 Shortts Road Raven, VA 24639	0.42 acres	0.0089%
Total Tract Acres                      0.42		
Total Tract Percentage              0.0089%		

**Tract #37A - 0.76 Acres**

*\*\*\*Cloud on Title - When Tom Short acquired title to the parent tract of which this property is a portion, he also obtained title to the gas and oil. He then conveyed the property to his wife (Bertha) and reserved all minerals in DB 190/119. Bertha later conveyed back to Tom in DB 217/438, with the same reservation language, though she owned no mineral to reserve. Tom again conveyed to Bertha in DB 281/12, reserving all mineral. Bertha again conveyed to Tom in DB 331/248, and again reserved mineral she did not own. Tom Short and Bertha Short conveyed to Walter M. Short and Jeanette H. Short, in DB 342/400, a 3.2 acre parcel, referencing as the source of title DB 331/248 wherein Bertha reserved mineral she did not own, as the mineral reservation language. The intent of Bertha and Tom Short may have been to reserve all mineral, however, the source reservation language reference within DB 342/400 fails. Correction deeds are necessary to vest title to the oil and gas in either the heirs of Tom Short, or the current surface owners, Robert and Jackie Rose.*

(1) Walter Shortt, et al	0.76 acres	0.0161%
(a) Tommy Arnold Shortt PO Box 1228 Richlands, VA 24641	0.0691 acres 1/11 of 0.76 acres	0.0015%
(b) Walter Mervin Shortt Heirs, Devisees, Successors, or Assigns		
(b.1) Mervin Shortt 815 W Thornwood Drive South Elgin, IL 60177	0.0230 acres 1/33 of 0.76 acres	0.0005%
(b.2) Linda F. Grasso 4016 Silk Oak Lane Palm Harbor, FL 34685	0.0230 acres 1/33 of 0.76 acres	0.0005%
(b.3) Larry Walter Short	<i>pre-deceased</i>	
(b.3.1) Larry Short, Jr. 436 Waverly Street Kingsford, MI 49802	0.0115 acres 1/66 of 0.76 acres	0.0002%
(b.3.2) Tamara Beth Ham 108 Chesterfield Drive Pinehurst, NC 28374	0.0115 acres 1/66 of 0.76 acres	0.0002%
(c) Harold B. Shortt Heirs, Devisees, Successors, or Assigns		

**Exhibit B3**  
**VS18**  
**Docket #VGOB 23-1121-4277-01**  
**List of all unleased Owners/Claimants**  
**(4,721.14 Acre Unit)**

	Acres in Unit	Interest in Unit
(c.1) Charlene Shortt PO Box 1818 Cedar Bluff, VA 24609	0.0691 acres 1/11 of 0.76 acres	0.0015%
(d) Glenward Jason Shortt 128 And Street Pounding Mill, VA 24637	0.0691 acres 1/11 of 0.76 acres	0.0015%
(e) Ballard Charlie Shortt Heirs, Deivsees, Successors, or Assigns		
(h.1) Earlean Shortt Heirs, Devisees, Successors, or Assigns <i>(Documentation Pending)</i>	0.0691 acres 1/11 of 0.76 acres	0.0015%
(h.1.1) Becky Harris 105 Windlass Court Moneta, VA 24121		
(f) Dorothy Short Keene 279 Townview Drive Lebanon, VA 24266	0.0691 acres 1/11 of 0.76 acres	0.0015%
(g) Maudie Short Bronson Heirs, Devisees, Successors, or Assigns		
(g.1) Kenneth Wingo 1509 East Blow Road Signal Mountain, TN 37377	0.0691 acres 1/11 of 0.76 acres	0.0015%
(h) Effie Shortt Heirs, Devisees, Successors, or Assigns		
(h.1) Garnie Jean Thomas PO Box 745 Doran, VA 24612	0.0691 acres 1/11 of 0.76 acres	0.0015%
(i) Garnie Jean Thomson	<i>Conveyed 11/26/1997 to Harold Short and Glenward Short as JTWROS, DB 472/104</i>	
(i.1) Harold B. Shortt	<i>(DOD 1/6/2017)</i>	
(i.2) Glenward Jason Short 128 And Street Pounding Mill, VA 24637	0.0691 acres 1/11 of 0.76 acres	0.0015%
(j) Otis Herbert Shortt Heirs, Devisees, Successors, or Assigns <i>(Documentation Pending)</i>	0.0691 acres 1/11 of 0.76 acres	0.0015%
(k) Raymond B. Short Heirs, Devisees, Successors, or Assigns		
(k.1) Delcie Norene Short Heirs, Devisees, Successors, or Assigns		
(k.1.1) Grover Cleveland Elswick 5220 Looking Glass Trail Denver, NC 28037	0.0345 acres 1/22 of 0.76 acres	0.0007%
(k.1.2) Heather Norene Thornburg 1515 Town N Country Drive Wilkesboro, NC 28697	0.0345 acres 1/22 of 0.76 acres	0.0007%

**OR**

Exhibit B3  
 VS18  
 Docket #VGOB 23-1121-4277-01  
 List of all unleased Owners/Claimants  
 (4,721.14 Acre Unit)

	Acres in Unit	Interest in Unit
(1) Robert and Jackie Rose 1008 Shortts Road Raven, VA 24639	0.76 acres	0.0161%
Total Tract Acres	0.76	
Total Tract Percentage	0.0161%	
<b><u>Tract #37B - 8.89 Acres</u></b>		
(1) Walter Shortt, et al	8.89 acres	0.1883%
(a) Tommy Arnold Shortt PO Box 1228 Richlands, VA 24641	0.8082 acres 1/11 of 8.89 acres	0.0171%
(b) Walter Mervin Shortt Heirs, Devisees, Successors, or Assigns		
(b.1) Mervin Shortt 815 W Thornwood Drive South Elgin, IL 60177	0.2694 acres 1/33 of 8.89 acres	0.0057%
(b.2) Linda F. Grasso 4016 Silk Oak Lane Palm Harbor, FL 34685	0.2694 acres 1/33 of 8.89 acres	0.0057%
(b.3) Larry Walter Short	<i>pre-deceased</i>	
(b.3.1) Larry Short, Jr. 436 Waverly Street Kingsford, MI 49802	0.1347 acres 1/66 of 8.89 acres	0.0029%
(b.3.2) Tamara Beth Ham 108 Chesterfield Drive Pinehurst, NC 28374	0.1347 acres 1/66 of 8.89 acres	0.0029%
(c) Harold B. Shortt Heirs, Devisees, Successors, or Assigns		
(c.1) Charlene Shortt PO Box 1818 Cedar Bluff, VA 24609	0.8082 acres 1/11 of 8.89 acres	0.0171%
(d) Glenward Jason Shortt 128 And Street Pounding Mill, VA 24637	0.8082 acres 1/11 of 8.89 acres	0.0171%
(e) Ballard Charlie Shortt Heirs, Devisees, Successors, or Assigns		
(h.1) Earlean Shortt Heirs, Devisees, Successors, or Assigns <i>(Documentation Pending)</i>	0.8082 acres 1/11 of 8.89 acres	0.0171%
(h.1.1) Becky Harris 105 Windlass Court Moneta, VA 24121		
(f) Dorothy Short Keene 279 Townview Drive Lebanon, VA 24266	0.8082 acres 1/11 of 8.89 acres	0.0171%
(g) Maudie Short Bronson Heirs, Devisees, Successors, or Assigns		

**Exhibit B3**  
**VS18**  
**Docket #VGOB 23-1121-4277-01**  
**List of all unleased Owners/Claimants**  
**(4,721.14 Acre Unit)**

	Acres in Unit	Interest in Unit
(g.1) Kenneth Wingo 1509 East Blow Road Signal Mountain, TN 37377	0.8082 acres 1/11 of 8.89 acres	0.0171%
(h) Effie Shortt Heirs, Devisees, Successors, or Assigns		
(h.1) Garnie Jean Thomas PO Box 745 Doran, VA 24612	0.8082 acres 1/11 of 8.89 acres	0.0171%
(i) Garnie Jean Thomson	<i>Conveyed 11/26/1997 to Harold Short and Glenward Short as JTWROS, DB 472/104</i>	
(i.1) Harold B. Shortt	<i>(DOD 1/6/2017)</i>	
(i.2) Glenward Jason Short 128 And Street Pounding Mill, VA 24637	0.8082 acres 1/11 of 8.89 acres	0.0171%
(j) Otis Herbert Shortt Heirs, Devisees, Successors, or Assigns <i>(Documentation Pending)</i>	0.8082 acres 1/11 of 8.89 acres	0.0171%
(k) Raymond B. Short Heirs, Devisees, Successors, or Assigns		
(k.1) Delcie Norene Short Heirs, Devisees, Successors, or Assigns		
(k.1.1) Grover Cleveland Elswick 5220 Looking Glass Trail Denver, NC 28037	0.4041 acres 1/22 of 8.89 acres	0.0086%
(k.1.2) Heather Norene Thornburg 1515 Town N Country Drive Wilkesboro, NC 28697	0.4041 acres 1/22 of 8.89 acres	0.0086%
	Total Tract Acres 8.89	
	Total Tract Percentage 0.1883%	
<b><u>Tract #37C - 1.01 Acres</u></b>		
(1) Commonwealth of Virginia Department of Transportation 2111 Bonham Road Bristol, VA 24201	1.01 acres	0.0214%
<b><u>Tract #37D - 0.20 Acres</u></b>		
(1) Walter Shortt, et al	0.20 acres	0.0042%
(a) Tommy Arnold Shortt PO Box 1228 Richlands, VA 24641	0.0182 acres 1/11 of 0.20 acres	0.0004%
(b) Walter Mervin Shortt Heirs, Devisees, Successors, or Assigns		
(b.1) Mervin Shortt 815 W Thornwood Drive South Elgin, IL 60177	0.0061 acres 1/33 of 0.20 acres	0.0001%

**Exhibit B3**  
**VS18**  
**Docket #VGOB 23-1121-4277-01**  
**List of all unleased Owners/Claimants**  
**(4,721.14 Acre Unit)**

	Acres in Unit	Interest in Unit
(b.2) Linda F. Grasso 4016 Silk Oak Lane Palm Harbor, FL 34685	0.0061 acres 1/33 of 0.20 acres	0.0001%
(b.3) Larry Walter Short	<i>pre-deceased</i>	
(b.3.1) Larry Short, Jr. 436 Waverly Street Kingsford, MI 49802	0.0030 acres 1/66 of 0.20 acres	0.0001%
(b.3.2) Tamara Beth Ham 108 Chesterfield Drive Pinehurst, NC 28374	0.0030 acres 1/66 of 0.20 acres	0.0001%
(c) Harold B. Shortt Heirs, Devisees, Successors, or Assigns		
(c.1) Charlene Shortt PO Box 1818 Cedar Bluff, VA 24609	0.0182 acres 1/11 of 0.20 acres	0.0004%
(d) Glenward Jason Shortt 128 And Street Pounding Mill, VA 24637	0.0182 acres 1/11 of 0.20 acres	0.0004%
(e) Ballard Charlie Shortt Heirs, Devisees, Successors, or Assigns		
(h.1) Earlean Shortt Heirs, Devisees, Successors, or Assigns <i>(Documentation Pending)</i>	0.0182 acres 1/11 of 0.20 acres	0.0004%
(h.1.1) Becky Harris 105 Windlass Court Moneta, VA 24121		
(f) Dorothy Short Keene 279 Townview Drive Lebanon, VA 24266	0.0182 acres 1/11 of 0.20 acres	0.0004%
(g) Maudie Short Bronson Heirs, Devisees, Successors, or Assigns		
(g.1) Kenneth Wingo 1509 East Blow Road Signal Mountain, TN 37377	0.0182 acres 1/11 of 0.20 acres	0.0004%
(h) Effie Shortt Heirs, Devisees, Successors, or Assigns		
(h.1) Garnie Jean Thomas PO Box 745 Doran, VA 24612	0.0182 acres 1/11 of 0.20 acres	0.0004%
(i) Garnie Jean Thomson	<i>Conveyed 11/26/1997 to Harold Short and Glenward Short as JTWROS, DB 472/104</i>	
(i.1) Harold B. Shortt	<i>(DOD 1/6/2017)</i>	
(i.2) Glenward Jason Short 128 And Street Pounding Mill, VA 24637	0.0182 acres 1/11 of 0.20 acres	0.0004%
(j) Otis Herbert Shortt Heirs, Devisees, Successors, or Assigns <i>(Documentation Pending)</i>	0.0182 acres 1/11 of 0.20 acres	0.0004%

**Exhibit B3**  
**VS18**  
**Docket #VGOB 23-1121-4277-01**  
**List of all unleased Owners/Claimants**  
**(4,721.14 Acre Unit)**

	Acres in Unit	Interest in Unit
(k) Raymond B. Short Heirs, Devisees, Successors, or Assigns		
(k.1) Delcie Norene Short Heirs, Devisees, Successors, or Assigns		
(k.1.1) Grover Cleveland Elswick 5220 Looking Glass Trail Denver, NC 28037	0.0091 acres 1/22 of 0.20 acres	0.0002%
(k.1.2) Heather Norene Thornburg 1515 Town N Country Drive Wilkesboro, NC 28697	0.0091 acres 1/22 of 0.20 acres	0.0002%
Total Tract Acres	0.20	
Total Tract Percentage	0.0042%	
<b><u>Tract #37E - 0.04 Acres</u></b>		
(1) Walter Shortt, et al	0.04 acres	0.0008%
(a) Tommy Arnold Shortt PO Box 1228 Richlands, VA 24641	0.0036 acres 1/11 of 0.04 acres	0.0001%
(b) Walter Mervin Shortt Heirs, Devisees, Successors, or Assigns		
(b.1) Mervin Shortt 815 W Thornwood Drive South Elgin, IL 60177	0.0012 acres 1/33 of 0.04 acres	0.0000%
(b.2) Linda F. Grasso 4016 Silk Oak Lane Palm Harbor, FL 34685	0.0012 acres 1/33 of 0.04 acres	0.0000%
(b.3) Larry Walter Short	<i>pre-deceased</i>	
(b.3.1) Larry Short, Jr. 436 Waverly Street Kingsford, MI 49802	0.0006 acres 1/66 of 0.04 acres	0.0000%
(b.3.2) Tamara Beth Ham 108 Chesterfield Drive Pinehurst, NC 28374	0.0006 acres 1/66 of 0.04 acres	0.0000%
(c) Harold B. Shortt Heirs, Devisees, Successors, or Assigns		
(c.1) Charlene Shortt PO Box 1818 Cedar Bluff, VA 24609	0.0036 acres 1/11 of 0.04 acres	0.0001%
(d) Glenward Jason Shortt 128 And Street Pounding Mill, VA 24637	0.0036 acres 1/11 of 0.04 acres	0.0001%
(e) Ballard Charlie Shortt Heirs, Devisees, Successors, or Assigns		
(h.1) Earlean Shortt Heirs, Devisees, Successors, or Assigns <i>(Documentation Pending)</i>	0.0036 acres 1/11 of 0.04 acres	0.0001%

**Exhibit B3**  
**VS18**  
**Docket #VGOB 23-1121-4277-01**  
**List of all unleased Owners/Claimants**  
**(4,721.14 Acre Unit)**

	Acres in Unit	Interest in Unit
(h.1.1) Becky Harris 105 Windlass Court Moneta, VA 24121		
(f) Dorothy Short Keene 279 Townview Drive Lebanon, VA 24266	0.0036 acres 1/11 of 0.04 acres	0.0001%
(g) Maudie Short Bronson Heirs, Devisees, Successors, or Assigns		
(g.1) Kenneth Wingo 1509 East Blow Road Signal Mountain, TN 37377	0.0036 acres 1/11 of 0.04 acres	0.0001%
(h) Effie Shortt Heirs, Devisees, Successors, or Assigns		
(h.1) Garnie Jean Thomas PO Box 745 Doran, VA 24612	0.0036 acres 1/11 of 0.04 acres	0.0001%
(i) Garnie Jean Thomson	<i>Conveyed 11/26/1997 to Harold Short and Glenward Short as JTWROS, DB 472/104</i>	
(i.1) Harold B. Shortt	<i>(DOD 1/6/2017)</i>	
(i.2) Glenward Jason Short 128 And Street Pounding Mill, VA 24637	0.0036 acres 1/11 of 0.04 acres	0.0001%
(j) Otis Herbert Shortt Heirs, Devisees, Successors, or Assigns <i>(Documentation Pending)</i>	0.0036 acres 1/11 of 0.04 acres	0.0001%
(k) Raymond B. Short Heirs, Devisees, Successors, or Assigns		
(k.1) Delcie Norene Short Heirs, Devisees, Successors, or Assigns		
(k.1.1) Grover Cleveland Elswick 5220 Looking Glass Trail Denver, NC 28037	0.0018 acres 1/22 of 0.04 acres	0.0000%
(k.1.2) Heather Norene Thornburg 1515 Town N Country Drive Wilkesboro, NC 28697	0.0018 acres 1/22 of 0.04 acres	0.0000%
	Total Tract Acres Total Tract Percentage	0.04 0.0008%
<b><u>Tract #41B - 23.97 Acres</u></b>		
(1) Curtis Elster Wade Heirs	23.97 acres	0.5077%
(a) Laura B. Wade Heirs, Devisees, Successors, or Assigns		
(a.1) Curtis R. Wade 926 High Point Drive Mount Dora, FL 32757	3.4243 acres 1/7 of 23.97 acres	0.0725%
(a.2) Barbara W. Hendrix 127 W Meldody Drive Jesup, GA 31545	3.4243 acres 1/7 of 23.97 acres	0.0725%

**Exhibit B3**  
**VS18**  
**Docket #VGOB 23-1121-4277-01**  
**List of all unleased Owners/Claimants**  
**(4,721.14 Acre Unit)**

	Acres in Unit	Interest in Unit
(a.3) Susan J. Wade 6745 N Richmond Street Chicago, IL 60645	3.4243 acres 1/7 of 23.97 acres	0.0725%
(a.4) Lydia R. Freund 734 Norton Avenue Mundelein, IL 60060	3.4243 acres 1/7 of 23.97 acres	0.0725%
(a.5) Thelma Josie Wade 16330 Old Timber Road Abingdon, VA 24210	3.4243 acres 1/7 of 23.97 acres	0.0725%
(a.6) Julia W. Beckham 12500 Virtudes Street Coral Gables, FL 33156	3.4243 acres 1/7 of 23.97 acres	0.0725%
(a.7) Nathan Wade 113 Hillrose Avenue Greenville, SC 29609	3.4243 acres 1/7 of 23.97 acres	0.0725%
	Total Tract Acres 23.97	
	Total Tract Percentage 0.5077%	
<b><u>Tract #41C - 10.72 Acres</u></b>		
(1) Gerald K. Shortt 1475 Shortts Road Raven, VA 24639	10.72 acres	0.2271%
<b><u>Tract #41D - 3.41 Acres</u></b>		
(1) Rondal & Freda Wade, TE 1053 Short Hill Road Raven, VA 24639	3.41 acres	0.0722%
<b><u>Tract #41E - 1.72 Acres</u></b>		
(1) Jimmy & Linda Wade, TE 1333 Short Hill Road Raven, VA 24639	1.72 acres	0.0364%
<b><u>Tract #41F - 1.66 Acres</u></b>		
(1) Evelyn Sprinkle Brown Heirs, Devises, Successors, or Assigns	1.66 acres	0.0352%
(a) Dianne Creed 18593 Ironwood Loop Abingdon, VA 24210	0.5533 acres 1/3 of 1.66 acres	0.0117%
(b) William Richard Brown 1907 Riverside Drive Raven, VA 24639	0.5533 acres 1/3 of 1.66 acres	0.0117%
(c) Dorothy Wallace 410 First Street Spencer, NC 28159	0.5533 acres 1/3 of 1.66 acres	0.0117%
	Total Tract Acres 1.66	
	Total Tract Percentage 0.0352%	

**Exhibit B3**  
**VS18**  
**Docket #VGOB 23-1121-4277-01**  
**List of all unleased Owners/Claimants**  
**(4,721.14 Acre Unit)**

	Acres in Unit	Interest in Unit
<b><u>Tract #41G - 0.25 Acres</u></b>		
(1) Commonwealth of Virginia Department of Transportation 2111 Bonham Road Bristol, VA 24201	0.25 acres	0.0053%
<b><u>Tract #41H - 1.45 Acres</u></b>		
(1) Elmer & Elsie Burke, TE 1759 Riverside Dr Raven, VA 24639	1.45 acres	0.0307%
<b><u>TOTAL UNLEASED OIL AND GAS ESTATE</u></b>		
	Total Acres	136.92
	Total Percentage	2.9001%

Exhibit E  
VS18  
Docket #VGOB 23-1121-4277-01  
List of Conflicting Owners/Claimants requiring Escrow  
(4,721.14 Acre Unit)

	Acres in Unit	Interest in Unit
<b>II. OIL &amp; GAS OWNERSHIP</b>		
<b><u>Tract #36C - 0.42 Acres</u></b>		
<i>***Cloud on Title - When Tom Short acquired title to the parent tract of which this property is a portion, he also obtained title to the gas and oil. He then conveyed the property to his wife (Bertha) and reserved all minerals in DB 190/119. Bertha later conveyed back to Tom in DB 217/438, with the same reservation language, though she owned no mineral to reserve. Tom again conveyed to Bertha in DB 281/12, reserving all mineral. Bertha again conveyed to Tom in DB 331/248, and again reserved mineral she did not own. Tom Short and Bertha Short conveyed to Walter M. Short and Jeanette H. Short, in DB 342/400, a 3.2 acre parcel, referencing as the source of title DB 331/248 wherein Bertha reserved mineral she did not own, as the mineral reservation language. The intent of Bertha and Tom Short may have been to reserve all mineral, however, the source reservation language reference within DB 342/400 fails. Correction deeds are necessary to vest title to the oil and gas in either the heirs of Tom Short, or the current surface owners, Robert and Jackie Rose.</i>		
(1) Walter Shortt, et al	0.42 acres	0.0089%
(a) Tommy Arnold Shortt PO Box 1228 Richlands, VA 24641	0.0382 acres 1/11 of 0.42 acres	0.0008%
(b) Walter Mervin Shortt Heirs, Deviseses, Successors, or Assigns		
(b.1) Mervin Shortt 815 W Thornwood Drive South Elgin, IL 60177	0.0127 acres 1/33 of 0.42 acres	0.0003%
(b.2) Linda F. Grasso 4016 Silk Oak Lane Palm Harbor, FL 34685	0.0127 acres 1/33 of 0.42 acres	0.0003%
(b.3) Larry Walter Short	<i>pre-deceased</i>	
(b.3.1) Larry Short, Jr. 436 Waverly Street Kingsford, MI 49802	0.0064 acres 1/66 of 0.42 acres	0.0001%
(b.3.2) Tamara Beth Ham 108 Chesterfield Drive Pinehurst, NC 28374	0.0064 acres 1/66 of 0.42 acres	0.0001%
(c) Harold B. Shortt Heirs, Deviseses, Successors, or Assigns		
(c.1) Charlene Shortt PO Box 1818 Cedar Bluff, VA 24609	0.0382 acres 1/11 of 0.42 acres	0.0008%
(d) Glenward Jason Shortt 128 And Street Pounding Mill, VA 24637	0.0382 acres 1/11 of 0.42 acres	0.0008%
(e) Ballard Charlie Shortt Heirs, Deivsees, Successors, or Assigns		
(h.1) Earlean Shortt Heirs, Deviseses, Successors, or Assigns <i>(Documentation Pending)</i>	0.0382 acres 1/11 of 0.42 acres	0.0008%
(h.1.1) Becky Harris 105 Windlass Court Moneta, VA 24121		
(f) Dorothy Short Keene 279 Townview Drive Lebanon, VA 24266	0.0382 acres 1/11 of 0.42 acres	0.0008%
(g) Maudie Short Bronson Heirs, Deviseses, Successors, or Assigns		
(g.1) Kenneth Wingo 1509 East Blow Road Signal Mountain, TN 37377	0.0382 acres 1/11 of 0.42 acres	0.0008%
(h) Effie Shortt Heirs, Deviseses, Successors, or Assigns		
(h.1) Garnie Jean Thomas PO Box 745 Doran, VA 24612	0.0382 acres 1/11 of 0.42 acres	0.0008%

**Exhibit E**  
**VS18**  
**Docket #VGOB 23-1121-4277-01**  
**List of Conflicting Owners/Claimants requiring Escrow**  
**(4,721.14 Acre Unit)**

	Acres in Unit	Interest in Unit
(i) Garnie Jean Thomson <i>Conveyed 11/26/1997 to Harold Short and Glenward Short as JTWROS, DB 472/104</i>		
(i.1) Harold B. Shortt <i>(DOD 1/6/2017)</i>		
(i.2) Glenward Jason Short 128 And Street Pounding Mill, VA 24637	0.0382 acres 1/11 of 0.42 acres	0.0008%
(j) Otis Herbert Shortt Heirs, Deviseses, Successors, or Assigns <i>(Documentation Pending)</i>	0.0382 acres 1/11 of 0.42 acres	0.0008%
(k) Raymond B. Short Heirs, Deviseses, Successors, or Assigns		
(k.1) Delcie Norene Short Heirs, Deviseses, Successors, or Assigns		
(k.1.1) Grover Cleveland Elswick 5220 Looking Glass Trail Denver, NC 28037	0.0191 acres 1/22 of 0.42 acres	0.0004%
(k.1.2) Heather Norene Thornburg 1515 Town N Country Drive Wilkesboro, NC 28697	0.0191 acres 1/22 of 0.42 acres	0.0004%
<b>OR</b>		
<b>(1)</b> Robert and Jackie Rose 1008 Shortts Road Raven, VA 24639	0.42 acres	0.0089%
<b><u>Tract #37A - 0.76 Acres</u></b>		
<i>***Cloud on Title - When Tom Short acquired title to the parent tract of which this property is a portion, he also obtained title to the gas and oil. He then conveyed the property to his wife (Bertha) and reserved all minerals in DB 190/119. Bertha later conveyed back to Tom in DB 217/438, with the same reservation language, though she owned no mineral to reserve. Tom again conveyed to Bertha in DB 281/12, reserving all mineral. Bertha again conveyed to Tom in DB 331/248, and again reserved mineral she did not own. Tom Short and Bertha Short conveyed to Walter M. Short and Jeanette H. Short, in DB 342/400, a 3.2 acre parcel, referencing as the source of title DB 331/248 wherein Bertha reserved mineral she did not own, as the mineral reservation language. The intent of Bertha and Tom Short may have been to reserve all mineral, however, the source reservation language reference within DB 342/400 fails. Correction deeds are necessary to vest title to the oil and gas in either the heirs of Tom Short, or the current surface owners, Robert and Jackie Rose.</i>		
<b>(1)</b> Walter Shortt, et al	0.76 acres	0.0161%
(a) Tommy Arnold Shortt PO Box 1228 Richlands, VA 24641	0.0691 acres 1/11 of 0.76 acres	0.0015%
(b) Walter Mervin Shortt Heirs, Deviseses, Successors, or Assigns		
(b.1) Mervin Shortt 815 W Thornwood Drive South Elgin, IL 60177	0.0230 acres 1/33 of 0.76 acres	0.0005%
(b.2) Linda F. Grasso 4016 Silk Oak Lane Palm Harbor, FL 34685	0.0230 acres 1/33 of 0.76 acres	0.0005%
(b.3) Larry Walter Short <i>pre-deceased</i>		
(b.3.1) Larry Short, Jr. 436 Waverly Street Kingsford, MI 49802	0.0115 acres 1/66 of 0.76 acres	0.0002%
(b.3.2) Tamara Beth Ham 108 Chesterfield Drive Pinehurst, NC 28374	0.0115 acres 1/66 of 0.76 acres	0.0002%
(c) Harold B. Shortt Heirs, Deviseses, Successors, or Assigns		
(c.1) Charlene Shortt PO Box 1818 Cedar Bluff, VA 24609	0.0691 acres 1/11 of 0.76 acres	0.0015%

Exhibit E  
VS18  
Docket #VGOB 23-1121-4277-01  
List of Conflicting Owners/Claimants requiring Escrow  
(4,721.14 Acre Unit)

	Acres in Unit	Interest in Unit
(d) Glenward Jason Shortt 128 And Street Pounding Mill, VA 24637	0.0691 acres 1/11 of 0.76 acres	0.0015%
(e) Ballard Charlie Shortt Heirs, Deivsees, Successors, or Assigns		
(h.1) Earlean Shortt Heirs, Deivsees, Successors, or Assigns <i>(Documentation Pending)</i>	0.0691 acres 1/11 of 0.76 acres	0.0015%
(h.1.1) Becky Harris 105 Windlass Court Moneta, VA 24121		
(f) Dorothy Short Keene 279 Townview Drive Lebanon, VA 24266	0.0691 acres 1/11 of 0.76 acres	0.0015%
(g) Maudie Short Bronson Heirs, Deivsees, Successors, or Assigns		
(g.1) Kenneth Wingo 1509 East Blow Road Signal Mountain, TN 37377	0.0691 acres 1/11 of 0.76 acres	0.0015%
(h) Effie Shortt Heirs, Deivsees, Successors, or Assigns		
(h.1) Garnie Jean Thomas PO Box 745 Doran, VA 24612	0.0691 acres 1/11 of 0.76 acres	0.0015%
(i) Garnie Jean Thomson <i>Conveyed 11/26/1997 to Harold Short and Glenward Short as JTWROS, DB 472/104</i>		
(i.1) Harold B. Shortt <i>(DOD 1/6/2017)</i>		
(i.2) Glenward Jason Short 128 And Street Pounding Mill, VA 24637	0.0691 acres 1/11 of 0.76 acres	0.0015%
(j) Otis Herbert Shortt Heirs, Deivsees, Successors, or Assigns <i>(Documentation Pending)</i>	0.0691 acres 1/11 of 0.76 acres	0.0015%
(k) Raymond B. Short Heirs, Deivsees, Successors, or Assigns		
(k.1) Delcie Norene Short Heirs, Deivsees, Successors, or Assigns		
(k.1.1) Grover Cleveland Elswick 5220 Looking Glass Trail Denver, NC 28037	0.0345 acres 1/22 of 0.76 acres	0.0007%
(k.1.2) Heather Norene Thornburg 1515 Town N Country Drive Wilkesboro, NC 28697	0.0345 acres 1/22 of 0.76 acres	0.0007%
<b>OR</b>		
<b>(1)</b> Robert and Jackie Rose 1008 Shortts Road Raven, VA 24639	0.76 acres	0.0161%
	<b>Total Acres</b>	1.18
	<b>Total Percentage</b>	0.0250%

BUCHANAN NO. 1 SGU  
SOUTH 1 PANEL  
298.43 ACRE TRACT

VENT SHAFT 18  
VGOB 23-1121-4277

VS18



NO MINING THIS AREA

BUCHANAN NO. 1  
SOUTH 1 PANEL SGU

VGOB 25-0415-4304

DRAWN BY: PD      DATE: MARCH 7, 2025

SCALE: N.T.S.      EXHIBIT A-4

VIRGINIA STATE PLANE NAD83 SOUTH ZONE

\_\_\_\_\_  
Licensed Professional Surveyor (Affix Seal)

V I R G I N I A:

BEFORE THE VIRGINIA GAS AND OIL BOARD

APPLICANT: **Pocahontas Gas LLC** ) VIRGINIA GAS  
) AND OIL BOARD  
RELIEF SOUGHT: (1) MODIFICATION OF UNIT ACREAGE; )  
(2) DISMISSAL OF RESPONDENTS; AND )  
(3) MODIFICATION OF DIVISION OF )  
INTERESTS. ) DOCKET NO.  
) **VGOB-23-1121-4277-01**  
)  
LEGAL DESCRIPTION: )  
)  
BUCHANAN No.1 VS-18 )  
**KEEN MOUNTAIN/JEWELL RIDGE/HONAKER** )  
**QUADRANGLE (S) ,** )  
**GARDEN/MAIDEN SPRING/NEW GARDEN** )  
**MAGISTERIAL DISTRICT (S)** )  
**BUCHANAN/TAZEWELL/RUSSELL COUNTY (S) , VIRGINIA** )

REPORT OF THE BOARD

FINDINGS AND ORDER

1. Hearing Date and Place: This matter came for hearing before the Virginia Gas and Oil board (hereafter "Board") at 10:00 a.m. on **April 15, 2025** at Virginia Energy 3405 Mountain Empire Road, Big Stone Gap, Virginia and was approved.

2. Appearances: **Mark Swartz, Esq.**, appeared for the Applicant. Jessica Cooper of the Office of Attorney General was present to advise the Board.

3. Jurisdiction and Notice: Pursuant to Va. Code §§45.2-1600 et seq., the Board finds that it has jurisdiction over the subject matter. The Board further finds that the Applicant has met the requirements of 4VAC25-160-140, to-wit: (1) it has provided the names and addresses of all Respondents; (2) it has mailed a copy of the Miscellaneous Petition and Exhibits thereto to all Respondents for whom it has addresses; (3) it has provided and filed its proof of mailing; (4) it has published its Notice of Hearing and provided and filed Proof of Publication; and (5) its Petition identifies the issues and sets forth the specific relief requested.

4. Amendments: **none**

5. Dismissals: **none**

6. Relief Requested:

6.1 Applicant requests that the Board extract the acreage within the Buchanan No. 1 South 1 Panel SGU consisting of **298.43 acres**, from the Buchanan No. 1 VS-18 Unit The boundaries of the acreage to be extracted are depicted in Exhibit A hereto which unit and acreage are bounded as follows:

Beginning at a point, Virginia State Plane NAD 83 coordinate of N:  
3593834.13 E: 10485609.83 (southwest corner of Buchanan Mine #1 South 1

Panel Sealed Gob Unit); thence S 89°43'34" E 1413.36 feet to a point, Virginia State Plane NAD 83 coordinate of N: 3593827.37 E: 10487023.18 (southeast corner of Buchanan Mine #1 Sealed Gob Unit South 1 Panel); thence N 43°58'55" W 93.33 feet to a point, Virginia State Plane NAD 83 coordinate of N: 3593894.52 E: 10486958.37; thence N: 01°38'34" E 9743.31 feet to a point, Virginia State Plane NAD 83 coordinate of N: 3603633.83 E: 10487237.70 (northeast corner of Buchanan Mine #1 Sealed Gob Unit South 1 Panel); thence N 39°28'40" W 229.37 feet to a point, Virginia State Plane NAD 83 coordinate of N: 3603456.78 E: 10487091.87; thence N 88°23'00" W 1206.00 feet a point of beginning, containing +/- **298.43** acres.

6.2 That the Board re-establish the percentages for division of interest for production, revenue, and costs for all Respondents with acreage remaining in the Buchanan No. 1 VS-18 Unit in accordance with those percentages set forth in Revised Exhibit B to the Application.

7. Relief Granted: The requested relief in this cause shall be and hereby is granted and:

7.1 The relief requested and granted is just and reasonable, is supported by substantial evidence and will afford each person listed and named in **Revised Exhibit B** hereto the opportunity to recover or receive, without unnecessary expense, such person's just and fair share of the production from the Subject Unit. The granting of the Application and relief requested therein will ensure to the extent possible the greatest ultimate recovery of Coalbed Methane Gas, prevent or assist in preventing the various types of waste prohibited by statute and protect or assist in protecting the correlative rights of all persons in the subject common sources of supply in the Subject Lands. Therefore, the Board is entering an Order granting the relief herein set forth.

8. Mailing Of Order And Filing Of Affidavit: Applicant or its Attorney shall file an affidavit with the Secretary of the Board within sixty (60) days after the date of recording of this Order stating that a true and correct copy of said Order was mailed within seven (7) days from the date of its receipt by Unit Operator to each Respondent named in **Revised Exhibit B** included with this Order and whose address is known.

9. Availability of Unit Records: The Director shall provide all persons not subject to a lease with reasonable access to all records for Subject Unit which are submitted by the Unit Operator to said Director and/or his Inspector(s).

10. Conclusion: Therefore, the requested relief and all terms and provisions set forth above be and hereby are granted and IT IS SO ORDERED.

11. Appeals: Appeals of this Order are governed by the provisions of Va. Code Ann. § 45.2-1625 which provides that any order or decision of the Board may be appealed to the appropriate circuit court.

12. Effective Date: This Order shall be effective as of the date of the Board's approval of this Application, which is set forth at Paragraph 1 above.