

BEFORE THE VIRGINIA GAS AND OIL BOARD

PETITIONER: CNX Gas Company LLC

DIVISION OF GAS AND OIL

DOCKET NO: VGOB 07-1113-2083-03

RELIEF SOUGHT: (1) DISBURSEMENT FROM ESCROW REGARDING TRACT(S) 4I (2) AND AUTHORIZATION FOR DIRECT PAYMENT OF ROYALTIES (3) AND DISMISSAL OF COAL OWNERS PURSUANT TO CODE OF VIRGINIA SECTION 45.1-361.22:2.

HEARING DATE: April 17, 2018

DRILLING UNIT: VP8SGU5

BUCHANAN COUNTY, VIRGINIA

PETITION FOR ORDER OF DISBURSEMENT OF ESCROW FUNDS

1. Petitioner and its counsel

Petitioner is CNX Gas Company LLC, PO Box 570, Pounding Mill, VA 24637, (276)596-5075. Petitioner's counsel is Mark A. Swartz, Hillard & Swartz, LLP, 122 Capital Street, Suite 201, Charleston, WV 25301.

2. Relief Sought

(1) the disbursement of escrowed funds heretofore deposited with the Board's Escrow Agent, attributable to Tract 4I, as depicted upon the annexed table; and (2) authorization to begin paying royalties directly to the parties to the prevailing plaintiffs: Theresa Brents.

3. Legal Authority

Va. Code Ann. § 45.1-361.1 et seq., 4 VAC 25-160-140., and relevant Virginia Gas and Oil Board Orders ("Board") heretofore promulgated pursuant to law.

4. Type of Well(s)

Sealed Gob Unit

5. Factual basis for relief requested

Theresa Brents is entitled to 100% of the CBM royalties awarded under Case No. CL12-387, Opinion dated February 5, 2015. Said decision allows the Applicant and Designated Operator to pay royalties directly to the persons identified in Exhibit EE annexed hereto and the annexed Table, further, specifies how said royalties are to be paid.

6. Attestation

The foregoing Petition to the best of my knowledge, information, and belief is true and correct.

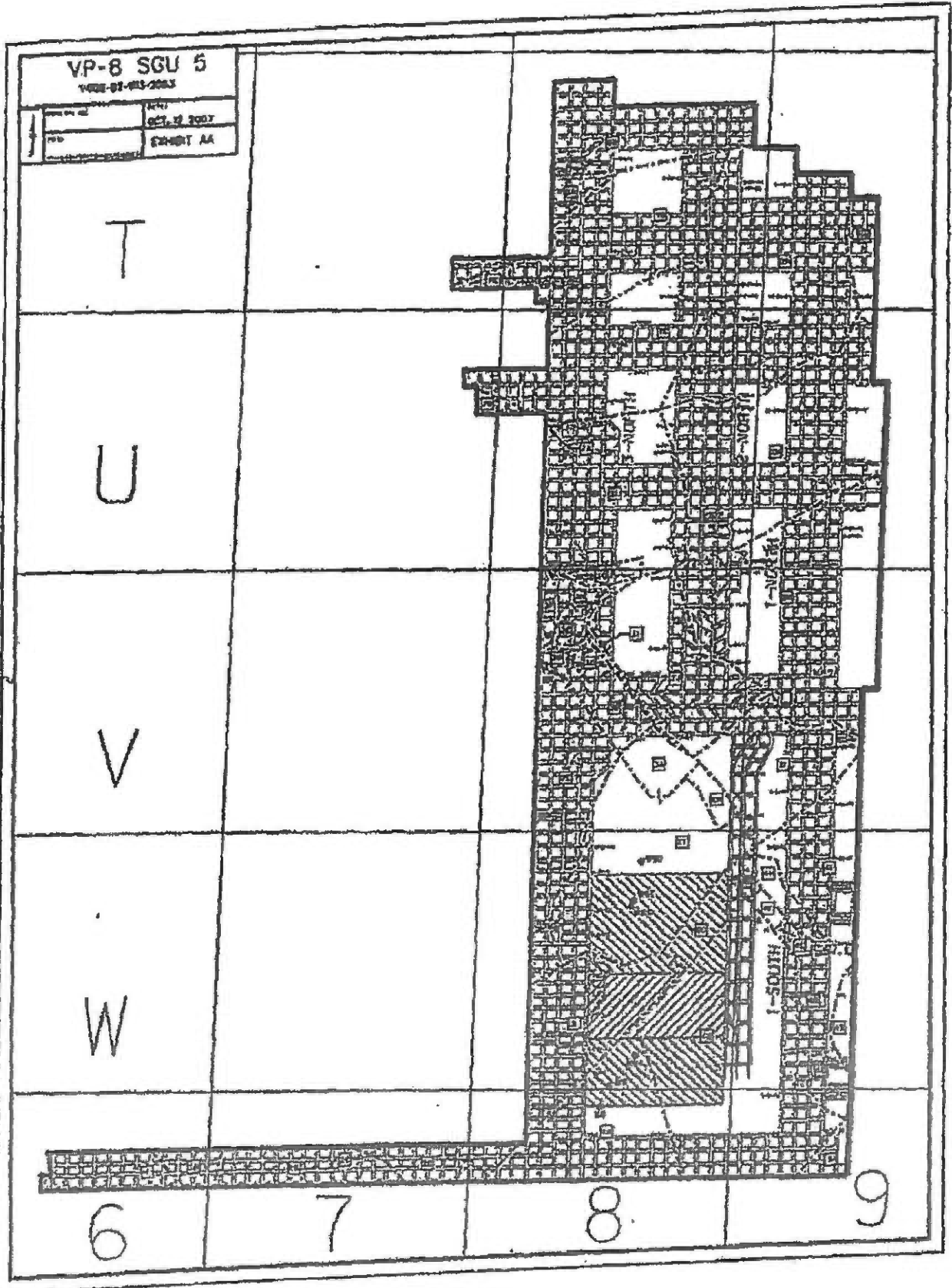

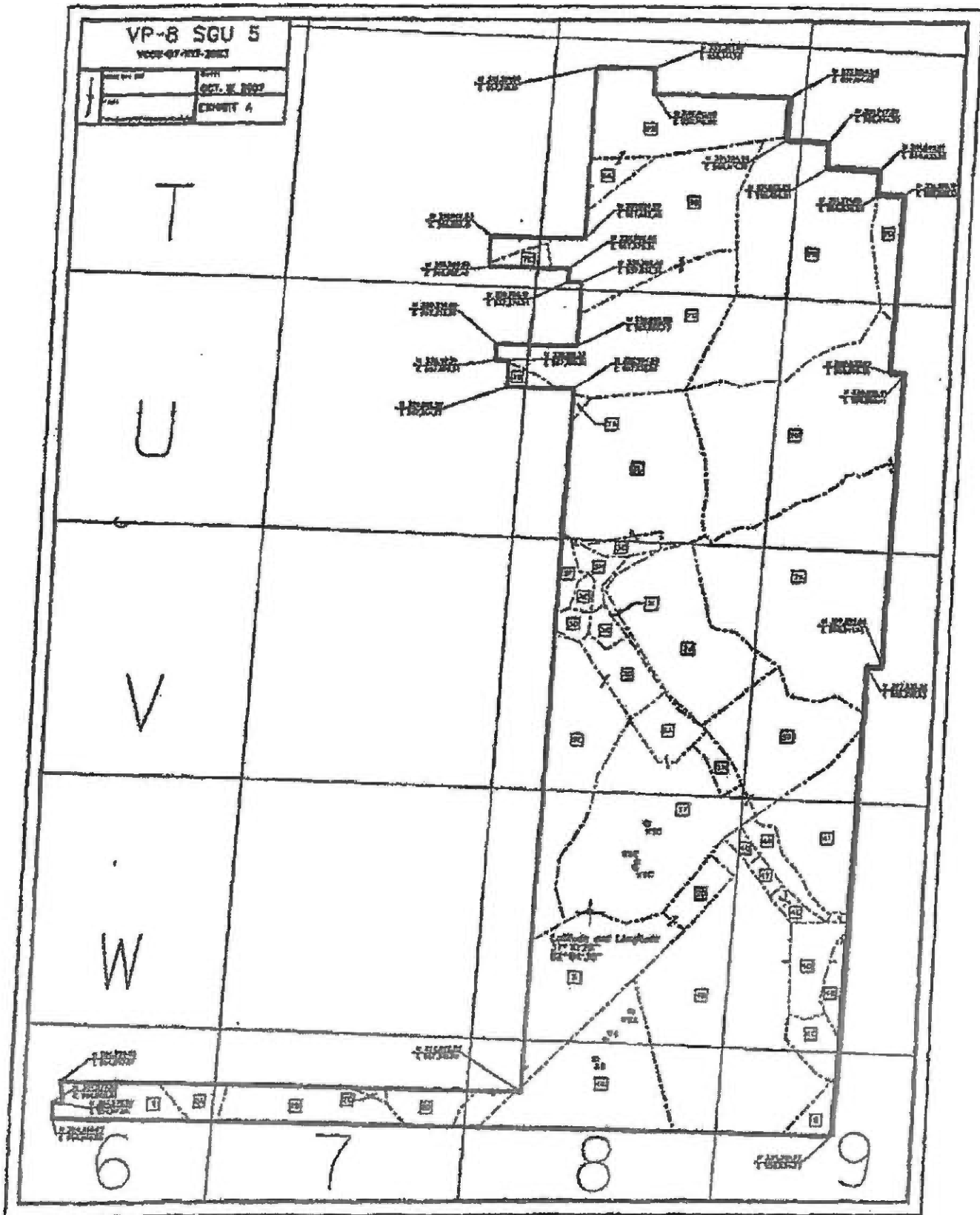

CNX Gas Company LLC
VP-8 Sealed Gob Unit 5
Tract Identifications
441.90 Acre Unit

1. Harrison-Wyatt, LLC, Big Axe Tr. 31, Oxy Tr. 25 (247 Acre Tract) – All Minerals
Island Creek Coal Company/Consol Energy, Inc. – Coal Below Tiller Leased
Jewell Smokeless Coal Corp. – Coal In and Above Tiller Leased
CNX Gas Company LLC – Oil, Gas and CBM Leased
Gregory L. Cook, et al – Surface
5.52 acres 1.2491%
- 2A. Harrison-Wyatt, LLC, Big Axe Tr. 30, Oxy Tr. 23 (900 Acre Tract) – Coal
Island Creek Coal Company/Consol Energy, Inc. – Coal Below Tiller Seam Leased
Jewell Smokeless Coal Company – Coal Above Jawbone Leased
CNX Gas Company LLC – CBM Leased
Alvin W. Cox, et ux – Surface, Oil and Gas
2.25 acres 0.5092%
- 2B. Harrison-Wyatt, LLC, Big Axe Tr. 30, Oxy Tr. 23 (900 Acre Tract) – Coal
Island Creek Coal Company/Consol Energy, Inc. – Coal Below Tiller Seam Leased
Jewell Smokeless Coal Company – Coal Above Jawbone Leased
Harris Crumpton, et ux – Surface, Oil and Gas
Harrison-Wyatt, LLC (50%)/Harris Crumpton, et ux (50%) – CBM
CNX Gas Company LLC – Oil, Gas and CBM Leased
7.52 acres 1.7017%
- 2C. Harrison-Wyatt, LLC, Big Axe Tr. 30, Oxy Tr. 23 (900 Acre Tract) – Coal
Island Creek Coal Company/Consol Energy, Inc. – Coal Below Tiller Seam Leased
Jewell Smokeless Coal Company – Coal Above Jawbone Leased
CNX Gas Company LLC – CBM Leased
Bobby H. C. Jackson, et al – Surface, Oil and Gas
0.33 acres 0.0747%
- 2D. Harrison-Wyatt, LLC, Big Axe Tr. 30, Oxy Tr. 23 (900 Acre Tract) – Coal
Island Creek Coal Company/Consol Energy, Inc. – Coal Below Tiller Seam Leased
Jewell Smokeless Coal Company – Coal Above Jawbone Leased
CNX Gas Company LLC – CBM Leased
Bobby H. C. Jackson, et al – Surface, Oil and Gas
3.33 acres 0.7536%
- 2E. Harrison-Wyatt, LLC, Big Axe Tr. 30, Oxy Tr. 23 (900 Acre Tract) – Coal
Island Creek Coal Company/Consol Energy, Inc. – Coal Below Tiller Seam Leased
Jewell Smokeless Coal Company – Coal Above Jawbone Leased
CNX Gas Company LLC – Oil and Gas
Harrison-Wyatt, LLC (50%)/CNX Gas Company LLC (50%) – CBM
CNX Gas Company LLC – CBM Leased (50%)
Unknown Surface Owner
16.68 acres 3.7746%
- 2F. Harrison-Wyatt, LLC, Big Axe Tr. 30, Oxy Tr. 23 (900 Acre Tract) – Coal
Island Creek Coal Company/Consol Energy, Inc. – Coal Below Tiller Seam Leased
Jewell Smokeless Coal Company – Coal Above Jawbone Leased
CNX Gas Company LLC – Oil and Gas
Harrison-Wyatt, LLC (50%)/CNX Gas Company LLC (50%) – CBM
CNX Gas Company LLC – CBM Leased (50%)
Unknown Surface Owner
28.80 acres 6.5173%

(This title block is for general informational purposes only and does not reflect an analysis of the severance deed and its effect upon coalbed methane ownership and should not be relied upon for such purpose.)

CNX Gas Company LLC
VP-8 Sealed Gob Unit 5
Tract Identifications
441.90 Acre Unit

- 2G. Harrison-Wyatt, LLC, Big Axe Tr. 30, Oxy Tr. 23 (900 Acre Tract) – Coal
Island Creek Coal Company/Consol Energy, Inc. – Coal Below Tiller Seam Leased
Jewell Smokeless Coal Company – Coal Above Jawbone Leased
CNX Gas Company LLC – CBM Leased
Bobby H. C. Jackson, et al – Surface, Oil and Gas
2.82 acres 0.6381%**
- 2H. Harrison-Wyatt, LLC, Big Axe Tr. 30, Oxy Tr. 23 (900 Acre Tract) – Coal
Jewell Smokeless Coal Corp. – Coal In Tiller and Above Leased
Island Creek Coal Company/Consol Energy, Inc. – Coal Below Tiller Leased
William Rife, et ux – Surface, Oil and Gas
Harrison-Wyatt, LLC (50%)/ William Rife, et ux (50%) – CBM
CNX Gas Company LLC – Oil, Gas and CBM Leased
1.68 acres 0.3802%**
- 2I. Harrison-Wyatt, LLC, Big Axe Tr. 30, Oxy Tr. 23 (900 Acre Tract) – Coal
Island Creek Coal Company/Consol Energy, Inc. – Coal Below Tiller Seam Leased
Jewell Smokeless Coal Company – Coal Above Jawbone Leased
CNX Gas Company LLC – Oil and Gas
Harrison-Wyatt, LLC (50%)/CNX Gas Company LLC (50%) – CBM
CNX Gas Company LLC – CBM Leased (50%)
Island Creek Coal Company – Surface
15.44 acres 3.4940%**
- 2J. Harrison-Wyatt, LLC, Big Axe Tr. 30, Oxy Tr. 23 (900 Acre Tract) – Coal
Island Creek Coal Company/Consol Energy, Inc. – Coal Below Tiller Seam Leased
Jewell Smokeless Coal Company – Coal Above Jawbone Leased
CNX Gas Company LLC – Oil and Gas
Harrison-Wyatt, LLC (50%)/CNX Gas Company LLC (50%) – CBM
CNX Gas Company LLC – CBM Leased (50%)
Island Creek Coal Company – Surface
18.75 acres 4.2430%**
- 2K. Harrison-Wyatt, LLC, Big Axe Tr. 30, Oxy Tr. 23 (900 Acre Tract) – Coal
Island Creek Coal Company/Consol Energy, Inc. – Coal Below Tiller Seam Leased
Jewell Smokeless Coal Company – Coal Above Jawbone Leased
CNX Gas Company LLC – Oil and Gas
Harrison-Wyatt, LLC (50%)/CNX Gas Company LLC (50%) – CBM
CNX Gas Company LLC – CBM Leased (50%)
Island Creek Coal Company – Surface
39.78 acres 9.0020%**
- 2L. Harrison-Wyatt, LLC, Big Axe Tr. 30, Oxy Tr. 23 (900 Acre Tract) – Coal
Island Creek Coal Company/Consol Energy, Inc. – Coal Below Tiller Seam Leased
Jewell Smokeless Coal Company – Coal Above Jawbone Leased
CNX Gas Company LLC – Oil and Gas
Harrison-Wyatt, LLC (50%)/CNX Gas Company LLC (50%) – CBM
CNX Gas Company LLC – CBM Leased (50%)
Island Creek Coal Company – Surface
24.39 acres 5.5183%**

(This title block is for general informational purposes only and does not reflect an analysis of the severance deed and its effect upon coalbed methane ownership and should not be relied upon for such purpose.)

CNX Gas Company LLC
VP-8 Sealed Gob Unit 5
Tract Identifications
441.90 Acre Unit

- 2M. Harrison-Wyatt, LLC, Big Axe Tr. 30, Oxy Tr. 23 (900 Acre Tract) – Coal
Island Creek Coal Company/Consol Energy, Inc. – Coal Below Tiller Seam Leased
Jewell Smokeless Coal Company – Coal Above Jawbone Leased
CNX Gas Company LLC – Oil and Gas
Harrison-Wyatt, LLC (50%)/CNX Gas Company LLC (50%) – CBM
CNX Gas Company LLC – CBM Leased (50%)
Island Creek Coal Company – Surface
36.17 acres 8.1851%
- 2N. Harrison-Wyatt, LLC, Big Axe Tr. 30, Oxy Tr. 23 (900 Acre Tract) – Coal
Island Creek Coal Company/Consol Energy, Inc. – Coal Below Tiller Seam Leased
Jewell Smokeless Coal Company – Coal Above Jawbone Leased
CNX Gas Company LLC – Oil and Gas
Harrison-Wyatt, LLC (50%)/CNX Gas Company LLC (50%) – CBM
CNX Gas Company LLC – CBM Leased (50%)
Island Creek Coal Company – Surface
39.12 acres 8.8527%
- 2O. Harrison-Wyatt, LLC, Big Axe Tr. 30, Oxy Tr. 23 (900 Acre Tract) – Coal
Island Creek Coal Company/Consol Energy, Inc. – Coal Below Tiller Seam Leased
Jewell Smokeless Coal Company – Coal Above Jawbone Leased
CNX Gas Company LLC – Oil and Gas
Harrison-Wyatt, LLC (50%)/CNX Gas Company LLC (50%) – CBM
CNX Gas Company LLC – CBM Leased (50%)
Island Creek Coal Company – Surface
3.80 acres 0.8599%
- 3A. Island Creek Coal Company/Consol Energy, Inc. – Coal
CNX Gas Company LLC – Oil and Gas
Island Creek Coal Company/Consol Energy, Inc. – Surface
3.72 acres 0.8418%
- 3B. Pearl H. Keene, et al (Edna L. Keene Heirs) – Coal
Island Creek Coal Company/Consol Energy, Inc. – Coal Below Tiller Seam Leased
CNX Gas Company LLC – Oil and Gas
Island Creek Coal Company/Consol Energy, Inc. – Surface
4.26 acres 0.9640%
- 3C. Pearl H. Keene, et al (Edna L. Keene Heirs) – All Minerals
Island Creek Coal Company/Consol Energy, Inc. – Coal Below Tiller Seam Leased
CNX Gas Company LLC – Oil, Gas and CBM Leased
Island Creek Coal Company/Consol Energy, Inc. – Surface
1.20 acres 0.2718%
- 3D. Pearl H. Keene, et al (Edna L. Keene Heirs) – All Minerals
Island Creek Coal Company/Consol Energy, Inc. – Coal Below Tiller Seam Leased
CNX Gas Company LLC – Oil, Gas and CBM Leased
Island Creek Coal Company/Consol Energy, Inc. – Surface
1.11 acres 0.2512%

(This title block is for general informational purposes only and does not reflect an analysis of the severance deed and its effect upon coalbed methane ownership and should not be relied upon for such purpose.)

**CNX Gas Company LLC
VP-8 Sealed Gob Unit 5
Tract Identifications
441.90 Acre Unit**

- 3E. Pearl H. Keene, et al (Edna L. Keene Heirs) – All Minerals
Island Creek Coal Company/Consol Energy, Inc. – Coal Below Tiller Seam Leased
CNX Gas Company LLC – Oil, Gas and CBM Leased
Island Creek Coal Company/Consol Energy, Inc. – Surface
0.78 acres 0.1765%
- 3F. Pearl H. Keene, et al (Edna L. Keene Heirs) – Coal Below Tiller Seam
Island Creek Coal Company/Consol Energy, Inc. – Coal Below Tiller Seam Leased
Island Creek Coal Company/Consol Energy, Inc. – Coal In Tiller Seam and Above
CNX Gas Company LLC – Oil and Gas
Island Creek Coal Company - Surface
1.48 acres 0.3281%
- 3G. Pearl H. Keene, et al (Edna L. Keene Heirs) – Coal Below Tiller Seam
Island Creek Coal Company/Consol Energy, Inc. – Coal Below Tiller Seam Leased
Island Creek Coal Company/Consol Energy, Inc. – Coal In Tiller Seam and Above
CNX Gas Company LLC – Oil and Gas
Island Creek Coal Company – Surface
1.48 acres 0.3349%
- 3H. Pearl H. Keene, et al (Edna L. Keene Heirs) – All Minerals
Island Creek Coal Company/Consol Energy, Inc. – Coal Below Tiller Seam Leased
CNX Gas Company LLC – Oil, Gas and CBM Leased
Island Creek Coal Company – Surface
1.76 acres 0.3983%
- 3I. Pearl H. Keene, et al (Edna L. Keene Heirs) – All Minerals
Island Creek Coal Company/Consol Energy, Inc. – Coal Below Tiller Seam Leased
CNX Gas Company LLC – Oil, Gas and CBM Leased
Island Creek Coal Company – Surface
1.20 acres 0.2716%
- 4A. Harrison-Wyatt, LLC, Big Axe Tr. 13, Oxy Tr. 27 (200 Acre Tract) – Coal
Island Creek Coal Company/Consol Energy, Inc. – Coal Below Tiller Seam Leased
Jewell Smokeless Coal Company – Coal Above Jawbone Seam Leased
CNX Gas Company LLC – Oil and Gas
Harrison-Wyatt, LLC (50%)/CNX Gas Company LLC (50%) – CBM
CNX Gas Company LLC – CBM Leased (50%)
Consolidation Coal Company – Surface
18.80 acres 4.2544%
- 4B. Harrison-Wyatt, LLC, Big Axe Tr. 13, Oxy Tr. 27 (200 Acre Tract) – Coal
Island Creek Coal Company/Consol Energy, Inc. – Coal Below Tiller Seam Leased
Jewell Smokeless Coal Company – Coal Above Jawbone Seam Leased
CNX Gas Company LLC – CBM Leased
Buchanan County, VA. – Surface, Oil and Gas
45.04 acres 10.1924%

(This title block is for general informational purposes only and does not reflect an analysis of the severance deed and its effect upon coalbed methane ownership and should not be relied upon for such purpose.)

CNX Gas Company LLC
VP-8 Sealed Gob Unit 5
Tract Identifications
441.90 Acre Unit

- 4C. Harrison-Wyatt, LLC, Big Axe Tr. 13, Oxy Tr. 27 (200 Acre Tract) – Coal Island Creek Coal Company/Consol Energy, Inc. – Coal Below Tiller Seam Leased Jewell Smokeless Coal Company – Coal Above Jawbone Seam Leased CNX Gas Company LLC – CBM Leased Virginia Department of Transportation – Surface, Oil and Gas
3.12 acres 0.7060%
- 4D. Harrison-Wyatt, LLC, Big Axe Tr. 13, Oxy Tr. 27 (200 Acre Tract) – Coal Island Creek Coal Company/Consol Energy, Inc. – Coal Below Tiller Seam Leased Jewell Smokeless Coal Company – Coal Above Jawbone Seam Leased Buchanan County Housing Limited Partnership – Surface, Oil and Gas Harrison-Wyatt, LLC (50%)/Buchanan County Housing Limited Partnership (50%) – CBM CNX Gas Company LLC – CBM Leased (50%)
4.86 acres 1.0998%
- 4E-1. Harrison-Wyatt, LLC, Big Axe Tr. 13, Oxy Tr. 27 (200 Acre Tract) – Coal Island Creek Coal Company/Consol Energy, Inc. – Coal Below Tiller Seam Leased Jewell Smokeless Coal Company – Coal Above Jawbone Seam Leased Cynthia P. Deel Rife – Surface, Oil and Gas Harrison-Wyatt, LLC (50%)/Cynthia P. Deel Rife (50%) – CBM CNX Gas Company LLC – Oil, Gas and CBM Leased
0.85 acres 0.1924%
- 4E-2. Harrison-Wyatt, LLC, Big Axe Tr. 13, Oxy Tr. 27 (200 Acre Tract) – Coal Island Creek Coal Company/Consol Energy, Inc. – Coal Below Tiller Seam Leased Jewell Smokeless Coal Company – Coal Above Jawbone Seam Leased Cynthia P. Deel Rife – Surface, Oil and Gas Harrison-Wyatt, LLC (50%)/Cynthia P. Deel Rife (50%) – CBM CNX Gas Company LLC – CBM Leased (50%)
0.26 acres 0.0588%
- 4F. Harrison-Wyatt, LLC, Big Axe Tr. 13, Oxy Tr. 27 (200 Acre Tract) – Coal Island Creek Coal Company/Consol Energy, Inc. – Coal Below Tiller Seam Leased Jewell Smokeless Coal Company – Coal Above Jawbone Seam Leased William E. Rife, et ux – Surface, Oil and Gas Harrison-Wyatt, LLC (50%)/William E. Rife, et ux (50%) – CBM CNX Gas Company LLC – Oil, Gas and CBM Leased
0.79 acres 0.1788%
- 4G. Harrison-Wyatt, LLC, Big Axe Tr. 13, Oxy Tr. 27 (200 Acre Tract) – Coal Island Creek Coal Company/Consol Energy, Inc. – Coal Below Tiller Seam Leased Jewell Smokeless Coal Company – Coal Above Jawbone Seam Leased CNX Gas Company LLC – CBM Leased Janet Brown, et vir – Surface, Oil and Gas Harrison-Wyatt, LLC (50%)/Janet Brown, et vir (50%) – CBM CNX Gas Company LLC – Oil, Gas and CBM Leased
0.84 acres 0.1901%

(This title block is for general informational purposes only and does not reflect an analysis of the severance deed and its effect upon coalbed methane ownership and should not be relied upon for such purpose.)

Page 5 of 7

February 22, 2012

**CNX Gas Company LLC
VP-8 Sealed Gob Unit 5
Tract Identifications
441.90 Acre Unit**

- 4H. Harrison-Wyatt, LLC, Big Axe Tr. 13, Oxy Tr. 27 (208 Acre Tract) – Coal
Island Creek Coal Company/Consol Energy, Inc. – Coal Below Tiller Seam Leased
Jewell Smokeless Coal Company – Coal Above Jawbone Seam Leased
Janet Brown, et vir – Surface, Oil and Gas
Harrison-Wyatt, LLC (50%)/Janet Brown, et vir (50%) – CBM
CNX Gas Company LLC – CBM Leased (50%)
2.73 acres 0.6178%
- 4I. Harrison-Wyatt, LLC, Big Axe Tr. 13, Oxy Tr. 27 (200 Acre Tract) – Coal
Island Creek Coal Company/Consol Energy, Inc. – Coal Below Tiller Seam Leased
Jewell Smokeless Coal Company – Coal Above Jawbone Seam Leased
CNX Gas Company LLC – CBM Leased
Theresa H. Brents – Surface, Oil and Gas
CNX Gas Company LLC – Oil, Gas and CBM Leased
12.48 acres 2.8242%
6. T. R. Mullins, et al (39.00 Acre Tract) – Coal
Island Creek Coal Company/Consol Energy, Inc. – Coal Below Tiller Seam Leased
CNX Gas Company LLC – CBM Leased (11.11%)
Bobby H. C. Jackson, et al – Surface, Oil and Gas
18.63 acres 4.2159%
6. Harrison-Wyatt, LLC Big Axe Tr. 12, Oxy Tr. 40 (155 Acre Tract) – All Minerals
Island Creek Coal Company/Consol Energy, Inc. – Coal Below Tiller Seam Leased
Jewell Smokeless Coal Corporation – Coal In Tiller and Above Leased
CNX Gas Company LLC – Oil, Gas and CBM Leased
Buchanan County, VA – Surface
1.99 acres 0.4503%
- 7A. Harrison-Wyatt, LLC Big Axe Tr. 11, Oxy Tr. 24 (336 Acre Tract) – Coal
Island Creek Coal Company/Consol Energy, Inc. – Coal Below Tiller Seam Leased
Jewell Smokeless Coal Corp. – Coal in Tiller Seam and Above Leased
CNX Gas Company LLC – Oil and Gas
Harrison-Wyatt, LLC (50%)/CNX Gas Company LLC (50%) – CBM
CNX Gas Company LLC – CBM Leased (50%)
Island Creek Coal Company – Surface
0.32 acres 0.0724%
- 7B. Harrison-Wyatt, LLC Big Axe Tr. 11, Oxy Tr. 24 (336 Acre Tract) – Coal
Island Creek Coal Company/Consol Energy, Inc. – Coal Below Tiller Seam Leased
Jewell Smokeless Coal Corp. – Coal in Tiller Seam and Above Leased
CNX Gas Company LLC – Oil and Gas
Harrison-Wyatt, LLC (50%)/CNX Gas Company LLC (50%) – CBM
CNX Gas Company LLC – CBM Leased (50%)
Island Creek Coal Company – Surface
0.85 acres 0.1824%

(This title block is for general informational purposes only and does not reflect an analysis of the severance deed and its effect upon coalbed methane ownership and should not be relied upon for such purpose.)

CNX Gas Company LLC
VP-8 Sealed Gob Unit 5
Tract Identifications
441.90 Acre Unit

- 7C. Harrison-Wyatt, LLC Big Axe Tr. 11, Oxy Tr. 24 (336 Acre Tract) – Coal
Island Creek Coal Company/Consol Energy, Inc. – Coal Below Tiller Seam Leased
Jewell Smokeless Coal Corp. – Coal in Tiller Seam and Above Leased
CNX Gas Company LLC – Oil and Gas
Harrison-Wyatt, LLC (60%)/CNX Gas Company LLC (50%) – CBM
CNX Gas Company LLC – CBM Leased (50%)
Island Creek Coal Company – Surface
23.46 acres 5.3089%
- 7D. Harrison-Wyatt, LLC Big Axe Tr. 11, Oxy Tr. 24 (336 Acre Tract) – Coal
Island Creek Coal Company/Consol Energy, Inc. – Coal Below Tiller Seam Leased
Jewell Smokeless Coal Corp. – Coal in Tiller Seam and Above Leased
CNX Gas Company LLC – Oil and Gas
Harrison-Wyatt, LLC (50%)/CNX Gas Company LLC (50%) – CBM
CNX Gas Company LLC – CBM Leased (50%)
Island Creek Coal Company – Surface
23.51 acres 5.3202%
- 7E. Harrison-Wyatt, LLC Big Axe Tr. 11, Oxy Tr. 24 (336 Acre Tract) – Coal
Island Creek Coal Company/Consol Energy, Inc. – Coal Below Tiller Seam Leased
Jewell Smokeless Coal Corp. – Coal in Tiller Seam and Above Leased
CNX Gas Company LLC – Oil and Gas
Harrison-Wyatt, LLC (50%)/CNX Gas Company LLC (50%) – CBM
CNX Gas Company LLC – CBM Leased (50%)
Island Creek Coal Company – Surface
1.08 acres 0.2444%
- 8A. Consolidation Coal Company OR Laura Baldwin Heirs (402.85 Acre Tract) – Coal
Island Creek Coal Company/Consol Energy, Inc. – Coal Below Tiller Seam Leased
Jewell Smokeless Coal Corp. – Coal in Tiller and Above Leased (If owned by Consolidation Coal Co.)
Highland Resources, Inc./North American Resources Corp. OR Laura Baldwin Heirs – Oil and Gas
CNX Gas Company LLC – Oil and Gas Leased (If owned by Highland Resources, Inc./North
American Resources Corp.)
Plum Creek Timberlands, L.P. OR Laura Baldwin Heirs – CBM
CNX Gas Company LLC – CBM Leased (If owned by Plum Creek Timberlands, L.P.)
CNX Gas Company LLC/Island Creek Coal Company – Surface
3.25 acres 0.7355%
- 8B. Consolidation Coal Company (402.85 Acre Tract) – Coal
Island Creek Coal Company/Consol Energy, Inc. – Coal Below Tiller Seam Leased
Jewell Smokeless Coal Corporation – Coal in Tiller and Above Leased
Highland Resources, Inc./North American Resources Corp. – Oil and Gas
CNX Gas Company LLC – Oil and Gas Leased
Plum Creek Timberlands, L.P. – CBM
CNX Gas Company LLC – CBM Leased
CNX Gas Company LLC/Island Creek Coal Company – Surface
15.70 acres 3.5528%

(This title block is for general informational purposes only and does not reflect an analysis of the severance deed and its effect upon coalbed methane ownership and should not be relied upon for such purpose.)

Page 7 of 7

February 22, 2012

Exhibit E
 VP8 - Sealed Gob Unit #5
 VP8SGU5
 Docket #VGOB 07-1113-2083-03
 List of all Owners/Claimants requiring Escrow
 (441.90 Acres)

	Acres in Unit	Percent of Unit
--	---------------	-----------------

Tract #3B - 4.26 acres

COAL OWNERSHIP

Edna L. Keene Heirs, Devisees,
 Successors or Assigns *(portions of a 27.32 acre tract)*
Documentation Pending

(1) Pearl H. Keene, et al.	4.26 acres	0.9640%
(a) Billy E. Keene Heirs, Devisees, Successors or Assigns (1/2)		
(a.1) Pearl H. Keene 672 Seven Lakes North West End, NC 27376	2.13 acres 1/2 of 4.26 acres	0.4820%
(b) Elizabeth K. Adams Heirs, Devisees, Successors or Assigns (1/2)		
(b.1) Howard Adams, III 632 Town Center Drive Joppa, MD 21085	0.53 acres 1/8 of 4.26 acres	0.1205%
(b.2) Bryan Adams 6 Ridgecliff Court Kingsville, MD 21087	0.53 acres 1/8 of 4.26 acres	0.1205%
(b.3) Cathy Rakowski 3871 Earl L. Cone Road Morgantown, WV 26508	0.53 acres 1/8 of 4.26 acres	0.1205%
(b.4) David Adams 5501 Sweet Air Road Baldwin, MD 21013	0.53 acres 1/8 of 4.26 acres	0.1205%

OIL & GAS OWNERSHIP

Continue to escrow due to Title Issues

(1) CNX Gas Company LLC 1000 Consol Energy Drive Canonsburg, PA 15317 <i>(Previously Island Creek Coal Company - p/o 27.32 acre O&G)</i>	4.26 acres	0.9640%
---	------------	---------

Tract #3F - 1.45 acres

COAL OWNERSHIP

Edna L. Keene Heirs, Devisees,
 Successors or Assigns *(a 4.60 acre tract)*
Documentation Pending
(Coal Below Tiller Seam)

(1) Pearl H. Keene, et al.	1.45 acres	0.3281%
(a) Billy E. Keene Heirs, Devisees, Successors or Assigns (3/8)		
(a.1) Pearl H. Keene 672 Seven Lakes North West End, NC 27376	0.18 acres 1/8 of 1.45 acres	0.0410%
(a.2) Billy E. Keene 9707 Chriesman Way Missouri City, TX 77459	0.18 acres 1/8 of 1.45 acres	0.0410%

Exhibit E
VP8 - Sealed Gob Unit #5
VP8SGU5
Docket #VGOB 07-1113-2083-03
List of all Owners/Claimants requiring Escrow
(441.90 Acres)

	Acres in Unit	Percent of Unit
(a.3) Beverly Stephenson 1118 W Miltrose Dr. Burns, WY 82053-9742	0.18 acres 1/8 of 1.45 acres	0.0410%
(b) Elizabeth K. Adams Heirs, Devisees, Successors or Assigns (5/8)		
(b.1) Howard Adams, III 632 Town Center Drive Joppa, MD 21085	0.23 acres 5/32 of 1.45 acres	0.0513%
(b.2) Bryan Adams 6 Ridgecliff Court Kingsville, MD 21087	0.23 acres 5/32 of 1.45 acres	0.0513%
(b.3) Cathy Rakowski 3871 Earl L. Cone Road Morgantown, WV 26508	0.23 acres 5/32 of 1.45 acres	0.0513%
(b.4) David Adams 5501 Sweet Air Road Baldwin, MD 21013	0.23 acres 5/32 of 1.45 acres	0.0513%

OIL & GAS OWNERSHIP

Continue to escrow due to Title Issues

(1) CNX Gas Company LLC 1000 Consol Energy Drive Canonsburg, PA 15317 <i>(Previously Island Creek Coal Company)</i>	1.45 acres	0.3281%
--	------------	---------

Tract #3G - 1.48 acres

COAL OWNERSHIP

Edna L. Keene Heirs, Devisees,
Successors or Assigns *(p/o a 30.50 acre tract)*
Documentation Pending
(Coal Below Tiller Seam)

(1) Pearl H. Keene, et al.	1.48 acres	0.3349%
(a) Billy E. Keene Heirs, Devisees, Successors or Assigns (3/8)		
(a.1) Pearl H. Keene 672 Seven Lakes North West End, NC 27376	0.19 acres 1/8 of 1.48 acres	0.0419%
(a.2) Billy E. Keene 9707 Chriesman Way Missouri City, TX 77459	0.19 acres 1/8 of 1.48 acres	0.0419%
(a.3) Beverly Stephenson 1118 W Miltrose Dr. Burns, WY 82053-9742	0.19 acres 1/8 of 1.48 acres	0.0419%
(b) Elizabeth K. Adams Heirs, Devisees, Successors or Assigns (5/8)		
(b.1) Howard Adams, III 632 Town Center Drive Joppa, MD 21085	0.23 acres 5/32 of 1.48 acres	0.0523%
(b.2) Bryan Adams 6 Ridgecliff Court Kingsville, MD 21087	0.23 acres 5/32 of 1.48 acres	0.0523%

Exhibit E
 VP8 - Sealed Gob Unit #5
 VP8SGU5
 Docket #VGOB 07-1113-2083-03
 List of all Owners/Claimants requiring Escrow
 (441.90 Acres)

	Acres in Unit	Percent of Unit
(b.3) Cathy Rakowski 3871 Earl L. Cone Road Morgantown, WV 26508	0.23 acres 5/32 of 1.48 acres	0.0523%
(b.4) David Adams 5501 Sweet Air Road Baldwin, MD 21013	0.23 acres 5/32 of 1.48 acres	0.0523%

OIL & GAS OWNERSHIP

Continue to escrow due to Title Issues

(1) CNX Gas Company LLC 1000 Consol Energy Drive Canonsburg, PA 15317 <i>(Previously Island Creek Coal Company - p/o 29.71 acre SOG)</i>	1.48 acres	0.3349%
---	------------	---------

Tract #8A - 3.25 acres

Escrow Due to Title Conflict

COAL OWNERSHIP

(1) Consolidation Coal Company * <i>(Parcel B, 30.00 acres of 402.85 Acre Tract)</i> 10545 Riverside Drive Oakwood, VA 24631	3.25 acres	0.7355%
---	------------	---------

* Note: Plum Creek Timberlands retained their CBM interest.

OR

Laura Baldwin Heirs, Devisees,
 Successors or Assigns *(30.00 Acres COG - GB 3/334)*

(1) Laura Baldwin Heirs	3.25 acres	0.7355%
(a) Carson D. Baldwin, Sr. Heirs, Devisees Successors or Assigns (1/8 + 1/56 = 1/7)		
(a.1) Carson David Baldwin, Jr. Heirs, Devisees, Successors or Assigns (1/28)		
(a.1.1) Patricia Baldwin 2514 57 th Street Sarasota, FL 34243	0.12 acres 1/28 of 3.25 acres	0.0263%
(a.2) Joanne Baldwin Wilson 1000 13 th Street Wytheville, VA 24382	0.12 acres 1/28 of 3.25 acres	0.0263%
(a.3) William Douglas Baldwin 3325 Bradenton Road Sarasota, FL 34234	0.12 acres 1/28 of 3.25 acres	0.0263%
(a.4) Larry Allen Baldwin 2514 57 th Street Sarasota, FL 34236	0.12 acres 1/28 of 3.25 acres	0.0263%
(b) Trula Ryan Heirs, Devisees, Successors or Assigns (1/8 + 1/56 = 1/7)		
(b.1) Sandy Ryan Moffett 8302 Brookfield Road Richmond, VA 23227	0.23 acres 1/14 of 3.25 acres	0.0525%
(b.2) Jackie Ryan 10116 Cheroy Woods Lane Ashland, VA 23005	0.23 acres 1/14 of 3.25 acres	0.0525%

Exhibit E
VP8 - Sealed Gob Unit #5
VP8SGU5
Docket #VGOB 07-1113-2083-03
List of all Owners/Claimants requiring Escrow
(441.90 Acres)

	Acres in Unit	Percent of Unit
(c) William J. Baldwin Heirs, Devisees, Successors or Assigns (1/8 + 1/56 = 1/7)		
(c.1) Sheryl Baldwin 1720 Hanover Avenue Richmond, VA 23220	0.23 acres 1/14 of 3.25 acres	0.0525%
(c.2) Deborah Drake 1720 Hanover Avenue Richmond, VA 23220	0.23 acres 1/14 of 3.25 acres	0.0525%
(d) Flora Smith Heirs, Devisees, Successors or Assigns (1/8 + 1/56 = 1/7)		
(d.1) William E. Smith 118 Nannie Ola Ct. Lascassas, TN 37085	0.15 acres 1/21 of 3.25 acres	0.0350%
(d.2) James Ronald Smith 2125 Crossfield Drive Murfreesboro, TN 37127	0.15 acres 1/21 of 3.25 acres	0.0350%
(d.3) Donna Smith 428 Biltmore Circle Murfreesboro, TN 37130	0.15 acres 1/21 of 3.25 acres	0.0350%
(e) Hassinger H. (aka Harman H.) Baldwin Heirs, Devisees, Successors or Assigns (1/8 + 1/56 = 1/7)		
(e.1) Lucy Baldwin Heirs, Devisees, Successors or Assigns	- 1/8 was reported by Harrison County, VA as being - the interest of a decedent's estate	
(e.2) Randall H. Baldwin 412 Fox Hill Road Hampton, VA 23669	0.15 acres 1/21 of 3.25 acres	0.0350%
(e.3) Laura O. Baldwin 113 Cambridge Place Hampton, VA 23669	0.15 acres 1/21 of 3.25 acres	0.0350%
(e.4) Gary A. Baldwin 1325 Coral Pl. Hampton, VA 23669	0.15 acres 1/21 of 3.25 acres	0.0350%
(f) Captola Baldwin Heirs, Devisees Successors or Assigns (1/8 + 1/56 = 1/7)		
(f.1) Amelia Ann Shoup 14441 Marsh Pike 28 Hagerstown, MD 21742-1647	0.46 acres 1/7 of 3.25 acres	0.1051%
(g) Mary Gladys Smith Heirs, Devisees, Successors or Assigns (1/8 + 1/56 = 1/7)		
(g.1) Gerri Smith Mosier 791 E. Northfield Blvd. Murfreesboro, TN 37130	0.46 acres 1/7 of 3.25 acres	0.1051%
<u>OIL & GAS OWNERSHIP</u>		
(1) Highland Resources, Inc/ North American Resources, Corp. * One Concourse Parkway, NE, Suite 755 Atlanta, GA 30328	3.25 acres	0.7355%

Exhibit E
 VP8 - Sealed Gob Unit #5
 VP8SGU5
 Docket #VGOB 07-1113-2083-03
 List of all Owners/Claimants requiring Escrow
 (441.90 Acres)

	Acres in Unit	Percent of Unit
<i>Royalties Payable to:</i>		
Plum Creek Timberlands, LP Attn: Mineral Department Five Concourse Parkway, Suite 1650 Atlanta, GA 30328		
* Note: Plum Creek Timberlands retained the CBM Estate, there is no conflict. Highland Resources, Inc. / North American Resources, Corp. is owner of only the Oil & Gas Estates.		
OR		
Laura Baldwin Heirs, Devisees, Successors or Assigns (30.00 Acres COG - GB 3/334)		
(1) Laura Baldwin Heirs	3.25 acres	0.7355%
(a) Carson D. Baldwin, Sr. Heirs, Devisees Successors or Assigns (1/8 + 1/56 = 1/7)		
(a.1) Carson David Baldwin, Jr. Heirs, Devisees, Successors or Assigns (1/28)		
(a.1.1) Patricia Baldwin 2514 57 th Street Sarasota, FL 34243	0.12 acres 1/28 of 3.25 acres	0.0263%
(a.2) Joanne Baldwin Wilson 1000 13 th Street North Wytheville, VA 24382	0.12 acres 1/28 of 3.25 acres	0.0263%
(a.3) William Douglas Baldwin 3325 Bradenton Road Sarasota, FL 34234	0.12 acres 1/28 of 3.25 acres	0.0263%
(a.4) Larry Allen Baldwin 2514 57 th Street Sarasota, FL 34243	0.12 acres 1/28 of 3.25 acres	0.0263%
(b) Trula Ryan Heirs, Devisees, Successors or Assigns (1/8 + 1/56 = 1/7)		
(b.1) Sandy Ryan Moffett 8302 Brookfield Road Richmond, VA 23227	0.23 acres 1/14 of 3.25 acres	0.0525%
(b.2) Jackie Ryan 10116 Cheroy Woods Lane Ashland, VA 23005	0.23 acres 1/14 of 3.25 acres	0.0525%
(c) William J. Baldwin Heirs, Devisees, Successors or Assigns (1/8 + 1/56 = 1/7)		
(c.1) Sheryl Baldwin 1720 Hanover Avenue Richmond, VA 23220	0.23 acres 1/14 of 3.25 acres	0.0525%
(c.2) Deborah Drake 1720 Hanover Avenue Richmond, VA 23220	0.23 acres 1/14 of 3.25 acres	0.0525%
(d) Flora Smith Heirs, Devisees, Successors or Assigns (1/8 + 1/56 = 1/7)		
(d.1) William E. Smith 118 Nannie Ola Ct. Lascassas, TN 37085	0.15 acres 1/21 of 3.25 acres	0.0350%

Exhibit E
VP8 - Sealed Gob Unit #5
VP8SGU5
Docket #VGOB 07-1113-2083-03
List of all Owners/Claimants requiring Escrow
(441.90 Acres)

	Acres in Unit	Percent of Unit
(d.2) James Ronald Smith 2125 Crossfield Drive Murfreesboro, TN 37127	0.15 acres 1/21 of 3.25 acres	0.0350%
(d.3) Donna Smith 428 Biltmore Circle Murfreesboro, TN 37130	0.15 acres 1/21 of 3.25 acres	0.0350%
(e) Hassinger H. (aka Harman H.) Baldwin Heirs, Devisees, Successors or Assigns (1/8 + 1/56 = 1/7)		
(e.1) Lucy Baldwin Heirs, Devisees, Successors or Assigns	<i>Interest reported by Hampton County, VA 1/21 Shareholder & recorded on Escrow</i>	
(e.2) Randall H. Baldwin 412 Fox Hill Road Hampton, VA 23669	0.15 acres 1/21 of 3.25 acres	0.0350%
(e.3) Laura O. Baldwin 113 Cambridge Place Hampton, VA 23669	0.15 acres 1/21 of 3.25 acres	0.0350%
(e.4) Gary A. Baldwin 1325 Coral Pl. Hampton, VA 23669	0.15 acres 1/21 of 3.25 acres	0.0350%
(f) Captola Baldwin Heirs, Devisees Successors or Assigns (1/8 + 1/56 = 1/7)		
(f.1) Amelia Ann Shoup 14441 Marsh Pike 28 Hagerstown, MD 21742-1647	0.46 acres 1/7 of 3.25 acres	0.1051%
(g) Mary Gladys Smith Heirs, Devisees, Successors or Assigns (1/8 + 1/56 = 1/7)		
(g.1) Gerri Smith Mosier 791 E. Northfield Blvd. Murfreesboro, TN 37130	0.46 acres 1/7 of 3.25 acres	0.1051%
Total tract acres	10.4400	
Total tract percent		2.3625%

Exhibit EE
 VP8 - Sealed Gob Unit #5
 VP8SGU5
 Docket #VGOB 07-1113-2083-03
 List of all Owners with Royalty Splits/Court Orders/HB2058
 (441.90 Acres)

	Acres in Unit	Percent of Unit	Percent of Escrow
<u>Tract #2A - 2.25 acres</u>			
<u>COAL OWNERSHIP</u>			
(1) H-W Financial, LLC <i>Oxy Tr 23 / Big Axe Tr 30 (900.00 acre tract)</i> P.O. Box 11000 Danville, VA 24543	2.25 acres	0.5092%	<i>n/a</i>
<u>OIL & GAS OWNERSHIP</u>			
(1) Alvin Wayne & Gaynell Cox, TE <i>(6.00 acre SOG tract)</i> Box 462 Vansant, VA 24656	2.25 acres	0.5092%	<i>n/a</i>
<u>Tract #2B - 7.52 acres</u>			
<u>COAL OWNERSHIP</u>			
(1) H-W Financial, LLC <i>Oxy Tr 23 / Big Axe Tr 30 (900.00 acre tract)</i> P.O. Box 11000 Danville, VA 24543	7.52 acres	1.7017%	<i>n/a</i>
<u>OIL & GAS OWNERSHIP</u>			
(1) Harris Crumpton, et ux. <i>(44.56 acre SOG tract)</i> P.O. Box 72 Oakwood, VA 24631	7.52 acres	1.7017%	<i>n/a</i>
<u>Tract #2C - 0.33 acres</u>			
<u>COAL OWNERSHIP</u>			
(1) H-W Financial, LLC <i>Oxy Tr 23 / Big Axe Tr 30 (900.00 acre tract)</i> P.O. Box 11000 Danville, VA 24543	0.33 acres	0.0747%	<i>n/a</i>
<u>OIL & GAS OWNERSHIP</u>			
(1) Bobby Henry Craig Jackson, et al. <i>(p/o 46.64 acre SOG Tract)</i>	0.33 acres	0.0747%	
(a) Bobby H.C. Jackson and Tracy Jackson ** P.O. Box 872 Lester Prairie, MN 55354	0.33 acres	0.0747%	<i>n/a</i>
<i>** NOTE: Joint Tenants with Rights of Survivorship</i>			
(b) Lawrence Jackson P.O. Box 376 Vansant, VA 24656			<i>Ownership subject to a Life Estate reservation deeded July 1994</i>
<i>Represented by T. Shea Cook</i>			
<u>Tract #2D - 3.33 acres</u>			
<u>COAL OWNERSHIP</u>			
(1) H-W Financial, LLC <i>Oxy Tr 23 / Big Axe Tr 30 (900.00 acre tract)</i> P.O. Box 11000 Danville, VA 24543	3.33 acres	0.7536%	<i>n/a</i>
<u>OIL & GAS OWNERSHIP</u>			
(1) Bobby Henry Craig Jackson, et al. <i>(p/o 35.00 acre SOG Tract)</i>	3.33 acres	0.7536%	

Exhibit EE
 VP8 - Sealed Gob Unit #5
 VP8SGU5
 Docket #VGOB 07-1113-2083-03
 List of all Owners with Royalty Splits/Court Orders/HB2058
 (441.90 Acres)

	Acres in Unit	Percent of Unit	Percent of Escrow
(a) Bobby H.C. Jackson and Tracy Jackson ** P.O. Box 872 Lester Prairie, MN 55354	3.33 acres	0.7536%	<i>n/a</i>
<i>** NOTE: Joint Tenants with Rights of Survivorship</i>			
(b) Lawrence Jackson P.O. Box 376 Vansant, VA 24656			<i>Ownership subject to a Life Estate reservation deeded July 1994</i>
Represented by T. Shea Cook			
<u>Tract #2E - 16.68 acres</u>			
<u>COAL OWNERSHIP</u>			
(1) H-W Financial, LLC <i>Oxy Tr 23 / Big Axe Tr 30 (900.00 acre tract)</i> P.O. Box 11000 Danville, VA 24543	16.68 acres	3.7746%	<i>n/a</i>
<u>OIL & GAS OWNERSHIP</u>			
(1) CNX Gas Company LLC 1000 Consol Energy Drive Canonsburg, PA 15317 <i>(Previously Island Creek Coal Company - p/o 27.32 acre O&G)</i>	16.68 acres	3.7746%	<i>n/a</i>
<u>Tract #2F - 28.80 acres</u>			
<u>COAL OWNERSHIP</u>			
(1) H-W Financial, LLC <i>Oxy Tr 23 / Big Axe Tr 30 (900.00 acre tract)</i> P.O. Box 11000 Danville, VA 24543	28.80 acres	6.5173%	<i>n/a</i>
<u>OIL & GAS OWNERSHIP</u>			
(1) CNX Gas Company LLC 1000 Consol Energy Drive Canonsburg, PA 15317 <i>(Previously Island Creek Coal Company - p/o 38.50 acre O&G)</i>	28.80 acres	6.5173%	<i>n/a</i>
<u>Tract #2G - 2.82 acres</u>			
<u>COAL OWNERSHIP</u>			
(1) H-W Financial, LLC <i>Oxy Tr 23 / Big Axe Tr 30 (900.00 acre tract)</i> P.O. Box 11000 Danville, VA 24543	2.82 acres	0.6382%	<i>n/a</i>
<u>OIL & GAS OWNERSHIP</u>			
(1) Bobby Henry Craig Jackson, et al. <i>(p/o 46.64 acre SOG Tract)</i>	2.82 acres	0.6382%	
(a) Bobby H.C. Jackson and Tracy Jackson ** P.O. Box 872 Lester Prairie, MN 55354	2.82 acres	0.6382%	<i>n/a</i>
<i>** NOTE: Joint Tenants with Rights of Survivorship</i>			
(b) Lawrence Jackson P.O. Box 376 Vansant, VA 24656			<i>Ownership subject to a Life Estate reservation deeded July 1994</i>
Represented by T. Shea Cook			

Exhibit EE
 VP8 - Sealed Gob Unit #5
 VP8SGU5
 Docket #VGOB 07-1113-2083-03
 List of all Owners with Royalty Splits/Court Orders/HB2058
 (441.90 Acres)

	Acres in Unit	Percent of Unit	Percent of Escrow
<u>Tract #2H - 1.68 acres</u>			
<u>COAL OWNERSHIP</u>			
(1) H-W Financial, LLC <i>Oxy Tr 23 / Big Axe Tr 30 (900.00 acre tract)</i> P.O. Box 11000 Danville, VA 24543	1.68 acres	0.3802%	<i>n/a</i>
<u>OIL & GAS OWNERSHIP</u>			
(1) William E. Rife, et ux. <i>(1.50 acre SOG tract)</i> 3451 Deskins Road Vansant, VA 24656	1.68 acres	0.3802%	<i>n/a</i>
<u>Tract #2I - 15.44 acres</u>			
<u>COAL OWNERSHIP</u>			
(1) H-W Financial, LLC <i>Oxy Tr 23 / Big Axe Tr 30 (900.00 acre tract)</i> P.O. Box 11000 Danville, VA 24543	15.44 acres	3.4940%	<i>n/a</i>
<u>OIL & GAS OWNERSHIP</u>			
(1) CNX Gas Company LLC 1000 Consol Energy Drive Canonsburg, PA 15317 <i>(Previously Island Creek Coal Company - p/o 15.70 acre SOG)</i>	15.44 acres	3.4940%	<i>n/a</i>
<u>Tract #2J - 18.75 acres</u>			
<u>COAL OWNERSHIP</u>			
(1) H-W Financial, LLC <i>Oxy Tr 23 / Big Axe Tr 30 (900.00 acre tract)</i> P.O. Box 11000 Danville, VA 24543	18.75 acres	4.2430%	<i>n/a</i>
<u>OIL & GAS OWNERSHIP</u>			
(1) CNX Gas Company LLC 1000 Consol Energy Drive Canonsburg, PA 15317 <i>(Previously Island Creek Coal Company - 20.75 acre SOG)</i>	18.75 acres	4.2430%	<i>n/a</i>
<u>Tract #2K - 39.78 acres</u>			
<u>COAL OWNERSHIP</u>			
(1) H-W Financial, LLC <i>Oxy Tr 23 / Big Axe Tr 30 (900.00 acre tract)</i> P.O. Box 11000 Danville, VA 24543	39.78 acres	9.0020%	<i>n/a</i>
<u>OIL & GAS OWNERSHIP</u>			
(1) CNX Gas Company LLC 1000 Consol Energy Drive Canonsburg, PA 15317 <i>(Previously Island Creek Coal Company - p/o 100.00 acre SOG)</i>	39.78 acres	9.0020%	<i>n/a</i>
<u>Tract #2L - 24.39 acres</u>			
<u>COAL OWNERSHIP</u>			

Exhibit EE
 VP8 - Sealed Gob Unit #5
 VP8SGU5
 Docket #VGOB 07-1113-2083-03
 List of all Owners with Royalty Splits/Court Orders/HB2058
 (441.90 Acres)

	Acres in Unit	Percent of Unit	Percent of Escrow
(1) H-W Financial, LLC <i>Oxy Tr 23 / Big Axe Tr 30 (900.00 acre tract)</i> P.O. Box 11000 Danville, VA 24543	24.39 acres	5.5193%	<i>n/a</i>
<u>OIL & GAS OWNERSHIP</u>			
(1) CNX Gas Company LLC 1000 Consol Energy Drive Canonsburg, PA 15317 <i>(Previously Island Creek Coal Company - p/o 29.71 acre SOG)</i>	24.39 acres	5.5193%	<i>n/a</i>
<u>Tract #2M - 36.17 acres</u>			
<u>COAL OWNERSHIP</u>			
(1) H-W Financial, LLC <i>Oxy Tr 23 / Big Axe Tr 30 (900.00 acre tract)</i> P.O. Box 11000 Danville, VA 24543	36.17 acres	8.1851%	<i>n/a</i>
<u>OIL & GAS OWNERSHIP</u>			
(1) CNX Gas Company LLC 1000 Consol Energy Drive Canonsburg, PA 15317 <i>(Previously Island Creek Coal Company - p/o 30.00 acre SOG)</i>	36.17 acres	8.1851%	<i>n/a</i>
<u>Tract #2N - 39.12 acres</u>			
<u>COAL OWNERSHIP</u>			
(1) H-W Financial, LLC <i>Oxy Tr 23 / Big Axe Tr 30 (900.00 acre tract)</i> P.O. Box 11000 Danville, VA 24543	39.12 acres	8.8527%	<i>n/a</i>
<u>OIL & GAS OWNERSHIP</u>			
(1) CNX Gas Company LLC 1000 Consol Energy Drive Canonsburg, PA 15317 <i>(Previously Island Creek Coal Company - p/o 60.00 acre SOG)</i>	39.12 acres	8.8527%	<i>n/a</i>
<u>Tract #2O - 3.80 acres</u>			
<u>COAL OWNERSHIP</u>			
(1) H-W Financial, LLC <i>Oxy Tr 23 / Big Axe Tr 30 (900.00 acre tract)</i> P.O. Box 11000 Danville, VA 24543	3.80 acres	0.8599%	<i>n/a</i>
<u>OIL & GAS OWNERSHIP</u>			
(1) CNX Gas Company LLC 1000 Consol Energy Drive Canonsburg, PA 15317 <i>(Previously Island Creek Coal Company - p/o 60.00 acre SOG)</i>	3.80 acres	0.8599%	<i>n/a</i>
<u>Tract #4A - 18.80 acres</u>			
<u>COAL OWNERSHIP</u>			
(1) H-W Financial, LLC <i>OXY Tr 27 / Big Axe Tr 13 (200.00 acre tract)</i> P.O. Box 11000 Danville, VA 24543	18.80 acres	4.2544%	<i>n/a</i>

Exhibit EE
 VP8 - Sealed Gob Unit #5
 VP8SGU5
 Docket #VGOB 07-1113-2083-03
 List of all Owners with Royalty Splits/Court Orders/HB2058
 (441.90 Acres)

	Acres in Unit	Percent of Unit	Percent of Escrow
<u>OIL & GAS OWNERSHIP</u>			
(1) CNX Gas Company LLC 1000 Consol Energy Drive Canonsburg, PA 15317	18.80 acres	4.2544%	<i>n/a</i>
<u>Tract #4B - 45.04 acres</u>			
<u>COAL OWNERSHIP</u>			
(1) H-W Financial, LLC <i>OXY Tr 27 / Big Axe Tr 13 (200.00 acre tract)</i> P.O. Box 11000 Danville, VA 24543	45.04 acres	10.1924%	<i>n/a</i>
<u>OIL & GAS OWNERSHIP</u>			
(1) Buchanan County, VA (<i>p/o 88.00 acre SOG tract</i>) P.O. Box 950 Grundy, VA 24614	45.04 acres	10.1924%	<i>n/a</i>
<u>Tract #4C - 3.12 acres</u>			
<u>COAL OWNERSHIP</u>			
(1) H-W Financial, LLC <i>OXY Tr 27 / Big Axe Tr 13 (200.00 acre tract)</i> P.O. Box 11000 Danville, VA 24543	3.12 acres	0.7060%	<i>n/a</i>
<u>OIL & GAS OWNERSHIP</u>			
(1) Commonwealth of Virginia (<i>p/o 6.987 acre SOG tract</i>) Department of Transportation 870 Bonham Road Bristol, VA 24201-2002	3.12 acres	0.7060%	<i>n/a</i>
<u>Tract #4D - 4.86 acres</u>			
<u>COAL OWNERSHIP</u>			
(1) H-W Financial, LLC <i>OXY Tr 27 / Big Axe Tr 13 (200.00 acre tract)</i> P.O. Box 11000 Danville, VA 24543	4.86 acres	1.0998%	<i>n/a</i>
<u>OIL & GAS OWNERSHIP</u>			
(1) Buchanan County Housing LP ** (<i>p/o 5.50 acre SOG</i>) 1173 W. Main Street Abingdon, VA 24210	4.86 acres	1.0998%	<i>n/a</i>
<u>Tract #4E(1) - 0.85 acres</u>			
<u>COAL OWNERSHIP</u>			
(1) H-W Financial, LLC <i>OXY Tr 27 / Big Axe Tr 13 (200.00 acre tract)</i> P.O. Box 11000 Danville, VA 24543	0.85 acres	0.1924%	<i>n/a</i>
<u>OIL & GAS OWNERSHIP</u>			
(1) Cynthia P. Deel Rife P.O. Box 880 Vansant, VA 24656 <i>(Previously owned by Gladys Price)</i>	0.85 acres	0.1924%	<i>n/a</i>

Exhibit EE
 VP8 - Sealed Gob Unit #5
 VP8SGU5
 Docket #VGOB 07-1113-2083-03
 List of all Owners with Royalty Splits/Court Orders/HB2058
 (441.90 Acres)

	Acres in Unit	Percent of Unit	Percent of Escrow
<u>Tract #4E(2) - 0.26 acres</u>			
<u>COAL OWNERSHIP</u>			
(1) H-W Financial, LLC <i>OXY Tr 27 / Big Axe Tr 13 (200.00 acre tract)</i> P.O. Box 11000 Danville, VA 24543	0.26 acres	0.0588%	<i>n/a</i>
<u>OIL & GAS OWNERSHIP</u>			
(1) Cynthia P. Deel Rife P.O. Box 880 Vansant, VA 24656 <i>(Previously owned by Walter Price)</i>	0.26 acres	0.0588%	<i>n/a</i>
<u>Tract #4F - 0.79 acres</u>			
<u>COAL OWNERSHIP</u>			
(1) H-W Financial, LLC <i>OXY Tr 27 / Big Axe Tr 13 (200.00 acre tract)</i> P.O. Box 11000 Danville, VA 24543	0.79 acres	0.1788%	<i>n/a</i>
<u>OIL & GAS OWNERSHIP</u>			
(1) William E. Rife, et ux. 3451 Deskins Road Vansant, VA 24656 <i>(Previously owned by Gladys Price)</i>	0.79 acres	0.1788%	<i>n/a</i>
<u>Tract #4G - 0.84 acres</u>			
<u>COAL OWNERSHIP</u>			
(1) H-W Financial, LLC <i>OXY Tr 27 / Big Axe Tr 13 (200.00 acre tract)</i> P.O. Box 11000 Danville, VA 24543	0.84 acres	0.1901%	<i>n/a</i>
<u>OIL & GAS OWNERSHIP</u>			
(1) Janet Brown, et vir. 1132 Valance Drive Vansant, VA 24656 <i>(Previously owned by Gladys Price)</i>	0.84 acres	0.1901%	<i>n/a</i>
<u>Tract #4H - 2.73 acres</u>			
<u>COAL OWNERSHIP</u>			
(1) H-W Financial, LLC <i>OXY Tr 27 / Big Axe Tr 13 (200.00 acre tract)</i> P.O. Box 11000 Danville, VA 24543	2.73 acres	0.6178%	<i>n/a</i>
<u>OIL & GAS OWNERSHIP</u>			
(1) Janet Brown, et vir. 1132 Valance Drive Vansant, VA 24656 <i>(Previously owned by Walter & Gladys Price)</i>	2.73 acres	0.6178%	<i>n/a</i>
<u>Tract #4I - 12.48 acres</u>			
<u>COAL OWNERSHIP</u>			

Exhibit EE
 VP8 - Sealed Gob Unit #5
 VP8SGU5
 Docket #VGOB 07-1113-2083-03
 List of all Owners with Royalty Splits/Court Orders/HB2058
 (441.90 Acres)

	Acres in Unit	Percent of Unit	Percent of Escrow
(1) H-W Financial, LLC <i>OXY Tr 27 / Big Axe Tr 13 (200.00 acre tract)</i> P.O. Box 11000 Danville, VA 24543	12.48 acres	2.8242%	<i>n/a</i>

OIL & GAS OWNERSHIP

(1) Theresa H. Brents 713 Churchman's Mill Road Stuarts Draft, VA 24477	12.48 acres	2.8242%	54.4503% Court Order
---	-------------	---------	--------------------------------

*Prevailing plaintiff under Case No. CL12-387
 Awarded 100% of the CBM royalty.*

Represented by T. Shea Cook

Tract #5 - 18.63 acres

COAL OWNERSHIP

*Geo. W. Mullins Heirs, Devisees,
 Successors or Assigns (39.00 acre Coal tract - WB 3/356)*

T.R. Mullins, et al.	18.63 acres	4.2159%	
(1) Theodore A. Mullins Heirs, Devisees, Successors or Assigns			
(a) Theodore Blaine Mullins 1468 Rock Cliff Drive, Apt #3 Martinsburg, WV 25401	2.07 acres 1/9 of 18.63 acres	0.46843%	<i>n/a</i>
(b) Cornelia Maurice Mullins P.O. Box 51 Clendenin, WV 25045	2.07 acres 1/9 of 18.63 acres	0.46843%	<i>n/a</i>
(c) Marilyn Mullins 19107 Park Place Blvd. Eustis, FL 32736	2.07 acres 1/9 of 18.63 acres	0.46843%	<i>n/a</i>
(2) John L. & Lucille M. Mullins Sr. Heirs, Devisees, Successors or Assigns			
(a) George W. Mullins, Sr. 165 Muller Road Cottageville WV 25239	1.55 acres 1/12 of 18.63 acres	0.35132%	<i>n/a</i>
(b) Joann Barker Heirs, Devisees, Successors or Assigns			
(b.1) Robert Barker Heirs, Devisees, Successors or Assigns			
(b.1.1) Thomas J. Barker 13658 NW 172 Ave Alachua, FL 32615-4453	0.39 acres 1/48 of 18.63 acres	0.0878%	<i>n/a</i>
(b.1.2) Timothy J. Barker 3854 Hampton Crest Lane Kennesaw, GA 30152-6990	0.39 acres 1/48 of 18.63 acres	0.0878%	<i>n/a</i>
(b.1.3) Elizabeth Barker 7745 Lupine Drive Blacklick, OH 43004-8062	0.39 acres 1/48 of 18.63 acres	0.0878%	<i>n/a</i>
(b.1.4) Jennifer Marie Wheeler 2151 Eastover Lane Miamisburg, OH 45342-5299	0.39 acres 1/48 of 18.63 acres	0.0878%	<i>n/a</i>

Exhibit EE
 VP8 - Sealed Gob Unit #5
 VP8SGU5
 Docket #VGOB 07-1113-2083-03
 List of all Owners with Royalty Splits/Court Orders/HB2058
 (441.90 Acres)

	Acres in Unit	Percent of Unit	Percent of Escrow
(c) John L. Mullins, Jr. Heirs, Devisees, Successors or Assigns (1/12)			
(c.1) Stephanie Mullins-Williams 1701 Sir John Court Orlando, FL 32837	0.39 acres 1/48 of 18.63 acres	0.0878%	<i>n/a</i>
(c.2) John David Mullins 2209 Falls Circle Vero Beach, FL 32967	0.39 acres 1/48 of 18.63 acres	0.0878%	<i>n/a</i>
(c.3) Barndon Overton Mullins 2736 Tolman Avenue, SE Palm Bay, FL 32909	0.39 acres 1/48 of 18.63 acres	0.0878%	<i>n/a</i>
(c.4) Heather L. Dawson 2016 Neveah Street NW Palm Bay, FL 32907	0.39 acres 1/48 of 18.63 acres	0.0878%	<i>n/a</i>
(d) Thomas L. Mullins 1394 Poca River Road South Poca, WV 25159	1.55 acres 1/12 of 18.63 acres	0.3513%	<i>n/a</i>
(3) Augustus C. Mullins Heirs, Devisees, Successors or Assigns (1/3)			
(a) Madeline Mullins Heirs, Devisees, Successors or Assigns (1/3)			
(a.1) Madeline Hunt P.O. Box 7305 Zephyrhills, FL 33543	6.21 acres 1/3 of 18.63 acres	1.4053%	<i>n/a</i>
<u>OIL & GAS OWNERSHIP</u>			
(1) Bobby Henry Craig Jackson, et al. <i>(p/o 46.64 acre SOG Tract)</i>	18.63 acres	4.2159%	
(a) Bobby H.C. Jackson and Tracy Jackson ** P.O. Box 872 Lester Prairie, MN 55354 <i>** NOTE: Joint Tenants with Rights of Survivorship</i>	6.21 acres 1/3 of 18.63 acres	1.4053%	<i>n/a</i>
(b) Bobby H.C. Jackson and Tracy Jackson ** P.O. Box 872 Lester Prairie, MN 55354 <i>** NOTE: Joint Tenants with Rights of Survivorship</i> Represented by T. Shea Cook as to 2/3 interest	12.42 acres 2/3 of 18.63 acres	2.8106%	<i>n/a</i>
(c) Lawrence Jackson P.O. Box 376 Vansant, VA 24656			<i>Ownership subject to a Life Estate reservation deeded July 1994</i>
<u>Tract #7A - 0.32 acres</u>			
<u>COAL OWNERSHIP</u>			
(1) H-W Financial, LLC <i>OXY Tr 24 / Big Axe Tr 11 (336.00 acre tract)</i> P.O. Box 11000 Danville, VA 24543	0.32 acres	0.0724%	<i>n/a</i>
<u>OIL & GAS OWNERSHIP</u>			
(1) CNX Gas Company LLC 1000 Consol Energy Drive Caronsburg, PA 15317 <i>(Previously Island Creek Coal Company - p/o 6.35 acre SOG)</i>	0.32 acres	0.0724%	<i>n/a</i>

Exhibit EE
 VP8 - Sealed Gob Unit #5
 VP8SGU5
 Docket #VGOB 07-1113-2083-03
 List of all Owners with Royalty Splits/Court Orders/HB2058
 (441.90 Acres)

	Acres in Unit	Percent of Unit	Percent of Escrow
<u>Tract #7B - 0.85 acres</u>			
<u>COAL OWNERSHIP</u>			
(1) H-W Financial, LLC <i>OXY Tr 24 / Big Axe Tr 11 (336.00 acre tract)</i> P.O. Box 11000 Danville, VA 24543	0.85 acres	0.1924%	<i>n/a</i>
<u>OIL & GAS OWNERSHIP</u>			
(1) CNX Gas Company LLC 1000 Consol Energy Drive Canonsburg, PA 15317 <i>(Previously Island Creek Coal Company - p/o 8.45 acre SOG)</i>	0.85 acres	0.1924%	<i>n/a</i>
<u>Tract #7C - 23.46 acres</u>			
<u>COAL OWNERSHIP</u>			
(1) H-W Financial, LLC <i>OXY Tr 24 / Big Axe Tr 11 (336.00 acre tract)</i> P.O. Box 11000 Danville, VA 24543	23.46 acres	5.3089%	<i>n/a</i>
<u>OIL & GAS OWNERSHIP</u>			
(1) CNX Gas Company LLC 1000 Consol Energy Drive Canonsburg, PA 15317 <i>(Previously Island Creek Coal Company - p/o 65.00 acre SOG)</i>	23.46 acres	5.3089%	<i>n/a</i>
<u>Tract #7D - 23.51 acres</u>			
<u>COAL OWNERSHIP</u>			
(1) H-W Financial, LLC <i>OXY Tr 24 / Big Axe Tr 11 (336.00 acre tract)</i> P.O. Box 11000 Danville, VA 24543	23.51 acres	5.3202%	<i>n/a</i>
<u>OIL & GAS OWNERSHIP</u>			
(1) CNX Gas Company LLC 1000 Consol Energy Drive Canonsburg, PA 15317 <i>(Previously Island Creek Coal Company - p/o 65.00 acre SOG)</i>	23.51 acres	5.3202%	<i>n/a</i>
<u>Tract #7E - 1.08 acres</u>			
<u>COAL OWNERSHIP</u>			
(1) H-W Financial, LLC <i>OXY Tr 24 / Big Axe Tr 11 (336.00 acre tract)</i> P.O. Box 11000 Danville, VA 24543	1.08 acres	0.2444%	<i>n/a</i>
<u>OIL & GAS OWNERSHIP</u>			
(1) CNX Gas Company LLC 1000 Consol Energy Drive Canonsburg, PA 15317 <i>(Previously Island Creek Coal Company - p/o 65.00 acre SOG)</i>	1.08 acres	0.2444%	<i>n/a</i>
<u>TOTAL RESOLVED:</u>			
	Acreage in Unit	398.4800	
	Percentage of Unit	90.1742%	

T. Shea Cook, P.C.

ATTORNEY AT LAW

2411 Second Street

Post Office Box 507

Richlands, Virginia 24641

Phone (276) 963-4332--Facsimile (276) 963-6271

tsheacook@yahoo.com

ATTORNEY FEE AGREEMENT

I have retained T. Shea Cook, P.C., to establish my gas rights and recover all funds held in escrow by EQT, CNX Gas Company, LLC or the VGOB.

Agreed:

Theresa H. Brento
Client

1/16/15
Date

Accepted:

T. Shea Cook
T. Shea Cook

1-16-15
Date

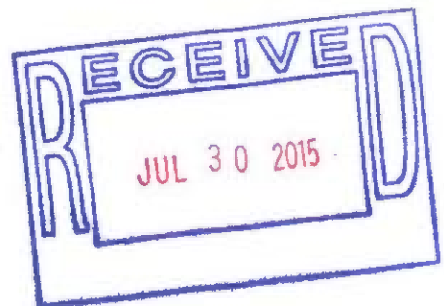

The above described tracts within the named units are referred to in this Order as the ("Subject Properties").

It is further; **Adjudged, Ordered and Decreed** that the Defendant, Harrison-Wyatt, LLC is not entitled to any royalties relating to the extraction of coal-bed methane gas by CNX Gas, LLC from the Subject Properties, and that it is not a conflicting claimant to the ownership of the CBM or the production royalties as identified in submissions made to, and orders entered by, the Virginia Gas and Oil Board with respect to the Subject Properties.

The Defendant's motion for a bill of particulars and demurrer are denied. All other claims asserted by either party against the other are denied, and this action is stricken from the docket of this Court with prejudice to the Plaintiff and Defendant as to any such other claims.

ENTER: This, the 5th day February, 2015.



MICHAEL L. MOORE
~~KEARY R. WILLIAMS~~, JUDGE

REQUESTED:



Counsel for Defendant, HARRISON-WYATT, LLC

SEEN AND AGREED:

NO LONGER A PARTY

Counsel for Defendant CNX GAS, LLC,
DAVID ALTIZER, ESQ.

SEEN:

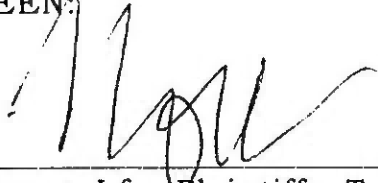

Counsel for Plaintiffs, T. SHEA COOK, ESQ.