

BEFORE THE VIRGINIA GAS AND OIL BOARD

PETITIONER: CNX Gas Company LLC

DIVISION OF GAS AND OIL

DOCKET NO: VGOB 98-1117-0697-05

RELIEF SOUGHT: (1) DISBURSEMENT FROM ESCROW REGARDING TRACT(S) 11, 12, 13, 30, 34, 35, A portion of 36A, 52 (2) AND AUTHORIZATION FOR DIRECT PAYMENT OF ROYALTIES (3) AND DISMISSAL OF COAL OWNERS PURSUANT TO CODE OF VIRGINIA SECTION 45.1-361.22:2.

HEARING DATE: December 19, 2017

DRILLING UNIT: BUCH1SGU1

BUCHANAN COUNTY, VIRGINIA

PETITION FOR ORDER OF DISBURSEMENT OF ESCROW FUNDS

1. Petitioner and its counsel

Petitioner is CNX Gas Company LLC, PO Box 570, Pounding Mill, VA 24637, (276)596-5075. Petitioner's counsel is Mark A. Swartz, Hillard & Swartz, LLP, 122 Capital Street, Suite 201, Charleston, WV 25301.

2. Relief Sought

(1) the disbursement of escrowed funds heretofore deposited with the Board's Escrow Agent(s) attributable to of Tracts 11, 12, 13, 30, 34, 35, 52 and a portion of Tract 36A, as depicted upon the annexed table; and (2) authorization to begin paying royalties directly to Arnold Keen, Carl Hale, Burns & Nancy Mullins, Rebecca Ritchie, John Ratliff, Michael Hess, Beth Underhill, David Hess, Jeff Jackson, Julia Jackson, Tamara Altizer, Bobby Steele, James D. Steele, Judy Horne, Cleo Preskewitz, Dawn McElfresh, Gaynell Fry, Ruth Virginia Lowe, Carol Pocock, Patricia Darlene Drudge, Jeanne Garrett, Yvonne White, Debra Estes, Lonnie Honaker, Sylvia McGlothlin, Charlotte Robinette, Ell See Ferrell, Teddy Ferrell, Michael Ellis Wilkes, Janet Willett, Coal Mountain Mining Co, LLC, Delores Estep, Darlene Bradley, Diana Asbury, Roy E. Keen, Ralph D. Keen, Andy Keen and Randy Keen.

3. Legal Authority

Va. Code Ann. § 45.1-361.1 et seq., 4 VAC 25-160-140., and relevant Virginia Gas and Oil Board Orders ("Board") heretofore promulgated pursuant to law.

4. Type of Well(s)

Sealed Gob Unit

5. Factual basis for relief requested

- a. Arnold Keen, Carl Hale, Burns & Nancy Mullins, Rebecca Ritchie, John Ratliff, Michael Hess, Beth Underhill, David Hess, Jeff Jackson, Julia Jackson, Tamara Altizer, Bobby Steele, James D. Steele, Judy Horne, Cleo Preskewitz, Dawn McElfresh, Gaynell Fry, Ruth Virginia Lowe, Carol Pocock, Patricia Darlene Drudge, Jeanne Garrett, Yvonne White, Debra Estes, Lonnie Honaker, Sylvia McGlothlin, Charlotte Robinette, Eil See Ferrell, Teddy Ferrell, Michael Ellis Wilkes, Janet Willett, Coal Mountain Mining Co, LLP, Delores Estep, Darlene Bradley, Diana Asbury, Roy E. Keen, Ralph D. Keen, Andy Keen, and Randy Keen are the gas claimants in a 11, 12, 13, 30, 34, 35, portion of 36A, & 52 . As such Arnold Keen, Carl Hale, Burns & Nancy Mullins, Rebecca Ritchie, John Ratliff, Michael Hess, Beth Underhill, David Hess, Jeff Jackson, Julia Jackson, Tamara Altizer, Bobby Steele, James D. Steele, Judy Horne, Cleo Preskewitz, Dawn McElfresh, Gaynell Fry, Ruth Virginia Lowe, Carol Pocock, Patricia Darlene Drudge, Jeanne Garrett, Yvonne White, Debra Estes, Lonnie Honaker, Sylvia McGlothlin, Charlotte Robinette, Eil See Ferrell, Teddy Ferrell, Michael Ellis Wilkes, Janet Willett, Coal Mountain Mining Co, LLP, Delores Estep, Darlene Bradley, Diana Asbury, Roy E. Keen, Ralph D. Keen, Andy Keen, and Randy Keen are entitled to 100% of the CBM royalties attributable to their gas claims that are now in escrow and as may be hereafter payable. See Va. Code Ann. § 45.1-361.22:2.A.
- b. That CNX Gas Company LLC has previously given the notice(s) required by § 45.1-361.22:2.A to all conflicting coal claimants identified in the above referenced pooling Order and any supplemental Orders pertaining thereto.
- c. That when the Board granted Petitioner's Miscellaneous Petition in VGOB 98-1117-0697-04, it dismissed the coal claimant(s) Hugh MacRae Land Trust (Torch Oil & Gas), Rockport Oil & Gas, and Chisos, LTD as a Respondent to these proceedings. Accordingly, Hugh MacRae Land Trust (Torch Oil & Gas), Rockport Oil & Gas, and Chisos, LTD was not provided further notice under § 45.1-361.19 and 22 of the hearing set on this Petition.
- d. That a detailed accounting in accordance with the applicable provisions of § 45.1-361.22 is submitted herewith and identified as Exhibit J.
- e. That an Exhibit identified as Table 1 is annexed hereto, and it specifies how the disbursement (s) is to be calculated and paid by the escrow agent.
- f. That Va. Code Ann. § 45.1-361.22:2.A. further provides that the Operator shall pay such royalties as may hereafter be payable directly to the gas claimant Arnold Keen, Carl Hale, Burns & Nancy Mullins, Rebecca Ritchie, John Ratliff, Michael Hess, Beth Underhill, David Hess, Jeff Jackson, Julia Jackson, Tamara Altizer, Bobby Steele, James D. Steele, Judy Horne, Cleo Preskewitz, Dawn McElfresh, Gaynell Fry, Ruth Virginia Lowe, Carol Pocock, Patricia Darlene Drudge, Jeanne Garrett, Yvonne White, Debra Estes, Lonnie Honaker, Sylvia McGlothlin, Charlotte Robinette, Eil See Ferrell, Teddy Ferrell, Michael Ellis Wilkes, Janet Willett, Coal Mountain Mining Co, LLP, Delores Estep, Darlene Bradley, Diana Asbury, Roy E. Keen, Ralph D. Keen, Andy Keen, and Randy Keen and shall not escrow same. See Exhibit EE annexed hereto.

6. Attestation

The foregoing Petition to the best of my knowledge, information, and belief is true and correct.

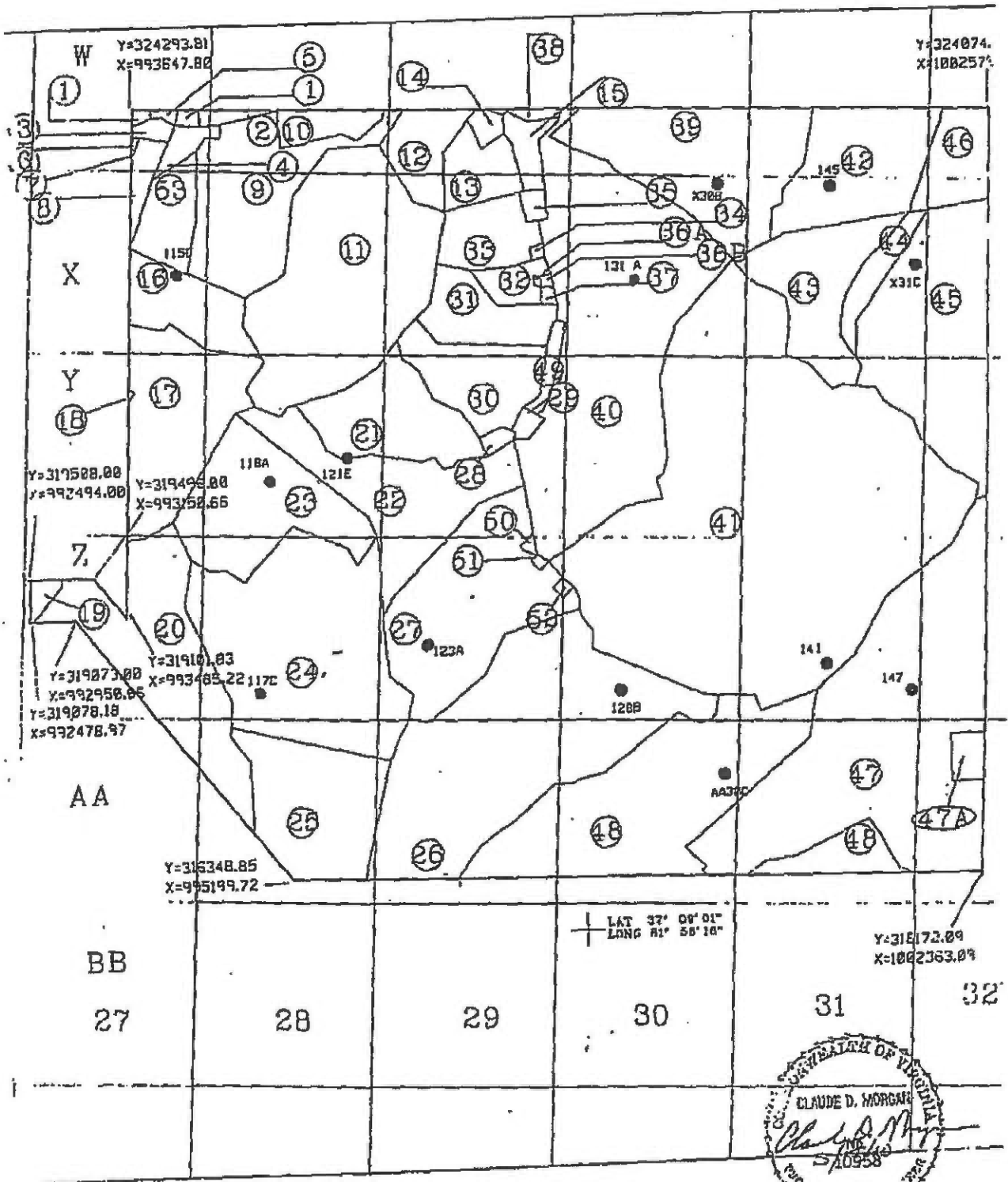
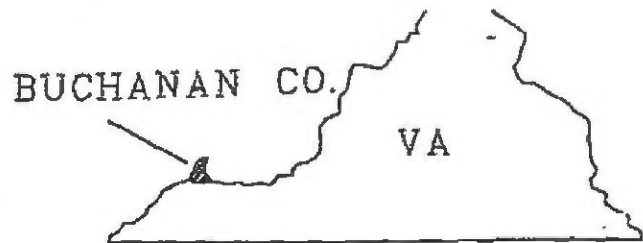

6

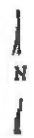

EXHIBIT A
VGOB-98-1117-0697-0

**POCAHONTAS GAS PARTNERSHIP
BUCHANAN #1 SOUTH SGU
Tract Identifications**

1. Hugh MacRae Land Trust - TR 17 - Coal
Coal Lessees
Permac, Inc.
Consolidation Coal Company
United Coal Company
Pocahontas Gas Partnership - CBM Lessee
Pocahontas Gas Partnership - Oil & Gas
1.50 acres 0.09431%

2. Hugh MacRae Land Trust - TR 17 - Coal
Coal Lessees
Permac, Inc.
Consolidation Coal Company
United Coal Company
Pocahontas Gas Partnership - Oil & Gas Lessee
Pocahontas Gas Partnership - CBM Lessee
Ernest Addison Helms - Oil & Gas
1.95 acres 0.12261%

3. Hugh MacRae Land Trust - TR 17 - Coal
Coal Lessees
Permac, Inc.
Consolidation Coal Company
United Coal Company
Pocahontas Gas Partnership - CBM Lessee
Consolidation Coal Company - Oil & Gas
1.83 acres 0.11506%

4. Hugh MacRae Land Trust - TR 17 - Coal
Coal Lessees
Permac, Inc.
Consolidation Coal Company
United Coal Company
Pocahontas Gas Partnership - CBM Lessee
Consolidation Coal Company - Oil & Gas
3.72 acres 0.23390%

5. Hugh MacRae Land Trust - TR 17 - Coal
Coal Lessees
Permac, Inc.
Consolidation Coal Company
United Coal Company
Pocahontas Gas Partnership - CBM Lessee
Pocahontas Gas Partnership - Oil & Gas Lessee
Jackie Meadows - Oil & Gas
0.72 acres 0.04527%

**POCAHONTAS GAS PARTNERSHIP
BUCHANAN #1 SOUTH SGU
Tract Identifications**

6. Hugh MacRae Land Trust - TR 17 - Coal
Coal Lessees
Permac, Inc.
Consolidation Coal Company
United Coal Company
Pocahontas Gas Partnership - CBM Lessee
Consolidation Coal Company - Oil & Gas
0.17 acres 0.01069%

7. Hugh MacRae Land Trust - TR 17 - Coal
Coal Lessees
Permac, Inc.
Consolidation Coal Company
United Coal Company
Pocahontas Gas Partnership - CBM Lessee
Consolidation Coal Company - Oil & Gas
0.08 acres 0.00503%

8. Hugh MacRae Land Trust - TR 17 - Coal
Coal Lessees
Permac, Inc.
Consolidation Coal Company
United Coal Company
Pocahontas Gas Partnership - CBM Lessee
Consolidation Coal Company - Oil & Gas
4.55 acres 0.28608%

9. Hugh MacRae Land Trust - TR 17 - Coal
Coal Lessees
Permac, Inc.
Consolidation Coal Company
United Coal Company
Pocahontas Gas Partnership - CBM Lessee
Consolidation Coal Company - Oil & Gas
48.15 acres 3.02746%

10. Hugh MacRae Land Trust - TR 17 - Coal
Coal Lessees
Permac, Inc.
Consolidation Coal Company
United Coal Company
Pocahontas Gas Partnership - CBM Lessee
Pocahontas Gas Partnership - Oil & Gas
7.33 acres 0.46088%



**POCAHONTAS GAS PARTNERSHIP
BUCHANAN #1 SOUTH SGU
Tract Identifications**

11. Hugh MacRae Land Trust - TR 2 - Coal
Coal Lessees
Permac, Inc.
Consolidation Coal Company
United Coal Company
Pocahontas Gas Partnership - Oil & Gas Lessee
Pocahontas Gas Partnership - CBM Lessee
Ernest Keen Heirs - Oil & Gas
81.53 acres 5.12625%

12. Hugh MacRae Land Trust - TR 17 - Coal
Coal Lessees
Permac, Inc.
Consolidation Coal Company
United Coal Company
Pocahontas Gas Partnership - Oil & Gas Lessee
Pocahontas Gas Partnership - CBM Lessee
Ernest Keen Heirs - Oil & Gas
12.69 acres 0.79789%

13. Hugh MacRae Land Trust - TR 17 - Coal
Coal Lessees
Permac, Inc.
Consolidation Coal Company
United Coal Company
Pocahontas Gas Partnership - Oil & Gas Lessee
Pocahontas Gas Partnership - CBM Lessee
Glen Rose - Oil & Gas
10.92 acres 0.68660%

14. Hugh MacRae Land Trust - TR 17 - Coal
Coal Lessees
Permac, Inc.
Consolidation Coal Company
United Coal Company
Pocahontas Gas Partnership - CBM Lessee
Pocahontas Gas Partnership - Oil & Gas
1.57 acres 0.09871%

15. Yukon Pocahontas Coal Company et al Tr 50-2 - Coal, Oil & Gas
Coal Lessees
Permac, Inc.
Consolidation Coal Company
Pocahontas Gas Partnership - CBM Lessee
8.49 acres 0.53381%

9

POCAHONTAS GAS PARTNERSHIP
BUCHANAN #1 SOUTH SGU
Tract Identifications

16. Hugh MacRae Land Trust - TR 17 - Coal
Coal Lessees
Permac, Inc.
Consolidation Coal Company
United Coal Company
Pocahontas Gas Partnership - CBM Lessee
Pocahontas Gas Partnership - Oil & Gas
19.18 acres 1.20596%

17. Hugh MacRae Land Trust - TR 17 - Coal
Coal Lessees
Permac, Inc.
Consolidation Coal Company
United Coal Company
Pocahontas Gas Partnership - CBM Lessee
Consolidation Coal Company - Oil & Gas
48.86 acres 3.07211%

18. Hugh MacRae Land Trust - TR 17 - Coal
Coal Lessees
Permac, Inc.
Consolidation Coal Company
United Coal Company
Pocahontas Gas Partnership - CBM Lessee
Consolidation Coal Company - Oil & Gas
0.11 acres 0.00692%

19. Hugh MacRae Land Trust - TR 21 - Coal, Oil & Gas -
Coal Lessees
Permac, Inc.
Consolidation Coal Company
United Coal Company
Pocahontas Gas Partnership - Oil & Gas Lessee
Pocahontas Gas Partnership - CBM Lessee
2.04 acres 0.12827%

20. Hugh MacRae Land Trust - TR 21A - Coal, Oil & Gas
Coal Lessees
Permac, Inc.
Consolidation Coal Company
United Coal Company
Pocahontas Gas Partnership - Oil & Gas Lessee
Pocahontas Gas Partnership - CBM Lessee
54.47 acres 3.42484%

10

**POCAHONTAS GAS PARTNERSHIP
BUCHANAN #1 SOUTH SGU
Tract Identifications**

- 21. Hugh MacRae Land Trust - TR 5 - Coal
Coal Lessees
Permac, Inc.
Consolidation Coal Company
United Coal Company
Pocahontas Gas Partnership - CBM Lessee
Pocahontas Gas Partnership - Oil & Gas
18.55 acres 1.16634%

- 22. Hugh MacRae Land Trust - TR 5 - Coal
Coal Lessees
Permac, Inc.
Consolidation Coal Company
United Coal Company
Pocahontas Gas Partnership - Oil & Gas Lessee
Pocahontas Gas Partnership - CBM Lessee
Thurman Wade - Oil & Gas
41.05 acres 2.58105%

- 23. Hugh MacRae Land Trust - TR 5 - Coal
Coal Lessees
Permac, Inc.
Consolidation Coal Company
United Coal Company
Pocahontas Gas Partnership - CBM Lessee
Pocahontas Gas Partnership - Oil & Gas
42.57 acres 2.67662%

- 24. Hugh MacRae Land Trust - TR 5 - Coal
Coal Lessees
Permac, Inc.
Consolidation Coal Company
United Coal Company
Pocahontas Gas Partnership - Oil & Gas Lessee
Pocahontas Gas Partnership - CBM Lessee
Coal Mountain Mining - Oil & Gas
79.56 acres 5.00239%

- 25. Coal Mountain Mining - TR 2 - Coal, Oil & Gas
Coal Lessees
Permac, Inc.
Consolidation Coal Company
United Coal Company
Pocahontas Gas Partnership - Oil & Gas Lessee
Pocahontas Gas Partnership - CBM Lessee
40.23 acres 2.52949%

**POCAHONTAS GAS PARTNERSHIP
BUCHANAN #1 SOUTH SGU
Tract Identifications**

26. Coal Mountain Mining - TR 6 - Coal, Oil & Gas
Coal Lessees
Permac, Inc.
Consolidation Coal Company
United Coal Company
Pocahontas Gas Partnership - Oil & Gas Lessee
Pocahontas Gas Partnership - CBM Lessee
106.39 acres 6.68934%
27. Coal Mountain Mining - TR 14 - Coal
Coal Lessees
Permac, Inc.
Consolidation Coal Company
United Coal Company
Pocahontas Gas Partnership - Oil & Gas Lessee
Pocahontas Gas Partnership - CBM Lessee
Ernest Keen Heirs - Oil & Gas
57.61 acres 3.62227%
28. Hugh MacRae Land Trust - TR 5 - Coal
Coal Lessees
Permac, Inc.
Consolidation Coal Company
United Coal Company
Pocahontas Gas Partnership - CBM Lessee
Pocahontas Gas Partnership - Oil & Gas Lessee
Winfred Wade - Oil & Gas
1.27 acres 0.07985%
29. Hugh MacRae Land Trust - TR 5 - Coal
Coal Lessees
Permac, Inc.
Consolidation Coal Company
United Coal Company
Pocahontas Gas Partnership - CBM Lessee
Pocahontas Gas Partnership - Oil & Gas Lessee
Agnes Deskins - Oil & Gas
1.34 acres 0.08425%
30. Hugh MacRae Land Trust - TR 17 - Coal
Coal Lessees
Permac, Inc.
Consolidation Coal Company
United Coal Company
Pocahontas Gas Partnership - CBM Lessee
Pocahontas Gas Partnership - Oil & Gas Lessee
Earl Marshall Heirs - Oil & Gas
20.06 acres 1.26129%

POCAHONTAS GAS PARTNERSHIP
BUCHANAN #1 SOUTH SGU
Tract Identifications

31. Hugh MacRae Land Trust - TR 17 - Coal
Coal Lessees
Permac, Inc.
Consolidation Coal Company
United Coal Company
Pocahontas Gas Partnership - CBM Lessee
Pocahontas Gas Partnership - Oil & Gas
19.31 acres 1.21413%
32. Hugh MacRae Land Trust - TR 17 - Coal
Coal Lessees
Permac, Inc.
Consolidation Coal Company
United Coal Company
Pocahontas Gas Partnership - CBM Lessee
Julius Rowe - Oil & Gas
6.64 acres 0.41749%
33. Hugh MacRae Land Trust - TR 17 - Coal
Coal Lessees
Permac, Inc.
Consolidation Coal Company
United Coal Company
Pocahontas Gas Partnership - CBM Lessee
Pocahontas Gas Partnership - Oil & Gas Lessee
Bobby Steele - Oil & Gas
19.07 acres 1.19904%
34. Hugh MacRae Land Trust - TR 17 - Coal
Coal Lessees
Permac, Inc.
Consolidation Coal Company
United Coal Company
Pocahontas Gas Partnership - CBM Lessee
Pocahontas Gas Partnership - Oil & Gas Lessee
Grady Horn - Oil & Gas
0.77 acres 0.04841%
35. Hugh MacRae Land Trust - TR 17 - Coal
Coal Lessees
Permac, Inc.
Consolidation Coal Company
United Coal Company
Pocahontas Gas Partnership - CBM Lessee
Pocahontas Gas Partnership - Oil & Gas Lessee
Ruth Steele - Oil & Gas
1.78 acres 0.11192%

**POCAHONTAS GAS PARTNERSHIP
BUCHANAN #1 SOUTH SGU
Tract Identifications**

- 36A. Hugh MacRae Land Trust - TR 17 - Coal
Coal Lessees
Permac, Inc.
Consolidation Coal Company
United Coal Company
Pocahontas Gas Partnership - CBM Lessee
A. Ferrell Heirs - Oil & Gas
0.11 acres 0.00692%
- 36B. Hugh MacRae Land Trust - TR 17 - Coal
Coal Lessees
Permac, Inc.
Consolidation Coal Company
United Coal Company
Pocahontas Gas Partnership - CBM Lessee
Nancy Rose - Oil & Gas
0.26 acres 0.01635%
37. Hugh MacRae Land Trust - TR 17 - Coal
Coal Lessees
Permac, Inc.
Consolidation Coal Company
United Coal Company
Pocahontas Gas Partnership - CBM Lessee
Pocahontas Gas Partnership - Oil & Gas
0.64 acres 0.04024%
38. Coal Mountain Mining - TR 24 - Coal
Coal Lessees
Permac, Inc.
Consolidation Coal Company
United Coal Company
Pocahontas Gas Partnership - CBM Lessee
Pocahontas Gas Partnership - Oil & Gas Lessee
Garden Realty Corporation - Oil & Gas
1.56 acres 0.09809%
39. Coal Mountain Mining - TR 17 - Coal
Coal Lessees
Permac, Inc.
Consolidation Coal Company
United Coal Company
Pocahontas Gas Partnership - CBM Lessee
Yukon Pocahontas et al Tr 112 - Oil & Gas
55.74 acres 3.50469%

14

POCAHONTAS GAS PARTNERSHIP
BUCHANAN #1 SOUTH SGU
Tract Identifications

40. Coal Mountain Mining - TR 19 - Coal, Oil & Gas
Coal Lessees
Permac, Inc.
Consolidation Coal Company
United Coal Company
Pocahontas Gas Partnership - CBM Lessee
Pocahontas Gas Partnership - Oil & Gas Lessee
122.60 acres 7.70856%
41. Coal Mountain Mining - TR 9A - Coal, Oil & Gas
Coal Lessees
Permac, Inc.
Consolidation Coal Company
United Coal Company
Pocahontas Gas Partnership - CBM Lessee
Pocahontas Gas Partnership - Oil & Gas Lessee
248.27 acres 15.61015%
42. Coal Mountain Mining - TR 23 - Coal
Coal Lessees
Permac, Inc.
Consolidation Coal Company
United Coal Company
Pocahontas Gas Partnership - CBM Lessee
Pocahontas Gas Partnership - Oil & Gas Lessee
Terry Baldwin - Oil & Gas
37.15 acres 2.33583%
43. Coal Mountain Mining - TR 5 - Coal
Coal Lessees
Permac, Inc.
Consolidation Coal Company
United Coal Company
Pocahontas Gas Partnership - CBM Lessee
Pocahontas Gas Partnership - Oil & Gas Lessee
Terry Baldwin - Oil & Gas
31.48 acres 1.97933%
44. Coal Mountain Mining - TR 5 - Coal
Coal Lessees
Permac, Inc.
Consolidation Coal Company
United Coal Company
Pocahontas Gas Partnership - CBM Lessee
Pocahontas Gas Partnership - Oil & Gas Lessee
Gary Davis et al - Oil & Gas
7.88 acres 0.49546%

**POCAHONTAS GAS PARTNERSHIP
BUCHANAN #1 SOUTH SGU
Tract Identifications**

45. Coal Mountain Mining - TR 5 - Coal
Coal Lessees
Permac, Inc.
Consolidation Coal Company
United Coal Company
Pocahontas Gas Partnership - CBM Lessee
Pocahontas Gas Partnership - Oil & Gas Lessee
Gary Davis et al - Oil & Gas
65.40 acres 4.11207%
46. Hurt McGuire Land Trust - Coal, Oil & Gas
Coal Lessees
Permac, Inc.
Consolidation Coal Company
United Coal Company
Pocahontas Gas Partnership - CBM Lessee
Pocahontas Gas Partnership - Oil & Gas Lessee
15.21 acres 0.95634%
47. Coal Mountain Mining - TR 7 - Coal, Oil & Gas
Coal Lessees
Permac, Inc.
Consolidation Coal Company
United Coal Company
Pocahontas Gas Partnership - CBM Lessee
Pocahontas Gas Partnership - Oil & Gas Lessee
128.74 acres 8.09461%
- 47A. John Astor Rife - Coal, Oil & Gas
Coal Lessees
Consolidation Coal Company - Pocahontas No. 3 Seam Lessee
Island Creek Coal Company
United Coal Company
Pocahontas Gas Partnership - CBM Lessee
3.98 acres 0.25025%
48. Coal Mountain Mining - TR 9 - Coal, Oil & Gas
Coal Lessees
Permac, Inc.
Consolidation Coal Company
United Coal Company
Pocahontas Gas Partnership - CBM Lessee
Pocahontas Gas Partnership - Oil & Gas Lessee
88.90 acres 5.58965%
49. Consolidation Coal Company - Coal, Oil & Gas
2.99 acres 0.18800%
50. Coal Mountain Mining - TR 24 - Coal
Coal Lessees
Permac, Inc.
Consolidation Coal Company

14

**POCAHONTAS GAS PARTNERSHIP
BUCHANAN #1 SOUTH SGU
Tract Identifications**

United Coal Company
Pocahontas Gas Partnership - CBM Lessee
Pocahontas Gas Partnership - Oil & Gas Lessee
Roy & Ann McCowan - Oil & Gas
1.13 acres 0.07105%

51. Coal Mountain Mining - TR 14 - Coal
Coal Lessees
Permac, Inc.
Consolidation Coal Company
United Coal Company
Pocahontas Gas Partnership - CBM Lessee
Pocahontas Gas Partnership - Oil & Gas Lessee
Ann R. Lambert - Oil & Gas
0.55 acres 0.03458%

52. Coal Mountain Mining - TR 14 - Coal
Coal Lessees
Permac, Inc.
Consolidation Coal Company
United Coal Company
Pocahontas Gas Partnership - CBM Lessee
Pocahontas Gas Partnership - Oil & Gas Lessee
Ralph Keen - Oil & Gas
0.23 acres 0.01446%

53. Hugh MacRae Land Trust - TR 17 - Coal
Coal Lessees
Permac, Inc.
Consolidation Coal Company
United Coal Company
Pocahontas Gas Partnership - CBM Lessee
Consolidation Coal Company - Oil & Gas
11.56 acres 0.72684%

11

36A Tract 36A (total acreage)

0.1100

2	36A	Dawn E. McElfresh\714 W. Virginia Avenue Kokomo IN 46902	1/351	0.0003	100.00%	0.0003	0.0005%		\$0.99
3	36A	Gaynell Fry\365 Boulevard Street Peru IN 46970	2/351	0.0006	100.00%	0.0006	0.0011%		\$1.98
4	36A	Ruth V. Lowe\1307 Wabash Ave Rochester IN 46975	2/351	0.0006	100.00%	0.0006	0.0011%		\$1.98
5	36A	Carol Pocock\1148 W 6th Street Rochester IN 46975	2/351	0.0006	100.00%	0.0006	0.0011%		\$1.98
6	36A	Patricia Darlene Drudge\11018 E State Rd 14 PO Box 303 Akron IN 46910	2/351	0.0006	100.00%	0.0006	0.0011%		\$1.98
7	36A	Cleo Preskewitz\955 East 9th Street Rochester IN 46975	1/1404	0.0001	100.00%	0.0001	0.0001%		\$0.25
8	36A	Dawn E. McElfresh\714 W. Virginia Avenue Kokomo IN 46902	1/2808	0.0000	100.00%	0.0000	0.0001%		\$0.12
9	36A	Gaynell Fry\365 Boulevard Street Peru IN 46970	1/1404	0.0001	100.00%	0.0001	0.0001%		\$0.25
10	36A	Ruth V. Lowe\1307 Wabash Ave Rochester IN 46975	1/1404	0.0001	100.00%	0.0001	0.0001%		\$0.25
11	36A	Carol Pocock\1148 W 6th Street Rochester IN 46975	1/1404	0.0001	100.00%	0.0001	0.0001%		\$0.25
12	36A	Patricia Darlene Drudge\11018 E State Rd 14 PO Box 303 Akron IN 46910	1/1404	0.0001	100.00%	0.0001	0.0001%		\$0.25
13	36A	Jeanne Garrett\966 Maple Glen Drive Conover NC 28613	1/91	0.0012	100.00%	0.0012	0.0020%		\$3.81
14	36A	Yvonne White\7802 Long Island Rd Catawba NC 28609	1/91	0.0012	100.00%	0.0012	0.0020%		\$3.81
15	36A	Debra Estes\3316 6th Ave NE Conover NC 28613	1/91	0.0012	100.00%	0.0012	0.0020%		\$3.81
16	36A	Lonnie Honaker\234 Blackhills Rd Cedar Bluff VA 24609	1/91	0.0012	100.00%	0.0012	0.0020%		\$3.81
17	36A	Sylvia McGlothlin\PO Box 71 Cedar Bluff VA 24609	1/39	0.0028	100.00%	0.0028	0.0048%		\$8.90
18	36A	Charlotte Robinette\7862 Sarah Dr Denver NC 28037	1/39	0.0028	100.00%	0.0028	0.0048%		\$8.90
19	36A	Ell See Ferrell\2057 Conaway Rd Big Rock VA 24603	1/234	0.0005	100.00%	0.0005	0.0008%		\$1.48
20	36A	Teddy Ferrell\30194 Blue Spring Rd Meadowview VA 24361	1/234	0.0005	100.00%	0.0005	0.0008%		\$1.48
21	36A	Michael Ellis Wilkes\929 Hulana St Rossville GA 30741	1/65	0.0017	100.00%	0.0017	0.0029%		\$5.34
22	36A	Janet Willett\1624 Osburn Rd Chickmauga GA 30707	1/65	0.0017	100.00%	0.0017	0.0029%		\$5.34

52 Tract 52 (total acreage)

0.2300

1	52	Coal Mountain Mining Co\PO Box 675 Tazewell VA 24651		0.2300	50.00%	0.1150	0.1942%		\$362.75
2	52	Delores Estep\200 Summit Avenue Lebanon VA 24266	1/7	0.0329	50.00%	0.0164	0.0277%		\$51.82
3	52	Darlene Bradley\PO Box 503 Keen Mountain VA 24624	1/7	0.0329	50.00%	0.0164	0.0277%		\$51.82
4	52	Diana Asbury\PO Box 974 Lowell NC 28098	1/7	0.0329	50.00%	0.0164	0.0277%		\$51.82
5	52	Roy E. Keen\200 Summit Avenue Lebanon VA 24266	1/7	0.0329	50.00%	0.0164	0.0277%		\$51.82
6	52	Ralph D. Keen\PO Box 1121 Raven VA 24639	1/7	0.0329	50.00%	0.0164	0.0277%		\$51.82
7	52	Andy G. Keen\4846 Quarterwood Road Thaxton VA 24174	1/7	0.0329	50.00%	0.0164	0.0277%		\$51.82
8	52	Randy L. Keen\49 Lakeshore Terrace Hardy VA 24101	1/7	0.0329	50.00%	0.0164	0.0277%		\$51.82

Adjustment Comments: Escrow Agent will deduct exact dollar amount paid to heirs of Corbit Jackson above

Wells contributing to the escrow account: PGP 115, PGP 118, PGP 119, PGP 120 W/PL, PGP 121 W/PL, PGP 122, PGP 123, PGP 124, PGP 125, PGP 126, PGP 128, PGP 130, PGP 131, CBM-PGP-134, PGP 135, PGP 139, PGP 140, PGP SL12 141, PGP SL12 142, PGP 144, PGP 145, PGP SL12 146, PGP 147, PGP 148, PGP 151, PGP 152, PGP 114A, PGP 115A, PGP 115B, PGP 115C W/PL, PGP 115D W/PL, PGP 117A, PGP 117C W/PL, PGP 118C, PGP 120A W/PL, PGP 121A W/PL, PGP 121B W/PL, PGP 121D, PGP 121E W/PL, PGP 122A, PGP 123A W/PL, PGP 123B W/PL, PGP 124B W/PL, PGP 124C W/PL, PGP 124D, PGP 125A W/PL, PGP 128A W/PL, PGP 128B W/PL, PGP 130A W/PL, PGP 130B W/PL, PGP 131A W/PL, PGP 131D W/PL, PGP-134A W/PL, PGP 135D W/PL, PGP 139D W/PL, PGP AA30C W/PL, PGP AA31C W/PL, PGP AA31F W/PL, PGP AA31G W/PL, PGP AA31H W/PL, PGP W31A W/PL, PGP X30B W/PL, PGP X31C W/PL, CBM Y28B W/PL, PGP Y30A W/PL, PGP-Y30B W/PL, PGP Y31A W/PL, PGP Y31C W/PL, PGP Y31D W/PL, PGP Y31E W/PL, PGP Y31F W/PL, CBM Y31G W/PL, CBM Z28 W/PL, CBM Z29A W/PL, CBM Z29B W/PL, PGP Z31A W/PL, PGP Z31C W/PL, CBM Z31D

Exhibit E
 Buchanan #1 South Sealed Gob Unit 1
 Docket #VGOB 98-1117-0697-05
 List of all Owners/Claimants

	Net Acres in Unit	Interest in Unit	
Tract #5 - 0.72 Acres			
COAL OWNERSHIP			
(1) Hugh MacRae Land Trust, Tr.17 c/o Alan Siegel Esq Gump, Strauss, Akin LLP 1 Bryant Park New York, NY 10036-6715	0.72 acres	0.0453%	Dismissed under -04 petition
<i>By Assignment and Bill of Sale (Gas lease royalty), HMLT devised all of its right, title and interest (other than "Excluded Assets") to Torch Energy Advisors Inc. effective September 4, 1991 and recorded in Buchanan County under DB474 / PG384.</i>			
Torch Oil & Gas Company c/o Sue Ann Craddock 670 Dona Ana Road SW Deming, New Mexico 88030			
<i>Effective 2/1/11, Torch Oil & Gas Company assigned a 2% ORRI to SAC Investments, L.P.</i>			
<i>Effective 3/31/14, Torch Oil & Gas Company, et al. assigned and conveyed 10% of its right, title and interest to Rockport Oil & Gas, L.L.C. In addition, Torch Oil & Gas Company, et al. assigned and conveyed the remaining 90% of its right, title and interest to Chisos, Ltd.</i>			
			Dismissed under -04 petition
Rockport Oil & Gas L.L.C. PO Box 847 Houston, TX 77001			Dismissed under -04 petition
Chisos, LTD 670 Dona Ana Road SW Deming, New Mexico 88030			Dismissed under -04 petition
OIL & GAS OWNERSHIP			
W9/Affidavits Pending			
(1) Jackie D. & Linda S. Meadows			<i>Conveyed to Ralph Boyd 3/19/1997, DB 460/12</i>
Ralph Boyd			<i>Conveyed to Ira Keen 7/24/2000, DB 510/748</i>
Ira C. Keen			<i>Conveyed to Gage Austin Keen, Life Estate reserved to Sammie Keen, 8/18/2015, Instrument #150001363</i>
Sammie Keen PO Box 57 Oakwood, VA 24631	0.72 acres	0.0453%	
Tract #29 - 1.34 Acres			
COAL OWNERSHIP			
(1) Hugh MacRae Land Trust, Tr.5 c/o Alan Siegel Esq Gump, Strauss, Akin LLP 1 Bryant Park New York, NY 10036-6715	1.34 acres	0.0843%	Dismissed under -04 petition
<i>By Assignment and Bill of Sale (Gas lease royalty), HMLT devised all of its right, title and interest (other than "Excluded Assets") to Torch Energy Advisors Inc. effective September 4, 1991 and recorded in Buchanan County under DB474 / PG384.</i>			
Torch Oil & Gas Company c/o Sue Ann Craddock 670 Dona Ana Road SW Deming, New Mexico 88030			
<i>Effective 2/1/11, Torch Oil & Gas Company assigned a 2% ORRI to SAC Investments, L.P.</i>			
<i>Effective 3/31/14, Torch Oil & Gas Company, et al. assigned and conveyed 10% of its right, title and interest to Rockport Oil & Gas, L.L.C. In addition, Torch Oil & Gas Company, et al. assigned and conveyed the remaining 90% of its right, title and interest to Chisos, Ltd.</i>			
			Dismissed under -04 petition
Rockport Oil & Gas L.L.C. PO Box 847 Houston, TX 77001			Dismissed under -04 petition
Chisos, LTD 670 Dona Ana Road SW Deming, New Mexico 88030			Dismissed under -04 petition
OIL & GAS OWNERSHIP			
W-9/Affidavit Pending			
(1) Agnes Cole Deskins Hyatt			<i>Conveyed 9/26/1991 to Gerald E. Deskins, DB 381/60</i>

Exhibit E
 Buchanan #1 South Sealed Gob Unit 1
 Docket #VGOB 98-1117-0697-05
 List of all Owners/Claimants

	Net Acres in Unit	Interest in Unit
<i>(Life Estate in Agnes Hyatt extinguished with her death 5/22/2002)</i>		
Gerald E. Deskins 4833 Riverside Drive Raven, VA 24637	1.34 acres	0.0843%

Tract #32 - 6.64 Acres

COAL OWNERSHIP

(1) Hugh MacRae Land Trust, Tr.17 c/o Alan Siegel Esq Gump, Strauss, Akin LLP 1 Bryant Park New York, NY 10036-6715	6.64 acres	0.4175% Dismissed under -04 petition
---	------------	---

By Assignment and Bill of Sale (Gas lease royalty), HMLT devised all of its right, title and interest (other than "Excluded Assets") to Torch Energy Advisors Inc. effective September 4, 1991 and recorded in Buchanan County under DB474 / PG384.

Torch Oil & Gas Company
c/o Sue Ann Craddock
670 Dona Ana Road SW
Deming, New Mexico 88030

Effective 2/1/11, Torch Oil & Gas Company assigned a 2% ORRI to SAC Investments, L.P.

Effective 3/31/14, Torch Oil & Gas Company, et al. assigned and conveyed 10% of its right, title and interest to Rockport Oil & Gas, L.L.C. In addition, Torch Oil & Gas Company, et al. assigned and conveyed the remaining 90% of its right, title and interest to Chisos, Ltd.

Rockport Oil & Gas L.L.C. PO Box 847 Houston, TX 77001		Dismissed under -04 petition
Chisos, LTD 670 Dona Ana Road SW Deming, New Mexico 88030		Dismissed under -04 petition

OIL & GAS OWNERSHIP

W9/Affidavits Pending

(1) Julius Rowe Heirs, Devisees, Successors or Assigns

(a) Lawrence E. Rowe 10160 E-1000S Upland, IN 46989		<i>Conveyed property by deed dated September 13, 2013, instrument #130001812</i>
---	--	--

(a.1) Larry Palmer 5547 Creek Hill Rd St. Paul, VA 24283	6.64 acres	0.4175%
--	------------	---------

Tract #36A - 0.11 Acres

COAL OWNERSHIP

(1) Hugh MacRae Land Trust, Tr.17 c/o Alan Siegel Esq Gump, Strauss, Akin LLP 1 Bryant Park New York, NY 10036-6715	0.11 acres	0.0069% Dismissed under -04 petition
---	------------	---

By Assignment and Bill of Sale (Gas lease royalty), HMLT devised all of its right, title and interest (other than "Excluded Assets") to Torch Energy Advisors Inc. effective September 4, 1991 and recorded in Buchanan County under DB474 / PG384.

Torch Oil & Gas Company
c/o Sue Ann Craddock
670 Dona Ana Road SW
Deming, New Mexico 88030

Effective 2/1/11, Torch Oil & Gas Company assigned a 2% ORRI to SAC Investments, L.P.

Effective 3/31/14, Torch Oil & Gas Company, et al. assigned and conveyed 10% of its right, title and interest to Rockport Oil & Gas, L.L.C. In addition, Torch Oil & Gas Company, et al. assigned and conveyed the remaining 90% of its right, title and interest to Chisos, Ltd.

Rockport Oil & Gas L.L.C. PO Box 847 Houston, TX 77001		Dismissed under -04 petition
Chisos, LTD 670 Dona Ana Road SW		Dismissed under -04 petition

Exhibit E
 Buchanan #1 South Sealed Gob Unit 1
 Docket #VGOB 98-1117-0697-05
 List of all Owners/Claimants

	Net Acres in Unit	Interest in Unit
Deming, New Mexico 88030		
<u>OIL & GAS OWNERSHIP</u>		
<i>Unresolved Heirship & Outstanding W9/Affidavits</i>		
(1) Alta Ferrell Heirs, Devisees, Successors of Assigns	0.11 acres	0.0069%
(a) Caroline B. Davis Heirs, Devisees, Successors or Assigns		
(a.2) Guy Willis Davis 285 Flat Ridge Rd Sugar Grove, VA 24735	0.0021 acres 1/52 of 0.11 acres	0.0001%
(a.3) Joan Davis Boyd 1192 Willie Rd Vansant, VA 24656	0.0021 acres 1/52 of 0.11 acres	0.0001%
(a.4) Jack Davis Heirs, Devisees, Successors or Assigns		
(a.4.1) Sharon Davis PO Box 82 Oakwood, VA 24631	0.0021 acres 1/52 of 0.11 acres	0.0001%
(b) Margie Sparks Heirs, Devisees, Successors or Assigns <i>(documentation requested 12/28/15)</i>		
(b.1) Julius Moldovan (4th spouse) Heirs, Devisees, Successors or Assigns <i>(documentation requested 12/30/15)</i>	0.0028 acres 1/39 of 0.11 acres	0.0002%
(b.3.2) Christopher Schroll 61 Shields Ave Peru, IN 46970	0.0003 acres 1/351 of 0.11 acres	0.0000%
(b.8) Jack Sparks 1211 N 47th St Ft Smith, AR 72904	0.0006 acres 2/351 of 0.11 acres	0.0000%
(b.9) Dana Sparks Heirs, Devisees, Successors or Assigns		
(b.9.2) Ruby Schroll (predeceased daughter)		
(b.9.2.2) Christopher Schroll 61 Shields Ave Peru, IN 46970	0.00004 acres 1/2808 of 0.11 acres	0.000002%
(b.9.7) Jack Sparks 1211 N 47th St Ft Smith, AR 72904	0.0001 acres 1/1404 of 0.11 acres	0.000005%
(b.9.8) Earl Sparks (predeceased brother 1987)		
(b.9.8.1) Frederick A. Sparks 198 Fulton Ave Rochester, IN 46975	0.0001 acres 1/1404 of 0.11 acres	0.000005%
(b.9.9) Earl Sparks (predeceased son 1987)		
(b.9.9.1) Frederick A. Sparks 198 Fulton Ave Rochester, IN 46975	0.0006 acres 2/351 of 0.11 acres	0.00004%
(c) Mary K. Honaker Heirs, Devisees, Successors or Assigns		
(c.4) Shaw Honaker Heirs, Devisees, Successors or Assigns		
(c.4.1) Nina Honaker Heirs, Devisees, Successors or Assigns <i>(documentation requested 12/11/15)</i>		
(c.4.1.1) Wilma Hagerman PO Box 229 Bradshaw, WV 24817	0.0006 acres 1/182 of 0.11 acres	0.0000%
(c.4.1.2) Steve Honaker	0.0006 acres	0.0000%

Exhibit E
Buchanan #1 South Sealed Gob Unit 1
Docket #VGOB 98-1117-0697-05
List of all Owners/Claimants

	Net Acres in Unit	Interest in Unit
<i>Address Unknown</i>	1/182 of 0.11 acres	
(c.6) Jack Honaker 559 Teak St Pounding Mill, VA 24637	0.0012 acres 1/91 of 0.11 acres	0.0001%
(c.7) Don Honaker 3041 Horn Mtn Rd Raven, VA 24639	0.0012 acres 1/91 of 0.11 acres	0.0001%
(d) Flora French Heirs, Devisees, Successors or Assigns		
(d.1) Evelyn Belcher 116 Lowe St Richlands, VA 24641	0.0028 acres 1/39 of 0.11 acres	0.0002%
(e) Hazel Hylton Heirs, Devisees, Successors or Assigns <i>(documentation requested 12/11/15)</i>	0.0085 acres 1/13 of 0.11 acres	0.0005%
(e.1) John Clarence Hylton (predeceased son 1989) <i>(documentation requested 12/11/15)</i>		
(e.1.1) Johnny Hylton <i>Address unknown</i>		
(e.1.2) Jennifer Hylton <i>Address unknown</i>		
(e.1.3) Joel Hylton <i>Address unknown</i>		
(e.1.4) Jeffrey Hylton <i>Address unknown</i>		
(e.2) Geneva Hylton Joyce <i>Address unknown</i>		
(e.3) Opal Bandy 107 Bandy Ln Richlands, VA 24641		
(e.4) Robert Andrew Hylton 2213 N. Clybourn Ave Chicago, IL 60614		
(e.5) Otis Hylton Heirs, Devisees, Successors or Assigns		
(e.5.1) Russell Otis Hylton PO Box 363 Raven, VA 24639		
(e.5.2) Mark Anthony Hylton 145 Spring St Pounding Mill, VA 24637		
(f) Clarence Ferrell Heirs, Devisees, Successors or Assigns		
(f.1) Theodosia M. Ferrell Heirs, Devisees, Successors or Assigns		
(f.2) Alice Fletcher 3440 Bloomingdale Pike Kingsport, TN 37660	0.0056 acres 2/39 of 0.11 acres	0.0004%
(f.1.1) Charles D. Ferrell (predeceased son of Theodosia 1957) <i>(documentation requested 12/11/15)</i>	0.0005 acres 1/234 of 0.11 acres	0.0000%
(f.1.2) Phyllis Dean Ramey 20498 Sheppard Ln Abingdon, VA 24611	0.0005 acres 1/234 of 0.11 acres	0.0000%
(f.1.4) Billy Joe Ferrell 15548 Road 1037 Oakwood, OH 45873	0.0005 acres 1/234 of 0.11 acres	0.0000%
(f.1.5) Freddie Ferrell 11226 College Dr Meadowview, VA 24631	0.0005 acres 1/234 of 0.11 acres	0.0000%
(g) Samuel L. Ferrell Heirs, Devisees,	0.0085 acres	0.0005%

Exhibit E
 Buchanan #1 South Sealed Gob Unit 1
 Docket #VGOB 98-1117-0697-05
 List of all Owners/Claimants

	Net Acres in Unit	Interest in Unit
Successors or Assigns <i>(documentation requested 12/14/15)</i>	1/13 of 0.11 acres	
(h) Josh Vinson Ferrell Heirs, devisees, Successors or Assigns <i>(documentation requested 12/3/15)</i>	0.0085 acres 1/13 of 0.11 acres	0.0005%
(h.1) James (aka Jimmie) Donald Ferrell (predeceased) <i>(documentation requested 12/3/15)</i>		
(h.1.1) James Ferrell 2766 W. Sunset Rd Tucson, AZ 85741		
(h.1.2) Michael Ferrell <i>Address unknown</i>		
(h.1.3) Stephen Ferrell 76842 Timbercreek Blvd Yulee, FL 32097		
(h.2) Betty Ann Ferrell 3924 Clifton Fork Rd Raven, VA 24639		
(i) Mazie Boardwine Heirs, Devisees, Successors or Assigns <i>(documentation requested 12/3/15)</i>	0.0085 acres 1/13 of 0.11 acres	0.0005%
(i.1) Arch Berdette Boardwine 3084 Mt Olivet Rd Pulaski, VA 24301		
(i.2) Samuel Boardwine 4481 Brookmont Rd Pulaski, VA 24301		
(i.3) Ronald Boardwine 707 S. Ocean Ave N. Myrtle Beach, SC 29582		
(i.4) Linda Wyatt 2761 Graham Rd Draper, VA 24324		
(i.5) Daniel Paul Boardwine 411 Horsemans Ln Abingdon, VA 24210		
(i.6) Clarence Wayne Boardwine 4466 Brookmont Rd Pulaski, VA 24301		
(i.7) Della Ayers 124 15th St NW Pulaski, VA 24301		
(j) Harry Ferrell Heirs, Devisees, Successors or Assigns <i>(documentation requested 12/8/15)</i>	0.0085 acres 1/13 of 0.11 acres	0.0005%
(j.1) Florene Ferrell PO Box 247 Oakwood, VA 24631		
(j.1.1) Denise Clevinger 1969 Old Wolf Creek Rd Narrows, VA 24124		
(j.1.2) Teresa Frazier 12288 Garrett Creek Rd Abingdon, VA 24210		
(j.1.3) Gary Ferrell PO Box 247 Oakwood, VA 24631		
(k) Margaret Wilkes Heirs, Devisees, Successors or Assigns		
(k.1) James Wilkes, Jr., Heirs, Devisees, Successors or Assigns <i>(documentation requested)</i>	0.0017 acres 1/65 of 0.11 acres	0.0001%

Exhibit E
 Buchanan #1 South Sealed Gob Unit 1
 Docket #VGOB 98-1117-0697-05
 List of all Owners/Claimants

	Net Acres in Unit	Interest in Unit
(k.1.1) Aaron Wilkes 2809 Angie Dr Bellvue, NE 68005		
(k.1.2) Andrew Wilkes 1521 Maxwell Rd East Ridge, TN 37412		
(k.2) Kelley Eugene Wilkes 183 E. Elmwood St Rossville, GA 30741	0.0017 acres 1/65 of 0.11 acres	0.0001%
(k.5) Mary Elizabeth Scott Heirs, Deviseses, Successors or Assigns <i>(documentation requested 12/10/15)</i>	0.0017 acres 1/65 of 0.11 acres	0.0001%
(k.5.1) James Wilkes, Jr., Heirs, Deviseses, Successors or Assigns <i>(documentation requested)</i>		
(k.5.1.1) Aaron Wilkes 2809 Angie Dr Bellvue, NE 68005		
(k.5.1.2) Andrew Wilkes 1521 Maxwell Rd East Ridge, TN 37412		
(k.5.2) Kelley Eugene Wilkes 183 E. Elmwood St Rossville, GA 30741		
(k.5.3) Michael Ellis Wilkes 929 Hulana St Rossville, GA 30741		
(k.5.4) Janet M. Willett 1642 Osbun Rd Chickamauga, GA 30707		
(l) Rachel Robinson Heirs, Deviseses, Successors or Assigns		
(l.1) Columbus Robinson Heirs, Deviseses, Successors or Assigns <i>(documentation requested 12/9/15)</i>	0.0009 acres 1/117 of 0.11 acres	0.0001%
(l.2) Lindenberg Robinson Heirs, Deviseses, Successors or Assigns <i>(documentation requested 12/29/15)</i>	0.0009 acres 1/117 of 0.11 acres	0.0001%
(l.2.1) Vernie Robinson <i>Address Unknown</i>		
(l.3) Tommy Robinson Heirs, Deviseses, Successors or Assigns		
(l.3.1) Loretta Robinson Rt 2 Box 470 Grundy, VA 24614	0.0005 acres 1/234 of 0.11 acres	0.0000%
(l.3.2) Tommy C. Robinson PO Box 72 Pearisburg, VA 24134	0.0005 acres 1/234 of 0.11 acres	0.0000%
(l.4) Elizabeth Holder 801 Delaware Dr Temple, TX 76504	0.0009 acres 1/117 of 0.11 acres	0.0001%
(l.5) Mollie Carlson PO Box 917 Boulder, MT 59632	0.0009 acres 1/117 of 0.11 acres	0.0001%
(l.6) Fanny Kocurek Heirs, Deviseses, Successors or Assigns <i>(documentation requested 12/14/15)</i>	0.0009 acres 1/117 of 0.11 acres	0.0001%
(l.7) Caroline Donaldson PO Box 796 Boulder, MT 59632	0.0009 acres 1/117 of 0.11 acres	0.0001%
(l.8) Mary L. Parker <i>Address Unknown</i>	0.0009 acres 1/117 of 0.11 acres	0.0001%

Exhibit E
 Buchanan #1 South Sealed Gob Unit 1
 Docket #VGOB 98-1117-0697-05
 List of all Owners/Claimants

	Net Acres in Unit	Interest in Unit
W9/Affidavits Pending		
(1) James W. & Nancy J. Rose, T/E <i>James Willard Rose deceased June 18, 1982 per instrument #120000977</i>		
(a) Nancy Rose 427 Kents Ridge Road Richlands, VA 24641 <i>By deed dated August 29, 2000 Nancy Rose conveyed property to Bobby & Petra Matney, T/E, DB 512/141</i>		
(a.1) Bobby & Petra Matney <i>By deed dated November 13, 2013 Bobby & Petra Matney conveyed property to Larry Palmer, Inst #130002232</i>		
(a.1.1) Larry Palmer 5547 Creek Hill Rd St. Paul, VA 24283	0.26 acres	0.0163%
Tract #44 - 7.88 Acres		
COAL OWNERSHIP		
(1) Coal Mountain Mining Co., LLP, Tr. 5 P.O. Box 675 Tazewell, VA 24651	7.88 acres	0.4955%
OIL & GAS OWNERSHIP		
Escrow Due to Title Conflict		
(1) Gary Davis, et al	7.88 acres	0.4955%
(a) Gary Davis P.O. Box 47 Shortt Gap, VA 24627	3.152 acres 2/5 of 7.88 acres	0.1982%
(b) Wayne Davis P.O. Box 183 Pounding Mill, VA 24637	1.576 acres 1/5 of 7.88 acres	0.0991%
(c) Buford Davis Rt. 1 Box 190 Pounding Mill, VA 24637	1.576 acres 1/5 of 7.88 acres	0.0991%
(d) Ruth Boyd P.O. Box 127 Grottoes, VA 24441	1.576 acres 1/5 of 7.88 acres	0.0991%
OR		
(1) Terry Baldwin Heirs, Devisees, Successors or Assigns	7.88 acres	0.4955%
(a) Matthew Baldwin P.O. Box 531 Oakwood, VA 24631	3.94 acres 1/2 of 7.88 acres	0.2477%
(b) Amanda Leigh Baldwin-Estep 24437 Mock Knob Rd Abingdon, VA 24211	3.94 acres 1/2 of 7.88 acres	0.2477%
TOTALS:		
Total Acreage in Unit	16.9292	
Total Percentage of Unit		1.0644%

Exhibit EE
Buchanan #1 South Sealed Gob Unit 1
Docket #VGOB 98-1117-0697-05
List of Respondents with Royalty Split Agreements/Court Orders/HB2058

	Net Acres in Unit	Interest in Unit	Percent of Escrow
--	----------------------	---------------------	----------------------

Tract #1 - 1.50 Acres

COAL OWNERSHIP

(1) Hugh MacRae Land Trust, Tr.17 c/o Alan Siegel Esq Gump, Strauss, Akin LLP 1 Bryant Park New York, NY 10036-6715	1.50 acres	0.0943%	n/a
---	------------	---------	-----

By Assignment and Bill of Sale (Gas lease royalty), HMLT devised all of its right, title and interest (other than "Excluded Assets") to Torch Energy Advisors Inc. effective September 4, 1991 and recorded in Buchanan County under DB474 / PG384.

Torch Oil & Gas Company
c/o Sue Ann Craddock
670 Dona Ana Road SW
Deming, New Mexico 88030

Effective 2/1/11, Torch Oil & Gas Company assigned a 2% ORRI to SAC Investments, L.P.

Effective 3/31/14, Torch Oil & Gas Company, et al. assigned and conveyed 10% of its right, title and interest to Rockport Oil & Gas, L.L.C. In addition, Torch Oil & Gas Company, et al. assigned and conveyed the remaining 90% of its right, title and interest to Chisos, Ltd.

Rockport Oil & Gas L.L.C.
PO Box 847
Houston, TX 77001

n/a

Chisos, LTD
670 Dona Ana Road SW
Deming, New Mexico 88030

n/a

OIL & GAS OWNERSHIP

(1) CNX Gas Company LLC 1000 Consol Energy Drive Canonsburg, PA 15317 <i>(previously Pocahontas Gas Partnership)</i>	1.50 acres	0.0943%	n/a
---	------------	---------	-----

Tract #2 - 1.95 Acres

COAL OWNERSHIP

(1) Hugh MacRae Land Trust, Tr.17 c/o Alan Siegel Esq Gump, Strauss, Akin LLP 1 Bryant Park New York, NY 10036-6715	1.95 acres	0.1226%	n/a
---	------------	---------	-----

By Assignment and Bill of Sale (Gas lease royalty), HMLT devised all of its right, title and interest (other than "Excluded Assets") to Torch Energy Advisors Inc. effective September 4, 1991 and recorded in Buchanan County under DB474 / PG384.

Torch Oil & Gas Company
c/o Sue Ann Craddock
670 Dona Ana Road SW
Deming, New Mexico 88030

Effective 2/1/11, Torch Oil & Gas Company assigned a 2% ORRI to SAC Investments, L.P.

Effective 3/31/14, Torch Oil & Gas Company, et al. assigned and conveyed 10% of its right, title and interest to Rockport Oil & Gas, L.L.C. In addition, Torch Oil & Gas Company, et al. assigned and conveyed the remaining 90% of its right, title and interest to Chisos, Ltd.

Rockport Oil & Gas L.L.C.
PO Box 847
Houston, TX 77001

n/a

Chisos, LTD
670 Dona Ana Road SW
Deming, New Mexico 88030

n/a

OIL & GAS OWNERSHIP

Exhibit EE
Buchanan #1 South Sealed Gob Unit 1
Docket #VGOB 98-1117-0697-05
List of Respondents with Royalty Split Agreements/Court Orders/HB2058

	Net Acres in Unit	Interest in Unit	Percent of Escrow
(1) Ernest Addison Heirs, Devisees, Successors or Assigns	1.95 acres	0.1226%	n/a
(a) Myrtle Addison Estate P.O. Box 91 Nokesville, VA 20182	0.65 acres 1/3 of 1.95 acres	0.0409%	n/a
(b) Ralph Addison 195 Morefield Bottom Dr. St. Paul, VA 24283	0.26 acres 2/15 of 1.95 acres	0.0163%	n/a
(c) Gayle Henderson 981 Grubmore Road Marion, VA 24354	0.26 acres 2/15 of 1.95 acres	0.0163%	n/a
(d) Helen McGrady 11656 Cemetery Road Bealeton, VA 22712	0.26 acres 2/15 of 1.95 acres	0.0163%	n/a
(e) Joe Addison P. O. Box 91 Nokesville, VA 22031	0.26 acres 2/15 of 1.95 acres	0.0163%	n/a
(f) Evelyn Massey P. O. Box 205 Sumerduck, VA 22742	0.26 acres 2/15 of 1.95 acres	0.0163%	n/a
Total tract acres	1.95		
Total tract percent	0.1226%		

Tract #3 - 1.83 Acres

COAL OWNERSHIP

(1) Hugh MacRae Land Trust, Tr.17 c/o Alan Siegel Esq Gump, Strauss, Akin LLP 1 Bryant Park New York, NY 10036-6715	1.83 acres	0.1151%	n/a
---	------------	---------	-----

By Assignment and Bill of Sale (Gas lease royalty), HMLT devised all of its right, title and interest (other than "Excluded Assets") to Torch Energy Advisors Inc. effective September 4, 1991 and recorded in Buchanan County under DB474 / PG384.

Torch Oil & Gas Company
c/o Sue Ann Craddock
670 Dona Ana Road SW
Deming, New Mexico 88030

Effective 2/1/11, Torch Oil & Gas Company assigned a 2% ORRI to SAC Investments, L.P.

Effective 3/31/14, Torch Oil & Gas Company, et al. assigned and conveyed 10% of its right, title and interest to Rockport Oil & Gas, L.L.C. In addition, Torch Oil & Gas Company, et al. assigned and conveyed the remaining 90% of its right, title and interest to Chisos, Ltd.

Rockport Oil & Gas L.L.C. PO Box 847 Houston, TX 77001			n/a
Chisos, LTD 670 Dona Ana Road SW Deming, New Mexico 88030			n/a

OIL & GAS OWNERSHIP

(1) CNX Gas Company LLC 1000 Consol Energy Drive Canonsburg, PA 15317 <i>(previously Consolidation Coal Company)</i>	1.83 acres	0.1151%	n/a
---	------------	---------	-----

Tract #4 - 3.72 Acres

COAL OWNERSHIP

(1) Hugh MacRae Land Trust, Tr.17	3.72 acres	0.2339%	n/a
-----------------------------------	------------	---------	-----

Exhibit EE
Buchanan #1 South Sealed Gob Unit 1
Docket #VGOB 98-1117-0697-05
List of Respondents with Royalty Split Agreements/Court Orders/HB2058

	Net Acres in Unit	Interest in Unit	Percent of Escrow
--	----------------------	---------------------	----------------------

c/o Alan Siegel Esq
Gump, Strauss, Akin LLP
1 Bryant Park
New York, NY 10036-6715

By Assignment and Bill of Sale (Gas lease royalty), HMLT devised all of its right, title and interest (other than "Excluded Assets") to Torch Energy Advisors Inc. effective September 4, 1991 and recorded in Buchanan County under DB474 / PG384.

Torch Oil & Gas Company
c/o Sue Ann Craddock
670 Dona Ana Road SW
Deming, New Mexico 88030

Effective 2/1/11, Torch Oil & Gas Company assigned a 2% ORRI to SAC Investments, L.P.

Effective 3/31/14, Torch Oil & Gas Company, et al. assigned and conveyed 10% of its right, title and interest to Rockport Oil & Gas, L.L.C. In addition, Torch Oil & Gas Company, et al. assigned and conveyed the remaining 90% of its right, title and interest to Chisos, Ltd.

Rockport Oil & Gas L.L.C.
PO Box 847
Houston, TX 77001

n/a

Chisos, LTD
670 Dona Ana Road SW
Deming, New Mexico 88030

n/a

OIL & GAS OWNERSHIP

(1) CNX Gas Company LLC 1000 Consol Energy Drive Canonsburg, PA 15317 <i>(previously Consolidation Coal Company)</i>	3.72 acres	0.2339%	<i>n/a</i>
---	------------	---------	------------

Tract #6 - 0.17 Acres

COAL OWNERSHIP

(1) Hugh MacRae Land Trust, Tr.17 c/o Alan Siegel Esq Gump, Strauss, Akin LLP 1 Bryant Park New York, NY 10036-6715	0.17 acres	0.0107%	<i>n/a</i>
---	------------	---------	------------

By Assignment and Bill of Sale (Gas lease royalty), HMLT devised all of its right, title and interest (other than "Excluded Assets") to Torch Energy Advisors Inc. effective September 4, 1991 and recorded in Buchanan County under DB474 / PG384.

Torch Oil & Gas Company
c/o Sue Ann Craddock
670 Dona Ana Road SW
Deming, New Mexico 88030

Effective 2/1/11, Torch Oil & Gas Company assigned a 2% ORRI to SAC Investments, L.P.

Effective 3/31/14, Torch Oil & Gas Company, et al. assigned and conveyed 10% of its right, title and interest to Rockport Oil & Gas, L.L.C. In addition, Torch Oil & Gas Company, et al. assigned and conveyed the remaining 90% of its right, title and interest to Chisos, Ltd.

Rockport Oil & Gas L.L.C.
PO Box 847
Houston, TX 77001

n/a

Chisos, LTD
670 Dona Ana Road SW
Deming, New Mexico 88030

n/a

OIL & GAS OWNERSHIP

(1) CNX Gas Company LLC 1000 Consol Energy Drive Canonsburg, PA 15317 <i>(previously Consolidation Coal Company)</i>	0.17 acres	0.0107%	<i>n/a</i>
---	------------	---------	------------

Exhibit EE
Buchanan #1 South Sealed Gob Unit 1
Docket #VGOB 98-1117-0697-05
List of Respondents with Royalty Split Agreements/Court Orders/HB2058

	Net Acres in Unit	Interest in Unit	Percent of Escrow
--	----------------------	---------------------	----------------------

Tract #7 - 0.08 Acres

COAL OWNERSHIP

(1) Hugh MacRae Land Trust, Tr.17 c/o Alan Siegel Esq Gump, Strauss, Akin LLP 1 Bryant Park New York, NY 10036-6715	0.08 acres	0.0050%	<i>n/a</i>
---	------------	---------	------------

By Assignment and Bill of Sale (Gas lease royalty), HMLT devised all of its right, title and interest (other than "Excluded Assets") to Torch Energy Advisors Inc. effective September 4, 1991 and recorded in Buchanan County under DB474 / PG384.

Torch Oil & Gas Company
c/o Sue Ann Craddock
670 Dona Ana Road SW
Deming, New Mexico 88030

Effective 2/1/11, Torch Oil & Gas Company assigned a 2% ORRI to SAC Investments, L.P.

Effective 3/31/14, Torch Oil & Gas Company, et al. assigned and conveyed 10% of its right, title and interest to Rockport Oil & Gas, L.L.C. In addition, Torch Oil & Gas Company, et al. assigned and conveyed the remaining 90% of its right, title and interest to Chisos, Ltd.

Rockport Oil & Gas L.L.C.
PO Box 847
Houston, TX 77001 *n/a*

Chisos, LTD *n/a*
670 Dona Ana Road SW
Deming, New Mexico 88030

OIL & GAS OWNERSHIP

(1) CNX Gas Company LLC 1000 Consol Energy Drive Canonsburg, PA 15317 <i>(previously Consolidation Coal Company)</i>	0.08 acres	0.0050%	<i>n/a</i>
---	------------	---------	------------

Tract #8 - 4.55 Acres

COAL OWNERSHIP

(1) Hugh MacRae Land Trust, Tr.17 c/o Alan Siegel Esq Gump, Strauss, Akin LLP 1 Bryant Park New York, NY 10036-6715	4.55 acres	0.2861%	<i>n/a</i>
---	------------	---------	------------

By Assignment and Bill of Sale (Gas lease royalty), HMLT devised all of its right, title and interest (other than "Excluded Assets") to Torch Energy Advisors Inc. effective September 4, 1991 and recorded in Buchanan County under DB474 / PG384.

Torch Oil & Gas Company
c/o Sue Ann Craddock
670 Dona Ana Road SW
Deming, New Mexico 88030

Effective 2/1/11, Torch Oil & Gas Company assigned a 2% ORRI to SAC Investments, L.P.

Effective 3/31/14, Torch Oil & Gas Company, et al. assigned and conveyed 10% of its right, title and interest to Rockport Oil & Gas, L.L.C. In addition, Torch Oil & Gas Company, et al. assigned and conveyed the remaining 90% of its right, title and interest to Chisos, Ltd.

Rockport Oil & Gas L.L.C.
PO Box 847
Houston, TX 77001 *n/a*

Chisos, LTD *n/a*
670 Dona Ana Road SW
Deming, New Mexico 88030

OIL & GAS OWNERSHIP

Exhibit EE
Buchanan #1 South Sealed Gob Unit 1
Docket #VGOB 98-1117-0697-05
List of Respondents with Royalty Split Agreements/Court Orders/HB2058

	Net Acres in Unit	Interest in Unit	Percent of Escrow
(1) CNX Gas Company LLC 1000 Consol Energy Drive Canonsburg, PA 15317 <i>(previously Consolidation Coal Company)</i>	4.55 acres	0.2861%	<i>n/a</i>

Tract #9 - 48.15 Acres

COAL OWNERSHIP

(1) Hugh MacRae Land Trust, Tr. 17 c/o Alan Siegel Esq Gump, Strauss, Akin LLP 1 Bryant Park New York, NY 10036-6715	48.15 acres	3.0275%	<i>n/a</i>
--	-------------	---------	------------

By Assignment and Bill of Sale (Gas lease royalty), HMLT devised all of its right, title and interest (other than "Excluded Assets") to Torch Energy Advisors Inc. effective September 4, 1991 and recorded in Buchanan County under DB474 / PG384.

Torch Oil & Gas Company
c/o Sue Ann Craddock
670 Dona Ana Road SW
Deming, New Mexico 88030

Effective 2/1/11, Torch Oil & Gas Company assigned a 2% ORRI to SAC Investments, L.P.

Effective 3/31/14, Torch Oil & Gas Company, et al. assigned and conveyed 10% of its right, title and interest to Rockport Oil & Gas, L.L.C. In addition, Torch Oil & Gas Company, et al. assigned and conveyed the remaining 90% of its right, title and interest to Chisos, Ltd.

Rockport Oil & Gas L.L.C. PO Box 847 Houston, TX 77001			<i>n/a</i>
Chisos, LTD 670 Dona Ana Road SW Deming, New Mexico 88030			<i>n/a</i>

OIL & GAS OWNERSHIP

(1) CNX Gas Company LLC 1000 Consol Energy Drive Canonsburg, PA 15317 <i>(previously Consolidation Coal Company)</i>	48.15 acres	3.0275%	<i>n/a</i>
---	-------------	---------	------------

Tract #10 - 7.33 Acres

COAL OWNERSHIP

(1) Hugh MacRae Land Trust, Tr. 17 c/o Alan Siegel Esq Gump, Strauss, Akin LLP 1 Bryant Park New York, NY 10036-6715	7.33 acres	0.4609%	<i>n/a</i>
--	------------	---------	------------

By Assignment and Bill of Sale (Gas lease royalty), HMLT devised all of its right, title and interest (other than "Excluded Assets") to Torch Energy Advisors Inc. effective September 4, 1991 and recorded in Buchanan County under DB474 / PG384.

Torch Oil & Gas Company
c/o Sue Ann Craddock
670 Dona Ana Road SW
Deming, New Mexico 88030

Effective 2/1/11, Torch Oil & Gas Company assigned a 2% ORRI to SAC Investments, L.P.

Effective 3/31/14, Torch Oil & Gas Company, et al. assigned and conveyed 10% of its right, title and interest to Rockport Oil & Gas, L.L.C. In addition, Torch Oil & Gas Company, et al. assigned and conveyed the remaining 90% of its right, title and interest to Chisos, Ltd.

Rockport Oil & Gas L.L.C. PO Box 847 Houston, TX 77001			<i>n/a</i>
Chisos, LTD			<i>n/a</i>

Exhibit EE
Buchanan #1 South Sealed Gob Unit 1
Docket #VGOB 98-1117-0697-05
List of Respondents with Royalty Split Agreements/Court Orders/HB2058

	Net Acres in Unit	Interest in Unit	Percent of Escrow
670 Dona Ana Road SW Deming, New Mexico 88030			
<u>OIL & GAS OWNERSHIP</u>			
(1) CNX Gas Company LLC 1000 Consol Energy Drive Canonsburg, PA 15317 <i>(previously Consolidation Coal Company)</i>	7.33 acres	0.4609%	<i>n/a</i>
<u>Tract #11 - 81.53 Acres</u>			
<u>COAL OWNERSHIP</u>			
(1) Hugh MacRae Land Trust, Tr.2 c/o Alan Siegel Esq Gump, Strauss, Akin LLP 1 Bryant Park New York, NY 10036-6715	81.53 acres	5.1263%	<i>n/a</i>
<i>By Assignment and Bill of Sale (Gas lease royalty), HMLT devised all of its right, title and interest (other than "Excluded Assets") to Torch Energy Advisors Inc. effective September 4, 1991 and recorded in Buchanan County under DB474 / PG384.</i>			
Torch Oil & Gas Company c/o Sue Ann Craddock 670 Dona Ana Road SW Deming, New Mexico 88030			
<i>Effective 2/1/11, Torch Oil & Gas Company assigned a 2% ORRI to SAC Investments, L.P.</i>			
<i>Effective 3/31/14, Torch Oil & Gas Company, et al. assigned and conveyed 10% of its right, title and interest to Rockport Oil & Gas, L.L.C. In addition, Torch Oil & Gas Company, et al. assigned and conveyed the remaining 90% of its right, title and interest to Chisos, Ltd.</i>			
			<i>n/a</i>
Rockport Oil & Gas L.L.C. PO Box 847 Houston, TX 77001			
			<i>n/a</i>
Chisos, LTD 670 Dona Ana Road SW Deming, New Mexico 88030			
<u>OIL & GAS OWNERSHIP</u>			
(1) Ernest Keene Heirs (aka Ernest Keen) 87.50 Acres	81.53 acres	5.1263%	
Lula Sisk Keen Heirs, Devisees, Successors or Assigns <i>(1/3 interest passes to children)</i>			
(a) Ralph Keene Heirs, Devisees, Successors or Assigns			
(a.1) Grace Keen Heirs, Devisees, Successors or Assigns			
(a.1.1) Delores E. Estep 200 Summit Ave Lebanon, VA 24266	1.9412 acres 1/42 of 81.53 acres	0.1221%	<i>n/a</i>
(a.1.2) Darlene Bradley PO Box 503 Keen Mountain, VA 24624	1.9412 acres 1/42 of 81.53 acres	0.1221%	<i>n/a</i>
(a.1.3) Diana Lee Asbury PO Box 974 Lowell, NC 28098	1.9412 acres 1/42 of 81.53 acres	0.1221%	<i>n/a</i>
(a.1.4) Roy Earnest Keen 200 Summit Ave Lebanon, VA 24266	1.9412 acres 1/42 of 81.53 acres	0.1221%	<i>n/a</i>

Exhibit EE
Buchanan #1 South Sealed Gob Unit 1
Docket #VGOB 98-1117-0697-05
List of Respondents with Royalty Split Agreements/Court Orders/HB2058

	Net Acres in Unit	Interest in Unit	Percent of Escrow
(a.1.5) Ralph Douglas Keen PO Box 1121 Raven, VA 24639	1.9412 acres 1/42 of 81.53 acres	0.1221%	<i>n/a</i>
(a.1.6) Andy Glen Keen 4846 Quarterwood Rd Thaxton, VA 24174	1.9412 acres 1/42 of 81.53 acres	0.1221%	<i>n/a</i>
(a.1.7) Randy Lynn Keen 49 Lakeshore Terrace Hardy, VA 24101	1.9412 acres 1/42 of 81.53 acres	0.1221%	<i>n/a</i>
(b) Arnold J. Keene 962 Ascue Rd Cedar Bluff, VA 24609	13.59 acres 1/6 of 81.53 acre	0.8544%	22.9463% HB2058
(c) Paul Keene Heirs, Devisees, Successors or Assigns			
(c.1) Ralph Keene Heirs, Devisees, Successors or Assigns			
(c.1.1) Grace Keen Heirs, Devisees, Successors or Assigns			
(c.1.1.1) Delores E. Estep 200 Summit Ave Lebanon, VA 24266	0.3882 acres 1/210 of 81.53 acres	0.0244%	<i>n/a</i>
(c.1.1.2) Darlene Bradley PO Box 503 Keen Mountain, VA 24624	0.3882 acres 1/210 of 81.53 acres	0.0244%	<i>n/a</i>
(c.1.1.3) Diana Lee Asbury PO Box 974 Lowell, NC 28098	0.3882 acres 1/210 of 81.53 acres	0.0244%	<i>n/a</i>
(c.1.1.4) Roy Earnest Keen 200 Summit Ave Lebanon, VA 24266	0.3882 acres 1/210 of 81.53 acres	0.0244%	<i>n/a</i>
(c.1.1.5) Ralph Douglas Keen PO Box 1121 Raven, VA 24639	0.3882 acres 1/210 of 81.53 acres	0.0244%	<i>n/a</i>
(c.1.1.6) Andy Glen Keen 4846 Quarterwood Rd Thaxton, VA 24174	0.3882 acres 1/210 of 81.53 acres	0.0244%	<i>n/a</i>
(c.1.1.7) Randy Lynn Keen 49 Lakeshore Terrace Hardy, VA 24101	0.3882 acres 1/210 of 81.53 acres	0.0244%	<i>n/a</i>
(c.2) Arnold J. Keene 962 Ascue Rd Cedar Bluff, VA 24609	2.72 acres 1/30 of 81.53 acre	0.1709%	4.5893% HB2058
(c.3) Anna R. Lambert 182 Blankenship Dr N. Tazewell, VA 24630	2.72 acres 1/30 of 81.53 acre	0.1709%	<i>n/a</i>
(c.4) Elizabeth Ann McCowen Justice PO Box 677 Rosedale, VA 24280	2.72 acres 1/30 of 81.53 acre	0.1709%	<i>n/a</i>
(d) Ruby Hale Heirs, Devisees, Successors or Assigns	<i>Pre-deceased Paul Keene</i>		
(d.1) Carl Lee Hale 104 Third Ave Richlands, VA 24641	0.68 acres 1/120 of 81.53 acre	0.0427%	1.1473% HB2058
(d.2) Billy Ray Hale	0.68 acres	0.0427%	<i>n/a</i>

Exhibit EE
Buchanan #1 South Sealed Gob Unit 1
Docket #VGOB 98-1117-0697-05
List of Respondents with Royalty Split Agreements/Court Orders/HB2058

	Net Acres in Unit	Interest in Unit	Percent of Escrow
PO Box 311 Honaker, VA 24260	1/120 of 81.53 acre		
(d.3) Linda K Matney PO Box 738 Pounding Mill, VA 24637	0.68 acres 1/120 of 81.53 acre	0.0427%	n/a
(d.4) Brenda Weddle PO Box 852 Pounding Mill, VA 24637	0.68 acres 1/120 of 81.53 acre	0.0427%	n/a
(e) Elizabeth Ann McCowen Justice PO Box 677 Rosedale, VA 24280	13.59 acres 1/6 of 81.53 acre	0.8544%	n/a
(f) Ruby Hale Heirs, Devisees, Successors or Assigns			
(f.1) Billy Ray Hale PO Box 311 Honaker, VA 24260	3.40 acres 1/24 of 81.53 acre	0.2136%	n/a
(f.2) Linda K Matney PO Box 738 Pounding Mill, VA 24637	3.40 acres 1/24 of 81.53 acre	0.2136%	n/a
(f.3) Brenda Weddle PO Box 852 Pounding Mill, VA 24637	3.40 acres 1/24 of 81.53 acre	0.2136%	n/a
(f.4) Carl Lee Hale 104 Third Ave Richlands, VA 24641	3.40 acres 1/24 of 81.53 acre	0.2136%	5.7366% HB2058
(g) Anna Ruth Lambert 182 Blankenship Dr N. Tazewell, VA 24630	13.59 acres 1/6 of 81.53 acre	0.8544%	n/a
Total tract acres	81.53		
Total tract percent	5.1263%		

Tract #12 - 12.69 Acres

COAL OWNERSHIP

(1) Hugh MacRae Land Trust, Tr.17 c/o Alan Siegel Esq Gump, Strauss, Akin LLP 1 Bryant Park New York, NY 10036-6715	12.69 acres	0.7979%	n/a
---	-------------	---------	-----

By Assignment and Bill of Sale (Gas lease royalty), HMLT devised all of its right, title and interest (other than "Excluded Assets") to Torch Energy Advisors Inc. effective September 4, 1991 and recorded in Buchanan County under DB474 / PG384.

Torch Oil & Gas Company
c/o Sue Ann Craddock
670 Dona Ana Road SW
Deming, New Mexico 88030

Effective 2/1/11, Torch Oil & Gas Company assigned a 2% ORRI to SAC Investments, L.P.

Effective 3/31/14, Torch Oil & Gas Company, et al. assigned and conveyed 10% of its right, title and interest to Rockport Oil & Gas, L.L.C. In addition, Torch Oil & Gas Company, et al. assigned and conveyed the remaining 90% of its right, title and interest to Chisos, Ltd.

Rockport Oil & Gas L.L.C. PO Box 847 Houston, TX 77001			n/a
Chisos, LTD 670 Dona Ana Road SW Deming, New Mexico 88030			n/a

Exhibit EE
 Buchanan #1 South Sealed Gob Unit 1
 Docket #VGOB 98-1117-0697-05
 List of Respondents with Royalty Split Agreements/Court Orders/HB2058

	Net Acres in Unit	Interest in Unit	Percent of Escrow
<u>OIL & GAS OWNERSHIP</u>			
(1) Ernest Keene Heirs (aka Ernest Keen) 87.50 Acres	12.69 acres	0.7979%	
Lula Sisk Keen Heirs, Devisees, Successors or Assigns <i>(1/3 interest passes to children)</i>			
(a) Ralph Keene Heirs, Devisees, Successors or Assigns			
(a.1) Grace Keen Heirs, Devisees, Successors or Assigns			
(a.1.1) Delores E. Estep 200 Summit Ave Lebanon, VA 24266	0.3021 acres 1/42 of 12.69 acres	0.0190%	<i>n/a</i>
(a.1.2) Darlene Bradley PO Box 503 Keen Mountain, VA 24624	0.3021 acres 1/42 of 12.69 acres	0.0190%	<i>n/a</i>
(a.1.3) Diana Lee Asbury PO Box 974 Lowell, NC 28098	0.3021 acres 1/42 of 12.69 acres	0.0190%	<i>n/a</i>
(a.1.4) Roy Earnest Keen 200 Summit Ave Lebanon, VA 24266	0.3021 acres 1/42 of 12.69 acres	0.0190%	<i>n/a</i>
(a.1.5) Ralph Douglas Keen PO Box 1121 Raven, VA 24639	0.3021 acres 1/42 of 12.69 acres	0.0190%	<i>n/a</i>
(a.1.6) Andy Glen Keen 4846 Quarterwood Rd Thaxton, VA 24174	0.3021 acres 1/42 of 12.69 acres	0.0190%	<i>n/a</i>
(a.1.7) Randy Lynn Keen 49 Lakeshore Terrace Hardy, VA 24101	0.3021 acres 1/42 of 12.69 acres	0.0190%	<i>n/a</i>
(b) Arnold J. Keene 962 Ascue Rd Cedar Bluff, VA 24609	2.1150 acres 1/6 of 12.69 acres	0.1330%	3.5716% HB2058
(c) Paul Keene Heirs, Devisees, Successors or Assigns			
(c.1) Ralph Keene Heirs, Devisees, Successors or Assigns			
(c.1.1) Grace Keen Heirs, Devisees, Successors or Assigns			
(c.1.1.1) Delores E. Estep 200 Summit Ave Lebanon, VA 24266	0.0604 acres 1/210 of 12.69 acres	0.0038%	<i>n/a</i>
(c.1.1.2) Darlene Bradley PO Box 503 Keen Mountain, VA 24624	0.0604 acres 1/210 of 12.69 acres	0.0038%	<i>n/a</i>
(c.1.1.3) Diana Lee Asbury PO Box 974 Lowell, NC 28098	0.0604 acres 1/210 of 12.69 acres	0.0038%	<i>n/a</i>
(c.1.1.4) Roy Earnest Keen 200 Summit Ave Lebanon, VA 24266	0.0604 acres 1/210 of 12.69 acres	0.0038%	<i>n/a</i>

Exhibit EE
Buchanan #1 South Sealed Gob Unit 1
Docket #VGOB 98-1117-0697-05
List of Respondents with Royalty Split Agreements/Court Orders/HB2058

	Net Acres in Unit	Interest in Unit	Percent of Escrow
(c.1.1.5) Ralph Douglas Keen PO Box 1121 Raven, VA 24639	0.0604 acres 1/210 of 12.69 acres	0.0038%	<i>n/a</i>
(c.1.1.6) Andy Glen Keen 4846 Quarterwood Rd Thaxton, VA 24174	0.0604 acres 1/210 of 12.69 acres	0.0038%	<i>n/a</i>
(c.1.1.7) Randy Lynn Keen 49 Lakeshore Terrace Hardy, VA 24101	0.0604 acres 1/210 of 12.69 acres	0.0038%	<i>n/a</i>
(c.2) Arnold J. Keene 962 Ascue Rd Cedar Bluff, VA 24609	0.4230 acres 1/30 of 12.69 acres	0.0266%	0.7143% HB2058
(c.3) Anna R. Lambert 182 Blankenship Dr N. Tazewell, VA 24630	0.4230 acres 1/30 of 12.69 acres	0.0266%	<i>n/a</i>
(c.4) Elizabeth Ann McCowen Justice PO Box 677 Rosedale, VA 24280	0.4230 acres 1/30 of 12.69 acres	0.0266%	<i>n/a</i>
(d) Ruby Hale Heirs, Devisees, Successors or Assigns	<i>Pre-deceased Paul Keene</i>		
(d.1) Carl Lee Hale 104 Third Ave Richlands, VA 24641	0.1058 acres 1/120 of 12.69 acres	0.0066%	0.1786% HB2058
(d.2) Billy Ray Hale PO Box 311 Honaker, VA 24260	0.1058 acres 1/120 of 12.69 acres	0.0066%	<i>n/a</i>
(d.3) Linda K Matney PO Box 738 Pounding Mill, VA 24637	0.1058 acres 1/120 of 12.69 acres	0.0066%	<i>n/a</i>
(d.4) Brenda Weddle PO Box 852 Pounding Mill, VA 24637	0.1058 acres 1/120 of 12.69 acres	0.0066%	<i>n/a</i>
(e) Elizabeth Ann McCowen Justice PO Box 677 Rosedale, VA 24280	2.1150 acres 1/6 of 12.69 acres	0.1330%	<i>n/a</i>
(f) Ruby Hale Heirs, Devisees, Successors or Assigns			
(f.1) Billy Ray Hale PO Box 311 Honaker, VA 24260	0.5288 acres 1/24 of 12.69 acres	0.0332%	<i>n/a</i>
(f.2) Linda K Matney PO Box 738 Pounding Mill, VA 24637	0.5288 acres 1/24 of 12.69 acres	0.0332%	<i>n/a</i>
(f.3) Brenda Weddle PO Box 852 Pounding Mill, VA 24637	0.5288 acres 1/24 of 12.69 acres	0.0332%	<i>n/a</i>
(f.4) Carl Lee Hale 104 Third Ave Richlands, VA 24641	0.5288 acres 1/24 of 12.69 acres	0.0332%	0.8929% HB2058
(g) Anna Ruth Lambert 182 Blankenship Dr N. Tazewell, VA 24630	2.1150 acres 1/6 of 12.69 acres	0.1330%	<i>n/a</i>

Total tract acres 12.69

Exhibit EE
Buchanan #1 South Sealed Gob Unit 1
Docket #VGOB 98-1117-0697-05
List of Respondents with Royalty Split Agreements/Court Orders/HB2058

	Net Acres in Unit	Interest in Unit	Percent of Escrow
--	----------------------	---------------------	----------------------

Total tract percent 0.7979%

Tract #13 - 10.92 Acres

COAL OWNERSHIP

(1) Hugh MacRae Land Trust, Tr.17 c/o Alan Siegel Esq Gump, Strauss, Akin LLP 1 Bryant Park New York, NY 10036-6715	10.92 acres	0.6866%	n/a
---	-------------	---------	-----

By Assignment and Bill of Sale (Gas lease royalty), HMLT devised all of its right, title and interest (other than "Excluded Assets") to Torch Energy Advisors Inc. effective September 4, 1991 and recorded in Buchanan County under DB474 / PG384.

Torch Oil & Gas Company
c/o Sue Ann Craddock
670 Dona Ana Road SW
Deming, New Mexico 88030

Effective 2/1/11, Torch Oil & Gas Company assigned a 2% ORRI to SAC Investments, L.P.

Effective 3/31/14, Torch Oil & Gas Company, et al. assigned and conveyed 10% of its right, title and interest to Rockport Oil & Gas, L.L.C. In addition, Torch Oil & Gas Company, et al. assigned and conveyed the remaining 90% of its right, title and interest to Chisos, Ltd.

Rockport Oil & Gas L.L.C. PO Box 847 Houston, TX 77001			n/a
--	--	--	-----

Chisos, LTD 670 Dona Ana Road SW Deming, New Mexico 88030			n/a
---	--	--	-----

OIL & GAS OWNERSHIP

(1) Glenn Rose, et ux			
	<i>Conveyed to Burns & Nancy Mullins 12/10/1993, DB 611/437</i>		
Burns & Nancy Mullins PO Box 35 Pilgrims Knob, VA 24634	10.92 acres	0.6866%	18.4404% HB2058

Tract #14 - 1.57 Acres

COAL OWNERSHIP

(1) Hugh MacRae Land Trust, Tr.17 c/o Alan Siegel Esq Gump, Strauss, Akin LLP 1 Bryant Park New York, NY 10036-6715	1.57 acres	0.0987%	n/a
---	------------	---------	-----

By Assignment and Bill of Sale (Gas lease royalty), HMLT devised all of its right, title and interest (other than "Excluded Assets") to Torch Energy Advisors Inc. effective September 4, 1991 and recorded in Buchanan County under DB474 / PG384.

Torch Oil & Gas Company
c/o Sue Ann Craddock
670 Dona Ana Road SW
Deming, New Mexico 88030

Effective 2/1/11, Torch Oil & Gas Company assigned a 2% ORRI to SAC Investments, L.P.

Effective 3/31/14, Torch Oil & Gas Company, et al. assigned and conveyed 10% of its right, title and interest to Rockport Oil & Gas, L.L.C. In addition, Torch Oil & Gas Company, et al. assigned and conveyed the remaining 90% of its right, title and interest to Chisos, Ltd.

Rockport Oil & Gas L.L.C. PO Box 847 Houston, TX 77001			n/a
--	--	--	-----

Chisos, LTD 670 Dona Ana Road SW Deming, New Mexico 88030			n/a
---	--	--	-----

Exhibit EE
Buchanan #1 South Sealed Gob Unit 1
Docket #VGOB 98-1117-0697-05
List of Respondents with Royalty Split Agreements/Court Orders/HB2058

	Net Acres in Unit	Interest in Unit	Percent of Escrow
--	----------------------	---------------------	----------------------

OIL & GAS OWNERSHIP

(1) CNX Gas Company LLC 1000 Consol Energy Drive Canonsburg, PA 15317 <i>(previously Pocahontas Gas Partnership)</i>	1.57 acres	0.0987%	<i>n/a</i>
---	------------	---------	------------

Tract #16 - 19.18 Acres

COAL OWNERSHIP

(1) Hugh MacRae Land Trust, Tr.17 c/o Alan Siegel Esq Gump, Strauss, Akin LLP 1 Bryant Park New York, NY 10036-6715	19.18 acres	1.2060%	<i>n/a</i>
---	-------------	---------	------------

By Assignment and Bill of Sale (Gas lease royalty), HMLT devised all of its right, title and interest (other than "Excluded Assets") to Torch Energy Advisors Inc. effective September 4, 1991 and recorded in Buchanan County under DB474 / PG384.

Torch Oil & Gas Company
c/o Sue Ann Craddock
670 Dona Ana Road SW
Deming, New Mexico 88030

Effective 2/1/11, Torch Oil & Gas Company assigned a 2% ORRI to SAC Investments, L.P.

Effective 3/31/14, Torch Oil & Gas Company, et al. assigned and conveyed 10% of its right, title and interest to Rockport Oil & Gas, L.L.C. In addition, Torch Oil & Gas Company, et al. assigned and conveyed the remaining 90% of its right, title and interest to Chisos, Ltd.

Rockport Oil & Gas L.L.C. PO Box 847 Houston, TX 77001			<i>n/a</i>
--	--	--	------------

Chisos, LTD 670 Dona Ana Road SW Deming, New Mexico 88030			<i>n/a</i>
---	--	--	------------

OIL & GAS OWNERSHIP

(1) CNX Gas Company LLC 1000 Consol Energy Drive Canonsburg, PA 15317 <i>(previously Pocahontas Gas Partnership)</i>	19.18 acres	1.2060%	<i>n/a</i>
---	-------------	---------	------------

Tract #17 - 48.86 Acres

COAL OWNERSHIP

(1) Hugh MacRae Land Trust, Tr.17 c/o Alan Siegel Esq Gump, Strauss, Akin LLP 1 Bryant Park New York, NY 10036-6715	48.86 acres	3.0721%	<i>n/a</i>
---	-------------	---------	------------

By Assignment and Bill of Sale (Gas lease royalty), HMLT devised all of its right, title and interest (other than "Excluded Assets") to Torch Energy Advisors Inc. effective September 4, 1991 and recorded in Buchanan County under DB474 / PG384.

Torch Oil & Gas Company
c/o Sue Ann Craddock
670 Dona Ana Road SW
Deming, New Mexico 88030

Effective 2/1/11, Torch Oil & Gas Company assigned a 2% ORRI to SAC Investments, L.P.

Effective 3/31/14, Torch Oil & Gas Company, et al. assigned and conveyed 10% of its right, title and interest to Rockport Oil & Gas, L.L.C. In addition, Torch Oil & Gas Company, et al. assigned and conveyed the remaining 90% of its right, title and interest to Chisos, Ltd.

Rockport Oil & Gas L.L.C.			<i>n/a</i>
---------------------------	--	--	------------

Exhibit EE
Buchanan #1 South Sealed Gob Unit 1
Docket #VGOB 98-1117-0697-05
List of Respondents with Royalty Split Agreements/Court Orders/HB2058

	Net Acres in Unit	Interest in Unit	Percent of Escrow
PO Box 847 Houston, TX 77001			
Chisos, LTD 670 Dona Ana Road SW Deming, New Mexico 88030			n/a
<u>OIL & GAS OWNERSHIP</u>			
(1) CNX Gas Company LLC 1000 Consol Energy Drive Canonsburg, PA 15317 <i>(previously Consolidation Coal Company)</i>	48.86 acres	3.0721%	n/a

Tract #18 - 0.11 Acres

COAL OWNERSHIP

(1) Hugh MacRae Land Trust, Tr.17 c/o Alan Siegel Esq Gump, Strauss, Akin LLP 1 Bryant Park New York, NY 10036-6715	0.11 acres	0.0069%	n/a
---	------------	---------	-----

By Assignment and Bill of Sale (Gas lease royalty), HMLT devised all of its right, title and interest (other than "Excluded Assets") to Torch Energy Advisors Inc. effective September 4, 1991 and recorded in Buchanan County under DB474 / PG384.

Torch Oil & Gas Company
c/o Sue Ann Craddock
670 Dona Ana Road SW
Deming, New Mexico 88030

Effective 2/1/11, Torch Oil & Gas Company assigned a 2% ORRI to SAC Investments, L.P.

Effective 3/31/14, Torch Oil & Gas Company, et al. assigned and conveyed 10% of its right, title and interest to Rockport Oil & Gas, L.L.C. In addition, Torch Oil & Gas Company, et al. assigned and conveyed the remaining 90% of its right, title and interest to Chisos, Ltd.

Rockport Oil & Gas L.L.C. PO Box 847 Houston, TX 77001			n/a
Chisos, LTD 670 Dona Ana Road SW Deming, New Mexico 88030			n/a

OIL & GAS OWNERSHIP

(1) CNX Gas Company LLC 1000 Consol Energy Drive Canonsburg, PA 15317 <i>(previously Consolidation Coal Company)</i>	0.11 acres	0.0069%	n/a
---	------------	---------	-----

Tract #21 - 18.55 Acres

COAL OWNERSHIP

(1) Hugh MacRae Land Trust, Tr.5 c/o Alan Siegel Esq Gump, Strauss, Akin LLP 1 Bryant Park New York, NY 10036-6715	18.55 acres	1.1663%	n/a
--	-------------	---------	-----

By Assignment and Bill of Sale (Gas lease royalty), HMLT devised all of its right, title and interest (other than "Excluded Assets") to Torch Energy Advisors Inc. effective September 4, 1991 and recorded in Buchanan County under DB474 / PG384.

Torch Oil & Gas Company
c/o Sue Ann Craddock
670 Dona Ana Road SW
Deming, New Mexico 88030

Effective 2/1/11, Torch Oil & Gas Company assigned a 2% ORRI to SAC Investments, L.P.

Exhibit EE
Buchanan #1 South Sealed Gob Unit 1
Docket #VGOB 98-1117-0697-05
List of Respondents with Royalty Split Agreements/Court Orders/HB2058

	Net Acres in Unit	Interest in Unit	Percent of Escrow
--	----------------------	---------------------	----------------------

Effective 3/31/14, Torch Oil & Gas Company, et al. assigned and conveyed 10% of its right, title and interest to Rockport Oil & Gas, L.L.C. In addition, Torch Oil & Gas Company, et al. assigned and conveyed the remaining 90% of its right, title and interest to Chisos, Ltd.

Rockport Oil & Gas L.L.C.
 PO Box 847
 Houston, TX 77001

n/a

Chisos, LTD
 670 Dona Ana Road SW
 Deming, New Mexico 88030

n/a

OIL & GAS OWNERSHIP

(1) CNX Gas Company LLC 1000 Consol Energy Drive Canonsburg, PA 15317 <i>(previously Pocahontas Gas Partnership)</i>	18.55 acres	1.1663%	<i>n/a</i>
---	-------------	---------	------------

Tract #22 - 41.05 Acres

COAL OWNERSHIP

(1) Hugh MacRae Land Trust, Tr.5 c/o Alan Siegel Esq Gump, Strauss, Akin LLP 1 Bryant Park New York, NY 10036-6715	41.05 acres	2.5810%	<i>n/a</i>
--	-------------	---------	------------

Although the deed from Hugh Macrae Land Trust to Torch Operating Company conveyed the Coal owners' claim to the CBM estate to Torch Operating Company. The CBM ownership was adjudicated to the prevailing plaintiff Sarah Kathleen Wade under Civil Action Case #CL09-476 executed August 31, 2010. Royalties are to be paid 100% to the prevailing plaintiff.

Torch Operating Company
 c/o Sue Ann Craddock
 670 Dona Ana Road SW
 Deming, NM 88030

OIL & GAS OWNERSHIP

(1) Thurman Wade Heirs, Devisees, Successors or Assigns

(a) Sarah Kathleen Wade P. O. Box 225 Oakwood, VA 24631	41.05 acres	2.5810%	<i>n/a</i>
---	-------------	---------	------------

NOTE: Sarah Kathleen Wade is prevailing Plaintiff in Civil Action Case #CL09-476 and is awarded 100% of the Coalbed Methane Gas estate underlying Tract #22. All bonuses and/or royalties are to be paid to Sarah Kathleen Wade.

Tract #23 - 42.57 Acres

COAL OWNERSHIP

(1) Hugh MacRae Land Trust, Tr.5 c/o Alan Siegel Esq Gump, Strauss, Akin LLP 1 Bryant Park New York, NY 10036-6715	42.57 acres	2.6766%	<i>n/a</i>
--	-------------	---------	------------

By Assignment and Bill of Sale (Gas lease royalty), HMLT devised all of its right, title and interest (other than "Excluded Assets") to Torch Energy Advisors Inc. effective September 4, 1991 and recorded in Buchanan County under DB474 / PG384.

Torch Oil & Gas Company
 c/o Sue Ann Craddock
 670 Dona Ana Road SW
 Deming, New Mexico 88030

Effective 2/1/11, Torch Oil & Gas Company assigned a 2% ORRI to SAC Investments, L.P.

Effective 3/31/14, Torch Oil & Gas Company, et al. assigned and conveyed 10% of its right, title and interest to Rockport Oil &

Exhibit EE
Buchanan #1 South Sealed Gob Unit 1
Docket #VGOB 98-1117-0697-05
List of Respondents with Royalty Split Agreements/Court Orders/HB2058

	Net Acres in Unit	Interest in Unit	Percent of Escrow
<i>Gas, L.L.C. In addition, Torch Oil & Gas Company, et al. assigned and conveyed the remaining 90% of its right, title and interest to Chisos, Ltd.</i>			
Rockport Oil & Gas L.L.C. PO Box 847 Houston, TX 77001			<i>n/a</i>
Chisos, LTD 670 Dona Ana Road SW Deming, New Mexico 88030			<i>n/a</i>
<u>OIL & GAS OWNERSHIP</u>			
(1) CNX Gas Company LLC 1000 Consol Energy Drive Canonsburg, PA 15317 <i>(previously Pocahontas Gas Partnership)</i>	42.57 acres	2.6766%	<i>n/a</i>
<u>Tract #24 - 79.56 Acres</u>			
<u>COAL OWNERSHIP</u>			
(1) Hugh MacRae Land Trust, Tr.5 c/o Alan Siegel Esq Gump, Strauss, Akin LLP 1 Bryant Park New York, NY 10036-6715	79.56 acres	5.0024%	<i>n/a</i>
<i>By Assignment and Bill of Sale (Gas lease royalty), HMLT devised all of its right, title and interest (other than "Excluded Assets") to Torch Energy Advisors Inc. effective September 4, 1991 and recorded in Buchanan County under DB474 / PG384.</i>			
Torch Oil & Gas Company c/o Sue Ann Craddock 670 Dona Ana Road SW Deming, New Mexico 88030			
<i>Effective 2/1/11, Torch Oil & Gas Company assigned a 2% ORRI to SAC Investments, L.P.</i>			
<i>Effective 3/31/14, Torch Oil & Gas Company, et al. assigned and conveyed 10% of its right, title and interest to Rockport Oil & Gas, L.L.C. In addition, Torch Oil & Gas Company, et al. assigned and conveyed the remaining 90% of its right, title and interest to Chisos, Ltd.</i>			
Rockport Oil & Gas L.L.C. PO Box 847 Houston, TX 77001			<i>n/a</i>
Chisos, LTD 670 Dona Ana Road SW Deming, New Mexico 88030			<i>n/a</i>
<u>OIL & GAS OWNERSHIP</u>			
(1) Coal Mountain Mining Co., LLP. Tr 5 P. O. Box 230 Tazewell, VA 24651	79.56 acres	5.0024%	<i>n/a</i>
<u>Tract #27 - 57.61 Acres</u>			
<u>COAL OWNERSHIP</u>			
(1) Coal Mountain Mining Co., LLP P.O. Box 675 Tazewell, VA 24651	57.61 acres	3.6223%	<i>n/a</i>
<u>OIL & GAS OWNERSHIP</u>			
(1) Ernest Keene Heirs (aka Ernest Keen) 50 Acre Tract	57.61 acres	3.6223%	<i>n/a</i>
(a) Lula Sisk Keen Heirs, Devisees, Successors or Assigns <i>(1/3 interest passes to children)</i>			

Exhibit EE
Buchanan #1 South Sealed Gob Unit 1
Docket #VGOB 98-1117-0697-05
List of Respondents with Royalty Split Agreements/Court Orders/HB2058

	Net Acres in Unit	Interest in Unit	Percent of Escrow
(b) Ralph Keene Heirs, Devisees, Successors or Assigns			
(b.1) Grace Keen Heirs, Devisees, Successors or Assigns			
(b.1.1) Delores E. Estep 200 Summit Ave Lebanon, VA 24266	1.3717 acres 1/42 of 57.61 acre	0.0862%	<i>n/a</i>
(b.1.2) Darlene Bradley PO Box 503 Keen Mountain, VA 24624	1.3717 acres 1/42 of 57.61 acre	0.0862%	<i>n/a</i>
(b.1.3) Diana Lee Asbury PO Box 974 Lowell, NC 28098	1.3717 acres 1/42 of 57.61 acre	0.0862%	<i>n/a</i>
(b.1.4) Roy Earnest Keen 200 Summit Ave Lebanon, VA 24266	1.3717 acres 1/42 of 57.61 acre	0.0862%	<i>n/a</i>
(b.1.5) Ralph Douglas Keen PO Box 1121 Raven, VA 24639	1.3717 acres 1/42 of 57.61 acre	0.0862%	<i>n/a</i>
(b.1.6) Andy Glen Keen 4846 Quarterwood Rd Thaxton, VA 24174	1.3717 acres 1/42 of 57.61 acre	0.0862%	<i>n/a</i>
(b.1.7) Randy Lynn Keen 49 Lakeshore Terrace Hardy, VA 24101	1.3717 acres 1/42 of 57.61 acre	0.0862%	<i>n/a</i>
(c) Arnold J. Keene 962 Ascue Rd Cedar Bluff, VA 24609	9.60 acres 1/6 of 57.61 acre	0.6037%	<i>n/a</i>
(d) Paul Keene Heirs, Devisees, Successors or Assigns			
(d.1) Ralph Keene Heirs, Devisees, Successors or Assigns			
(d.1.1) Grace Keen Heirs, Devisees, Successors or Assigns			
(d.1.1.1) Delores E. Estep 200 Summit Ave Lebanon, VA 24266	0.2743 acres 1/210 of 57.61 acre	0.0172%	<i>n/a</i>
(d.1.1.2) Darlene Bradley PO Box 503 Keen Mountain, VA 24624	0.2743 acres 1/210 of 57.61 acre	0.0172%	<i>n/a</i>
(d.1.1.3) Diana Lee Asbury PO Box 974 Lowell, NC 28098	0.2743 acres 1/210 of 57.61 acre	0.0172%	<i>n/a</i>
(d.1.1.4) Roy Earnest Keen 200 Summit Ave Lebanon, VA 24266	0.2743 acres 1/210 of 57.61 acre	0.0172%	<i>n/a</i>
(d.1.1.5) Ralph Douglas Keen PO Box 1121 Raven, VA 24639	0.2743 acres 1/210 of 57.61 acre	0.0172%	<i>n/a</i>
(d.1.1.6) Andy Glen Keen 4846 Quarterwood Rd Thaxton, VA 24174	0.2743 acres 1/210 of 57.61 acre	0.0172%	<i>n/a</i>
(d.1.1.7) Randy Lynn Keen 49 Lakeshore Terrace Hardy, VA 24101	0.2743 acres 1/210 of 57.61 acre	0.0172%	<i>n/a</i>

Exhibit EE
Buchanan #1 South Sealed Gob Unit 1
Docket #VGOB 98-1117-0697-05
List of Respondents with Royalty Split Agreements/Court Orders/HB2058

	Net Acres in Unit	Interest in Unit	Percent of Escrow
(d.2) Arnold J. Keene 962 Ascue Rd Cedar Bluff, VA 24609	1.92 acres 1/30 of 57.61 acre	0.1207%	<i>n/a</i>
(d.3) Anna R. Lambert 182 Blankenship Dr N. Tazewell, VA 24630	1.92 acres 1/30 of 57.61 acre	0.1207%	<i>n/a</i>
(d.4) Ann McCowen Justice PO Box 677 Rosedale, VA 24280	1.92 acres 1/30 of 57.61 acre	0.1207%	<i>n/a</i>
(e) Ruby Hale Heirs, Devisees, Successors or Assigns	<i>Pre-deceased Paul Keene</i>		
(e.1) Carl Lee Hale 104 Third Ave Richlands, VA 24641	0.48 acres 1/120 of 57.61 acre	0.0302%	<i>n/a</i>
(e.2) Billy Ray Hale PO Box 311 Honaker, VA 24260	0.48 acres 1/120 of 57.61 acre	0.0302%	<i>n/a</i>
(e.3) Linda K Matney PO Box 738 Pounding Mill, VA 24637	0.48 acres 1/120 of 57.61 acre	0.0302%	<i>n/a</i>
(e.4) Brenda Weddle PO Box 852 Pounding Mill, VA 24637	0.48 acres 1/120 of 57.61 acre	0.0302%	<i>n/a</i>
(f) Ann McCowen Justice PO Box 677 Rosedale, VA 24280	9.60 acres 1/6 of 57.61 acre	0.6037%	<i>n/a</i>
(g) Ruby Hale Heirs, Devisees, Successors or Assigns			
(g.1) Billy Ray Hale PO Box 311 Honaker, VA 24260	2.40 acres 1/24 of 57.61 acre	0.1509%	<i>n/a</i>
(g.2) Linda K Matney PO Box 738 Pounding Mill, VA 24637	2.40 acres 1/24 of 57.61 acre	0.1509%	<i>n/a</i>
(g.3) Brenda Weddle PO Box 852 Pounding Mill, VA 24637	2.40 acres 1/24 of 57.61 acre	0.1509%	<i>n/a</i>
(g.4) Carl Lee Hale 104 Third Ave Richlands, VA 24641	2.40 acres 1/24 of 57.61 acre	0.1509%	<i>n/a</i>
(h) Anna Ruth Lambert 182 Blankenship Dr N. Tazewell, VA 24630	9.60 acres 1/6 of 57.61 acre	0.6037%	<i>n/a</i>

Tract #28 - 1.27 Acres

COAL OWNERSHIP

(1) Hugh MacRae Land Trust, Tr.5 c/o Alan Siegel Esq Gump, Strauss, Akin LLP 1 Bryant Park New York, NY 10036-6715	1.27 acres	0.0799%	<i>n/a</i>
--	------------	---------	------------

By Assignment and Bill of Sale (Gas lease royalty), HMLT devised all of its right, title and interest (other than "Excluded Assets") to Torch Energy Advisors Inc. effective September 4, 1991 and recorded in Buchanan County under DB474 / PG384.

Exhibit EE
Buchanan #1 South Sealed Gob Unit 1
Docket #VGOB 98-1117-0697-05
List of Respondents with Royalty Split Agreements/Court Orders/HB2058

	Net Acres in Unit	Interest in Unit	Percent of Escrow
--	----------------------	---------------------	----------------------

Torch Oil & Gas Company
c/o Sue Ann Craddock
670 Dona Ana Road SW
Deming, New Mexico 88030

Effective 2/1/11, Torch Oil & Gas Company assigned a 2% ORRI to SAC Investments, L.P.

Effective 3/31/14, Torch Oil & Gas Company, et al. assigned and conveyed 10% of its right, title and interest to Rockport Oil & Gas, L.L.C. In addition, Torch Oil & Gas Company, et al. assigned and conveyed the remaining 90% of its right, title and interest to Chisos, Ltd.

Rockport Oil & Gas L.L.C.
PO Box 847
Houston, TX 77001

n/a

Chisos, LTD
670 Dona Ana Road SW
Deming, New Mexico 88030

n/a

OIL & GAS OWNERSHIP

(1) Winfred L. Wade Heirs

(a) Edith Frances Wade
1026 Wade Rd
Raven, VA 24639

1.27 acres

0.0799%

n/a

Tract #30 - 20.06 Acres

COAL OWNERSHIP

(1) Hugh MacRae Land Trust, Tr.17
c/o Alan Siegel Esq
Gump, Strauss, Akin LLP
1 Bryant Park
New York, NY 10036-6715

20.06 acres

1.2613%

n/a

By Assignment and Bill of Sale (Gas lease royalty), HMLT devised all of its right, title and interest (other than "Excluded Assets") to Torch Energy Advisors Inc. effective September 4, 1991 and recorded in Buchanan County under DB474 / PG384.

Torch Oil & Gas Company
c/o Sue Ann Craddock
670 Dona Ana Road SW
Deming, New Mexico 88030

Effective 2/1/11, Torch Oil & Gas Company assigned a 2% ORRI to SAC Investments, L.P.

Effective 3/31/14, Torch Oil & Gas Company, et al. assigned and conveyed 10% of its right, title and interest to Rockport Oil & Gas, L.L.C. In addition, Torch Oil & Gas Company, et al. assigned and conveyed the remaining 90% of its right, title and interest to Chisos, Ltd.

Rockport Oil & Gas L.L.C.
PO Box 847
Houston, TX 77001

n/a

Chisos, LTD
670 Dona Ana Road SW
Deming, New Mexico 88030

n/a

OIL & GAS OWNERSHIP

(1) **Earl & Nellie Marshall Heirs**
25.00 Acres

20.06 acres

1.2613%

(a) Earl Marshall Heirs, Devisees,
Successors or Assigns

(a.1) Nellie Jackson Marshall Heirs, Devisees,
Successors or Assigns

Life Estate Extinguished

(a.1.1) Wanda Marshall Ritchie Heirs, Devisees,
Successors or assigns

Exhibit EE
Buchanan #1 South Sealed Gob Unit 1
Docket #VGOB 98-1117-0697-05
List of Respondents with Royalty Split Agreements/Court Orders/HB2058

	Net Acres in Unit	Interest in Unit	Percent of Escrow
(a.1.1.1) Charles L. Ritchie	<i>Conveyed by quitclaim deed 7/30/11 Instrument 11-2643</i>		
(a.1.1.1.1) Rebecca I. Ritchie Hale 1509 Kentucky Ave Bristol, TN 37620	10.03 acres 1/2 of 20.06 acres	0.6306%	<i>n/a</i>
(b) Nellie Jackson Marshall Heirs, Devisees, Successors or Assigns			
(b.1) Herbert Lawrence Jackson Heirs, Devisees, Successors or Assigns			
(b.1.1) Jerry W. Jackson	<i>Conveyed by quitclaim deed 2/4/09 Instrument 09-0565</i>		
(b.1.1.1) Rebecca I. Ritchie Hale 1509 Kentucky Ave Bristol, TN 37620	2.51 acres 1/8 of 20.06 acres	0.1577%	<i>n/a</i>
(b.2) Lowery Lee Jackson Heirs, Devisees, Successors or Assigns			
(b.2.1) Ruth Jackson	<i>Conveyed 2/26/08 Instrument 08-1526</i>		
(b.2.1.1) Jerry W. Jackson	<i>Conveyed by quitclaim deed 2/4/09 Instrument 09-0565</i>		
(b.2.1.1.1) Rebecca I. Ritchie Hale 1509 Kentucky Ave Bristol, TN 37620	2.51 acres 1/8 of 20.06 acres	0.1577%	4.2344% HB2058
(b.3) Wanda Marshall Ritchie Heirs, Devisees, Successors or Assigns			
(b.3.1) Charles L. Ritchie	<i>Conveyed by quitclaim deed 7/30/11 Instrument 11-2643</i>		
(b.3.1.1) Rebecca I. Ritchie Hale 1509 Kentucky Ave Bristol, TN 37620	2.51 acres 1/8 of 20.06 acres	0.1577%	<i>n/a</i>
(b.4) Corbit Jackson Heirs, Devisees, Successors or Assigns <i>D.O.D 6/18/2008 Instrument 08-0207*</i>			
(b.4.1) Jerry W. Jackson	<i>Conveyed by quitclaim deed 2/4/09 Instrument 09-0565</i>		
(b.4.1.1) Rebecca I. Ritchie Hale 1509 Kentucky Ave Bristol, TN 37620	2.51 acres 1/8 of 20.06 acres	0.1577%	4.2344% HB2058

* Instrument 08-0207
Pursuant to Article IV, Item 2 of the Last Will & Testament of Corbit Jackson, any money held in escrow at the time of his death passes to his six grandchildren listed below: (D.O.D. 6/18/2008)

***The grandchildren of Corbit Jackson are due a one time payment from escrow for funds accumulated up to the date of his death*

John Radliff 38416 Valley Ridge Place Hamilton, VA 20158	0.42 acres 1/48 of 20.06 acres	0.0263%	0.1573% HB2058
Michael Hess 109 Aldie Burn Ct Stephens City, VA 22655	0.42 acres 1/48 of 20.06 acres	0.0263%	0.1573% HB2058
Beth Underhill 243 Forest Ct Bentonville, VA 22610	0.42 acres 1/48 of 20.06 acres	0.0263%	0.1573% HB2058
David Hess 6103 Wild Pear Lane Crozet, VA 22932	0.42 acres 1/48 of 20.06 acres	0.0263%	0.1573% HB2058
Jeff Jackson	0.42 acres	0.0263%	0.1573%

Exhibit EE
Buchanan #1 South Sealed Gob Unit 1
Docket #VGOB 98-1117-0697-05
List of Respondents with Royalty Split Agreements/Court Orders/HB2058

	Net Acres in Unit	Interest in Unit	Percent of Escrow
1001 E. 35th St Charlotte, NC 28205	1/48 of 20.06 acres		HB2058
Julia Chitester Jackson 2212 E. 8th St Charlotte, NC 28204	0.42 acres 1/48 of 20.06 acres	0.0263%	0.1573% HB2058
Total tract acres	20.06		
Total tract percent		1.2613%	

Tract #31 - 19.31 Acres

COAL OWNERSHIP

(1) Hugh MacRae Land Trust, Tr.17 c/o Alan Siegel Esq Gump, Strauss, Akin LLP 1 Bryant Park New York, NY 10036-6715	19.31 acres	1.2141%	n/a
---	-------------	---------	-----

By Assignment and Bill of Sale (Gas lease royalty), HMLT devised all of its right, title and interest (other than "Excluded Assets") to Torch Energy Advisors Inc. effective September 4, 1991 and recorded in Buchanan County under DB474 / PG384.

Torch Oil & Gas Company
c/o Sue Ann Craddock
670 Dona Ana Road SW
Deming, New Mexico 88030

Effective 2/1/11, Torch Oil & Gas Company assigned a 2% ORRI to SAC Investments, L.P.

Effective 3/31/14, Torch Oil & Gas Company, et al. assigned and conveyed 10% of its right, title and interest to Rockport Oil & Gas, L.L.C. In addition, Torch Oil & Gas Company, et al. assigned and conveyed the remaining 90% of its right, title and interest to Chisos, Ltd.

Rockport Oil & Gas L.L.C. PO Box 847 Houston, TX 77001	n/a
--	-----

Chisos, LTD 670 Dona Ana Road SW Deming, New Mexico 88030	n/a
---	-----

OIL & GAS OWNERSHIP

(1) CNX Gas Company LLC 1000 Consol Energy Drive Canonsburg, PA 15317 <i>(previously Pocahontas Gas Partnership)</i>	19.31 acres	1.2141%	n/a
---	-------------	---------	-----

Tract #33 - 19.07 Acres

COAL OWNERSHIP

(1) Hugh MacRae Land Trust, Tr.17 c/o Alan Siegel Esq Gump, Strauss, Akin LLP 1 Bryant Park New York, NY 10036-6715	19.07 acres	1.1990%	n/a
---	-------------	---------	-----

By Assignment and Bill of Sale (Gas lease royalty), HMLT devised all of its right, title and interest (other than "Excluded Assets") to Torch Energy Advisors Inc. effective September 4, 1991 and recorded in Buchanan County under DB474 / PG384.

Torch Oil & Gas Company
c/o Sue Ann Craddock
670 Dona Ana Road SW
Deming, New Mexico 88030

Effective 2/1/11, Torch Oil & Gas Company assigned a 2% ORRI to SAC Investments, L.P.

Effective 3/31/14, Torch Oil & Gas Company, et al. assigned and conveyed 10% of its right, title and interest to Rockport Oil & Gas, L.L.C. In addition, Torch Oil & Gas Company, et al. assigned and conveyed the remaining 90% of its right, title and interest to Chisos, Ltd.

Exhibit EE
Buchanan #1 South Sealed Gob Unit 1
Docket #VGOB 98-1117-0697-05
List of Respondents with Royalty Split Agreements/Court Orders/HB2058

	Net Acres in Unit	Interest in Unit	Percent of Escrow
Rockport Oil & Gas L.L.C. PO Box 847 Houston, TX 77001			n/a
Chisos, LTD 670 Dona Ana Road SW Deming, New Mexico 88030			n/a

OIL & GAS OWNERSHIP

(1) Bobby Steele Box 1153 Raven, VA 24639	19.07 acres	1.1990%	n/a
---	-------------	---------	-----

Tract #34 - 0.77 Acres

COAL OWNERSHIP

(1) Hugh MacRae Land Trust, Tr.17 c/o Alan Siegel Esq Gump, Strauss, Akin LLP 1 Bryant Park New York, NY 10036-6715	0.77 acres	0.0484%	n/a
---	------------	---------	-----

By Assignment and Bill of Sale (Gas lease royalty), HMLT devised all of its right, title and interest (other than "Excluded Assets") to Torch Energy Advisors Inc. effective September 4, 1991 and recorded in Buchanan County under DB474 / PG384.

Torch Oil & Gas Company
c/o Sue Ann Craddock
670 Dona Ana Road SW
Deming, New Mexico 88030

Effective 2/1/11, Torch Oil & Gas Company assigned a 2% ORRI to SAC Investments, L.P.

Effective 3/31/14, Torch Oil & Gas Company, et al. assigned and conveyed 10% of its right, title and interest to Rockport Oil & Gas, L.L.C. In addition, Torch Oil & Gas Company, et al. assigned and conveyed the remaining 90% of its right, title and interest to Chisos, Ltd.

Rockport Oil & Gas L.L.C. PO Box 847 Houston, TX 77001			n/a
Chisos, LTD 670 Dona Ana Road SW Deming, New Mexico 88030			n/a

OIL & GAS OWNERSHIP

(1) Grady Horn PO Box 782 Raven, VA 24639	0.77 acres	0.0484%	1.3003% HB2058
---	------------	---------	-------------------

Tract #35 - 1.78 Acres

COAL OWNERSHIP

(1) Hugh MacRae Land Trust, Tr.17 c/o Alan Siegel Esq Gump, Strauss, Akin LLP 1 Bryant Park New York, NY 10036-6715	1.78 acres	0.1119%	n/a
---	------------	---------	-----

By Assignment and Bill of Sale (Gas lease royalty), HMLT devised all of its right, title and interest (other than "Excluded Assets") to Torch Energy Advisors Inc. effective September 4, 1991 and recorded in Buchanan County under DB474 / PG384.

Torch Oil & Gas Company
c/o Sue Ann Craddock
670 Dona Ana Road SW
Deming, New Mexico 88030

Effective 2/1/11, Torch Oil & Gas Company assigned a 2% ORRI to SAC Investments, L.P.

Exhibit EE
Buchanan #1 South Sealed Gob Unit 1
Docket #VGOB 98-1117-0697-05
List of Respondents with Royalty Split Agreements/Court Orders/HB2058

	Net Acres in Unit	Interest in Unit	Percent of Escrow
<i>Effective 3/31/14, Torch Oil & Gas Company, et al. assigned and conveyed 10% of its right, title and interest to Rockport Oil & Gas, L.L.C. In addition, Torch Oil & Gas Company, et al. assigned and conveyed the remaining 90% of its right, title and interest to Chisos, Ltd.</i>			
Rockport Oil & Gas L.L.C. PO Box 847 Houston, TX 77001			n/a
Chisos, LTD 670 Dona Ana Road SW Deming, New Mexico 88030			n/a

OIL & GAS OWNERSHIP

(1) Kermit & Ruth Steele Heirs, Devisees, Successors or Assigns	1.78 acres	0.1119%	
(a) Kermit Q. Steele Heirs, Devisees, Successors or Assigns			
(a.1) Ruth E. Steele Messer Heirs, Devisees, Successors or Assigns			
(b) Ruth E. Steele Messer Heirs, Devisees, Successors or Assigns			
(b.1) Bobby W. Steele PO Box 1153 Raven, VA 24639	0.45 acres 1/4 of 1.78 acres	0.0280%	0.7515% HB2058
(b.2) James D. Steele PO Box 785 Max Meadows, VA 24360	0.45 acres 1/4 of 1.78 acres	0.0280%	0.7515% HB2058
(b.3) Judy Steele Horne 190 Drews Lane Cedar Bluff, VA 24609	0.45 acres 1/4 of 1.78 acres	0.0280%	0.7515% HB2058
(b.4) Tamara Altizer 4630 Twelveoaks Rd. Midlothian, VA 23112	0.45 acres 1/4 of 1.78 acres	0.0280%	0.7515% HB2058

Tract #36A - 0.11 Acres

COAL OWNERSHIP

(1) Hugh MacRae Land Trust, Tr.17 c/o Alan Siegel Esq Gump, Strauss, Akin LLP 1 Bryant Park New York, NY 10036-6715	0.11 acres	0.0069%	n/a
---	------------	---------	-----

By Assignment and Bill of Sale (Gas lease royalty), HMLT devised all of its right, title and interest (other than "Excluded Assets") to Torch Energy Advisors Inc. effective September 4, 1991 and recorded in Buchanan County under DB474 / PG384.

Torch Oil & Gas Company
c/o Sue Ann Craddock
670 Dona Ana Road SW
Deming, New Mexico 88030

Effective 2/1/11, Torch Oil & Gas Company assigned a 2% ORRI to SAC Investments, L.P.

Effective 3/31/14, Torch Oil & Gas Company, et al. assigned and conveyed 10% of its right, title and interest to Rockport Oil & Gas, L.L.C. In addition, Torch Oil & Gas Company, et al. assigned and conveyed the remaining 90% of its right, title and interest to Chisos, Ltd.

Rockport Oil & Gas L.L.C. PO Box 847 Houston, TX 77001			n/a
Chisos, LTD 670 Dona Ana Road SW Deming, New Mexico 88030			n/a

Exhibit EE
Buchanan #1 South Sealed Gob Unit 1
Docket #VGOB 98-1117-0697-05
List of Respondents with Royalty Split Agreements/Court Orders/HB2058

	Net Acres in Unit	Interest in Unit	Percent of Escrow
<u>OIL & GAS OWNERSHIP</u>			
(1) Alta Ferrell Heirs, Devisees, Successors of Assigns	0.11 acres	0.0069%	
(a) Caroline B. Davis Heirs, Devisees, Successors or Assigns			
(a.1) John Douglas Davis 2146 Old Ky Tpk Raven, VA 24639	0.0021 acres 1/52 of 0.11 acres	0.0001%	<i>n/a</i>
(b) Margie Sparks Heirs, Devisees, Successors or Assigns			
(b.2) Cleo Preskewitz 955 E 9th St Rochester, IN 46579	0.0006 acres 2/351 of 0.11 acres	0.00004%	0.0011% HB2058
(b.3) Ruby Schroll (predeceased daughter)			
(b.3.1) Dawn E. McElfresh 714 W. Virginia Ave Kokomo, IN 46902	0.0003 acres 1/351 of 0.11 acres	0.00002%	0.0005% HB2058
(b.4) Gaynell Fry 365 Boulevard St Peru, IN 46970	0.0006 acres 2/351 of 0.11 acres	0.00004%	0.0011% HB2058
(b.5) Ruth V. Lowe 1307 Wabash St Rochester, IN 46975	0.0006 acres 2/351 of 0.11 acres	0.00004%	0.0011% HB2058
(b.6) Carol Pocock 1148 W 6th St Rochester, IN 46975	0.0006 acres 2/351 of 0.11 acres	0.00004%	0.0011% HB2058
(b.7) Patricia Darlene Drudge PO Box 303 Akron, IN 46910	0.0006 acres 2/351 of 0.11 acres	0.00004%	0.0011% HB2058
(b.9) Dana Sparks Heirs, Devisees, Successors or Assigns			
(b.9.1) Cleo Preskewitz 955 E 9th St Rochester, IN 46579	0.0001 acres 1/1404 of 0.11 acres	0.000005%	0.0001% HB2058
(b.9.2) Ruby Schroll (predeceased daughter)			
(b.9.2.1) Dawn E. McElfresh 714 W. Virginia Ave Kokomo, IN 46902	0.00004 acres 1/2808 of 0.11 acres	0.000002%	0.0001% HB2058
(b.9.3) Gaynell Fry 365 Boulevard St Peru, IN 46970	0.0001 acres 1/1404 of 0.11 acres	0.000005%	0.0001% HB2058
(b.9.4) Ruth V. Lowe 1307 Wabash St Rochester, IN 46975	0.0001 acres 1/1404 of 0.11 acres	0.000005%	0.0001% HB2058
(b.9.5) Carol Pocock 1148 W 6th St Rochester, IN 46975	0.0001 acres 1/1404 of 0.11 acres	0.000005%	0.0001% HB2058
(b.9.6) Patricia Darlene Drudge PO Box 303 Akron, IN 46910	0.0001 acres 1/1404 of 0.11 acres	0.000005%	0.0001% HB2058
(c) Mary K. Honaker Heirs, Devisees,			

Exhibit EE
Buchanan #1 South Sealed Gob Unit 1
Docket #VGOB 98-1117-0697-05
List of Respondents with Royalty Split Agreements/Court Orders/HB2058

	Net Acres in Unit	Interest in Unit	Percent of Escrow
Successors or Assigns			
(c.1) Jeanne Garrett 966 Maple Glen Drive Conover, NC 28613	0.0012 acres 1/91 of 0.11 acres	0.0001%	0.0020% HB2058
(c.2) Yvonne White 7802 Long Island Rd Catawba, NC 28609	0.0012 acres 1/91 of 0.11 acres	0.0001%	0.0020% HB2058
(c.3) Debra Estes 3316 6th Ave NE Conover, NC 28613	0.0012 acres 1/91 of 0.11 acres	0.0001%	0.0020% HB2058
(c.5) Lonnie Honaker 234 Blackhills Rd Cedar Bluff, VA 24609	0.0012 acres 1/91 of 0.11 acres	0.0001%	0.0020% HB2058
(d) Flora French Heirs, Devisees, Successors or Assigns			
(d.2) Sylvia McGlothlin PO Box 71 Cedar Bluff, VA 24609	0.0028 acres 1/39 of 0.11 acres	0.0002%	0.0048% HB2058
(d.3) Charlotte Robinette 7862 Sarah Dr Denver, NC 28037	0.0028 acres 1/39 of 0.11 acres	0.0002%	0.0048% HB2058
(f) Clarence Ferrell Heirs, Devisees, Successors or Assigns			
(f.1) Theodosia M. Ferrell Heirs, Devisees, Successors or Assigns			
(f.1.3) Eli See Ferrell 2057 Conaway Rd Big Rock, VA 24603	0.0005 acres 1/234 of 0.11 acres	0.00003%	0.0008% HB2058
(f.1.6) Teddy Ferrell 30194 Blue Springs Rd Meadowview, VA 24631	0.0005 acres 1/234 of 0.11 acres	0.00003%	0.0008% HB2058
(k) Margaret Wilkes Heirs, Devisees, Successors or Assigns			
(k.3) Michael Ellis Wilkes 929 Hulana St Rossville, GA 30741	0.0017 acres 1/65 of 0.11 acres	0.0001%	0.0029% HB2058
(k.4) Janet M. Willett 1642 Osburn Rd Chickamauga, GA 30707	0.0017 acres 1/65 of 0.11 acres	0.0001%	0.0029% HB2058
	Tract Acres 0.0208		
	Tract Percentage 0.0013%		

Tract #37 - 0.64 Acres

COAL OWNERSHIP

(1) Hugh MacRae Land Trust, Tr.17 c/o Alan Siegel Esq Gump, Strauss, Akin LLP 1 Bryant Park New York, NY 10036-6715	0.64 acres	0.0402%	n/a
---	------------	---------	-----

By Assignment and Bill of Sale (Gas lease royalty), HMLT devised all of its right, title and interest (other than "Excluded Assets") to Torch Energy Advisors Inc. effective September 4, 1991 and recorded in Buchanan County under DB474 / PG384.

Torch Oil & Gas Company
c/o Sue Ann Craddock
670 Dona Ana Road SW

Exhibit EE
Buchanan #1 South Sealed Gob Unit 1
Docket #VGOB 98-1117-0697-05
List of Respondents with Royalty Split Agreements/Court Orders/HB2058

	Net Acres in Unit	Interest in Unit	Percent of Escrow
Deming, New Mexico 88030			
<i>Effective 2/1/11, Torch Oil & Gas Company assigned a 2% ORRI to SAC Investments, L.P.</i>			
<i>Effective 3/31/14, Torch Oil & Gas Company, et al. assigned and conveyed 10% of its right, title and interest to Rockport Oil & Gas, L.L.C. In addition, Torch Oil & Gas Company, et al. assigned and conveyed the remaining 90% of its right, title and interest to Chisos, Ltd.</i>			
Rockport Oil & Gas L.L.C. PO Box 847 Houston, TX 77001			<i>n/a</i>
Chisos, LTD 670 Dona Ana Road SW Deming, New Mexico 88030			<i>n/a</i>
<u>OIL & GAS OWNERSHIP</u>			
(1) CNX Gas Company LLC 1000 Consol Energy Drive Canonsburg, PA 15317 <i>(previously Pocahontas Gas Partnership)</i>	0.64 acres	0.0402%	<i>n/a</i>
<u>Tract #38 - 1.56 Acres</u>			
<u>COAL OWNERSHIP</u>			
(1) Coal Mountain Mining Co., LLP, Tr. 24 P.O. Box 675 Tazewell, VA 24651	1.56 acres	0.0981%	<i>n/a</i>
<u>OIL & GAS OWNERSHIP</u>			
(1) Garden Realty Coal Corp 108 Bexley Rd Mooresville, NC 28117	1.56 acres	0.0981%	<i>n/a</i>
<u>Tract #39 - 55.74 Acres</u>			
<u>COAL OWNERSHIP</u>			
(1) Coal Mountain Mining Co., LLP, Tr. 17 P.O. Box 675 Tazewell, VA 24651	55.74 acres	3.5047%	<i>n/a</i>
<u>OIL & GAS OWNERSHIP</u>			
(1) Yukon Pocahontas Coal Company, et al., Tr.112	55.74 acres	3.5047%	<i>n/a</i>
(a) Yukon Pocahontas Coal Company P.O. Box 187 Tazewell, VA 24651	27.87 acres 1/2 of 55.74 acres	1.7523%	<i>n/a</i>
(b) Buchanan Coal Company P.O. Box 187 Tazewell, VA 24651	6.19 acres 1/9 of 55.74 acres	0.3894%	<i>n/a</i>
(c) Sayers-Pocahontas Coal Company P.O. Box 187 Tazewell, VA 24651	3.10 acres 1/18 of 55.74 acres	0.1947%	<i>n/a</i>
(d) Highland Resources, Inc/ North American Resources, Corp. * 100 Peachtree Street NW, Suite 2650 Atlanta, GA 30303	18.58 acres 1/3 of 55.74 acres	1.1682%	<i>n/a</i>

Royalties Payable to:

Plum Creek Timberlands, LP
Attn: Mineral Department
Five Concourse Parkway, Suite 1650
Atlanta, GA 30328

* Note: Plum Creek Timberlands retained their CBM interest.

Exhibit EE
 Buchanan #1 South Sealed Gob Unit 1
 Docket #VGOB 98-1117-0697-05
 List of Respondents with Royalty Split Agreements/Court Orders/HB2058

	Net Acres in Unit	Interest in Unit	Percent of Escrow
--	----------------------	---------------------	----------------------

Highland Resources, Inc/North American Resource, Corp is owner of the Oil & Gas estates.

Total tract acres 55.74
Total tract percent 3.5047%

Tract #42 - 37.15 Acres

COAL OWNERSHIP

(1) Coal Mountain Mining Co., LLP, Tr. 23 P.O. Box 675 Tazewell, VA 24651	37.15 acres	2.3358%	<i>n/a</i>
---	-------------	---------	------------

OIL & GAS OWNERSHIP

(1) Terry Baldwin Heirs, Devisees, Successors or Assigns	37.15 acres		
(a) Matthew Baldwin P.O. Box 531 Oakwood, VA 24631	18.58 acres 1/2 of 37.15 acres	1.1679%	<i>n/a</i>
(b) Amanda Leigh Baldwin-Estep 24437 Mock Knob Rd Abingdon, VA 24211	18.58 acres 1/2 of 37.15 acres	1.1679%	<i>n/a</i>

Total tract acres 37.15
Total tract percent 2.3358%

Tract #43 - 31.48 Acres

COAL OWNERSHIP

(1) Coal Mountain Mining Co., LLP, Tr. 5 P.O. Box 675 Tazewell, VA 24651	31.48 acres	1.9793%	<i>n/a</i>
--	-------------	---------	------------

OIL & GAS OWNERSHIP

(1) Terry Baldwin Heirs, Devisees, Successors or Assigns	31.48 acres		
(a) Matthew Baldwin P.O. Box 531 Oakwood, VA 24631	15.74 acres 1/2 of 37.15 acres	0.9897%	<i>n/a</i>
(b) Amanda Leigh Baldwin-Estep 24437 Mock Knob Rd Abingdon, VA 24211	15.74 acres 1/2 of 37.15 acres	0.9897%	<i>n/a</i>

Total tract acres 31.48
Total tract percent 1.9793%

Tract #45 - 65.40 Acres

COAL OWNERSHIP

(1) Coal Mountain Mining Co., LLP, Tr. 5 P.O. Box 675 Tazewell, VA 24651	65.40 acres	4.1121%	<i>n/a</i>
--	-------------	---------	------------

OIL & GAS OWNERSHIP

(1) Gary Davis, et al	65.40 acres	4.1121%	<i>n/a</i>
(a) Gary Davis P.O. Box 47 Short Gap, VA 24627	26.16 acres 2/5 of 65.40 acres	1.6448%	<i>n/a</i>
(b) Larry Wayne Davis P.O. Box 183 Pounding Mill, VA 24637	13.08 acres 1/5 of 65.40 acres	0.8224%	<i>n/a</i>

Exhibit EE
 Buchanan #1 South Sealed Gob Unit 1
 Docket #VGOB 98-1117-0697-05
 List of Respondents with Royalty Split Agreements/Court Orders/HB2058

	Net Acres in Unit	Interest in Unit	Percent of Escrow
(c) Buford Davis Rt. 1 Box 190 Pounding Mill, VA 24637	13.08 acres 1/5 of 65.40 acres	0.8224%	n/a
(d) Ruth Boyd P.O. Box 127 Grottoes, VA 24441	13.08 acres 1/5 of 65.40 acres	0.8224%	n/a
Total tract acres	65.40		
Total tract percent	4.1121%		

Tract #49 - 2.99 Acres

COAL OWNERSHIP

(1) Buchanan Mining Co LLC 3337 Contrary Creek Rd Raven, VA 24637	2.99 acres	0.1880%	n/a
---	------------	---------	-----

OIL & GAS OWNERSHIP

(1) CNX Gas Company LLC 1000 Consol Energy Drive Canonsburg, PA 15317 <i>(previously Consolidation Coal Company)</i>	2.99 acres	0.1880%	n/a
---	------------	---------	-----

Tract #50 - 1.13 Acres

COAL OWNERSHIP

(1) Coal Mountain Mining Co., LLP, Tr. 14 P.O. Box 675 Tazewell, VA 24651	1.13 acres	0.0710%	n/a
---	------------	---------	-----

OIL & GAS OWNERSHIP

(1) Elizabeth Ann Justice P.O. Box 677 Rosedale, VA 24280 <i>(formerly Roy & Ann McCowan. Roy McCowan is deceased and Ann remarried.)</i>	1.13 acres	0.0710%	n/a
--	------------	---------	-----

Tract #51 - 0.55 Acres

COAL OWNERSHIP

(1) Coal Mountain Mining Co., LLP, Tr. 14 P.O. Box 675 Tazewell, VA 24651	0.55 acres	0.0346%	n/a
---	------------	---------	-----

OIL & GAS OWNERSHIP

(1) Anna R. Lambert 182 Blankenship Drive North Tazewell, VA 24630	0.55 acres	0.0346%	n/a
--	------------	---------	-----

Tract #52 - 0.23 Acres

COAL OWNERSHIP

(1) Coal Mountain Mining Co., LLP, Tr. 14 P.O. Box 675 Tazewell, VA 24651	0.23 acres	0.0145%	0.1942% Royalty Division Agreement
---	------------	---------	--

OIL & GAS OWNERSHIP

(1) Ralph Keene Heirs, Devisees, Successors or Assigns	0.23 acres	0.0145%	
(a.1) Grace Keen Heirs, Devisees, Successors or Assigns			
(a.1.1) Delores E. Estep	0.0329 acres	0.0021%	0.0277%

Exhibit EE
Buchanan #1 South Sealed Gob Unit 1
Docket #VGOB 98-1117-0697-05
List of Respondents with Royalty Split Agreements/Court Orders/HB2058

	Net Acres in Unit	Interest in Unit	Percent of Escrow
200 Summit Ave Lebanon, VA 24266	1/7 of 0.23 acres		Royalty Division Agreement
(a.1.2) Darlene Bradley PO Box 503 Keen Mountain, VA 24624	0.0329 acres 1/7 of 0.23 acres	0.0021%	0.0277% Royalty Division Agreement
(a.1.3) Diana Lee Asbury PO Box 974 Lowell, NC 28098	0.0329 acres 1/7 of 0.23 acres	0.0021%	0.0277% Royalty Division Agreement
(a.1.4) Roy Earnest Keen 200 Summit Ave Lebanon, VA 24266	0.0329 acres 1/7 of 0.23 acres	0.0021%	0.0277% Royalty Division Agreement
(a.1.5) Ralph Douglas Keen PO Box 1121 Raven, VA 24639	0.0329 acres 1/7 of 0.23 acres	0.0021%	0.0277% Royalty Division Agreement
(a.1.6) Andy Glen Keen 4846 Quarterwood Rd Thaxton, VA 24174	0.0329 acres 1/7 of 0.23 acres	0.0021%	0.0277% Royalty Division Agreement
(a.1.7) Randy Lynn Keen 49 Lakeshore Terrace Hardy, VA 24101	0.0329 acres 1/7 of 0.23 acres	0.0021%	0.0277% Royalty Division Agreement

Tract #53 - 11.56 Acres

COAL OWNERSHIP

(1) Hugh MacRae Land Trust, Tr.17 c/o Alan Siegel Esq Gump, Strauss, Akin LLP 1 Bryant Park New York, NY 10036-6715	11.56 acres	0.7268%	n/a
---	-------------	---------	-----

By Assignment and Bill of Sale (Gas lease royalty), HMLT devised all of its right, title and interest (other than "Excluded Assets") to Torch Energy Advisors Inc. effective September 4, 1991 and recorded in Buchanan County under DB474 / PG384.

Torch Oil & Gas Company
c/o Sue Ann Craddock
670 Dona Ana Road SW
Deming, New Mexico 88030

Effective 2/1/11, Torch Oil & Gas Company assigned a 2% ORRI to SAC Investments, L.P.

Effective 3/31/14, Torch Oil & Gas Company, et al. assigned and conveyed 10% of its right, title and interest to Rockport Oil & Gas, L.L.C. In addition, Torch Oil & Gas Company, et al. assigned and conveyed the remaining 90% of its right, title and interest to Chisos, Ltd.

Rockport Oil & Gas L.L.C.
PO Box 847
Houston, TX 77001

Chisos, LTD
670 Dona Ana Road SW
Deming, New Mexico 88030

OIL & GAS OWNERSHIP

(1) CNX Gas Company LLC 1000 Consol Energy Drive Canonsburg, PA 15317 <i>(previously Consolidation Coal Company)</i>	11.56 acres	0.7268%	n/a
---	-------------	---------	-----

TOTALS:

Total Acreage in Unit	754.19	
Total Percentage of Unit		47.4203%

Exhibit J
Unit BUCHISGU1 Escrow Account Reconciliation
VGOB 98-1117-0696 and 98-1117-0697

CNX Deposit Information		
Check Date	Check Number	Total
5/25/2000		\$6,400.58
6/23/2000		\$4,162.51
7/25/2000		\$4,439.18
8/25/2000		\$7,413.72
9/25/2000		\$6,758.28
10/25/2000		\$6,107.23
11/21/2000		\$8,060.71
12/22/2000		\$8,603.17
1/25/2001		\$6,828.88
2/23/2001		\$10,079.12
3/23/2001		\$14,863.48
4/25/2001		\$8,330.48
5/25/2001		\$7,489.52
6/25/2001		\$7,690.46
7/25/2001		\$6,731.30
8/10/2001		\$12.62
8/24/2001		\$4,444.04
9/25/2001		\$3,545.36
10/25/2001		\$3,427.90
11/21/2001		\$1,858.42
12/21/2001		\$1,785.36
1/25/2002		\$1,678.86
2/25/2002		\$2,253.62
3/25/2002		\$1,992.64
4/25/2002		\$1,813.93
5/24/2002		\$1,844.52
6/25/2002		\$2,451.10
7/25/2002		\$2,261.33
8/23/2002		\$2,157.11
9/25/2002		\$2,907.84
10/25/2002		\$3,215.34
11/25/2002		\$3,096.54
12/24/2002		\$3,169.66
1/24/2003		\$3,813.01
2/25/2003		\$4,289.89
3/25/2003		\$4,068.75
4/25/2003		\$3,372.00
5/23/2003		\$4,442.17
6/25/2003		\$4,160.00
7/25/2003		\$3,706.33
8/25/2003		\$3,566.94
9/25/2003		\$3,514.72
10/24/2003		\$3,729.60
11/25/2003		\$3,677.31
12/24/2003		\$5,069.12
1/23/2004		\$3,571.38
2/25/2004		\$4,117.04
3/25/2004		\$6,029.58
4/23/2004		\$5,261.55
5/25/2004		\$6,061.81
6/25/2004		\$6,099.22
7/23/2004		\$5,943.68
8/25/2004		\$6,317.94
9/24/2004		\$5,958.08
10/25/2004		\$6,310.40
11/24/2004		\$4,443.28

Escrow Bank Data														
Date	Escrow Royalty Deposits	Income	\$ Mrket Int	CDARS Int	Fees	Distributions	Audit Costs	Corrections	Gain/Loss	Royalty Bonus	Total Int. and Fees	Bank Balance	Running Balance	Difference
4/30/2000	\$11.03	\$0.04									\$0.04	\$11.07	\$0.04	\$11.03
5/31/2000	\$6,400.58	\$27.97									\$27.97	\$6,439.62	\$6,428.59	\$11.03
6/30/2000	\$4,162.51	\$42.98									\$42.98	\$10,645.11	\$10,634.08	\$11.03
7/31/2000	\$4,439.18	\$63.84									\$63.84	\$15,148.13	\$15,137.10	\$11.03
8/31/2000	\$7,510.72	\$95.14									\$95.14	\$22,656.99	\$22,645.96	\$11.03
9/30/2000	\$6,758.28	\$115.91									\$115.91	\$29,531.18	\$29,520.15	\$11.03
10/31/2000	\$6,107.23	\$161.83									\$161.83	\$35,800.24	\$35,789.21	\$11.03
11/30/2000											\$0.00		\$43,849.92	-\$43,849.92
12/31/2000	\$8,603.17	\$203.14									\$203.14	\$52,850.21	\$52,656.23	\$193.98
1/31/2001	\$6,828.88	\$223.64									\$223.64	\$59,902.73	\$59,708.75	\$193.98
2/28/2001	\$16,908.00	\$430.89									\$430.89	\$70,189.10	\$70,218.76	-\$29.66
3/31/2001	\$14,824.16	\$222.79									\$222.79	\$85,236.05	\$85,305.03	-\$68.98
4/25/2001											\$0.00		\$93,635.51	-\$93,635.51
5/31/2001	\$7,489.52	\$257.07									\$257.07	\$101,577.90	\$101,382.10	\$195.80
6/30/2001	\$7,691.49	\$232.83									\$232.83	\$109,502.22	\$109,305.39	\$196.83
7/31/2001	\$6,701.70	\$258.92									\$258.92	\$116,462.84	\$116,295.61	\$167.23
8/31/2001													\$116,308.23	-\$116,308.23
8/31/2001	\$4,708.56	\$251.90									\$251.90	\$121,004.17	\$121,004.17	\$167.23
9/30/2001	\$3,545.36	\$200.54									\$200.54	\$124,917.30	\$124,750.07	\$167.23
10/31/2001	\$3,427.90	\$180.17									\$180.17	\$128,525.37	\$128,358.14	\$167.23
11/30/2001	\$0.00	\$0.00									\$0.00	\$130,531.18	\$130,216.56	\$314.62
12/31/2001	\$1,785.36	\$159.85									\$159.85	\$132,476.39	\$132,161.77	\$314.62
1/31/2002	\$1,678.86	\$94.88									\$94.88	\$134,250.13	\$133,985.51	\$314.62
2/28/2002	\$2,234.74	\$71.07									\$71.07	\$136,555.94	\$136,260.20	\$295.74
3/31/2002	\$1,992.64	\$81.06									\$81.06	\$138,629.64	\$138,333.90	\$295.74
4/30/2002	\$1,813.93	\$0.00									\$0.00	\$140,443.57	\$140,147.83	\$295.74
5/31/2002	\$1,844.52	\$92.54									\$92.54	\$142,380.63	\$142,084.89	\$295.74
6/30/2002	\$2,451.10	\$77.84									\$77.84	\$144,909.57	\$144,613.83	\$295.74
7/31/2002	\$2,261.33	\$76.01									\$76.01	\$147,246.91	\$146,951.17	\$295.74
8/31/2002	\$2,157.11	\$81.08									\$81.08	\$149,485.10	\$149,189.36	\$295.74
9/30/2002	\$2,907.84	\$79.96									\$79.96	\$152,472.90	\$152,177.16	\$295.74
10/31/2002	\$3,215.34	\$69.09									\$69.09	\$155,757.33	\$155,461.59	\$295.74
11/30/2002	\$3,096.54	\$76.45									\$76.45	\$158,930.32	\$158,634.58	\$295.74
12/31/2002	\$3,169.66	\$74.95									\$74.95	\$162,174.93	\$161,879.19	\$295.74
1/31/2003	\$3,813.01	\$37.67				\$0.00					\$37.67	\$166,025.61	\$165,729.87	\$295.74
2/28/2003	\$4,289.89	\$34.53				\$0.00					\$34.53	\$170,350.03	\$170,054.29	\$295.74
3/31/2003	\$4,068.75	\$18.13				\$0.00					\$18.13	\$174,436.91	\$174,141.17	\$295.74
4/30/2003	\$3,372.00	\$30.22				\$0.00					\$30.22	\$177,839.13	\$177,543.39	\$295.74
5/31/2003	\$4,442.17	\$20.98				\$0.00					\$20.98	\$182,302.28	\$182,006.54	\$295.74
6/30/2003	\$4,160.00	\$30.20				\$0.00					\$30.20	\$186,492.48	\$186,196.74	\$295.74
7/31/2003	\$3,706.33	\$18.46				\$0.00					\$18.46	\$190,217.27	\$189,921.53	\$295.74
8/31/2003	\$3,566.94	\$7.94				\$0.00					\$7.94	\$193,792.15	\$193,496.41	\$295.74
9/30/2003	\$3,514.72	\$7.10				\$0.00					\$7.10	\$197,313.97	\$197,018.23	\$295.74
10/31/2003	\$3,729.60	\$11.05				\$0.00					\$11.05	\$201,054.62	\$200,758.88	\$295.74
11/30/2003	\$3,677.31	\$17.40				\$0.00					\$17.40	\$204,749.33	\$204,453.59	\$295.74
12/31/2003	\$5,069.12	\$11.54				\$0.00					\$11.54	\$209,829.99	\$209,534.25	\$295.74
1/31/2004	\$3,571.38	\$21.61				\$0.00					\$21.61	\$213,422.98	\$213,127.24	\$295.74
2/28/2004	\$4,117.04	\$16.09				\$0.00					\$16.09	\$217,556.11	\$217,260.37	\$295.74
3/31/2004	\$6,029.58	\$9.79				\$0.00					\$9.79	\$223,595.48	\$223,299.74	\$295.74
4/30/2004	\$5,261.55	\$26.83				\$0.00					\$26.83	\$228,883.86	\$228,588.12	\$295.74
5/31/2004	\$6,061.81	\$27.00				\$0.00					\$27.00	\$234,972.67	\$234,676.93	\$295.74
6/30/2004	\$6,099.22	\$37.59				\$0.00					\$37.59	\$241,109.48	\$240,813.74	\$295.74
7/31/2004	\$5,943.68	\$51.14				\$0.00					\$51.14	\$247,104.30	\$246,808.56	\$295.74
8/31/2004	\$6,317.94	\$107.70				\$0.00					\$107.70	\$253,529.94	\$253,234.20	\$295.74
9/30/2004	\$5,958.08	\$128.03				\$0.00					\$128.03	\$259,616.05	\$259,320.31	\$295.74
10/31/2004	\$6,310.40	\$158.75				\$0.00					\$158.75	\$266,085.20	\$265,789.46	\$295.74
11/30/2004	\$4,443.28	\$207.54				\$0.00					\$207.54	\$270,736.02	\$270,440.28	\$295.74

Exhibit J
Unit BUCHISGU1 Escrow Account Reconciliation
VGOB 98-1117-0696 and 98-1117-0697

CNX Deposit Information		
Check Date	Check Number	Total
12/24/2004		\$6,115.29
1/25/2005		\$5,050.31
2/25/2005		\$6,510.72
3/24/2005		\$6,072.39
4/25/2005		\$4,495.33
5/25/2005		\$4,330.52
6/24/2005		\$3,149.15
7/25/2005		\$5,213.69
8/25/2005		\$5,765.24
9/23/2005		\$5,923.11
10/25/2005		\$7,012.53
11/25/2005		\$8,165.03
12/23/2005		\$9,622.52
1/25/2006		\$7,490.96
2/24/2006		\$10,686.96
3/24/2006		\$11,006.89
4/25/2006		\$8,057.29
5/25/2006		\$7,471.08
6/23/2006		\$6,244.99
7/25/2006		\$6,545.97
8/25/2006		\$5,519.08
9/25/2006		\$5,374.90
10/25/2006		\$6,657.76
11/25/2006		\$4,886.07
12/25/2006		\$633.30
1/25/2007		\$80.25
1/31/2007		\$119.02
2/25/2007		\$628.69
4/5/2007		\$347.60
4/25/2007		\$1,049.80
5/25/2007		\$1,574.33
6/25/2007		\$555.85
7/25/2007		\$28.83
8/25/2007		\$554.20
9/25/2007		\$50.26
10/25/2007		\$223.51
12/25/2007		\$74.64
1/25/2008		\$3,917.21
2/25/2008		\$7,885.62
3/25/2008		\$8,700.89
4/25/2008		\$7,877.97
5/25/2008		\$8,955.01
6/25/2008		\$8,770.00
7/25/2008		\$12,185.77
8/25/2008		\$13,311.90
9/25/2008		\$14,896.99
10/25/2008		\$9,941.89
11/25/2008		\$7,780.22
12/25/2008		\$6,961.02
1/25/2009		\$5,304.56
2/25/2009		\$5,882.01
3/25/2009		\$5,296.98
4/25/2009		\$3,307.68
5/25/2009		\$2,443.23
6/25/2009		\$2,455.61
7/25/2009		\$2,384.66

Escrow Bank Data														
Date	Escrow Royalty Deposits	Income	\$ Mrket Int	CDARS Int	Fees	Distributions	Audit Costs	Corrections	Gain/Loss	Royalty Bonus	Total Int. and Fees	Bank Balance	Running Balance	Difference
12/31/2004	\$6,115.29	\$209.00				\$0.00					\$209.00	\$277,060.31	\$276,764.57	\$295.74
1/31/2005	\$5,050.31	\$291.42				\$0.00					\$291.42	\$282,402.04	\$282,106.30	\$295.74
2/28/2005	\$6,510.72	\$338.89				\$0.00					\$338.89	\$289,251.65	\$288,955.91	\$295.74
3/31/2005	\$6,072.39	\$336.96				\$0.00					\$336.96	\$295,661.00	\$295,365.26	\$295.74
4/30/2005	\$4,495.33	\$450.23				\$0.00					\$450.23	\$300,606.56	\$300,310.82	\$295.74
5/31/2005	\$4,330.52	\$481.27				\$0.00					\$481.27	\$305,418.35	\$305,122.61	\$295.74
6/30/2005	\$3,149.15	\$527.15				\$0.00					\$527.15	\$309,094.65	\$308,798.91	\$295.74
7/31/2005	\$5,213.69	\$541.55				\$0.00					\$541.55	\$314,849.89	\$314,554.15	\$295.74
8/31/2005	\$5,765.24	\$621.03				\$0.00					\$621.03	\$321,236.16	\$320,940.42	\$295.74
9/30/2005	\$5,923.11	\$680.49				\$0.00					\$680.49	\$327,839.76	\$327,544.02	\$295.74
10/31/2005	\$7,012.53	\$716.58				\$0.00					\$716.58	\$335,568.87	\$335,273.13	\$295.74
11/30/2005	\$8,165.03	\$754.15				\$0.00					\$754.15	\$344,488.05	\$344,192.31	\$295.74
12/31/2005	\$9,622.52	\$815.40				\$0.00					\$815.40	\$354,925.97	\$354,630.23	\$295.74
1/31/2006	\$7,490.96	\$931.32				\$0.00					\$931.32	\$363,348.25	\$363,052.51	\$295.74
2/28/2006	\$10,686.96	\$971.74				\$0.00					\$971.74	\$375,006.95	\$374,711.21	\$295.74
3/31/2006	\$11,006.89	\$1,008.39				\$0.00					\$1,008.39	\$387,022.23	\$386,726.49	\$295.74
4/30/2006	\$8,057.29	\$1,224.35				\$0.00					\$1,224.35	\$396,303.87	\$396,008.13	\$295.74
5/31/2006	\$7,471.08	\$1,203.24				\$0.00					\$1,203.24	\$404,978.19	\$404,682.45	\$295.74
6/30/2006	\$6,244.99	\$1,278.08				\$0.00					\$1,278.08	\$412,501.26	\$412,205.52	\$295.74
7/31/2006	\$6,545.97	\$1,298.20				\$0.00					\$1,298.20	\$420,345.43	\$420,049.69	\$295.74
8/31/2006	\$0.00	\$1,414.04				\$0.00					\$1,414.04	\$421,759.47	\$426,982.81	-\$5,223.34
9/25/2006											\$0.00		\$432,357.71	-\$432,357.71
10/25/2006						\$0.00					\$1,638.64	\$442,403.79	\$440,654.11	\$1,749.68
11/30/2006					(\$29.91)	\$0.00					\$1,675.27	\$447,113.46	\$447,213.45	-\$101.99
12/31/2006					(\$237.92)	\$0.00					\$1,496.63	\$448,666.24	\$449,345.38	-\$679.14
1/31/2007						\$0.00					\$1,640.40	\$450,429.15	\$451,066.03	-\$636.88
2/28/2007						\$0.00					\$0.00		\$451,185.05	-\$451,185.05
3/31/2007						\$0.00					\$1,577.91	\$452,007.06	\$453,391.65	-\$1,384.59
4/30/2007						\$0.00					\$1,459.04	\$453,466.10	\$455,198.29	-\$1,732.19
5/31/2007						\$0.00					\$1,686.78	\$458,327.61	\$457,934.87	\$392.74
6/30/2007						\$0.00					\$1,563.90	\$463,256.24	\$461,073.10	\$2,183.14
7/31/2007						\$0.00					\$1,640.25	\$464,896.49	\$463,269.20	\$1,627.29
8/31/2007						\$0.00					\$3,216.16	\$467,089.25	\$466,514.19	\$575.06
9/30/2007						\$0.00					\$1,580.69	\$469,224.14	\$468,649.08	\$575.06
10/31/2007						\$0.00					\$2,509.30	\$471,783.70	\$471,208.64	\$575.06
11/30/2007						\$0.00					\$1,580.89	\$473,364.59	\$473,013.04	\$351.55
12/31/2007						\$0.00					\$1,633.64	\$475,252.32	\$474,646.68	\$605.64
1/31/2008						\$0.00					\$1,506.79	\$476,833.75	\$476,228.11	\$605.64
2/29/2008						\$0.00					\$1,206.05	\$481,957.01	\$481,351.37	\$605.64
3/31/2008						\$0.00					\$1,034.14	\$490,913.60	\$490,271.13	\$642.47
4/30/2008						\$0.00					\$919.37	\$500,560.33	\$499,891.39	\$668.94
5/31/2008						\$0.00					\$700.67	\$509,138.97	\$508,470.03	\$668.94
6/30/2008						\$0.00					\$586.21	\$518,730.06	\$518,011.25	\$718.81
7/31/2008						\$0.00					\$593.41	\$528,093.47	\$527,374.66	\$718.81
8/31/2008						\$0.00					\$582.24	\$540,920.79	\$540,142.67	\$778.12
9/30/2008						\$0.00					\$758.13	\$555,030.30	\$554,212.70	\$817.60
10/31/2008						\$0.00					\$691.74	\$570,662.30	\$569,801.43	\$860.87
11/30/2008						\$0.00					\$569.93	\$581,203.68	\$580,313.25	\$890.43
12/31/2008						\$0.00					\$765.16	\$589,749.06	\$588,858.63	\$890.43
1/1/2009						\$0.00					\$313.27	\$597,067.40	\$596,132.92	\$934.48
2/28/2009						\$0.00					\$29.09	\$597,096.49	\$601,466.57	-\$4,370.08
3/31/2009						\$0.00					-\$54.21	\$608,263.70	\$607,294.37	\$969.33
4/30/2009						\$0.00					\$149.52	\$613,710.20	\$612,740.87	\$969.33
5/31/2009						\$0.00					-\$96.49	\$616,948.56	\$615,952.06	\$996.50
6/30/2009						\$0.00					-\$97.87	\$619,293.92	\$618,297.42	\$996.50
7/31/2009						\$0.00					-\$101.29	\$621,648.24	\$620,651.74	\$996.50
						\$0.00					-\$103.20	\$623,929.71	\$622,933.20	\$996.51

Exhibit J
Unit BUCHISGU1 Escrow Account Reconciliation
VGOB 98-1117-0696 and 98-1117-0697

CNX Deposit Information		
Check Date	Check Number	Total
Interest and Fees		\$60,351.15
Total		\$183,866.93
September 2017 First Bank and Trust balance		\$183,966.75
FB&T Difference		\$99.82

Escrow Bank Data													Running Balance	Difference
Date	Escrow Royalty Deposits	Income	\$ Mrket Int	CDARS Int	Fees	Distributions	Audit Costs	Corrections	Gain/Loss	Royalty Bonus	Total Int. and Fees	Bank Balance		

**Deposit of \$2,814.77 into escrow account made 11/6/17 to correct previous acreage discrepancy and overpayment of owners on (04) disbursement order.

SUPPLEMENTAL AFFIDAVIT OF MAILING—COAL OWNER

COMMONWEALTH OF VIRGINIA
COUNTY OF **BUCHANAN**

Applicant: CNX Gas Company LLC
Relief Sought: Disbursement/Dismissal for Unit **BUCH1SGU1**
VGOB: 98-1117-0697-05

I, Anita D. Duty, being first duly sworn on oath, depose and say:

1. I am the Pooling Supervisor for CNX Land LLC, and I am authorized to submit this Affidavit on behalf of the Applicant CNX Gas Company LLC.

2. I affirm that the coal owner(s) in this Unit was properly noticed under Va. Code Ann. 45.1-361-22:2. See annexed letter(s) dated **November 4, 2015**.

3. **Hugh MacRae Land Trust (Torch Oil & Gas), Rockport Oil & Gas, and Chisos, LTD** should be dismissed as Respondent/coal claimant for failure to timely provide evidence of a relevant proceeding or agreement.

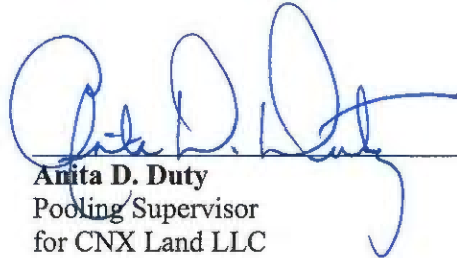
Anita D. Duty
Pooling Supervisor
for CNX Land LLC

STATE OF VIRGINIA
COUNTY OF TAZEWELL, TO-WIT:

TAKEN, SUBSCRIBED AND SWORN to before me this 7th day of February, 2017.

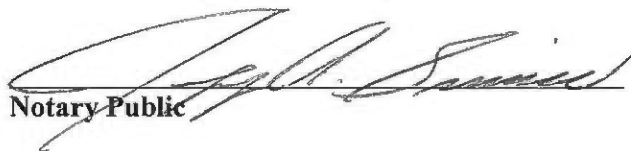
Notary Public

My commission expires: August 31, 2020

Commonwealth of Virginia
Jeffrey A. Simmons - Notary Public
Commission ID: 7215200
My Commission Expires 08/31/2020

CERTIFICATION OF NOTICE
CNX Gas Company LLC

Buchanan No1 SGU1
VGOB 98-1117-0697-04
Coal Owner Dismissal

Last Name	First Name	MAILED	RECEIPT #	Received
Torch Oil and Gas Company (Coal Owner)		11/4/2015	70151520000353330240	11/7/2015
Coal Mountain Mining Company (Coal Owner)		11/4/2015	70151520000353330233	11/6/2015
Hugh MacRae (Coal Owner)		11/4/2015	70091680000108911298	11/9/2015
Gentry Locke (Coal Owner)		11/4/2015	70091680000108911274	11/10/2015
Chisos, LTD (Coal Owner)		11/4/2015	70091680000108911281	11/9/2015
Island Creek Coal Company (Coal Owner)		**Hand delivered**	**Hand Delivered**	



USPS Tracking®



Customer Service ›
Have questions? We're here to help.



Get Easy Tracking Updates ›
Sign up for My USPS.

Tracking Number: 70151520000353330240

Updated Delivery Day: Saturday, November 7, 2015

Product & Tracking Information

Available Actions

Postal Product:

Features:
Certified Mail™

DELIVERY

STATUS OF ITEM

LOCATION

November 7, 2015, 9:44 am

Delivered

DEMING, NM 88030

Track this package's history and view photos of the package's location. [Track for this package](#)

November 7, 2015, 8:33 am

Arrived at Unit

DEMING, NM 88030

November 7, 2015, 4:28 am

Departed USPS Facility

EL PASO, TX 79910

November 6, 2015, 7:24 pm

Arrived at USPS Facility

EL PASO, TX 79910

November 5, 2015, 4:26 am

Departed USPS Facility

CHARLESTON, WV 25350

November 4, 2015, 10:04 pm

Arrived at USPS Facility

CHARLESTON, WV 25350

Track Another Package

Tracking (or receipt) number

Track It

Manage Incoming Packages

Track all your packages from a dashboard. No tracking numbers necessary.

[Sign up for My USPS](#) ›





USPS Tracking®



Customer Service >
Have questions? We're here to help.



Get Easy Tracking Updates >
Sign up for My USPS.

Tracking Number: 70151520000353330233

Product & Tracking Information

Available Actions

Postal Product:

Features:
Certified Mail™

DATE & TIME

STATUS OF ITEM

LOCATION

November 6, 2015 , 9:52 am

Delivered

TAZEWELL, VA 24651

November 6, 2015 , 9:01 am Available for Pickup TAZEWELL, VA 24651

November 6, 2015 , 9:01 am

Available for Pickup

TAZEWELL, VA 24651

November 5, 2015 , 7:12 pm

Departed USPS Facility

CHARLESTON, WV 25350

November 4, 2015 , 10:05 pm

Arrived at USPS Facility

CHARLESTON, WV 25350

Track Another Package

Tracking (or receipt) number

Track It

Manage Incoming Packages

Track all your packages from a dashboard. No tracking numbers necessary.

[Sign up for My USPS >](#)



HELPFUL LINKS

- Contact Us
- Site Index
- FAQs

ON ABOUT.USPS.COM

- About USPS Home
- Newsroom
- USPS Service Updates
- Forms & Publications
- Government Services
- Careers

OTHER USPS SITES

- Business Customer Gateway
- Postal Inspectors
- Inspector General
- Postal Explorer
- National Postal Museum
- Resources for Developers

LEGAL INFORMATION

- Privacy Policy
- Terms of Use
- FOIA
- No FEAR Act EEO Data

SENDER: COMPLETE THIS SECTION

- Complete items 1, 2, and 3. Also complete item 4 if Restricted Delivery is desired.
- Print your name and address on the reverse so that we can return the card to you.
- Attach this card to the back of the mailpiece, or on the front if space permits.

1. Article Addressed to:
 Hugh McCrae
 PO Box 830
 Tazewell VA
 24651

COMPLETE THIS SECTION ON DELIVERY

A. Signature: *[Signature]* Agent Address

B. Received by (Printed Name): *[Signature]* C. Date of Delivery: 11/9/15

D. Is delivery address different from item 1? Yes No
 If YES, enter delivery address below:

3. Service Type
 Certified Mail Express Mail
 Registered Return Receipt for Merchandise
 Insured Mail C.O.D.

4. Restricted Delivery? (Extra Fee) Yes

7009 1680 0001 0891 1298

PS Form 3811, February 2004 Domestic Return Receipt 585-02-M-11

SENDER: COMPLETE THIS SECTION

- Complete items 1, 2, and 3. Also complete item 4 if Restricted Delivery is desired.
- Print your name and address on the reverse so that we can return the card to you.
- Attach this card to the back of the mailpiece, or on the front if space permits.

1. Article Addressed to:
 Chisos
 670 Dona Ana Rd
 Deming NM 88030

COMPLETE THIS SECTION ON DELIVERY

A. Signature: *[Signature]* Agent Address

B. Received by (Printed Name): B. Jacobson C. Date of Delivery: 11/19/15

D. Is delivery address different from item 1? Yes No
 If YES, enter delivery address below:

3. Service Type
 Certified Mail Express Mail
 Registered Return Receipt for Merchandise
 Insured Mail C.O.D.

4. Restricted Delivery? (Extra Fee) Yes

7009 1680 0001 0891 1274

PS Form 3811, February 2004 Domestic Return Receipt 585-02-M-11

SENDER: COMPLETE THIS SECTION

- Complete items 1, 2, and 3. Also complete item 4 if Restricted Delivery is desired.
- Print your name and address on the reverse so that we can return the card to you.
- Attach this card to the back of the mailpiece, or on the front if space permits.

1. Article Addressed to:
 Gentry Locke
 Attn: Kathy Wright
 PO Box 40013
 Roanoke VA 24022-0013

COMPLETE THIS SECTION ON DELIVERY

A. Signature: *[Signature]* Agent Address

B. Received by (Printed Name): DEBBY BUCKNER C. Date of Delivery: 11/19/15

D. Is delivery address different from item 1? Yes No
 If YES, enter delivery address below:

3. Service Type
 Certified Mail Express Mail
 Registered Return Receipt for Merchandise
 Insured Mail C.O.D.

4. Restricted Delivery? (Extra Fee) Yes

2 7009 1680 0001 0891 1281

PS Form 3811, February 2004 Domestic Return Receipt 585-02-M-11



CNX Gas Company LLC

PO Box 570

Pounding Mill, VA 24637

Phone: (724) 485-3600

Date

«FNAME» «LNAME»

«Attention_Line»

«Street_Address»

«City»«State»«Zip»

COAL OWNERS

RE: Unit _____
Miscellaneous Petition for Disbursement from Escrow

Dear Property Owner,

House Bill 2058 was signed by the Governor and became law effective July 1, 2015. This new law requires the Virginia Gas and Oil Board to disburse monies placed in escrow because of conflicting claims (between coal owners and oil and gas owners) to coalbed methane gas royalties to the oil and gas owners of the tracts in this Unit.

In general, under this new law escrowed funds are to be paid to oil and gas owners unless the coal owner(s) provides the operator CNX and the Division of Gas and Oil "with evidence of a proceeding" [as in a court case] "or an agreement." The new law gives coal owners/coal claimants **45 days** from the date you get this letter to provide that evidence.

Enclosed herewith please find a copy of the 45 day Notice of Filing. Please read the Notice carefully to be sure you understand that you have 45 days to provide evidence to the operator CNX Gas Company LLC at the address above **and** the Division of Gas and Oil at PO Draw 159, Lebanon, VA 24266

In order to help us keep our records current and to make sure you receive all correspondence and notices promptly, please notify us of any address change at the address above.

Sincerely,

Anita Duty
Pooling Supervisor

Enclosure(s)

Gilmer, Sarah (DMME)

From: Berry (Howery), Kelli <KelliBerry@consolenergy.com>
Sent: Thursday, November 16, 2017 11:42 AM
To: Gilmer, Sarah (DMME)
Subject: RE: 0697-05 (BUC1SGU1)

Yes, that is why we had to have it rejected back. I placed a note in the comments regarding the acres in escrow. The prior order erroneously omitted Tract 52 from the acres in escrow. This tract has always paid into escrow, which we confirmed internally. In previous orders, there were questions regarding the validity of royalty split agreements. It appears that whomever filed the 04 petition assumed this tract had been paid out when it actually had not. This was confirmed with Jody. Because the acres for this tract were not included in the 04 petition, the owners that were paid out in the 04 were overpaid. We calculated the amount of the overpayment and deposited those dollars back into the escrow account.

From: Gilmer, Sarah (DMME) [mailto:Sarah.Gilmer@dmme.virginia.gov]
Sent: Thursday, November 16, 2017 11:24 AM
To: Berry (Howery), Kelli
Subject: 0697-05 (BUC1SGU1)

Hi Kelli!

I just wanted to check with you on the prior acres in escrow for Docket 0697-05 (BUC1SGU1). The prior disbursement has 58.99 acres remaining in escrow and the current disbursement has 59.21790. Would you mind to let me know where the change in numbers came from?

Thanks,
Sarah

Unit:	BUCH1SGU1
Unit Acres:	1590.44
# Wells (contributing to escrow account):	79
Authorization for Direct Payment:	<input checked="" type="radio"/> Yes <input type="radio"/> No
Total Acres in Escrow (prior to this disbursement):	59.21790
Total Acres being Disbursed:	42.28870
Remaining acres in escrow:	16.92920
Reported Bank Account Balance:	183966.75
Reported Bank Account Balance Date:	09/30/17 ▾
Does the above account balance reconcile to company balance?	No ▾
Account Balance:	186796.39
Account will:	<input checked="" type="radio"/> Continue <input type="radio"/> Close
Factual Basis for Relief Sought:	a. Arnold Keen, Carl Hale, Burns & Nancy Mul Ratliff, Michael Hess, Beth Underhill, David Hess Tamara Altizer, Bobby Steele, James D. Steele, Dawn McElfresh, Gaynell Fry, Ruth Virginia Low Darlene Drudge, Jeanne Garrett, Yvonne White,

"This communication, including any attachments, may contain confidential and privileged information that is subject to the CONSOL Energy Inc.'s Business Information Protection Policy. The information is intended solely for the use of the intended recipient(s). If you are not an intended recipient, you are prohibited from any

use, distribution, or copying of this communication. If you have received this communication in error, please immediately notify the sender and then delete this communication in its entirety from your system."