

BEFORE THE VIRGINIA GAS AND OIL BOARD

PETITIONER: CNX Gas Company LLC

DIVISION OF GAS AND OIL

DOCKET NO: VGOB 92-0317-0198-01

RELIEF SOUGHT: (1) DISBURSEMENT FROM ESCROW REGARDING TRACT(S) 2 (2) AND DISMISSAL OF COAL OWNERS PURSUANT TO CODE OF VIRGINIA SECTION 45.1-361.22:2.

HEARING DATE: December 19, 2017

DRILLING UNIT: T14

BUCHANAN COUNTY, VIRGINIA

PETITION FOR ORDER OF DISBURSEMENT OF ESCROW FUNDS

1. Petitioner and its counsel

Petitioner is CNX Gas Company LLC, PO Box 570, Pounding Mill, VA 24637, (276)596-5075. Petitioner's counsel is Mark A. Swartz, Hillard & Swartz, LLP, 122 Capital Street, Suite 201, Charleston, WV 25301.

2. Relief Sought

(1) the disbursement of escrowed funds heretofore deposited with the Board's Escrow Agent, attributable to Tract 2, as depicted upon the annexed table; (2) dismissal of surface owners in Tract 2, B.F. McGlothlin Heirs, Devisees, Successors or Assigns (individuals listed below).

3. Legal Authority

Va. Code Ann. § 45.1-361.1 et seq., 4 VAC 25-160-140., and relevant Virginia Gas and Oil Board Orders ("Board") heretofore promulgated pursuant to law.

4. Type of Well(s)

Coalbed Methane

5. Factual basis for relief requested

a. COMMONWEALTH OF VIRGINIA: To the following persons who will receive a disbursement of escrowed funds if the relief sought by Applicant's Petition is granted by the Virginia Gas and Oil Board:

H-W Financial, LLC (previously Harrison-Wyatt, LLC)

COMMONWEALTH OF VIRGINIA: To the following persons identified as SURFACE OWNERS in the Pooling Order and Supplemental Order(s) pertaining to the referenced Docket No. who were previously pooled by Virginia Gas and Oil Board Order as potential claimants. YOU, AS A RESPONDENT AND YOUR CLAIMS, IF ANY, TO COALBED METHANE ROYALTIES for gas produced from this Unit ARE SUBJECT TO DISMISSAL BY BOARD ORDER AT THE HEARING NOTICED ABOVE:

B.F. McGlothlin Heirs, Devisees, Successors or Assigns including Shauna McGlothlin, Jon McGlothlin, Logan McGlothlin, Bonnie McGlothlin, Ralph Edward McGlothlin, Jr., Patricia S. McGlothlin, Bascom "Buddy" Matney, Helen Carol Mamone, Ann C. Rauhauser, Joseph Blair McGlothlin, Katherine M. Warren, St. Jude's Children's Research Hospital, Children's Hospital of Richmond, Shirley Presley, Donald A. McGlothlin, Jr., Wayne Talbert Burton, Sr., Joseph John Laperla, Mary Louise Laperla, Leah Ann McGlothlin, Kevin Timothy McGlothlin, Kenna Dixon Moose, Michael McKinley Dixon, Peggy Durham, Shery W. Bennett, Pauline W. Shortridge, Floyd Edmond Wampler, Thomas D. McGlothlin, James W. McGlothlin, Michael G. McGlothlin, Doris Ann McGlothlin, Anne Borkey Fath, Sharon Borkey Parsons, Betty McGlothlin, Una Lee Mulligan Bailey, McGlothlin Living Trust, Darla Torres, Cecil McGlothlin, Jr., Norman McGlothlin, Ann Mullins Washburn, Michael M. Mullins, Charlene Dixon Seale, Patricia Wade, Virginia Peterson, Paula J. Morrow, W.A. Street Heirs Trust c/o H.A. Street

NOTICE IS HEREBY GIVEN that Applicant is requesting that the Virginia Gas and Oil Board (hereinafter Board) issue an order as follows:

- (1) Directing the Board's Escrow Agent to make the disbursements to the persons identified in Table 1 hereto using the percentages stated therein;
- (2) Directing Applicant to pay the persons identified in Table 1 hereto and to discontinue escrow of their royalty payments;
- (3) Dismissing the Respondent surface owners named above.

6. Attestation

The foregoing Petition to the best of my knowledge, information, and belief is true and correct.

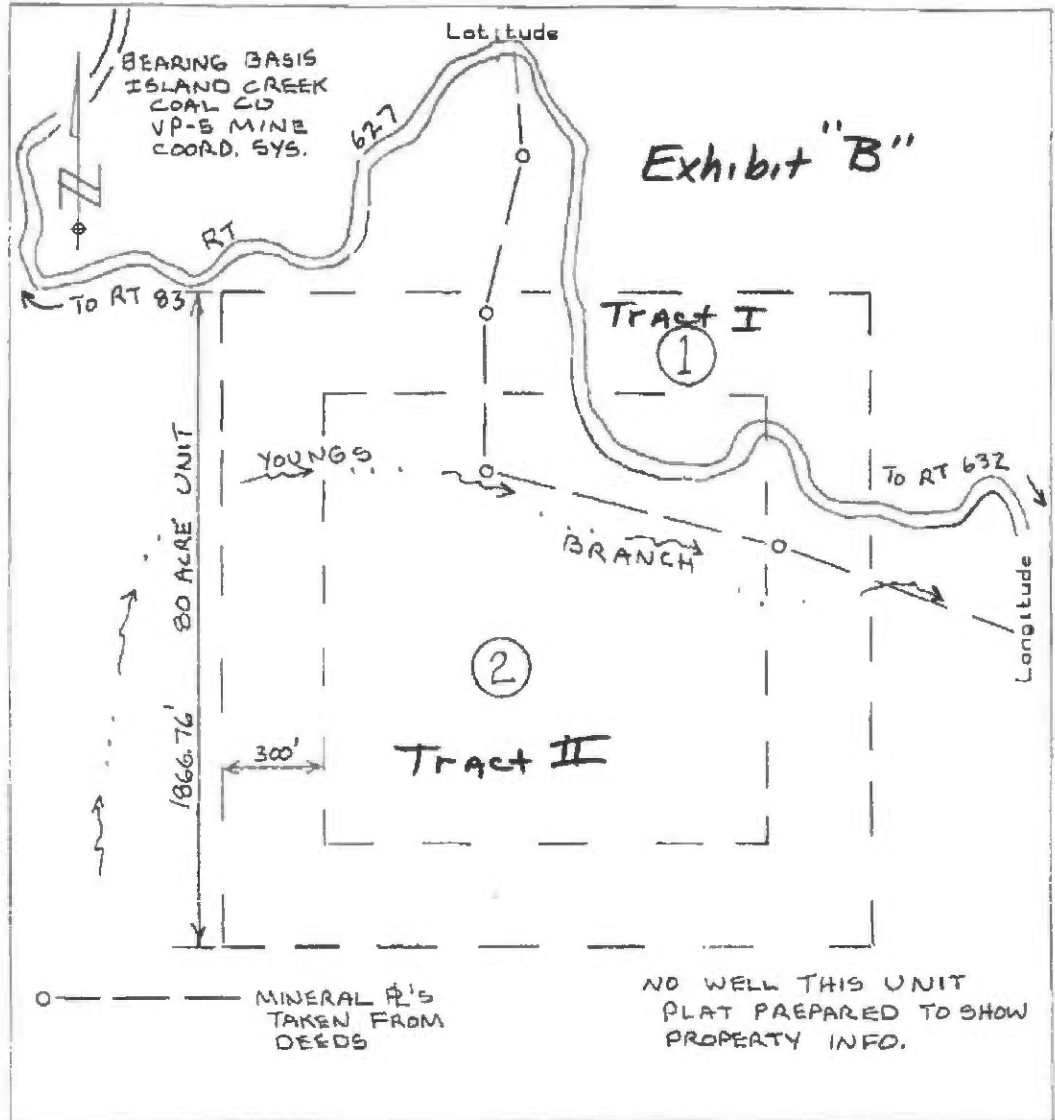

WELL LOCATION PLAT

Company OXY USA INC Well Name and Number UNIT T14
 Tract No. N/A Elevation N/A Quadrangle VANSANT
 County BUCHANAN District GARDEN Scale: 1" = 400' Date 08/24/92

This Plat is a new plot ; an updated plot ; or a final location plat
 Denotes the location of a well on United States topographic Maps, scale 1" =
 + 24,000. latitude and longitude lines being represented by border lines and
 shown.

D. H. PRICE
 Licensed Professional Engineer or Licensed Land Surveyor

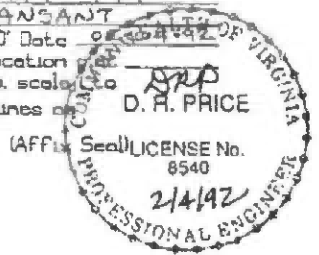

Form DGO-GO-7
 Rev. 9/91

OXY USA INC.

Well Plat Legend
Property and Lease Information
Well Unit -- T14

1. Surface ----- Thelma Sizemore
Coal, Oil & Gas ----- Big Axe Tract No 3
Wayles R. Harrison and Landon R.
Wyatt, Jr., Trustees
Oil & Gas Lessee ----- OXY USA INC
Coal Lessee ----- Island Creek Coal Co.
Jewell Smokless Coal Corp.
Coalbed Methane Lessee -- OXY USA INC

1 = 16.46 Acres - 20.57% of Unit

2. Surface ----- B. F. McGlothlin Heirs
Coal, Oil & Gas ----- Big Axe Tract No 8
Wayles R. Harrison and Landon R.
Wyatt, Jr., Trustees
Oil & Gas Lessee ----- OXY USA INC
Coal Lessee ----- Island Creek Coal Co.
Jewell Smokless Coal Corp.
Coalbed Methane Lessee -- OXY USA INC

2 = 63.54 Acres - 79.43% of Unit

Exhibit E
Unit T-14
Docket # VGOB-92-0317-0198-01
List of Owners/Claimants that require escrow

	Acres in Unit	Percent of Unit	Division of Interest in		Percent of Escrow
			9 East	10-East	

Escrowing no longer required

Exhibit EE
Unit T-14
Docket # VGOB-92-0317-0198-01
List of Owners/Claimants with Royalty Split Agreement/Court Order/HB2058

	Acres in Unit	Percent of Unit	Division of Interest in 9 East 0.00%	10-East 2.25%	Percent of Escrow
<u>Tract #2 - 63.54 acres</u>					
<u>COAL OWNERSHIP</u>					
(1) H-W Financial, LLC PO Box 11000 Danville, VA 24543	63.54 acres	79.4250%	0.00000%	1.78706%	<i>n/a</i>
<u>OIL & GAS OWNERSHIP</u>					
(1) H-W Financial, LLC PO Box 11000 Danville, VA 24543	63.54 acres	79.4250%	0.00000%	1.78706%	100.00% HB2058

Exhibit J
Unit T14 Escrow Account Reconciliation
VGOB 92-0317-0198

CNX Deposit Information		
Check Date	Check Number	Total
8/25/1992		\$346.33
9/25/1992		\$111.40
10/25/1992		\$201.95
11/25/1992		\$163.49
12/25/1992		\$764.30
1/25/1993		\$634.88
2/25/1993		\$613.91
3/25/1993		\$580.75
4/25/1993		\$295.71
5/25/1993		\$253.25
6/25/1993		\$304.65
7/25/1993		\$455.19
8/25/1993		\$302.04
11/25/1993		\$292.89
12/25/1993		\$152.29
1/25/1994		\$178.20
2/25/1994		\$376.74
3/25/1994		\$881.50
4/25/1994		\$1,482.82
5/25/1994		\$1,821.55
6/25/1994		\$692.79
7/25/1994		\$317.64
8/25/1994		\$240.80
9/25/1994		\$275.56
10/25/1994		\$85.08
11/25/1994		\$5.44
12/25/1994		\$0.01
1/25/1995		\$77.62
2/25/1995		\$102.25
3/25/1995		\$68.63
4/25/1995		\$301.70
5/25/1995		\$16.17
6/25/1995		\$112.47
7/25/1995		\$284.92
8/25/1995		\$203.73
9/25/1995		\$22.27
10/25/1995		\$8.33
11/25/1995		\$25.43
12/25/1995		\$44.81
1/25/1996		\$86.72
2/25/1996		\$198.60
3/25/1996		\$412.01
4/25/1996		\$1,374.57
5/25/1996		\$185.77
6/25/1996		\$13.15
7/25/1996		\$13.28
8/25/1996		\$11.32
9/25/1996		\$15.78
1/25/1997		\$42.93

Escrow Bank Data															
Date	Escrow Royalty Deposits	Income	\$ Mkt Int	CDARS Int	Fees	Distributions	Audit Costs	Corrections	Gain/Loss	Royalty Bonus	Total Int. and Fees	Bank Balance	Running Balance	Difference	
													\$346.33		
9/30/1992	\$346.33	\$0.00									\$0.00	\$346.33	\$457.73	-\$111.40	
10/31/1992	\$313.35										\$0.00	\$659.68	\$659.68	\$0.00	
11/30/1992	\$0.00	\$0.34									\$0.34	\$660.02	\$823.51	-\$163.49	
12/31/1992	\$927.79	\$0.78									\$0.78	\$1,588.59	\$1,588.59	\$0.00	
1/31/1993	\$698.42	\$1.47									\$1.47	\$2,288.48	\$2,224.94	\$63.54	
2/28/1993	\$0.00	\$3.76									\$3.76	\$2,292.24	\$2,842.61	-\$550.37	
3/31/1993	\$1,194.66	\$5.25			-\$80.00						-\$74.75	\$3,412.15	\$3,348.61	\$63.54	
4/30/1993	\$295.71	\$7.06									\$7.06	\$3,714.92	\$3,651.38	\$63.54	
5/31/1993	\$253.25	\$8.23									\$8.23	\$3,976.40	\$3,912.86	\$63.54	
6/30/1993	\$304.65	\$9.09									\$9.09	\$4,290.14	\$4,226.60	\$63.54	
7/31/1993	\$455.19	\$9.45			-\$19.33						-\$9.88	\$4,735.45	\$4,671.91	\$63.54	
8/31/1993	\$302.04	\$10.56			-\$53.94						-\$43.38	\$4,994.11	\$4,930.57	\$63.54	
9/30/1993	\$111.73	\$11.60			-\$14.16						-\$2.56	\$5,103.28	\$4,928.01	\$175.27	
10/31/1993	\$129.48	\$11.92			-\$14.25						-\$2.33	\$5,230.43	\$4,925.68	\$304.75	
11/30/1993	\$0.00	\$12.59			-\$14.35						-\$1.76	\$5,228.67	\$5,216.81	\$11.86	
12/31/1993	\$445.18	\$12.50			-\$4.35						\$8.15	\$5,682.00	\$5,377.25	\$304.75	
1/31/1994	\$0.00	\$13.82			-\$24.73						-\$10.91	\$5,671.09	\$5,544.54	\$126.55	
2/28/1994	\$178.20	\$14.23			-\$4.72						\$9.51	\$5,858.80	\$5,930.79	-\$71.99	
3/31/1994	\$1,258.24	\$13.22			-\$14.88						-\$1.66	\$7,115.38	\$6,810.63	\$304.75	
4/30/1994	\$1,482.82	\$16.44			-\$15.93						\$0.51	\$8,598.71	\$8,293.96	\$304.75	
5/31/1994	\$0.00	\$19.54			-\$17.16						\$2.38	\$8,601.09	\$10,117.89	-\$1,516.80	
6/30/1994	\$2,514.34	\$26.18			-\$17.16						\$9.02	\$11,124.45	\$10,819.70	\$304.75	
7/31/1994	\$317.64	\$32.30			-\$19.27						\$13.03	\$11,455.12	\$11,150.37	\$304.75	
8/31/1994	\$240.80	\$38.90			-\$19.54						\$19.36	\$11,715.28	\$11,410.53	\$304.75	
9/30/1994	\$275.56	\$41.22			-\$19.77						\$121.87	\$12,112.71	\$11,807.96	\$304.75	
10/31/1994	\$75.08	\$36.80			-\$10.05						\$26.75	\$12,214.54	\$11,919.79	\$294.75	
11/30/1994	\$0.00	\$32.03			-\$20.06						-\$105.11	-\$93.14	\$12,121.40	\$11,832.09	\$289.31
12/31/1994	\$0.00	\$32.76			-\$10.11						-\$0.02	\$22.63	\$12,144.03	\$11,854.73	\$289.30
1/31/1995	\$0.00	\$29.21			-\$10.02						\$19.19	\$12,163.22	\$11,951.54	\$211.68	
2/28/1995	\$83.07	\$30.64			-\$9.99						\$20.65	\$12,266.94	\$12,074.44	\$192.50	
3/31/1995	\$170.88	\$2,033.46			-\$20.09						\$101.97	\$12,539.79	\$12,245.04	\$294.75	
4/30/1995	\$0.00	\$35.86			-\$20.38						\$15.48	\$12,555.27	\$12,562.22	-\$6.95	
5/31/1995	\$301.70	\$41.74			-\$10.38						\$31.36	\$12,888.33	\$12,609.75	\$278.58	
6/30/1995	\$128.64	\$44.59			-\$20.71						\$23.88	\$13,040.85	\$12,746.10	\$294.75	
7/31/1995	\$0.00	\$43.04			-\$20.86						\$22.18	\$13,063.03	\$13,053.20	\$9.83	
8/31/1995	\$488.65	\$44.37			-\$10.87						\$33.50	\$13,585.18	\$13,290.43	\$294.75	
9/30/1995	\$0.00	\$105.31			-\$22.97						\$167.78	\$13,752.96	\$13,480.48	\$272.48	
10/31/1995	\$22.27	\$35.21			-\$9.19						\$24.28	\$13,799.51	\$13,513.09	\$286.42	
11/30/1995	\$33.76	\$37.00			-\$21.53						\$40.60	\$13,873.87	\$13,579.12	\$294.75	
12/31/1995	\$44.81	\$35.89			-\$21.58						\$46.11	\$13,964.79	\$13,670.04	\$294.75	
1/31/1996	\$0.00	\$90.79			-\$21.64						\$20.53	\$13,985.32	\$13,777.29	\$208.03	
2/29/1996	\$285.32	\$36.72			-\$11.71						\$25.01	\$14,295.65	\$14,000.90	\$294.75	
3/31/1996	\$0.00	\$151.45			-\$20.33						\$131.12	\$14,426.77	\$14,544.03	-\$117.26	
4/30/1996	\$412.01	\$37.35			-\$12.02						\$25.33	\$14,869.11	\$15,943.93	-\$1,074.82	
5/31/1996	\$1,560.34	\$38.23			-\$22.37						\$15.86	\$16,440.31	\$16,145.56	\$294.75	
6/30/1996	\$0.00	\$45.39			-\$21.15						\$11.68	\$16,451.99	\$16,170.39	\$281.60	
7/31/1996	\$26.43	\$93.95			-\$13.71						\$95.44	\$16,572.26	\$16,279.11	\$293.15	
8/31/1996	\$0.00	\$39.21			-\$23.80						\$15.41	\$16,587.67	\$16,305.84	\$281.83	
9/30/1996	\$27.10	\$156.77			-\$13.04						\$118.89	\$16,733.66	\$16,440.51	\$293.15	
10/31/1996	\$0.00	\$43.45			-\$23.91						\$64.23	\$16,797.89	\$16,504.74	\$293.15	
11/30/1996	\$0.00	\$71.12			-\$14.02						\$57.10	\$16,854.99	\$16,561.84	\$293.15	
12/31/1996	\$0.00	\$68.25			-\$14.04						\$30.63	\$16,885.62	\$16,592.47	\$293.15	
1/31/1997	\$42.95	\$120.18			-\$14.05						\$31.02	\$17,065.72	\$16,772.55	\$293.17	

Exhibit J
Unit T14 Escrow Account Reconciliation
VGOB 92-0317-0198

CNX Deposit Information		
Check Date	Check Number	Total
2/25/1997		\$39.34
3/25/1997		\$38.52
4/25/1997		\$58.64
6/25/1997		\$30.98
8/25/1997		\$32.54
9/25/1997		\$33.87
10/25/1997		\$27.23
12/25/1997		\$52.70
1/25/1998		\$70.55
2/25/1998		\$32.35
4/24/1998		\$35.84
6/25/1998		\$41.59
10/24/1998		\$33.78
12/24/1998		\$16.17
2/25/1999		\$36.80
7/24/1999		\$26.64
10/25/1999		\$26.44
12/22/1999		\$1.28
8/25/2000		\$29.86
12/22/2000		\$28.32
2/23/2001		\$65.93
3/23/2001		\$48.31
7/25/2001		\$48.85
8/24/2001		\$36.43

Escrow Bank Data														
Date	Escrow Royalty Deposits	Income	\$ Mkt Int	CDARS Int	Fees	Distributions	Audit Costs	Corrections	Gain/Loss	Royalty Bonus	Total Int. and Fees	Bank Balance	Running Balance	Difference
2/28/1997	\$39.34	\$34.76			-\$24.23				-\$908.22		-\$897.69	\$16,207.37	\$15,914.20	\$293.17
3/31/1997	\$38.52	\$88.53			-\$24.22				\$796.35		\$860.66	\$17,106.55	\$16,813.38	\$293.17
4/30/1997	\$58.64	\$107.12			-\$24.25				\$20.74		\$103.61	\$17,268.80	\$16,975.63	\$293.17
5/31/1997	\$0.00	\$64.01			-\$24.36				\$36.96		\$76.61	\$17,345.41	\$17,052.24	\$293.17
6/30/1997	\$30.98	\$66.94			-\$14.46				\$12.61		\$65.09	\$17,441.48	\$17,148.31	\$293.17
7/31/1997	\$0.00	\$122.96			-\$24.53				\$41.56		\$139.99	\$17,581.47	\$17,288.30	\$293.17
8/31/1997	\$32.54	\$51.70			-\$14.66						\$37.04	\$17,651.05	\$17,357.88	\$293.17
9/30/1997	\$33.87	\$108.92			-\$24.69						\$84.23	\$17,769.15	\$17,475.98	\$293.17
10/31/1997	\$27.23	\$174.90			-\$49.70				-\$32.39		\$92.81		\$17,596.02	-\$17,596.02
11/30/1997											\$0.00	\$17,889.19	\$17,596.02	\$293.17
12/31/1997	\$0.00	\$111.18							\$0.34		\$111.52	\$18,000.71	\$17,760.24	\$240.47
1/31/1998	\$191.44	\$385.37							\$10.40		\$395.77		\$18,226.56	-\$18,226.56
2/28/1998											\$0.00		\$18,258.91	-\$18,258.91
3/31/1998											\$0.00		\$18,258.91	-\$18,258.91
4/30/1998											\$0.00		\$18,294.75	-\$18,294.75
5/31/1998											\$0.00		\$18,294.75	-\$18,294.75
6/30/1998											\$0.00	\$18,587.92	\$18,336.34	\$251.58
7/31/1998	\$75.37	\$384.60							\$40.84		\$425.44		\$18,761.78	-\$18,761.78
8/31/1998											\$0.00		\$18,761.78	-\$18,761.78
9/30/1998											\$0.00		\$18,761.78	-\$18,761.78
10/31/1998											\$0.00		\$18,795.56	-\$18,795.56
11/30/1998											\$0.00		\$18,795.56	-\$18,795.56
12/31/1998											\$0.00	\$19,088.73	\$18,811.73	\$277.00
1/31/1999	\$16.17	\$94.02							-\$5.69		\$88.33	\$19,193.23	\$18,900.06	\$293.17
2/28/1999	\$0.00	\$54.24			-\$15.64				-\$28.05		\$10.55	\$19,203.78	\$18,947.41	\$256.37
3/31/1999	\$36.80	\$80.68			-\$41.64				\$3.79		\$42.83	\$19,283.41	\$18,990.24	\$293.17
4/30/1999	\$0.00	\$112.11			-\$30.21				-\$7.70		\$74.20	\$19,357.61	\$19,064.44	\$293.17
5/31/1999	\$0.00	\$78.39			-\$17.83				-\$20.29		\$40.27	\$19,397.88	\$19,104.71	\$293.17
6/30/1999	\$0.00	\$84.26			-\$16.01				-\$8.63		\$59.62	\$19,457.50	\$19,164.33	\$293.17
7/31/1999	\$0.00	\$99.43			-\$16.18				-\$7.10		\$76.15	\$19,533.65	\$19,267.12	\$266.53
8/31/1999	\$26.66	\$55.32			-\$16.14				-\$6.14		\$33.04	\$19,593.35	\$19,300.16	\$293.19
9/30/1999	\$0.00	\$106.76			-\$27.00				\$4.18		\$83.94	\$19,677.29	\$19,384.10	\$293.19
10/31/1999	\$0.00	\$80.03			-\$16.39				\$0.80		\$64.44	\$19,741.73	\$19,474.98	\$266.75
11/30/1999	\$26.57	\$60.05			-\$16.45				-\$22.05		\$21.55	\$19,789.85	\$19,496.53	\$293.32
12/31/1999	\$1.28	\$229.90			-\$26.48				-\$33.70		\$169.72	\$19,960.85	\$19,667.53	\$293.32
1/31/2000	\$0.00	\$55.38									\$55.38	\$20,016.23	\$19,722.91	\$293.32
2/29/2000	\$0.00	\$61.84									\$61.84	\$20,078.07	\$19,784.75	\$293.32
3/31/2000	\$0.00	\$69.15									\$69.15	\$20,147.23	\$19,853.90	\$293.33
4/30/2000	\$0.00	\$64.60									\$64.60	\$20,211.83	\$19,918.50	\$293.33
5/31/2000	\$0.00	\$88.17									\$88.17	\$20,300.00	\$20,006.67	\$293.33
6/30/2000	\$0.00	\$82.29									\$82.29	\$20,382.29	\$20,088.96	\$293.33
7/31/2000	\$0.00	\$66.27									\$66.27	\$20,468.56	\$20,155.23	\$313.33
8/31/2000	\$29.90	\$86.44									\$86.44	\$20,584.90	\$20,271.53	\$313.37
9/30/2000	\$0.00	\$81.11				\$0.00					\$81.11	\$20,666.01	\$20,352.64	\$313.37
10/31/2000	\$0.00	\$93.84									\$93.84	\$20,759.85	\$20,446.48	\$313.37
11/30/2000	\$0.00	\$86.59									\$86.59	\$20,846.44	\$20,533.07	\$313.37
12/31/2000	\$28.36	\$84.72				\$0.00					\$84.72	\$20,959.52	\$20,646.11	\$313.41
1/31/2001	\$0.00	\$88.69				\$0.00					\$88.69	\$21,048.21	\$20,734.80	\$313.41
2/28/2001	\$65.93	\$151.22				\$0.00					\$151.22	\$21,176.67	\$20,951.95	\$224.72
3/31/2001	\$48.31	\$67.37				\$0.00					\$67.37	\$21,292.35	\$21,067.63	\$224.72
5/31/2001	\$0.00	\$54.19				\$0.00					\$54.19	\$21,412.68	\$21,121.82	\$290.86
6/30/2001	\$0.00	\$45.63				\$0.00					\$45.63	\$21,458.31	\$21,167.45	\$290.86
7/31/2001	\$48.85	\$47.92				\$0.00					\$47.92	\$21,555.08	\$21,264.22	\$290.86
8/31/2001	\$36.43	\$46.62				\$0.00					\$46.62	\$21,638.13	\$21,347.27	\$290.86
9/30/2001	\$0.00	\$34.79				\$0.00					\$34.79	\$21,672.92	\$21,382.06	\$290.86

Exhibit J
Unit T14 Escrow Account Reconciliation
VGOB 92-0317-0198

CNX Deposit Information		
Check Date	Check Number	Total
12/24/2001		\$27.30
4/25/2002		\$28.72
6/25/2002		\$36.02
7/25/2002		\$29.31
9/25/2002		\$52.53
10/25/2002		\$32.14
11/25/2002		\$25.18
12/24/2002		\$27.12
1/24/2003		\$25.50
3/25/2003		\$38.83
5/23/2003		\$48.60
6/25/2003		\$30.34
7/25/2003		\$25.94
8/25/2003		\$30.98
9/25/2003		\$30.53
10/24/2003		\$27.59
12/24/2003		\$37.79
2/25/2004		\$40.94
3/25/2004		\$26.92
4/25/2004		\$31.18
5/25/2004		\$32.95
6/25/2004		\$26.09
7/25/2004		\$34.15
8/25/2004		\$44.63
9/25/2004		\$45.09
10/25/2004		\$43.99
11/25/2004		\$39.32
12/25/2004		\$40.29
1/25/2005		\$27.02
5/25/2005		\$29.38
7/25/2005		\$37.51
8/25/2005		\$41.69
9/23/2005		\$47.12
10/25/2005		\$53.76
11/25/2005		\$53.22
12/23/2005		\$84.50
1/25/2006		\$59.56
2/24/2006		\$72.57
3/24/2006		\$74.99
4/25/2006		\$57.66

Escrow Bank Data														
Date	Escrow Royalty Deposits	Income	\$ Mkt Int	CDARS Int	Fees	Distributions	Audit Costs	Corrections	Gain/Loss	Royalty Bonus	Total Int. and Fees	Bank Balance	Running Balance	Difference
10/31/2001	\$0.00	\$31.26				\$0.00					\$31.26	\$21,704.18	\$21,413.32	\$290.86
11/30/2001	\$0.00	\$0.00				\$0.00					\$0.00	\$21,728.72	\$21,413.32	\$315.40
12/31/2001	\$27.33	\$26.28				\$0.00					\$26.28	\$21,782.33	\$21,466.90	\$315.43
1/31/2002	\$0.00	\$15.60				\$0.00					\$15.60	\$21,797.93	\$21,482.50	\$315.43
2/28/2002	\$0.00	\$11.54				\$0.00					\$11.54	\$21,809.47	\$21,494.04	\$315.43
3/31/2002	\$0.00	\$12.76				\$0.00					\$12.76	\$21,822.23	\$21,506.80	\$315.43
4/30/2002	\$28.76	\$0.00				\$0.00					\$0.00	\$21,850.99	\$21,535.52	\$315.47
5/31/2002	\$0.00	\$14.21				\$0.00					\$14.21	\$21,865.20	\$21,549.73	\$315.47
6/30/2002	\$36.02	\$11.95				\$0.00					\$11.95	\$21,913.17	\$21,597.70	\$315.47
7/31/2002	\$29.31	\$11.33				\$0.00					\$11.33	\$21,953.81	\$21,638.34	\$315.47
8/31/2002	\$0.00	\$11.91				\$0.00					\$11.91	\$21,965.72	\$21,650.25	\$315.47
9/30/2002	\$52.53	\$11.55				\$0.00					\$11.55	\$22,029.80	\$21,714.33	\$315.47
10/31/2002	\$32.14	\$9.79				\$0.00					\$9.79	\$22,071.73	\$21,756.26	\$315.47
11/30/2002	\$25.18	\$10.83				\$0.00					\$10.83	\$22,107.74	\$21,792.27	\$315.47
12/31/2002	\$27.12	\$10.23				\$0.00					\$10.23	\$22,145.09	\$21,829.62	\$315.47
1/31/2003	\$25.50	\$5.03				\$0.00					\$5.03	\$22,175.62	\$21,860.15	\$315.47
2/28/2003	\$0.00	\$4.61				\$0.00					\$4.61	\$22,180.23	\$21,864.76	\$315.47
3/31/2003	\$38.83	\$2.31				\$0.00					\$2.31	\$22,221.37	\$21,905.90	\$315.47
4/30/2003	\$0.00	\$3.77				\$0.00					\$3.77	\$22,225.14	\$21,909.67	\$315.47
5/31/2003	\$48.60	\$2.62				\$0.00					\$2.62	\$22,276.36	\$21,960.89	\$315.47
6/30/2003	\$30.34	\$3.61				\$0.00					\$3.61	\$22,310.31	\$21,994.84	\$315.47
7/31/2003	\$25.94	\$2.20				\$0.00					\$2.20	\$22,338.45	\$22,022.98	\$315.47
8/31/2003	\$30.98	\$0.91				\$0.00					\$0.91	\$22,370.34	\$22,054.87	\$315.47
9/30/2003	\$30.53	\$0.80				\$0.00					\$0.80	\$22,401.67	\$22,086.20	\$315.47
10/31/2003	\$27.59	\$1.23				\$0.00					\$1.23	\$22,430.49	\$22,115.02	\$315.47
11/30/2003	\$0.00	\$1.90				\$0.00					\$1.90	\$22,432.39	\$22,116.92	\$315.47
12/31/2003	\$37.96	\$1.23				\$0.00					\$1.23	\$22,471.58	\$22,155.94	\$315.64
1/31/2004	\$0.00	\$2.31				\$0.00					\$2.31	\$22,473.89	\$22,158.25	\$315.64
2/28/2004	\$40.94	\$1.66				\$0.00					\$1.66	\$22,516.49	\$22,200.85	\$315.64
3/31/2004	\$26.92	\$1.01				\$0.00					\$1.01	\$22,544.42	\$22,228.78	\$315.64
4/30/2004	\$31.18	\$2.70				\$0.00					\$2.70	\$22,578.30	\$22,262.66	\$315.64
5/31/2004	\$32.95	\$2.66				\$0.00					\$2.66	\$22,613.91	\$22,298.27	\$315.64
6/30/2004	\$26.09	\$3.61				\$0.00					\$3.61	\$22,643.61	\$22,327.97	\$315.64
7/31/2004	\$34.15	\$4.69				\$0.00					\$4.69	\$22,682.45	\$22,366.81	\$315.64
8/31/2004	\$44.63	\$9.65				\$0.00					\$9.65	\$22,736.73	\$22,421.09	\$315.64
9/30/2004	\$45.09	\$11.48				\$0.00					\$11.48	\$22,793.78	\$22,477.66	\$316.12
10/31/2004	\$43.99	\$13.63				\$0.00					\$13.63	\$22,851.40	\$22,535.28	\$316.12
11/30/2004	\$39.32	\$17.82				\$0.00					\$17.82	\$22,908.54	\$22,592.42	\$316.12
12/31/2004	\$40.29	\$17.68				\$0.00					\$17.68	\$22,966.51	\$22,650.39	\$316.12
1/31/2005	\$27.02	\$23.75				\$0.00					\$23.75	\$23,017.28	\$22,701.16	\$316.12
2/28/2005	\$0.00	\$26.99				\$0.00					\$26.99	\$23,044.27	\$22,728.15	\$316.12
3/31/2005	\$0.00	\$26.29				\$0.00					\$26.29	\$23,070.56	\$22,754.44	\$316.12
4/30/2005	\$0.00	\$34.60				\$0.00					\$34.60	\$23,105.16	\$22,789.04	\$316.12
5/31/2005	\$29.69	\$36.99				\$0.00					\$36.99	\$23,171.84	\$22,855.41	\$316.43
6/30/2005	\$0.00	\$39.99				\$0.00					\$39.99	\$23,211.83	\$22,895.40	\$316.43
7/31/2005	\$37.51	\$40.05				\$0.00					\$40.05	\$23,289.39	\$22,972.96	\$316.43
8/31/2005	\$41.69	\$45.19				\$0.00					\$45.19	\$23,376.27	\$23,059.84	\$316.43
9/30/2005	\$47.12	\$48.72				\$0.00					\$48.72	\$23,472.11	\$23,155.68	\$316.43
10/31/2005	\$53.76	\$50.34				\$0.00					\$50.34	\$23,576.21	\$23,259.78	\$316.43
11/30/2005	\$53.22	\$51.84				\$0.00					\$51.84	\$23,681.27	\$23,364.84	\$316.43
12/31/2005	\$84.50	\$56.05				\$0.00					\$56.05	\$23,821.82	\$23,505.39	\$316.43
1/31/2006	\$59.56	\$62.50				\$0.00					\$62.50	\$23,943.88	\$23,627.45	\$316.43
2/28/2006	\$72.57	\$62.39				\$0.00					\$62.39	\$24,078.84	\$23,762.41	\$316.43
3/31/2006	\$74.99	\$64.74				\$0.00					\$64.74	\$24,218.57	\$23,902.14	\$316.43
4/30/2006	\$57.66	\$75.23				\$0.00					\$75.23	\$24,351.46	\$24,035.03	\$316.43
5/31/2006	\$0.00	\$72.56				\$0.00					\$72.56	\$24,424.02	\$24,107.59	\$316.43

