

BEFORE THE VIRGINIA GAS AND OIL BOARD

PETITIONER: CNX Gas Company LLC

DIVISION OF GAS AND OIL

DOCKET NO: VGOB 91-1119-0161-07

RELIEF SOUGHT: (1) DISBURSEMENT FROM ESCROW REGARDING TRACT(S) 11B, A portion of 20, A portion of 21, 22, A portion of 5, A portion of 5A, 8B (2) AND AUTHORIZATION FOR DIRECT PAYMENT OF ROYALTIES (3) AND DISMISSAL OF COAL OWNERS PURSUANT TO CODE OF VIRGINIA SECTION 45.1-361.22:2.

HEARING DATE: March 21, 2017

DRILLING UNIT: BUNE1

BUCHANAN COUNTY, VIRGINIA

PETITION FOR ORDER OF DISBURSEMENT OF ESCROW FUNDS

1. Petitioner and its counsel

Petitioner is CNX Gas Company LLC, PO Box 570, Pounding Mill, VA 24637, (276)596-5075. Petitioner's counsel is Mark A. Swartz, Hillard & Swartz, LLP, 122 Capital Street, Suite 201, Charleston, WV 25301.

2. Relief Sought

(1) the disbursement of escrowed funds heretofore deposited with the Board's Escrow Agent(s) attributable to Tract(s) 5, 5A, 8B, 11B, 20, 21, 22 as depicted upon the annexed Table; and (2) authorization to begin paying royalties directly to Emmanuel Wade, Sherman Baldwin, Nancy Wooten Komp, Sandra Cranmer, Donna Foote, Pamela Case, Rufus Baldwin, David Baldwin, Tammy Muir, Eddie Baldwin, Kathy Whitt, Lisa Shaver, Patti Gilbert, Michael T. Boyd, Venia Wade Newberry, Virginia Edith Smith, Yukon Pocahontas Coal Company, Buchanan Coal Company, Sayers-Pocahontas Coal Company, Highland Resources/North American Resources Corp, Janet Weatherford, William Tickle, Jr., Commonwealth of Virginia, Rockport Oil & Gas and Chisos, LTD; (3) Dismissal of Coal owner(s): Hugh MacRae Land Trust (Torch Oil & Gas).

3. Legal Authority

Va. Code Ann. § 45.1-361.1 et seq., 4 VAC 25-160-140., and relevant Virginia Gas and Oil Board Orders ("Board") heretofore promulgated pursuant to law.

4. Type of Well(s)

Sealed Gob Unit

5. Factual basis for relief requested

- a. Rockport Oil & Gas and Chisos, LTD(formerly Torch Oil & Gas) and Emmanuel Wade have entered into royalty split agreement(s). Said royalty split agreement(s) allow the Applicant and Designated Operator to pay royalties directly to the persons identified in Exhibit EE
- b. Sherman Baldwin, Nancy Wooten Komp, Sandra Cranmer, Donna Foote, Pamela Case, Rufus Baldwin, David Baldwin, Tammy Muir, Eddie Baldwin, Kathy Whitt, Lisa Shaver, Patti Gilbert, Michael T. Boyd, Venia Wade Newberry, Virginia Edith Smith, Yukon Pocahontas Coal Company, Buchanan Coal Company, Sayers-Pocahontas Coal Company, Highland Resources/North American Resources Corp, Janet Weatherford, William Tickle, Jr., Commonwealth of Virginia is the gas claimant in Tracts 5, 5A, 8B, 11B, 20, 21, 22. As such Sherman Baldwin, Nancy Wooten Komp, Sandra Cranmer, Donna Foote, Pamela Case, Rufus Baldwin, David Baldwin, Tammy Muir, Eddie Baldwin, Kathy Whitt, Lisa Shaver, Patti Gilbert, Michael T. Boyd, Venia Wade Newberry, Virginia Edith Smith, Yukon Pocahontas Coal Company, Buchanan Coal Company, Sayers-Pocahontas Coal Company, Highland Resources/North American Resources Corp, Janet Weatherford, William Tickle, Jr., Commonwealth of Virginia are entitled to 100% of the CBM royalties now in escrow and as may be hereafter payable. See Va. Code Ann. § 45.1-361.22:2.A.
- c. That CNX Gas Company LLC has given the notice(s) required by § 45.1-361.22:2.A to all conflicting claimants identified in the above referenced pooling Order and any supplemental Orders pertaining thereto.
- d. That none of the conflicting claimants noticed have provided, within 45 days of the notice(s) given as provided in b. above, the Board, its designated agent the Director of the Division of Gas and Oil, the Operator and/or the Applicant evidence of either an agreement regarding the escrowed funds/royalties or a proceeding regarding same.
- e. That a detailed accounting in accordance with the applicable provisions of § 45.1-361.22 is submitted herewith and identified as Exhibit J.
- f. That an Exhibit identified as Table 1 is annexed hereto, and it specifies how the disbursement (s) is to be calculated and paid by the escrow agent.
- g. That Va. Code Ann. § 45.1-361.22:2.A. further provides that the Operator shall pay such royalties as may hereafter be payable directly to the gas claimant Sherman Baldwin, Nancy Wooten Komp, Sandra Cranmer, Donna Foote, Pamela Case, Rufus Baldwin, David Baldwin, Tammy Muir, Eddie Baldwin, Kathy Whitt, Lisa Shaver, Patti Gilbert, Michael T. Boyd, Venia Wade Newberry, Virginia Edith Smith, Yukon Pocahontas Coal Company, Buchanan Coal Company, Sayers-Pocahontas Coal Company, Highland Resources/North American Resources Corp, Janet Weatherford, William Tickle, Jr., Commonwealth of Virginia and not escrow same. See Exhibit EE annexed hereto.

6. Attestation

The foregoing Petition to the best of my knowledge, information, and belief is true and correct.

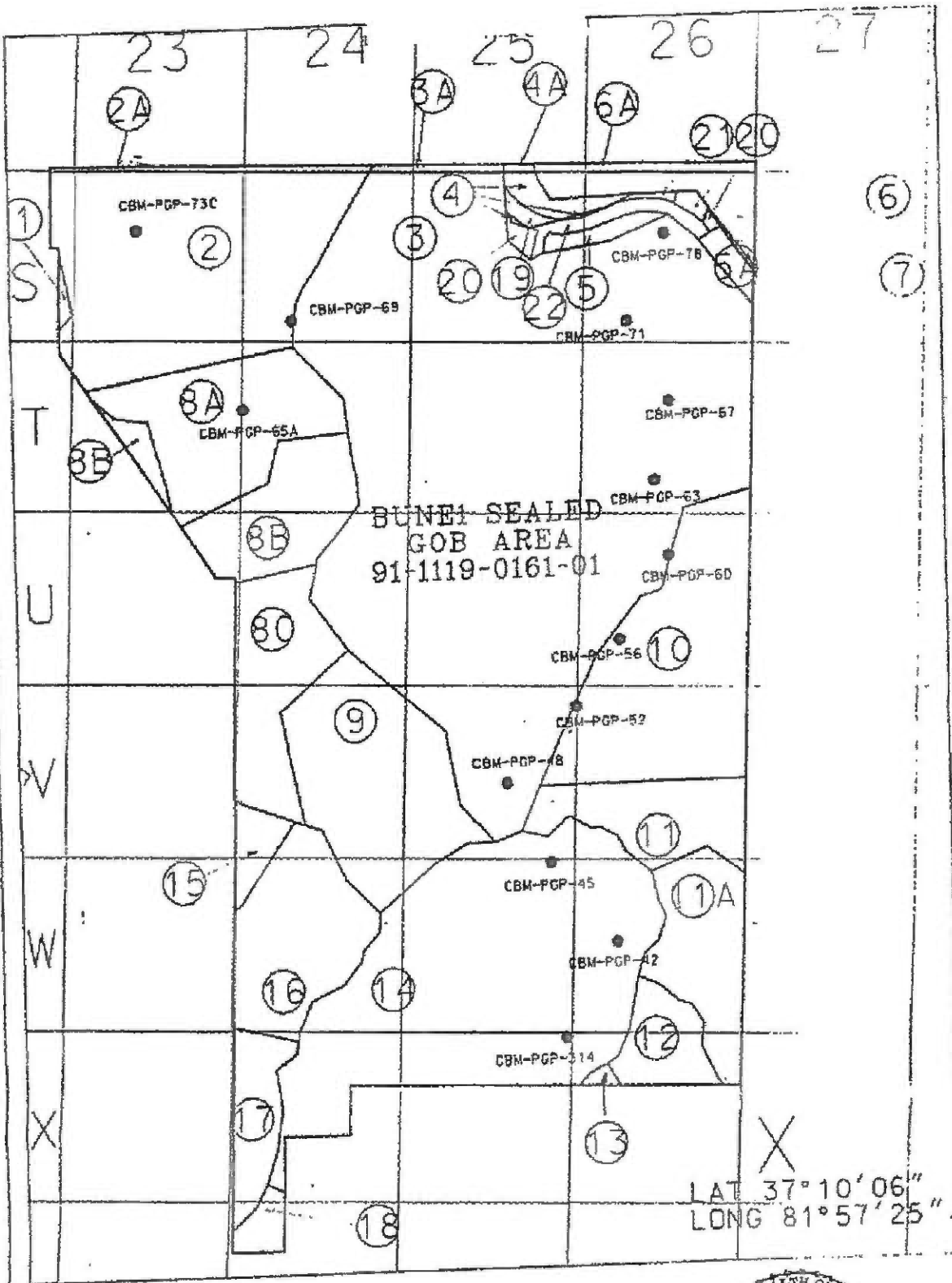

CONSOL INC.
 BUCHANAN NO. 1
 BUNE 1
 91-1119-0161-01
 EXHIBIT A1

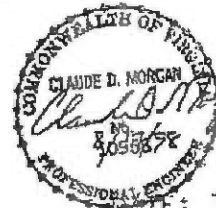

DATE: 7-15-98
 SCALE 1"=100'

EXHIBIT A-1 Supplement BUNE1 SGU

10

3

11 - Torch Oil & Gas Co. / CNX Gas Company LLC
35.60 Acres

11C - Torch Oil & Gas Co. / Garden Realty Corp.
2.38 Acres

11A - Torch Oil & Gas Co. / CNX Gas Company LLC
16.60 Acres

11B - Torch Oil & Gas Co. /
CNX Gas Company (1/2)
William Tickle, Jr. (1/2)
25.91 Acres

12 - Torch Oil & Gas Co. / Ira Mutter
20.44 Acres

13C - Torch Oil & Gas Co. / Monta Mutter
0.04 Acres

13A - Torch Oil & Gas Co. / Fern Duecaster
0.94 Acres

13B - Torch Oil & Gas Co. / Kimberly R. Davis
0.34 Acres

BUNE1 Sealed Gob Boundary

POCAHONTAS GAS PARTNERSHIP
UNIT BUNE 1
Tract Identifications

1. Yukon Pocahontas Coal Co., et al - Tr. 18 - Coal, Oil & Gas
 Coal Lessees
 Consolidation Coal Co. - Pocahontas #3 Seam
 Jewell Smokeless Coal Corp.
 Permac Inc.
 Pocahontas Gas Partnership - CBM Lessee
 1.44 Acres 0.09706%

2. Yukon Pocahontas Coal Co., et al - Tr. 100 - Coal, Oil & Gas
 Coal Lessees
 Consolidation Coal Co. - Pocahontas #3 Seam
 Jewell Smokeless Coal Corp.
 Permac Inc.
 Pocahontas Gas Partnership - CBM Lessee
 143.84 Acres 9.69488%

- 2A. Yukon Pocahontas Coal Co., et al - Tr. 100 - Coal, Oil & Gas
 Coal Lessees
 Consolidation Coal Co. - Pocahontas #3 Seam
 Jewell Smokeless Coal Corp.
 Permac Inc.
 Buchanan Production Company - CBM Lessee
 4.76 Acres 0.32083%

3. Hugh MacRae Land Trust - Tr. 23 - Coal
 Torch Operating Company - CBM Royalty Owner
 Coal Lessees
 Consolidation Coal Co. - Below Drainage Coal
 United Coal Company
 Pocahontas Gas Partnership - CBM Lessee
 Pocahontas Gas Partnership - Oil & Gas Lessee
 Garden Realty Corporation - Oil & Gas
 526.17 Acres 35.46409%

- 3A. Hugh MacRae Land Trust - Tr. 23 - Coal
 Torch Operating Company - CBM Royalty Owner
 Coal Lessees
 Consolidation Coal Co. - Pocahontas #3 Seam
 United Coal Company
 Buchanan Production Company - CBM Lessee
 Buchanan Production Company - Oil & Gas Lessee
 Garden Realty Corporation - Oil & Gas
 2.61 Acres 0.17592%

4. Modern Homes Inc. - Coal Oil & Gas
 Coal Lessees
 Consolidation Coal Co. - Below Drainage Coal
 Pocahontas Gas Partnership - CBM Lessee
 Pocahontas Gas Partnership - Oil & Gas Lessee
 4.87 Acres 0.32834%

POCAHONTAS GAS PARTNERSHIP
UNIT BUNE 1
Tract identifications

- 4A. Modem Homes Inc. - Coal Oil & Gas
 Coal Lessees
 Consolidation Coal Co. - Below Drainage Coal
 Buchanan Production Company- CBM Lessee
 Buchanan Production Company - Oil & Gas Lessee
 0.73 Acres 0.04920%
5. Hugh MacRae Land Trust - Coal
 Torch Operating Company - CBM Royalty Owner
 Coal Lessees
 Consolidation Coal Co. - Below Drainage Coal
 United Coal Company
 Pocahontas Gas Partnership - CBM Lessee
 Walter Wade Heirs 1/5 - Oil & Gas
 Lida Vandyke 4/5 -Oil & Gas
 3.30 Acres 0.22242%
- 5A. Hugh MacRae Land Trust - Coal
 Torch Operating Company - CBM Royalty Owner
 Coal Lessees
 Consolidation Coal Co. - Below Drainage Coal
 United Coal Company
 Pocahontas Gas Partnership - CBM Lessee
 Walter Wade Heirs 1/5 - Oil & Gas
 Yukon Pocahontas Coal Co. Et al. 4/5 -Oil & Gas
 3.89 Acres 0.26219%
6. Yukon Pocahontas Coal Co., et al - Tr. 20 - Coal, Oil & Gas
 Coal Lessees
 Consolidation Coal Co. - Pocahontas #3 Seam
 Jewell Smokeless Coal Corp.
 Permac Inc.
 Pocahontas Gas Partnership - CBM Lessee
 19.38 Acres 1.30522%
- 6A. Yukon Pocahontas Coal Co., et al - Tr. 20 - Coal, Oil & Gas
 Coal Lessees
 Consolidation Coal Co. - Pocahontas #3 Seam
 Jewell Smokeless Coal Corp.
 Permac Inc.
 Buchanan Production Company - CBM Lessee
 5.80 Acres 0.39092%
7. Yukon Pocahontas Coal Co., et al - Tr. 99 - Coal, Oil & Gas
 Coal Lessees
 Consolidation Coal Co. - Pocahontas #3 Seam
 Jewell Smokeless Coal Corp.
 Permac Inc.
 Pocahontas Gas Partnership - CBM Lessee
 0.69 Acres 0.04651%

POCAHONTAS GAS PARTNERSHIP
UNIT BUNE 1
Tract Identifications

- 8A. Hugh MacRae Land Trust - Tr. 11 - Coal
Torch Operating Company - CBM Royalty Owner
Coal Lessees
Consolidation Coal Co. - Below Drainage Coal
United Coal Company
Pocahontas Gas Partnership - Oil & Gas
65.64 Acres 4.42416%
- 8B. Hugh MacRae Land Trust - Tr. 11 - Coal
Torch Operating Company - CBM Royalty Owner
Coal Lessees
Consolidation Coal Co. - Below Drainage Coal
United Coal Company
Pocahontas Gas Partnership - Oil & Gas
Janet Weatherford - 1/8 Gas Royalty Interest
48.01 Acres 3.23589%
- 8C. Hugh MacRae Land Trust - Tr. 11 - Coal
Torch Operating Company - CBM Royalty Owner
Coal Lessees
Consolidation Coal Co. - Below Drainage Coal
United Coal Company
Pocahontas Gas Partnership - Oil & Gas
Clinton Don Wood - 1/8 Gas Royalty Interest
48.22 Acres 3.25005%
9. Hugh MacRae Land Trust - Tr. 11 - Coal
Torch Operating Company - CBM Royalty Owner
Coal Lessees
Consolidation Coal Co. - Below Drainage Coal
United Coal Company
Pocahontas Gas Partnership - CBM Lessee
Pocahontas Gas Partnership - Oil & Gas Lessee
S. J. Mullins Heirs - Oil & Gas
83.27 Acres 5.61243%
10. Hugh MacRae Land Trust - Tr. 6 - Coal
Torch Operating Company - CBM Royalty Owner
Coal Lessees
Consolidation Coal Co. - Below Drainage Coal
United Coal Company
Pocahontas Gas Partnership - Oil & Gas
103.33 Acres 6.96449%

**POCAHONTAS GAS PARTNERSHIP
UNIT BUNE 1
Tract Identifications**

- | | | |
|------|--|--|
| 11. | Hugh MacRae Land Trust - Tr. 17 - Coal
Torch Operating Company - CBM Royalty Owner
Coal Lessees
Consolidation Coal Co. - Below Drainage Coal
United Coal Company
Pocahontas Gas Partnership - Oil & Gas
37.88 Acres 2.55987% |]
(See Tract Identification Supplement) |
| 11A. | Hugh MacRae Land Trust - Tr. 17 - Coal
Torch Operating Company - CBM Royalty Owner
Coal Lessees
Consolidation Coal Co. - Below Drainage Coal
United Coal Company
1/4 Pocahontas Gas Partnership - Oil & Gas
1/4 William Tickle - Oil & Gas
42.51 Acres 2.86518% |]
(See Tract Identification Supplement) |
| 12. | Hugh MacRae Land Trust - Tr. 17 - Coal
Torch Operating Company - CBM Royalty Owner
Coal Lessees
Consolidation Coal Co. - Below Drainage Coal
United Coal Company
Pocahontas Gas Partnership - Oil & Gas Lessee
Pocahontas Gas Partnership - CBM Lessee
L. Mutter Heirs - Oil & Gas
20.44 Acres 1.37766% | |
| 13. | Hugh MacRae Land Trust - Tr. 10 - Coal
Torch Operating Company - CBM Royalty Owner
Coal Lessees
Consolidation Coal Co. - Below Drainage Coal
United Coal Company
Pocahontas Gas Partnership - Oil & Gas Lessee
Pocahontas Gas Partnership - CBM Lessee
R. C. Mutter Heirs - Oil & Gas
1.32 Acres 0.06897% |]
(See Tract Identification Supplement) |
| 14. | Hugh MacRae Land Trust - Tr. 24 - Coal
Torch Operating Company - CBM Royalty Owner
Coal Lessees
Consolidation Coal Co. - Below Drainage Coal
United Coal Company
Pocahontas Gas Partnership - Oil & Gas
201.06 Acres 13.55288% | |

**POCAHONTAS GAS PARTNERSHIP
UNIT BUNE 1
Tract Identifications**

- 15. Hugh MacRae Land Trust - Tr. 13 - Coal
Torch Operating Company - CBM Royalty Owner
Coal Lessees
Consolidation Coal Co. - Below Drainage Coal
United Coal Company
Pocahontas Gas Partnership - Oil & Gas
9.35 Acres 0.63018%
- 16. Hugh MacRae Land Trust - Tr. 13 - Coal
Torch Operating Company - CBM Royalty Owner
Coal Lessees
Consolidation Coal Co. - Below Drainage Coal
United Coal Company
Pocahontas Gas Partnership - Oil & Gas
56.90 Acres 3.83508%
- 17. Hugh MacRae Land Trust - Tr. 13 - Coal
Torch Operating Company - CBM Royalty Owner
Coal Lessees
Consolidation Coal Co. - Below Drainage Coal
United Coal Company
Pocahontas Gas Partnership - Oil & Gas
23.22 Acres 1.56504%
- 18. Hugh MacRae Land Trust - Tr. 10 - Coal
Torch Operating Company - CBM Royalty Owner
Coal Lessees
Consolidation Coal Co. - Below Drainage Coal
United Coal Company
Pocahontas Gas Partnership - Oil & Gas
6.98 Acres 0.47046%
- 19. Virginia Department of Transportation - Coal (except P-3 seam), Oil & Gas
Consolidation Coal Company - Pocahontas #3 Seam
Pocahontas Gas Partnership - Oil & Gas Lessee
2.14 Acres 0.14424%
- 20. Hugh MacRae Land Trust - Coal
Torch Operating Company - CBM Royalty Owner
Coal Lessees
Consolidation Coal Co. - Below Drainage Coal
United Coal Company
Pocahontas Gas Partnership - CBM Lessee
Walter Wade Hairs 1/5 - Oil & Gas
Modern Homes Inc. 4/5 - Oil & Gas
10.00 Acres 0.67400%

POCAHONTAS GAS PARTNERSHIP

UNIT BUNE 1

Tract Identifications

21. Hugh MacRae Land Trust - Coal
Torch Operating Company - CBM Royalty Owner
Coal Lessees
Consolidation Coal Co. - Below Drainage Coal
United Coal Company
Pocahontas Gas Partnership - CBM Lessee
Walter Wade Hairs 1/5 - Oil & Gas
Pepsico of Norton Inc. 4/5 -Oil & Gas
0.80 Acres 0.05382%
22. Hugh MacRae Land Trust - Coal
Torch Operating Company - CBM Royalty Owner
Coal Lessees
Consolidation Coal Co. - Below Drainage Coal
United Coal Company
Pocahontas Gas Partnership - CBM Lessee
Virginia Department of Transportation - Oil & Gas
5.00 Acres 0.33700%

CNX Gas Company LLC
UNIT BUNE 1
Tract Identification Supplement

11. Hugh MacRae Land Trust, Tract 17 (632.50 Acre Tract) – Coal Consolidation Coal Company – Coal Below Drainage Leased
CNX Gas Company LLC – CBM Leased
CNX Gas Company LLC – Oil and Gas
35.60 acres 2.3995%
- 11A. Hugh MacRae Land Trust, Tract 17 (632.50 Acre Tract) – Coal Consolidation Coal Company – Coal Below Drainage Leased
CNX Gas Company LLC – CBM Leased
CNX Gas Company LLC – Oil and Gas
16.60 acres 1.1189%
- 11B. Hugh MacRae Land Trust, Tract 17 (632.50 Acre Tract) – Coal Consolidation Coal Company – Coal Below Drainage Leased
CNX Gas Company LLC – CBM Leased
William Tickle, Jr. – Oil and Gas (1/2)
CNX Gas Company LLC – Oil, Gas and CBM Leased
CNX Gas Company LLC – Oil and Gas (1/2)
25.91 acres 1.7463%
- 11C. Hugh MacRae Land Trust, Tract 17 (632.50 Acre Tract) – Coal Consolidation Coal Company – Coal Below Drainage Leased
CNX Gas Company LLC – CBM Leased
Garden Realty Corporation – Oil and Gas
CNX Gas Company LLC – Oil, Gas and CBM Leased
2.38 acres 0.1604%
12. Hugh MacRae Land Trust, Tract 10 (398.00 Acre Tract) – Coal Consolidation Coal Company – Coal Below Drainage Leased
CNX Gas Company LLC – CBM Leased
Ira C. Mutter, et ux (L. Mutter Heirs) – Oil and Gas
CNX Gas Company LLC – Oil, Gas and CBM Leased
20.44 acres 1.3777%
- 13A. Hugh MacRae Land Trust, Tract 10 (398.00 Acre Tract) – Coal Consolidation Coal Company – Coal Below Drainage Leased
CNX Gas Company LLC – CBM Leased
Fern Duecaster (R.C. Mutter Heirs) – Oil and Gas
CNX Gas Company LLC – Oil, Gas and CBM Leased
0.94 acres 0.0634%
- 13B. Hugh MacRae Land Trust, Tract 10 (398.00 Acre Tract) – Coal Consolidation Coal Company – Coal Below Drainage Leased
CNX Gas Company LLC – CBM Leased
Kimberly Davis (R.C. Mutter Heirs) – Oil and Gas
CNX Gas Company LLC – Oil, Gas and CBM Leased
0.34 acres 0.0229%

"This title block is for general informational purposes only and does not reflect an analysis of the severance deed and its effect upon coal bed methane ownership and should not be relied upon for such purpose."

**CNX Gas Company LLC
UNIT BUNE 1
Tract Identification Supplement**

- 13C. Hugh MacRae Land Trust, Tract 10 (398.00 Acre Tract) – Coal
Consolidation Coal Company – Coal Below Drainage Leased
CNX Gas Company LLC – CBM Leased
Monta G. Mutter (R.C. Mutter Heirs) – Oil and Gas
CNX Gas Company LLC – Oil, Gas and CBM Leased
0.04 acres 0.0027%

"This title block is for general informational purposes only and does not reflect an analysis of the severance deed and its effect upon coal bed methane ownership and should not be relied upon for such purpose."

VGOB Disbursement

Unit BUNE1

VGOB-91-1119-0161-07

Table 1

Tracts: 11B, A portion of 20, A portion of 21, 22, A portion of 5, A portion of 5A, 8B

Item	Tract	Disbursement Table	Fractional Ownership in Tract	Net Acreage in Tract	Royalty Split Agreement	Escrowed Acres Disbursed	Percent of Escrowed Funds Disbursed	Disbursement
		Total acreage in escrow before disbursement				214.95000		
5 Tract 5 (total acreage)			3.3000					
1	5	Emmanuel Wade\226 Adams St Blountville TN 37617	1/60	0.0550	50.00%	0.0275	0.0128%	\$61.08
2	5	Sandra Cranmer\11651 SE 69th Terr, Lot 18 Belleview FL 34420	1/720	0.0046	100.00%	0.0046	0.0021%	\$10.18
3	5	Donna Foote\32632 Downing Rd Delmar MD 21875	1/720	0.0046	100.00%	0.0046	0.0021%	\$10.18
4	5	Pamela Ginger Case\325 2nd St, North Little Rock, AK 72117	1/720	0.0046	100.00%	0.0046	0.0021%	\$10.18
5	5	Rufus Baldwin\208 High St Richlands VA 24641	1/1800	0.0018	100.00%	0.0018	0.0009%	\$4.07
6	5	David Baldwin\PO Box 803 RAven VA 24639	1/1800	0.0018	100.00%	0.0018	0.0009%	\$4.07
7	5	Tammy Baldwin Muir\4480 Clarks valley Rd Swords Creek VA 24649	1/1800	0.0018	100.00%	0.0018	0.0009%	\$4.07
8	5	Eddie Baldwin\1210 Sunset Dr Richlands VA 24641	1/1080	0.0031	100.00%	0.0031	0.0014%	\$6.79
9	5	Kathy Whitt\8740 Swords Creek Rd Swords Creek VA 24649	1/1080	0.0031	100.00%	0.0031	0.0014%	\$6.79
10	5	Lisa Shaver\89 Sevier ST Lebanon, VA 24266-7142	1/1080	0.0031	100.00%	0.0031	0.0014%	\$6.79
11	5	Patti Gilbert\3603 Kent Ridge Rd Cedar Bluff vA 24609	1/90	0.0367	100.00%	0.0367	0.0171%	\$81.44
12	5	Michael T Boyd\3849 Kent Ridge Rd Cedar Bluff VA 24609	1/90	0.0367	100.00%	0.0367	0.0171%	\$81.44
13	5	Venia Wade Newberry\639 Daniel Dr Newport News VA 23601-1701	1/30	0.1100	100.00%	0.1100	0.0512%	\$244.33
14	5	Virginia Edith Smith\PO Box 535 Doran VA 24612	1/120	0.0275	100.00%	0.0275	0.0128%	\$61.08
15	5	Sherman Baldwin\1210 Lake Witten Road North Tazewell VA 24630	1/360	0.0092	100.00%	0.0092	0.0043%	\$20.36
16	5	Nancy Wooten Komp\2510 Arthur Road Springfield OH 45502	1/720	0.0046	100.00%	0.0046	0.0021%	\$10.18
17	5	Rockport Oil & Gas L.L.C\PO Box 847 Houston TX 77001	1/60	0.0550	10.00%	0.0055	0.0026%	\$12.22
18	5	Chisos, LTD\670 Dona Ana Road SW Deming New Mexico 88030	1/60	0.0550	40.00%	0.0220	0.0102%	\$48.87
5A Tract 5A (total acreage)			3.8900					
1	5A	Yukon Pocahontas Coal Company\PO Box 187 Tazewell VA 24651	2/5	1.5560	100.00%	1.5560	0.7239%	\$3,456.19
2	5A	Buchanan Coal Company\PO Box 187 Tazewell VA 24651	4/45	0.3458	100.00%	0.3458	0.1609%	\$768.04
3	5A	Sayers-Pocahontas Coal Company\PO Box 187 Tazewell VA 24651	2/45	0.1729	100.00%	0.1729	0.0804%	\$384.02

5A Tract 5A (total acreage)

3.8900

4	5A	Plum Creek Timberlands\PO Box 1990 Columbia Falls, MT 59912	4/15	1.0373	100.00%	1.0373	0.4826%	\$2,304.13
5	5A	Emmanuel Wade \226 Adams St Blountville TN 37617	1/60	0.0648	50.00%	0.0324	0.0151%	\$72.00
6	5A	Sherman Baldwin\1210 Lake Whitten Rd N Tazewell VA 24630	1/360	0.0108	100.00%	0.0108	0.0050%	\$24.00
7	5A	Nancy Baldwin Wooten Komp\2510 ARthur Rd Springfield OH 45502	1/720	0.0054	100.00%	0.0054	0.0025%	\$12.00
8	5a	Sandra Cranmer \11651 SE 69th Terr, Lot 18 Belleview FL 34420	1/720	0.0054	100.00%	0.0054	0.0025%	\$12.00
9	5A	Donna Foote \32632 Downing Rd Delmar MD 21875	1/720	0.0054	100.00%	0.0054	0.0025%	\$12.00
10	5A	Pamela Ginger Case \325 2nd St, North Little Rock, AK 72117	1/720	0.0054	100.00%	0.0054	0.0025%	\$12.00
11	5A	Rufus Baldwin \208 High St Richlands VA 24641	1/1800	0.0022	100.00%	0.0022	0.0010%	\$4.80
12	5A	David Baldwin \PO Box 803 RAven VA 24639	1/1800	0.0022	100.00%	0.0022	0.0010%	\$4.80
13	5A	Tammy Baldwin Muir \4480 Clarks valley Rd Swords Creek VA 24649	1/1800	0.0022	100.00%	0.0022	0.0010%	\$4.80
14	5A	Eddie Baldwin \1210 Sunset Dr Richlands VA 24641	1/1080	0.0036	100.00%	0.0036	0.0017%	\$8.00
15	5A	Kathy Whitt \8740 Swords Creek Rd Swords Creek VA 24649	1/1080	0.0036	100.00%	0.0036	0.0017%	\$8.00
16	5A	Lisa Shaver \89 Sevier ST Lebanon, VA 24266-7142	1/1080	0.0036	100.00%	0.0036	0.0017%	\$8.00
17	5A	Patti Gilbert \3603 Kent Ridge Rd Cedar Bluff vA 24609	1/90	0.0432	100.00%	0.0432	0.0201%	\$96.01
18	5A	Michael T Boyd \3849 Kent Ridge Rd Cedar Bluff VA 24609	1/90	0.0432	100.00%	0.0432	0.0201%	\$96.01
19	5A	Venia Wade Newberry \639 Daniel Dr Newport News VA 23601-1701	1/30	0.1297	100.00%	0.1297	0.0603%	\$288.02
20	5A	Virginia Edith Smith \PO Box 535 Doran VA 24612	1/120	0.0324	100.00%	0.0324	0.0151%	\$72.00
21	5A	Chisos, LTD\670 Dona Ana Road SW Deming New Mexico 88030	1/60	0.0648	40.00%	0.0259	0.0121%	\$57.60
22	5A	Rockport Oil & Gas L.L.C\PO Box 847 Houston TX 77001	1/60	0.0648	10.00%	0.0065	0.0030%	\$14.40

8B Tract 8B (total acreage)

48.0100

1	8B	Janet Weatherford\PO Box 22483 Alexandria VA 22304		48.0100	100.00%	48.0100	22.3354%	\$106,639.86
---	----	--	--	---------	---------	---------	----------	--------------

11B Tract 11B (total acreage)

12.9600

1	11B	William Tickle, Jr\1663 Chambers Rd Raven VA 24639-8413		12.9600	100.00%	12.9600	6.0293%	\$28,786.76
---	-----	---	--	---------	---------	---------	---------	-------------

20 Tract 20 (total acreage)

10.0000

1	20	Emmanuel Wade\226 Adams St Blountville TN 37617	1/60	0.1667	50.00%	0.0833	0.0388%	\$185.10
2	20	Sherman Baldwin\1210 Lake Whitten Rd N Tazewell VA 24630	1/360	0.0278	100.00%	0.0278	0.0129%	\$61.70
3	20	Nancy Baldwin Wooten Komp\2510 ARthur Rd Springfield OH 45502	1/720	0.0139	100.00%	0.0139	0.0065%	\$30.85
4	20	Sandra Cranmer\11651 SE 69th Terr, Lot 18 Belleview FL 34420	1/720	0.0139	100.00%	0.0139	0.0065%	\$30.85
5	20	Donna Foote\32632 Downing Rd Delmar MD 21875	1/720	0.0139	100.00%	0.0139	0.0065%	\$30.85
6	20	Pamela Ginger Case\325 2nd St, North Little Rock, AK 72117	1/720	0.0139	100.00%	0.0139	0.0065%	\$30.85
7	20	Rufus Baldwin\208 High St Richlands VA 24641	1/1800	0.0056	100.00%	0.0056	0.0026%	\$12.34
8	20	David Baldwin\PO Box 803 RAven VA 24639	1/1800	0.0056	100.00%	0.0056	0.0026%	\$12.34
9	20	Tammy Baldwin Muir\4480 Clarks valley Rd Swords Creek VA 24649	1/1800	0.0056	100.00%	0.0056	0.0026%	\$12.34
10	20	Eddie Baldwin\1210 Sunset Dr Richlands VA 24641	1/1080	0.0093	100.00%	0.0093	0.0043%	\$20.57

20 Tract 20 (total acreage)

10.0000

11	20	Kathy Whitt\8740 Swords Creek Rd Swords Creek VA 24649	1/1080	0.0093	100.00%	0.0093	0.0043%	\$20.57
12	20	Lisa Shaver\89 Sevier ST Lebanon, VA 24266-7142	1/1080	0.0093	100.00%	0.0093	0.0043%	\$20.57
13	20	Patti Gilbert\3603 Kent Ridge Rd Cedar Bluff vA 24609	1/90	0.1111	100.00%	0.1111	0.0517%	\$246.80
14	20	Michael T Boyd\3849 Kent Ridge Rd Cedar Bluff VA 24609	1/90	0.1111	100.00%	0.1111	0.0517%	\$246.80
15	20	Venia Wade Newberry\639 Daniel Dr Newport News VA 23601-1701	1/30	0.3333	100.00%	0.3333	0.1551%	\$740.40
16	20	Virginia Edith Smith\PO Box 335 Doran, VA 24612	1/120	0.0833	100.00%	0.0833	0.0388%	\$185.10
17	20	Chisos, LTD\670 Dona Ana Road SW Deming New Mexico 88030	1/60	0.1667	40.00%	0.0667	0.0310%	\$148.08
18	20	Rockport Oil & Gas L.L.C\PO Box 847 Houston TX 77001	1/60	0.1667	10.00%	0.0167	0.0078%	\$37.02

21 Tract 21 (total acreage)

0.8000

1	21	Emmanuel Wade\226 Adams St Blountville TN 37617	1/60	0.0133	50.00%	0.0067	0.0031%	\$14.81
2	21	Sherman Baldwin\1210 Lake Whitten Rd N Tazewell VA 24630	1/360	0.0022	100.00%	0.0022	0.0010%	\$4.94
3	21	Nancy Baldwin Wooten Komp\2510 ARthur Rd Springfield OH 45502	1/720	0.0011	100.00%	0.0011	0.0005%	\$2.47
4	21	Sandra Cranmer\11651 SE 69th Terr, Lot 18 Belleview FL 34420	1/720	0.0011	100.00%	0.0011	0.0005%	\$2.47
5	21	Donna Foote\32632 Downing Rd Delmar MD 21875	1/720	0.0011	100.00%	0.0011	0.0005%	\$2.47
6	21	Pamela Ginger Case\325 2nd St, North Little Rock, AK 72117	1/720	0.0011	100.00%	0.0011	0.0005%	\$2.47
7	21	Rufus Baldwin\208 High St Richlands VA 24641	1/1800	0.0004	100.00%	0.0004	0.0002%	\$0.99
8	21	David Baldwin\PO Box 803 RAven VA 24639	1/1800	0.0004	100.00%	0.0004	0.0002%	\$0.99
9	21	Tammy Baldwin Muir\4480 Clarks valley Rd Swords Creek VA 24649	1/1800	0.0004	100.00%	0.0004	0.0002%	\$0.99
10	21	Eddie Baldwin\1210 Sunset Dr Richlands VA 24641	1/1080	0.0007	100.00%	0.0007	0.0003%	\$1.65
11	21	Kathy Whitt \8740 Swords Creek Rd Swords Creek VA 24649	1/1080	0.0007	100.00%	0.0007	0.0003%	\$1.65
12	21	Lisa Shaver\89 Sevier ST Lebanon, VA 24266-7142	1/1080	0.0007	100.00%	0.0007	0.0003%	\$1.65
13	21	Patti Gilbert\3603 Kent Ridge Rd Cedar Bluff vA 24609	1/90	0.0089	100.00%	0.0089	0.0041%	\$19.74
14	21	Michael T Boyd\3849 Kent Ridge Rd Cedar Bluff VA 24609	1/90	0.0089	100.00%	0.0089	0.0041%	\$19.74
15	21	Venia Wade Newberry\639 Daniel Dr Newport News VA 23601-1701	1/30	0.0267	100.00%	0.0267	0.0124%	\$59.23
16	21	Virginia Edith Smith\PO Box 335 Doran, VA 24612	1/120	0.0067	100.00%	0.0067	0.0031%	\$14.81
17	21	Chisos, LTD\670 Dona Ana Road SW Deming New Mexico 88030	1/60	0.0133	40.00%	0.0053	0.0025%	\$11.85
18	21	Rockport Oil & Gas L.L.C\PO Box 847 Houston TX 77001	1/60	0.0133	10.00%	0.0013	0.0006%	\$2.96

22 Tract 22 (total acreage)

5.0000

1	22	Commonwealth of Virginia\870 Bonham Rd Bristol VA 24201-2002		5.0000	100.00%	5.0000	2.3261%	\$11,106.00
---	----	--	--	--------	---------	--------	---------	-------------

Wells contributing to the escrow account: PGP 73, PGP 78A W/PL, PGP 63, PGP 48, PGP 45, PGP 62C W/PL, PGP 44, PGP 51, PGP 52 W/PL, PGP 56, PGP 60, PGP 61 W/PL, PGP 62, PGP 64, PGP 67, PGP 68, PGP 69, PGP 70, PGP 71, PGP NE 10 74, PGP NE 10 75, PGP NE1076, PGP 77, PGP 78, PGP 61B W/PL, PGP 62A W/PL, PGP 63A W/PL, PGP 63B W/PL, PGP 65A, PGP 66A, PGP 66C, PGP 66, PGP 67A W/PL, PGP 69A W/PL, PGP 69C W/PL, PGP 70A, PGP 70B W/PL, PGP 71C W/PL, PGP 73A W/PL, PGP 73B W/PL, PGP 73C W/PL, PGP 74A W/PL, PGP 76A W/PL, PGP 77A W/PL, CBM V24-47A W/PL, CBM V24-51A W/PL, CBM W25-41 W/PL, CBM W25-41A W/PL, CBM W26-43 W/PL, CBM X25 313A W/PL, CBM X26-316 W/PL

Exhibit E
Unit BUNE1
Docket #VGOB 91-1119-0161-07
List of Owners in escrow
(1483.67 Acre Unit)

	Net Acres in Unit	Interest in Unit
<u>Tract #5 - 3.30 Acres</u>		
<u>COAL OWNERSHIP</u>		
(1) Hugh Macrae Land Trust Tr 25 (36.00 acre tract) c/o Alan Siegel, Esq. Gump, Strauss, Akin LLP 1 Bryant Park New York, NY 10034-6715	3.30 acres	0.2224%
<i>By Assignment and Bill of Sale (Gas lease royalty), HMLT devised all of its right, title and interest (other than "Excluded Assets") to Torch Energy Advisors Inc. effective September 4, 1991 and recorded in Buchanan County under DB474 / PG384.</i>		
Torch Oil & Gas Company c/o Sue Ann Craddock 670 Dona Ana Road SW Deming, New Mexico 88030		
<i>Effective 2/1/11, Torch Oil & Gas Company assigned a 2% ORRI to SAC Investments, L.P.</i>		
<i>Effective 3/31/14, Torch Oil & Gas Company, et al. assigned and conveyed 10% of its right, title and interest to Rockport Oil & Gas, L.L.C. In addition, Torch Oil & Gas Company, et al. assigned and conveyed the remaining 90% of its right, title and interest to Chisos, Ltd.</i>		
Rockport Oil & Gas L.L.C. PO Box 847 Houston, TX 77001	0.33 acres 1/10 of 3.30 acres	0.0222%
Chisos, LTD 670 Dona Ana Road SW Deming, New Mexico 88030	2.97 acres 9/10 of 3.30 acres	0.2002%
<u>OIL & GAS OWNERSHIP</u>		
Lida Vandyke, et al. <i>(Lida Vandyke - 4/5 & Walter Wade Heirs - 1/5)</i>	3.30 acres	0.2224%
(1) Lida G. Vandyke Heirs, Devisees, Successors or Assigns		
<i>The respondents listed below did not respond timely to the W9 request and will continue to be escrowed</i>		
(a) Linda J. Holzgrefe 13765 Seabiscuit Drive Reno, NV 89521-8349	2.640 acres 4/5 of 3.30 acres	0.1779%
(2) Walter Wade Heirs		
(b) Eunice Wade Baldwin Heirs, Devisees, Successors or Assigns		
(b.1) Inez B. Kimbrell 225 Raven Circle Raven, VA 24639	0.009 acres 1/360 of 3.30 acres	0.0006%

Exhibit E
Unit BUNE1
Docket #VGOB 91-1119-0161-07
List of Owners in escrow
(1483.67 Acre Unit)

	Net Acres in Unit	Interest in Unit
(b.2) Alice Ruth Meadows 5931 State Route 314 Fredericktown, OH 43019-9225	0.009 acres 1/360 of 3.30 acres	0.0006%
(b.3) Wanda Griffith PO Box 116 Doran, VA 24612	0.009 acres 1/360 of 3.30 acres	0.0006%
(b.4) Ted Allen Baldwin Heirs, Devisees, Successors or Assigns		
(b.4.1) Pansy Baldwin 135 Indian Springs Drive Cedar Bluff, VA 24609-8837	0.009 acres 1/360 of 3.30 acres	0.0006%
Unlocatable		
(b.6) Marty Baldwin <i>Address Unknown</i>	0.009 acres 1/360 of 3.30 acres	0.0006%
(b.7) Ola Gay Baldwin Arnold Heirs, Devisees, Successors or Assigns		
Unlocatable		
(b.7.1) Wanda Gay Bohon <i>Address Unknown</i>	0.009 acres 1/360 of 3.30 acres	0.0006%
(b.10) Norman Baldwin Heirs, Devisees, Successors or Assigns		
The respondents listed below did not respond timely to the W9 request and will continue to be escrowed		
(b.10.3) Michael Baldwin P.O. Box 1044 Raven, VA 24639	0.002 acres 1/1800 of 3.30 acres	0.0001%
(b.10.5) Sharon K. Baldwin c/o SWVA Training Center 160 Training Center Road Hillsville, VA 24343	0.002 acres 1/1800 of 3.30 acres	0.0001%
(b.12) Marty Arnold c/o Wanda Griffith P.O. Box 116 Doran, VA 24612	0.009 acres 1/360 of 3.30 acres	0.0006%
(c) Stella Wade Gillespie Heirs, Devisees, Successors or Assigns		
(c.1) Cecil Gillespie 439 Brown Ave. Richlands, VA 24641-2907	0.028 acres 1/120 of 3.30 acres	0.0019%
(c.2) Troy Gillespie 20307 Cleveland Rd. Abingdon, VA 24211-5843	0.028 acres 1/120 of 3.30 acres	0.0019%
(c.3) David Gillespie 596 Podesta St. Memphis, TN 38120-1541	0.028 acres 1/120 of 3.30 acres	0.0019%

Exhibit E
Unit BUNE1
Docket #VGOB 91-1119-0161-07
List of Owners in escrow
(1483.67 Acre Unit)

	Net Acres in Unit	Interest in Unit
Unlocatable		
(c.4) Darrell Gillespie <i>Address pending</i>	0.028 acres 1/120 of 3.30 acres	0.0019%
(f) Sarah Eady "Edith" Wade Smith Heirs		
<i>The ownership listed below is currently being reviewed and documentation is being requested to verify title</i>		
(f.1) Lula Smith Robins Heirs, Devisees, Successors or Assigns	0.028 acres 1/120 of 3.30 acres	0.0019%
(f.1.1) Timothy K. Martin 331 Sugar Run Road Cedar Bluff, VA 24609		
(f.1.2) Patricia Diane Taylor P.O. Box 2104 Honaker, VA 24260-2104		
(f.1.3) Louise R. Smith Heirs, Devisees, Successors or Assigns <i>Heirs Unknown</i>		
(f.2) Tom C. Smith Heirs Deceased, no children - no issue		
(f.3) Earl Dolphus Smith Heirs, Devisees, Successors or Assigns	0.028 acres 1/120 of 3.30 acres	0.0019%
(f.3.1) Marie Carter Smith 905 Big Creek Rd. Richlands, VA 24641		
(f.5) Luther Smith Heirs, Devisees, Successors or Assigns	0.028 acres 1/120 of 3.30 acres	0.0019%
(f.5.1) Geraldine Smith Heirs, Devisees, Successors or Assigns		
(f.5.1.1) Lisa Wallace	Predeceased Luther & Geraldine Smith	
(f.5.1.1.1) Anna Bond 1760 Knox Creek Road Hurley, VA 24620		
(f.5.1.1.2) Scotty Bond Box 82 Swords Creek, VA 24649		
(f.5.2.1) David Smith 84 Poison Ivy Drive Taylorsville, NC 28681		
(f.5.2.2) Donald Smith 84 Poison Ivy Drive Taylorsville, NC 28681		
(f.5.2.3) Judy Tiedemann 530 150th Street Amery, WI 54001-2805		

Exhibit E
Unit BUNE1
Docket #VGOB 91-1119-0161-07
List of Owners in escrow
(1483.67 Acre Unit)

	Net Acres in Unit	Interest in Unit
(f.5.2.4) Paul Smith Heirs, Devisees, Successors or Assigns		
(f.5.2.4.1) Jo Ann Perkins Smith PO Box 1143 Claremont, NC 28610		
(f.5.2.5) Peggy Smith 84 Poison Ivy Drive Taylorsville, NC 28681		
(f.6) Tom C. Smith Heirs		<i>Deceased - no issue - interest back to siblings</i>
Total tract acres	2.9003	
Total tract percent		0.1955%

Tract #5A - 3.89 Acres

COAL OWNERSHIP

(1) Hugh Macrae Land Trust <i>Tr 25 (36.00 acre tract)</i> c/o Alan Siegel, Esq. Gump, Strauss, Akin LLP 1 Bryant Park New York, NY 10034-6715	3.89 acres	0.2622%
---	------------	---------

By Assignment and Bill of Sale (Gas lease royalty), HMLT devised all of its right, title and interest (other than "Excluded Assets") to Torch Energy Advisors Inc. effective September 4, 1991 and recorded in Buchanan County under DB474 / PG384.

Torch Oil & Gas Company
c/o Sue Ann Craddock
670 Dona Ana Road SW
Deming, New Mexico 88030

Effective 2/1/11, Torch Oil & Gas Company assigned a 2% ORRI to SAC Investments, L.P.

Effective 3/31/14, Torch Oil & Gas Company, et al. assigned and conveyed 10% of its right, title and interest to Rockport Oil & Gas, L.L.C. In addition, Torch Oil & Gas Company, et al. assigned and conveyed the remaining 90% of its right, title and interest to Chisos, Ltd.

Rockport Oil & Gas L.L.C. PO Box 847 Houston, TX 77001	0.39 acres 1/10 of 3.89 acres	0.0262%
Chisos, LTD 670 Dona Ana Road SW Deming, New Mexico 88030	3.50 acres 9/10 of 3.89 acres	0.2360%

OIL & GAS OWNERSHIP

Yukon Pocahontas Coal Co., et al <i>(Yukon Pocahontas Coal Co., et al - 4/5 & Walter Wade Heirs - 1/5)</i>	3.89 acres	0.2622%
(2) Walter Wade Heirs		
(b) Eunice Wade Baldwin Heirs, Devisees, Successors or Assigns		
(b.1) Inez B. Kimbrell 225 Raven Circle Raven, VA 24639	0.011 acres 1/360 of 3.89 acres	0.0007%

Exhibit E
Unit BUNE1
Docket #VGOB 91-1119-0161-07
List of Owners in escrow
(1483.67 Acre Unit)

	Net Acres in Unit	Interest in Unit
(b.2) Alice Ruth Meadows 5931 State Route 314 Fredericktown, OH 43019-9225	0.011 acres 1/360 of 3.89 acres	0.0007%
(b.3) Wanda Griffith PO Box 116 Doran, VA 24612	0.011 acres 1/360 of 3.89 acres	0.0007%
(b.4) Ted Allen Baldwin Heirs, Devisees, Successors or Assigns		
(b.4.1) Pansy Baldwin 135 Indian Springs Drive Cedar Bluff, VA 24609-8837	0.011 acres 1/360 of 3.89 acres	0.0007%
Unlocatable		
(b.6) Marty Baldwin <i>Address Unknown</i>	0.011 acres 1/360 of 3.89 acres	0.0007%
(b.7) Ola Gay Baldwin Arnold Heirs, Devisees, Successors or Assigns		
Unlocatable		
(b.7.1) Wanda Gay Bohon <i>Address Unknown</i>	0.011 acres 1/360 of 3.89 acres	0.0007%
(b.10) Norman Baldwin Heirs, Devisees, Successors or Assigns		
The respondents listed below did not respond timely to the W9 request and will continue to be escrowed		
(b.10.3) Michael Baldwin P.O. Box 1044 Raven, VA 24639	0.002 acres 1/1800 of 3.89 acres	0.0001%
(b.10.5) Sharon K. Baldwin c/o SWVA Training Center 160 Training Center Road Hillsville, VA 24343	0.002 acres 1/1800 of 3.89 acres	0.0001%
(b.12) Marty Arnold c/o Wanda Griffith P.O. Box 116 Doran, VA 24612	0.011 acres 1/360 of 3.89 acres	0.0007%
(c) Stella Wade Gillespie Heirs, Devisees, Successors or Assigns		

Exhibit E
Unit BUNE1
Docket #VGOB 91-1119-0161-07
List of Owners in escrow
(1483.67 Acre Unit)

	Net Acres in Unit	Interest in Unit
(c.1) Cecil Gillespie 439 Brown Ave. Richlands, VA 24641-2907	0.032 acres 1/120 of 3.89 acres	0.0022%
(c.2) Troy Gillespie 20307 Cleveland Rd. Abingdon, VA 24211-5843	0.032 acres 1/120 of 3.89 acres	0.0022%
(c.3) David Gillespie 596 Podesta St. Memphis, TN 38120-1541	0.032 acres 1/120 of 3.89 acres	0.0022%
(c.4) Darrell Gillespie <i>Address pending</i>	0.032 acres 1/120 of 3.89 acres	0.0022%
(f) Sarah Eady "Edith" Wade Smith Heirs		
<i>The ownership listed below is currently being reviewed and documentation is being requested to verify title</i>		
(f.1) Lula Smith Robins Heirs, Devisees, Successors or Assigns	0.032 acres 1/120 of 3.89 acres	0.0022%
(f.1.1) Timothy K. Martin 331 Sugar Run Road Cedar Bluff, VA 24609		
(f.1.2) Patricia Diane Taylor P.O. Box 2104 Honaker, VA 24260-2104		
(f.1.3) Louise R. Smith Heirs, Devisees, Successors or Assigns <i>Heirs Unknown</i>		
(f.2) Tom C. Smith Heirs Deceased, no children - no issue		
<i>The ownership listed below is currently being reviewed and documentation is being requested to verify title</i>		
(f.3) Earl Dolphus Smith Heirs, Devisees, Successors or Assigns	0.032 acres 1/120 of 3.89 acres	0.0022%
(f.3.1) Marie Carter Smith 905 Big Creek Rd. Richlands, VA 24641		
(f.5) Luther Smith Heirs, Devisees, Successors or Assigns	0.032 acres 1/120 of 3.89 acres	0.0022%
(f.5.1) Geraldine Smith Heirs, Devisees, Successors or Assigns		
(f.5.1.1) Lisa Wallace	Predeceased Luther & Geraldine Smith	
(f.5.1.1.1) Anna Bond 1760 Knox Creek Road Hurley, VA 24620		
(f.5.1.1.2) Scotty Bond Box 82 Swords Creek, VA 24649		

Exhibit E
Unit BUNE1
Docket #VGOB 91-1119-0161-07
List of Owners in escrow
(1483.67 Acre Unit)

	Net Acres in Unit	Interest in Unit
(f.5.2.1) David Smith 84 Poison Ivy Drive Taylorsville, NC 28681		
(f.5.2.2) Donald Smith 84 Poison Ivy Drive Taylorsville, NC 28681		
(f.5.2.3) Judy Tiedemann 530 150th Street Amery, WI 54001-2805		
(f.5.2.4) Paul Smith Heirs, Devisees, Successors or Assigns		
(f.5.2.4.1) Jo Ann Perkins Smith PO Box 1143 Claremont, NC 28610		
(f.5.2.5) Peggy Smith 84 Poison Ivy Drive Taylorsville, NC 28681		
(f.6) Tom C. Smith Heirs		<i>Deceased - no issue - interest back to siblings</i>
	Total tract acres	0.3069
	Total tract percent	0.0207%

Tract #8C - 48.22 Acres

COAL OWNERSHIP

(1) Hugh Macrae Land Trust <i>Tr 11 (856.25 acre tract)</i> c/o Alan Siegel, Esq. Gump, Strauss, Akin LLP 1 Bryant Park New York, NY 10034-6715	48.22 acres	3.2500%
--	-------------	---------

By Assignment and Bill of Sale (Gas lease royalty), HMLT devised all of its right, title and interest (other than "Excluded Assets") to Torch Energy Advisors Inc. effective September 4, 1991 and recorded in Buchanan County under DB474 / PG384.

Torch Oil & Gas Company
c/o Sue Ann Craddock
670 Dona Ana Road SW
Deming, New Mexico 88030

Effective 2/1/11, Torch Oil & Gas Company assigned a 2% ORRI to SAC Investments, L.P.

Effective 3/31/14, Torch Oil & Gas Company, et al. assigned and conveyed 10% of its right, title and interest to Rockport Oil & Gas, L.L.C. In addition, Torch Oil & Gas Company, et al. assigned and conveyed the remaining 90% of its right, title and interest to Chisos, Ltd.

Rockport Oil & Gas L.L.C. PO Box 847 Houston, TX 77001	4.82 acres 1/10 of 48.22 acres	0.3250%
Chisos, LTD 670 Dona Ana Road SW Deming, New Mexico 88030	43.40 acres 9/10 of 48.22 acres	2.9250%

Exhibit E
Unit BUNE1
Docket #VGOB 91-1119-0161-07
List of Owners in escrow
(1483.67 Acre Unit)

	Net Acres in Unit	Interest in Unit
<u>OIL & GAS OWNERSHIP</u>		
(1) CNX Gas Company LLC *** 1000 Consol Energy Drive Canonsburg, PA 15317	48.22 acres	3.2500%

The respondents listed below did not respond timely to the W9 request and will continue to be escrowed

*** NOTE: The Royalty Interest was RETAINED by:

Clinton Don Wood
Box 309
Frankfort, KY 40602

Tract #9 - 83.27 Acres

COAL OWNERSHIP

(1) Hugh Macrae Land Trust <i>Tr 11 (856.25 acre tract)</i> c/o Alan Siegel, Esq. Gump, Strauss, Akin LLP 1 Bryant Park New York, NY 10034-6715	83.27 acres	5.6124%
--	-------------	---------

By Assignment and Bill of Sale (Gas lease royalty), HMLT devised all of its right, title and interest (other than "Excluded Assets") to Torch Energy Advisors Inc. effective September 4, 1991 and recorded in Buchanan County under DB474 / PG384.

Torch Oil & Gas Company
c/o Sue Ann Craddock
670 Dona Ana Road SW
Deming, New Mexico 88030

Effective 2/1/11, Torch Oil & Gas Company assigned a 2% ORRI to SAC Investments, L.P.

Effective 3/31/14, Torch Oil & Gas Company, et al. assigned and conveyed 10% of its right, title and interest to Rockport Oil & Gas, L.L.C. In addition, Torch Oil & Gas Company, et al. assigned and conveyed the remaining 90% of its right, title and interest to Chisos, Ltd.

Rockport Oil & Gas L.L.C. PO Box 847 Houston, TX 77001	8.33 acres 1/10 of 83.27 acres	0.5612%
Chisos, LTD 670 Dona Ana Road SW Deming, New Mexico 88030	74.94 acres 9/10 of 83.27 acres	5.0512%

OIL & GAS OWNERSHIP

The ownership listed below is currently being reviewed and documentation is being requested to verify title

(1) S. J. Mullins, et al. Heirs, Devisees, Successors or Assigns	83.27 acres	5.6124%
(a) Stanford J. Mullins, Jr. Heirs, Devisees, Successors or Assigns (1/2)		
(a.1) Mary L. Mullins 580 Forest Hills Drive Pounding Mill, VA 24637	41.64 acres 1/2 of 83.27 acres	2.8062%
(b) Ralph Mullins (1/2)		

Exhibit E
Unit BUNE1
Docket #VGOB 91-1119-0161-07
List of Owners in escrow
(1483.67 Acre Unit)

	Net Acres in Unit	Interest in Unit
(b.1) Stanford Thomas Mullins <i>Address Unknown</i>	41.64 acres 1/2 of 83.27 acres	2.8062%
Total tract acres	83.2700	
Total tract percent	5.6124%	

Tract #20 - 10.00 Acres

COAL OWNERSHIP

(1) Hugh Macrae Land Trust <i>Tr ?? (Per map - Tr 25 - 36.00 acre tract)</i> c/o Alan Siegel, Esq. Gump, Strauss, Akin LLP 1 Bryant Park New York, NY 10034-6715	10.00 acres	0.6740%
---	-------------	---------

By Assignment and Bill of Sale (Gas lease royalty), HMLT devised all of its right, title and interest (other than "Excluded Assets") to Torch Energy Advisors Inc. effective September 4, 1991 and recorded in Buchanan County under DB474 / PG384.

Torch Oil & Gas Company
c/o Sue Ann Craddock
670 Dona Ana Road SW
Deming, New Mexico 88030

Effective 2/1/11, Torch Oil & Gas Company assigned a 2% ORRI to SAC Investments, L.P.

Effective 3/31/14, Torch Oil & Gas Company, et al. assigned and conveyed 10% of its right, title and interest to Rockport Oil & Gas, L.L.C. In addition, Torch Oil & Gas Company, et al. assigned and conveyed the remaining 90% of its right, title and interest to Chisos, Ltd.

Rockport Oil & Gas L.L.C. PO Box 847 Houston, TX 77001	1.00 acres 1/10 of 10.00 acres	0.0674%
Chisos, LTD 670 Dona Ana Road SW Deming, New Mexico 88030	9.00 acres 9/10 of 10.00 acres	0.6066%

OIL & GAS OWNERSHIP

Modern Homes Inc., et al. <i>(Modern Homes Inc. - 4/5 & Walter Wade Heirs - 1/5)</i>	10.00 acres	0.6740%
---	-------------	---------

The respondents listed below did not respond timely to the W9 request and will continue to be escrowed

(1) Modern Homes Inc. c/o James E. Childress P.O. Box 22 Vansant, VA 24656	8.000 acres 4/5 of 10.00 acres	0.5392%
(2) Walter Wade Heirs		
(b) Eunice Wade Baldwin Heirs, Devisees, Successors or Assigns		

Exhibit E
Unit BUNE1
Docket #VGOB 91-1119-0161-07
List of Owners in escrow
(1483.67 Acre Unit)

	Net Acres in Unit	Interest in Unit
(b.1) Inez B. Kimbrell 225 Raven Circle Raven, VA 24639	0.028 acres 1/360 of 10.00 acres	0.0019%
(b.2) Alice Ruth Meadows 5931 State Route 314 Fredericktown, OH 43019-9225	0.028 acres 1/360 of 10.00 acres	0.0019%
(b.3) Wanda Griffith PO Box 116 Doran, VA 24612	0.028 acres 1/360 of 10.00 acres	0.0019%
(b.4) Ted Allen Baldwin Heirs, Devisees, Successors or Assigns		
(b.4.1) Pansy Baldwin 135 Indian Springs Drive Cedar Bluff, VA 24609-8837	0.028 acres 1/360 of 10.00 acres	0.0019%
Unlocatable		
(b.6) Marty Baldwin <i>Address Unknown</i>	0.028 acres 1/360 of 10.00 acres	0.0019%
(b.7) Ola Gay Baldwin Arnold Heirs, Devisees, Successors or Assigns		
Unlocatable		
(b.7.1) Wanda Gay Bohon <i>Address Unknown</i>	0.028 acres 1/360 of 10.00 acres	0.0019%
(b.10) Norman Baldwin Heirs, Devisees, Successors or Assigns		
The respondents listed below did not respond timely to the W9 request and will continue to be escrowed		
(b.10.3) Michael Baldwin P.O. Box 1044 Raven, VA 24639	0.006 acres 1/1800 of 10.00 acres	0.0004%
(b.10.5) Sharon K. Baldwin c/o SWVA Training Center 160 Training Center Road Hillsville, VA 24343	0.006 acres 1/1800 of 10.00 acres	0.0004%
(b.12) Marty Arnold c/o Wanda Griffith P.O. Box 116 Doran, VA 24612	0.028 acres 1/360 of 10.00 acres	0.0019%
(c) Stella Wade Gillespie Heirs, Devisees, Successors or Assigns		
(c.1) Cecil Gillespie 439 Brown Ave. Richlands, VA 24641-2907	0.083 acres 1/120 of 10.00 acres	0.0056%
(c.2) Troy Gillespie 20307 Cleveland Rd. Abingdon, VA 24211-5843	0.083 acres 1/120 of 10.00 acres	0.0056%

Exhibit E
Unit BUNE1
Docket #VGOB 91-1119-0161-07
List of Owners in escrow
(1483.67 Acre Unit)

	Net Acres in Unit	Interest in Unit
(c.3) David Gillespie 596 Podesta St. Memphis, TN 38120-1541	0.083 acres 1/120 of 10.00 acres	0.0056%
(c.4) Darrell Gillespie <i>Address pending</i>	0.083 acres 1/120 of 10.00 acres	0.0056%
(f) Sarah Eady "Edith" Wade Smith Heirs		
<i>The ownership listed below is currently being reviewed and documentation is being requested to verify title</i>		
(f.1) Lula Smith Robins Heirs, Devisees, Successors or Assigns	0.083 acres 1/120 of 10.00 acres	0.0056%
(f.1.1) Timothy K. Martin 331 Sugar Run Road Cedar Bluff, VA 24609		
(f.1.2) Patricia Diane Taylor P.O. Box 2104 Honaker, VA 24260-2104		
(f.1.3) Louise R. Smith Heirs, Devisees, Successors or Assigns <i>Heirs Unknown</i>		
(f.2) Tom C. Smith Heirs Deceased, no children - no issue		
(f.3) Earl Dolphus Smith Heirs, Devisees, Successors or Assigns	0.083 acres 1/120 of 10.00 acres	0.0056%
(f.3.1) Marie Carter Smith 905 Big Creek Rd. Richlands, VA 24641		
(f.5) Luther Smith Heirs, Devisees, Successors or Assigns	0.083 acres 1/120 of 10.00 acres	0.0056%
(f.5.1) Geraldine Smith Heirs, Devisees, Successors or Assigns		
(f.5.1.1) Lisa Wallace	Predeceased Luther & Geraldine Smith	
(f.5.1.1.1) Anna Bond 1760 Knox Creek Road Hurley, VA 24620		
(f.5.1.1.2) Scotty Bond Box 82 Swords Creek, VA 24649		
(f.5.2.1) David Smith 84 Poison Ivy Drive Taylorsville, NC 28681		
(f.5.2.2) Donald Smith 84 Poison Ivy Drive Taylorsville, NC 28681		
(f.5.2.3) Judy Tiedemann 530 150th Street Amery, WI 54001-2805		

Exhibit E
Unit BUNE1
Docket #VGOB 91-1119-0161-07
List of Owners in escrow
(1483.67 Acre Unit)

	Net Acres in Unit	Interest in Unit
(f.5.2.4) Paul Smith Heirs, Devisees, Successors or Assigns		
(f.5.2.4.1) Jo Ann Perkins Smith PO Box 1143 Claremont, NC 28610		
(f.5.2.5) Peggy Smith 84 Poison Ivy Drive Taylorsville, NC 28681		
(f.6) Tom C. Smith Heirs		<i>Deceased - no issue - interest back to siblings</i>
Total tract acres	8.7056	
Total tract percent		0.5868%

Tract #21 - 0.80 Acres

COAL OWNERSHIP

(1) Hugh Macrae Land Trust <i>Tr ??? (Per map - Tr 25 - 36.00 acre tract)</i> c/o Alan Siegel, Esq. Gump, Strauss, Akin LLP 1 Bryant Park New York, NY 10034-6715	0.80 acres	0.0539%
--	------------	---------

By Assignment and Bill of Sale (Gas lease royalty), HMLT devised all of its right, title and interest (other than "Excluded Assets") to Torch Energy Advisors Inc. effective September 4, 1991 and recorded in Buchanan County under DB474 / PG384.

Torch Oil & Gas Company
c/o Sue Ann Craddock
670 Dona Ana Road SW
Deming, New Mexico 88030

Effective 2/1/11, Torch Oil & Gas Company assigned a 2% ORRI to SAC Investments, L.P.

Effective 3/31/14, Torch Oil & Gas Company, et al. assigned and conveyed 10% of its right, title and interest to Rockport Oil & Gas, L.L.C. In addition, Torch Oil & Gas Company, et al. assigned and conveyed the remaining 90% of its right, title and interest to Chisos, Ltd.

Rockport Oil & Gas L.L.C. PO Box 847 Houston, TX 77001	0.08 acres 1/10 of 0.80 acres	0.0054%
Chisos, LTD 670 Dona Ana Road SW Deming, New Mexico 88030	0.72 acres 9/10 of 0.80 acres	0.0485%

OIL & GAS OWNERSHIP

Pepsico of Norton, Inc., et al. <i>(Pepsico of Norton, Inc. - 4/5 & Walter Wade Heirs - 1/5)</i>	0.80 acres	0.0539%
---	------------	---------

The respondents listed below did not respond timely to the W9 request and will continue to be escrowed

(1) Pepsico of Norton, Inc. 12th Street & Park Avenue Norton, VA 24273	0.640 acres 4/5 of 0.80 acres	0.0431%
(2) Walter Wade Heirs		
(b) Eunice Wade Baldwin Heirs, Devisees, Successors or Assigns		

Exhibit E
Unit BUNE1
Docket #VGOB 91-1119-0161-07
List of Owners in escrow
(1483.67 Acre Unit)

	Net Acres in Unit	Interest in Unit
(b.1) Inez B. Kimbrell 225 Raven Circle Raven, VA 24639	0.002 acres 1/360 of 0.80 acres	0.0001%
(b.2) Alice Ruth Meadows 5931 State Route 314 Fredericktown, OH 43019-9225	0.002 acres 1/360 of 0.80 acres	0.0001%
(b.3) Wanda Griffith PO Box 116 Doran, VA 24612	0.002 acres 1/360 of 0.80 acres	0.0001%
(b.4) Ted Allen Baldwin Heirs, Devisees, Successors or Assigns		
(b.4.1) Pansy Baldwin 135 Indian Springs Drive Cedar Bluff, VA 24609-8837	0.002 acres 1/360 of 0.80 acres	0.0001%
Unlocatable		
(b.6) Marty Baldwin <i>Address Unknown</i>	0.002 acres 1/360 of 0.80 acres	0.0001%
(b.7) Ola Gay Baldwin Arnold Heirs, Devisees, Successors or Assigns		
Unlocatable		
(b.7.1) Wanda Gay Bohon <i>Address Unknown</i>	0.002 acres 1/360 of 0.80 acres	0.0001%
(b.10) Norman Baldwin Heirs, Devisees, Successors or Assigns		
(b.10.3) Michael Baldwin P.O. Box 1044 Raven, VA 24639	0.000 acres 1/1800 of 0.80 acres	0.0000%
(b.10.5) Sharon K. Baldwin c/o SWVA Training Center 160 Training Center Road Hillsville, VA 24343	0.000 acres 1/1800 of 0.80 acres	0.0000%
(b.12) Marty Arnold c/o Wanda Griffith P.O. Box 116 Doran, VA 24612	0.002 acres 1/360 of 0.80 acres	0.0001%
(c) Stella Wade Gillespie Heirs, Devisees, Successors or Assigns		
(c.1) Cecil Gillespie 439 Brown Ave. Richlands, VA 24641-2907	0.007 acres 1/120 of 0.80 acres	0.0004%
(c.2) Troy Gillespie 20307 Cleveland Rd. Abingdon, VA 24211-5843	0.007 acres 1/120 of 0.80 acres	0.0004%

Exhibit E
Unit BUNE1
Docket #VGOB 91-1119-0161-07
List of Owners in escrow
(1483.67 Acre Unit)

	Net Acres in Unit	Interest in Unit
(c.3) David Gillespie 596 Podesta St. Memphis, TN 38120-1541	0.007 acres 1/120 of 0.80 acres	0.0004%
(c.4) Darrell Gillespie <i>Address pending</i>	0.007 acres 1/120 of 0.80 acres	0.0004%
(f) Sarah Eady "Edith" Wade Smith Heirs		
<i>The ownership listed below is currently being reviewed and documentation is being requested to verify title.</i>		
(f.1) Lula Smith Robins Heirs, Devisees, Successors or Assigns	0.007 acres 1/120 of 0.80 acres	0.0004%
(f.1.1) Timothy K. Martin 331 Sugar Run Road Cedar Bluff, VA 24609		
(f.1.2) Patricia Diane Taylor P.O. Box 2104 Honaker, VA 24260-2104		
(f.1.3) Louise R. Smith Heirs, Devisees, Successors or Assigns <i>Heirs Unknown</i>		
(f.2) Tom C. Smith Heirs Deceased, no children - no issue		
(f.3) Earl Dolphus Smith Heirs, Devisees, Successors or Assigns	0.007 acres 1/120 of 0.80 acres	0.0004%
(f.3.1) Marie Carter Smith 905 Big Creek Rd. Richlands, VA 24641		
(f.5) Luther Smith Heirs, Devisees, Successors or Assigns	0.007 acres 1/120 of 0.80 acres	0.0004%
(f.5.1) Geraldine Smith Heirs, Devisees, Successors or Assigns		
(f.5.1.1) Lisa Wallace	Predeceased Luther & Geraldine Smith	
(f.5.1.1.1) Anna Bond 1760 Knox Creek Road Hurley, VA 24620		
(f.5.1.1.2) Scotty Bond Box 82 Swords Creek, VA 24649		
(f.5.2.1) David Smith 84 Poison Ivy Drive Taylorsville, NC 28681		
(f.5.2.2) Donald Smith 84 Poison Ivy Drive Taylorsville, NC 28681		
(f.5.2.3) Judy Tiedemann 530 150th Street Amery, WI 54001-2805		

Exhibit E
Unit BUNE1
Docket #VGOB 91-1119-0161-07
List of Owners in escrow
(1483.67 Acre Unit)

	Net Acres in Unit	Interest in Unit
(f.5.2.4) Paul Smith Heirs, Devisees, Successors or Assigns		
(f.5.2.4.1) Jo Ann Perkins Smith PO Box 1143 Claremont, NC 28610		
(f.5.2.5) Peggy Smith 84 Poison Ivy Drive Taylorsville, NC 28681		
(f.6) Tom C. Smith Heirs		<i>Deceased - no issue - interest back to siblings</i>
Total tract acres	0.7031	
Total tract percent	0.0474%	
Total Acreage Remaining in Unit	144.1059	
Total Percentage Remaining in Unit		9.7128%

Exhibit EE
Unit BUNE1
Docket #VGOB 91-1119-0161-07
List of Respondents with Royalty Split Agreements and/or Court Orders/HB2058
(1483.67 Acre Unit)

	Net Acres in Unit	Interest in Unit	Percent of Escrow
<u>Tract #3 - 526.17 Acres</u>			
<u>COAL OWNERSHIP</u>			
(1) Hugh Macrae Land Trust <i>Tr 23 (557.25 acre tract)</i> c/o Alan Siegel, Esq. Gump, Strauss, Akin LLP 1 Bryant Park New York, NY 10036-6715	526.17 acres	35.4641%	<i>n/a</i>
<i>By Assignment and Bill of Sale (Gas lease royalty), HMLT devised all of its right, title and interest (other than "Excluded Assets") to Torch Energy Advisors Inc. effective September 4, 1991 and recorded in Buchanan County under DB474 / PG384.</i>			
Torch Oil & Gas Company c/o Sue Ann Craddock 670 Dona Ana Road SW Deming, New Mexico 88030			
<i>Effective 2/1/11, Torch Oil & Gas Company assigned a 2% ORRI to SAC Investments, L.P.</i>			
<i>Effective 3/31/14, Torch Oil & Gas Company, et al. assigned and conveyed 10% of its right, title and interest to Rockport Oil & Gas, L.L.C. In addition, Torch Oil & Gas Company, et al. assigned and conveyed the remaining 90% of its right, title and interest to Chisos, Ltd.</i>			
Rockport Oil & Gas L.L.C. PO Box 847 Houston, TX 77001	52.62 acres 1/10 of 526.17 acres	3.5464%	<i>n/a</i>
Chisos, LTD 670 Dona Ana Road SW Deming, New Mexico 88030	473.55 acres 9/10 of 526.17 acres	31.9177%	<i>n/a</i>
<u>OIL & GAS OWNERSHIP</u>			
(1) Garden Realty Corporation 108 Bexley Road Mooresville, NC 28117	526.17 acres	35.4641%	<i>n/a</i>
<u>Tract #3A - 2.61 Acres</u>			
<u>COAL OWNERSHIP</u>			
(1) Hugh Macrae Land Trust <i>Tr 23 (557.25 acre tract)</i> c/o Alan Siegel, Esq. Gump, Strauss, Akin LLP 1 Bryant Park New York, NY 10036-6715	2.61 acres	0.1759%	<i>n/a</i>
<i>By Assignment and Bill of Sale (Gas lease royalty), HMLT devised all of its right, title and interest (other than "Excluded Assets") to Torch Energy Advisors Inc. effective September 4, 1991 and recorded in Buchanan County under DB474 / PG384.</i>			
Torch Oil & Gas Company c/o Sue Ann Craddock 670 Dona Ana Road SW Deming, New Mexico 88030			
<i>Effective 2/1/11, Torch Oil & Gas Company assigned a 2% ORRI to SAC Investments, L.P.</i>			
<i>Effective 3/31/14, Torch Oil & Gas Company, et al. assigned and conveyed 10% of its right, title and interest to Rockport Oil & Gas, L.L.C. In addition, Torch Oil & Gas Company, et al. assigned and conveyed the remaining 90% of its right, title and interest to Chisos, Ltd.</i>			
Rockport Oil & Gas L.L.C. PO Box 847 Houston, TX 77001	0.26 acres 1/10 of 2.61 acres	0.0176%	<i>n/a</i>
Chisos, LTD 670 Dona Ana Road SW Deming, New Mexico 88030	2.35 acres 9/10 of 2.61 acres	0.1583%	<i>n/a</i>

Exhibit EE
Unit BUNE1
Docket #VGOB 91-1119-0161-07
List of Respondents with Royalty Split Agreements and/or Court Orders/HB2058
(1483.67 Acre Unit)

	Net Acres in Unit	Interest in Unit	Percent of Escrow
<u>OIL & GAS OWNERSHIP</u>			
(1) Garden Realty Corporation 108 Bexley Road Mooresville, NC 28117	2.61 acres	0.1759%	<i>n/a</i>
<u>Tract #5 - 3.30 Acres</u>			
<u>COAL OWNERSHIP</u>			
(1) Hugh Macrae Land Trust <i>Tr 25 (36.00 acre tract)</i> <i>c/o Alan Siegel, Esq.</i> Gump, Strauss, Akin LLP 1 Bryant Park New York, NY 10034-6715	3.30 acres	0.2224%	<i>n/a</i>
<i>By Assignment and Bill of Sale (Gas lease royalty), HMLT devised all of its right, title and interest (other than "Excluded Assets") to Torch Energy Advisors Inc. effective September 4, 1991 and recorded in Buchanan County under DB474 / PG384.</i>			
Torch Oil & Gas Company c/o Sue Ann Craddock 670 Dona Ana Road SW Deming, New Mexico 88030			
<i>Effective 2/1/11, Torch Oil & Gas Company assigned a 2% ORRI to SAC Investments, L.P.</i>			
<i>Effective 3/31/14, Torch Oil & Gas Company, et al. assigned and conveyed 10% of its right, title and interest to Rockport Oil & Gas, L.L.C. In addition, Torch Oil & Gas Company, et al. assigned and conveyed the remaining 90% of its right, title and interest to Chisos, Ltd.</i>			
Rockport Oil & Gas L.L.C. PO Box 847 Houston, TX 77001	0.33 acres 1/10 of 3.30 acres	0.0222%	0.0013% Royalty Division Agreement
Chisos, LTD 670 Dona Ana Road SW Deming, New Mexico 88030	2.97 acres 9/10 of 3.30 acres	0.2002%	0.0115% Royalty Division Agreement
<u>OIL & GAS OWNERSHIP</u>			
Lida Vandyke, et al. (<i>Lida Vandyke - 4/5 & Walter Wade Heirs - 1/5</i>)	3.30 acres	0.2224%	
(2) Walter Wade Heirs			
(a) Carl Wade Heirs, Devisees, Successors or Assigns			
(a) Carl Wade Heirs, Devisees, Successors or Assigns			
(a.1) Emanuel Wade 226 Adams Street Blountville, TN 37617	0.055 acres 1/60 of 3.30 acres	0.0037%	0.0128% Royalty Division Agreement
(a.2) Gaylene Deskins Heirs, Devisees, Successors or Assigns			
(a.2.1) Nick Deskins 720 Skyview Drive Chilhowie, VA 24319-4527	0.028 acres 1/120 of 3.30 acres	0.0019%	<i>n/a</i>
(a.2.2) Valmy Shannon 103 Blanton Drive Seaford, VA 23696-2522	0.028 acres 1/120 of 3.30 acres	0.0019%	<i>n/a</i>
(b) Eunice Wade Baldwin Heirs, Devisees, Successors or Assigns			

Exhibit EE
Unit BUNE1
Docket #VGOB 91-1119-0161-07
List of Respondents with Royalty Split Agreements and/or Court Orders/HB2058
(1483.67 Acre Unit)

	Net Acres in Unit	Interest in Unit	Percent of Escrow
(b.5) Sherman Baldwin 1210 Lake Witten Road North Tazewell, VA 24630	0.009 acres 1/360 of 3.30 acres	0.0006%	0.0043% HB2058
(b.8) D.C. Baldwin Heirs, Devisees, Successors or Assigns			
(b.8.1) Nancy Baldwin Wooten Komp 2510 Arthur Road Springfield, OH 45502	0.005 acres 1/720 of 3.30 acres	0.0003%	0.0021% HB2058
(b.8.2) Sandra Baldwin Cranmer 11651 SE 69th Ter, Lot 18 Bellevue, FL 34420	0.005 acres 1/720 of 3.30 acres	0.0003%	0.0021% HB2058
(b.9) Shirley F. Baldwin Heirs, Devisees, Successors or Assigns			
(b.9.1) Donna Foote 32632 Downing Rd Delmar, MD 21875	0.005 acres 1/720 of 3.30 acres	0.0003%	0.0021% HB2058
(b.9.2) Pamela Ginger Case 325 2nd Street North Little Rock, AK 72117	0.005 acres 1/720 of 3.30 acres	0.0003%	0.0021% HB2058
(b.10) Norman Baldwin Heirs, Devisees, Successors or Assigns			
(b.10.1) Rufus Baldwin 208 High Street Richlands, VA 24641	0.002 acres 1/1800 of 3.30 acres	0.0001%	0.0009% HB2058
(b.10.2) David Baldwin P.O. Box 803 Raven, VA 24639	0.002 acres 1/1800 of 3.30 acres	0.0001%	0.0009% HB2058
(b.10.4) Tammy Baldwin Muir 4480 Clarks Valley Road Swords Creek, VA 24649	0.002 acres 1/1800 of 3.30 acres	0.0001%	0.0009% HB2058
(b.11) Bane Baldwin Heirs, Devisees, Successors or Assigns			
(b.11.1) Eddie Baldwin 1210 Sunset Drive Richlands, VA 24641	0.003 acres 1/1080 of 3.30 acres	0.0002%	0.0014% HB2058
(b.11.2) Kathy Whitt 8740 Swords Creek Road Swords Creek, VA 24649	0.003 acres 1/1080 of 3.30 acres	0.0002%	0.0014% HB2058
(b.11.3) Lisa Shaver 89 Sevier Street Lebanon, VA 24266-7142	0.003 acres 1/1080 of 3.30 acres	0.0002%	0.0014% HB2058
(d) Glayds Ida Boyd Heirs, Devisees, Successors or Assigns			
(d.1) Patti Gilbert 3603 Kents Ridge Road Cedar Bluff, VA 24609-8517	0.037 acres 1/90 of 3.30 acres	0.0025%	0.0171% HB2058
(d.2) Michael T. Boyd 3849 Kents Ridge Road Cedar Bluff, VA 24609-8518	0.037 acres 1/90 of 3.30 acres	0.0025%	0.0171% HB2058
(d.3) Eleanor Sue Hagy	0.037 acres	0.0025%	n/a

Exhibit EE
Unit BUNE1
Docket #VGOB 91-1119-0161-07
List of Respondents with Royalty Split Agreements and/or Court Orders/HB2058
(1483.67 Acre Unit)

	Net Acres in Unit	Interest in Unit	Percent of Escrow
14475 Rainbow Road, Lot #31 Bristol, VA 24202	1/90 of 3.30 acres		
(e) Venia Wade Newberry 639 Daniel Drive Newport News, VA 23601-1701	0.110 acres 1/30 of 3.30 acres	0.0074%	0.0512% HB2058
(f) Sarah Eady "Edith" Wade Smith Heirs			
(f.4) Raymond S. Smith Heirs, Devisees, Successors or Assigns			
(f.4.1) Virginia Edith Smith PO Box 335 Doran, VA 24612	0.028 acres 1/120 of 3.30 acres	0.0019%	0.0128% HB2058
Total tract acres	0.400		
Total tract percent		0.0269%	

Tract #5A - 3.89 Acres

COAL OWNERSHIP

(1) Hugh Macrae Land Trust <i>Tr 25 (36.00 acre tract)</i> c/o Alan Siegel, Esq. Gump, Strauss, Akin LLP 1 Bryant Park New York, NY 10034-6715	3.89 acres	0.2622%	
---	------------	---------	--

By Assignment and Bill of Sale (Gas lease royalty), HMLT devised all of its right, title and interest (other than "Excluded Assets") to Torch Energy Advisors Inc. effective September 4, 1991 and recorded in Buchanan County under DB474 / PG384.

Torch Oil & Gas Company
c/o Sue Ann Craddock
670 Dona Ana Road SW
Deming, New Mexico 88030

Effective 2/1/11, Torch Oil & Gas Company assigned a 2% ORRI to SAC Investments, L.P.

Effective 3/31/14, Torch Oil & Gas Company, et al. assigned and conveyed 10% of its right, title and interest to Rockport Oil & Gas, L.L.C. In addition, Torch Oil & Gas Company, et al. assigned and conveyed the remaining 90% of its right, title and interest to Chisos, Ltd.

Rockport Oil & Gas L.L.C. PO Box 847 Houston, TX 77001	0.39 acres 1/10 of 3.89 acres	0.0262%	0.0015% Royalty Division Agreement
Chisos, LTD 670 Dona Ana Road SW Deming, New Mexico 88030	3.50 acres 9/10 of 3.89 acres	0.2360%	0.0136% Royalty Division Agreement

OIL & GAS OWNERSHIP

Yukon Pocahontas Coal Co., et al <i>(Yukon Pocahontas Coal Co., et al - 4/5 & Walter Wade Heirs - 1/5)</i>	3.89 acres	0.2622%	
(1) Yukon Pocahontas Coal Company, et al			
(a) Yukon Pocahontas Coal Company P.O. Box 187 Tazewell, VA 24651	1.556 acres 2/5 of 3.89 acres	0.1049%	0.7239% HB2058
(b) Buchanan Coal Company P.O. Box 187 Tazewell, VA 24651	0.346 acres 4/45 of 3.89 acres	0.0233%	0.1609% HB2058
(c) Sayers-Pocahontas Coal Company P.O. Box 187	0.173 acres 2/45 of 3.89 acres	0.0117%	0.0804% HB2058

Exhibit EE
Unit BUNE1
Docket #VGOB 91-1119-0161-07
List of Respondents with Royalty Split Agreements and/or Court Orders/HB2058
(1483.67 Acre Unit)

	Net Acres in Unit	Interest in Unit	Percent of Escrow
Tazewell, VA 24651			
(d) Highland Resources, Inc/ North American Resources, Corp. * Five Concourse Parkway, Suite 1650 Atlanta, GA 30328	1.037 acres 4/15 of 3.89 acres	0.0699%	0.4826% HB2058
* Note: Plum Creek Timberlands retained their CBM interest, there is no conflict. The royalty for (d) is to be paid to Plum Creek. Highland Resources, Inc. / North American Resources, Corp. is owner of the Oil & Gas Only.			
(2) Walter Wade Heirs			
(a) Carl Wade Heirs, Devisees, Successors or Assigns			
(a) Carl Wade Heirs, Devisees, Successors or Assigns			
(a.1) Emanuel Wade 226 Adams Street Blountville, TN 37617	0.065 acres 1/60 of 3.89 acres	0.0044%	0.0151% Royalty Division Agreement
(a.2) Gaylene Deskins Heirs, Devisees, Successors or Assigns			
(a.2.1) Nick Deskins 720 Skyview Drive Chilhowie, VA 24319-4527	0.032 acres 1/120 of 3.89 acres	0.0022%	n/a
(a.2.2) Valmy Shannon 103 Blanton Drive Seaford, VA 23696-2522	0.032 acres 1/120 of 3.89 acres	0.0022%	n/a
(b) Eunice Wade Baldwin Heirs, Devisees, Successors or Assigns			
(b.5) Sherman Baldwin 1210 Lake Witten Road North Tazewell, VA 24630	0.011 acres 1/360 of 3.89 acres	0.0007%	0.0050% HB2058
(b.8) D.C. Baldwin Heirs, Devisees, Successors or Assigns			
(b.8.1) Nancy Baldwin Wooten Komp 2510 Arthur Road Springfield, OH 45502	0.005 acres 1/720 of 3.89 acres	0.0004%	0.0025% HB2058
(b.8.2) Sandra Baldwin Cranmer 11651 SE 69th Ter, Lot 18 Belleview, FL 34420	0.005 acres 1/720 of 3.89 acres	0.0004%	0.0025% HB2058
(b.9) Shirley F. Baldwin Heirs, Devisees, Successors or Assigns			
(b.9.1) Donna Foote 32632 Downing Rd Delmar, MD 21875	0.005 acres 1/720 of 3.89 acres	0.0004%	0.0025% HB2058
(b.9.2) Pamela Ginger Case 325 2nd Street North Little Rock, AK 72117	0.005 acres 1/720 of 3.89 acres	0.0004%	0.0025% HB2058
(b.10) Norman Baldwin Heirs, Devisees, Successors or Assigns			
(b.10.1) Rufus Baldwin 208 High Street Richlands, VA 24641	0.002 acres 1/1800 of 3.89 acres	0.0001%	0.0010% HB2058
(b.10.2) David Baldwin	0.002 acres	0.0001%	0.0010%

Exhibit EE
Unit BUNE1
Docket #VGOB 91-1119-0161-07
List of Respondents with Royalty Split Agreements and/or Court Orders/HB2058
(1483.67 Acre Unit)

	Net Acres in Unit	Interest in Unit	Percent of Escrow
P.O. Box 803 Raven, VA 24639	1/1800 of 3.89 acres		HB2058
(b.10.4) Tammy Baldwin Muir 4480 Clarks Valley Road Swords Creek, VA 24649	0.002 acres 1/1800 of 3.89 acres	0.0001%	0.0010% HB2058
(b.11) Bane Baldwin Heirs, Devisees, Successors or Assigns			
(b.11.1) Eddie Baldwin 1210 Sunset Drive Richlands, VA 24641	0.004 acres 1/1080 of 3.89 acres	0.0002%	0.0017% HB2058
(b.11.2) Kathy Whitt 8740 Swords Creek Road Swords Creek, VA 24649	0.004 acres 1/1080 of 3.89 acres	0.0002%	0.0017% HB2058
(b.11.3) Lisa Shaver 89 Sevier Street Lebanon, VA 24266-7142	0.004 acres 1/1080 of 3.89 acres	0.0002%	0.0017% HB2058
(d) Glayds Ida Boyd Heirs, Devisees, Successors or Assigns			
(d.1) Patti Gilbert 3603 Kents Ridge Road Cedar Bluff, VA 24609-8517	0.043 acres 1/90 of 3.89 acres	0.0029%	0.0201% HB2058
(d.2) Michael T. Boyd 3849 Kents Ridge Road Cedar Bluff, VA 24609-8518	0.043 acres 1/90 of 3.89 acres	0.0029%	0.0201% HB2058
(d.3) Eleanor Sue Hagy 14475 Rainbow Road, Lot #31 Bristol, VA 24202	0.043 acres 1/90 of 3.89 acres	0.0029%	n/a
(e) Venia Wade Newberry 639 Daniel Drive Newport News, VA 23601-1701	0.130 acres 1/30 of 3.89 acres	0.0087%	0.0603% HB2058
(f) Sarah Eady "Edith" Wade Smith Heirs			
(f.4) Raymond S. Smith Heirs, Devisees, Successors or Assigns			
(f.4.1) Virginia Edith Smith PO Box 335 Doran, VA 24612	0.032 acres 1/120 of 3.89 acres	0.0022%	0.0151% HB2058
Total tract acres	3.583		
Total tract percent	0.2415%		

Tract #8A - 65.64 Acres

COAL OWNERSHIP

(1) Hugh Macrae Land Trust <i>Tr 11 (856.25 acre tract)</i> c/o Alan Siegel, Esq. Gump, Strauss, Akin LLP 1 Bryant Park New York, NY 10036-6715	65.64 acres	4.4242%	n/a
--	-------------	---------	-----

By Assignment and Bill of Sale (Gas lease royalty), HMLT devised all of its right, title and interest (other than "Excluded Assets") to Torch Energy Advisors Inc. effective September 4, 1991 and recorded in Buchanan County under DB474 / PG384.

Torch Oil & Gas Company

Exhibit EE
Unit BUNE1
Docket #VGOB 91-1119-0161-07
List of Respondents with Royalty Split Agreements and/or Court Orders/HB2058
(1483.67 Acre Unit)

	Net Acres in Unit	Interest in Unit	Percent of Escrow
<p>c/o Sue Ann Craddock 670 Dona Ana Road SW Deming, New Mexico 88030</p> <p><i>Effective 2/1/11, Torch Oil & Gas Company assigned a 2% ORRI to SAC Investments, L.P.</i></p> <p><i>Effective 3/31/14, Torch Oil & Gas Company, et al. assigned and conveyed 10% of its right, title and interest to Rockport Oil & Gas, L.L.C. In addition, Torch Oil & Gas Company, et al. assigned and conveyed the remaining 90% of its right, title and interest to Chisos, Ltd.</i></p>			
<p>Rockport Oil & Gas L.L.C. PO Box 847 Houston, TX 77001</p>	<p>6.56 acres 1/10 of 65.64 acres</p>	<p>0.4424%</p>	<p><i>n/a</i></p>
<p>Chisos, LTD 670 Dona Ana Road SW Deming, New Mexico 88030</p>	<p>59.08 acres 9/10 of 65.64 acres</p>	<p>4.4242%</p>	<p><i>n/a</i></p>
<u>OIL & GAS OWNERSHIP</u>			
<p>(1) CNX Gas Company LLC 1000 Consol Energy Drive Canonsburg, PA 15317</p>	<p>65.64 acres</p>	<p>4.4242%</p>	<p><i>n/a</i></p>
<u>Tract #8B - 48.01 Acres</u>			
<u>COAL OWNERSHIP</u>			
<p>(1) Hugh Macrae Land Trust <i>Tr 11 (856.25 acre tract)</i> c/o Alan Siegel, Esq. Gump, Strauss, Akin LLP 1 Bryant Park New York, NY 10034-6715</p> <p><i>By Assignment and Bill of Sale (Gas lease royalty), HMLT devised all of its right, title and interest (other than "Excluded Assets") to Torch Energy Advisors Inc. effective September 4, 1991 and recorded in Buchanan County under DB474 / PG384.</i></p> <p>Torch Oil & Gas Company c/o Sue Ann Craddock 670 Dona Ana Road SW Deming, New Mexico 88030</p> <p><i>Effective 2/1/11, Torch Oil & Gas Company assigned a 2% ORRI to SAC Investments, L.P.</i></p> <p><i>Effective 3/31/14, Torch Oil & Gas Company, et al. assigned and conveyed 10% of its right, title and interest to Rockport Oil & Gas, L.L.C. In addition, Torch Oil & Gas Company, et al. assigned and conveyed the remaining 90% of its right, title and interest to Chisos, Ltd.</i></p>	<p>48.01 acres</p>	<p>3.2359%</p>	<p><i>n/a</i></p>
<p>Rockport Oil & Gas L.L.C. PO Box 847 Houston, TX 77001</p>	<p>4.80 acres 1/10 of 48.01 acres</p>	<p>0.3236%</p>	<p><i>n/a</i></p>
<p>Chisos, LTD 670 Dona Ana Road SW Deming, New Mexico 88030</p>	<p>43.21 acres 9/10 of 48.01 acres</p>	<p>2.9123%</p>	<p><i>n/a</i></p>
<u>OIL & GAS OWNERSHIP</u>			
<p>(1) CNX Gas Company LLC *** 1000 Consol Energy Drive Canonsburg, PA 15317</p>	<p>48.01 acres</p>	<p>3.2359%</p>	
*** NOTE: The Royalty Interest was RETAINED by:			
<p>Janet Weatherford P. O. Box 22483 Alexandria, VA 22304</p>			<p>22.3359% HB2058</p>

Tract #10 - 103.33 Acres

Exhibit EE
Unit BUNE1
Docket #VGOB 91-1119-0161-07
List of Respondents with Royalty Split Agreements and/or Court Orders/HB2058
(1483.67 Acre Unit)

	Net Acres in Unit	Interest in Unit	Percent of Escrow
COAL OWNERSHIP			
(1) Hugh Macrae Land Trust <i>Tr 6 (226.00 acre tract)</i> c/o Alan Siegel, Esq. Gump, Strauss, Akin LLP 1 Bryant Park New York, NY 10036-6715	103.33 acres	6.9645%	<i>n/a</i>
<i>By Assignment and Bill of Sale (Gas lease royalty), HMLT devised all of its right, title and interest (other than "Excluded Assets") to Torch Energy Advisors Inc. effective September 4, 1991 and recorded in Buchanan County under DB474 / PG384.</i>			
Torch Oil & Gas Company c/o Sue Ann Craddock 670 Dona Ana Road SW Deming, New Mexico 88030			
<i>Effective 2/1/11, Torch Oil & Gas Company assigned a 2% ORRI to SAC Investments, L.P.</i>			
<i>Effective 3/31/14, Torch Oil & Gas Company, et al. assigned and conveyed 10% of its right, title and interest to Rockport Oil & Gas, L.L.C. In addition, Torch Oil & Gas Company, et al. assigned and conveyed the remaining 90% of its right, title and interest to Chisos, Ltd.</i>			
Rockport Oil & Gas L.L.C. PO Box 847 Houston, TX 77001	10.33 acres 1/10 of 103.33 acres	0.6964%	<i>n/a</i>
Chisos, LTD 670 Dona Ana Road SW Deming, New Mexico 88030	93.00 acres 9/10 of 103.33 acres	6.2680%	<i>n/a</i>
OIL & GAS OWNERSHIP			
(1) CNX Gas Company LLC 1000 Consol Energy Drive Canonsburg, PA 15317	103.33 acres	6.9645%	<i>n/a</i>
Tract #11 - 35.60 Acres			
COAL OWNERSHIP			
(1) Hugh Macrae Land Trust <i>Tr 17 (632.50 acre tract)</i> c/o Alan Siegel, Esq. Gump, Strauss, Akin LLP 1 Bryant Park New York, NY 10036-6715	35.60 acres	2.3995%	<i>n/a</i>
<i>By Assignment and Bill of Sale (Gas lease royalty), HMLT devised all of its right, title and interest (other than "Excluded Assets") to Torch Energy Advisors Inc. effective September 4, 1991 and recorded in Buchanan County under DB474 / PG384.</i>			
Torch Oil & Gas Company c/o Sue Ann Craddock 670 Dona Ana Road SW Deming, New Mexico 88030			
<i>Effective 2/1/11, Torch Oil & Gas Company assigned a 2% ORRI to SAC Investments, L.P.</i>			
<i>Effective 3/31/14, Torch Oil & Gas Company, et al. assigned and conveyed 10% of its right, title and interest to Rockport Oil & Gas, L.L.C. In addition, Torch Oil & Gas Company, et al. assigned and conveyed the remaining 90% of its right, title and interest to Chisos, Ltd.</i>			
Rockport Oil & Gas L.L.C. PO Box 847 Houston, TX 77001	3.56 acres 1/10 of 35.60 acres	0.2399%	<i>n/a</i>
Chisos, LTD 670 Dona Ana Road SW Deming, New Mexico 88030	32.04 acres 9/10 of 35.60 acres	2.1595%	<i>n/a</i>

Exhibit EE
Unit BUNE1
Docket #VGOB 91-1119-0161-07
List of Respondents with Royalty Split Agreements and/or Court Orders/HB2058
(1483.67 Acre Unit)

	Net Acres in Unit	Interest in Unit	Percent of Escrow
--	----------------------	---------------------	----------------------

OIL & GAS OWNERSHIP

(1) CNX Gas Company LLC 1000 Consol Energy Drive Canonsburg, PA 15317	37.98 acres	2.5599%	n/a
---	-------------	---------	-----

Tract #11A- 16.60 Acres

COAL OWNERSHIP

(1) Hugh Macrae Land Trust <i>Tr 17 (632.50 acre tract)</i> c/o Alan Siegel, Esq. Gump, Strauss, Akin LLP 1 Bryant Park New York, NY 10036-6715	16.60 acres	1.1188%	n/a
--	-------------	---------	-----

By Assignment and Bill of Sale (Gas lease royalty), HMLT devised all of its right, title and interest (other than "Excluded Assets") to Torch Energy Advisors Inc. effective September 4, 1991 and recorded in Buchanan County under DB474 / PG384.

Torch Oil & Gas Company
c/o Sue Ann Craddock
670 Dona Ana Road SW
Deming, New Mexico 88030

Effective 2/1/11, Torch Oil & Gas Company assigned a 2% ORRI to SAC Investments, L.P.

Effective 3/31/14, Torch Oil & Gas Company, et al. assigned and conveyed 10% of its right, title and interest to Rockport Oil & Gas, L.L.C. In addition, Torch Oil & Gas Company, et al. assigned and conveyed the remaining 90% of its right, title and interest to Chisos, Ltd.

Rockport Oil & Gas L.L.C. PO Box 847 Houston, TX 77001	1.66 acres 1/10 of 16.60 acres	0.1119%	n/a
Chisos, LTD 670 Dona Ana Road SW Deming, New Mexico 88030	14.94 acres 9/10 of 16.60 acres	1.0070%	n/a

OIL & GAS OWNERSHIP

William Tickle, Jr. & Ruth Stump conveyed to Consol Energy Inc. by Deed dated 4/2/01, recorded at DB 521/ PG 631

(1) CNX Gas Company LLC 1000 Consol Energy Drive Canonsburg, PA 15317	16.60 acres	1.1188%	n/a
---	-------------	---------	-----

Tract #11B- 25.91 Acres

COAL OWNERSHIP

(1) Hugh Macrae Land Trust <i>Tr 17 (632.50 acre tract)</i> c/o Alan Siegel, Esq. Gump, Strauss, Akin LLP 1 Bryant Park New York, NY 10036-6715	25.91 acres	1.7463%	n/a
--	-------------	---------	-----

By Assignment and Bill of Sale (Gas lease royalty), HMLT devised all of its right, title and interest (other than "Excluded Assets") to Torch Energy Advisors Inc. effective September 4, 1991 and recorded in Buchanan County under DB474 / PG384.

Torch Oil & Gas Company
c/o Sue Ann Craddock
670 Dona Ana Road SW
Deming, New Mexico 88030

Effective 2/1/11, Torch Oil & Gas Company assigned a 2% ORRI to SAC Investments, L.P.

Effective 3/31/14, Torch Oil & Gas Company, et al. assigned and conveyed 10% of its right, title and interest to Rockport Oil & Gas, L.L.C. In addition, Torch Oil & Gas Company, et al. assigned and conveyed the remaining 90% of its right, title and interest to Chisos, Ltd.

Exhibit EE
Unit BUNE1
Docket #VGOB 91-1119-0161-07
List of Respondents with Royalty Split Agreements and/or Court Orders/HB2058
(1483.67 Acre Unit)

	Net Acres in Unit	Interest in Unit	Percent of Escrow
Rockport Oil & Gas L.L.C. PO Box 847 Houston, TX 77001	2.59 acres 1/10 of 25.91 acres	0.1746%	<i>n/a</i>
Chisos, LTD 670 Dona Ana Road SW Deming, New Mexico 88030	23.32 acres 9/10 of 25.91 acres	1.5717%	<i>n/a</i>
<u>OIL & GAS OWNERSHIP</u>			
(1) CNX Gas Company LLC, et al	25.91 acres	1.7463%	
(a) CNX Gas Company LLC 1000 Consol Energy Drive Canonsburg, PA 15317	12.96 acres 1/2 of 25.91 acres	0.8732%	<i>n/a</i>
(b) William Tickle, Jr. 1663 Chambers Rd Raven, VA 24639-8413	12.96 acres 1/2 of 25.91 acres	0.8732%	6.0271%
<u>Tract #11C - 2.38 Acres</u>			
<u>COAL OWNERSHIP</u>			
(1) Hugh Macrae Land Trust <i>Tr 17 (632.50 acre tract)</i> c/o Alan Siegel, Esq. Gump, Strauss, Akin LLP 1 Bryant Park New York, NY 10036-6715	2.38 acres	0.1604%	<i>n/a</i>
<i>By Assignment and Bill of Sale (Gas lease royalty), HMLT devised all of its right, title and interest (other than "Excluded Assets") to Torch Energy Advisors Inc. effective September 4, 1991 and recorded in Buchanan County under DB474 / PG384.</i>			
Torch Oil & Gas Company c/o Sue Ann Craddock 670 Dona Ana Road SW Deming, New Mexico 88030			
<i>Effective 2/1/11, Torch Oil & Gas Company assigned a 2% ORRI to SAC Investments, L.P.</i>			
<i>Effective 3/31/14, Torch Oil & Gas Company, et al. assigned and conveyed 10% of its right, title and interest to Rockport Oil & Gas, L.L.C. In addition, Torch Oil & Gas Company, et al. assigned and conveyed the remaining 90% of its right, title and interest to Chisos, Ltd.</i>			
Rockport Oil & Gas L.L.C. PO Box 847 Houston, TX 77001	0.24 acres 1/10 of 2.38 acres	0.0160%	<i>n/a</i>
Chisos, LTD 670 Dona Ana Road SW Deming, New Mexico 88030	2.14 acres 9/10 of 2.38 acres	0.1444%	<i>n/a</i>
<u>OIL & GAS OWNERSHIP</u>			
(1) Garden Realty Corporation 108 Bexley Road Mooresville, NC 28117	2.38 acres	0.1604%	<i>n/a</i>
<u>Tract #12 - 20.44 Acres</u>			
<u>COAL OWNERSHIP</u>			
(1) Hugh Macrae Land Trust <i>Tr 10 (398.00 acre tract)</i> c/o Alan Siegel, Esq. Gump, Strauss, Akin LLP 1 Bryant Park New York, NY 10034-6715	20.44 acres	1.3777%	<i>n/a</i>

Exhibit EE
Unit BUNE1
Docket #VGOB 91-1119-0161-07
List of Respondents with Royalty Split Agreements and/or Court Orders/HB2058
(1483.67 Acre Unit)

	Net Acres in Unit	Interest in Unit	Percent of Escrow
--	----------------------	---------------------	----------------------

By Assignment and Bill of Sale (Gas lease royalty), HMLT devised all of its right, title and interest (other than "Excluded Assets") to Torch Energy Advisors Inc. effective September 4, 1991 and recorded in Buchanan County under DB474 / PG384.

Torch Oil & Gas Company
c/o Sue Ann Craddock
670 Dona Ana Road SW
Deming, New Mexico 88030

Effective 2/1/11, Torch Oil & Gas Company assigned a 2% ORRI to SAC Investments, L.P.

Effective 3/31/14, Torch Oil & Gas Company, et al. assigned and conveyed 10% of its right, title and interest to Rockport Oil & Gas, L.L.C. In addition, Torch Oil & Gas Company, et al. assigned and conveyed the remaining 90% of its right, title and interest to Chisos, Ltd.

Rockport Oil & Gas L.L.C. PO Box 847 Houston, TX 77001	2.04 acres 1/10 of 20.44 acres	0.1378%	<i>n/a</i>
Chisos, LTD 670 Dona Ana Road SW Deming, New Mexico 88030	18.40 acres 9/10 of 20.44 acres	1.2399%	<i>n/a</i>

OIL & GAS OWNERSHIP

(1) L. Mutter Heirs, Devisees,
Successors or Assigns

(a) Eric Mutter, Jr.

(a.1) Ira C. Mutter, et ux. Box 326 Rich Creek, VA 24147	20.44 acres	1.3777%	<i>n/a</i>
--	-------------	---------	------------

*Torch Oil & Gas Company received a one-time payout from escrow of 25% and Ira Mutter 75%
After escrow is disbursed, Ira Mutter will receive 100% direct payments.*

Tract #13A - 0.94 Acres

COAL OWNERSHIP

(1) Hugh Macrae Land Trust <i>Tr 10 (398.00 acre tract)</i> c/o Alan Siegel, Esq. Gump, Strauss, Akin LLP 1 Bryant Park New York, NY 10034-6715	0.94 acres	0.0634%	<i>n/a</i>
--	------------	---------	------------

By Assignment and Bill of Sale (Gas lease royalty), HMLT devised all of its right, title and interest (other than "Excluded Assets") to Torch Energy Advisors Inc. effective September 4, 1991 and recorded in Buchanan County under DB474 / PG384.

Torch Oil & Gas Company
c/o Sue Ann Craddock
670 Dona Ana Road SW
Deming, New Mexico 88030

Effective 2/1/11, Torch Oil & Gas Company assigned a 2% ORRI to SAC Investments, L.P.

Effective 3/31/14, Torch Oil & Gas Company, et al. assigned and conveyed 10% of its right, title and interest to Rockport Oil & Gas, L.L.C. In addition, Torch Oil & Gas Company, et al. assigned and conveyed the remaining 90% of its right, title and interest to Chisos, Ltd.

Rockport Oil & Gas L.L.C. PO Box 847 Houston, TX 77001	0.09 acres 1/10 of 0.94 acres	0.0063%	<i>n/a</i>
Chisos, LTD 670 Dona Ana Road SW Deming, New Mexico 88030	0.85 acres 9/10 of 0.94 acres	0.0570%	<i>n/a</i>

Although the deed from Hugh Macrae Land Trust to Torch Operating Company conveyed the Coal owners' claim to CBM, CBM ownership was adjudicated

Exhibit EE
Unit BUNE1
Docket #VGOB 91-1119-0161-07
List of Respondents with Royalty Split Agreements and/or Court Orders/HB2058
(1483.67 Acre Unit)

	Net Acres in Unit	Interest in Unit	Percent of Escrow
--	----------------------	---------------------	----------------------

*to the prevailing plaintiffs under Case no. 07000420-00 executed on July 7, 2009
Torch Operating Company received a one-time payout of 7.5% from escrow.
After the one-time payout from escrow, royalties will be paid 100% to the prevailing plaintiffs.*

OIL & GAS OWNERSHIP

(1) Fern Duecaster 518 Clinton Street Ravenna, OH 44266	0.94 acres	0.0634%	n/a
---	------------	---------	-----

*Although the deed from Hugh Macrae Land Trust to Torch Operating Company conveyed the Coal owners' claim to CBM, CBM ownership was adjudicated to the prevailing plaintiffs under Case no. 07000420-00 executed on July 7, 2009
Torch Operating Company received a one-time payout of 7.5% from escrow.
After the one-time payout from escrow, royalties will be paid 100% to the prevailing plaintiffs.*

Tract #13B - 0.34 Acres

COAL OWNERSHIP

(1) Hugh Macrae Land Trust <i>Tr 10 (398.00 acre tract)</i> c/o Alan Siegel, Esq. Gump, Strauss, Akin LLP 1 Bryant Park New York, NY 10034-6715	0.34 acres	0.0229%	n/a
--	------------	---------	-----

By Assignment and Bill of Sale (Gas lease royalty), HMLT devised all of its right, title and interest (other than "Excluded Assets") to Torch Energy Advisors Inc. effective September 4, 1991 and recorded in Buchanan County under DB474 / PG384.

Torch Oil & Gas Company
c/o Sue Ann Craddock
670 Dona Ana Road SW
Deming, New Mexico 88030

Effective 2/1/11, Torch Oil & Gas Company assigned a 2% ORRI to SAC Investments, L.P.

Effective 3/31/14, Torch Oil & Gas Company, et al. assigned and conveyed 10% of its right, title and interest to Rockport Oil & Gas, L.L.C. In addition, Torch Oil & Gas Company, et al. assigned and conveyed the remaining 90% of its right, title and interest to Chisos, Ltd.

Rockport Oil & Gas L.L.C. PO Box 847 Houston, TX 77001	0.03 acres 1/10 of 0.34 acres	0.0023%	n/a
Chisos, LTD 670 Dona Ana Road SW Deming, New Mexico 88030	0.31 acres 9/10 of 0.34 acres	0.0206%	n/a

*Although the deed from Hugh Macrae Land Trust to Torch Operating Company conveyed the Coal owners' claim to CBM, CBM ownership was adjudicated to the prevailing plaintiffs under Case no. 07000420-00 executed on July 7, 2009
Torch Operating Company will receive a one-time payout of 7.5% from escrow.
After the one-time payout from escrow, royalties will be paid 100% to the prevailing plaintiffs.*

OIL & GAS OWNERSHIP

(1) Kimberly R. Tucker (aka Kimberly R. Davis) 3930 McNaull Road Mansfield, OH 44903	0.34 acres	0.0229%	n/a
--	------------	---------	-----

*Although the deed from Hugh Macrae Land Trust to Torch Operating Company conveyed the Coal owners' claim to CBM, CBM ownership was adjudicated to the prevailing plaintiffs under Case no. 07000420-00 executed on July 7, 2009
Torch Operating Company will receive a one-time payout of 7.5% from escrow.
After the one-time payout from escrow, royalties will be paid 100% to the prevailing plaintiffs.*

Tract #13C - 0.04 Acres

COAL OWNERSHIP

Exhibit EE
Unit BUNE1
Docket #VGOB 91-1119-0161-07
List of Respondents with Royalty Split Agreements and/or Court Orders/HB2058
(1483.67 Acre Unit)

	Net Acres in Unit	Interest in Unit	Percent of Escrow
(1) Hugh Macrae Land Trust <i>Tr 10 (398.00 acre tract)</i> c/o Alan Siegel, Esq. Gump, Strauss, Akin LLP 1 Bryant Park New York, NY 10034-6715	0.04 acres	0.0027%	<i>n/a</i>
<i>By Assignment and Bill of Sale (Gas lease royalty), HMLT devised all of its right, title and interest (other than "Excluded Assets") to Torch Energy Advisors Inc. effective September 4, 1991 and recorded in Buchanan County under DB474 / PG384.</i>			
Torch Oil & Gas Company c/o Sue Ann Craddock 670 Dona Ana Road SW Deming, New Mexico 88030			
<i>Effective 2/1/11, Torch Oil & Gas Company assigned a 2% ORRI to SAC Investments, L.P.</i>			
<i>Effective 3/31/14, Torch Oil & Gas Company, et al. assigned and conveyed 10% of its right, title and interest to Rockport Oil & Gas, L.L.C. In addition, Torch Oil & Gas Company, et al. assigned and conveyed the remaining 90% of its right, title and interest to Chisos, Ltd.</i>			
Rockport Oil & Gas L.L.C. PO Box 847 Houston, TX 77001	0.004 acres 1/10 of 0.04 acres	0.0003%	<i>n/a</i>
Chisos, LTD 670 Dona Ana Road SW Deming, New Mexico 88030	0.04 acres 9/10 of 0.04 acres	0.0024%	<i>n/a</i>

*Although the deed from Hugh Macrae Land Trust to Torch Operating Company conveyed the Coal owners' claim to CBM, CBM ownership was adjudicated to the prevailing plaintiffs under Case no. 07000420-00 executed on July 7, 2009 Torch Operating Company received a one-time payout of 7.5% from escrow.
After the one-time payout from escrow, royalties will be paid 100% to the prevailing plaintiffs.*

OIL & GAS OWNERSHIP

(1) Monta Mutter 16713 Recreation Drive Lake Milton, OH 44429	0.04 acres	0.0027%	<i>n/a</i>
---	------------	---------	------------

*Although the deed from Hugh Macrae Land Trust to Torch Operating Company conveyed the Coal owners' claim to CBM, CBM ownership was adjudicated to the prevailing plaintiffs under Case no. 07000420-00 executed on July 7, 2009 Torch Operating Company received a one-time payout of 7.5% from escrow.
After the one-time payout from escrow, royalties will be paid 100% to the prevailing plaintiffs.*

Tract #14 - 201.08 Acres

COAL OWNERSHIP

(1) Hugh Macrae Land Trust <i>Tr 24 (252.00 acre tract)</i> c/o Alan Siegel, Esq. Gump, Strauss, Akin LLP 1 Bryant Park New York, NY 10036-6715	201.08 acres	13.5529%	<i>n/a</i>
--	--------------	----------	------------

By Assignment and Bill of Sale (Gas lease royalty), HMLT devised all of its right, title and interest (other than "Excluded Assets") to Torch Energy Advisors Inc. effective September 4, 1991 and recorded in Buchanan County under DB474 / PG384.

Torch Oil & Gas Company
c/o Sue Ann Craddock
670 Dona Ana Road SW
Deming, New Mexico 88030

Effective 2/1/11, Torch Oil & Gas Company assigned a 2% ORRI to SAC Investments, L.P.

Effective 3/31/14, Torch Oil & Gas Company, et al. assigned and conveyed 10% of its right, title and interest to Rockport Oil & Gas, L.L.C. In addition, Torch Oil & Gas Company, et al. assigned and conveyed the remaining 90% of its right, title and interest to Chisos, Ltd.

Exhibit EE
Unit BUNE1
Docket #VGOB 91-1119-0161-07
List of Respondents with Royalty Split Agreements and/or Court Orders/HB2058
(1483.67 Acre Unit)

	Net Acres in Unit	Interest in Unit	Percent of Escrow
Rockport Oil & Gas L.L.C. PO Box 847 Houston, TX 77001	20.108 acres 1/10 of 201.08 acres	1.3553%	n/a
Chisos, LTD 670 Dona Ana Road SW Deming, New Mexico 88030	180.97 acres 9/10 of 201.08 acres	12.1976%	n/a
<u>OIL & GAS OWNERSHIP</u>			
(1) CNX Gas Company LLC 1000 Consol Energy Drive Canonsburg, PA 15317	201.08 acres	13.5529%	n/a
<u>Tract #15 - 9.35 Acres</u>			
<u>COAL OWNERSHIP</u>			
(1) Hugh Macrae Land Trust <i>Tr 13 (254.50 acre tract)</i> c/o Alan Siegel, Esq. Gump, Strauss, Akin LLP 1 Bryant Park New York, NY 10036-6715	9.35 acres	0.6302%	n/a
<i>By Assignment and Bill of Sale (Gas lease royalty), HMLT devised all of its right, title and interest (other than "Excluded Assets") to Torch Energy Advisors Inc. effective September 4, 1991 and recorded in Buchanan County under DB474 / PG384.</i>			
Torch Oil & Gas Company c/o Sue Ann Craddock 670 Dona Ana Road SW Deming, New Mexico 88030			
<i>Effective 2/1/11, Torch Oil & Gas Company assigned a 2% ORRI to SAC Investments, L.P.</i>			
<i>Effective 3/31/14, Torch Oil & Gas Company, et al. assigned and conveyed 10% of its right, title and interest to Rockport Oil & Gas, L.L.C. In addition, Torch Oil & Gas Company, et al. assigned and conveyed the remaining 90% of its right, title and interest to Chisos, Ltd.</i>			
Rockport Oil & Gas L.L.C. PO Box 847 Houston, TX 77001	0.935 acres 1/10 of 9.35 acres	0.0630%	n/a
Chisos, LTD 670 Dona Ana Road SW Deming, New Mexico 88030	8.42 acres 9/10 of 9.35 acres	0.5672%	n/a
<u>OIL & GAS OWNERSHIP</u>			
(1) CNX Gas Company LLC 1000 Consol Energy Drive Canonsburg, PA 15317	9.35 acres	0.6302%	n/a
<u>Tract #16 - 56.90 Acres</u>			
<u>COAL OWNERSHIP</u>			
(1) Hugh Macrae Land Trust <i>Tr 13 (254.50 acre tract)</i> c/o Alan Siegel, Esq. Gump, Strauss, Akin LLP 1 Bryant Park New York, NY 10036-6715	56.90 acres	3.8351%	n/a
<i>By Assignment and Bill of Sale (Gas lease royalty), HMLT devised all of its right, title and interest (other than "Excluded Assets") to Torch Energy Advisors Inc. effective September 4, 1991 and recorded in Buchanan County under DB474 / PG384.</i>			
Torch Oil & Gas Company c/o Sue Ann Craddock			

Exhibit EE
Unit BUNE1
Docket #VGOB 91-1119-0161-07
List of Respondents with Royalty Split Agreements and/or Court Orders/HB2058
(1483.67 Acre Unit)

	Net Acres in Unit	Interest in Unit	Percent of Escrow
670 Dona Ana Road SW Deming, New Mexico 88030			
<i>Effective 2/1/11, Torch Oil & Gas Company assigned a 2% ORRI to SAC Investments, L.P.</i>			
<i>Effective 3/31/14, Torch Oil & Gas Company, et al. assigned and conveyed 10% of its right, title and interest to Rockport Oil & Gas, L.L.C. In addition, Torch Oil & Gas Company, et al. assigned and conveyed the remaining 90% of its right, title and interest to Chisos, Ltd.</i>			
Rockport Oil & Gas L.L.C. PO Box 847 Houston, TX 77001	5.690 acres 1/10 of 56.90 acres	0.3835%	<i>n/a</i>
Chisos, LTD 670 Dona Ana Road SW Deming, New Mexico 88030	51.21 acres 9/10 of 56.90 acres	3.4516%	<i>n/a</i>
<u>OIL & GAS OWNERSHIP</u>			
(1) CNX Gas Company LLC 1000 Consol Energy Drive Canonsburg, PA 15317	56.90 acres	3.8351%	<i>n/a</i>
<u>Tract #17 - 23.22 Acres</u>			
<u>COAL OWNERSHIP</u>			
(1) Hugh Macrae Land Trust <i>Tr 13 (254.50 acre tract)</i> c/o Alan Siegel, Esq. Gump, Strauss, Akin LLP 1 Bryant Park New York, NY 10036-6715	23.22 acres	1.5650%	<i>n/a</i>
<i>By Assignment and Bill of Sale (Gas lease royalty), HMLT devised all of its right, title and interest (other than "Excluded Assets") to Torch Energy Advisors Inc. effective September 4, 1991 and recorded in Buchanan County under DB474 / PG384.</i>			
Torch Oil & Gas Company c/o Sue Ann Craddock 670 Dona Ana Road SW Deming, New Mexico 88030			
<i>Effective 2/1/11, Torch Oil & Gas Company assigned a 2% ORRI to SAC Investments, L.P.</i>			
<i>Effective 3/31/14, Torch Oil & Gas Company, et al. assigned and conveyed 10% of its right, title and interest to Rockport Oil & Gas, L.L.C. In addition, Torch Oil & Gas Company, et al. assigned and conveyed the remaining 90% of its right, title and interest to Chisos, Ltd.</i>			
Rockport Oil & Gas L.L.C. PO Box 847 Houston, TX 77001	2.322 acres 1/10 of 23.22 acres	0.1565%	<i>n/a</i>
Chisos, LTD 670 Dona Ana Road SW Deming, New Mexico 88030	20.90 acres 9/10 of 23.22 acres	1.4085%	<i>n/a</i>
<u>OIL & GAS OWNERSHIP</u>			
(1) CNX Gas Company LLC 1000 Consol Energy Drive Canonsburg, PA 15317	23.22 acres	1.5650%	<i>n/a</i>
<u>Tract #18 - 6.98 Acres</u>			
<u>COAL OWNERSHIP</u>			
(1) Hugh Macrae Land Trust <i>Tr 10 (398.00 acre tract)</i> c/o Alan Siegel, Esq. Gump, Strauss, Akin LLP 1 Bryant Park	6.98 acres	0.4705%	<i>n/a</i>

Exhibit EE
Unit BUNE1
Docket #VGOB 91-1119-0161-07
List of Respondents with Royalty Split Agreements and/or Court Orders/HB2058
(1483.67 Acre Unit)

	Net Acres in Unit	Interest in Unit	Percent of Escrow
New York, NY 10036-6715			
<i>By Assignment and Bill of Sale (Gas lease royalty), HMLT devised all of its right, title and interest (other than "Excluded Assets") to Torch Energy Advisors Inc. effective September 4, 1991 and recorded in Buchanan County under DB474 / PG384.</i>			
Torch Oil & Gas Company c/o Sue Ann Craddock 670 Dona Ana Road SW Deming, New Mexico 88030			
<i>Effective 2/1/11, Torch Oil & Gas Company assigned a 2% ORRI to SAC Investments, L.P.</i>			
<i>Effective 3/31/14, Torch Oil & Gas Company, et al. assigned and conveyed 10% of its right, title and interest to Rockport Oil & Gas, L.L.C. In addition, Torch Oil & Gas Company, et al. assigned and conveyed the remaining 90% of its right, title and interest to Chisos, Ltd.</i>			
Rockport Oil & Gas L.L.C. PO Box 847 Houston, TX 77001	0.698 acres 1/10 of 6.98 acres	0.0470%	<i>n/a</i>
Chisos, LTD 670 Dona Ana Road SW Deming, New Mexico 88030	6.28 acres 9/10 of 6.98 acres	0.4234%	<i>n/a</i>
<u>OIL & GAS OWNERSHIP</u>			
(1) CNX Gas Company LLC 1000 Consol Energy Drive Canonsburg, PA 15317	6.98 acres	0.4705%	<i>n/a</i>
<u>Tract #20 - 10.00 Acres</u>			
<u>COAL OWNERSHIP</u>			
(1) Hugh Macrae Land Trust <i>Tr ?? (Per map - Tr 25 - 36.00 acre tract)</i> c/o Alan Siegel, Esq. Gump, Strauss, Akin LLP 1 Bryant Park New York, NY 10034-6715	10.00 acres	0.6740%	<i>n/a</i>
<i>By Assignment and Bill of Sale (Gas lease royalty), HMLT devised all of its right, title and interest (other than "Excluded Assets") to Torch Energy Advisors Inc. effective September 4, 1991 and recorded in Buchanan County under DB474 / PG384.</i>			
Torch Oil & Gas Company c/o Sue Ann Craddock 670 Dona Ana Road SW Deming, New Mexico 88030			
<i>Effective 2/1/11, Torch Oil & Gas Company assigned a 2% ORRI to SAC Investments, L.P.</i>			
<i>Effective 3/31/14, Torch Oil & Gas Company, et al. assigned and conveyed 10% of its right, title and interest to Rockport Oil & Gas, L.L.C. In addition, Torch Oil & Gas Company, et al. assigned and conveyed the remaining 90% of its right, title and interest to Chisos, Ltd.</i>			
Rockport Oil & Gas L.L.C. PO Box 847 Houston, TX 77001	1.000 acres 1/10 of 10.00 acres	0.0674%	0.0039% Royalty Division Agreement
Chisos, LTD 670 Dona Ana Road SW Deming, New Mexico 88030	9.00 acres 9/10 of 10.00 acres	0.6066%	0.0349% Royalty Division Agreement
<u>OIL & GAS OWNERSHIP</u>			
Modern Homes Inc., et al. <i>(Modern Homes Inc. - 4/5 & Walter Wade Heirs - 1/5)</i>	10.00 acres	0.6740%	
(2) Walter Wade Heirs			

Exhibit EE
Unit BUNE1
Docket #VGOB 91-1119-0161-07
List of Respondents with Royalty Split Agreements and/or Court Orders/HB2058
(1483.67 Acre Unit)

	Net Acres in Unit	Interest in Unit	Percent of Escrow
(a) Carl Wade Heirs, Devisees, Successors or Assigns			
(a) Carl Wade Heirs, Devisees, Successors or Assigns			
(a.1) Emanuel Wade 226 Adams Street Blountville, TN 37617	0.167 acres 1/60 of 10.00 acres	0.0112%	0.0388% Royalty Division Agreement
(a.2) Gaylene Deskins Heirs, Devisees, Successors or Assigns			
(a.2.1) Nick Deskins 720 Skyview Drive Chilhowie, VA 24319-4527	0.083 acres 1/120 of 10.00 acres	0.0056%	n/a
(a.2.2) Valmy Shannon 103 Blanton Drive Seaford, VA 23696-2522	0.083 acres 1/120 of 10.00 acres	0.0056%	n/a
(b) Eunice Wade Baldwin Heirs, Devisees, Successors or Assigns			
(b.5) Sherman Baldwin 1210 Lake Witten Road North Tazewell, VA 24630	0.028 acres 1/360 of 10.00 acres	0.0019%	0.0129% HB2058
(b.8) D.C. Baldwin Heirs, Devisees, Successors or Assigns			
(b.8.1) Nancy Baldwin Wooten Komp 2510 Arthur Road Springfield, OH 45502	0.014 acres 1/720 of 10.00 acres	0.0009%	0.0065% HB2058
(b.8.2) Sandra Baldwin Cranmer 11651 SE 69th Ter, Lot 18 Bellevue, FL 34420	0.014 acres 1/720 of 10.00 acres	0.0009%	0.0065% HB2058
(b.9) Shirley F. Baldwin Heirs, Devisees, Successors or Assigns			
(b.9.1) Donna Foote 32632 Downing Rd Delmar, MD 21875	0.014 acres 1/720 of 10.00 acres	0.0009%	0.0065% HB2058
(b.9.2) Pamela Ginger Case 325 2nd Street North Little Rock, AK 72117	0.014 acres 1/720 of 10.00 acres	0.0009%	0.0065% HB2058
(b.10) Norman Baldwin Heirs, Devisees, Successors or Assigns			
(b.10.1) Rufus Baldwin 208 High Street Richlands, VA 24641	0.006 acres 1/1800 of 10.00 acres	0.0004%	0.0026% HB2058
(b.10.2) David Baldwin P.O. Box 803 Raven, VA 24639	0.006 acres 1/1800 of 10.00 acres	0.0004%	0.0026% HB2058
(b.10.4) Tammy Baldwin Muir 4480 Clarks Valley Road Swords Creek, VA 24649	0.006 acres 1/1800 of 10.00 acres	0.0004%	0.0026% HB2058
(b.11) Bane Baldwin Heirs, Devisees, Successors or Assigns			

Exhibit EE
Unit BUNE1
Docket #VGOB 91-1119-0161-07
List of Respondents with Royalty Split Agreements and/or Court Orders/HB2058
(1483.67 Acre Unit)

	Net Acres in Unit	Interest in Unit	Percent of Escrow
(b.11.1) Eddie Baldwin 1210 Sunset Drive Richlands, VA 24641	0.009 acres 1/1080 of 10.00 acres	0.0006%	0.0043% HB2058
(b.11.2) Kathy Whitt 8740 Swords Creek Road Swords Creek, VA 24649	0.009 acres 1/1080 of 10.00 acres	0.0006%	0.0043% HB2058
(b.11.3) Lisa Shaver 89 Sevier Street Lebanon, VA 24266-7142	0.009 acres 1/1080 of 10.00 acres	0.0006%	0.0043% HB2058
(d) Glayds Ida Boyd Heirs, Devisees, Successors or Assigns			
(d.1) Patti Gilbert 3603 Kents Ridge Road Cedar Bluff, VA 24609-8517	0.111 acres 1/90 of 10.00 acres	0.0075%	0.0517% HB2058
(d.2) Michael T. Boyd 3849 Kents Ridge Road Cedar Bluff, VA 24609-8518	0.111 acres 1/90 of 10.00 acres	0.0075%	0.0517% HB2058
(d.3) Eleanor Sue Hagy 14475 Rainbow Road, Lot #31 Bristol, VA 24202	0.111 acres 1/90 of 10.00 acres	0.0075%	n/a
(e) Venia Wade Newberry 639 Daniel Drive Newport News, VA 23601-1701	0.333 acres 1/30 of 10.00 acres	0.0225%	0.1551% HB2058
(f) Sarah Eady "Edith" Wade Smith Heirs			
(f.4) Raymond S. Smith Heirs, Devisees, Successors or Assigns			
(f.4.1) Virginia Edith Smith PO Box 335 Doran, VA 24612	0.083 acres 1/120 of 10.00 acres	0.0056%	0.0388% HB2058
	Total tract acres	1.211	
	Total tract percent	0.0816%	

Tract #21 - 0.80 Acres

COAL OWNERSHIP

- (1) Hugh Macrae Land Trust
Tr ?? (Per map - Tr 25 - 36.00 acre tract)
c/o Alan Siegel, Esq.
Gump, Strauss, Akin LLP
1 Bryant Park
New York, NY 10034-6715

By Assignment and Bill of Sale (Gas lease royalty), HMLT devised all of its right, title and interest (other than "Excluded Assets") to Torch Energy Advisors Inc. effective September 4, 1991 and recorded in Buchanan County under DB474 / PG384.

Torch Oil & Gas Company
c/o Sue Ann Craddock
670 Dona Ana Road SW
Deming, New Mexico 88030

Effective 2/1/11, Torch Oil & Gas Company assigned a 2% ORRI to SAC Investments, L.P.

Effective 3/31/14, Torch Oil & Gas Company, et al. assigned and conveyed 10% of its right, title and interest to Rockport Oil & Gas, L.L.C. In addition, Torch Oil & Gas Company, et al. assigned and conveyed the remaining 90% of its right, title and interest to Chisos, Ltd.

Exhibit EE
Unit BUNE1
Docket #VGOB 91-1119-0161-07
List of Respondents with Royalty Split Agreements and/or Court Orders/HB2058
(1483.67 Acre Unit)

	Net Acres in Unit	Interest in Unit	Percent of Escrow
Rockport Oil & Gas L.L.C. PO Box 847 Houston, TX 77001	0.080 acres 1/10 of 0.80 acres	0.0054%	0.0003% Royalty Division Agreement
Chisos, LTD 670 Dona Ana Road SW Deming, New Mexico 88030	0.720 acres 9/10 of 0.80 acres	0.0485%	0.0028% Royalty Division Agreement
<u>OIL & GAS OWNERSHIP</u>			
Pepsico of Norton, Inc., et al. <i>(Pepsico of Norton, Inc. - 4/5 & Walter Wade Heirs - 1/5)</i>	0.80 acres	0.0539%	
(2) Walter Wade Heirs			
(a) Carl Wade Heirs, Devisees, Successors or Assigns			
(a) Carl Wade Heirs, Devisees, Successors or Assigns			
(a.1) Emanuel Wade 226 Adams Street Blountville, TN 37617	0.013 acres 1/60 of 0.80 acres	0.0009%	0.0031% Royalty Division Agreement
(a.2) Gaylene Deskins Heirs, Devisees, Successors or Assigns			
(a.2.1) Nick Deskins 720 Skyview Drive Chilhowie, VA 24319-4527	0.007 acres 1/120 of 0.80 acres	0.0004%	n/a
(a.2.2) Valmy Shannon 103 Blanton Drive Seaford, VA 23696-2522	0.007 acres 1/120 of 0.80 acres	0.0004%	n/a
(b) Eunice Wade Baldwin Heirs, Devisees, Successors or Assigns			
(b.5) Sherman Baldwin 1210 Lake Witten Road North Tazewell, VA 24630	0.002 acres 1/360 of 0.80 acres	0.0001%	0.0010% HB2058
(b.8) D.C. Baldwin Heirs, Devisees, Successors or Assigns			
(b.8.1) Nancy Baldwin Wooten Komp 2510 Arthur Road Springfield, OH 45502	0.001 acres 1/720 of 0.80 acres	0.0001%	0.0005% HB2058
(b.8.2) Sandra Baldwin Cranmer 11651 SE 69th Ter, Lot 18 Belleview, FL 34420	0.001 acres 1/720 of 0.80 acres	0.0001%	0.0005% HB2058
(b.9) Shirley F. Baldwin Heirs, Devisees, Successors or Assigns			
(b.9.1) Donna Foote 32632 Downing Rd Delmar, MD 21875	0.001 acres 1/720 of 0.80 acres	0.0001%	0.0005% HB2058
(b.9.2) Pamela Ginger Case 325 2nd Street North Little Rock, AK 72117	0.001 acres 1/720 of 0.80 acres	0.0001%	0.0005% HB2058
(b.10) Norman Baldwin Heirs, Devisees, Successors or Assigns			
(b.10.1) Rufus Baldwin	0.000 acres	0.0000%	0.0002%

Exhibit EE
Unit BUNE1
Docket #VGOB 91-1119-0161-07
List of Respondents with Royalty Split Agreements and/or Court Orders/HB2058
(1483.67 Acre Unit)

	Net Acres in Unit	Interest in Unit	Percent of Escrow
208 High Street Richlands, VA 24641	1/1800 of 0.80 acres		HB2058
(b.10.2) David Baldwin P.O. Box 803 Raven, VA 24639	0.000 acres 1/1800 of 0.80 acres	0.0000%	0.0002% HB2058
(b.10.4) Tammy Baldwin Muir 4480 Clarks Valley Road Swords Creek, VA 24649	0.000 acres 1/1800 of 0.80 acres	0.0000%	0.0002% HB2058
(b.11) Bane Baldwin Heirs, Devisees, Successors or Assigns			
(b.11.1) Eddie Baldwin 1210 Sunset Drive Richlands, VA 24641	0.001 acres 1/1080 of 0.80 acres	0.0000%	0.0003% HB2058
(b.11.2) Kathy Whitt 8740 Swords Creek Road Swords Creek, VA 24649	0.001 acres 1/1080 of 0.80 acres	0.0000%	0.0003% HB2058
(b.11.3) Lisa Shaver 89 Sevier Street Lebanon, VA 24266-7142	0.001 acres 1/1080 of 0.80 acres	0.0000%	0.0003% HB2058
(d) Glayds Ida Boyd Heirs, Devisees, Successors or Assigns			
(d.1) Patti Gilbert 3603 Kent Ridge Road Cedar Bluff, VA 24609-8517	0.009 acres 1/90 of 0.80 acres	0.0006%	0.0041% HB2058
(d.2) Michael T. Boyd 3849 Kent Ridge Road Cedar Bluff, VA 24609-8518	0.009 acres 1/90 of 0.80 acres	0.0006%	0.0041% HB2058
(d.3) Eleanor Sue Hagy 14475 Rainbow Road, Lot #31 Bristol, VA 24202	0.009 acres 1/90 of 0.80 acres	0.0006%	n/a
(e) Venia Wade Newberry 639 Daniel Drive Newport News, VA 23601-1701	0.027 acres 1/30 of 0.80 acres	0.0018%	0.0124% HB2058
(f) Sarah Eady "Edith" Wade Smith Heirs			
(f.4) Raymond S. Smith Heirs, Devisees, Successors or Assigns			
(f.4.1) Virginia Edith Smith PO Box 335 Doran, VA 24612	0.007 acres 1/120 of 0.80 acres	0.0004%	0.0031% HB2058
Total tract acres	0.097		
Total tract percent	0.0065%		

Tract #22 - 5.00 Acres

COAL OWNERSHIP

(1) Hugh Macrae Land Trust <i>Tr ?? (Per map - Tr 25 - 36.00 acre tract)</i> c/o Alan Siegel, Esq. Gump, Strauss, Akin LLP 1 Bryant Park New York, NY 10034-6715	5.00 acres	0.3370%	n/a
---	------------	---------	-----

Exhibit EE
Unit BUNE1
Docket #VGOB 91-1119-0161-07
List of Respondents with Royalty Split Agreements and/or Court Orders/HB2058
(1483.67 Acre Unit)

	Net Acres in Unit	Interest in Unit	Percent of Escrow
<i>By Assignment and Bill of Sale (Gas lease royalty), HMLT devised all of its right, title and interest (other than "Excluded Assets") to Torch Energy Advisors Inc. effective September 4, 1991 and recorded in Buchanan County under DB474 / PG384.</i>			
Torch Oil & Gas Company c/o Sue Ann Craddock 670 Dona Ana Road SW Deming, New Mexico 88030			
<i>Effective 2/1/11, Torch Oil & Gas Company assigned a 2% ORRI to SAC Investments, L.P.</i>			
<i>Effective 3/31/14, Torch Oil & Gas Company, et al. assigned and conveyed 10% of its right, title and interest to Rockport Oil & Gas, L.L.C. In addition, Torch Oil & Gas Company, et al. assigned and conveyed the remaining 90% of its right, title and interest to Chisos, Ltd.</i>			
Rockport Oil & Gas L.L.C. PO Box 847 Houston, TX 77001	0.500 acres 1/10 of 5.00 acres	0.0337%	<i>n/a</i>
Chisos, LTD 670 Dona Ana Road SW Deming, New Mexico 88030	4.500 acres 9/10 of 5.00 acres	0.3033%	<i>n/a</i>
<u>OIL & GAS OWNERSHIP</u>			
(1) Commonwealth of Virginia Department of Transportation 870 Bonham Road Bristol, VA 24201-2002	5.00 acres	0.3370%	2.3262%
	Total Acreage Resolved	TOTALS: 1158.2108	
	Total Percentage Resolved	78.0639%	

Exhibit J
Unit BUNE1 Escrow Account Reconciliation
VGOB 91-1119-0161

CNX Deposit Information		
Check Date	Check Number	Total
9/25/1998		\$354.52
10/25/1998		\$212.26
11/25/1998		\$121.38
12/25/1998		\$258.36
1/25/1999		\$306.80
2/25/1999		\$303.76
3/25/1999		\$375.20
4/25/1999		\$310.78
5/25/1999		\$235.20
6/25/1999		\$216.44
7/25/1999		\$322.12
8/25/1999		\$294.62
9/25/1999		\$267.00
10/25/1999		\$350.40
11/25/1999		\$502.34
12/25/1999		\$394.22
1/25/2000		\$502.64
2/25/2000		\$201.64
3/25/2000		\$251.40
4/25/2000		\$299.58
5/25/2000		\$360.80
6/25/2000		\$23,417.85
7/25/2000		\$2,823.18
8/25/2000		\$3,925.36
9/25/2000		\$4,134.08
10/25/2000		\$3,430.56
11/25/2000		\$4,016.43
12/25/2000		\$4,845.56
1/25/2001		\$3,875.96
2/25/2001		\$6,080.60
3/25/2001		\$8,604.94
4/25/2001		\$4,669.30
5/25/2001		\$4,105.74
6/25/2001		\$4,262.20
7/25/2001		\$3,860.52
8/25/2001		\$2,722.78
9/25/2001		\$2,087.50
10/25/2001		\$1,971.96
11/25/2001		\$1,080.32
12/25/2001		\$1,024.28
1/25/2002		\$941.50
2/25/2002		\$1,119.54
3/25/2002	16261, 16262	\$1,135.08
4/25/2002	16513	\$861.48
5/24/2002	17377	\$1,071.47
6/25/2002	18029	\$1,333.45
7/25/2002	18607	\$1,293.95
8/23/2002	19215	\$1,404.85
9/25/2002	19549	\$1,638.28

Escrow Bank Data														
Date	Escrow Royalty Deposits	Income	\$ Mrket Int	CDARS Int	Fees	Distributions	Corrections	Audit Costs	Gain/Loss	Royalty Bonus	Total Int. and Fees	Bank Balance	Running Balance	Difference
											\$0.00		\$354.52	-\$354.52
											\$0.00		\$566.78	-\$566.78
											\$0.00		\$688.16	-\$688.16
											\$0.00		\$946.52	-\$946.52
											\$0.00		\$1,253.32	-\$1,253.32
											\$0.00		\$1,557.08	-\$1,557.08
											\$0.00		\$1,932.28	-\$1,932.28
											\$0.00		\$2,243.06	-\$2,243.06
											\$0.00		\$2,478.26	-\$2,478.26
											\$0.00		\$2,694.70	-\$2,694.70
											\$0.00		\$3,016.82	-\$3,016.82
											\$0.00		\$3,311.44	-\$3,311.44
											\$0.00		\$3,578.44	-\$3,578.44
											\$0.00		\$3,928.84	-\$3,928.84
11/30/1999	\$48.90										\$0.00	\$48.90	\$4,431.18	-\$4,382.28
12/31/1999		\$0.57			-\$0.04				-\$0.08		\$0.45	\$49.35	\$4,825.85	-\$4,776.50
1/31/2000		\$0.14									\$0.14	\$49.49	\$5,328.63	-\$5,279.14
2/29/2000		\$0.15									\$0.15	\$49.64	\$5,530.42	-\$5,480.78
3/31/2000		\$0.17									\$0.17	\$49.81	\$5,781.99	-\$5,732.18
4/30/2000		\$0.15									\$0.15	\$49.97	\$6,081.72	-\$6,031.75
5/31/2000		\$0.22									\$0.22	\$50.19	\$6,442.74	-\$6,392.55
6/30/2000	\$22,927.40	\$93.14									\$93.14	\$23,070.73	\$29,953.73	-\$6,883.00
7/31/2000		\$106.84									\$106.84	\$23,177.57	\$32,883.75	-\$9,706.18
8/31/2000	\$3,062.75	\$119.81									\$119.81	\$26,360.13	\$36,928.92	-\$10,568.79
9/30/2000	\$0.00	\$112.44				\$0.00					\$112.44	\$26,472.57	\$41,175.44	-\$14,702.87
10/31/2000	\$2,696.67	\$142.33										\$29,311.57	\$44,606.00	-\$15,294.43
11/30/2000	\$0.00	\$131.33										\$29,422.90	\$48,622.43	-\$19,199.53
12/31/2000	\$196.92	\$128.31				\$0.00					\$128.31	\$29,768.13	\$53,596.30	-\$23,828.17
1/31/2001	\$3,015.92	\$135.16				\$0.00					\$135.16	\$32,919.21	\$57,607.42	-\$24,688.21
2/28/2001	\$7,757.26	\$253.13				\$0.00					\$253.13	\$37,778.52	\$63,941.15	-\$26,162.63
3/31/2001	\$6,730.34	\$126.81				\$0.00					\$126.81	\$46,809.14	\$72,672.90	-\$25,863.76
5/31/2001	\$3,193.00	\$162.18				\$0.00					\$162.18	\$64,081.54	\$81,610.12	-\$17,528.58
6/30/2001	\$3,331.84	\$143.64				\$0.00					\$143.64	\$67,557.02	\$86,015.96	-\$18,458.94
7/31/2001	\$22,858.86	\$201.46				\$0.00					\$201.46	\$90,617.34	\$90,077.94	\$539.40
8/31/2001	\$2,719.72	\$196.03				\$0.00					\$196.03	\$93,533.09	\$92,996.75	\$536.34
9/30/2001	\$2,096.32	\$153.77				\$0.00					\$153.77	\$95,783.18	\$95,238.02	\$545.16
10/31/2001	\$1,952.80	\$138.15				\$0.00					\$138.15	\$97,874.13	\$97,348.13	\$526.00
11/30/2001	\$0.00	\$0.00				\$0.00					\$0.00	\$99,024.32	\$98,428.45	\$595.87
12/31/2001	\$1,074.54	\$120.93				\$0.00					\$120.93	\$100,219.79	\$99,573.66	\$646.13
1/31/2002	\$910.22	\$71.78				\$0.00					\$71.78	\$101,201.79	\$100,586.94	\$614.85
2/28/2002	\$1,179.22	\$53.57				\$0.00					\$53.57	\$102,434.58	\$101,760.05	\$674.53
3/31/2002	\$1,135.08	\$60.60				\$0.00					\$60.60	\$103,630.26	\$102,955.73	\$674.53
4/30/2002	\$861.48	\$0.00				\$0.00					\$0.00	\$104,491.74	\$103,817.21	\$674.53
5/31/2002	\$1,071.47	\$68.66				\$0.00					\$68.66	\$105,631.87	\$104,957.34	\$674.53
6/30/2002	\$1,678.47	\$57.75				\$0.00					\$57.75	\$107,368.09	\$106,348.54	\$1,019.55
7/31/2002	\$1,293.95	\$56.12				\$0.00					\$56.12	\$108,718.16	\$107,698.61	\$1,019.55
8/31/2002	\$1,404.85	\$59.76				\$0.00					\$59.76	\$110,182.77	\$109,163.22	\$1,019.55
9/30/2002	\$1,638.28	\$58.67				\$0.00					\$58.67	\$111,879.72	\$110,860.17	\$1,019.55

Exhibit J
Unit BUNE1 Escrow Account Reconciliation
VGOB 91-1119-0161

CNX Deposit Information		
Check Date	Check Number	Total
10/25/2002	20446	\$1,631.18
11/25/2002	21118	\$1,503.74
12/24/2002	21589	\$1,359.27
1/24/2003	23071	\$1,688.91
2/25/2003	23766	\$1,948.13
3/25/2003	24576	\$1,871.13
4/25/2003	25429	\$1,819.05
5/23/2003	26329	\$2,603.66
6/25/2003	26806	\$2,192.31
7/25/2003	27359	\$2,146.19
8/25/2003	28238	\$1,805.85
9/25/2003	28974	\$1,973.69
10/24/2003	29852	\$1,847.62
11/25/2003	30759	\$1,809.23
12/24/2003	31622	\$1,945.02
1/23/2004	33116	\$1,962.63
2/25/2004	33953	\$2,453.28
3/25/2004	34819	\$3,499.55
4/23/2004	35759	\$3,303.49
5/25/2004	36851	\$3,317.89
6/25/2004	37789	\$3,354.62
7/23/2004	38755	\$3,188.49
8/25/2004	39899	\$3,089.69
9/24/2004	41032	\$2,792.95
10/25/2004	42140	\$3,023.06
11/24/2004	43239	\$3,056.18
12/24/2004	44265	\$3,216.33
1/25/2005	45909	\$2,758.33
2/25/2005	46935	\$3,218.01
3/24/2005	48237	\$2,894.12
4/25/2005	49433	\$2,572.78
5/25/2005	50734	\$2,190.01
6/24/2005	51901	\$1,215.38
7/25/2005	52937	\$2,650.24
8/25/2005	54275	\$3,057.84
9/23/2005	55604	\$2,927.99
10/25/2005	56830	\$3,931.55
11/25/2005	58114	\$4,196.66
12/23/2005	59371	\$4,532.67
1/25/2006	61261	\$2,895.53
2/24/2006	62565	\$3,678.90
3/24/2006	63942	\$3,964.63
4/25/2006	65299	\$2,376.55
5/25/2006	66729	\$2,035.71
6/23/2006	67888	\$2,086.14
7/25/2006	69414	\$2,363.68
8/25/2006		\$2,200.10
9/25/2006		\$2,168.73
10/25/2006		\$2,530.41

Escrow Bank Data													Running Balance	Difference
Date	Escrow Royalty Deposits	Income	\$ Mrket Int	CDARS Int	Fees	Distributions	Corrections	Audit Costs	Gain/Loss	Royalty Bonus	Total Int. and Fees	Bank Balance		
10/31/2002	\$1,631.18	\$50.38				\$0.00					\$50.38	\$113,561.28	\$112,541.73	\$1,019.55
11/30/2002	\$1,503.74	\$55.74				\$0.00					\$55.74	\$115,120.76	\$114,101.21	\$1,019.55
12/31/2002	\$1,359.27	\$53.85				\$0.00					\$53.85	\$116,533.88	\$115,514.33	\$1,019.55
1/31/2003	\$1,668.91	\$26.83				\$0.00					\$26.83	\$118,249.62	\$117,230.07	\$1,019.55
2/28/2003	\$1,948.13	\$24.59				\$0.00					\$24.59	\$120,222.34	\$119,202.79	\$1,019.55
3/31/2003	\$1,871.13	\$12.69				\$0.00					\$12.69	\$122,106.16	\$121,086.61	\$1,019.55
4/30/2003	\$1,819.05	\$21.06				\$0.00					\$21.06	\$123,946.27	\$122,926.72	\$1,019.55
5/31/2003	\$2,603.66	\$14.62				\$0.00					\$14.62	\$126,564.55	\$125,545.00	\$1,019.55
6/30/2003	\$2,192.31	\$20.85				\$0.00					\$20.85	\$128,777.71	\$127,758.16	\$1,019.55
7/31/2003	\$2,146.19	\$12.74				\$0.00					\$12.74	\$130,936.64	\$129,917.09	\$1,019.55
8/31/2003	\$1,805.85	\$5.44				\$0.00					\$5.44	\$132,747.93	\$131,728.38	\$1,019.55
9/30/2003	\$1,973.69	\$4.84				\$0.00					\$4.84	\$134,726.46	\$133,706.91	\$1,019.55
10/31/2003	\$1,847.62	\$7.51				\$0.00					\$7.51	\$136,581.59	\$135,562.04	\$1,019.55
11/30/2003	\$1,809.23	\$11.76				\$0.00					\$11.76	\$138,402.58	\$137,383.03	\$1,019.55
12/31/2003	\$1,945.02	\$7.71				\$0.00					\$7.71	\$140,355.31	\$139,335.76	\$1,019.55
1/31/2004	\$1,962.63	\$14.45				\$0.00					\$14.45	\$142,332.39	\$141,312.84	\$1,019.55
2/28/2004	\$2,453.28	\$10.71				\$0.00					\$10.71	\$144,796.38	\$143,776.83	\$1,019.55
3/31/2004	\$3,499.55	\$6.51				\$0.00					\$6.51	\$148,302.44	\$147,282.89	\$1,019.55
4/30/2004	\$3,303.49	\$17.79				\$0.00					\$17.79	\$151,623.72	\$150,604.17	\$1,019.55
5/31/2004	\$3,317.89	\$17.89				\$0.00					\$17.89	\$154,959.50	\$153,939.95	\$1,019.55
6/30/2004	\$3,354.62	\$24.79				\$0.00					\$24.79	\$158,338.91	\$157,319.36	\$1,019.55
7/31/2004	\$3,188.49	\$33.43				\$0.00					\$33.43	\$161,560.83	\$160,541.28	\$1,019.55
8/31/2004	\$3,089.69	\$69.97				\$0.00					\$69.97	\$164,720.49	\$163,700.94	\$1,019.55
9/30/2004	\$2,792.95	\$83.18				\$0.00					\$83.18	\$167,596.62	\$166,577.07	\$1,019.55
10/31/2004	\$3,023.06	\$101.85				\$0.00					\$101.85	\$170,721.53	\$169,701.98	\$1,019.55
11/30/2004	\$3,056.18	\$133.16				\$0.00					\$133.16	\$173,910.87	\$172,891.32	\$1,019.55
12/31/2004	\$3,216.33	\$134.25				\$0.00					\$134.25	\$177,261.45	\$176,241.90	\$1,019.55
1/31/2005	\$2,758.33	\$185.96				\$0.00					\$185.96	\$180,205.74	\$179,186.19	\$1,019.55
2/28/2005	\$3,218.01	\$215.15				\$0.00					\$215.15	\$183,638.90	\$182,619.35	\$1,019.55
3/31/2005	\$2,894.12	\$212.83				\$0.00					\$212.83	\$186,745.85	\$185,726.30	\$1,019.55
4/30/2005	\$2,572.78	\$283.97				\$0.00					\$283.97	\$189,602.60	\$188,583.05	\$1,019.55
5/31/2005	\$2,190.01	\$303.55				\$0.00					\$303.55	\$192,096.16	\$191,076.61	\$1,019.55
6/30/2005	\$1,215.38	\$331.55				\$0.00					\$331.55	\$193,643.09	\$192,623.54	\$1,019.55
7/31/2005	\$2,650.24	\$338.21				\$0.00					\$338.21	\$196,631.54	\$195,611.99	\$1,019.55
8/31/2005	\$3,057.84	\$386.79				\$0.00					\$386.79	\$200,076.17	\$199,056.62	\$1,019.55
9/30/2005	\$2,927.99	\$422.24				\$0.00					\$422.24	\$203,426.40	\$202,406.85	\$1,019.55
10/31/2005	\$3,931.55	\$443.74				\$0.00					\$443.74	\$207,801.69	\$206,782.14	\$1,019.55
11/30/2005	\$4,196.66	\$465.12				\$0.00					\$465.12	\$212,463.47	\$211,443.92	\$1,019.55
12/31/2005	\$4,532.67	\$502.90				\$0.00					\$502.90	\$217,499.04	\$216,479.49	\$1,019.55
1/31/2006	\$2,895.53	\$570.71				\$0.00					\$570.71	\$220,965.28	\$219,945.73	\$1,019.55
2/28/2006	\$3,678.90	\$583.62				\$0.00					\$583.62	\$225,227.80	\$224,208.25	\$1,019.55
3/31/2006	\$3,964.63	\$605.63				\$0.00					\$605.63	\$229,798.06	\$228,778.51	\$1,019.55
4/30/2006	\$2,376.55	\$719.50				\$0.00					\$719.50	\$232,894.11	\$231,874.56	\$1,019.55
5/31/2006	\$2,035.71	\$700.09				\$0.00					\$700.09	\$235,629.91	\$234,610.36	\$1,019.55
6/30/2006	\$2,086.14	\$738.82				\$0.00					\$738.82	\$238,454.87	\$237,435.32	\$1,019.55
7/31/2006	\$2,363.68	\$746.05				\$0.00					\$746.05	\$241,564.60	\$240,545.05	\$1,019.55
8/31/2006	\$0.00	\$812.62				\$0.00					\$812.62	\$242,377.22	\$243,557.77	-\$1,180.55
											\$0.00		\$245,726.50	-\$245,726.50
10/31/2006	\$2,505.17	\$934.13				\$0.00					\$934.13	\$251,025.47	\$249,191.04	\$1,834.43

Exhibit J
Unit BUNE1 Escrow Account Reconciliation
VGOB 91-1119-0161

CNX Deposit Information		
Check Date	Check Number	Total
11/25/2006		\$2,228.83
12/25/2006		\$1,592.06
1/25/2007		\$3,578.59
2/25/2007		\$4,318.49
3/25/2007		\$3,158.74
4/5/2007		\$45.44
4/25/2007		\$4,240.85
5/25/2007		\$4,048.69
6/25/2007		\$3,545.77
7/25/2007		\$3,934.91
8/25/2007		\$3,829.85
9/25/2007		\$3,146.79
10/25/2007		\$2,873.33
11/25/2007		\$2,413.75
12/25/2007		\$3,053.07
1/25/2008		\$3,542.73
2/25/2008		\$4,314.24
3/25/2008		\$4,992.72
4/25/2008		\$3,982.28
5/25/2008		\$5,089.94
6/25/2008		\$4,275.20
7/25/2008		\$5,208.08
8/25/2008		\$8,079.75
9/25/2008		\$6,580.00
10/25/2008		\$4,569.78
11/25/2008		\$3,871.95
12/18/2008		\$118.55
12/25/2008		\$4,023.36
1/25/2009		\$3,171.64
2/25/2009		\$3,230.60
3/25/2009		\$2,799.68
4/25/2009		\$1,923.08
5/25/2009		\$1,818.66
6/25/2009		\$1,755.20
7/25/2009		\$79,643.94
8/25/2009		\$1,827.88
9/25/2009		\$2,079.48
10/25/2009		\$1,667.28
11/19/2009		\$1,273.42
12/18/2009		\$2,090.94
1/18/2010		\$2,194.89
2/22/2010		\$1,412.74
3/22/2010		\$3,439.05
4/20/2010		\$3,024.87
5/19/2010		\$2,753.47
6/21/2010		\$1,667.55
7/20/2010		\$2,195.77
8/20/2010		\$2,028.67

Escrow Bank Data														
Date	Escrow Royalty Deposits	Income	\$ Mrket Int	CDARS Int	Fees	Distributions	Corrections	Audit Costs	Gain/Loss	Royalty Bonus	Total Int. and Fees	Bank Balance	Running Balance	Difference
11/30/2006	\$2,200.20	\$967.98			-\$16.98	\$0.00					\$951.00	\$254,176.67	\$252,370.87	\$1,805.80
12/31/2006	\$1,592.06	\$986.84			-\$135.36	\$0.00					\$851.48	\$256,620.21	\$254,814.41	\$1,805.80
1/31/2007	\$3,520.16	\$938.02				\$0.00					\$938.02	\$261,078.39	\$259,331.02	\$1,747.37
2/28/2007	\$0.00	\$914.59				\$0.00					\$914.59	\$261,992.98	\$264,564.10	-\$2,571.12
3/31/2007	\$4,292.27	\$857.31				\$0.00					\$857.31	\$267,142.56	\$268,580.15	-\$1,437.59
4/30/2007	\$7,399.59	\$995.13				\$0.00					\$995.13	\$275,537.28	\$269,620.72	\$5,916.56
5/31/2007	\$4,094.13	\$939.12				\$0.00					\$0.00	\$273,861.57	\$273,861.57	-\$273,861.57
6/30/2007	\$0.00	\$993.41				\$0.00					\$939.12	\$280,570.53	\$278,849.38	\$1,721.15
7/31/2007	\$7,480.68	\$1,958.92				\$0.00					\$993.41	\$281,563.94	\$283,388.56	-\$1,824.62
8/31/2007	\$3,829.85	\$983.38				\$0.00					\$1,958.92	\$290,024.08	\$289,282.39	\$741.69
9/30/2007	\$3,146.79	\$1,578.39				\$0.00					\$983.38	\$294,837.31	\$294,095.62	\$741.69
10/31/2007	\$0.00	\$1,003.80				\$0.00					\$1,578.39	\$299,562.49	\$298,820.80	\$741.69
11/30/2007	\$5,287.08	\$1,047.48				\$0.00					\$1,003.80	\$300,566.29	\$302,697.93	-\$2,131.64
12/31/2007	\$3,053.07	\$976.41				\$0.00					\$1,047.48	\$306,900.85	\$306,159.16	\$741.69
1/31/2008	\$3,542.73	\$787.00				\$0.00					\$976.41	\$310,930.33	\$310,188.64	\$741.69
2/29/2008	\$4,314.24	\$676.26				\$0.00					\$787.00	\$315,260.06	\$314,518.37	\$741.69
3/31/2008	\$4,992.72	\$599.76				\$0.00					\$676.26	\$320,250.56	\$319,508.87	\$741.69
4/30/2008	\$3,982.28	\$456.11				\$0.00					\$599.76	\$325,843.04	\$325,101.35	\$741.69
5/31/2008	\$5,089.94	\$380.14				\$0.00					\$456.11	\$330,281.43	\$329,539.74	\$741.69
6/30/2008	\$4,275.20	\$383.88				\$0.00					\$380.14	\$335,751.51	\$335,009.82	\$741.69
7/31/2008	\$5,208.08	\$374.65				\$0.00					\$383.88	\$340,410.59	\$339,668.90	\$741.69
8/31/2008	\$8,079.75	\$484.79				\$0.00					\$374.65	\$345,993.32	\$345,251.63	\$741.69
9/30/2008	\$6,580.00	\$441.64				\$0.00					\$484.79	\$354,557.86	\$353,816.17	\$741.69
10/31/2008	\$4,569.78	\$361.00				\$0.00					\$441.64	\$361,579.50	\$360,837.81	\$741.69
11/30/2008	\$3,871.95	\$482.24				\$0.00					\$361.00	\$366,510.28	\$365,768.59	\$741.69
12/31/2008	\$4,023.36	\$197.03				\$0.00					\$482.24	\$370,864.47	\$370,122.78	\$741.69
1/1/2009	\$0.00	\$18.28				\$0.00					\$0.00	\$370,241.33	\$370,241.33	-\$370,241.33
2/28/2009	\$6,402.24	-\$34.04				\$0.00					\$197.03	\$375,084.86	\$374,461.72	\$623.14
3/31/2009	\$2,799.68	\$93.74				\$0.00					\$18.28	\$375,103.14	\$377,651.64	-\$2,548.50
4/30/2009	\$1,923.08	-\$60.42				\$0.00					-\$34.04	\$381,471.34	\$380,848.20	\$623.14
5/31/2009	\$1,818.66	-\$61.28				\$0.00					\$93.74	\$384,364.76	\$383,741.62	\$623.14
6/30/2009	\$1,755.20	-\$63.46				\$0.00					-\$60.42	\$386,227.42	\$385,604.28	\$623.14
7/31/2009	\$79,643.94	-\$66.78				\$0.00					-\$61.28	\$387,984.80	\$387,361.66	\$623.14
8/31/2009	\$1,827.88	-\$45.07				\$0.00					-\$63.46	\$389,676.54	\$389,053.40	\$623.14
9/30/2009	\$2,079.48	-\$31.92				\$0.00					-\$66.78	\$468,630.56	\$468,630.56	\$623.15
10/31/2009	\$1,667.28	-\$37.47				\$0.00					-\$45.07	\$471,036.52	\$470,413.37	\$623.15
11/30/2009	\$1,273.42	-\$35.16				\$0.00					-\$31.92	\$473,084.08	\$472,460.93	\$623.15
12/31/2009	\$2,090.94	-\$132.70				\$0.00					-\$37.47	\$474,713.89	\$474,090.74	\$623.15
1/1/2010	\$2,194.89	\$88.89				\$0.00					-\$35.16	\$475,952.15	\$475,329.00	\$623.15
2/1/2010	\$1,412.74	\$92.23				\$0.00					-\$132.70	\$477,910.39	\$477,287.24	\$623.15
3/1/2010	\$3,439.05	\$102.36				\$0.00					\$88.89	\$480,051.02	\$479,571.02	\$480.00
4/1/2010	\$3,024.87	\$106.47				\$0.00					\$53.60	\$481,517.36	\$481,037.36	\$480.00
5/1/2010	\$2,753.47	\$97.11				\$0.00					\$62.23	\$485,018.64	\$484,538.64	\$480.00
6/1/2010	\$1,667.55	\$100.86				\$0.00					\$66.05	\$488,109.56	\$487,629.56	\$480.00
7/1/2010	\$2,195.77		\$101.62	\$14.05	-\$41.02	\$0.00					\$56.43	\$490,919.46	\$490,439.46	\$480.00
8/1/2010	\$2,028.67		\$87.11	\$34.17	-\$41.21	\$0.00					\$371.11	\$492,215.90	\$491,735.90	\$480.00
											\$74.65	\$494,486.32	\$494,006.32	\$480.00
											\$80.07	\$496,595.06	\$496,115.06	\$480.00

Exhibit J
Unit BUNE1 Escrow Account Reconciliation
VGOB 91-1119-0161

CNX Deposit Information		
Check Date	Check Number	Total
06 Disbursement		-\$2,619.58
Interest & Fees		\$39,146.51
Grand Total		\$477,633.86
January 2017 First Bank and Trust balance		\$477,447.15
FB&T difference		-\$186.71

Escrow Bank Data												Running Balance	Difference
Date	Escrow Royalty Deposits	Income	\$ Mrket Int	CDARS Int	Fees	Distributions	Corrections	Audit Costs	Gain/Loss	Royalty Bonus	Total Int. and Fees		

SUPPLEMENTAL AFFIDAVIT OF MAILING—COAL OWNER

COMMONWEALTH OF VIRGINIA
COUNTY OF **BUCHANAN**

Applicant: CNX Gas Company LLC
Relief Sought: Disbursement/Dismissal for Unit **BUNE 1**
VGOB: 91-1119-0161-07

I, Anita D. Duty, being first duly sworn on oath, depose and say:

1. I am the Pooling Supervisor for CNX Land LLC, and I am authorized to submit this Affidavit on behalf of the Applicant CNX Gas Company LLC.

2. I affirm that the coal owner(s) in this Unit was properly noticed under Va. Code Ann. 45.1-361-22:2 on **November 6, 2015 & May 10, 2016**. See annexed Certificate of Notice and coal owner notice form letter example.

3. **Hugh McRae Land Trust, Chisos, LTD, Rockport Oil & Gas, and Gentry Locke** should be dismissed as Respondent/coal claimant for failure to timely provide evidence of a relevant proceeding or agreement.



Anita D. Duty
Pooling Supervisor
for CNX Land LLC

STATE OF VIRGINIA
COUNTY OF TAZEWELL, TO-WIT:

TAKEN, SUBSCRIBED AND SWORN to before me this 29th day of August, 2016.

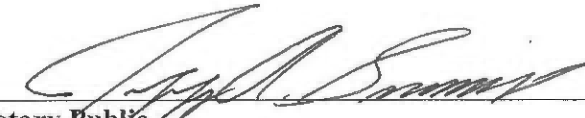

Notary Public
Commission ID 7215200

My commission expires: August 31, 2016

Commonwealth of Virginia
Jeffrey A. Simmons - Notary Public
Commission ID: 7215200
My Commission Expires 08/31/2016

SENDER: COMPLETE THIS SECTION	COMPLETE THIS SECTION ON DELIVERY	
<ul style="list-style-type: none"> Complete items 1, 2, and 3. Also complete item 4 if Restricted Delivery is desired. Print your name and address on the reverse so that we can return the card to you. Attach this card to the back of the mailpiece, or on the front if space permits. 	A. Signature <input checked="" type="checkbox"/> <i>Chet H5</i>	<input type="checkbox"/> Agent <input type="checkbox"/> Address
1. Article Addressed to: <i>Hugh Macrae PO BOX 834 Tazewell VA 24651</i>	B. Received by (Printed Name) <i>Chet H5</i>	C. Date of Delivery <i>11/9/15</i>
	D. Is delivery address different from item 1? <input type="checkbox"/> Yes if YES, enter delivery address below: <input type="checkbox"/> No	
	3. Service Type <input checked="" type="checkbox"/> Certified Mail <input type="checkbox"/> Express Mail <input type="checkbox"/> Registered <input type="checkbox"/> Return Receipt for Merchandise <input type="checkbox"/> Insured Mail <input type="checkbox"/> C.O.D.	
	4. Restricted Delivery? (Extra Fee) <input type="checkbox"/> Yes	
7009 1680 0001 0891 1298 <i>DD24/25 EE25</i>		
PS Form 3811, February 2004 Domestic Return Receipt <i>RWS</i> 10295-02-000-10		

SENDER: COMPLETE THIS SECTION	COMPLETE THIS SECTION ON DELIVERY	
<ul style="list-style-type: none"> Complete items 1, 2, and 3. Also complete item 4 if Restricted Delivery is desired. Print your name and address on the reverse so that we can return the card to you. Attach this card to the back of the mailpiece, or on the front if space permits. 	A. Signature <input checked="" type="checkbox"/> <i>Brian RCH</i>	<input type="checkbox"/> Agent <input type="checkbox"/> Address
1. Article Addressed to: <i>Chisols 670 Dona Ana Rd Deming Nm 88030</i>	B. Received by (Printed Name) <i>B. Jackson</i>	C. Date of Delivery <i>11/9/15</i>
	D. Is delivery address different from item 1? <input type="checkbox"/> Yes if YES, enter delivery address below: <input type="checkbox"/> No	
	3. Service Type <input checked="" type="checkbox"/> Certified Mail <input type="checkbox"/> Express Mail <input type="checkbox"/> Registered <input type="checkbox"/> Return Receipt for Merchandise <input type="checkbox"/> Insured Mail <input type="checkbox"/> C.O.D.	
	4. Restricted Delivery? (Extra Fee) <input type="checkbox"/> Yes	
7009 1680 0001 0891 1274 <i>DD24 DD25 EE25 RWS</i>		
PS Form 3811, February 2004 Domestic Return Receipt <i>EE25 RWS</i> 10295-02-000-10		

SENDER: COMPLETE THIS SECTION	COMPLETE THIS SECTION ON DELIVERY	
<ul style="list-style-type: none"> Complete items 1, 2, and 3. Also complete item 4 if Restricted Delivery is desired. Print your name and address on the reverse so that we can return the card to you. Attach this card to the back of the mailpiece, or on the front if space permits. 	A. Signature <input checked="" type="checkbox"/> <i>D. Kelly B...</i>	<input type="checkbox"/> Agent <input type="checkbox"/> Address
1. Article Addressed to: <i>Gentry Locke Attn: Kathy Wright PO BOX 40013 Roanoke VA 24022-0013</i>	B. Received by (Printed Name) <i>DEBRA B...</i>	C. Date of Delivery <i>11/9/15</i>
	D. Is delivery address different from item 1? <input type="checkbox"/> Yes if YES, enter delivery address below: <input type="checkbox"/> No	
	3. Service Type <input checked="" type="checkbox"/> Certified Mail <input type="checkbox"/> Express Mail <input type="checkbox"/> Registered <input type="checkbox"/> Return Receipt for Merchandise <input type="checkbox"/> Insured Mail <input type="checkbox"/> C.O.D.	
	4. Restricted Delivery? (Extra Fee) <input type="checkbox"/> Yes	
2 7009 1680 0001 0891 1281 <i>DD24/25 EE25 RWS</i>		
PS Form 3811, February 2004 Domestic Return Receipt <i>EE25 RWS</i> 10295-02-000-10		



USPS Tracking®

Still Have Questions?

[Browse our FAQs >](#)



[Get Easy Tracking Updates >](#)
Sign up for My USPS.

Tracking Number: 70091680000108910567

Product & Tracking Information

Postal Product:

Features:

Certified Mail™

Available Actions

DATE & TIME	STATUS OF ITEM	LOCATION
May 16, 2016 , 10:51 am	Delivered, PO Box	HOUSTON, TX 77210
Your item has been delivered and is available at a PO Box at 10:51 am on May 16, 2016 in HOUSTON, TX 77210.		
May 12, 2016 , 5:34 am	Arrived at USPS Facility	HOUSTON, TX 77210
May 12, 2016 , 4:34 am	Departed USPS Facility	NORTH HOUSTON, TX 77315
May 11, 2016 , 11:03 pm	Arrived at USPS Facility	NORTH HOUSTON, TX 77315
May 11, 2016 , 5:31 am	Departed USPS Facility	CHARLESTON, WV 25350
May 10, 2016 , 8:24 pm	Arrived at USPS Facility	CHARLESTON, WV 25350

Track Another Package

Tracking (or receipt) number

[Track It](#)

Manage Incoming Packages

Track all your packages from a dashboard. No tracking numbers necessary.

[Sign up for My USPS >](#)



CERTIFICATION OF NOTICE
CNX Gas Company LLC

Unit BUNE1
VGOB 91-1119-0161-07
Coal Owner dismissal

Last Name	First Name	MAILED	RECEIPT #	Received	
Hugh Macrae Land Trust(Coal Owner)		11/6/2015	7009168000010891	1274	11/9/2015
Chisos, LTD		11/6/2015	7009168000010891	1281	11/10/2015
Gentry Locke		11/6/2015	7009168000010891	1298	11/9/2015
Rockport Oil & Gas		5/10/2016	7009168000010891	0567	5/18/2016



Date _____

«FNAME» «LNAME»
«Attention_Line»
«Street_Address»
«City»«State»«Zip»
COAL OWNERS

RE: Unit _____
Miscellaneous Petition for Disbursement from Escrow

Dear Property Owner,

House Bill 2058 was signed by the Governor and became law effective July 1, 2015. This new law requires the Virginia Gas and Oil Board to disburse monies placed in escrow because of conflicting claims (between coal owners and oil and gas owners) to coalbed methane gas royalties to the oil and gas owners of the tracts in this Unit.

In general, under this new law escrowed funds are to be paid to oil and gas owners unless the coal owner(s) provides the operator CNX and the Division of Gas and Oil "with evidence of a proceeding" [as in a court case] "or an agreement." The new law gives coal owners/coal claimants 45 days from the date you get this letter to provide that evidence.

Enclosed herewith please find a copy of the 45 day Notice of Filing. Please read the Notice carefully to be sure you understand that you have 45 days to provide evidence to the operator CNX Gas Company LLC at the address above **and** the Division of Gas and Oil at PO Draw 159, Lebanon, VA 24266

In order to help us keep our records current and to make sure you receive all correspondence and notices promptly, please notify us of any address change at the address above.

Sincerely,

Anita Duty
Pooling Supervisor

Enclosure(s)