

BEFORE THE VIRGINIA GAS AND OIL BOARD

PETITIONER: CNX Gas Company LLC

DIVISION OF GAS AND OIL

DOCKET NO: VGOB 93-0622-0380-01

RELIEF SOUGHT: (1) DISBURSEMENT FROM ESCROW REGARDING TRACT(S) A portion of 3 (2) AND AUTHORIZATION FOR DIRECT PAYMENT OF ROYALTIES (3) AND DISMISSAL OF COAL OWNERS PURSUANT TO CODE OF VIRGINIA SECTION 45.1-361.22:2.

HEARING DATE: October 18, 2016

DRILLING UNIT: U15

BUCHANAN COUNTY, VIRGINIA

PETITION FOR ORDER OF DISBURSEMENT OF ESCROW FUNDS

1. Petitioner and its counsel

Petitioner is CNX Gas Company LLC, PO Box 570, Pounding Mill, VA 24637, (276)596-5075. Petitioner's counsel is Mark A. Swartz, Hillard & Swartz, LLP, 122 Capital Street, Suite 201, Charleston, WV 25301.

2. Relief Sought

1) the disbursement of escrowed funds heretofore deposited with the Board's Escrow Agent, attributable to a portion of Tract 3, as depicted upon the annexed table; and (2) authorization to begin paying royalties directly to H-W Financial, LLC (previously Harrison-Wyatt LLC), CNX Gas Company LLC, Joyce Hawkins Jones, Charles Hawkins, Phyllis Everett McKeon, Louise Agee; (3) Dismissal of Coal Owner(s): H-W Financial, LLC. (Royalties currently being paid under VP8SGU3, Docket #VGOB 06-0321-1598)

3. Legal Authority

Va. Code Ann. § 45.1-361.1 et seq., 4 VAC 25-160-140., and relevant Virginia Gas and Oil Board Orders ("Board") heretofore promulgated pursuant to law.

4. Type of Well(s)

Coalbed Methane

5. Factual basis for relief requested

- a. H-W Financial, LLC and CNX Gas Company LLC have entered into royalty split agreement(s). Said royalty split agreement(s) allow the Applicant and Designated Operator to pay royalties directly to the persons identified in Exhibit EE.
- b. Joyce Hawkins Jones, Charles Hawkins, Phyllis Everett McKeon, Louise Agee is the gas claimants in Tract 3 As such, is entitled to 100% of the CBM royalties now in escrow and as may be hereafter payable. See Va. Code Ann. § 45.1-361.22:2.A.
- c. That CNX Gas Company LLC has given the notice(s) required by § 45.1-361.22:2.A to all conflicting claimants identified in the above referenced pooling Order and any supplemental Orders pertaining thereto.
- d. That none of the conflicting claimants noticed have provided, within 45 days of the notice(s) given as provided in b. above, the Board, its designated agent the Director of the Division of Gas and Oil, the Operator and/or the Applicant evidence of either an agreement regarding the escrowed funds/royalties or a proceeding regarding same.
- e. That a detailed accounting in accordance with the applicable provisions of § 45.1-361.22 is submitted herewith and identified as Exhibit J.
- f. That an Exhibit identified as Table 1 is annexed hereto, and it specifies how the disbursement (s) is to be calculated and paid by the escrow agent.
- g. That Va. Code Ann. § 45.1-361.22:2.A. further provides that the Operator shall pay such royalties as may hereafter be payable directly to the gas claimant H-W Financial, LLC (previously Harrison-Wyatt LLC), CNX Gas Company LLC, Joyce Hawkins Jones, Charles Hawkins, Phyllis Everett McKeon, Louise Agee and not escrow same. See Exhibit EE annexed hereto.

6. Attestation

The foregoing Petition to the best of my knowledge, information, and belief is true and correct.



BEARING BASIS
ISLAND CRK.
VP 6 EAST
STATE PLANE
COORDINATE SYSTEMS

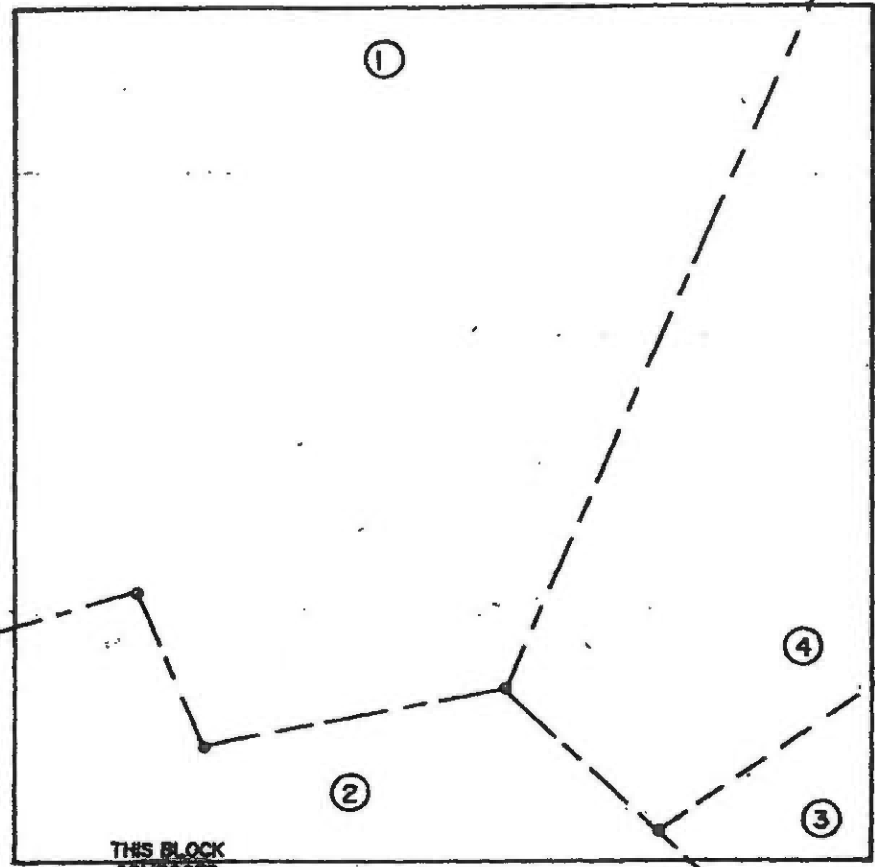

THIS BLOCK
COMPOSED
OF 80 acs.

Exhibit "A"
VGOB-93-06-22-0380

WELL LOCATION PLAT

COMPANY OXY USA INC. WELL NAME and No. UNIT U15
 TRACT No. NA ELEVATION NA QUADRANGLE VANSANT
 COUNTY BUCHANAN DISTRICT SOUTH GRUND SCALE: 1"=400' DATE 11/2/92

THIS PLAT IS A NEW PLAT X; AN UPDATED PLAT _____; OR A SERIAL LOCATION PLAT _____

+ DENOTES THE LOCATION OF A WELL ON UNITED STATES TOPOGRAPHIC MAPS, SCALE 1 TO 24,000, LATITUDE AND LONGITUDE LINES BEING REPRESENTED BY BORDER LINES AS SHOWN.

HC Van Meter

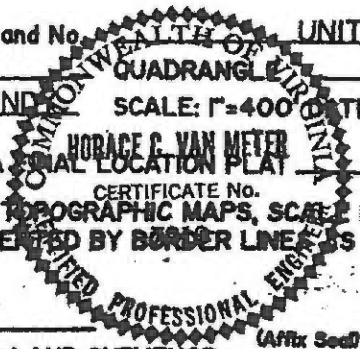

LICENSED PROFESSIONAL ENGINEER OR LICENSED LAND SURVEYOR

Exhibit B
Unit U-15/B
Docket # VGOB-93-0622-0380-01
List of all Owners/Claimants

	Acres in Unit	Percent of Unit	Division of Interest in	
			1 East 15.4930%	2 East 26.8990%
I. COAL OWNERSHIP				
		100.0000%	15.4930%	26.8990%
<u>Tract #1, 43.80 Acres</u>				
(1) H-W Financial, LLC, Big Axe Tr.3 P.O. Box 11000 Danville, VA 24543	43.80 acres	54.7500%	8.48242%	14.72720%
<u>Tract #2, 12.39 Acres</u>				
(1) H-W Financial, LLC, Big Axe Tr.7 P.O. Box 11000 Danville, VA 24543	12.39 acres	15.4875%	2.39948%	4.16598%
<u>Tract #3, 7.49 Acres</u>				
(1) H-W Financial, LLC, Big Axe Tr.4 P.O. Box 11000 Danville, VA 24543	7.49 acres	9.3625%	1.45053% -50%	2.51842%
<u>Tract #4, 16.32 Acres</u>				
(1) H-W Financial, LLC, Big Axe Tr.4 P.O. Box 11000 Danville, VA 24543	16.32 acres	20.4000%	3.16057%	5.48740%
II. OIL & GAS OWNERSHIP				
		100.0000%	15.4930%	26.8990%
<u>Tract #1, 43.80 Acres</u>				
(1) H-W Financial, LLC, Big Axe Tr.3 P.O. Box 11000 Danville, VA 24543	43.80 acres	54.7500%	8.48242%	14.72720%
<u>Tract #2, 12.39 Acres</u>				
(1) H-W Financial, LLC, Big Axe Tr.7 P.O. Box 11000 Danville, VA 24543	12.39 acres	15.4875%	2.39948%	4.16598%
<u>Tract #3, 7.49 Acres</u>				
(1) Jessie Childress Heirs, et al. <i>(33.34 Acre Tract)</i>	7.49 acres	9.3625%	1.45053%	2.51842%
(a) Virginia H. Childress			<i>Conveyed to BPC 10/21/94 DB 429/385</i>	
(b) Nellie Fay Couch			<i>Conveyed to BPC 9/27/94 DB 428/429</i>	
(b.1) Buchanan Production Company			<i>Merger with CNX Gas Co LLC 3/31/03 DB 617/576</i>	
(b.1.1) CNX Gas Company LLC PO Box 643830 Pittsburgh, PA 15264-3830 <i>(previously Buchanan Production Company)</i>	0.511 acres 3/44 of 7.49 acres	0.6384%	0.09890% -50%	0.17171%
(c) Eula Childress Hensdill			<i>Conveyed to BPC 10/3/94 DB 428/431</i>	
(c.1) Buchanan Production Company			<i>Merger with CNX Gas Co LLC 3/31/03 DB 617/576</i>	

Exhibit B
Unit U-15/B
Docket # VGOB-93-0622-0380-01
List of all Owners/Claimants

		Acres in Unit	Percent of Unit	Division of Interest in	
				1 East 15.4930%	2 East 26.8990%
(c.1.1)	CNX Gas Company LLC PO Box 643830 Pittsburgh, PA 15264-3830 <i>(previously Buchanan Production Company)</i>	0.511 acres 3/44 of 7.49 acres	0.6384%	0.09890% -50%	0.17171%
(d)	Madeline Childress Tucker	<i>Conveyed to BPC 10/14/94 DB 429/389</i>			
(d.1)	Buchanan Production Company	<i>Merger with CNX Gas Co LLC 3/31/03 DB 617/576</i>			
(d.1.1)	CNX Gas Company LLC PO Box 643830 Pittsburgh, PA 15264-3830 <i>(previously Buchanan Production Company)</i>	0.511 acres 3/44 of 7.49 acres	0.6384%	0.09890% -50%	0.17171%
(e)	Eleanor Hankins Heirs, Devisees, Successors or Assigns				
(e.1)	Robert B. Hawkins, Jr., Heirs, Devisees, Successors or Assigns				
W9/Affidavit not received					
(e.1.1)	Elvetta Wood Hawkins 5843 Fairhill Ln Knoxville, TN 37918	0.170 acres 1/44 of 7.49 acres	0.2128%	0.03297%	0.05724%
(e.1.2)	Joyce Hawkins Jones 840 Fairview School Rd Blountville, TN 37617	0.170 acres 1/44 of 7.49 acres	0.2128%	0.03297%	0.05724%
(e.1.3)	Charles Hawkins 343 Glasgow Ln Blountville, TN 37617	0.170 acres 1/44 of 7.49 acres	0.2128%	0.03297%	0.05724%
(f)	Wanda Childress Cochran	<i>Conveyed to Virginia H. Childress 10/11/94 DB 429/381</i>			
(f.1)	Virginia H. Childress	<i>Conveyed to BPC 10/11/94 DB 429/385</i>			
(f.1.1)	Buchanan Production Company	<i>Merger with CNX Gas Co LLC 3/31/03 DB 617/576</i>			
(f.1.1.1)	CNX Gas Company LLC PO Box 643830 Pittsburgh, PA 15264-3830 <i>(previously Buchanan Production Company)</i>	0.511 acres 3/44 of 7.49 acres	0.6384%	0.09890% -50%	0.17171%
(g)	Edith Virginia Presnell	<i>Conveyed to BPC 10/24/94 DB 429/391</i>			
(g.1)	Buchanan Production Company	<i>Merger with CNX Gas Co LLC 3/31/03 DB 617/576</i>			
(g.1.1)	CNX Gas Company LLC PO Box 643830 Pittsburgh, PA 15264-3830 <i>(previously Buchanan Production Company)</i>	0.511 acres 3/44 of 7.49 acres	0.6384%	0.09890% -50%	0.17171%
(h)	Phyllis Everett McKeon 4472 Dike Road Winter Park, FL 32792	0.511 acres 3/44 of 7.49 acres	0.6384%	0.09890%	0.17171%
(i)	Beatrice Childress Raleigh	<i>Conveyed to BPC 9/29/94 DB 428/433</i>			
(i.1)	Buchanan Production Company	<i>Merger with CNX Gas Co LLC 3/31/03 DB 617/576</i>			

Exhibit B
Unit U-15/B
Docket # VGOB-93-0622-0380-01
List of all Owners/Claimants

		Acres in Unit	Percent of Unit	Division of Interest in	
				1 East 15.4930%	2 East 26.8990%
(i.1.1)	CNX Gas Company LLC PO Box 643830 Pittsburgh, PA 15264-3830 <i>(previously Buchanan Production Company)</i>	0.511 acres 3/44 of 7.49 acres	0.6384%	0.09890% -50%	0.17171%
(j)	Carl C. Childress	<i>Conveyed to BPC 9/29/94 DB 428/433</i>			
(j.1)	Buchanan Production Company	<i>Merger with CNX Gas Co LLC 3/31/03 DB 617/576</i>			
(j.1.1)	CNX Gas Company LLC PO Box 643830 Pittsburgh, PA 15264-3830 <i>(previously Buchanan Production Company)</i>	0.511 acres 3/44 of 7.49 acres	0.6384%	0.09890% -50%	0.17171%
(k)	Emory Childress	<i>Conveyed to Virginia H. Childress 10/11/94 DB 429/381</i>			
(k.1)	Virginia H. Childress	<i>Conveyed to BPC 10/11/94 DB 429/385</i>			
(k.1.1)	Buchanan Production Company	<i>Merger with CNX Gas Co LLC 3/31/03 DB 617/576</i>			
(k.1.1.1)	CNX Gas Company LLC PO Box 643830 Pittsburgh, PA 15264-3830 <i>(previously Buchanan Production Company)</i>	0.511 acres 3/44 of 7.49 acres	0.6384%	0.09890% -50%	0.17171%
(l)	Pinkie Edna Kitts Heirs, Devises, Successors or Assigns				
(l.1)	Verna Taylor	<i>Conveyed to BPC 10/21/94 DB 430/26</i>			
(l.1.1)	Buchanan Production Company	<i>Merger with CNX Gas Co LLC 3/31/03 DB 617/576</i>			
(l.1.1.1)	CNX Gas Company LLC PO Box 643830 Pittsburgh, PA 15264-3830 <i>(previously Buchanan Production Company)</i>	0.102 acres 3/220 of 7.49 acres	0.1277%	0.01978% -50%	0.03434%
(l.2)	Louise Agee 7601 Bull Run Road Manassas, VA 22110	0.102 acres 3/220 of 7.49 acres	0.1277%	0.01978%	0.03434%
(l.3)	Straley D. Kitts	<i>Conveyed to BPC 10/6/94 DB 428/437</i>			
(l.3.1)	Buchanan Production Company	<i>Merger with CNX Gas Co LLC 3/31/03 DB 617/576</i>			
(l.3.1.1)	CNX Gas Company LLC PO Box 643830 Pittsburgh, PA 15264-3830 <i>(previously Buchanan Production Company)</i>	0.102 acres 3/220 of 7.49 acres	0.1277%	0.01978% -50%	0.03434%
(l.4)	R. Warren Kitts	<i>Conveyed to BPC 10/6/94 DB 428/435</i>			
(l.4.1)	Buchanan Production Company	<i>Merger with CNX Gas Co LLC 3/31/03 DB 617/576</i>			
(l.4.1.1)	CNX Gas Company LLC PO Box 643830 Pittsburgh, PA 15264-3830 <i>(previously Buchanan Production Company)</i>	0.102 acres 3/220 of 7.49 acres	0.1277%	0.01978% -50%	0.03434%
(l.5)	George Wendell Kitts	<i>Conveyed to BPC 10/6/94 DB 429/387</i>			
(l.5.1)	Buchanan Production Company	<i>Merger with CNX Gas Co LLC 3/31/03 DB 617/576</i>			

Exhibit B
Unit U-15/B
Docket # VGOB-93-0622-0380-01
List of all Owners/Claimants

	Acres in Unit	Percent of Unit	Division of Interest in	
			1 East 15.4930%	2 East 26.8990%
(I.5.1.1) CNX Gas Company LLC PO Box 643830 Pittsburgh, PA 15264-3830 <i>(previously Buchanan Production Company)</i>	0.102 acres 3/220 of 7.49 acres	0.1277%	0.01978% -50%	0.03434%
(c) CNX Gas Company LLC PO Box 643830 Pittsburgh, PA 15264-3830 <i>(previously Buchanan Production Company)</i>	1.873 acres 1/4 of 7.49 acres	2.3406%	0.36263% -50%	0.62960%
<u>Tract #4, 16.32 Acres</u>				
<i>Unresolved Heirship</i>				
Vicey McGlothlin Heirs, Devisees, Successors or Assigns, et al.	16.32 acres	20.4000%	3.16057%	5.48740%
(1) Julia McGlothlin Jackson Heirs, Devisees, Successors or Assigns (1/13)				
(a) Bessie J. Hammonds, Heirs, Devisees, Successors or Assigns <i>Heirs/Addresses Unknown</i>	0.1255 acres 1/130 of 16.32 acres	0.1569%	0.02431%	0.04221%
(b) Myrtle Jackson Hale Heirs, Devisees, Successors or Assigns <i>Heirs/Addresses Unknown</i>	0.1255 acres 1/130 of 16.32 acres	0.1569%	0.02431%	0.04221%
(c) Carlous Jackson 1606 Old Vandyke Hollow Rd. Oakwood, VA 24631	0.0418 acres 1/390 of 16.32 acres	0.0523%	0.00810%	0.01407%
(d) Dallas Jackson 1606 Old Vandyke Hollow Rd. Oakwood, VA 24631	0.0418 acres 1/390 of 16.32 acres	0.0523%	0.00810%	0.01407%
(e) Patsy Ruth Coleman 1061 Conn Street Imperial Beach, CA 92032	0.0418 acres 1/390 of 16.32 acres	0.0523%	0.00810%	0.01407%
(f) Gracie Jackson Hale Rt. 1, Box 68-A Swords Creek, VA 24649	0.1255 acres 1/130 of 16.32 acres	0.1569%	0.02431%	0.04221%
(g) Lydia Jackson, Heirs, Devisees, Successors or Assigns <i>Heirs/Addresses Unknown</i>	0.1255 acres 1/130 of 16.32 acres	0.1569%	0.02431%	0.04221%
(h) Curtis Jackson, Heirs, Devisees, Successors or Assigns <i>Heirs/Addresses Unknown</i>	0.1255 acres 1/130 of 16.32 acres	0.1569%	0.02431%	0.04221%
(i) Ardella Jackson, Heirs, Devisees, Successors or Assigns <i>Heirs/Addresses Unknown</i>	0.1255 acres 1/130 of 16.32 acres	0.1569%	0.02431%	0.04221%
(j) Ocie Robinson, Heirs, Devisees, Successors or Assigns <i>Heirs/Addresses Unknown</i>	0.1255 acres 1/130 of 16.32 acres	0.1569%	0.02431%	0.04221%
(k) Jeff Jackson, Heirs, Devisees, Successors or Assigns <i>Heirs/Addresses Unknown</i>	0.1255 acres 1/130 of 16.32 acres	0.1569%	0.02431%	0.04221%

Exhibit B
Unit U-15/B
Docket # VGOB-93-0622-0380-01
List of all Owners/Claimants

	Acres in Unit	Percent of Unit	Division of Interest in	
			1 East 15.4930%	2 East 26.8990%
(l) Mary Jackson Justus, Heirs, Devisees, Successors or Assigns <i>Heirs/Addresses Unknown</i>	0.1255 acres 1/130 of 16.32 acres	0.1569%	0.02431%	0.04221%
(2) Virgie Dotson Heirs, Devisees, Successors or Assigns (1/26)				
(a) Edward Dotson Rt. 1 Box 85 Vansant, VA 24656	0.1569 acres 1/104 of 16.32 acres	0.1962%	0.03039%	0.05276%
(b) Joyce Owens P. O. Box 214 Vansant, VA 24656	0.1569 acres 1/104 of 16.32 acres	0.1962%	0.03039%	0.05276%
(c) James Dotson 24916 South Levisa Road Mouthcard, KY 41548	0.1569 acres 1/104 of 16.32 acres	0.1962%	0.03039%	0.05276%
(d) Geraldine Ratliff 1046 Parkside Drive Georgetown, KY 40324	0.1569 acres 1/104 of 16.32 acres	0.1962%	0.03039%	0.05276%
(3) Edd Looney Rt. 1, Box 74 Vansant, VA 24656	0.6277 acres 1/26 of 16.32 acres	0.7846%	0.12156%	0.21105%
(4) Kay Childress 103 1/2 Luther Street Bluefield, VA 24605	0.0251 acres 1/650 of 16.32 acres	0.0314%	0.00486%	0.00844%
(5) Ancil Childress Box 216 Rowe, VA 24646	0.0251 acres 1/650 of 16.32 acres	0.0314%	0.00486%	0.00844%
(6) L.C. Childress Heirs, Devisees, Successors or Assigns (1/650)				
(a) Annette Childress P.O. Box 301 Honaker, VA 24260	0.0084 acres 1/1950 of 16.32 acres	0.0105%	0.00162%	0.00281%
(b) Denise & Ron Blankenship P.O. Box 301 Honaker, VA 24260	0.0056 acres 1/2925 of 16.32 acres	0.0070%	0.00108%	0.00188%
(c) Karen & Richard Bostic P.O. Box 373 Swords Creek, VA 24649	0.0056 acres 1/2925 of 16.32 acres	0.0070%	0.00108%	0.00188%
(d) Deborah & Berk Artrip 277 Friendship Dr. Swords Creek, VA 24649	0.0056 acres 1/2925 of 16.32 acres	0.0070%	0.00108%	0.00188%
(7) Janice Hodock Rt. 2 Box 227 Bluefield, VA 24605	0.0251 acres 1/650 of 16.32 acres	0.0314%	0.00486%	0.00844%
(8) James H. Childress Rt. 1 Box 263-A Honaker, VA 24260	0.0251 acres 1/650 of 16.32 acres	0.0314%	0.00486%	0.00844%

Exhibit B
Unit U-15/B
Docket # VGOB-93-0622-0380-01
List of all Owners/Claimants

	Acres in Unit	Percent of Unit	Division of Interest in	
			1 East 15.4930%	2 East 26.8990%
(9) Lillie C. Bailey, Heirs, Devisees, Successors or Assigns <i>Heirs/Addresses Unknown</i>	0.1255 acres 1/130 of 16.32 acres	0.1569%	0.02431%	0.04221%
(10) John B. Childress Heirs, Devisees, Successors or Assigns (9/1300)				
(a) Reves Childress Box 410-L Kelly Road Gainesville, VA 22065	0.0126 acres 1/1300 of 16.32 acres	0.0157%	0.00243%	0.00422%
(b) Gertrude Mudiman 8503 Thomas Drive Manassas, VA 22110	0.0126 acres 1/1300 of 16.32 acres	0.0157%	0.00243%	0.00422%
(c) Robert E. Childress Rt. 1 Box 553-A Elkton, VA 22827	0.0126 acres 1/1300 of 16.32 acres	0.0157%	0.00243%	0.00422%
(d) Madilee Wnek 8006 Rugby Road Manassas, VA 22111	0.0126 acres 1/1300 of 16.32 acres	0.0157%	0.00243%	0.00422%
(e) Arbutus Childress c/o Madilee Wnek 8006 Rugby Road Manassas, VA 22111	0.0126 acres 1/1300 of 16.32 acres	0.0157%	0.00243%	0.00422%
(f) John R. Childress 16000 Laconia Circle Woodbridge, VA 22191	0.0126 acres 1/1300 of 16.32 acres	0.0157%	0.00243%	0.00422%
(g) Donald R. Childress 826 Glades Court NE St. Petersburg, FL 33702	0.0126 acres 1/1300 of 16.32 acres	0.0157%	0.00243%	0.00422%
(h) Zed L. Childress 13989 Dancing Twig Drive Gainesville, VA 22065	0.0126 acres 1/1300 of 16.32 acres	0.0157%	0.00243%	0.00422%
(i) Diane Blair P.O. Box 1733 Haines City, FL 33844	0.0126 acres 1/1300 of 16.32 acres	0.0157%	0.00243%	0.00422%
(11) Fayrene Childress Heirs, Devisees, Successors or Assigns (1/1300)				
(a) Michael Clayborn 823 East 6th Street Front Royal, VA 22630	0.0021 acres 1/7800 of 16.32 acres	0.0026%	0.00041%	0.00070%
(b) Steven Clayborn 10260 Battle Field Drive Manassas, VA 22110	0.0021 acres 1/7800 of 16.32 acres	0.0026%	0.00041%	0.00070%
(c) Timothy Clayborn 8103 Maplewood Manassas, VA 22111	0.0021 acres 1/7800 of 16.32 acres	0.0026%	0.00041%	0.00070%
(d) Jeffery Clayborn c/o Timothy Clayborn 8103 Maplewood Manassas, VA 22111	0.0021 acres 1/7800 of 16.32 acres	0.0026%	0.00041%	0.00070%

Exhibit B
Unit U-15/B
Docket # VGOB-93-0622-0380-01
List of all Owners/Claimants

	Acres in Unit	Percent of Unit	Division of Interest in	
			1 East 15.4930%	2 East 26.8990%
(e) Anthony Clayborn c/o Timothy Clayborn 8103 Maplewood Manassas, VA 22111	0.0021 acres 1/7800 of 16.32 acres	0.0026%	0.00041%	0.00070%
(f) Regina Fay Smith 10316 Trundle Place Manassas, VA 22110	0.0021 acres 1/7800 of 16.32 acres	0.0026%	0.00041%	0.00070%
(12) Vida C. Murphy, Heirs, Devisees, Successors or Assigns <i>Heirs/Addresses Unknown</i>	0.1255 acres 1/130 of 16.32 acres	0.1569%	0.02431%	0.04221%
(13) Julia C. Lowe Heirs, Devisees, Successors or Assigns (1/130)				
(a) Ira Lowe Rt. 2 Box 506 Honaker, VA 24260	0.0139 acres 1/1170 of 16.32 acres	0.0174%	0.00270%	0.00469%
(b) Lucille Blankenship Box 107A Rowe, VA 24646	0.0139 acres 1/1170 of 16.32 acres	0.0174%	0.00270%	0.00469%
(c) Sue Meade Rt. 2 Box 515 Honaker, VA 24260	0.0139 acres 1/1170 of 16.32 acres	0.0174%	0.00270%	0.00469%
(d) Helen Wyatt Box 2, Russell Street North Wilkesboro, NC	0.0139 acres 1/1170 of 16.32 acres	0.0174%	0.00270%	0.00469%
(e) Fred Lowe Rt. 2 Box 506 Honaker, VA 24260	0.0139 acres 1/1170 of 16.32 acres	0.0174%	0.00270%	0.00469%
(f) James Bill & Nancy Lowe 835 Martinsburg Rd. Mt. Vernon, OH	0.0139 acres 1/1170 of 16.32 acres	0.0174%	0.00270%	0.00469%
(g) Paul Lowe Rt. 2 Honaker, VA 24260	0.0139 acres 1/1170 of 16.32 acres	0.0174%	0.00270%	0.00469%
(h) Henry Lowe Box 2, Russell Street North Wilkesboro, NC	0.0139 acres 1/1170 of 16.32 acres	0.0174%	0.00270%	0.00469%
(i) Arbutus Smith <i>Address Unknown</i> Whitesville, WV	0.0139 acres 1/1170 of 16.32 acres	0.0174%	0.00270%	0.00469%
(14) Farley Childress P.O. Box 72 Rowe, VA 24642	0.1255 acres 1/130 of 16.32 acres	0.1569%	0.02431%	0.04221%
(15) Ronkeith Childress, Heirs, Devisees, Successors or Assigns <i>Heirs/Addresses Unknown</i>	0.1255 acres 1/130 of 16.32 acres	0.1569%	0.02431%	0.04221%
(16) Allen Childress 127 Manassas Drive Manassas Park, VA 22111	0.1255 acres 1/130 of 16.32 acres	0.1569%	0.02431%	0.04221%

Exhibit B
Unit U-15/B
Docket # VGOB-93-0622-0380-01
List of all Owners/Claimants

	Acres in Unit	Percent of Unit	Division of Interest in	
			1 East 15.4930%	2 East 26.8990%
(17) Lottie Childress Fields Heirs, Devisees, Successors or Assigns (1/130)				
(a) Otis Fields Heirs, Devisees, Successors or Assigns (1/260)				
(a.1) Otis John Fields 938 Miller Creek Rd. Rowe, VA 24646	0.0057 acres 1/2860 of 16.32 acres	0.0071%	0.00111%	0.00192%
(a.2) Patricia L. Hurt PO Box 1380 Honaker, VA 24260	0.0057 acres 1/2860 of 16.32 acres	0.0071%	0.00111%	0.00192%
(a.3) Lottie Randolph 8271 Hidden Valley Rd. Abingdon, VA 24210	0.0057 acres 1/2860 of 16.32 acres	0.0071%	0.00111%	0.00192%
(a.4) Barbara Sue Adams 2684 Huff Hill Rd. Hillsville, VA 24343	0.0057 acres 1/2860 of 16.32 acres	0.0071%	0.00111%	0.00192%
(a.5) Evelyn Marie Nygaard 166 Dahoon Dr. Wytheville, VA 24382	0.0057 acres 1/2860 of 16.32 acres	0.0071%	0.00111%	0.00192%
(a.6) Hazel Goad 904 Blue Ridge Dr. Blue Ridge, VA 24646	0.0057 acres 1/2860 of 16.32 acres	0.0071%	0.00111%	0.00192%
(a.7) Robert C. Fields 1066 Miller Creek Rd. Rowe, VA 24646	0.0057 acres 1/2860 of 16.32 acres	0.0071%	0.00111%	0.00192%
(a.8) Virginia Austin <i>Address Unknown</i>	0.0057 acres 1/2860 of 16.32 acres	0.0071%	0.00111%	0.00192%
(a.9) Ronald J. Fields Heirs, Devisees, Successors or Assigns <i>Heirs/Addresses Unknown</i>	0.0057 acres 1/2860 of 16.32 acres	0.0071%	0.00111%	0.00192%
(a.10) Janet Fields <i>Address Unknown</i>	0.0057 acres 1/2860 of 16.32 acres	0.0071%	0.00111%	0.00192%
(a.11) Jenkie Fields <i>Address Unknown</i>	0.0057 acres 1/2860 of 16.32 acres	0.0071%	0.00111%	0.00192%
(b) Hazel Keen, Heirs, Devisees, Successors or Assigns <i>Heirs/Addresses Unknown</i>	0.0628 acres 1/260 of 16.32 acres	0.0785%	0.01216%	0.02111%
(18) Louise Childress Hughes Heirs, Devisees, Successors or Assigns (1/130)				
(a) Alice Coleman P.O. Box 945 Abingdon, VA 24210	0.0314 acres 1/520 of 16.32 acres	0.0392%	0.00608%	0.01055%
(b) Lee Hughes P.O. Box 444 Doran, VA 24612-0444	0.0314 acres 1/520 of 16.32 acres	0.0392%	0.00608%	0.01055%

Exhibit B
Unit U-15/B
Docket # VGOB-93-0622-0380-01
List of all Owners/Claimants

	Acres in Unit	Percent of Unit	Division of Interest in	
			1 East 15.4930%	2 East 26.8990%
(c) Thurman Hughes 4612 New Garden St. Portsmouth, OH 45662	0.0314 acres 1/520 of 16.32 acres	0.0392%	0.00608%	0.01055%
(d) Gary Hughes Rt. 1 Box 263 Grundy, VA 24614	0.0314 acres 1/520 of 16.32 acres	0.0392%	0.00608%	0.01055%
(19) Raymond Guy & Barbara J. Boyd Box 541 Honaker, VA 24260	0.0131 acres 1/1248 of 16.32 acres	0.0163%	0.00253%	0.00440%
(20) Wanda Lee Boyd Rt. 1 Box 300-A Vansant, VA 24656	0.0131 acres 1/1248 of 16.32 acres	0.0163%	0.00253%	0.00440%
(21) Tivis Boyd, Jr. Rt. 1 Box 330-A Vansant, VA 24656	0.0131 acres 1/1248 of 16.32 acres	0.0163%	0.00253%	0.00440%
(22) Jennings Vandyke 7813 Tariton Rd. Circleville, OH 43113	0.0392 acres 1/416 of 16.32 acres	0.0490%	0.00760%	0.01319%
(23) Arthur Herman Looney 4511 Herend Place Fairfax, VA 22032	0.0392 acres 1/416 of 16.32 acres	0.0490%	0.00760%	0.01319%
(24) Clarence Looney P. O. Box 11 Caretta, WV 24821	0.0392 acres 1/416 of 16.32 acres	0.0490%	0.00760%	0.01319%
(25) Elsie L. Ratliff Rt. 1, Box 227 Vansant, VA 24656	0.0392 acres 1/416 of 16.32 acres	0.0490%	0.00760%	0.01319%
(26) Faye L. Stevens P.O. Box 65 Pagaolia, CA 95954	0.0392 acres 1/416 of 16.32 acres	0.0490%	0.00760%	0.01319%
(27) Edna L. Breeding P.O. Box 2151 Pulaski, VA 24301	0.0392 acres 1/416 of 16.32 acres	0.0490%	0.00760%	0.01319%
(28) Juanita Price Rt. 1 Box 29-A Raven, VA 24639	0.0056 acres 1/2912 of 16.32 acres	0.0070%	0.00109%	0.00188%
(29) Roger Paul Looney 7756 Pohick River Dr. Lorton, VA 22079	0.0056 acres 1/2912 of 16.32 acres	0.0070%	0.00109%	0.00188%
(30) Martha & Warren Looney 9380 Whaleys Lake Trace Jonesboro, GA 30236	0.0056 acres 1/2912 of 16.32 acres	0.0070%	0.00109%	0.00188%
(31) Charles Don Looney 10444 Greene Dr. Lorton, VA 22079	0.0056 acres 1/2912 of 16.32 acres	0.0070%	0.00109%	0.00188%

Exhibit B
Unit U-15/B
Docket # VGOB-93-0622-0380-01
List of all Owners/Claimants

		Acres in Unit	Percent of Unit	Division of Interest in	
				1 East 15.4930%	2 East 26.8990%
(32)	Janice Carol Looney P.O. Box 301 Oakwood, VA 24631	0.0056 acres 1/2912 of 16.32 acres	0.0070%	0.00109%	0.00188%
(33)	Lawrence Gary Looney P.O. Box 341 Oakwood, VA 24631	0.0056 acres 1/2912 of 16.32 acres	0.0070%	0.00109%	0.00188%
(34)	Loretta Joyce Stacy P. O. Box 116 Wolford, VA 24658	0.0056 acres 1/2912 of 16.32 acres	0.0070%	0.00109%	0.00188%
(35)	Clarence Childress 4000 Norris Drive Fredericksburg, VA 22401	0.3138 acres 1/52 of 16.32 acres	0.3923%	0.06078%	0.10553%
(36)	Dorothy & Fred Jacobson 1741 Indian River Road Virginia Beach, VA 24356	0.0065 acres 1/2496 of 16.32 acres	0.0082%	0.00127%	0.00220%
(37)	Charles L. Runyon 4233 Cardinal Lane Suffolk, VA 23434	0.0065 acres 1/2496 of 16.32 acres	0.0082%	0.00127%	0.00220%
(38)	Kay Phillips Star Route, Box 21 Bell Island Road Currituck, NC 27929	0.0065 acres 1/2496 of 16.32 acres	0.0082%	0.00127%	0.00220%
(39)	Kenneth Ray Runyon 4233 Cardinal Lane Suffolk, VA 23434	0.0065 acres 1/2496 of 16.32 acres	0.0082%	0.00127%	0.00220%
(40)	Brenda & Gerald Armentrout 2279 Airport Road Suffolk, VA 23434	0.0065 acres 1/2496 of 16.32 acres	0.0082%	0.00127%	0.00220%
(41)	Donna & Harry Cleveland 116 Burnetts Court Suffolk, VA 23434	0.0065 acres 1/2496 of 16.32 acres	0.0082%	0.00127%	0.00220%
(42)	James C. Suttle 2208 Cross Street Chesapeake, VA 23323	0.0392 acres 1/416 of 16.32 acres	0.0490%	0.00760%	0.01319%
(43)	Perry VanDyke Rt. 2 Box 137 Cedar Bluff, VA 24609	0.0392 acres 1/416 of 16.32 acres	0.0490%	0.00760%	0.01319%
(44)	Claude & Allene VanDyke P.O. Box 92 Haysi, VA 24256	0.0392 acres 1/416 of 16.32 acres	0.0490%	0.00760%	0.01319%
(45)	Granville & Thelma VanDyke Rt. 2 Box 137 Cedar Bluff, VA 24609	0.0392 acres 1/416 of 16.32 acres	0.0490%	0.00760%	0.01319%
(46)	Mary VanDyke Cook P.O. Box 250 Vansant, VA 24656	0.0392 acres 1/416 of 16.32 acres	0.0490%	0.00760%	0.01319%

Exhibit B
Unit U-15/B
Docket # VGOB-93-0622-0380-01
List of all Owners/Claimants

	Acres in Unit	Percent of Unit	Division of Interest in	
			1 East 15.4930%	2 East 26.8990%
(47) Fred VanDyke 1069 Cox Avenue Chesapeake, VA 23323	0.0392 acres 1/416 of 16.32 acres	0.0490%	0.00760%	0.01319%
(48) Marie & Charles Hale 100 University Blvd., Apt. A23 Kingsport, TN 37660	0.0392 acres 1/416 of 16.32 acres	0.0490%	0.00760%	0.01319%
(49) Jessie G. Childress Heirs, Devisees, Successors or Assigns (31/1716)				
(a) Virginia H. Childress 6102 Violet Street Kingsport, TN 37662	0.1046 acres 1/156 of 16.32 acres	0.1308%	0.02026%	0.03518%
(b) Fay & Lee Couch 129 S. Mulberry Street Madison, IN 47220	0.0190 acres 1/858 of 16.32 acres	0.0238%	0.00368%	0.00640%
(c) Eula Hensdill Rt. 1, Box 156 Castlewood, VA 24224	0.0190 acres 1/858 of 16.32 acres	0.0238%	0.00368%	0.00640%
(d) Madeline & Karl Tucker 1253 Ovington Road Jacksonville, FL 32216	0.0190 acres 1/858 of 16.32 acres	0.0238%	0.00368%	0.00640%
(e) Eleanor & Robert Hawkins Heirs, Devisees, Successors or Assigns (1/858)				
(e.1) Joyce Hawkins Jones 840 Fairview School Road Blountville, TN 37617	0.0095 acres 1/1716 of 16.32 acres	0.0119%	0.00184%	0.00320%
(e.2) Charles Hawkins 343 Glasgow Lane Blountville, TN 37617	0.0095 acres 1/1716 of 16.32 acres	0.0119%	0.00184%	0.00320%
(f) Wanda & George Cochran, Jr. 324 First Street Gate City, VA 24251	0.0190 acres 1/858 of 16.32 acres	0.0238%	0.00368%	0.00640%
(g) Edith Presnell 3425 Memorial Street Alexander, VA 22306	0.0190 acres 1/858 of 16.32 acres	0.0238%	0.00368%	0.00640%
(h) Phyllis Evertt McKeon 4472 Dike Road Winter Park, FL 32792	0.0190 acres 1/858 of 16.32 acres	0.0238%	0.00368%	0.00640%
(i) Beatrice Raleigh Rt. 6, Lt. 59 Hawkins Mobile Park Church Hill, TN 37642	0.0190 acres 1/858 of 16.32 acres	0.0238%	0.00368%	0.00640%
(j) Carl & Claudia Childress	<i>Interest purchased by Buchanan Production Company (DB 432-463).</i>			
(j.1) CNX Gas Company LLC 1000 Consol Energy Drive Canonsburg, PA 15317 <i>(Previously Buchanan Production Company)</i>	0.0190 acres 1/858 of 16.32 acres	0.0238%	0.00368% -50%	0.00640%

Exhibit B
Unit U-15/B
Docket # VGOB-93-0622-0380-01
List of all Owners/Claimants

	Acres in Unit	Percent of Unit	Division of Interest in	
			1 East 15.4930%	2 East 26.8990%
<i>** NOTE: In order to resolve the CBM conflict, by Deed of Correction dated May 18, 2012, CNX Gas Company LLC conveys an undivided one-half (1/2) interest in the CBM Estate to Harrison-Wyatt, LLC (Instrument # 120001064)</i>				
(k) Emory & Katherine Childress 6102 Violet Street Kingsport, TN 37663	0.0190 acres 1/858 of 16.32 acres	0.0238%	0.00368%	0.00640%
(50) Pinkey Kitts Heirs, Devisees, Successors or Assigns (1/858)				
(a) Verna & Joseph Taylor 8703 Lonepine Road Richmond, VA 23229	0.0038 acres 1/4290 of 16.32 acres	0.0048%	0.00074%	0.00128%
(b) Louise & Lester Agee 7601 Bull Run Road Manassas, VA 22110	0.0038 acres 1/4290 of 16.32 acres	0.0048%	0.00074%	0.00128%
(c) Straley & Betty Kitts Rt. 4 Box 244 Madison Heights, VA 24572	0.0038 acres 1/4290 of 16.32 acres	0.0048%	0.00074%	0.00128%
(d) Warren & Jacqueline Kitts 5320 Twilight Road NW Roanoke, VA 24019	0.0038 acres 1/4290 of 16.32 acres	0.0048%	0.00074%	0.00128%
(e) Wendell & Angie Kitts Box 53 Bastian, VA 24314	0.0038 acres 1/4290 of 16.32 acres	0.0048%	0.00074%	0.00128%
(51) Daniel J. Looney Heirs, Devisees, Successors or Assigns (1/78)				
(a) David C. Looney 3030 Tanglewood Dr. Clearwater, FL 34621	0.1046 acres 1/156 of 16.32 acres	0.1308%	0.02026%	0.03518%
(b) Nyrell V. Looney 829 Benjamin Place Virginia Beach, VA 23435	0.1046 acres 1/156 of 16.32 acres	0.1308%	0.02026%	0.03518%
(52) John C. Looney Heirs, Devisees, Successors or Assigns (1/52)				
(a) Marceline Krause 2920 Bradley Avenue N.E. Roanoke, VA 24012	0.0628 acres 1/260 of 16.32 acres	0.0785%	0.01216%	0.02111%
(b) Harold Looney Box 125 Grundy, VA 24614	0.0628 acres 1/260 of 16.32 acres	0.0785%	0.01216%	0.02111%
(c) Jimmy B. Looney Box 745 Grundy, VA 24614	0.0628 acres 1/260 of 16.32 acres	0.0785%	0.01216%	0.02111%
(d) Larry Q. Looney Box 125 Grundy, VA 24614	0.0628 acres 1/260 of 16.32 acres	0.0785%	0.01216%	0.02111%
(e) Dollie Sue Grace Rt. 2 Lot 1 Springfield North Tazewell, VA 24630	0.0628 acres 1/260 of 16.32 acres	0.0785%	0.01216%	0.02111%

Exhibit B
Unit U-15/B
Docket # VGOB-93-0622-0380-01
List of all Owners/Claimants

	Acres in Unit	Percent of Unit	Division of Interest in	
			1 East 15.4930%	2 East 26.8990%
(53) Rosa Childress Heirs, Devisees, Successors or Assigns (3/208)				
(a) Ruby & Oscar White P.O. Box 580 Oakwood, VA 24631	0.0785 acres 1/208 of 16.32 acres	0.0981%	0.01520%	0.02638%
(b) Jessie Childress Box 22 Vansant, VA 24656	0.0785 acres 1/208 of 16.32 acres	0.0981%	0.01520%	0.02638%
(c) Mary C. Miller, Heirs, Devisees, Successors or Assigns <i>Heirs/Addresses Unknown</i>	0.0785 acres 1/208 of 16.32 acres	0.0981%	0.01520%	0.02638%
(54) Robert Childress Heirs, Devisees, Successors or Assigns (1/208)				
(a) Pauline M. Childress, widow Box 84 Oakwood, VA 24631	0.0262 acres 1/624 of 16.32 acres	0.0327%	0.00507%	0.00879%
(b) Nancy & Robert Childress, Jr. HC4 Box 228 Council, VA 24260	0.0174 acres 1/936 of 16.32 acres	0.0218%	0.00338%	0.00586%
(c) Patricia & Larry Blankenship P.O. Box 881 Tazewell, VA 24651	0.0174 acres 1/936 of 16.32 acres	0.0218%	0.00338%	0.00586%
(d) Steven M. Childress 4313 Dearbrook Way Lilburn, GA 30247	0.0174 acres 1/936 of 16.32 acres	0.0218%	0.00338%	0.00586%
(55) Jettie Lee Shortridge, Heirs, Devisees, Successors or Assigns <i>Heirs/Addresses Unknown</i>	0.1395 acres 1/117 of 16.32 acres	0.1744%	0.02701%	0.04690%
(56) Ferrell W. Shortridge, Heirs, Devisees, Successors or Assigns <i>Heirs/Addresses Unknown</i>	0.0465 acres 1/351 of 16.32 acres	0.0581%	0.00900%	0.01563%
(57) Frazier A. Shortridge, Heirs, Devisees, Successors or Assigns <i>Heirs/Addresses Unknown</i>	0.0465 acres 1/351 of 16.32 acres	0.0581%	0.00900%	0.01563%
(58) Judith Stiltner, Heirs, Devisees, Successors or Assigns <i>Heirs/Addresses Unknown</i>	0.0465 acres 1/351 of 16.32 acres	0.0581%	0.00900%	0.01563%
(59) Connie S. Sluder, Heirs, Devisees, Successors or Assigns <i>Heirs/Addresses Unknown</i>	0.0465 acres 1/351 of 16.32 acres	0.0581%	0.00900%	0.01563%
(60) Mable Mullins HCR Box 50-B Grundy, VA 24614	0.0465 acres 1/351 of 16.32 acres	0.0581%	0.00900%	0.01563%
(61) Harold Shortridge 521 Suffolk Avenue Richlands, VA 24641	0.0465 acres 1/351 of 16.32 acres	0.0581%	0.00900%	0.01563%

Exhibit B
Unit U-15/B
Docket # VGOB-93-0622-0380-01
List of all Owners/Claimants

	Acres in Unit	Percent of Unit	Division of Interest in	
			1 East 15.4930%	2 East 26.8990%
(62) Hettie Elswick Hess Heirs, Devisees, Successors or Assigns (1/39)				
(a) Bernard Elswick Heirs, Devisees, Successors or Assigns				
(a.1) Nara Elswick, widow 11 South Meadow Drive Glen Burnic, MD 21060	0.1395 acres 1/117 of 16.32 acres	0.1744%	0.02701%	0.04690%
(b) Corina E. Nuckles 7366 Woodlawn Lane Warrenton, VA 20187-8953	0.1395 acres 1/117 of 16.32 acres	0.1744%	0.02701%	0.04690%
(c) Mrs. Arbutus Baldauf RR3 Box 306B Seaford, DE 19973-7517	0.1395 acres 1/117 of 16.32 acres	0.1744%	0.02701%	0.04690%
(63) Thurman Shortridge, Heirs, Devisees, Successors or Assigns <i>Heirs/Addresses Unknown</i>	0.4185 acres 1/39 of 16.32 acres	0.5231%	0.08104%	0.14070%
(64) Ruby McGlothlin 8607 Virginia Avenue Annadale, VA 22003	0.0349 acres 1/468 of 16.32 acres	0.0436%	0.00675%	0.01173%
(65) John Pevny 13036 Sheffield Drive Pickerington, OH 43147	0.0349 acres 1/468 of 16.32 acres	0.0436%	0.00675%	0.01173%
(66) Kenneth S. McGlothlin 1759 25th Avenue Vero Beach, FL 32960	0.0349 acres 1/468 of 16.32 acres	0.0436%	0.00675%	0.01173%
(67) Pamela Jones 5324 E. Diamond Mesa, AZ 85206	0.0131 acres 1/1248 of 16.32 acres	0.0163%	0.00253%	0.00440%
(68) Carol & Sparky Barnett 5324 E. Diamond Mesa, AZ 85206	0.0131 acres 1/1248 of 16.32 acres	0.0163%	0.00253%	0.00440%
(69) Anna Hammer P.O. Box 51417 Phoenix, AZ 85076-1417	0.0262 acres 1/624 of 16.32 acres	0.0327%	0.00507%	0.00879%
(70) Glen Arthur Starkey 1132 W. Southern Avenue Tolleson, AZ 85353	0.0262 acres 1/624 of 16.32 acres	0.0327%	0.00507%	0.00879%
(71) The Starkey Family Trust c/o Marilyn Starkey, Trustee 123 N. Shamrock Ave. Monrovia, CA 91016	0.0262 acres 1/624 of 16.32 acres	0.0327%	0.00507%	0.00879%
(72) Julie S. McCoy, Heirs, Devisees Successors or Assigns				
(a) Nellie Crothers 550 Basin Run Road Conowingo, MD 21918	0.1046 acres 1/156 of 16.32 acres	0.1308%	0.02026%	0.03518%

Exhibit B
Unit U-15/B
Docket # VGOB-93-0622-0380-01
List of all Owners/Claimants

	Acres in Unit	Percent of Unit	Division of Interest in	
			1 East 15.4930%	2 East 26.8990%
(73) Carrie McGlothlin Heirs, Devisees, Successors or Assigns				
(a) Luther H. McGlothlin Heirs, Devisees, Successors or Assigns				
(a.1) Melissa Ann Kugler 139 Harmony Crest Drive Newark, DE 19713	0.0523 acres 1/312 of 16.32 acres	0.0654%	0.01013%	0.01759%
(b) Warren McGlothlin Heirs Devisees, Successors or Assigns (1/312)				
(b.1) Debra Susan McGlothlin 64 Rowlandsville Road Conowingo, MD 21918	0.0262 acres 1/624 of 16.32 acres	0.0327%	0.00507%	0.00879%
(b.2) Allen Neal McGlothlin 40 McGlothlin Road Conowingo, MD 21918	0.0262 acres 1/624 of 16.32 acres	0.0327%	0.00507%	0.00879%
(74) Arbutus McGlothlin Heirs, Devisees, Successors or Assigns				
(a) Cynthia McGlothlin 2220 Porter Road Bear, DE 19701	0.1046 acres 1/156 of 16.32 acres	0.1308%	0.02026%	0.03518%
(75) Mae McGlothlin Heirs, Devisees, Successors or Assigns	<i>Interest went to Janet McGrath, along with what she already inherited. (1/1170 and 1/468)</i>			
(76) John & Janet McGrath 9027 East Broadway Mesa, AZ 85208	0.0488 acres 7/2340 of 16.32 acres	0.0610%	0.00945%	0.01642%
(77) June & Donald Donaldson 1273 Carr Avenue Memphis, TN 38104	0.0139 acres 1/1170 of 16.32 acres	0.0174%	0.00270%	0.00469%
(78) Marlene M. Pardi 8711 E. Pinnacle Peak Road, PMB295 Scottsdale, AZ 85255	0.0139 acres 1/1170 of 16.32 acres	0.0174%	0.00270%	0.00469%
(79) George & Alberta McGlothlin 6473 County Road #218 Jacksonville, FL 32234	0.0139 acres 1/1170 of 16.32 acres	0.0174%	0.00270%	0.00469%
(80) Stephen & Naia McGlothlin 746 East 8th Avenue Mesa, AZ 85204	0.0139 acres 1/1170 of 16.32 acres	0.0174%	0.00270%	0.00469%
(81) Delford & Mary McGlothlin	<i>Interest was purchased by Buchanan Production Company by deed dated 9</i>			
(a) CNX Gas Company LLC 1000 Consol Energy Drive Canonsburg, PA 15317 <i>(Previously Buchanan Production Company)</i>	0.1046 acres 1/156 of 16.32 acres	0.1308%	0.02026% -50%	0.03518%

**** NOTE:** In order to resolve the CBM conflict, by Deed of Correction dated May 18, 2012, CNX Gas Company LLC conveys an undivided one-half (1/2) interest in the CBM Estate to Harrison-Wyatt, LLC (Instrument # 120001064)

Exhibit B
Unit U-15/B
Docket # VGOB-93-0622-0380-01
List of all Owners/Claimants

	Acres in Unit	Percent of Unit	Division of Interest in	
			1 East 15.4930%	2 East 26.8990%
(82) Virginia I. Shinault Heirs, Devisees, Successors or Assigns (1/156)				
(a) Charles F. Jones 223 McGlothlin Road Conowingo, MD 21918	0.0349 acres 1/468 of 16.32 acres	0.0436%	0.00675%	0.01173%
(b) The Melony Richards Trust c/o Anthony G. Richards 3955 Oakland Street Cocoa, FL 32927	0.0349 acres 1/468 of 16.32 acres	0.0436%	0.00675%	0.01173%
(c) Patricia Edler 4345 Fairfax Street Cocoa, FL 32927-3901	0.0349 acres 1/468 of 16.32 acres	0.0436%	0.00675%	0.01173%
(83) John D. McGlothlin 111 Peppermint Drive Port Deposit, MD 21904-1365	0.1046 acres 1/156 of 16.32 acres	0.1308%	0.02026%	0.03518%
(84) Nellie J. McGlothlin Estate c/o Orpha J. Shmel, Executrix 626 Biggs Highway Rising Sun, MD 21911	0.1046 acres 1/156 of 16.32 acres	0.1308%	0.02026%	0.03518%
(85) Doris C. McGlothlin, Heirs, Devisees, Successors or Assigns				
(a) Roger McGlothlin 7633 Wilson Blvd. Jacksonville, FL 32210	0.1046 acres 1/156 of 16.32 acres	0.1308%	0.02026%	0.03518%
(86) Nancy M. Griffin 5746 Firestone Road Jacksonville, FL 32244	0.0070 acres 1/2340 of 16.32 acres	0.0087%	0.00135%	0.00235%
(87) John M. McGlothlin 8077 Wilson Blvd. Jacksonville, FL 32210-3551	0.0108 acres 7/10530 of 16.32 acres	0.0136%	0.00210%	0.00365%
(88) Herman T. McGlothlin 930 Flagg Springs Road Lynnville, TN 38472	0.0108 acres 7/10530 of 16.32 acres	0.0136%	0.00210%	0.00365%
(89) Kenneth P. McGlothlin Heirs, Devisees, Successors or Assigns				
(a) Christine L. McGlothlin 1651 Alexander Lane Grants Pass, OR 97527	0.0108 acres 7/10530 of 16.32 acres	0.0136%	0.00210%	0.00365%
(90) Nelson E. McGlothlin 16386 Campbellsville Road Lynnville, TN 38472	0.0108 acres 7/10530 of 16.32 acres	0.0136%	0.00210%	0.00365%
(91) Jacob L. McGlothlin 860 Tookie Road Jacksonville, FL 32234	0.0108 acres 7/10530 of 16.32 acres	0.0136%	0.00210%	0.00365%
(92) David A. McGlothlin 181 Sonja Ellen Drive Jacksonville, FL 32234	0.0108 acres 7/10530 of 16.32 acres	0.0136%	0.00210%	0.00365%

Exhibit B
Unit U-15/B
Docket # VGOB-93-0622-0380-01
List of all Owners/Claimants

	Acres in Unit	Percent of Unit	Division of Interest in	
			1 East 15.4930%	2 East 26.8990%
(93) Phyllis D. Cline 424 Woodland Drive St. Albans, WV 25177	0.0108 acres 7/10530 of 16.32 acres	0.0136%	0.00210%	0.00365%
(94) Carol E. Lynch 43180 Oyster Bay Drive Hollywood, MD 20636	0.0108 acres 7/10530 of 16.32 acres	0.0136%	0.00210%	0.00365%
(95) Orpha J. Schlarbaum Heirs, Devisees, Successors or Assigns				
(a) Jessie L. Schlarbaum c/o Circle of Hope Inc. Assisted Living Facilit 1550 W. 9th Street Jacksonville, FL 32209	0.0027 acres 133/800000 of 16.32 acres	0.0034%	0.00053%	0.00091%
(b) George M. Schlarbaum P.O. Box 1410 St. Mary, FL 32040-1410	0.0027 acres 133/800000 of 16.32 acres	0.0034%	0.00053%	0.00091%
(c) Emory J. Schlarbaum 4709 Daughtry Blvd. East Jacksonville, FL 32210	0.0027 acres 133/800000 of 16.32 acres	0.0034%	0.00053%	0.00091%
(d) Ty Cobb Schlarbaum 1015 Green St. Oskaloosa, IA 52577	0.0027 acres 133/800000 of 16.32 acres	0.0034%	0.00053%	0.00091%
(96) Lonzo Murphy, Heirs, Devisees, Successors or Assigns <i>Heirs/Addresses Unknown</i>	1.2554 acres 1/13 of 16.32 acres	1.5692%	0.24312%	0.42211%
(97) Vernie S. Baldrige Heirs, Devisees, Successors or Assigns (1/143)				
(a) Opal Coleman 18998 Rd I-18 Continental, OH 45831	0.0163 acres 1/1001 of 16.32 acres	0.0204%	0.00316%	0.00548%
(b) Lillian Griffith Ball Road, Rt. 5, House #20801 Defiance, OH 43512	0.0163 acres 1/1001 of 16.32 acres	0.0204%	0.00316%	0.00548%
(c) Helen Meade Ball Road, Rt. 5, House #20767 Defiance, OH 43512	0.0163 acres 1/1001 of 16.32 acres	0.0204%	0.00316%	0.00548%
(d) Billy Baldrige 14382 Row B Leipsie, OH 45856	0.0163 acres 1/1001 of 16.32 acres	0.0204%	0.00316%	0.00548%
(e) Elmer Baldrige Rt. 7, Arena Drive Defiance, OH 43512	0.0163 acres 1/1001 of 16.32 acres	0.0204%	0.00316%	0.00548%
(f) Wilmer Baldrige Slusser Drive Rt. 7 Defiance, OH 43512	0.0163 acres 1/1001 of 16.32 acres	0.0204%	0.00316%	0.00548%
(g) Buddy Baldrige Woodland Park, Apt. #408 10401 North 33rd Avenue Phoenix, AZ 85051	0.0163 acres 1/1001 of 16.32 acres	0.0204%	0.00316%	0.00548%

Exhibit B
Unit U-15/B
Docket # VGOB-93-0622-0380-01
List of all Owners/Claimants

	Acres in Unit	Percent of Unit	Division of Interest in	
			1 East 15.4930%	2 East 26.8990%
(98) Ora M. Baldrige c/o Mavis Grinnell 14495 Marrice Road Perry, MI 48872	0.1141 acres 1/143 of 16.32 acres	0.1427%	0.02210%	0.03837%
(99) Effie Looney (Shortridge?) Heirs, Devisees, Successors or Assigns (1/143)				
(a) Roger Lee Shortridge 695 Long Level Rd., SW Floyd, VA 24091	0.0571 acres 1/286 of 16.32 acres	0.0713%	0.01105%	0.01919%
(b) Lois S. Horne Heirs, Devisees, Successors or Assigns				
(b.1) Larry V. Horne 645 Long Level Rd., SW Floyd, VA 24091	0.0190 acres 1/858 of 16.32 acres	0.0238%	0.00368%	0.00640%
(b.2) Keith D. Horne 534 Morre Rd., NE Floyd, VA 24091	0.0190 acres 1/858 of 16.32 acres	0.0238%	0.00368%	0.00640%
(b.3) Sharon H. Beasley PO Box 1525 Hillsville, VA 24343	0.0190 acres 1/858 of 16.32 acres	0.0238%	0.00368%	0.00640%
(100) Nell K. Branham P.O. Box 1756 Richlands, VA 24641	0.1141 acres 1/143 of 16.32 acres	0.1427%	0.02210%	0.03837%
(101) Roy B. McGlothlin 372 Pleasant Hill Blountville, TN	0.1141 acres 1/143 of 16.32 acres	0.1427%	0.02210%	0.03837%
(102) Jessie McGlothlin 218 E. Central Avenue Bristol, TN 37620	0.1141 acres 1/143 of 16.32 acres	0.1427%	0.02210%	0.03837%
(103) Ed Harold McGlothlin 201 Aldrich Rd. Vermillion, OH 44089	0.1141 acres 1/143 of 16.32 acres	0.1427%	0.02210%	0.03837%
(104) Dale R. McGlothlin Rt. 4 Box 208A Grundy, VA 24614	0.1141 acres 1/143 of 16.32 acres	0.1427%	0.02210%	0.03837%
(105) Etta Ruth M. & Charles Justice P.O. Box 248 Big Rock, VA 24603	0.1141 acres 1/143 of 16.32 acres	0.1427%	0.02210%	0.03837%
(106) Juanita McGlothlin Rt. 4 Box 208A Grundy, VA 24614	0.1141 acres 1/143 of 16.32 acres	0.1427%	0.02210%	0.03837%
(107) Franklin McGlothlin Rt. 4 Box 208A Grundy, VA 24614	0.1141 acres 1/143 of 16.32 acres	0.1427%	0.02210%	0.03837%
(108) Rosa M. Norman P.O. Box 476 Vansant, VA 24656	0.4185 acres 1/39 of 16.32 acres	0.5231%	0.08104%	0.14070%

Exhibit B
Unit U-15/B
Docket # VGOB-93-0622-0380-01
List of all Owners/Claimants

	Acres in Unit	Percent of Unit	Division of Interest in	
			1 East 15.4930%	2 East 26.8990%
(109) Pearl M. Matney, Heirs, Devisees, Successors or Assigns <i>Heirs/Addresses Unknown</i>	0.0930 acres 2/351 of 16.32 acres	0.1162%	0.01801%	0.03127%
(110) Sally C. Hatfield, Heirs, Devisees, Successors or Assigns <i>Heirs/Addresses Unknown</i>	0.0930 acres 2/351 of 16.32 acres	0.1162%	0.01801%	0.03127%
(111) Roy McGlothlin Heirs, Devisees, Successors or Assigns (2/351)				
(a) Elsie McGlothlin 739 Crestwood Dr. Richlands, VA 24641	0.0310 acres 2/1053 of 16.32 acres	0.0387%	0.00600%	0.01042%
(b) James B. McGlothlin 739 Crestwood Dr. Richlands, VA 24641	0.0207 acres 4/3159 of 16.32 acres	0.0258%	0.00400%	0.00695%
(c) Sue Bowlin 2466 Brights Pike Morristown, TN 37814	0.0207 acres 4/3159 of 16.32 acres	0.0258%	0.00400%	0.00695%
(d) Ronnie McGlothlin Kents Ridge Cedar Bluff, VA 24609	0.0207 acres 4/3159 of 16.32 acres	0.0258%	0.00400%	0.00695%
(112) John McGlothlin, Jr., Heirs, Devisees, Successors or Assigns <i>Heirs/Addresses Unknown</i>	0.0930 acres 2/351 of 16.32 acres	0.1162%	0.01801%	0.03127%
(113) Kermit McGlothlin Rt. 2 Box 656 Vansant, VA 24656	0.0930 acres 2/351 of 16.32 acres	0.1162%	0.01801%	0.03127%
(114) Leonard McGlothlin, Heirs, Devisees, Successors or Assigns <i>Heirs/Addresses Unknown</i>	0.0930 acres 2/351 of 16.32 acres	0.1162%	0.01801%	0.03127%
(115) Samie G. McGlothlin, Heirs, Devisees, Successors or Assigns <i>Heirs/Addresses Unknown</i>	0.0930 acres 2/351 of 16.32 acres	0.1162%	0.01801%	0.03127%
(116) Victory McGlothlin, Heirs, Devisees, Successors or Assigns <i>Heirs/Addresses Unknown</i>	0.0930 acres 2/351 of 16.32 acres	0.1162%	0.01801%	0.03127%
(117) Buford Lee McGlothlin P.O. Box 69 Oakwood, VA 24631	0.0930 acres 2/351 of 16.32 acres	0.1162%	0.01801%	0.03127%
(118) Ethel Shortridge 4401 Roosevelt Blvd. Dearborn Hts., MI 48125	0.0966 acres 1/169 of 16.32 acres	0.1207%	0.01870%	0.03247%
(119) Bea Johnson 3420 East Bonner Dr. Norfolk, VA 23501	0.0966 acres 1/169 of 16.32 acres	0.1207%	0.01870%	0.03247%

Exhibit B
Unit U-15/B
Docket # VGOB-93-0622-0380-01
List of all Owners/Claimants

	Acres in Unit	Percent of Unit	Division of Interest in	
			1 East 15.4930%	2 East 26.8990%
(120) June Arms Rt. 1, Box 177 Vansant, VA 24656	0.0966 acres 1/169 of 16.32 acres	0.1207%	0.01870%	0.03247%
(121) Edd Shortridge RR5 Box 485 Grundy, VA 24614	0.0966 acres 1/169 of 16.32 acres	0.1207%	0.01870%	0.03247%
(122) Hassell Shortridge 1226 Stringer Rd. Belton, SC 29627	0.0966 acres 1/169 of 16.32 acres	0.1207%	0.01870%	0.03247%
(123) Lola Skeens 902 Hammonds Lane Baltimore, MD 21225	0.0966 acres 1/169 of 16.32 acres	0.1207%	0.01870%	0.03247%
(124) Carl Shortridge Rt. 2 Box 14A Grundy, VA 24614	0.0966 acres 1/169 of 16.32 acres	0.1207%	0.01870%	0.03247%
(125) Faye Delroseers 1809 Skyline Dr. Norfolk, VA 23500	0.0966 acres 1/169 of 16.32 acres	0.1207%	0.01870%	0.03247%
(126) Paul Shortridge 1520 McWhorter Rd. London, KY 40741	0.0966 acres 1/169 of 16.32 acres	0.1207%	0.01870%	0.03247%
(127) Marlene Rife P.O. Box 255 Pilgrim Knob, VA 24634	0.0966 acres 1/169 of 16.32 acres	0.1207%	0.01870%	0.03247%
(128) Johnny M. Shortridge Jr. HC67 Box 6A Vansant, VA 24656	0.0966 acres 1/169 of 16.32 acres	0.1207%	0.01870%	0.03247%
(129) Freddie Shortridge HRC Vansant, VA 24656	0.0966 acres 1/169 of 16.32 acres	0.1207%	0.01870%	0.03247%
(130) Irene Stacy 1336 Kenworth Drive Conway, SC 29526	0.0966 acres 1/169 of 16.32 acres	0.1207%	0.01870%	0.03247%
(131) Bennie McGlothlin Rt.4 Box 420 Gate City, VA 24251	0.0761 acres 2/429 of 16.32 acres	0.0951%	0.01473%	0.02558%
(132) Bonnie McGlothlin 2267 Roberts Creek Rd. Hiltons, VA 24258	0.0761 acres 2/429 of 16.32 acres	0.0951%	0.01473%	0.02558%
(133) Ralph Edward McGlothlin 94 Collins Crest Cedar Bluff, VA 24609	0.0761 acres 2/429 of 16.32 acres	0.0951%	0.01473%	0.02558%
(134) Patricia S. McGlothlin 6293 Wilderness Road Dublin, VA 24084	0.1141 acres 1/143 of 16.32 acres	0.1427%	0.02210%	0.03837%

Exhibit B
Unit U-15/B
Docket # VGOB-93-0622-0380-01
List of all Owners/Claimants

	Acres in Unit	Percent of Unit	Division of Interest in	
			1 East 15.4930%	2 East 26.8990%
(135) Ruby B. McGlothlin Heirs, Devisees, Successors or Assigns				
(a) Ann M. Lilly 16540 Heron Coach Way #406 Fort Meyers, FL 33908	0.1141 acres 1/143 of 16.32 acres	0.1427%	0.02210%	0.03837%
(136) Helen E. Counts Heirs, Devisees, Successors or Assigns (2/143)				
(a) Bascom "Buddy" B. B. Matney 4841 25th Road Nth Arlington, VA 22207-2648	0.0761 acres 2/429 of 16.32 acres	0.0951%	0.01473%	0.02558%
(b) Helen Carol Mamone 600 Alexandria Circle Bluefield, VA 24605-9241	0.0761 acres 2/429 of 16.32 acres	0.0951%	0.01473%	0.02558%
(c) Ann C. Rauehauser 28 Bog Meadow Road Sharon, CT 06069	0.0761 acres 2/429 of 16.32 acres	0.0951%	0.01473%	0.02558%
(137) Frankie Mae Street Heirs, Devisees, Successors or Assigns (2/143)				
(a) W.A. Street Heirs Trust				
(a.1) W.A. Street Heirs Trust c/o Hiram A. Street 4601 Gulf Shore Blvd., North Enclave No. 10 Naples, FL 33910	0.0571 acres 1/286 of 16.32 acres	0.0713%	0.01105%	0.01919%
(a.2) W.A. Street Heirs Trust c/o Nicholas D. Street 101 Lick Branch Rd. Bristol, TN 37620	0.0571 acres 1/286 of 16.32 acres	0.0713%	0.01105%	0.01919%
(a.3) W.A. Street Heirs Trust c/o James H. Street PO Box 2100 Grundy, VA 24614	0.0571 acres 1/286 of 16.32 acres	0.0713%	0.01105%	0.01919%
(a.4) W.A. Street Heirs Trust c/o Daniel Street PO Box 2100 Grundy, VA 24614	0.0571 acres 1/286 of 16.32 acres	0.0713%	0.01105%	0.01919%

The interest of heirs in yellow are now a part of the W.A. Street Heirs Trust

Gaynell S. Fowler
28201 Alfred Moore Ct.
Bonita Springs, FL 34135

James H. Street
PO Box 1475
Grundy, VA 24614

Marcus A. Street
PO Box 1475
Grundy, VA 24614

Exhibit B
Unit U-15/B
Docket # VGOB-93-0622-0380-01
List of all Owners/Claimants

	Acres in Unit	Percent of Unit	Division of Interest in 1 East 15.4930%	2 East 26.8990%
<p>Robert D. Street PO Box 1869 Corvallis, OR 97339-1869</p> <p>David A. Street P. O. Box 1475 Grundy, VA 24614</p> <p>Lauren F. Street 14684 Old Jonesboro Road Bristol, VA 24202</p> <p>Russell K. Street 1004 Thornehill Dr. Anderson, SC 29621</p>				
(138)	Joseph Blair McGlothlin P. O. Box 71 Cedar Bluff, VA 24609	0.1141 acres 1/143 of 16.32 acres	0.1427%	0.02210% 0.03837%
(139)	Katherine M. & John Warren 2208 Wingfield Road Charlottesville, VA 22901	0.1141 acres 1/143 of 16.32 acres	0.1427%	0.02210% 0.03837%
(140)	Nannie P. Lockhart Heirs, Devisees, Successors or Assigns			
(a)	Violet Doris Smith 9625 Alfaree Rd. Richmond, VA 23237	0.1141 acres 1/143 of 16.32 acres	0.1427%	0.02210% 0.03837%
(b)	Fred Presley 6815 Pounding Mill Branch Rd. Pounding Mill, VA 24637	0.1141 acres 1/143 of 16.32 acres	0.1427%	0.02210% 0.03837%
(141)	Mary & D.A. McGlothlin, Sr. P.O. Box 909 Grundy, VA 24614	0.0761 acres 2/429 of 16.32 acres	0.0951%	0.01473% 0.02558%
(142)	Billy Sue Dixon Heirs, Devisees, Successors or Assigns			
(a)	Hobart Dixon Heirs, Devisees, Successors or Assigns (2/249)			
(a.1)	Kenna Dixon Moose 309 Lindsey Street Bristol, VA 24201	0.0380 acres 1/429 of 16.32 acres	0.0476%	0.00737% 0.01279%
(a.2)	Michael McKinley Dixon 21045 Campground Rd. Bristol, VA 24202	0.0380 acres 1/429 of 16.32 acres	0.0476%	0.00737% 0.01279%
(143)	Peggy & Henry Durham 607 S. Westland Ave. Tampa, FL 33606	0.0761 acres 2/429 of 16.32 acres	0.0951%	0.01473% 0.02558%
(144)	Rose Myrtle Wampler Heirs, Devisees, Successors or Assigns			
(a)	Sherry W. Bennett 155 Mountain Ave Rocky Mount, VA 24151	0.0761 acres 2/429 of 16.32 acres	0.0951%	0.01473% 0.02558%

Exhibit B
Unit U-15/B
Docket # VGOB-93-0622-0380-01
List of all Owners/Claimants

	Acres in Unit	Percent of Unit	Division of Interest in	
			1 East 15.4930%	2 East 26.8990%
(b) Pauline W. Shortridge 9217 Brentsville Road Manassas, VA 20112	0.0761 acres 2/429 of 16.32 acres	0.0951%	0.01473%	0.02558%
(c) F.E. Wampler 22784 Osprey Ridge Road Bristol, VA 24202	0.0761 acres 2/429 of 16.32 acres	0.0951%	0.01473%	0.02558%
(145) Woodrow & Sally McGlothlin Heirs, Devisees, Successors or Assigns				
(a) James W. McGlothlin 1005 Glenway Ave. Bristol, VA 24201	0.0761 acres 2/429 of 16.32 acres	0.0951%	0.01473%	0.02558%
(b) Thomas D. McGlothlin 112 Plox Creek Bristol, TN 37620	0.0761 acres 2/429 of 16.32 acres	0.0951%	0.01473%	0.02558%
(c) Michael G. McGlothlin PO Drawer 810 Grundy, VA 24614	0.0761 acres 2/429 of 16.32 acres	0.0951%	0.01473%	0.02558%
(146) Doris Ann McGlothlin P. O. Box 428 Raven, VA 24639	0.0652 acres 4/1001 of 16.32 acres	0.0815%	0.01263%	0.02193%
(147) Cecil Borkey Heirs, Devisees, Successors or Assigns				
(a) Francis Ann Borkey 9608 Gaslight Place Richmond, VA 23229	0.0326 acres 2/1001 of 16.32 acres	0.0408%	0.00631%	0.01096%
(148) Betty & James Lloyd McGlothlin 998 Glenwood St. Cedar Bluff, VA 24609	0.0326 acres 2/1001 of 16.32 acres	0.0408%	0.00631%	0.01096%
(149) Una Lee Mulligan Bailey Box 51 Richlands, VA 24641	0.0326 acres 2/1001 of 16.32 acres	0.0408%	0.00631%	0.01096%
(150) Cecil Earl McGlothlin Heirs, Devisees, Successors or Assigns				
(a) McGlothlin Living Trust c/o Joyce McGlothlin, Trustee PO Box 2417 Cookeville, TN 38502	0.0326 acres 2/1001 of 16.32 acres	0.0408%	0.00631%	0.01096%
(151) Norman McGlothlin 6239 Oak Leaf Ln. N. Fayetteville, PA 17222	0.0326 acres 2/1001 of 16.32 acres	0.0408%	0.00631%	0.01096%
(152) Dorothy Mullins Heirs, Devisees, Successors or Assigns				
(a) Ann Mullins Washburn 3343 Notingham Drive Tallahassee, FL 32312	0.0380 acres 1/429 of 16.32 acres	0.0476%	0.00737%	0.01279%

Exhibit B
Unit U-15/B
Docket # VGOB-93-0622-0380-01
List of all Owners/Claimants

	Acres in Unit	Percent of Unit	Division of Interest in	
			1 East 15.4930%	2 East 26.8990%
(b) Mike Mullins 1445 Westerly Terrace Los Angeles, CA 90026	0.0380 acres 1/429 of 16.32 acres	0.0476%	0.00737%	0.01279%
(153) Charles Robert Dixon Heirs, Devisees, Successors or Assigns				
(a) Charleen Dixon Seale 2653 Suffolk St. Kingsport, TN 37660	0.0761 acres 2/429 of 16.32 acres	0.0951%	0.01473%	0.02558%
(154) Gladys Jessee 413 North Street Richlands, VA 24641	0.0761 acres 2/429 of 16.32 acres	0.0951%	0.01473%	0.02558%
(155) CNX Gas Company LLC 1000 Consol Energy Drive Canonsburg, PA 15317 <i>(previously Buchanan Production Company)</i>	0.4185 acres 1/39 of 16.32 acres	0.5231%	0.08104%	0.14070%

Exhibit E
Unit U-15/B
Docket # VGOB-93-0622-0380-01
List of all Owners/Claimants in escrow

	Acres in Unit	Percent of Unit
<u>Tract No. 3, 7.49 Acres</u>		
<u>COAL OWNERSHIP</u>		
(1) H-W Financial, LLC, Big Axe Tr.4 P.O. Box 11000 Danville, VA 24543	7.49 acres	9.3625%
<u>OIL & GAS OWNERSHIP</u>		
(1) Jessie Childress Heirs, et al. <i>(33.34 Acre Tract)</i>	7.49 acres	9.3625%
(e) Eleanor Hankins Heirs, Devisees, Successors or Assigns		
(e.1) Robert B. Hawkins, Jr., Heirs, Devisees, Successors or Assigns		
<i>W9/Affidavit not received</i>		
(e.1.1) Elvetta Wood Hawkins 5843 Fairhill Ln Knoxville, TN 37918	0.1702 acres 1/44 of 7.49 acres	0.2128%
	Acres	0.1702
	Percent	0.2128%

Tract No. 4, 16.32 Acres

COAL OWNERSHIP

(1) H-W Financial, LLC, Big Axe Tr.4 P.O. Box 11000 Danville, VA 24543	16.32 acres	20.4000%
--	-------------	----------

OIL & GAS OWNERSHIP

Unresolved Heirship

Vicey McGlothlin Heirs, Devisees, Successors or Assigns, et al.	16.32 acres	20.4000%
(1) Julia McGlothlin Jackson Heirs, Devisees, Successors or Assigns (1/13)		
(a) Bessie J. Hammonds, Heirs, Devisees, Successors or Assigns <i>Heirs/Addresses Unknown</i>	0.1255 acres 1/130 of 16.32 acres	0.1569%
(b) Myrtle Jackson Hale Heirs, Devisees, Successors or Assigns <i>Heirs/Addresses Unknown</i>	0.1255 acres 1/130 of 16.32 acres	0.1569%
(c) Carlous Jackson 1606 Old Vandyke Hollow Rd. Oakwood, VA 24631	0.0418 acres 1/390 of 16.32 acres	0.0523%
(d) Dallas Jackson 1606 Old Vandyke Hollow Rd. Oakwood, VA 24631	0.0418 acres 1/390 of 16.32 acres	0.0523%

Exhibit E
Unit U-15/B
Docket # VGOB-93-0622-0380-01
List of all Owners/Claimants in escrow

	Acres in Unit	Percent of Unit
(e) Patsy Ruth Coleman 1061 Conn Street Imperial Beach, CA 92032	0.0418 acres 1/390 of 16.32 acres	0.0523%
(f) Gracie Jackson Hale Rt. 1, Box 68-A Swords Creek, VA 24649	0.1255 acres 1/130 of 16.32 acres	0.1569%
(g) Lydia Jackson, Heirs, Devisees, Successors or Assigns <i>Heirs/Addresses Unknown</i>	0.1255 acres 1/130 of 16.32 acres	0.1569%
(h) Curtis Jackson, Heirs, Devisees, Successors or Assigns <i>Heirs/Addresses Unknown</i>	0.1255 acres 1/130 of 16.32 acres	0.1569%
(i) Ardella Jackson, Heirs, Devisees, Successors or Assigns <i>Heirs/Addresses Unknown</i>	0.1255 acres 1/130 of 16.32 acres	0.1569%
(j) Ocie Robinson, Heirs, Devisees, Successors or Assigns <i>Heirs/Addresses Unknown</i>	0.1255 acres 1/130 of 16.32 acres	0.1569%
(k) Jeff Jackson, Heirs, Devisees, Successors or Assigns <i>Heirs/Addresses Unknown</i>	0.1255 acres 1/130 of 16.32 acres	0.1569%
(l) Mary Jackson Justus, Heirs, Devisees, Successors or Assigns <i>Heirs/Addresses Unknown</i>	0.1255 acres 1/130 of 16.32 acres	0.1569%
(2) Virgie Dotson Heirs, Devisees, Successors or Assigns (1/26)		
(a) Edward Dotson Rt. 1 Box 85 Vansant, VA 24656	0.1569 acres 1/104 of 16.32 acres	0.1962%
(b) Joyce Owens P. O. Box 214 Vansant, VA 24656	0.1569 acres 1/104 of 16.32 acres	0.1962%
(c) James Dotson 24916 South Levisa Road Mouthcard, KY 41548	0.1569 acres 1/104 of 16.32 acres	0.1962%
(d) Geraldine Ratliff 1046 Parkside Drive Georgetown, KY 40324	0.1569 acres 1/104 of 16.32 acres	0.1962%
(3) Edd Looney Rt. 1, Box 74 Vansant, VA 24656	0.6277 acres 1/26 of 16.32 acres	0.7846%
(4) Kay Childress 103 1/2 Luther Street Bluefield, VA 24605	0.0251 acres 1/650 of 16.32 acres	0.0314%
(5) Ancil Childress Box 216 Rowe, VA 24646	0.0251 acres 1/650 of 16.32 acres	0.0314%

Exhibit E
Unit U-15/B
Docket # VGOB-93-0622-0380-01
List of all Owners/Claimants in escrow

	Acres in Unit	Percent of Unit
(6) L.C. Childress Heirs, Devisees, Successors or Assigns (1/650)		
(a) Annette Childress P.O. Box 301 Honaker, VA 24260	0.0084 acres 1/1950 of 16.32 acres	0.0105%
(b) Denise & Ron Blankenship P.O. Box 301 Honaker, VA 24260	0.0056 acres 1/2925 of 16.32 acres	0.0070%
(c) Karen & Richard Bostic P.O. Box 373 Swords Creek, VA 24649	0.0056 acres 1/2925 of 16.32 acres	0.0070%
(d) Deborah & Berk Artrip 277 Friendship Dr. Swords Creek, VA 24649	0.0056 acres 1/2925 of 16.32 acres	0.0070%
(7) Janice Hodock Rt. 2 Box 227 Bluefield, VA 24605	0.0251 acres 1/650 of 16.32 acres	0.0314%
(8) James H. Childress Rt. 1 Box 263-A Honaker, VA 24260	0.0251 acres 1/650 of 16.32 acres	0.0314%
(9) Lillie C. Bailey, Heirs, Devisees, Successors or Assigns <i>Heirs/Addresses Unknown</i>	0.1255 acres 1/130 of 16.32 acres	0.1569%
(10) John B. Childress Heirs, Devisees, Successors or Assigns (9/1300)		
(a) Reves Childress Box 410-L Kelly Road Gainesville, VA 22065	0.0126 acres 1/1300 of 16.32 acres	0.0157%
(b) Gertrude Mudiman 8503 Thomas Drive Manassas, VA 22110	0.0126 acres 1/1300 of 16.32 acres	0.0157%
(c) Robert E. Childress Rt. 1 Box 553-A Elkton, VA 22827	0.0126 acres 1/1300 of 16.32 acres	0.0157%
(d) Madilee Wnek 8006 Rugby Road Manassas, VA 22111	0.0126 acres 1/1300 of 16.32 acres	0.0157%
(e) Arbutus Childress c/o Madilee Wnek 8006 Rugby Road Manassas, VA 22111	0.0126 acres 1/1300 of 16.32 acres	0.0157%
(f) John R. Childress 16000 Laconia Circle Woodbridge, VA 22191	0.0126 acres 1/1300 of 16.32 acres	0.0157%
(g) Donald R. Childress 826 Glades Court NE St. Petersburg, FL 33702	0.0126 acres 1/1300 of 16.32 acres	0.0157%

Exhibit E
Unit U-15/B
Docket # VGOB-93-0622-0380-01
List of all Owners/Claimants in escrow

	Acres in Unit	Percent of Unit
(h) Zed L. Childress 13989 Dancing Twig Drive Gainesville, VA 22065	0.0126 acres 1/1300 of 16.32 acres	0.0157%
(i) Diane Blair P.O. Box 1733 Haines City, FL 33844	0.0126 acres 1/1300 of 16.32 acres	0.0157%
(11) Fayrene Childress Heirs, Devisees, Successors or Assigns (1/1300)		
(a) Michael Clayborn 823 East 6th Street Front Royal, VA 22630	0.0021 acres 1/7800 of 16.32 acres	0.0026%
(b) Steven Clayborn 10260 Battle Field Drive Manassas, VA 22110	0.0021 acres 1/7800 of 16.32 acres	0.0026%
(c) Timothy Clayborn 8103 Maplewood Manassas, VA 22111	0.0021 acres 1/7800 of 16.32 acres	0.0026%
(d) Jeffery Clayborn c/o Timothy Clayborn 8103 Maplewood Manassas, VA 22111	0.0021 acres 1/7800 of 16.32 acres	0.0026%
(e) Anthony Clayborn c/o Timothy Clayborn 8103 Maplewood Manassas, VA 22111	0.0021 acres 1/7800 of 16.32 acres	0.0026%
(f) Regina Fay Smith 10316 Trundle Place Manassas, VA 22110	0.0021 acres 1/7800 of 16.32 acres	0.0026%
(12) Vida C. Murphy, Heirs, Devisees, Successors or Assigns <i>Heirs/Addresses Unknown</i>	0.1255 acres 1/130 of 16.32 acres	0.1569%
(13) Julia C. Lowe Heirs, Devisees, Successors or Assigns (1/130)		
(a) Ira Lowe Rt. 2 Box 506 Honaker, VA 24260	0.0139 acres 1/1170 of 16.32 acres	0.0174%
(b) Lucille Blankenship Box 107A Rowe, VA 24646	0.0139 acres 1/1170 of 16.32 acres	0.0174%
(c) Sue Meade Rt. 2 Box 515 Honaker, VA 24260	0.0139 acres 1/1170 of 16.32 acres	0.0174%
(d) Helen Wyatt Box 2, Russell Street North Wilkesboro, NC	0.0139 acres 1/1170 of 16.32 acres	0.0174%
(e) Fred Lowe Rt. 2 Box 506 Honaker, VA 24260	0.0139 acres 1/1170 of 16.32 acres	0.0174%

Exhibit E
Unit U-15/B
Docket # VGOB-93-0622-0380-01
List of all Owners/Claimants in escrow

	Acres in Unit	Percent of Unit
(f) James Bill & Nancy Lowe 835 Martinsburg Rd. Mt. Vernon, OH	0.0139 acres 1/1170 of 16.32 acres	0.0174%
(g) Paul Lowe Rt. 2 Honaker, VA 24260	0.0139 acres 1/1170 of 16.32 acres	0.0174%
(h) Henry Lowe Box 2, Russell Street North Wilkesboro, NC	0.0139 acres 1/1170 of 16.32 acres	0.0174%
(i) Arbutus Smith <i>Address Unknown</i> Whitesville, WV	0.0139 acres 1/1170 of 16.32 acres	0.0174%
(14) Farley Childress P.O. Box 72 Rowe, VA 24642	0.1255 acres 1/130 of 16.32 acres	0.1569%
(15) Ronkeith Childress, Heirs, Devisees, Successors or Assigns <i>Heirs/Addresses Unknown</i>	0.1255 acres 1/130 of 16.32 acres	0.1569%
(16) Allen Childress 127 Manassas Drive Manassas Park, VA 22111	0.1255 acres 1/130 of 16.32 acres	0.1569%
(17) Lottie Childress Fields Heirs, Devisees, Successors or Assigns (1/130)		
(a) Otis Fields Heirs, Devisees, Successors or Assigns (1/260)		
(a.1) Otis John Fields 938 Miller Creek Rd. Rowe, VA 24646	0.0057 acres 1/2860 of 16.32 acres	0.0071%
(a.2) Patricia L. Hurt PO Box 1380 Honaker, VA 24260	0.0057 acres 1/2860 of 16.32 acres	0.0071%
(a.3) Lottie Randolph 8271 Hidden Valley Rd. Abingdon, VA 24210	0.0057 acres 1/2860 of 16.32 acres	0.0071%
(a.4) Barbara Sue Adams 2684 Huff Hill Rd. Hillsville, VA 24343	0.0057 acres 1/2860 of 16.32 acres	0.0071%
(a.5) Evelyn Marie Nygaard 166 Dahoon Dr. Wytheville, VA 24382	0.0057 acres 1/2860 of 16.32 acres	0.0071%
(a.6) Hazel Goad 904 Blue Ridge Dr. Blue Ridge, VA 24646	0.0057 acres 1/2860 of 16.32 acres	0.0071%
(a.7) Robert C. Fields 1066 Miller Creek Rd. Rowe, VA 24646	0.0057 acres 1/2860 of 16.32 acres	0.0071%
(a.8) Virginia Austin <i>Address Unknown</i>	0.0057 acres 1/2860 of 16.32 acres	0.0071%

Exhibit E
Unit U-15/B
Docket # VGOB-93-0622-0380-01
List of all Owners/Claimants in escrow

	Acres in Unit	Percent of Unit
(a.9) Ronald J. Fields Heirs, Devisees, Successors or Assigns <i>Heirs/Addresses Unknown</i>	0.0057 acres 1/2860 of 16.32 acres	0.0071%
(a.10) Janet Fields <i>Address Unknown</i>	0.0057 acres 1/2860 of 16.32 acres	0.0071%
(a.11) Jenkie Fields <i>Address Unknown</i>	0.0057 acres 1/2860 of 16.32 acres	0.0071%
(b) Hazel Keen, Heirs, Devisees, Successors or Assigns <i>Heirs/Addresses Unknown</i>	0.0628 acres 1/260 of 16.32 acres	0.0785%
(18) Louise Childress Hughes Heirs, Devisees, Successors or Assigns (1/130)		
(a) Alice Coleman P.O. Box 945 Abingdon, VA 24210	0.0314 acres 1/520 of 16.32 acres	0.0392%
(b) Lee Hughes P.O. Box 444 Doran, VA 24612-0444	0.0314 acres 1/520 of 16.32 acres	0.0392%
(c) Thurman Hughes 4612 New Garden St. Portsmouth, OH 45662	0.0314 acres 1/520 of 16.32 acres	0.0392%
(d) Gary Hughes Rt. 1 Box 263 Grundy, VA 24614	0.0314 acres 1/520 of 16.32 acres	0.0392%
(19) Raymond Guy & Barbara J. Boyd Box 541 Honaker, VA 24260	0.0131 acres 1/1248 of 16.32 acres	0.0163%
(20) Wanda Lee Boyd Rt. 1 Box 300-A Vansant, VA 24656	0.0131 acres 1/1248 of 16.32 acres	0.0163%
(21) Tivis Boyd, Jr. Rt. 1 Box 330-A Vansant, VA 24656	0.0131 acres 1/1248 of 16.32 acres	0.0163%
(22) Jennings Vandyke 7813 Tariton Rd. Circleville, OH 43113	0.0392 acres 1/416 of 16.32 acres	0.0490%
(23) Arthur Herman Looney 4511 Herend Place Fairfax, VA 22032	0.0392 acres 1/416 of 16.32 acres	0.0490%
(24) Clarence Looney P. O. Box 11 Caretta, WV 24821	0.0392 acres 1/416 of 16.32 acres	0.0490%
(25) Elsie L. Ratliff Rt. 1, Box 227 Vansant, VA 24656	0.0392 acres 1/416 of 16.32 acres	0.0490%

Exhibit E
Unit U-15/B
Docket # VGOB-93-0622-0380-01
List of all Owners/Claimants in escrow

	Acres in Unit	Percent of Unit
(26) Faye L. Stevens P.O. Box 65 Pagaolia, CA 95954	0.0392 acres 1/416 of 16.32 acres	0.0490%
(27) Edna L. Breeding P.O. Box 2151 Pulaski, VA 24301	0.0392 acres 1/416 of 16.32 acres	0.0490%
(28) Juanita Price Rt. 1 Box 29-A Raven, VA 24639	0.0056 acres 1/2912 of 16.32 acres	0.0070%
(29) Roger Paul Looney 7756 Pohick River Dr. Lorton, VA 22079	0.0056 acres 1/2912 of 16.32 acres	0.0070%
(30) Martha & Warren Looney 9380 Whaleys Lake Trace Jonesboro, GA 30236	0.0056 acres 1/2912 of 16.32 acres	0.0070%
(31) Charles Don Looney 10444 Greene Dr. Lorton, VA 22079	0.0056 acres 1/2912 of 16.32 acres	0.0070%
(32) Janice Carol Looney P.O. Box 301 Oakwood, VA 24631	0.0056 acres 1/2912 of 16.32 acres	0.0070%
(33) Lawrence Gary Looney P.O. Box 341 Oakwood, VA 24631	0.0056 acres 1/2912 of 16.32 acres	0.0070%
(34) Loretta Joyce Stacy P. O. Box 116 Wolford, VA 24658	0.0056 acres 1/2912 of 16.32 acres	0.0070%
(35) Clarence Childress 4000 Norris Drive Fredericksburg, VA 22401	0.3138 acres 1/52 of 16.32 acres	0.3923%
(36) Dorothy & Fred Jacobson 1741 Indian River Road Virginia Beach, VA 24356	0.0065 acres 1/2496 of 16.32 acres	0.0082%
(37) Charles L. Runyon 4233 Cardinal Lane Suffolk, VA 23434	0.0065 acres 1/2496 of 16.32 acres	0.0082%
(38) Kay Phillips Star Route, Box 21 Bell Island Road Currituck, NC 27929	0.0065 acres 1/2496 of 16.32 acres	0.0082%
(39) Kenneth Ray Runyon 4233 Cardinal Lane Suffolk, VA 23434	0.0065 acres 1/2496 of 16.32 acres	0.0082%
(40) Brenda & Gerald Armentrout 2279 Airport Road Suffolk, VA 23434	0.0065 acres 1/2496 of 16.32 acres	0.0082%

Exhibit E
Unit U-15/B
Docket # VGOB-93-0622-0380-01
List of all Owners/Claimants in escrow

	Acres in Unit	Percent of Unit
(41) Donna & Harry Cleveland 116 Burnetts Court Suffolk, VA 23434	0.0065 acres 1/2496 of 16.32 acres	0.0082%
(42) James C. Suttle 2208 Cross Street Chesapeake, VA 23323	0.0392 acres 1/416 of 16.32 acres	0.0490%
(43) Perry VanDyke Rt. 2 Box 137 Cedar Bluff, VA 24609	0.0392 acres 1/416 of 16.32 acres	0.0490%
(44) Claude & Allene VanDyke P.O. Box 92 Haysi, VA 24256	0.0392 acres 1/416 of 16.32 acres	0.0490%
(45) Granville & Thelma VanDyke Rt. 2 Box 137 Cedar Bluff, VA 24609	0.0392 acres 1/416 of 16.32 acres	0.0490%
(46) Mary VanDyke Cook P.O. Box 250 Vansant, VA 24656	0.0392 acres 1/416 of 16.32 acres	0.0490%
(47) Fred VanDyke 1069 Cox Avenue Chesapeake, VA 23323	0.0392 acres 1/416 of 16.32 acres	0.0490%
(48) Marie & Charles Hale 100 University Blvd., Apt. A23 Kingsport, TN 37660	0.0392 acres 1/416 of 16.32 acres	0.0490%
(49) Jessie G. Childress Heirs, Devisees, Successors or Assigns (31/1716)		
(a) Virginia H. Childress 6102 Violet Street Kingsport, TN 37662	0.1046 acres 1/156 of 16.32 acres	0.1308%
(b) Fay & Lee Couch 129 S. Mulberry Street Madison, IN 47220	0.0190 acres 1/858 of 16.32 acres	0.0238%
(c) Eula Hensdill Rt. 1, Box 156 Castlewood, VA 24224	0.0190 acres 1/858 of 16.32 acres	0.0238%
(d) Madeline & Karl Tucker 1253 Ovington Road Jacksonville, FL 32216	0.0190 acres 1/858 of 16.32 acres	0.0238%
(e) Eleanor & Robert Hawkins Heirs, Devisees, Successors or Assigns (1/858)		
(e.1) Joyce Hawkins Jones 840 Fairview School Road Blountville, TN 37617	0.0095 acres 1/1716 of 16.32 acres	0.0119%
(e.2) Charles Hawkins 343 Glasgow Lane Blountville, TN 37617	0.0095 acres 1/1716 of 16.32 acres	0.0119%

Exhibit E
Unit U-15/B
Docket # VGOB-93-0622-0380-01
List of all Owners/Claimants in escrow

	Acres in Unit	Percent of Unit
(f) Wanda & George Cochran, Jr. 324 First Street Gate City, VA 24251	0.0190 acres 1/858 of 16.32 acres	0.0238%
(g) Edith Presnell 3425 Memorial Street Alexander, VA 22306	0.0190 acres 1/858 of 16.32 acres	0.0238%
(h) Phyllis Everitt McKeon 4472 Dike Road Winter Park, FL 32792	0.0190 acres 1/858 of 16.32 acres	0.0238%
(i) Beatrice Raleigh Rt. 6. Lt. 59 Hawkins Mobile Park Church Hill, TN 37642	0.0190 acres 1/858 of 16.32 acres	0.0238%
(j) Carl & Claudia Childress	<i>Interest purchased by Buchanan Production C</i>	
(j.1) CNX Gas Company LLC 1000 Consol Energy Drive Canonsburg, PA 15317 <i>(Previously Buchanan Production Company)</i>	0.0190 acres 1/858 of 16.32 acres	0.0238%
(k) Emory & Katherine Childress 6102 Violet Street Kingsport, TN 37663	0.0190 acres 1/858 of 16.32 acres	0.0238%
(50) Pinkey Kitts Heirs, Devisees, Successors or Assigns (1/858)		
(a) Verna & Joseph Taylor 8703 Lonestone Road Richmond, VA 23229	0.0038 acres 1/4290 of 16.32 acres	0.0048%
(b) Louise & Lester Agee 7601 Bull Run Road Manassas, VA 22110	0.0038 acres 1/4290 of 16.32 acres	0.0048%
(c) Straley & Betty Kitts Rt. 4 Box 244 Madison Heights, VA 24572	0.0038 acres 1/4290 of 16.32 acres	0.0048%
(d) Warren & Jacqueline Kitts 5320 Twilight Road NW Roanoke, VA 24019	0.0038 acres 1/4290 of 16.32 acres	0.0048%
(e) Wendell & Angie Kitts Box 53 Bastian, VA 24314	0.0038 acres 1/4290 of 16.32 acres	0.0048%
(51) Daniel J. Looney Heirs, Devisees, Successors or Assigns (1/78)		
(a) David C. Looney 3030 Tanglewood Dr. Clearwater, FL 34621	0.1046 acres 1/156 of 16.32 acres	0.1308%
(b) Nyrell V. Looney 829 Benjamin Place Virginia Beach, VA 23435	0.1046 acres 1/156 of 16.32 acres	0.1308%
(52) John C. Looney Heirs, Devisees, Successors or Assigns (1/52)		

Exhibit E
Unit U-15/B
Docket # VGOB-93-0622-0380-01
List of all Owners/Claimants in escrow

	Acres in Unit	Percent of Unit
(a) Marceline Krause 2920 Bradley Avenue N.E. Roanoke, VA 24012	0.0628 acres 1/260 of 16.32 acres	0.0785%
(b) Harold Looney Box 125 Grundy, VA 24614	0.0628 acres 1/260 of 16.32 acres	0.0785%
(c) Jimmy B. Looney Box 745 Grundy, VA 24614	0.0628 acres 1/260 of 16.32 acres	0.0785%
(d) Larry Q. Looney Box 125 Grundy, VA 24614	0.0628 acres 1/260 of 16.32 acres	0.0785%
(e) Dollie Sue Grace Rt. 2 Lot 1 Springfield North Tazewell, VA 24630	0.0628 acres 1/260 of 16.32 acres	0.0785%
(53) Rosa Childress Heirs, Devisees, Successors or Assigns (3/208)		
(a) Ruby & Oscar White P.O. Box 580 Oakwood, VA 24631	0.0785 acres 1/208 of 16.32 acres	0.0981%
(b) Jessie Childress Box 22 Vansant, VA 24656	0.0785 acres 1/208 of 16.32 acres	0.0981%
(c) Mary C. Miller, Heirs, Devisees, Successors or Assigns <i>Heirs/Addresses Unknown</i>	0.0785 acres 1/208 of 16.32 acres	0.0981%
(54) Robert Childress Heirs, Devisees, Successors or Assigns (1/208)		
(a) Pauline M. Childress, widow Box 84 Oakwood, VA 24631	0.0262 acres 1/624 of 16.32 acres	0.0327%
(b) Nancy & Robert Childress, Jr. HC4 Box 228 Council, VA 24260	0.0174 acres 1/936 of 16.32 acres	0.0218%
(c) Patricia & Larry Blankenship P.O. Box 881 Tazewell, VA 24651	0.0174 acres 1/936 of 16.32 acres	0.0218%
(d) Steven M. Childress 4313 Dearbrook Way Lilburn, GA 30247	0.0174 acres 1/936 of 16.32 acres	0.0218%
(55) Jettie Lee Shortridge, Heirs, Devisees, Successors or Assigns <i>Heirs/Addresses Unknown</i>	0.1395 acres 1/117 of 16.32 acres	0.1744%
(56) Ferrell W. Shortridge, Heirs, Devisees, Successors or Assigns <i>Heirs/Addresses Unknown</i>	0.0465 acres 1/351 of 16.32 acres	0.0581%

Exhibit E
Unit U-15/B
Docket # VGOB-93-0622-0380-01
List of all Owners/Claimants in escrow

	Acres in Unit	Percent of Unit
(57) Frazier A. Shortridge, Heirs, Devisees, Successors or Assigns <i>Heirs/Addresses Unknown</i>	0.0465 acres 1/351 of 16.32 acres	0.0581%
(58) Judith Stiltner, Heirs, Devisees, Successors or Assigns <i>Heirs/Addresses Unknown</i>	0.0465 acres 1/351 of 16.32 acres	0.0581%
(59) Connie S. Sluder, Heirs, Devisees, Successors or Assigns <i>Heirs/Addresses Unknown</i>	0.0465 acres 1/351 of 16.32 acres	0.0581%
(60) Mable Mullins HCR Box 50-B Grundy, VA 24614	0.0465 acres 1/351 of 16.32 acres	0.0581%
(61) Harold Shortridge 521 Suffolk Avenue Richlands, VA 24641	0.0465 acres 1/351 of 16.32 acres	0.0581%
(62) Hettie Elswick Hess Heirs, Devisees, Successors or Assigns (1/39)		
(a) Bernard Elswick Heirs, Devisees, Successors or Assigns		
(a.1) Nara Elswick, widow 11 South Meadow Drive Glen Burnic, MD 21060	0.1395 acres 1/117 of 16.32 acres	0.1744%
(b) Corina E. Nuckles 7366 Woodlawn Lane Warrenton, VA 20187-8953	0.1395 acres 1/117 of 16.32 acres	0.1744%
(c) Mrs. Arbutus Baldauf RR3 Box 306B Seaford, DE 19973-7517	0.1395 acres 1/117 of 16.32 acres	0.1744%
(63) Thurman Shortridge, Heirs, Devisees, Successors or Assigns <i>Heirs/Addresses Unknown</i>	0.4185 acres 1/39 of 16.32 acres	0.5231%
(64) Ruby McGlothlin 8607 Virginia Avenue Annadale, VA 22003	0.0349 acres 1/468 of 16.32 acres	0.0436%
(65) John Pevny 13036 Sheffield Drive Pickerington, OH 43147	0.0349 acres 1/468 of 16.32 acres	0.0436%
(66) Kenneth S. McGlothlin 1759 25th Avenue Vero Beach, FL 32960	0.0349 acres 1/468 of 16.32 acres	0.0436%
(67) Pamela Jones 5324 E. Diamond Mesa, AZ 85206	0.0131 acres 1/1248 of 16.32 acres	0.0163%
(68) Carol & Sparky Barnett 5324 E. Diamond Mesa, AZ 85206	0.0131 acres 1/1248 of 16.32 acres	0.0163%

Exhibit E
Unit U-15/B
Docket # VGOB-93-0622-0380-01
List of all Owners/Claimants in escrow

	Acres in Unit	Percent of Unit
(69) Anna Hammer P.O. Box 51417 Phoenix, AZ 85076-1417	0.0262 acres 1/624 of 16.32 acres	0.0327%
(70) Glen Arthur Starkey 1132 W. Southern Avenue Tolleson, AZ 85353	0.0262 acres 1/624 of 16.32 acres	0.0327%
(71) The Starkey Family Trust c/o Marilyn Starkey, Trustee 123 N. Shamrock Ave. Monrovia, CA 91016	0.0262 acres 1/624 of 16.32 acres	0.0327%
(72) Julie S. McCoy, Heirs, Devisees Successors or Assigns		
(a) Nellie Crothers 550 Basin Run Road Conowingo, MD 21918	0.1046 acres 1/156 of 16.32 acres	0.1308%
(73) Carrie McGlothlin Heirs, Devisees, Successors or Assigns		
(a) Luther H. McGlothlin Heirs, Devisees, Successors or Assigns		
(a.1) Melissa Ann Kugler 139 Harmony Crest Drive Newark, DE 19713	0.0523 acres 1/312 of 16.32 acres	0.0654%
(b) Warren McGlothlin Heirs Devisees, Successors or Assigns (1/312)		
(b.1) Debra Susan McGlothlin 64 Rowlandsville Road Conowingo, MD 21918	0.0262 acres 1/624 of 16.32 acres	0.0327%
(b.2) Allen Neal McGlothlin 40 McGlothlin Road Conowingo, MD 21918	0.0262 acres 1/624 of 16.32 acres	0.0327%
(74) Arbutus McGlothlin Heirs, Devisees, Successors or Assigns		
(a) Cynthia McGlothlin 2220 Porter Road Bear, DE 19701	0.1046 acres 1/156 of 16.32 acres	0.1308%
(75) Mae McGlothlin Heirs, Devisees, Successors or Assigns	<i>Interest went to Janet McGrath, along with wh. already inherited. (1/1170 and 1/468)</i>	
(76) John & Janet McGrath 9027 East Broadway Mesa, AZ 85208	0.0488 acres 7/2340 of 16.32 acres	0.0610%
(77) June & Donald Donaldson 1273 Carr Avenue Memphis, TN 38104	0.0139 acres 1/1170 of 16.32 acres	0.0174%
(78) Marlene M. Pardi 8711 E. Pinnacle Peak Road, PMB295 Scottsdale, AZ 85255	0.0139 acres 1/1170 of 16.32 acres	0.0174%

Exhibit E
Unit U-15/B
Docket # VGOB-93-0622-0380-01
List of all Owners/Claimants in escrow

	Acres in Unit	Percent of Unit
(79) George & Alberta McGlothlin 6473 County Road #218 Jacksonville, FL 32234	0.0139 acres 1/1170 of 16.32 acres	0.0174%
(80) Stephen & Naia McGlothlin 746 East 8th Avenue Mesa, AZ 85204	0.0139 acres 1/1170 of 16.32 acres	0.0174%
(81) Delford & Mary McGlothlin	<i>Interest was purchased by Buchanan Producti</i>	
(a) CNX Gas Company LLC 1000 Consol Energy Drive Canonsburg, PA 15317 <i>(Previously Buchanan Production Company)</i>	0.1046 acres 1/156 of 16.32 acres	0.1308%
(82) Virginia I. Shinault Heirs, Devisees, Successors or Assigns (1/156)		
(a) Charles F. Jones 223 McGlothlin Road Conowingo, MD 21918	0.0349 acres 1/468 of 16.32 acres	0.0436%
(b) The Melony Richards Trust c/o Anthony G. Richards 3955 Oakland Street Cocoa, FL 32927	0.0349 acres 1/468 of 16.32 acres	0.0436%
(c) Patricia Edler 4345 Fairfax Street Cocoa, FL 32927-3901	0.0349 acres 1/468 of 16.32 acres	0.0436%
(83) John D. McGlothlin 111 Peppermint Drive Port Deposit, MD 21904-1365	0.1046 acres 1/156 of 16.32 acres	0.1308%
(84) Nellie J. McGlothlin Estate c/o Orpha J. Shmel, Executrix 626 Biggs Highway Rising Sun, MD 21911	0.1046 acres 1/156 of 16.32 acres	0.1308%
(85) Doris C. McGlothlin, Heirs, Devisees, Successors or Assigns		
(a) Roger McGlothlin 7633 Wilson Blvd. Jacksonville, FL 32210	0.1046 acres 1/156 of 16.32 acres	0.1308%
(86) Nancy M. Griffin 5746 Firestone Road Jacksonville, FL 32244	0.0070 acres 1/2340 of 16.32 acres	0.0087%
(87) John M. McGlothlin 8077 Wilson Blvd. Jacksonville, FL 32210-3551	0.0108 acres 7/10530 of 16.32 acres	0.0136%
(88) Herman T. McGlothlin 930 Flagg Springs Road Lynnville, TN 38472	0.0108 acres 7/10530 of 16.32 acres	0.0136%
(89) Kenneth P. McGlothlin Heirs, Devisees, Successors or Assigns		

Exhibit E
Unit U-15/B
Docket # VGOB-93-0622-0380-01
List of all Owners/Claimants in escrow

	Acres in Unit	Percent of Unit
(a) Christine L. McGlothlin 1651 Alexander Lane Grants Pass, OR 97527	0.0108 acres 7/10530 of 16.32 acres	0.0136%
(90) Nelson E. McGlothlin 16386 Campbellsville Road Lynnville, TN 38472	0.0108 acres 7/10530 of 16.32 acres	0.0136%
(91) Jacob L. McGlothlin 860 Tookie Road Jacksonville, FL 32234	0.0108 acres 7/10530 of 16.32 acres	0.0136%
(92) David A. McGlothlin 181 Sonja Ellen Drive Jacksonville, FL 32234	0.0108 acres 7/10530 of 16.32 acres	0.0136%
(93) Phyllis D. Cline 424 Woodland Drive St. Albans, WV 25177	0.0108 acres 7/10530 of 16.32 acres	0.0136%
(94) Carol E. Lynch 43180 Oyster Bay Drive Hollywood, MD 20636	0.0108 acres 7/10530 of 16.32 acres	0.0136%
(95) Orpha J. Schlarbaum Heirs, Devisees, Successors or Assigns		
(a) Jessie L. Schlarbaum c/o Circle of Hope Inc. Assisted Living Facilit 1550 W. 9th Street Jacksonville, FL 32209	0.0027 acres 133/800000 of 16.32 acres	0.0034%
(b) George M. Schlarbaum P.O. Box 1410 St. Mary, FL 32040-1410	0.0027 acres 133/800000 of 16.32 acres	0.0034%
(c) Emory J. Schlarbaum 4709 Daughtry Blvd. East Jacksonville, FL 32210	0.0027 acres 133/800000 of 16.32 acres	0.0034%
(d) Ty Cobb Schlarbaum 1015 Green St. Oskaloosa, IA 52577	0.0027 acres 133/800000 of 16.32 acres	0.0034%
(96) Lonzo Murphy, Heirs, Devisees, Successors or Assigns <i>Heirs/Addresses Unknown</i>	1.2554 acres 1/13 of 16.32 acres	1.5692%
(97) Vernie S. Baldrige Heirs, Devisees, Successors or Assigns (1/143)		
(a) Opal Coleman 18998 Rd I-18 Continental, OH 45831	0.0163 acres 1/1001 of 16.32 acres	0.0204%
(b) Lillian Griffith Ball Road, Rt. 5, House #20801 Defiance, OH 43512	0.0163 acres 1/1001 of 16.32 acres	0.0204%
(c) Helen Meade Ball Road, Rt. 5, House #20767 Defiance, OH 43512	0.0163 acres 1/1001 of 16.32 acres	0.0204%

Exhibit E
Unit U-15/B
Docket # VGOB-93-0622-0380-01
List of all Owners/Claimants in escrow

	Acres in Unit	Percent of Unit
(d) Billy Baldrige 14382 Row B Leipsie, OH 45856	0.0163 acres 1/1001 of 16.32 acres	0.0204%
(e) Elmer Baldrige Rt. 7, Arena Drive Defiance, OH 43512	0.0163 acres 1/1001 of 16.32 acres	0.0204%
(f) Willmer Baldrige Slusser Drive Rt. 7 Defiance, OH 43512	0.0163 acres 1/1001 of 16.32 acres	0.0204%
(g) Buddy Baldrige Woodland Park, Apt. #408 10401 North 33rd Avenue Phoenix, AZ 85051	0.0163 acres 1/1001 of 16.32 acres	0.0204%
(98) Ora M. Baldrige c/o Mavis Grinnell 14495 Marrice Road Perry, MI 48872	0.1141 acres 1/143 of 16.32 acres	0.1427%
(99) Effie Looney (Shortridge?) Heirs, Devisees, Successors or Assigns (1/143)		
(a) Roger Lee Shortridge 695 Long Level Rd., SW Floyd, VA 24091	0.0571 acres 1/286 of 16.32 acres	0.0713%
(b) Lois S. Horne Heirs, Devisees, Successors or Assigns		
(b.1) Larry V. Horne 645 Long Level Rd., SW Floyd, VA 24091	0.0190 acres 1/858 of 16.32 acres	0.0238%
(b.2) Keith D. Horne 534 Morre Rd., NE Floyd, VA 24091	0.0190 acres 1/858 of 16.32 acres	0.0238%
(b.3) Sharon H. Beasley PO Box 1525 Hillsville, VA 24343	0.0190 acres 1/858 of 16.32 acres	0.0238%
(100) Nell K. Branham P.O. Box 1756 Richlands, VA 24641	0.1141 acres 1/143 of 16.32 acres	0.1427%
(101) Roy B. McGlothlin 372 Pleasant Hill Blountville, TN	0.1141 acres 1/143 of 16.32 acres	0.1427%
(102) Jessie McGlothlin 218 E. Central Avenue Bristol, TN 37620	0.1141 acres 1/143 of 16.32 acres	0.1427%
(103) Ed Harold McGlothlin 201 Aldrich Rd. Vermillion, OH 44089	0.1141 acres 1/143 of 16.32 acres	0.1427%
(104) Dale R. McGlothlin Rt. 4 Box 208A Grundy, VA 24614	0.1141 acres 1/143 of 16.32 acres	0.1427%

Exhibit E
Unit U-15/B
Docket # VGOB-93-0622-0380-01
List of all Owners/Claimants in escrow

	Acres in Unit	Percent of Unit
(105) Etta Ruth M. & Charles Justice P.O. Box 248 Big Rock, VA 24603	0.1141 acres 1/143 of 16.32 acres	0.1427%
(106) Juanita McGlothlin Rt. 4 Box 208A Grundy, VA 24614	0.1141 acres 1/143 of 16.32 acres	0.1427%
(107) Franklin McGlothlin Rt. 4 Box 208A Grundy, VA 24614	0.1141 acres 1/143 of 16.32 acres	0.1427%
(108) Rosa M. Norman P.O. Box 476 Vansant, VA 24656	0.4185 acres 1/39 of 16.32 acres	0.5231%
(109) Pearl M. Matney, Heirs, Devisees, Successors or Assigns <i>Heirs/Addresses Unknown</i>	0.0930 acres 2/351 of 16.32 acres	0.1162%
(110) Sally C. Hatfield, Heirs, Devisees, Successors or Assigns <i>Heirs/Addresses Unknown</i>	0.0930 acres 2/351 of 16.32 acres	0.1162%
(111) Roy McGlothlin Heirs, Devisees, Successors or Assigns (2/351)		
(a) Elsie McGlothlin 739 Crestwood Dr. Richlands, VA 24641	0.0310 acres 2/1053 of 16.32 acres	0.0387%
(b) James B. McGlothlin 739 Crestwood Dr. Richlands, VA 24641	0.0207 acres 4/3159 of 16.32 acres	0.0258%
(c) Sue Bowlin 2466 Brights Pike Morristown, TN 37814	0.0207 acres 4/3159 of 16.32 acres	0.0258%
(d) Ronnie McGlothlin Kents Ridge Cedar Bluff, VA 24609	0.0207 acres 4/3159 of 16.32 acres	0.0258%
(112) John McGlothlin, Jr., Heirs, Devisees, Successors or Assigns <i>Heirs/Addresses Unknown</i>	0.0930 acres 2/351 of 16.32 acres	0.1162%
(113) Kermit McGlothlin Rt. 2 Box 656 Vansant, VA 24656	0.0930 acres 2/351 of 16.32 acres	0.1162%
(114) Leonard McGlothlin, Heirs, Devisees, Successors or Assigns <i>Heirs/Addresses Unknown</i>	0.0930 acres 2/351 of 16.32 acres	0.1162%
(115) Samie G. McGlothlin, Heirs, Devisees, Successors or Assigns <i>Heirs/Addresses Unknown</i>	0.0930 acres 2/351 of 16.32 acres	0.1162%
(116) Victory McGlothlin, Heirs, Devisees, Successors or Assigns <i>Heirs/Addresses Unknown</i>	0.0930 acres 2/351 of 16.32 acres	0.1162%

Exhibit E
Unit U-15/B
Docket # VGOB-93-0622-0380-01
List of all Owners/Claimants in escrow

	Acres in Unit	Percent of Unit
(117) Buford Lee McGlothlin P.O. Box 69 Oakwood, VA 24631	0.0930 acres 2/351 of 16.32 acres	0.1162%
(118) Ethel Shortridge 4401 Roosevelt Blvd. Dearborn Hts., MI 48125	0.0966 acres 1/169 of 16.32 acres	0.1207%
(119) Bea Johnson 3420 East Bonner Dr. Norfolk, VA 23501	0.0966 acres 1/169 of 16.32 acres	0.1207%
(120) June Arms Rt. 1, Box 177 Vansant, VA 24656	0.0966 acres 1/169 of 16.32 acres	0.1207%
(121) Edd Shortridge RR5 Box 485 Grundy, VA 24614	0.0966 acres 1/169 of 16.32 acres	0.1207%
(122) Hassell Shortridge 1226 Stringer Rd. Belton, SC 29627	0.0966 acres 1/169 of 16.32 acres	0.1207%
(123) Lola Skeens 902 Hammonds Lane Baltimore, MD 21225	0.0966 acres 1/169 of 16.32 acres	0.1207%
(124) Carl Shortridge Rt. 2 Box 14A Grundy, VA 24614	0.0966 acres 1/169 of 16.32 acres	0.1207%
(125) Faye Delroseers 1809 Skyline Dr. Norfolk, VA 23500	0.0966 acres 1/169 of 16.32 acres	0.1207%
(126) Paul Shortridge 1520 McWhorter Rd. London, KY 40741	0.0966 acres 1/169 of 16.32 acres	0.1207%
(127) Marlene Rife P.O. Box 255 Pilgrim Knob, VA 24634	0.0966 acres 1/169 of 16.32 acres	0.1207%
(128) Johnny M. Shortridge Jr. HC67 Box 6A Vansant, VA 24656	0.0966 acres 1/169 of 16.32 acres	0.1207%
(129) Freddie Shortridge HRC Vansant, VA 24656	0.0966 acres 1/169 of 16.32 acres	0.1207%
(130) Irene Stacy 1336 Kenworth Drive Conway, SC 29526	0.0966 acres 1/169 of 16.32 acres	0.1207%
(131) Bennie McGlothlin Rt.4 Box 420 Gate City, VA 24251	0.0761 acres 2/429 of 16.32 acres	0.0951%

Exhibit E
Unit U-15/B
Docket # VGOB-93-0622-0380-01
List of all Owners/Claimants in escrow

	Acres in Unit	Percent of Unit
(132) Bonnie McGlothlin 2267 Roberts Creek Rd. Hiltons, VA 24258	0.0761 acres 2/429 of 16.32 acres	0.0951%
(133) Ralph Edward McGlothlin 94 Collins Crest Cedar Bluff, VA 24609	0.0761 acres 2/429 of 16.32 acres	0.0951%
(134) Patricia S. McGlothlin 6293 Wilderness Road Dublin, VA 24084	0.1141 acres 1/143 of 16.32 acres	0.1427%
(135) Ruby B. McGlothlin Heirs, Devisees, Successors or Assigns		
(a) Ann M. Lilly 16540 Heron Coach Way #406 Fort Meyers, FL 33908	0.1141 acres 1/143 of 16.32 acres	0.1427%
(136) Helen E. Counts Heirs, Devisees, Successors or Assigns (2/143)		
(a) Bascom "Buddy" B. B. Matney 4841 25th Road Nth Arlington, VA 22207-2648	0.0761 acres 2/429 of 16.32 acres	0.0951%
(b) Helen Carol Mamone 600 Alexandria Circle Bluefield, VA 24605-9241	0.0761 acres 2/429 of 16.32 acres	0.0951%
(c) Ann C. Rauehauser 28 Bog Meadow Road Sharon, CT 06069	0.0761 acres 2/429 of 16.32 acres	0.0951%
(137) Frankie Mae Street Heirs, Devisees, Successors or Assigns (2/143)		
(a) W.A. Street Heirs Trust		
(a.1) W.A. Street Heirs Trust c/o Hiram A. Street 4601 Gulf Shore Blvd., North Enclave No. 10 Naples, FL 33910	0.0571 acres 1/286 of 16.32 acres	0.0713%
(a.2) W.A. Street Heirs Trust c/o Nicholas D. Street 101 Lick Branch Rd. Bristol, TN 37620	0.0571 acres 1/286 of 16.32 acres	0.0713%
(a.3) W.A. Street Heirs Trust c/o James H. Street PO Box 2100 Grundy, VA 24614	0.0571 acres 1/286 of 16.32 acres	0.0713%
(a.4) W.A. Street Heirs Trust c/o Daniel Street PO Box 2100 Grundy, VA 24614	0.0571 acres 1/286 of 16.32 acres	0.0713%

The interest of heirs in yellow are now a part of the W.A. Street Heirs Trust

Exhibit E
Unit U-15/B
Docket # VGOB-93-0622-0380-01
List of all Owners/Claimants in escrow

	Acres in Unit	Percent of Unit
<p>Gaynell S. Fowler 28201 Alfred Moore Ct. Bonita Springs, FL 34135</p> <p>James H. Street PO Box 1475 Grundy, VA 24614</p> <p>Marcus A. Street PO Box 1475 Grundy, VA 24614</p> <p>Robert D. Street PO Box 1869 Corvallis, OR 97339-1869</p> <p>David A. Street P. O. Box 1475 Grundy, VA 24614</p> <p>Lauren F. Street 14684 Old Jonesboro Road Bristol, VA 24202</p> <p>Russell K. Street 1004 Thornehill Dr. Anderson, SC 29621</p>		
(138) Joseph Blair McGlothlin P. O. Box 71 Cedar Bluff, VA 24609	0.1141 acres 1/143 of 16.32 acres	0.1427%
(139) Katherine M. & John Warren 2208 Wingfield Road Charlottesville, VA 22901	0.1141 acres 1/143 of 16.32 acres	0.1427%
(140) Nannie P. Lockhart Heirs, Devisees, Successors or Assigns		
(a) Violet Doris Smith 9625 Alfaree Rd. Richmond, VA 23237	0.1141 acres 1/143 of 16.32 acres	0.1427%
(b) Fred Presley 6815 Pounding Mill Branch Rd. Pounding Mill, VA 24637	0.1141 acres 1/143 of 16.32 acres	0.1427%
(141) Mary & D.A. McGlothlin, Sr. P.O. Box 909 Grundy, VA 24614	0.0761 acres 2/429 of 16.32 acres	0.0951%
(142) Billy Sue Dixon Heirs, Devisees, Successors or Assigns		
(a) Hobart Dixon Heirs, Devisees, Successors or Assigns (2/249)		
(a.1) Kenna Dixon Moose 309 Lindsey Street Bristol, VA 24201	0.0380 acres 1/429 of 16.32 acres	0.0476%
(a.2) Michael McKinley Dixon 21045 Campground Rd. Bristol, VA 24202	0.0380 acres 1/429 of 16.32 acres	0.0476%

Exhibit E
Unit U-15/B
Docket # VGOB-93-0622-0380-01
List of all Owners/Claimants in escrow

	Acres in Unit	Percent of Unit
(143) Peggy & Henry Durham 607 S. Westland Ave. Tampa, FL 33606	0.0761 acres 2/429 of 16.32 acres	0.0951%
(144) Rose Myrtle Wampler Heirs, Devisees, Successors or Assigns		
(a) Sherry W. Bennett 155 Mountain Ave Rocky Mount, VA 24151	0.0761 acres 2/429 of 16.32 acres	0.0951%
(b) Pauline W. Shortridge 9217 Brentsville Road Manassas, VA 20112	0.0761 acres 2/429 of 16.32 acres	0.0951%
(c) F.E. Wampler 22784 Osprey Ridge Road Bristol, VA 24202	0.0761 acres 2/429 of 16.32 acres	0.0951%
(145) Woodrow & Sally McGlothlin Heirs, Devisees, Successors or Assigns		
(a) James W. McGlothlin 1005 Glenway Ave. Bristol, VA 24201	0.0761 acres 2/429 of 16.32 acres	0.0951%
(b) Thomas D. McGlothlin 112 Plox Creek Bristol, TN 37620	0.0761 acres 2/429 of 16.32 acres	0.0951%
(c) Michael G. McGlothlin PO Drawer 810 Grundy, VA 24614	0.0761 acres 2/429 of 16.32 acres	0.0951%
(146) Doris Ann McGlothlin P. O. Box 428 Raven, VA 24639	0.0652 acres 4/1001 of 16.32 acres	0.0815%
(147) Cecil Borkey Heirs, Devisees, Successors or Assigns		
(a) Francis Ann Borkey 9608 Gaslight Place Richmond, VA 23229	0.0326 acres 2/1001 of 16.32 acres	0.0408%
(148) Betty & James Lloyd McGlothlin 998 Glenwood St. Cedar Bluff, VA 24609	0.0326 acres 2/1001 of 16.32 acres	0.0408%
(149) Una Lee Mulligan Bailey Box 51 Richlands, VA 24641	0.0326 acres 2/1001 of 16.32 acres	0.0408%
(150) Cecil Earl McGlothlin Heirs, Devisees, Successors or Assigns		
(a) McGlothlin Living Trust c/o Joyce McGlothlin, Trustee PO Box 2417 Cookeville, TN 38502	0.0326 acres 2/1001 of 16.32 acres	0.0408%
(151) Norman McGlothlin 6239 Oak Leaf Ln. N. Fayetteville, PA 17222	0.0326 acres 2/1001 of 16.32 acres	0.0408%

Exhibit E
Unit U-15/B
Docket # VGOB-93-0622-0380-01
List of all Owners/Claimants in escrow

	Acres in Unit	Percent of Unit
(152) Dorothy Mullins Heirs, Devisees, Successors or Assigns		
(a) Ann Mullins Washburn 3343 Notingham Drive Tallahassee, FL 32312	0.0380 acres 1/429 of 16.32 acres	0.0476%
(b) Mike Mullins 1445 Westerly Terrace Los Angeles, CA 90026	0.0380 acres 1/429 of 16.32 acres	0.0476%
(153) Charles Robert Dixon Heirs, Devisees, Successors or Assigns		
(a) Charleen Dixon Seale 2653 Suffolk St. Kingsport, TN 37660	0.0761 acres 2/429 of 16.32 acres	0.0951%
(154) Gladys Jessee 413 North Street Richlands, VA 24641	0.0761 acres 2/429 of 16.32 acres	0.0951%
(155) CNX Gas Company LLC 1000 Consol Energy Drive Canonsburg, PA 15317 <i>(previously Buchanan Production Company)</i>	0.4185 acres 1/39 of 16.32 acres	0.5231%

Acres	16.3200
Percent	20.4000%
TOTALS:	
Acres Remaining in Escrow	16.4902
Percentage Remaining in Escrow	20.6128%

Exhibit EE
Unit U-15/B
Docket # VGOB-93-0622-0380-01
List of Owners with Royalty Splits/Court Orders/HB2058

		Acres in Unit	Percent of Unit	Division of Interest in		
				1 East 15.4930%	2 East 26.8990%	Percent of Escrow
Tract #3, 7.49 Acres						
<u>COAL OWNERSHIP</u>						
(1)	H-W Financial, LLC, Big Axe Tr.4 P.O. Box 11000 Danville, VA 24543	7.49 acres	9.3625%	1.45053%	2.51842%	13.3694% - 50% (Royalty Split)
<u>OIL & GAS OWNERSHIP</u>						
(1)	Jessie Childress Heirs, et al. (33.34 Acre Tract)	7.49 acres	9.3625%	1.45053%	2.51842%	
(a)	Virginia H. Childress	Conveyed to BPC 10/21/94 DB 429/385				
(b)	Nellie Fay Couch	Conveyed to BPC 9/27/94 DB 428/429				
(b.1)	Buchanan Production Company	Merger with CNX Gas Co LLC 3/31/03 DB 617/576				
(b.1.1)	CNX Gas Company LLC PO Box 643830 Pittsburgh, PA 15264-3830 (previously Buchanan Production Company)	0.511 acres 3/44 of 7.49 acres	0.6384%	0.09890%	0.17171%	1.0724% - 50% (Royalty Split)
(c)	Eula Childress Hensdill	Conveyed to BPC 10/3/94 DB 428/431				
(c.1)	Buchanan Production Company	Merger with CNX Gas Co LLC 3/31/03 DB 617/576				
(c.1.1)	CNX Gas Company LLC PO Box 643830 Pittsburgh, PA 15264-3830 (previously Buchanan Production Company)	0.511 acres 3/44 of 7.49 acres	0.6384%	0.09890%	0.17171%	1.0724% - 50% (Royalty Split)
(d)	Madeline Childress Tucker	Conveyed to BPC 10/14/94 DB 429/389				
(d.1)	Buchanan Production Company	Merger with CNX Gas Co LLC 3/31/03 DB 617/576				
(d.1.1)	CNX Gas Company LLC PO Box 643830 Pittsburgh, PA 15264-3830 (previously Buchanan Production Company)	0.511 acres 3/44 of 7.49 acres	0.6384%	0.09890%	0.17171%	1.0724% - 50% (Royalty Split)
(e)	Eleanor Hankins Heirs, Devisees, Successors or Assigns					
(e.1)	Robert B. Hawkins, Jr., Heirs, Devisees, Successors or Assigns					
(e.1.2)	Joyce Hawkins Jones 840 Fairview School Rd Blountville, TN 37617	0.170 acres 1/44 of 7.49 acres	0.2128%	0.03297%	0.05724%	0.7149% HB2058
(e.1.3)	Charles Hawkins 343 Glasgow Ln Blountville, TN 37617	0.170 acres 1/44 of 7.49 acres	0.2128%	0.03297%	0.05724%	0.7149% HB2058
(f)	Wanda Childress Cochran	Conveyed to Virginia H. Childress 10/11/94 DB 429/381				
(f.1)	Virginia H. Childress	Conveyed to BPC 10/11/94 DB 429/385				
(f.1.1)	Buchanan Production Company	Merger with CNX Gas Co LLC 3/31/03 DB 617/576				
(f.1.1.1)	CNX Gas Company LLC PO Box 643830 Pittsburgh, PA 15264-3830 (previously Buchanan Production Company)	0.511 acres 3/44 of 7.49 acres	0.6384%	0.09890%	0.17171%	1.0724% - 50% (Royalty Split)

Exhibit EE
Unit U-15/B
Docket # VGOB-93-0622-0380-01
List of Owners with Royalty Splits/Court Orders/HB2058

	Acres in Unit	Percent of Unit	Division of Interest in		
			1 East 15.4930%	2 East 26.8990%	Percent of Escrow
(g) Edith Virginia Presnell	<i>Conveyed to BPC 10/24/94 DB 429/391</i>				
(g.1) Buchanan Production Company	<i>Merger with CNX Gas Co LLC 3/31/03 DB 617/576</i>				
(g.1.1) CNX Gas Company LLC PO Box 643830 Pittsburgh, PA 15264-3830 <i>(previously Buchanan Production Company)</i>	0.511 acres 3/44 of 7.49 acres	0.6384%	0.09890%	0.17171%	1.0724% (Royalty Split) - 50%
(h) Phyllis Everett McKeon 4472 Dike Road Winter Park, FL 32792	0.511 acres 3/44 of 7.49 acres	0.6384%	0.09890%	0.17171%	2.1448% HB2058
(i) Beatrice Childress Raleigh	<i>Conveyed to BPC 9/29/94 DB 428/433</i>				
(i.1) Buchanan Production Company	<i>Merger with CNX Gas Co LLC 3/31/03 DB 617/576</i>				
(i.1.1) CNX Gas Company LLC PO Box 643830 Pittsburgh, PA 15264-3830 <i>(previously Buchanan Production Company)</i>	0.511 acres 3/44 of 7.49 acres	0.6384%	0.09890%	0.17171%	1.0724% (Royalty Split) - 50%
(j) Carl C. Childress	<i>Conveyed to BPC 9/29/94 DB 428/433</i>				
(j.1) Buchanan Production Company	<i>Merger with CNX Gas Co LLC 3/31/03 DB 617/576</i>				
(j.1.1) CNX Gas Company LLC PO Box 643830 Pittsburgh, PA 15264-3830 <i>(previously Buchanan Production Company)</i>	0.511 acres 3/44 of 7.49 acres	0.6384%	0.09890%	0.17171%	1.0724% (Royalty Split) - 50%
(k) Emory Childress	<i>Conveyed to Virginia H. Childress 10/11/94 DB 429/381</i>				
(k.1) Virginia H. Childress	<i>Conveyed to BPC 10/11/94 DB 429/385</i>				
(k.1.1) Buchanan Production Company	<i>Merger with CNX Gas Co LLC 3/31/03 DB 617/576</i>				
(k.1.1.1) CNX Gas Company LLC PO Box 643830 Pittsburgh, PA 15264-3830 <i>(previously Buchanan Production Company)</i>	0.511 acres 3/44 of 7.49 acres	0.6384%	0.09890%	0.17171%	1.0724% (Royalty Split) - 50%
(l) Pinkie Edna Kitts Heirs, Devises, Successors or Assigns					
(l.1) Verna Taylor	<i>Conveyed to BPC 10/21/94 DB 430/26</i>				
(l.1.1) Buchanan Production Company	<i>Merger with CNX Gas Co LLC 3/31/03 DB 617/576</i>				
(l.1.1.1) CNX Gas Company LLC PO Box 643830 Pittsburgh, PA 15264-3830 <i>(previously Buchanan Production Company)</i>	0.102 acres 3/220 of 7.49 acres	0.1277%	0.01978%	0.03434%	0.2145% (Royalty Split) - 50%
(l.2) Louise Agee 7601 Bull Run Road Manassas, VA 22110	0.102 acres 3/220 of 7.49 acres	0.1277%	0.01978%	0.03434%	0.4290% HB2058
(l.3) Straley D. Kitts	<i>Conveyed to BPC 10/6/94 DB 428/437</i>				
(l.3.1) Buchanan Production Company	<i>Merger with CNX Gas Co LLC 3/31/03 DB 617/576</i>				
(l.3.1.1) CNX Gas Company LLC PO Box 643830 Pittsburgh, PA 15264-3830 <i>(previously Buchanan Production Company)</i>	0.102 acres 3/220 of 7.49 acres	0.1277%	0.01978%	0.03434%	0.2145% (Royalty Split) - 50%

Exhibit EE
Unit U-15/B
Docket # VGOB-93-0622-0380-01
List of Owners with Royalty Splits/Court Orders/HB2058

	Acres in Unit	Percent of Unit	Division of Interest in		
			1 East 15.4930%	2 East 26.8990%	Percent of Escrow
(I.4) R. Warren Kitts	<i>Conveyed to BPC 10/6/94 DB 428/435</i>				
(I.4.1) Buchanan Production Company	<i>Merger with CNX Gas Co LLC 3/31/03 DB 617/576</i>				
(I.4.1.1) CNX Gas Company LLC PO Box 643830 Pittsburgh, PA 15264-3830 <i>(previously Buchanan Production Company)</i>	0.102 acres 3/220 of 7.49 acres	0.1277%	0.01978%	0.03434%	0.2145% - 50% (Royalty Split)
(I.5) George Wendell Kitts	<i>Conveyed to BPC 10/6/94 DB 429/387</i>				
(I.5.1) Buchanan Production Company	<i>Merger with CNX Gas Co LLC 3/31/03 DB 617/576</i>				
(I.5.1.1) CNX Gas Company LLC PO Box 643830 Pittsburgh, PA 15264-3830 <i>(previously Buchanan Production Company)</i>	0.102 acres 3/220 of 7.49 acres	0.1277%	0.01978%	0.03434%	0.2145% - 50% (Royalty Split)
(c) CNX Gas Company LLC PO Box 643830 Pittsburgh, PA 15264-3830 <i>(previously Buchanan Production Company)</i>	1.873 acres 1/4 of 7.49 acres	2.3406%	0.36263%	0.62960%	3.9322% - 50% (Royalty Split)
<u>TOTAL CONFLICT RESOLVED</u>					
		Acres	7.3198		
		Percent	9.1497%		

AFFIDAVIT OF MAILING

COMMONWEALTH OF VIRGINIA
COUNTY OF **BUCHANAN**

Applicant: CNX Gas Company LLC
Relief Sought: Disbursement Petition for U15
VGOB: 93-0622-0380-01

I, Anita D. Duty, after being duly sworn upon oath, state as follows:

1. I am the Pooling Supervisor for CNX Land Resources, Inc. and am responsible for the notification process required by Va. Code Ann. §45.1-361.19 of the Code of Virginia and 4VAC25-160-40.

2. That on September 9, 2016 a true and correct copy of the Notice of Hearing and Exhibits were mailed, via certified mail return receipt requested, based upon information and belief, the names and last-known addresses, where such addresses are known, of the parties owning an interest in this cause are set forth and attached hereto.

3. Notice of this cause has therefore been served by mail pursuant to the applicable statutes and rules of the Board.

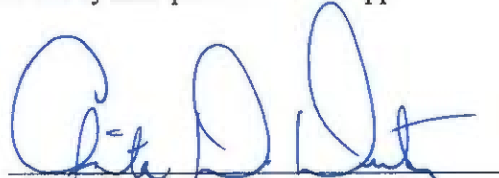

Anita D. Duty
Pooling Supervisor
for CNX Land LLC

STATE OF VIRGINIA

COUNTY OF TAZEWELL, TO-WIT:

TAKEN, SUBSCRIBED AND SWORN to before me this 22 day of Sept,
2016.



Notary Public

My commission expires: 3/31/20

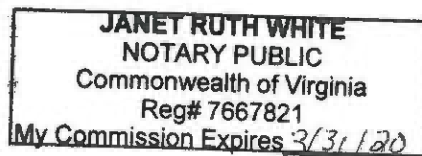

CERTIFICATION OF NOTICE
CNX Gas Company LLC

Unit U15
VGOB 93-0622-0380-01
Disbursement
Buchanan

Last Name	First Name	MAILED	RECEIPT #	RECEIVED
Agee	Louise	9/9/2016	7016034000008988 2790	9/16/2016 1
Hawkins	Charles	9/9/2016	7016034000008988 2813	9/12/2016 2
H-W Financial, LLC		9/9/2016	7016034000008988 2820	9/12/2016 3
Jones	Joyce Hawkins	9/9/2016	7016034000008988 2837	9/12/2016 4
Mickeon	Phyllis Everett	9/9/2016	7016034000008988 2806	9/12/2016 5
CNX Gas Co LLC		**Hand Delivered**		

Exhibit J
Unit U15 Escrow Account Reconciliation
VGOB 93-0622-0380

CNX Deposit Information		
Check Date	Check Number	Total

Total Deposited **\$44,005.73**

Interest & Fees **\$14,204.85**

Grand Total **\$58,210.58**

July 2016 First Bank and Trust Balance

\$58,323.37

Difference **-\$112.79**

Escrow Bank Data													Running Balance	Difference
Date	Escrow Royalty Deposits	Income	\$ Mktet Int	CDARS Int	Fees	Distributions	Audit Costs	Corrections	Gain/Loss	Royalty Bonus	Total Int. and Fees	Bank Balance		

SUPPLEMENTAL AFFIDAVIT OF MAILING—COAL OWNER

COMMONWEALTH OF VIRGINIA
COUNTY OF **BUCHANAN**

Applicant: CNX Gas Company LLC
Relief Sought: Disbursement/Dismissal for Unit U15
VGOB: 93-0622-0380-01

I, Anita D. Duty, being first duly sworn on oath, depose and say:

1. I am the Pooling Supervisor for CNX Land LLC, and I am authorized to submit this Affidavit on behalf of the Applicant CNX Gas Company LLC.

2. I affirm that the coal owner(s) in this Unit was properly noticed under Va. Code Ann. 45.1-361-22:2. See annexed letter(s) dated **September 29, 2015**. See annexed Certificate of Notice and coal owner notice form letter example.

3. The coal owner(s) **H-W Financial, LLC (previously Harrison-Wyatt, LLC)** provided evidence of a split agreement pertaining to a portion of this Unit, and consequently, to the extent the split agreement applies, said owner(s) is not dismissed as a Respondent by reason of being a gas claimant under the split agreement.

However, **H-W Financial, LLC (previously Harrison-Wyatt, LLC)** should be dismissed as Respondent/coal claimant for failure to timely provide evidence of a relevant proceeding or agreement with regard to its other coal owner claims.



Anita D. Duty
Pooling Supervisor
for CNX Land LLC

STATE OF VIRGINIA
COUNTY OF TAZEWELL, TO-WIT:

TAKEN, SUBSCRIBED AND SWORN to before me this 8 day of Sept., 2016.



Notary Public

My commission expires: 3/31/20

JANET RUTH WHITE
NOTARY PUBLIC
Commonwealth of Virginia
Reg# 7667821
My Commission Expires 3/31/20

CERTIFICATION OF NOTICE
CNX Gas Company LLC

Unit U15 & U16
VGOB 93-0622-0380 & 93-0622-0381-03
Coal dismissal

Last Name	First Name	MAILED	RECEIPT #	RECEIVED
Harrison-Wyatt, LLC (coal Owner)		9/29/15	70151520000353336136	10/1/2015

SENDER: COMPLETE THIS SECTION	COMPLETE THIS SECTION ON DELIVERY
<ul style="list-style-type: none"> ■ Complete items 1, 2, and 3. ■ Print your name and address on the reverse so that we can return the card to you. ■ Attach this card to the back of the mailpiece, or on the front if space permits. 	<p><i>Signature</i> <i>[Handwritten Signature]</i></p> <p><input type="checkbox"/> Agent <input type="checkbox"/> Addressee</p>
<p>1. Article Addressed to:</p> <p><i>Aernson Wyatt LLC</i> <i>PO Box 11000</i> <i>Donville, VA 24543</i></p>	<p>B. Received by (Printed Name) <i>LANDON WYATT</i> C. Date of Delivery <i>10-1-15</i></p> <p>D. Is delivery address different from item 1? <input type="checkbox"/> Yes <input checked="" type="checkbox"/> YES, enter delivery address below: <input type="checkbox"/> No</p>
<p></p> <p>9590 9403 0688 5198 3258 89</p>	<p>3. Service Type</p> <p><input type="checkbox"/> Adult Signature <input type="checkbox"/> Priority Mail Express®</p> <p><input type="checkbox"/> Adult Signature Restricted Delivery <input type="checkbox"/> Registered Mail™</p> <p><input type="checkbox"/> Certified Mail <input type="checkbox"/> Registered Mail Restricted Delivery</p> <p><input type="checkbox"/> Certified Mail Restricted Delivery <input checked="" type="checkbox"/> Return Receipt for Merchandise</p> <p><input type="checkbox"/> Collect on Delivery <input type="checkbox"/> Signature Confirmation</p> <p><input type="checkbox"/> Collect on Delivery Restricted Delivery <input type="checkbox"/> Signature Confirmation Restricted Delivery</p> <p><input type="checkbox"/> Mail Restricted Delivery</p>
<p>2. Article Number (Domestic Mail Only)</p> <p>7015 1520 0003 5333 6136</p>	<p><i>TK, P, 18 HB</i> Domestic Mail</p>
<p>PS Form 3811, April 2015 PSN 7530-02-000-9053</p>	



CNX Gas Company LLC

PO Box 570

Pounding Mill, VA 24637

Phone: (724) 485-3600

Date _____

«FNAME» «LNAME»

«Attention_Line»

«Street_Address»

«City»«State»«Zip»

COAL OWNERS

RE: Unit _____
Miscellaneous Petition for Disbursement from Escrow

Dear Property Owner,

House Bill 2058 was signed by the Governor and became law effective July 1, 2015. This new law requires the Virginia Gas and Oil Board to disburse monies placed in escrow because of conflicting claims (between coal owners and oil and gas owners) to coalbed methane gas royalties to the oil and gas owners of the tracts in this Unit.

In general, under this new law escrowed funds are to be paid to oil and gas owners unless the coal owner(s) provides the operator CNX and the Division of Gas and Oil "with evidence of a proceeding" [as in a court case] "or an agreement." The new law gives coal owners/coal claimants 45 days from the date you get this letter to provide that evidence.

Enclosed herewith please find a copy of the 45 day Notice of Filing. Please read the Notice carefully to be sure you understand that you have 45 days to provide evidence to the operator CNX Gas Company LLC at the address above **and** the Division of Gas and Oil at PO Draw 159, Lebanon, VA 24266

In order to help us keep our records current and to make sure you receive all correspondence and notices promptly, please notify us of any address change at the address above.

Sincerely,

Anita Duty
Pooling Supervisor

Enclosure(s)