

BEFORE THE VIRGINIA GAS AND OIL BOARD

PETITIONER: CNX Gas Company LLC

DIVISION OF GAS AND OIL

DOCKET NO: VGOB 95-0418-0500-04

RELIEF SOUGHT: (1) DISBURSEMENT FROM ESCROW REGARDING TRACT(S) 1, A portion of 12, A portion of 14, 3, 5, A portion of 7 (2) AND AUTHORIZATION FOR DIRECT PAYMENT OF ROYALTIES (3) AND DISMISSAL OF COAL OWNERS PURSUANT TO CODE OF VIRGINIA SECTION 45.1-361.22:2.

HEARING DATE: September 20, 2016

DRILLING UNIT: X29

BUCHANAN COUNTY, VIRGINIA

PETITION FOR ORDER OF DISBURSEMENT OF ESCROW FUNDS

1. Petitioner and its counsel

Petitioner is CNX Gas Company LLC, PO Box 570, Pounding Mill, VA 24637, (276)596-5075. Petitioner's counsel is Mark A. Swartz, Hillard & Swartz, LLP, 122 Capital Street, Suite 201, Charleston, WV 25301.

2. Relief Sought

(1) the disbursement of escrowed funds heretofore deposited with the Board's Escrow Agent, attributable to Tracts 1, 3, 5, and a portion of 7, 12 & 14, as depicted upon the annexed Table; and (2) authorization to begin paying royalties directly to Delores Estep, Darlene Bradley, Diana Asbury, Ralph D. Keen, Andy Keen, Randy Keen, Roy Keen, Arnold Keene, Billy Ray Hale, Linda K. Matney, Brenda Weddle, Carl Lee Hale, Bobby Steele, Rebecca I. Ritchie Hale, Michael Hess, Beth Underhill, David Hess, Jeff Jackson, Julia Jackson, John Douglas Davis, Jeanne Garrett, Yvonne White, Debra Estes, Lonnie Honaker, Sylvia McGlothlin, Charlotte Robinette, Ell See Ferrell, Teddy Ferrell, Michael Ellis Wilkers, Janet M. Willett, James Donald Steele, and Judy Horne; (3) Dismissal of Coal Owner(s): Rockport Oil & Gas, L.L.C. and Chisos, LTD (Royalties currently being paid under Buchanan No1 SGU1, VGOB 98-1117-0697)

3. Legal Authority

Va. Code Ann. § 45.1-361.1 et seq., 4 VAC 25-160-140., and relevant Virginia Gas and Oil Board Orders ("Board") heretofore promulgated pursuant to law.

4. Type of Well(s)

Coalbed Methane

5. Factual basis for relief requested

a. Delores Estep, Darlene Bradley, Diana Asbury, Ralph D. Keen, Andy Keen, Randy Keen, Roy Keen, Arnold Keene, Billy Ray Hale, Linda K. Matney, Brenda Weddle, Carl Lee Hale, Bobby Steele, Rebecca Ritchie Hale, Michael Hess, Beth Underhill, David Hess, Jeff Jackson, Julia Jackson, John Douglas Davis, Jeanne Garrett, Yvonne White, Debra Estes, Lonnie Honaker, Sylvia McGlothlin, Charlotte Robinette, Ell See Ferrell, Teddy Ferrell, Michael Ellis Wilkers, Janet M. Willett, James Donald Steele, and Judy Horne is the gas claimant in Tracts 1, 3, 5, portion of 12 & 14. As such Delores Estep, Darlene Bradley, Diana Asbury, Ralph D. Keen, Andy Keen, Randy Keen, Roy Keen, Arnold Keene, Billy Ray Hale, Linda K. Matney, Brenda Weddle, Carl Lee Hale, Bobby Steele, Jerry Jackson, Michael Hess, Beth Underhill, David Hess, Jeff Jackson, Julia Jackson, John Douglas Davis, Jeanne Garrett, Yvonne White, Debra Estes, Lonnie Honaker, Sylvia McGlothlin, Charlotte Robinette, Ell See Ferrell, Teddy Ferrell, Michael Ellis Wilkers, Janet M. Willett, James Donald Steele, and Judy Horne are entitled to 100% of the CBM royalties now in escrow and as may be hereafter payable. See Va. Code Ann. § 45.1-361.22:2.A.

b. That CNX Gas Company LLC has given the notice(s) required by § 45.1-361.22:2.A to all conflicting claimants identified in the above referenced pooling Order and any supplemental Orders pertaining thereto.

That none of the conflicting claimants noticed have provided, within 45 days of the notice(s) given as provided in b. above, the Board, its designated agent the Director of the Division of Gas and Oil, the Operator and/or the Applicant evidence of either an agreement regarding the escrowed funds/royalties or a proceeding regarding same.

c. That a detailed accounting in accordance with the applicable provisions of § 45.1-361.22 is submitted herewith and identified as Exhibit J.

d. That an Exhibit identified as Table 1 is annexed hereto, and it specifies how the disbursement (s) is to be calculated and paid by the escrow agent.

e. That Va. Code Ann. § 45.1-361.22:2.A. further provides that the Operator shall pay such royalties as may hereafter be payable directly to the gas claimant Delores Estep, Darlene Bradley, Diana Asbury, Ralph D. Keen, Andy Keen, Randy Keen, Roy Keen, Arnold Keene, Billy Ray Hale, Linda K. Matney, Brenda Weddle, Carl Lee Hale, Bobby Steele, Jerry Jackson, Michael Hess, Beth Underhill, David Hess, Jeff Jackson, Julia Jackson, John Douglas Davis, Jeanne Garrett, Yvonne White, Debra Estes, Lonnie Honaker, Sylvia McGlothlin, Charlotte Robinette, Ell See Ferrell, Teddy Ferrell, Michael Ellis Wilkers, Janet M. Willett, James Donald Steele, and Judy Horne and not escrow same. See Exhibit EE annexed hereto.

6. Attestation

The foregoing Petition to the best of my knowledge, information, and belief is true and correct.

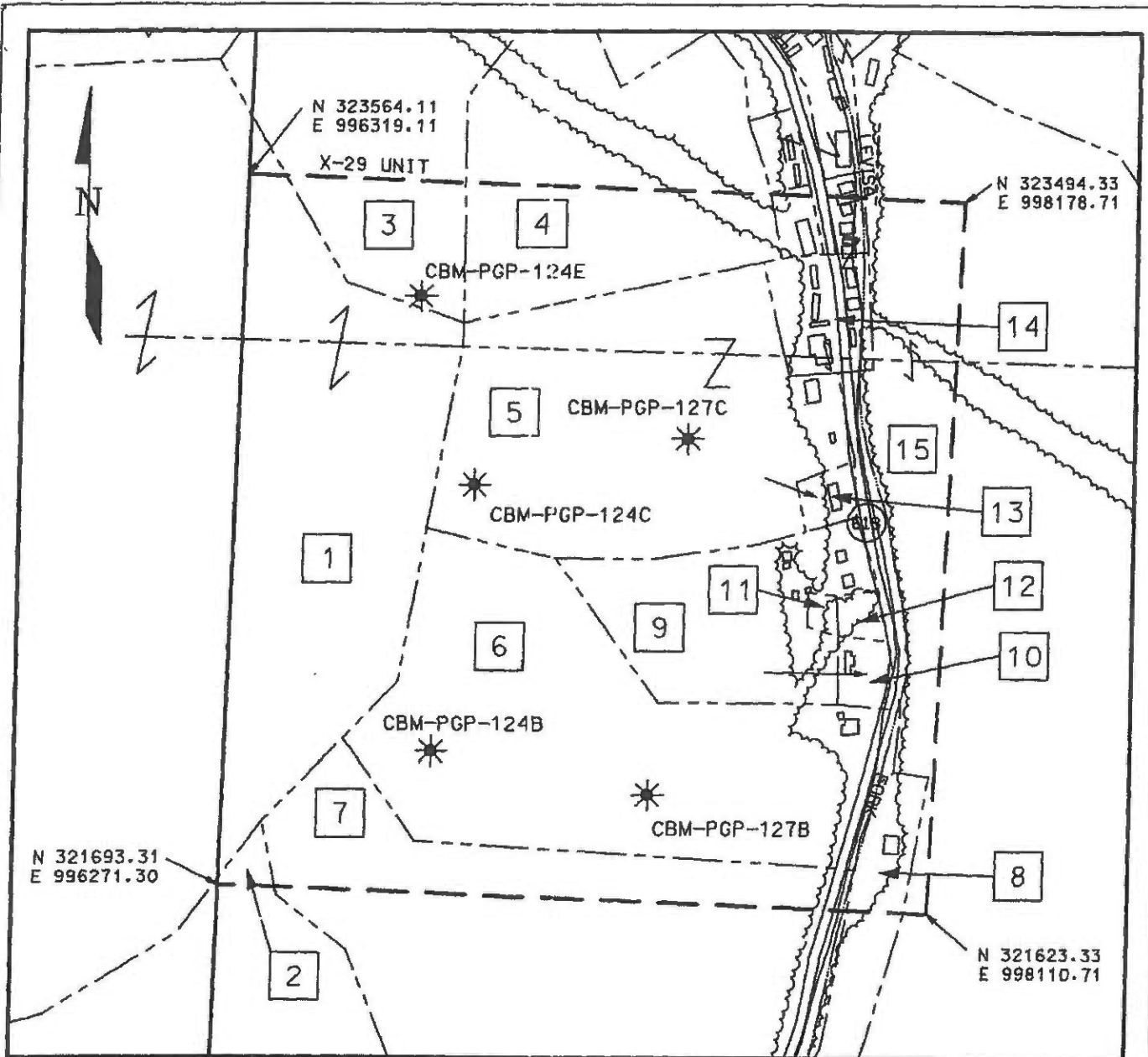

LEGEND

- TRACT LAND HOOK
- EXISTING CBM WELL
- PROPOSED CBM WELL
- TRACT LAND ID'S

EXHIBIT B1
 OAKWOOD FIELD UNIT X-29
 FORCE POOLING
 VGOB-95/04/18-0500-01
 95/04/18-0500

Company Pocahontas Gas Partnership Well Name and Number UNIT X-29
 Tract No. _____ Elevation _____ Quadrangle Keen Mountain
 County Buchanan District Garden Scale: 1" = 400' Date 3/2/95
 This plat is a new plat X ; an updated plat _____ ; or a final plat _____

Form DGO-GO-7
 Rev. 9/91

Claude D. Maza
 Licensed Professional Engineer or Licensed Land Surveyor

(Affix Seal)

**Pocahontas Gas Partnership
Oakwood Field Unit X-29
Docket No. VGOB-95/04/18-0500, 95/04/18-0500-01
Acres: 79.36**

1. **Hugh MacRae Land Trust - TR 2 - Coal
Coal Lessees
Permac, Inc.
Consolidation Coal Company
Pocahontas Gas Partnership - CBM Lessee
E. Keen Heirs - Oil & Gas
Pocahontas Gas Partnership - Oil & Gas Lessee
15.8 acres - 19.9093%**
2. **Hugh MacRae Land Trust - TR 5 - Coal
Coal Lessees
Permac, Inc.
Consolidation Coal Company
Pocahontas Gas Partnership - CBM Lessee
Pocahontas Gas Partnership - Oil & Gas
0.3 acres - 0.3780%**
3. **Hugh MacRae Land Trust - TR 17 - Coal
Coal Lessees
Permac, Inc.
Consolidation Coal Company
Pocahontas Gas Partnership - CBM Lessee
E. Keen Heirs - Oil & Gas
Pocahontas Gas Partnership - Oil & Gas Lessee
2.76 acres - 3.4778%**
4. **Hugh MacRae Land Trust - TR 17 - Coal
Coal Lessees
Permac, Inc.
Consolidation Coal Company
Pocahontas Gas Partnership - CBM Lessee
Glenn Rose - Oil & Gas
5.01 acres - 6.313%**
5. **Hugh MacRae Land Trust - TR 17 - Coal
Coal Lessees
Permac, Inc.
Consolidation Coal Company
Pocahontas Gas Partnership - CBM Lessee
B. Steele - Oil & Gas
Pocahontas Gas Partnership - CBM Lessee
14.66 acres - 18.4728%**

Pocahontas Gas Partnership
Oakwood Field Unit X-29
Docket No. VGOB-95/04/18-0500 , 95/04/18-0500-01
Acres: 79.36

6. Hugh MacRae Land Trust - TR 17 - Coal
Coal Lessees
Permac, Inc.
Consolidation Coal Company
Pocahontas Gas Partnership - CBM Lessee
O. Sisk - Oil & Gas
Pocahontas Gas Partnership - Oil & Gas Lessee
16.74 acres - 21.094%
7. Hugh MacRae Land Trust - TR 17 - Coal
Coal Lessees
Permac, Inc.
Consolidation Coal Company
Pocahontas Gas Partnership - CBM Lessee
E. Marshall Heirs - Oil & Gas
Pocahontas Gas Partnership - Oil & Gas Lessee
5.56 acres - 7.006%
8. Consolidation Coal Company - Coal, Oil & Gas
1.15 acres - 1.449%
9. Hugh MacRae Land Trust - TR 17 - Coal
Coal Lessees
Permac, Inc.
Consolidation Coal Company
Pocahontas Gas Partnership - CBM Lessee
J. Rowe - Oil & Gas
Pocahontas Gas Partnership - Oil & Gas Lessee
5.86 acres - 7.384%
10. Hugh MacRae Land Trust - TR 17 - Coal
Coal Lessees
Permac, Inc.
Consolidation Coal Company
Pocahontas Gas Partnership - CBM Lessee
Fred Sisk - Oil & Gas
0.6 acres - 0.756%
11. Hugh MacRae Land Trust - TR 17 - Coal
Coal Lessees
Permac, Inc.
Consolidation Coal Company
Pocahontas Gas Partnership - CBM Lessee
A. Ferrell Heirs - Oil & Gas
0.16 acres - 0.2016%

**Pocahontas Gas Partnership
Oakwood Field Unit X-29
Docket No. VGOB-95/04/18-0500, 95/04/18-0500-01
Acres: 79.36**

12. Hugh MacRae Land Trust - TR 17 - Coal
Coal Lessees
Permac, Inc.
Consolidation Coal Company
Pocahontas Gas Partnership - CBM Lessee
N. Rose - Oil & Gas
0.32 acres - 0.4032%
13. Hugh MacRae Land Trust - TR 17 - Coal
Coal Lessees
Permac, Inc.
Consolidation Coal Company
Pocahontas Gas Partnership - CBM Lessee
G. Horn - Oil & Gas
0.46 acres - 0.5796%
14. Hugh MacRae Land Trust - TR 17 - Coal
Coal Lessees
Permac, Inc.
Consolidation Coal Company
Pocahontas Gas Partnership - CBM Lessee
Ruth Steele - Oil & Gas
Pocahontas Gas Partnership - CBM Lessee
2.58 acres - 3.251%
15. Coal Mountain Mining Company - TR 19 - Coal, Oil & Gas
Coal Lessees
United Coal Company
Consolidation Coal Company
Pocahontas Gas Partnership - CBM Lessee
Consolidation Coal Company - Oil & Gas Lessee
7.4 acres - 9.3247%

3		Tract 3 (total acreage)			2.7600			
10	3	Linda K. Matney\PO Box 738, Pounding Mill, VA 24637	1/20	0.1380	100.00%	0.1380	0.3017%	\$322.14
11	3	Brenda Weddle\PO Box 852, Pounding Mill, VA 24637	1/20	0.1380	100.00%	0.1380	0.3017%	\$322.14
12	3	Carl Lee Hale\104 Third Ave, Richlands, VA 24641	1/20	0.1380	100.00%	0.1380	0.3017%	\$322.14
5		Tract 5 (total acreage)			14.6600			
1	5	Bobby W. Steele\PO Box 1153, Raven, VA 24639		14.6600	100.00%	14.6600	32.0465%	\$34,221.57
7		Tract 7 (total acreage)			5.5600			
1	7	Rebecca Ritchie Hale\1509 Kentucky Ave, Bristol, TN 37620	1/8	0.6950	100.00%	0.6950	1.5193%	\$1,622.37
2	7	Rebecca Ritchie Hale\1509 Kentucky Ave, Bristol, TN 37620	1/8	0.6950	100.00%	0.6950	1.5193%	\$1,622.37
3	7	Michael Hess\109 Aldie Burn Ct., Stephens City, VA 22655	1/48	0.1158	100.00%	0.1158	0.2532%	\$270.40
4	7	Beth underhill\243 Forest Ct., Bentonville, VA 22610	1/48	0.1158	100.00%	0.1158	0.2532%	\$270.40
5	7	David Hess\6103 Wild Pear Lane, Crozet, VA 22932	1/48	0.1158	100.00%	0.1158	0.2532%	\$270.40
6	7	Jeff Jackson\1001 E. 8th St., Charlotte, NC 28205	1/48	0.1158	100.00%	0.1158	0.2532%	\$270.40
7	7	Rebecca I. Ritchie Hale\1509 Kentucky Ave, Bristol, TN 37620	1/8	0.6950	100.00%	0.6950	1.5193%	\$1,622.37
8	7	Rebecca I. Ritchie Hale\1509 Kentucky Ave, Bristol, TN 37620	1/2	2.7800	100.00%	2.7800	6.0770%	\$6,489.49
12		Tract 12 (total acreage)			0.3200			
1	12	John Douglas Davis\2146 Old Kentucky Turnpike, Raven, VA 24639	1/52	0.0062	100.00%	0.0062	0.0135%	\$14.37
2	12	Jeanne Garrett\966 Maple Glen Drive, Conover, NC 28613	1/91	0.0035	100.00%	0.0035	0.0077%	\$8.21
3	12	Yvonne White\7802 Long Island Rd., Catawba, NC 28609	1/91	0.0035	100.00%	0.0035	0.0077%	\$8.21
4	12	Debra A. Estes\3316 6th Ave. NE, Conover, NC 28613	1/91	0.0035	100.00%	0.0035	0.0077%	\$8.21
5	12	Lonnie Honaker\234 Blackhills Rd., Pounding Mill, VA 24637	1/91	0.0035	100.00%	0.0035	0.0077%	\$8.21
6	12	Sylvia McGlothlin\PO Box 71, Cedar Bluff, VA 24609	1/39	0.0082	100.00%	0.0082	0.0179%	\$19.15
7	12	Charlotte Robinette\7862 Sarah Dr., Denver, NC 28037	1/39	0.0082	100.00%	0.0082	0.0179%	\$19.15
8	12	Ell See Ferrell\2057 Conway Rd., Big Rock, VA 24603	1/234	0.0014	100.00%	0.0014	0.0030%	\$3.19
9	12	Teddy Ferrell\30194 Blue Springs Rd., Meadowview, VA 24631	1/234	0.0014	100.00%	0.0014	0.0030%	\$3.19
10	12	Michael Wilkes\929 Hulana St., Rossville, GA 30741	1/65	0.0049	100.00%	0.0049	0.0108%	\$11.49
11	12	Janet Willett\1642 Osburn Rd., Chickamunga, GA 30707	1/65	0.0049	100.00%	0.0049	0.0108%	\$11.49
14		Tract 14 (total acreage)			2.5800			
1	14	Bobby W. Steele\PO Box 1153, Raven, VA 24639	1/4	0.6450	100.00%	0.6450	1.4100%	\$1,505.66
2	14	James D. Steele\181 Bearwallow Rd., Max Meadows, VA 24360	1/4	0.6450	100.00%	0.6450	1.4100%	\$1,505.66
3	14	Judy Steele Horne\190 Drews Lane, Cedar Bluff, VA 24609	1/4	0.6450	100.00%	0.6450	1.4100%	\$1,505.66

Wells contributing to the escrow account: PGP 124C W/PL, PGP 124B W/PL, PGP 127B W/PL

Unit X-29
Exhibit E
Docket # VGOB-95-0418-0500-04
List of Owners/Claimants in escrow

		Acres in Unit	Percent of Unit	Division of Interest in 4 EAST = 28.172%	Division of Interest in 5 EAST = 26.237%
--	--	---------------	-----------------	---	---

Tract #4 - 5.01 Acres

COAL OWNERSHIP

(1)	Hugh MacRae Land Trust Tr 17 c/o Gump, Strauss, Akin LLP 1 Bryant Park, Floor 41 New York, NY 10036-6715	5.01 acres	6.3130%	1.7785%	1.6563%
-----	---	------------	---------	---------	---------

By Assignment and Bill of Sale (Gas lease royalty), HMLT devised all of its right, title and interest (other than "Excluded Assets") to Torch Energy Advisors Inc. effective September 4, 1991 and recorded in Buchanan County under DB474 / PG384.

Torch Oil & Gas Company
c/o Sue Ann Craddock
670 Dona Ana Road SW
Deming, New Mexico 88030

Effective 2/1/11, Torch Oil & Gas Company assigned a 2% ORRI to SAC Investments, L.P.

Effective 3/31/14, Torch Oil & Gas Company, et al. assigned and conveyed 10% of its right, title and interest to Rockport Oil & Gas, L.L.C. in addition, Torch Oil & Gas Company, et al. assigned and conveyed the remaining 90% of its right, title and interest to Chisos, Ltd.

	Rockport Oil & Gas L.L.C. PO Box 847 Houston, TX 77001	0.50 acres 1/10 of 5.01 acres	0.6313%	0.1778%	0.1656%
--	--	----------------------------------	---------	---------	---------

	Chisos, LTD 670 Dona Ana Road SW Deming, New Mexico 88030	4.51 acres 9/10 of 5.01 acres	5.6817%	1.6006%	1.4907%
--	---	----------------------------------	---------	---------	---------

OIL & GAS OWNERSHIP

The ownership listed below is currently being reviewed and documentation is being requested to verify title

(1)	Glenn Rose Heirs, Devises, Successors or Assigns <i>Heirs Unknown</i>	5.01 acres	6.3130%	1.7785%	1.6563%
-----	---	------------	---------	---------	---------

Tract #7 - 5.56 Acres

COAL OWNERSHIP

(1)	Hugh MacRae Land Trust Tr 17 c/o Gump, Strauss, Akin LLP 1 Bryant Park, Floor 41 New York, NY 10036-6715	5.56 acres	7.0060%	1.9737%	1.8382%	<i>n/a</i>
-----	---	------------	---------	---------	---------	------------

By Assignment and Bill of Sale (Gas lease royalty), HMLT devised all of its right, title and interest (other than "Excluded Assets") to Torch Energy Advisors Inc. effective September 4, 1991 and recorded in Buchanan County under DB474 / PG384.

Torch Oil & Gas Company
c/o Sue Ann Craddock
670 Dona Ana Road SW
Deming, New Mexico 88030

Effective 2/1/11, Torch Oil & Gas Company assigned a 2% ORRI to SAC Investments, L.P.

Effective 3/31/14, Torch Oil & Gas Company, et al. assigned and conveyed 10% of its right, title and interest to Rockport Oil & Gas, L.L.C. in addition, Torch Oil & Gas Company, et al. assigned and conveyed the remaining 90% of its right, title and interest to Chisos, Ltd.

	Rockport Oil & Gas L.L.C. PO Box 847 Houston, TX 77001	0.00 acres 1/10 of 5.56 acres	0.0008%	0.0002%	0.0002%	<i>n/a</i>
--	--	----------------------------------	---------	---------	---------	------------

	Chisos, LTD 670 Dona Ana Road SW Deming, New Mexico 88030	0.01 acres 9/10 of 5.56 acres	0.0073%	0.0020%	0.0019%	<i>n/a</i>
--	---	----------------------------------	---------	---------	---------	------------

OIL & GAS OWNERSHIP

(1)	Earl & Nellie Marshall Heirs, Devises, Successors or Assigns <i>(25.00 Acre Tract)</i>	5.56 acres	7.0060%	1.9737%	1.8382%
-----	--	------------	---------	---------	---------

(b) Nellie Jackson Marshall Heirs, Devises,
Successors or Assigns

(b.4) Corbit Jackson Heirs, Devises,
Successors or Assigns
*D.O.D 6/18/2008 Instrument 08-0207**

(b.4.1) Jerry W. Jackson *Conveyed by quitclaim deed 2/4/09 Instrument 09-0565, including all past and present royalty escrowed or otherwise paid*

(b.4.1.1) Rebecca I. Ritchie Hale *n/a
see below*
1509 Kentucky Ave
Bristol, TN 37620

Unit X-29
Exhibit E
Docket # VGOB-95-0418-0500-04
List of Owners/Claimants in escrow

Acres in Unit	Percent of Unit	Division of Interest in 4 EAST = 28.172%	Division of Interest in 5 EAST = 26.237%
---------------	-----------------	---	---

* Instrument 08-0207
Pursuant to Article IV, Item 2 of the Last Will & Testament of Corbit Jackson, any money held in escrow at the time of his death passes to his six grandchildren listed below: (D.O.D. 6/18/2008)

The individuals below will receive a one time payout from escrow in accordance with the Will of Corbit Jackson

Unlocatable

John Ratliff 21338 Sorrell Grove Ct Ashburn, VA 20147	0.116 acres 1/48 of 5.56 acres	0.1460%	0.0411%	0.0383%
---	-----------------------------------	---------	---------	---------

Julia Chitester Jackson 2212 E. 8th St Charlotte, NC 28204	0.116 acres 1/48 of 5.56 acres	0.1460%	0.0411%	0.0383%
--	-----------------------------------	---------	---------	---------

Total Tract Acres	0.2317			
Total Tract Percentage		0.2919%		

Tract #9 - 5.86 Acres

COAL OWNERSHIP

(1) Hugh MacRae Land Trust Tr 17 c/o Gump, Strauss, Akin LLP 1 Bryant Park, Floor 41 New York, NY 10036-6715	5.86 acres	7.3841%	2.0802%	1.9374%
---	------------	---------	---------	---------

By Assignment and Bill of Sale (Gas lease royalty), HMLT devised all of its right, title and interest (other than "Excluded Assets") to Torch Energy Advisors Inc. effective September 4, 1991 and recorded in Buchanan County under DB474 / PG384.

Torch Oil & Gas Company
c/o Sue Ann Craddock
670 Dona Ana Road SW
Deming, New Mexico 88030

Effective 2/1/11, Torch Oil & Gas Company assigned a 2% ORRI to SAC Investments, L.P.

Effective 3/31/14, Torch Oil & Gas Company, et al. assigned and conveyed 10% of its right, title and interest to Rockport Oil & Gas, L.L.C. In addition, Torch Oil & Gas Company, et al. assigned and conveyed the remaining 90% of its right, title and interest to Chisos, Ltd.

Rockport Oil & Gas L.L.C. PO Box 847 Houston, TX 77001	0.59 acres 1/10 of 5.86 acres	0.7384%	0.2080%	0.1937%
--	----------------------------------	---------	---------	---------

Chisos, LTD 670 Dona Ana Road SW Deming, New Mexico 88030	5.27 acres 9/10 of 5.86 acres	6.6457%	1.8722%	1.7436%
---	----------------------------------	---------	---------	---------

OIL & GAS OWNERSHIP

W-9/Affidavit Pending (Prior Owner)

(1) Julius Rowe Heirs, Devises, Successors or Assigns				
(a) Lawrence E. Rowe 10160 E-1000S Upland, IN 46989	<i>Conveyed property by deed dated September 13, 2013, Instrument #130001812</i>			
Lawrence Rowe will be paid all funds in escrow for underlying unit X29 which accumulated prior to date of BUCH 1 SGU 1 being sealed in 1998				
(a.1) Larry Palmer 5547 Creek Hill Rd St. Paul, VA 24283	5.86 acres	7.3841%	2.0802%	1.9374%

Tract #11 - 0.16 Acres

COAL OWNERSHIP

(1) Hugh MacRae Land Trust Tr 17 c/o Gump, Strauss, Akin LLP 1 Bryant Park, Floor 41 New York, NY 10036-6715	0.16 acres	0.2016%	0.0568%	0.0529%
---	------------	---------	---------	---------

By Assignment and Bill of Sale (Gas lease royalty), HMLT devised all of its right, title and interest (other than "Excluded Assets") to Torch Energy Advisors Inc. effective September 4, 1991 and recorded in Buchanan County under DB474 / PG384.

Torch Oil & Gas Company
c/o Sue Ann Craddock
670 Dona Ana Road SW
Deming, New Mexico 88030

Effective 2/1/11, Torch Oil & Gas Company assigned a 2% ORRI to SAC Investments, L.P.

Effective 3/31/14, Torch Oil & Gas Company, et al. assigned and conveyed 10% of its right, title and interest to Rockport Oil & Gas, L.L.C. In addition, Torch Oil & Gas Company, et al. assigned and conveyed the remaining 90% of its right, title and interest to Chisos, Ltd.

Unit X-29
Exhibit E
Docket # VGOB-95-0418-0500-04
List of Owners/Claimants in escrow

	Acres in Unit	Percent of Unit	Division of Interest in 4 EAST = 28.172% 5 EAST = 26.237%	Division of Interest in
Rockport Oil & Gas L.L.C. PO Box 847 Houston, TX 77001	0.03 acres 1/10 of 0.16 acres	0.0403%	0.0114%	0.0106%
Chisos, LTD 670 Dona Ana Road SW Deming, New Mexico 88030	0.29 acres 9/10 of 0.16 acres	0.3629%	0.1022%	0.0952%

OIL & GAS OWNERSHIP

Previously shown incorrectly as A. Ferrell Heirs, updated to reflect correct mapping and title ownership

W-9/Affidavits Pending

(1) James W. & Nancy J. Rose, T/E

James Willard Rose deceased June 18, 1982 per instrument #120000977

(a) Nancy Rose
427 Kents Ridge Road
Richlands, VA 24641

Nancy Rose will be paid all funds in escrow for underlying unit X29 which accumulated prior to date of BUCH 1 SGU 1 being sealed in 1998

By deed dated August 29, 2000 Nancy Rose conveyed property to Bobby and Petra Matney, T/E, Deed Book 512 Page

By deed dated November 13, 2013 Bobby and Petra Matney conveyed property to Larry Palmer, Instrument #130002232

(a.1) Larry Palmer
5547 Creek Hill Rd
St. Paul, VA 24283

0.16 acres 0.2016% 0.0568% 0.0529%

Tract #12 - 0.32 Acres

COAL OWNERSHIP

(1) Hugh MacRae Land Trust Tr 17
c/o Gump, Strauss, Akin LLP
1 Bryant Park, Floor 41
New York, NY 10036-6715

0.32 acres 0.4032% 0.1136% 0.1058%

By Assignment and Bill of Sale (Gas lease royalty), HMLT devised all of its right, title and interest (other than "Excluded Assets") to Torch Energy Advisors Inc. effective September 4, 1991 and recorded in Buchanan County under DB474 / PG384.

Torch Oil & Gas Company
c/o Sue Ann Craddock
670 Dona Ana Road SW
Deming, New Mexico 88030

Effective 2/1/11, Torch Oil & Gas Company assigned a 2% ORRI to SAC Investments, L.P.

Effective 3/31/14, Torch Oil & Gas Company, et al. assigned and conveyed 10% of its right, title and interest to Rockport Oil & Gas, L.L.C. In addition, Torch Oil & Gas Company, et al. assigned and conveyed the remaining 90% of its right, title and interest to Chisos, Ltd.

Rockport Oil & Gas L.L.C.
PO Box 847
Houston, TX 77001

0.03 acres
1/10 of 0.32 acres 0.0403% 0.0114% 0.0106%

Chisos, LTD
670 Dona Ana Road SW
Deming, New Mexico 88030

0.29 acres
9/10 of 0.32 acres 0.3629% 0.1022% 0.0952%

OIL & GAS OWNERSHIP

Previously shown incorrectly as Nancy Rose, updated to reflect correct mapping and title ownership

(1) A. Ferrell Heirs, Deviseses,
Successors of Assigns

0.32 acres 0.4032% 0.1136% 0.1058%

(a) Caroline B. Davis Heirs, Deviseses, Successors
or Assigns

The respondents listed below did not respond timely to the W9 request and will continue to be escrowed

(a.2) Guy W. Davis
285 Flat Ridge Rd
Sugar Grove, VA 24656

0.0062 acres
1/52 of 0.32 acres 0.0078% 0.0022% 0.0020%

(a.3) Joan D. Boyd
1192 Willie Rd
Vansant, VA 24656

0.0062 acres
1/52 of 0.32 acres 0.0078% 0.0022% 0.0020%

The ownership listed below is currently being reviewed and documentation is being requested to verify title

(a.4) Jack Davis Heirs Deviseses, Successors or
Assigns

0.0062 acres
1/52 of 0.32 acres 0.0078% 0.0022% 0.0020%

Documentation requested 12/11/15

(a.4.1) Sharon Davis
PO Box 82
Oakwood, VA 24631

Unit X-29
Exhibit E
Docket # VGOB-95-0418-0500-04
List of Owners/Claimants in escrow

	Acres in Unit	Percent of Unit	Division of Interest in 4 EAST = 28.172%	Division of Interest in 5 EAST = 26.237%
(b) Margie Sparks Moore Miller Moldovan Heirs, Devisees, Successors or Assigns <i>Revised list of heirs requested 12/28/15</i>				
The ownership listed below is currently being reviewed and documentation is being requested to verify title				
(b.1) Julius Moldovan (4th spouse) Heirs, Devisees, Successors or Assigns <i>List of Heirs requested 12/30/15</i>	0.0082 acres 1/39 of 0.32 acres	0.0103%	0.0029%	0.0027%
The respondents listed below did not respond timely to the W9 request and will continue to be escrowed				
(b.2) Cleo Preskewitz 955 East 9th Street Rochester, IN 46579	0.0021 acres 1/156 of 0.32 acres	0.0026%	0.0007%	0.0007%
(b.3) Ruby Schroll Heirs, Devisees, Successors or Assigns	<i>pre-deceased daughter</i>			
(b.3.1) Dawn E. McElfresh 714 W. Virginia Ave Kokomo, IN 46902	0.0010 acres 1/312 of 0.32 acres	0.0013%	0.0004%	0.0003%
(b.3.2) Christopher Schroll 61 Shields Ave Peru, IN 46970	0.0010 acres 1/312 of 0.32 acres	0.0013%	0.0004%	0.0003%
(b.4) Gaynell Fry 365 Boulevard St. Peru, IN 46970	0.0021 acres 1/156 of 0.32 acres	0.0026%	0.0007%	0.0007%
(b.5) Virginia Ruth Lowe 1307 Wabash St. Rochester, IN 46579	0.0021 acres 1/156 of 0.32 acres	0.0026%	0.0007%	0.0007%
(b.6) Carol Pocock 1148 W. 6th St. Rochester, IN 46579	0.0021 acres 1/156 of 0.32 acres	0.0026%	0.0007%	0.0007%
(b.7) Darlene Drudge PO Box 303 Akron, IN 46910	0.0021 acres 1/156 of 0.32 acres	0.0026%	0.0007%	0.0007%
(b.8) Jack Sparks 1211 N. 47th Street Fort Smith, AR 72904	0.0021 acres 1/156 of 0.32 acres	0.0026%	0.0007%	0.0007%
(b.9) Dana Sparks Heirs, Devisees, Successors or Assigns	<i>No issue - interest goes back to siblings</i>			
(b.10) Earl Sparks Heirs Devisees, Successors or Assigns	<i>Pre-deceased brother</i>			
(b.10.1) Frederick A. Sparks 198 Fulton Ave. Rochester, IN 46975	0.0021 acres 1/156 of 0.32 acres	0.0026%	0.0007%	0.0007%
(c) Mary Honaker Heirs, Devisees, Successors or Assigns				
The ownership listed below is currently being reviewed and documentation is being requested to verify title				
(c.4) Shaw Honaker Heirs, Devisees, Successors or Assigns	0.0035 acres 1/91 of 0.32 acres	0.0044%	0.0012%	0.0012%
(c.4.1) Nina Honaker Heirs, Devisees, Successors or Assigns <i>Documentation requested 12/11/2015</i>				
(c.4.1.1) Wilma Hagerman PO Box 229 Bradshaw, WV 24817				
(c.4.1.2) Steve Honaker <i>Address Unknown</i>				

Unit X-29
Exhibit E
Docket # VGOB-95-0418-0500-04
List of Owners/Claimants in escrow

	Acres in Unit	Percent of Unit	Division of Interest in 4 EAST = 28.172%	Division of Interest in 5 EAST = 26.237%
The respondents listed below did not respond timely to the W9 request and will continue to be escrowed				
(c.6) Jack Honaker 559 Teak Street Pounding Mill, VA 24637	0.0035 acres 1/91 of 0.32 acres	0.0044%	0.0012%	0.0012%
(c.7) Don Honaker 3041 Horn Mountain Rd Raven, VA 24639	0.0035 acres 1/91 of 0.32 acres	0.0044%	0.0012%	0.0012%
(d) Flora French Heirs, Devisees, Successors or Assigns				
(d.1) Evelyn Belcher 116 Lowe St. Richlands, VA 24641	0.0082 acres 1/39 of 0.32 acres	0.0103%	0.0029%	0.0027%
(e) Hazel Hylton Heirs, Devisees, Successors or Assigns <i>Documentation requested 12/11/2015</i>	0.0246 acres 1/13 of 0.32 acres	0.0310%	0.0087%	0.0081%
The ownership listed below is currently being reviewed and documentation is being requested to verify title				
(e.1) John Clarence Hylton <i>Pre-deceased son</i>				
(e.1.1) Johnny Hylton <i>Address Unknown</i>				
(e.1.2) Jennifer Hylton <i>Address Unknown</i>				
(e.1.3) Joel Hylton <i>Address Unknown</i>				
(e.1.4) Jeffrey Hylton <i>Address Unknown</i>				
(e.2) Geneva Hylton Joyce <i>Address Unknown</i>				
(e.3) Opal Bandy 107 Bandy Lane Richlands, VA 24641				
(e.4) Robert Andrew Hylton 2213 N. Clybourn Ave. Chicago, IL 60614				
(e.5) Otis Hylton Heirs, Devisees, Successors or Assigns				
(e.5.1) Russell Otis Hylton PO Box 363 Raven, VA 24639				
(e.5.2) Mark Anthony Hylton 145 Spring St. Pounding Mill, VA 24637				
(f) Clarence Ferrell Heirs Devisees, Successors or Assigns				
(f.1) Theodosia M. Ferrell Heirs, Devisees, Successors and Assigns				
The respondents listed below did not respond timely to the W9 request and will continue to be escrowed				
(f.1.1) Alice Fletcher 3440 Bloomingdale Pike Kingsport, TN 37660	0.0164 acres 2/39 of 0.32 acres	0.0207%	0.0058%	0.0054%
The ownership listed below is currently being reviewed and documentation is being requested to verify title				
(f.1.2) Charles D. Ferrell Heirs, Devisees, Successors or Assigns <i>Documentation requested 12/11/2015</i>	<i>Pre-deceased son</i> 0.0014 acres 1/234 of 0.32 acres	0.0017%	0.0005%	0.0005%
The respondents listed below did not respond timely to the W9 request and will continue to be escrowed				
(f.1.3) Phyllis D. Ramey 20498 Sheppard Lane Abingdon, VA 24611	0.0014 acres 1/234 of 0.32 acres	0.0017%	0.0005%	0.0005%
(f.1.5) Billy Joe Ferrell 15548 Road 1037 Oakwood, OH 45873	0.0014 acres 1/234 of 0.32 acres	0.0017%	0.0005%	0.0005%
(f.1.6) Freddie Ferrell 11226 College Dr. Meadowview, VA 24631	0.0014 acres 1/234 of 0.32 acres	0.0017%	0.0005%	0.0005%

Unit X-29
Exhibit E
Docket # VG0B-95-0418-0500-04
List of Owners/Claimants in escrow

	Acres in Unit	Percent of Unit	Division of Interest in 4 EAST = 28.172%	Division of Interest in 5 EAST = 26.237%
--	---------------	-----------------	---	---

The ownership listed below is currently being reviewed and documentation is being requested to verify title

(g) Samuel L. Ferrell Heirs, Devisees, Successors or Assigns <i>List of Heirs requested 12/14/2015</i>	0.025 acres 1/13 of 0.32 acres	0.0310%	0.0087%	0.0081%
(h) Joshua Vinson Ferrell Heirs, Devisees, Successors or Assigns	0.025 acres 1/13 of 0.32 acres	0.0310%	0.0087%	0.0081%

The ownership listed below is currently being reviewed and documentation is being requested to verify title

- (h.1) James Donald Ferrell Heirs, Devisees, Successors or Assigns
Pre-Deceased son
Documentation requested 12/3/2015
- (h.1.1) James Ferrell
2766 West Sunset Loop
Tucson, AZ 85741
- (h.1.2) Michael Ferrell
Address Unknown
- (h.1.3) Stephen Ferrell
76842 Timbercreek Blvd
Yulee, FL 32097
- (h.2) Betty Ann Ferrell
3924 Clifton Fork Rd
Raven, VA 24639

The ownership listed below is currently being reviewed and documentation is being requested to verify title

(i) Maze Boardwine Heirs, Devisees, Successors or Assigns <i>Documentation requested 12/3/2015</i>	0.025 acres 1/13 of 0.32 acres	0.0310%	0.0087%	0.0081%
(i.1) Arch Burdette Boardwine 3084 Mount Olivet Rd Pulaski, VA 24301				
(i.2) Samuel Boardwine 4481 Brookmont Rd Pulaski, VA 24301				
(i.3) Ronald Boardwine 707 South Ocean Avenue North Myrtle Beach, SC 29582				
(i.4) Linda Wyatt 2761 Graham Rd Draper, VA 24324				
(i.5) Daniel Paul Boardwine 411 Horsemans Lane Abingdon, VA 24210				
(i.6) Clarence Wayne Boardwine 4466 Brookmont Rd Pulaski, VA 24301				
(i.7) Della Ayers 124 15th St. Northwest Pulaski, VA 24301				

The ownership listed below is currently being reviewed and documentation is being requested to verify title

(j) Harry Ferrell Heirs, Devisees, Successors or Assigns <i>Documentation requested 12/8/2015</i>	0.025 acres 1/13 of 0.32 acres	0.0310%	0.0087%	0.0081%
(j.1) Florene Ferrell PO Box 247 Oakwood, VA 24631				
(j.2) Denise Clevinger 1969 Old Wolf Creek Rd Narrows, VA 24124				
(j.3) Teresa Frazier 12288 Garrett Creek Rd Abingdon, VA 24210				
(j.4) Gary Ferrell PO Box 247 Oakwood, VA 24631				
(k) Margaret Wilkes Heirs, Devisees, Successors or Assigns				

Unit X-29
Exhibit E
Docket # VG0B-95-0418-0500-04
List of Owners/Claimants in escrow

	Acres in Unit	Percent of Unit	Division of Interest in 4 EAST = 28.172%	Division of Interest in 5 EAST = 26.237%
<i>The ownership listed below is currently being reviewed and documentation is being requested to verify title</i>				
(k.1) James Beuman Wilkes, Jr. Heirs, Devisees, Successors or Assigns <i>Documentation requested from Walker County, GA</i>	0.005 acres 1/65 of 0.32 acres	0.0062%	0.0017%	0.0016%
(k.1.1) Aaron Wilkes 2809 Angie Drive Bellevue, NE 68005				
(k.1.2) Andrew Wilkes 1521 Maxwell Rd East Ridge, TN 37412				
<i>The respondents listed below did not respond timely to the W9 request and will continue to be escrowed</i>				
(k.2) Kelley Eugene Wilkes 183 East Elmwood St Rossville, GA 30741	0.005 acres 1/65 of 0.32 acres	0.0062%	0.0017%	0.0016%
<i>The ownership listed below is currently being reviewed and documentation is being requested to verify title</i>				
(k.5) Mary Scott Heirs, Devisees, Successors or Assigns <i>List of Heirs requested 12/10/2015</i>	0.005 acres 1/65 of 0.32 acres	0.0062%	0.0017%	0.0016%
(k.5.1) James Beuman Wilkes, Jr. Heirs, Devisees, Successors or Assigns <i>Documentation requested from Walker County, GA</i>				
(k.5.1.1) Aaron Wilkes 2809 Angie Drive Bellevue, NE 68005				
(k.5.1.2) Andrew Wilkes 1521 Maxwell Rd East Ridge, TN 37412				
(k.5.2) Kelley Eugene Wilkes 183 East Elmwood St Rossville, GA 30741				
(k.5.3) Michael Wilkes 929 Hulana Street Rossville, GA 30741				
(k.5.4) Janet Willett 1642 Osburn Rd Chickamauga, GA 30707				
<i>The ownership listed below is currently being reviewed and documentation is being requested to verify title</i>				
(l) Rachel Robinson Heirs Devisees, Successors or Assigns				
(l.1) Columbus Robinson Heirs, Devisees, Successors or Assigns <i>Documentation requested 12/9/2015</i>	0.003 acres 1/117 of 0.32 acres	0.0034%	0.0010%	0.0009%
(l.2) Lindberg Robinson Heirs, Devisees, Successors or Assigns <i>Documentation requested 12/29/2015</i>	0.003 acres 1/117 of 0.32 acres	0.0034%	0.0010%	0.0009%
(i.2.1) Vernie Robinson <i>Address Unknown</i>				
<i>The respondents listed below did not respond timely to the W9 request and will continue to be escrowed</i>				
(l.3) Tommy Robinson Heirs, Devisees, Successors or Assigns				
(i.3.1) Loretta Robinson Rt. 2 Box 470 Grundy, VA 24614	0.001 acres 1/234 of 0.32 acres	0.0017%	0.0005%	0.0005%
(i.3.2) Tommy C. Robinson PO Box 72 Pearisburg, VA 24134	0.001 acres 1/234 of 0.32 acres	0.0017%	0.0005%	0.0005%
(l.4) Elizabeth Holder 801 Delaware Drive Temple, TX 76504	0.003 acres 1/117 of 0.32 acres	0.0034%	0.0010%	0.0009%
(l.5) Molly Carlson PO Box 917 Boulder, MT 59632	0.003 acres 1/117 of 0.32 acres	0.0034%	0.0010%	0.0009%

Unit X-29
Exhibit E
Docket # VGOB-95-0418-0500-04
List of Owners/Claimants in escrow

	Acres in Unit	Percent of Unit	Division of Interest in 4 EAST = 28.172%	Division of Interest in 5 EAST = 26.237%
<i>The ownership listed below is currently being reviewed and documentation is being requested to verify title</i>				
(l.6) Fanny Kocurek Heirs, Devisees, Successors or Assigns <i>Estate requested from Kerr Co, TX 12/14/2015</i>	0.003 acres 1/117 of 0.32 acres	0.0034%	0.0010%	0.0009%
<i>The respondents listed below did not respond timely to the W9 request and will continue to be escrowed</i>				
(l.7) Caroline Donaldson PO Box 796 Boulder, MT 59632	0.003 acres 1/117 of 0.32 acres	0.0034%	0.0010%	0.0009%
(l.8) Mary Parker <i>Address Unknown</i>	0.003 acres 1/117 of 0.32 acres	0.0034%	0.0010%	0.0009%
<i>The ownership listed below is currently being reviewed and documentation is being requested to verify title</i>				
(l.9) Virginia Howell Heirs, Devisees, Successors or Assigns <i>Documentation requested 12/11/2015</i>	0.003 acres 1/117 of 0.32 acres	0.0034%	0.0010%	0.0009%
(l.9.1) Rachael Mingus 434 Patrick Avenue Fieldale, VA 24089				
(l.9.2) Elena Maria Rigler 190 Corn Tassell Drive Bassett, VA 24055				
(l.9.3) Phyllis Curtis 30 Josie Lane Stuart, VA 24171				
(m) Virginia Boyd Heirs, Devisees, Successors or Assigns <i>Estate requested from Chesterfield Co, VA 12/11/2015</i>	0.025 acres 1/13 of 0.32 acres	0.0310%	0.0087%	0.0081%
(m.1) Phyllis Beyd 5500 Qualla Rd Chesterfield, VA 23832				
(m.2) Larry Boyd Heirs, Devisees, Successors or Assigns				
(m.2.1) Linda Boyd 2125 Clay Street Kannapolis, NC 28083				
(m.3) Harold Boyd 1017 Ferrell Cemetery Rd Raven, VA 24639				
(m.4) Clarence W. Boyd, Jr. 131 Coal Street Pounding Mill, VA 24637				
(m.5) David F. Boyd 2603 Fruehauf Road Richmond, VA 23228				
Total Tract Acres	0.2708			
Total Tract Percentage		0.3412%		

Tract #13 - 0.46 Acres

COAL OWNERSHIP

(1) Hugh MacRae Land Trust Tr 17 c/o Gump, Strauss, Akin LLP 1 Bryant Park, Floor 41 New York, NY 10036-6715	0.46 acres	0.5796%	0.1633%	0.1521%
<i>By Assignment and Bill of Sale (Gas lease royalty), HMLT devised all of its right, title and interest (other than "Excluded Assets") to Torch Energy Advisors Inc. effective September 4, 1991 and recorded in Buchanan County under DB474 / PG384.</i>				
Torch Oil & Gas Company c/o Sue Ann Craddock 670 Dona Ana Road SW Deming, New Mexico 88030				
<i>Effective 2/1/11, Torch Oil & Gas Company assigned a 2% ORRI to SAC Investments, L.P.</i>				
<i>Effective 3/31/14, Torch Oil & Gas Company, et al. assigned and conveyed 10% of its right, title and interest to Rockport Oil & Gas, L.L.C. In addition, Torch Oil & Gas Company, et al. assigned and conveyed the remaining 90% of its right, title and interest to Chisos, Ltd.</i>				
Rockport Oil & Gas L.L.C. PO Box 847 Houston, TX 77001	0.05 acres 1/10 of 0.46 acres	0.0580%	0.0163%	0.0152%

Unit X-29
Exhibit E
Docket # VGOB-95-0418-0500-04
List of Owners/Claimants in escrow

	Acres in Unit	Percent of Unit	Division of Interest in 4 EAST = 28.172%	Division of Interest in 5 EAST = 26.237%
Chisos, LTD 670 Dona Ana Road SW Deming, New Mexico 88030	0.41 acres 9/10 of 0.46 acres	0.5217%	0.1470%	0.1369%

OIL & GAS OWNERSHIP

The respondents listed below did not respond timely to the W9 request and will continue to be escrowed

(1) Grady & Ellen Horn, T/E

Ellen J. Horn deceased 9/22/2015

Grady Horn PO Box 782 Raven, VA 24639	0.46 acres	0.5796%	0.1633%	0.1521%
---	------------	---------	---------	---------

Tract #14 - 2.58 Acres

COAL OWNERSHIP

(1) Hugh MacRae Land Trust Tr 17 c/o Gump, Strauss, Akin LLP 1 Bryant Park, Floor 41 New York, NY 10036-6715	2.58 acres	3.2510%	0.9159%	0.8530%
---	------------	---------	---------	---------

By Assignment and Bill of Sale (Gas lease royalty), HMLT devised all of its right, title and interest (other than "Excluded Assets") to Torch Energy Advisors Inc. effective September 4, 1991 and recorded in Buchanan County under DB474 / PG384.

Torch Oil & Gas Company
c/o Sue Ann Craddock
670 Dona Ana Road SW
Deming, New Mexico 88030

Effective 2/1/11, Torch Oil & Gas Company assigned a 2% ORRI to SAC Investments, L.P.

Effective 3/31/14, Torch Oil & Gas Company, et al. assigned and conveyed 10% of its right, title and interest to Rockport Oil & Gas, L.L.C. In addition, Torch Oil & Gas Company, et al. assigned and conveyed the remaining 90% of its right, title and interest to Chisos, Ltd.

Rockport Oil & Gas L.L.C. PO Box 847 Houston, TX 77001	0.26 acres 1/10 of 2.58 acres	0.3251%	0.0916%	0.0853%
Chisos, LTD 670 Dona Ana Road SW Deming, New Mexico 88030	2.32 acres 9/10 of 2.58 acres	2.9259%	0.8243%	0.7677%

OIL & GAS OWNERSHIP

(1) Kermit & Ruth Steele Heirs, Devisees, Successors or Assigns	2.58 acres	3.2510%	0.9159%	0.8530%
(a) Kermit Q. Steele Heirs, Devisees, Successors or Assigns				
(a.1) Ruth E. Steele Messer Heirs, Devisees, Successors or Assigns				
(b) Ruth E. Steele Messer Heirs, Devisees, Successors or Assigns				

The respondents listed below did not respond timely to the W9 request and will continue to be escrowed

(b.4) Tamara Altizer 4630 Twelveoaks Rd. Midlothian, VA 23112	0.65 acres 1/4 of 2.58 acres	0.8128%	0.2290%	0.2132%
---	---------------------------------	---------	---------	---------

Total Conflicts

Total Acres	12.6375
Total Percentage	15.9242%

Exhibit EE
Unit X-29
Docket # VGOB-95-0418-0500-04
List of Respondents with Royalty Split Agreements/Court Orders/HB2058

	Acres in Unit	Percent of Unit	Division of Interest in 4 EAST = 28.172%	Division of Interest in 5 EAST = 26.237%	Percent of Escrow
--	---------------	-----------------	--	--	-------------------

Tract #1 - 15.80 Acres

COAL OWNERSHIP

(1) Hugh MacRae Land Trust Tr 2 c/o Gump, Strauss, Akin LLP 1 Bryant Park, Floor 41 New York, NY 10036-6715	15.80 acres	19.9093%	5.6088%	5.2236%	n/a
--	-------------	----------	---------	---------	-----

By Assignment and Bill of Sale (Gas lease royalty), HMLT devised all of its right, title and interest (other than "Excluded Assets") to Torch Energy Advisors Inc. effective September 4, 1991 and recorded in Buchanan County under DB474 / PG384.

Torch Oil & Gas Company
c/o Sue Ann Craddock
670 Dona Ana Road SW
Deming, New Mexico 88030

Effective 2/1/11, Torch Oil & Gas Company assigned a 2% ORRI to SAC Investments, L.P.

Effective 3/31/14, Torch Oil & Gas Company, et al. assigned and conveyed 10% of its right, title and interest to Rockport Oil & Gas, L.L.C. In addition, Torch Oil & Gas Company, et al. assigned and conveyed the remaining 90% of its right, title and interest to Chisos, Ltd.

Rockport Oil & Gas L.L.C. PO Box 847 Houston, TX 77001	1.58 acres 1/10 of 15.80 acres	1.9909%	0.5609%	0.5224%	n/a
Chisos, LTD 670 Dona Ana Road SW Deming, New Mexico 88030	14.22 acres 9/10 of 15.80 acres	17.9183%	5.0480%	4.7012%	n/a

OIL & GAS OWNERSHIP

(1) Ernest Keene Heirs (<i>aka Ernest Keen</i>) (87.50 Acre Tract)	15.80 acres	19.9093%	5.6088%	5.2236%	
(a) Lula Sisk Keen Heirs, Devisees, Successors or Assigns					
(a.1) Ralph Keene Heirs, Devisees, Successors or Assigns					
(a.1.1) Grace Keen Heirs, Devisees, Successors or Assigns					
(a.1.1.1) Delores E. Estep 200 Summit Ave Lebanon, VA 24266	0.4514 acres 1/35 of 15.80 acres	0.5688%	0.1603%	0.1492%	0.9868% HB2058
(a.1.1.2) Darlene Bradley PO Box 503 Keen Mountain, VA 24624	0.4514 acres 1/35 of 15.80 acres	0.5688%	0.1603%	0.1492%	0.9868% HB2058
(a.1.1.3) Diana Lee Asbury PO Box 974 Lowell, NC 28098	0.4514 acres 1/35 of 15.80 acres	0.5688%	0.1603%	0.1492%	0.9868% HB2058
(a.1.1.4) Roy Earnest Keen 200 Summit Ave Lebanon, VA 24266	0.4514 acres 1/35 of 15.80 acres	0.5688%	0.1603%	0.1492%	0.9868% HB2058
(a.1.1.5) Ralph Douglas Keen PO Box 1121 Raven, VA 24639	0.4514 acres 1/35 of 15.80 acres	0.5688%	0.1603%	0.1492%	0.9868% HB2058
(a.1.1.6) Andy Glen Keen 4846 Quarterwood Rd Thaxton, VA 24174	0.4514 acres 1/35 of 15.80 acres	0.5688%	0.1603%	0.1492%	0.9868% HB2058

Exhibit EE
Unit X-29
Docket # VGOB-95-0418-0500-04
List of Respondents with Royalty Split Agreements/Court Orders/HB2058

	Acres in Unit	Percent of Unit	Division of Interest in 4 EAST = 28.172%	Division of Interest in 5 EAST = 26.237%	Percent of Escrow
(a.1.1.7) Randy Lynn Keen 49 Lakeshore Terrace Hardy, VA 24101	0.4514 acres 1/35 of 15.80 acres	0.5688%	0.1603%	0.1492%	0.9868% HB2058
(a.2) Arnold J. Keene 962 Ascue Rd Cedar Bluff, VA 24609	3.1600 acres 1/5 of 15.80 acres	3.9819%	1.1218%	1.0447%	6.9077% HB2058
(a.3) Paul Keene Heirs Devisees, Successors or Assigns	<i>Deceased with no issue - interest passes to siblings</i>				
(a.4) Elizabeth Ann McCowan Justice PO Box 677 Rosedale, VA 24280	3.1600 acres 1/5 of 15.80 acres	3.9819%	1.1218%	1.0447%	n/a
(a.5) Ruby Lee Keene Hale Heirs, Devisees, Successors or Assigns					
(a.5.1) Billy Ray Hale PO Box 311 Honaker, VA 24260	0.79 acres 1/20 of 15.80 acres	0.9955%	0.2804%	0.2612%	1.7269% HB2058
(a.5.2) Linda K. Matney PO Box 738 Pounding Mill, VA 24637	0.79 acres 1/20 of 15.80 acres	0.9955%	0.2804%	0.2612%	1.7269% HB2058
(a.5.3) Brenda Weddle PO Box 852 Pounding Mill, VA 24637	0.79 acres 1/20 of 15.80 acres	0.9955%	0.2804%	0.2612%	1.7269% HB2058
(a.5.4) Carl Lee Hale 104 Third Ave Richlands, VA 24641	0.79 acres 1/20 of 15.80 acres	0.9955%	0.2804%	0.2612%	1.7269% HB2058
(a.6) Anna R. Lambert 182 Blankenship Dr N. Tazewell, VA 24630	3.1600 acres 1/5 of 15.80 acres	3.9819%	1.1218%	1.0447%	n/a
Total Tract Acres	15.8000				
Total Tract Percentage		19.9093%			

Tract #2 - 0.30 Acres

COAL OWNERSHIP

(1) Hugh MacRae Land Trust Tr 5 c/o Gump, Strauss, Akin LLP 1 Bryant Park, Floor 41 New York, NY 10036-6715	0.30 acres	0.3780%	0.1065%	0.0992%	n/a
--	------------	---------	---------	---------	-----

By Assignment and Bill of Sale (Gas lease royalty), HMLT devised all of its right, title and interest (other than "Excluded Assets") to Torch Energy Advisors Inc. effective September 4, 1991 and recorded in Buchanan County under DB474 / PG384.

Torch Oil & Gas Company
c/o Sue Ann Craddock
670 Dona Ana Road SW
Deming, New Mexico 88030

Effective 2/1/11, Torch Oil & Gas Company assigned a 2% ORRI to SAC Investments, L.P.

Effective 3/31/14, Torch Oil & Gas Company, et al. assigned and conveyed 10% of its right, title and interest to Rockport Oil & Gas, L.L.C. In addition, Torch Oil & Gas Company, et al. assigned and conveyed the remaining 90% of its right, title and interest to Chisos, Ltd.

Rockport Oil & Gas L.L.C. PO Box 847 Houston, TX 77001	0.03 acres 1/10 of 0.30 acres	0.0378%			n/a
Chisos, LTD 670 Dona Ana Road SW Deming, New Mexico 88030	0.27 acres 9/10 of 0.30 acres	0.3402%			n/a

Exhibit EE
Unit X-29
Docket # VGOB-95-0418-0500-04
List of Respondents with Royalty Split Agreements/Court Orders/HB2058

	Acres in Unit	Percent of Unit	Division of Interest in 4 EAST = 28.172%	Division of Interest in 5 EAST = 26.237%	Percent of Escrow
<u>OIL & GAS OWNERSHIP</u>					
(1) CNX Gas Company LLC PO Box 643830 Pittsburgh, PA 15264-3830 <i>(previously Pocahontas Gas Partnership)</i>	0.30 acres	0.3780%	0.1065%	0.0992%	<i>n/a</i>
<u>Tract #3 - 2.76 Acres</u>					
<u>COAL OWNERSHIP</u>					
(1) Hugh MacRae Land Trust Tr 17 c/o Gump, Strauss, Akin LLP 1 Bryant Park, Floor 41 New York, NY 10036-6715	2.76 acres	3.4778%	0.9798%	0.9125%	<i>n/a</i>
<i>By Assignment and Bill of Sale (Gas lease royalty), HMLT devised all of its right, title and interest (other than "Excluded Assets") to Torch Energy Advisors Inc. effective September 4, 1991 and recorded in Buchanan County under DB474 / PG384.</i>					
Torch Oil & Gas Company c/o Sue Ann Craddock 670 Dona Ana Road SW Deming, New Mexico 88030					
<i>Effective 2/1/11, Torch Oil & Gas Company assigned a 2% ORRI to SAC Investments, L.P.</i>					
<i>Effective 3/31/14, Torch Oil & Gas Company, et al. assigned and conveyed 10% of its right, title and interest to Rockport Oil & Gas, L.L.C. In addition, Torch Oil & Gas Company, et al. assigned and conveyed the remaining 90% of its right, title and interest to Chisos, Ltd.</i>					
Rockport Oil & Gas L.L.C. PO Box 847 Houston, TX 77001	0.28 acres 1/10 of 2.76 acres	0.3478%	0.0980%	0.0912%	<i>n/a</i>
Chisos, LTD 670 Dona Ana Road SW Deming, New Mexico 88030	2.48 acres 9/10 of 2.76 acres	3.1300%	0.8818%	0.8212%	<i>n/a</i>
<u>OIL & GAS OWNERSHIP</u>					
(1) Ernest Keene Heirs (<i>aka Ernest Keen</i>) <i>(87.50 Acre Tract)</i>	2.76 acres	3.4778%	0.9798%	0.9125%	
(a) Lula Sisk Keen Heirs, Devisees, Successors or Assigns					
(a.1) Ralph Keene Heirs, Devisees, Successors or Assigns					
(a.1.1) Grace Keen Heirs, Devisees, Successors or Assigns					
(a.1.1.1) Delores E. Estep 200 Summit Ave Lebanon, VA 24266	0.0789 acres 1/35 of 2.76 acres	0.0994%	0.0280%	0.0261%	0.1724% HB2058
(a.1.1.2) Darlene Bradley PO Box 503 Keen Mountain, VA 24624	0.0789 acres 1/35 of 2.76 acres	0.0994%	0.0280%	0.0261%	0.1724% HB2058
(a.1.1.3) Diana Lee Asbury PO Box 974 Lowell, NC 28098	0.0789 acres 1/35 of 2.76 acres	0.0994%	0.0280%	0.0261%	0.1724% HB2058
(a.1.1.4) Roy Earnest Keen 200 Summit Ave Lebanon, VA 24266	0.0789 acres 1/35 of 2.76 acres	0.0994%	0.0280%	0.0261%	0.1724% HB2058
(a.1.1.5) Ralph Douglas Keen PO Box 1121 Raven, VA 24639	0.0789 acres 1/35 of 2.76 acres	0.0994%	0.0280%	0.0261%	0.1724% HB2058

Exhibit EE
Unit X-29
Docket # VGOB-95-0418-0500-04
List of Respondents with Royalty Split Agreements/Court Orders/HB2058

	Acres in Unit	Percent of Unit	Division of Interest in 4 EAST = 28.172%	Division of Interest in 5 EAST = 26.237%	Percent of Escrow
(a.1.1.6) Andy Glen Keen 4846 Quarterwood Rd Thaxton, VA 24174	0.0789 acres 1/35 of 2.76 acres	0.0994%	0.0280%	0.0261%	0.1724% HB2058
(a.1.1.7) Randy Lynn Keen 49 Lakeshore Terrace Hardy, VA 24101	0.0789 acres 1/35 of 2.76 acres	0.0994%	0.0280%	0.0261%	0.1724% HB2058
(a.2) Arnold J. Keene 962 Ascue Rd Cedar Bluff, VA 24609	0.5520 acres 1/5 of 2.76 acres	0.6956%	0.1960%	0.1825%	1.2067% HB2058
(a.3) Paul Keene Heirs Devisees, Successors or Assigns	<i>Deceased with no issue - interest passes to siblings</i>				
(a.4) Elizabeth Ann McCowan Justice PO Box 677 Rosedale, VA 24280	0.5520 acres 1/5 of 2.76 acres	0.6956%	0.1960%	0.1825%	n/a
(a.5) Ruby Lee Keene Hale Heirs, Devisees, Successors or Assigns					
(a.5.1) Billy Ray Hale PO Box 311 Honaker, VA 24260	0.138 acres 1/20 of 2.76 acres	0.1739%	0.0490%	0.0456%	0.3017% HB2058
(a.5.2) Linda K. Matney PO Box 738 Pounding Mill, VA 24637	0.138 acres 1/20 of 2.76 acres	0.1739%	0.0490%	0.0456%	0.3017% HB2058
(a.5.3) Brenda Weddle PO Box 852 Pounding Mill, VA 24637	0.138 acres 1/20 of 2.76 acres	0.1739%	0.0490%	0.0456%	0.3017% HB2058
(a.5.4) Carl Lee Hale 104 Third Ave Richlands, VA 24641	0.138 acres 1/20 of 2.76 acres	0.1739%	0.0490%	0.0456%	0.3017% HB2058
(a.6) Anna R. Lambert 182 Blankenship Dr N. Tazewell, VA 24630	0.5520 acres 1/5 of 2.76 acres	0.6956%	0.1960%	0.1825%	n/a
Total Tract Acres	2.7600				
Total Tract Percentage		3.4778%			

Tract #5 - 14.66 Acres

COAL OWNERSHIP

(1) Hugh MacRae Land Trust Tr 17 c/o Gump, Strauss, Akin LLP 1 Bryant Park, Floor 41 New York, NY 10036-6715	14.66 acres	18.4728%	5.2042%	4.8467%	n/a
---	-------------	----------	---------	---------	-----

By Assignment and Bill of Sale (Gas lease royalty), HMLT devised all of its right, title and interest (other than "Excluded Assets") to Torch Energy Advisors Inc. effective September 4, 1991 and recorded in Buchanan County under DB474 / PG384.

Torch Oil & Gas Company
c/o Sue Ann Craddock
670 Dona Ana Road SW
Deming, New Mexico 88030

Effective 2/1/11, Torch Oil & Gas Company assigned a 2% ORRI to SAC Investments, L.P.

Effective 3/31/14, Torch Oil & Gas Company, et al. assigned and conveyed 10% of its right, title and interest to Rockport Oil & Gas, L.L.C. In addition, Torch Oil & Gas Company, et al. assigned and conveyed the remaining 90% of its right, title and interest to Chisos, Ltd.

Rockport Oil & Gas L.L.C. PO Box 847 Houston, TX 77001	1.47 acres 1/10 of 14.66 acres	1.8473%	0.5204%	0.4847%	n/a
--	-----------------------------------	---------	---------	---------	-----

Exhibit EE
Unit X-29
Docket # VGOB-95-0418-0500-04
List of Respondents with Royalty Split Agreements/Court Orders/HB2058

	Acres in Unit	Percent of Unit	Division of Interest in 4 EAST = 28.172%	Division of Interest in 5 EAST = 26.237%	Percent of Escrow
Chisos, LTD 670 Dona Ana Road SW Deming, New Mexico 88030	13.19 acres 9/10 of 14.66 acres	16.6255%	4.6837%	4.3620%	n/a

OIL & GAS OWNERSHIP

(1) Bobby W. Steele PO Box 1153 Raven, VA 24639	14.66 acres	18.4728%	5.2042%	4.8467%	32.0465% HB2058
---	-------------	----------	---------	---------	--------------------

Tract #6 - 16.74 Acres

COAL OWNERSHIP

(1) Hugh MacRae Land Trust Tr 17 c/o Gump, Strauss, Akin LLP 1 Bryant Park, Floor 41 New York, NY 10036-6715	16.74 acres	21.0938%	5.9425%	5.5344%	n/a
---	-------------	----------	---------	---------	-----

By Assignment and Bill of Sale (Gas lease royalty), HMLT devised all of its right, title and interest (other than "Excluded Assets") to Torch Energy Advisors Inc. effective September 4, 1991 and recorded in Buchanan County under DB474 / PG384.

Torch Oil & Gas Company
c/o Sue Ann Craddock
670 Dona Ana Road SW
Deming, New Mexico 88030

Effective 2/1/11, Torch Oil & Gas Company assigned a 2% ORRI to SAC Investments, L.P.

Effective 3/31/14, Torch Oil & Gas Company, et al. assigned and conveyed 10% of its right, title and interest to Rockport Oil & Gas, L.L.C. In addition, Torch Oil & Gas Company, et al. assigned and conveyed the remaining 90% of its right, title and interest to Chisos, Ltd.

Rockport Oil & Gas L.L.C. PO Box 847 Houston, TX 77001	1.67 acres 1/10 of 16.74 acres	2.1094%	0.5943%	0.5534%	n/a
Chisos, LTD 670 Dona Ana Road SW Deming, New Mexico 88030	15.07 acres 9/10 of 16.74 acres	18.9844%	5.3483%	4.9809%	n/a

OIL & GAS OWNERSHIP

(1) CNX Gas Company LLC PO Box 643830 Pittsburgh, PA 15264-3830 <i>(previously Pocahontas Gas Partnership)</i>	16.74 acres	21.0938%	5.9425%	5.5344%	n/a
---	-------------	----------	---------	---------	-----

Tract #7 - 5.56 Acres

COAL OWNERSHIP

(1) Hugh MacRae Land Trust Tr 17 c/o Gump, Strauss, Akin LLP 1 Bryant Park, Floor 41 New York, NY 10036-6715	5.56 acres	7.0060%	1.9737%	1.8382%	n/a
---	------------	---------	---------	---------	-----

By Assignment and Bill of Sale (Gas lease royalty), HMLT devised all of its right, title and interest (other than "Excluded Assets") to Torch Energy Advisors Inc. effective September 4, 1991 and recorded in Buchanan County under DB474 / PG384.

Torch Oil & Gas Company
c/o Sue Ann Craddock
670 Dona Ana Road SW
Deming, New Mexico 88030

Effective 2/1/11, Torch Oil & Gas Company assigned a 2% ORRI to SAC Investments, L.P.

Effective 3/31/14, Torch Oil & Gas Company, et al. assigned and conveyed 10% of its right, title and interest to Rockport Oil & Gas, L.L.C. In addition, Torch Oil & Gas Company, et al. assigned and conveyed the remaining 90% of its right, title and interest to Chisos, Ltd.

Exhibit EE
Unit X-29
Docket # VGOB-95-0418-0500-04
List of Respondents with Royalty Split Agreements/Court Orders/HB2058

	Acres in Unit	Percent of Unit	Division of Interest in 4 EAST = 28.172%	Division of Interest in 5 EAST = 26.237%	Percent of Escrow
Rockport Oil & Gas L.L.C. PO Box 847 Houston, TX 77001	0.56 acres 1/10 of 5.56 acres	0.7006%	0.1974%	0.1838%	n/a
Chisos, LTD 670 Dona Ana Road SW Deming, New Mexico 88030	5.00 acres 9/10 of 5.56 acres	6.3054%	1.7764%	1.6544%	n/a
<u>OIL & GAS OWNERSHIP</u>					
(1) Earl & Nellie Marshall Heirs, Devises, Successors or Assigns <i>(25.00 Acre Tract)</i>	5.56 acres	7.0060%	1.9737%	1.8382%	
(a) Earl Marshall Heirs, Devises, Successors or Assigns					
(a.1) Nellie Jackson Marshall Heirs, Devises, Successors or Assigns					<i>Life Estate Extinguished</i>
(a.1.1) Wanda Marshall Ritchie Heirs, Devises, Successors or Assigns					
(a.1.1.1) Charles L. Ritchie					<i>Conveyed by quitclaim deed 7/30/11 Instrument 11-2643, including all past and present royalty escrowed or otherwise</i>
(a.1.1.1.1) Rebecca I. Ritchie Hale 1509 Kentucky Ave Bristol, TN 37620	2.780 acres 1/2 of 5.56 acres	3.5030%	0.9869%	0.9191%	6.0770% HB2058
(b) Nellie Jackson Marshall Heirs, Devises, Successors or Assigns					
(b.1) Herbert Lawrence Jackson Heirs, Devises, Successors or Assigns					
(b.1.1) Jerry W. Jackson					<i>Conveyed by quitclaim deed 2/4/09 Instrument 09-0565, including all past and present royalty escrowed or otherwise paid</i>
(b.1.1.1) Rebecca I. Ritchie Hale 1509 Kentucky Ave Bristol, TN 37620	0.695 acres 1/8 of 5.56 acres	0.8758%	0.2467%	0.2298%	1.5193% HB2058
(b.2) Lowery Lee Jackson Heirs, Devises, Successors or Assigns					
(b.2.1) Ruth Jackson					<i>Conveyed 2/26/08 Instrument 08-1526</i>
(b.2.1.1) Jerry W. Jackson					<i>Conveyed by quitclaim deed 2/4/09 Instrument 09-0565, including all past and present royalty escrowed or otherwise paid</i>
(b.2.1.1) Rebecca I. Ritchie Hale 1509 Kentucky Ave Bristol, TN 37620	0.695 acres 1/8 of 5.56 acres	0.8758%	0.2467%	0.2298%	1.5193% HB2058
(b.3) Wanda Marshall Ritchie Heirs, Devises, Successors or Assigns					
(b.3.1) Charles L. Ritchie					<i>Conveyed by quitclaim deed 7/30/11 Instrument 11-2643, including all past and present royalty escrowed or otherwise</i>
(b.3.1.1) Rebecca I. Ritchie Hale 1509 Kentucky Ave Bristol, TN 37620	0.695 acres 1/8 of 5.56 acres	0.8758%	0.2467%	0.2298%	1.5193% HB2058
(b.4) Corbit Jackson Heirs, Devises, Successors or Assigns <i>D.O.D 6/18/2008 Instrument 08-0207*</i>					
(b.4.1) Jerry W. Jackson					<i>Conveyed by quitclaim deed 2/4/09 Instrument 09-0565, including all past and present royalty escrowed or otherwise paid</i>

Exhibit EE
Unit X-29
Docket # VG0B-95-0418-0500-04
List of Respondents with Royalty Split Agreements/Court Orders/HB2058

	Acres in Unit	Percent of Unit	Division of Interest in 4 EAST = 28.172%	Division of Interest in 5 EAST = 26.237%	Percent of Escrow
(b.4.1.1) Rebecca I. Ritchie Hale 1509 Kentucky Ave Bristol, TN 37620			<i>n/a</i> see below		
* Instrument 08-0207 Pursuant to Article IV, Item 2 of the Last Will & Testament of Corbit Jackson, any money held in escrow at the time of his death passes to his six grandchildren listed below: (D.O.D. 6/18/2008)					
<i>The individuals below will receive a one time payout from escrow in accordance with the Will of Corbit Jackson</i>					
Michael Hess 109 Aldie Burn Ct Stephens City, VA 22655	0.116 acres 1/48 of 5.56 acres	0.1460%	0.0411%	0.0383%	0.2532% HB2058
Beth Underhill 243 Forest Ct Bentonville, VA 22610	0.116 acres 1/48 of 5.56 acres	0.1460%	0.0411%	0.0383%	0.2532% HB2058
David Hess 717 Cabell Rd Wingina, VA 24599	0.116 acres 1/48 of 5.56 acres	0.1460%	0.0411%	0.0383%	0.2532% HB2058
Jeff Jackson 1001 E. 35th St Charlotte, NC 28205	0.116 acres 1/48 of 5.56 acres	0.1460%	0.0411%	0.0383%	0.2532% HB2058
	Total Tract Acres	5.3283			
	Total Tract Percentage	6.7141%			

Tract #10 - 0.60 Acres

COAL OWNERSHIP

(1) Hugh MacRae Land Trust Tr 17 c/o Gump, Strauss, Akin LLP 1 Bryant Park, Floor 41 New York, NY 10036-6715	0.60 acres	0.7560%	0.2130%	0.1984%	<i>n/a</i>
---	------------	---------	---------	---------	------------

By Assignment and Bill of Sale (Gas lease royalty), HMLT devised all of its right, title and interest (other than "Excluded Assets") to Torch Energy Advisors Inc. effective September 4, 1991 and recorded in Buchanan County under DB474 / PG384.

Torch Oil & Gas Company
c/o Sue Ann Craddock
670 Dona Ana Road SW
Deming, New Mexico 88030

Effective 2/1/11, Torch Oil & Gas Company assigned a 2% ORRI to SAC Investments, L.P.

Effective 3/31/14, Torch Oil & Gas Company, et al. assigned and conveyed 10% of its right, title and interest to Rockport Oil & Gas, L.L.C. In addition, Torch Oil & Gas Company, et al. assigned and conveyed the remaining 90% of its right, title and interest to Chisos, Ltd.

Rockport Oil & Gas L.L.C. PO Box 847 Houston, TX 77001	0.06 acres 1/10 of 0.60 acres	0.0756%	0.0213%	0.0198%	<i>n/a</i>
Chisos, LTD 670 Dona Ana Road SW Deming, New Mexico 88030	0.54 acres 9/10 of 0.60 acres	0.6804%	0.1917%	0.1785%	<i>n/a</i>

OIL & GAS OWNERSHIP

(1) CNX Gas Company LLC PO Box 643830 Pittsburgh, PA 15264-3830 <i>(previously Pocahontas Gas Partnership)</i>	0.60 acres	0.7560%	0.2130%	0.1984%	<i>n/a</i>
---	------------	---------	---------	---------	------------

Exhibit EE
Unit X-29
Docket # VGOB-95-0418-0500-04
List of Respondents with Royalty Split Agreements/Court Orders/HB2058

	Acres in Unit	Percent of Unit	Division of Interest in 4 EAST = 28.172%	Division of Interest in 5 EAST = 26.237%	Percent of Escrow
Tract #12 - 0.32 Acres					
COAL OWNERSHIP					
(1) Hugh MacRae Land Trust Tr 17 c/o Gump, Strauss, Akin LLP 1 Bryant Park, Floor 41 New York, NY 10036-6715	0.32 acres	0.4032%	0.1136%	0.1058%	n/a
<i>By Assignment and Bill of Sale (Gas lease royalty), HMLT devised all of its right, title and interest (other than "Excluded Assets") to Torch Energy Advisors Inc. effective September 4, 1991 and recorded in Buchanan County under DB474 / PG384.</i>					
Torch Oil & Gas Company c/o Sue Ann Craddock 670 Dona Ana Road SW Deming, New Mexico 88030					
<i>Effective 2/1/11, Torch Oil & Gas Company assigned a 2% ORRI to SAC Investments, L.P.</i>					
<i>Effective 3/31/14, Torch Oil & Gas Company, et al. assigned and conveyed 10% of its right, title and interest to Rockport Oil & Gas, L.L.C. In addition, Torch Oil & Gas Company, et al. assigned and conveyed the remaining 90% of its right, title and interest to Chisos, Ltd.</i>					
Rockport Oil & Gas L.L.C. PO Box 847 Houston, TX 77001	0.03 acres 1/10 of 0.32 acres	0.0403%	0.0114%	0.0106%	n/a
Chisos, LTD 670 Dona Ana Road SW Deming, New Mexico 88030	0.29 acres 9/10 of 0.32 acres	0.3629%	0.1022%	0.0952%	n/a
OIL & GAS OWNERSHIP					
<i>Previously shown incorrectly as Nancy Rose, updated to reflect correct mapping and title ownership</i>					
(1) A. Ferrell Heirs, Devisees, Successors of Assigns	0.32 acres	0.4032%	0.1136%	0.1058%	
(a) Caroline B. Davis Heirs, Devisees, Successors or Assigns					
(a.1) John Douglas Davis 2146 Old Kentucky Turnpike Raven, VA 24639	0.006 acres 1/52 of 0.32 acres	0.0078%	0.0022%	0.0020%	0.0135% HB2058
(c) Mary Honaker Heirs, Devisees, Successors or Assigns					
(c.1) Jeanne Garrett 966 Maple Glen Drive Conover, NC 28613	0.004 acres 1/91 of 0.32 acres	0.0044%	0.0012%	0.0012%	0.0077% HB2058
(c.2) Yvonne White 7802 Long Island Rd Catawba, NC 28609	0.004 acres 1/91 of 0.32 acres	0.0044%	0.0012%	0.0012%	0.0077% HB2058
(c.3) Debra A. Estes 3316 6th Ave. NE Conover, NC 28613	0.004 acres 1/91 of 0.32 acres	0.0044%	0.0012%	0.0012%	0.0077% HB2058
(c.5) Lonnie Honaker 234 Blackhills Rd Pounding Mill, VA 24637	0.004 acres 1/91 of 0.32 acres	0.0044%	0.0012%	0.0012%	0.0077% HB2058
(d) Flora French Heirs, Devisees, Successors or Assigns					
(d.2) Sylvia McGlothlin PO Box 71 Cedar Bluff, VA 24609	0.008 acres 1/39 of 0.32 acres	0.0103%	0.0029%	0.0027%	0.0179% HB2058
(d.3) Charlotte Robinette 7862 Sarah Dr. Denver, NC 28037	0.008 acres 1/39 of 0.32 acres	0.0103%	0.0029%	0.0027%	0.0179% HB2058

Exhibit EE
Unit X-29
Docket # VGOB-95-0418-0500-04
List of Respondents with Royalty Split Agreements/Court Orders/HB2058

	Acres in Unit	Percent of Unit	Division of Interest in 4 EAST = 28.172%	Division of Interest in 5 EAST = 26.237%	Percent of Escrow
(f) Clarence Ferrell Heirs Devisees, Successors or Assigns					
(f.1.4) Eli See (LC) Ferrell 2057 Conaway Rd Big Rock, VA 24603	0.001 acres 1/234 of 0.32 acres	0.0017%	0.0005%	0.0005%	0.0030% HB2058
(f.1.7) Teddy Ferrell 30194 Blue Springs Rd Meadowview, VA 24631	0.001 acres 1/234 of 0.32 acres	0.0017%	0.0005%	0.0005%	0.0030% HB2058
(k) Margaret Wilkes Heirs, Devisees, Successors or Assigns					
(k.3) Michael Wilkes 929 Hulana Street Rossville, GA 30741	0.005 acres 1/65 of 0.32 acres	0.0062%	0.0017%	0.0016%	0.0108% HB2058
(k.4) Janet Willett 1642 Osburn Rd Chickamauga, GA 30707	0.005 acres 1/65 of 0.32 acres	0.0062%	0.0017%	0.0016%	0.0108% HB2058
Total Tract Acres	0.0492				
Total Tract Percentage		0.0620%			

Tract #14 - 2.58 Acres

COAL OWNERSHIP

(1) Hugh MacRae Land Trust Tr 17 c/o Gump, Strauss, Akin LLP 1 Bryant Park, Floor 41 New York, NY 10036-6715	2.58 acres	3.2510%	0.9159%	0.8530%	n/a
---	------------	---------	---------	---------	-----

By Assignment and Bill of Sale (Gas lease royalty), HMLT devised all of its right, title and interest (other than "Excluded Assets") to Torch Energy Advisors Inc. effective September 4, 1991 and recorded in Buchanan County under DB474 / PG384.

Torch Oil & Gas Company
c/o Sue Ann Craddock
670 Dona Ana Road SW
Deming, New Mexico 88030

Effective 2/1/11, Torch Oil & Gas Company assigned a 2% ORRI to SAC Investments, L.P.

Effective 3/31/14, Torch Oil & Gas Company, et al. assigned and conveyed 10% of its right, title and interest to Rockport Oil & Gas, L.L.C. In addition, Torch Oil & Gas Company, et al. assigned and conveyed the remaining 90% of its right, title and interest to Chisos, Ltd.

Rockport Oil & Gas L.L.C. PO Box 847 Houston, TX 77001	0.26 acres 1/10 of 2.58 acres	0.3251%	0.0916%	0.0853%	n/a
Chisos, LTD 670 Dona Ana Road SW Deming, New Mexico 88030	2.32 acres 9/10 of 2.58 acres	2.9259%	0.8243%	0.7677%	n/a

OIL & GAS OWNERSHIP

(1) Kermit & Ruth Steele Heirs, Devisees, Successors or Assigns	2.58 acres	3.2510%	0.9159%	0.8530%	
(a) Kermit Q. Steele Heirs, Devisees, Successors or Assigns					
(a.1) Ruth E. Steele Messer Heirs, Devisees, Successors or Assigns					
(b) Ruth E. Steele Messer Heirs, Devisees, Successors or Assigns					
(b.1) Bobby W. Steele PO Box 1153 Raven, VA 24639	0.65 acres 1/4 of 2.58 acres	0.8128%	0.2290%	0.2132%	1.4100% HB2058

Exhibit EE
Unit X-29
Docket # VGOB-95-0418-0500-04
List of Respondents with Royalty Split Agreements/Court Orders/HB2058

	Acres in Unit	Percent of Unit	Division of Interest in 4 EAST = 28.172%	Division of Interest in 5 EAST = 26.237%	Percent of Escrow
(b.2) James D. Steele PO Box 785 Max Meadows, VA 24360	0.65 acres 1/4 of 2.58 acres	0.8128%	0.2290%	0.2132%	1.4100% HB2058
(b.3) Judy Steele Horne 190 Drews Lane Cedar Bluff, VA 24609	0.65 acres 1/4 of 2.58 acres	0.8128%	0.2290%	0.2132%	1.4100% HB2058
Total Tract Acres		1.9350			
Total Tract Percentage			2.4383%		

Tract #15 - 7.40 Acres

This tract was incorrectly identified in previous order as a conflicting tract (Hugh MacRae Land Trust / Coal Mountain Mining Co.) No money was ever escrowed for this tract. Coal Mountain is the owner of Coal, Oil & Gas and is currently being paid.

COAL OWNERSHIP

(1) Coal Mountain Mining Co., Tr 17 P.O. Box 675 Tazewell, VA 24651	7.40 acres	9.3246%			n/a
---	------------	---------	--	--	-----

OIL & GAS OWNERSHIP

(1) Coal Mountain Mining Co., Tr 17 P.O. Box 675 Tazewell, VA 24651	7.40 acres	9.3246%			n/a
---	------------	---------	--	--	-----

Total Conflicts Resolved

Total Acres	65.5725
Total Percentage	82.6267%

AFFIDAVIT OF MAILING

COMMONWEALTH OF VIRGINIA
COUNTY OF **BUCHANAN**

Applicant: CNX Gas Company LLC
Relief Sought: Disbursement Petition for X29
VGOB: 95-0418-0500-04

I, Anita D. Duty, after being duly sworn upon oath, state as follows:

1. I am the Pooling Supervisor for CNX Land Resources, Inc. and am responsible for the notification process required by Va. Code Ann. §45.1-361.19 of the Code of Virginia and 4VAC25-160-40.
2. That on **June 14 & August 24, 2016** a true and correct copy of the Notice of Hearing and Exhibits were mailed, via certified mail return receipt requested, based upon information and belief, the names and last-known addresses, where such addresses are known, of the parties owning an interest in this cause are set forth and attached hereto.
3. Notice of this cause has therefore been served by mail pursuant to the applicable statutes and rules of the Board.

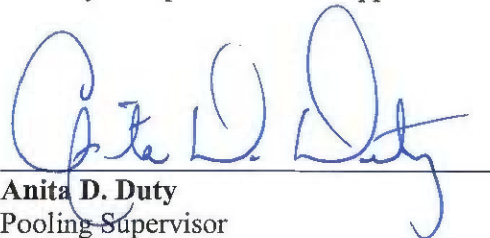

Anita D. Duty
Pooling Supervisor
for CNX Land LLC

STATE OF VIRGINIA

COUNTY OF TAZEWELL, TO-WIT:

TAKEN, SUBSCRIBED AND SWORN to before me this 13 day of Sept.,
2016.



Notary Public

My commission expires: 3/31/20

JANET RUTH WHITE
NOTARY PUBLIC
Commonwealth of Virginia
Reg# 7667821
My Commission Expires 3/31/20

CERTIFICATION OF NOTICE
CNX Gas Company LLC

X29
VGOB 95-0418-0500-04

Disbursement

Buchanan

Last Name	First Name	MAILED	RECEIPT #		Received
Asbury	Diana	6/14/2016	7016034000008989	0160	REFUSED 1
Bradley	Darlene	6/14/2016	7016034000008989	0177	6/17/2016 2
Davis	John D.	6/14/2016	7016034000008989	0184	6/23/2016 3
Estep	Delores	6/14/2016	7016034000008989	0197	6/28/2016 4
Estes	Debra A.	6/14/2016	7016034000008989	0207	6/22/2016 5
Ferrell	Ell See	6/14/2016	7016034000008989	0214	6/21/2016 6
Ferrell	Teddy	6/14/2016	7016034000008989	0221	6/16/2016 7
Garrett	Jeanne	6/14/2016	7016034000008989	0238	6/16/2016 8
Hale	Billy Ray Hale	6/14/2016	7016034000008989	0245	6/17/2016 9
Hale	Carl Lee	6/14/2016	7016034000008989	0252	6/16/2016 10
Hess	David	8/24/2016	7016034000008989	3759	8/29/2016 11
Hess	Michael	6/14/2016	7016034000008989	0276	6/17/2016 12
Honaker	Lonnie	6/14/2016	7016034000008989	0283	6/15/2016 13
Horne	Judy	6/14/2016	7016034000008989	0290	6/22/2016 14
Jackson	Jeff	6/14/2016	7016034000008989	0306	6/16/2016 15
Jackson	Jerry	6/14/2016	7016034000008989	0313	6/18/2016 16
Keen	Ralph D.	6/14/2016	7016034000008989	0337	6/22/2016 18
Keen	Randy L.	6/14/2016	7016034000008989	0344	Unclaimed 19
Keen	Roy E.	6/14/2016	7016034000008989	0351	6/28/2016 20
Keene	Arnold	6/14/2016	7016034000008989	0368	6/16/2016 21
Matney	Linda Hale	6/14/2016	7016034000008989	0375	6/15/2016 22
McGlothlin	Sylvia	6/14/2016	7016034000008989	0382	6/17/2016 23
Robinette	Charlotte	6/14/2016	7016034000008989	0405	6/16/2016 25
Steele	Bobby	6/14/2016	7016034000008989	0412	6/17/2016 26
Steele	James Donald	6/14/2016	7016034000008989	0429	6/16/2016 27
Underhill	Beth	6/14/2016	7016034000008989	0436	6/20/2016 28
Weddle	Brenda	6/14/2016	7016034000008989	0443	6/15/2016 29
White	Yvonne	6/14/2016	7016034000008989	0450	6/17/2016 30
Wilkes	Michael Ellis	6/14/2016	7016034000008989	0467	6/18/2016 31
Willett	Janet M.	6/14/2016	7016034000008989	0474	6/23/2016 32

COMPLETE THIS SECTION ON DELIVERY

A. Signature Agent Address Date of Delivery Yes No

B. Received by (Printed Name) James Hess C. Date of Delivery 6-16

D. Is delivery address different from item 1? Yes No

If YES, enter delivery address below:

1. Article Addressed to:

2. Article Number (transfer from service label)

3. Service Type Priority Mail Express® Registered Mail™ Registered Mail Restricted Delivery Certified Mail® Certified Mail Restricted Delivery Collect on Delivery Restricted Delivery Insured Mail™ Insured Mail Restricted Delivery (over \$500)

4. Signature Adult Signature Restricted Delivery Return Receipt for Merchandise Signature Confirmation™ Signature Confirmation Restricted Delivery

5. Domestic Return Receipt

6. PS F: 7016 0340 0000 8989 0236

COMPLETE THIS SECTION ON DELIVERY

A. Signature Agent Address Date of Delivery Yes No

B. Received by (Printed Name) Stevie Hess C. Date of Delivery 6-17

D. Is delivery address different from item 1? Yes No

If YES, enter delivery address below:

1. Article Addressed to:

2. Article Number (transfer from service label)

3. Service Type Priority Mail Express® Registered Mail™ Registered Mail Restricted Delivery Certified Mail® Certified Mail Restricted Delivery Collect on Delivery Restricted Delivery Insured Mail™ Insured Mail Restricted Delivery (over \$500)

4. Signature Adult Signature Restricted Delivery Return Receipt for Merchandise Signature Confirmation™ Signature Confirmation Restricted Delivery

5. Domestic Return Receipt

6. PS F: 7016 0340 0000 8989 0236

COMPLETE THIS SECTION ON DELIVERY

A. Signature Agent Address Date of Delivery Yes No

B. Received by (Printed Name) Stevie Hess C. Date of Delivery 6-17

D. Is delivery address different from item 1? Yes No

If YES, enter delivery address below:

1. Article Addressed to:

2. Article Number (transfer from service label)

3. Service Type Priority Mail Express® Registered Mail™ Registered Mail Restricted Delivery Certified Mail® Certified Mail Restricted Delivery Collect on Delivery Restricted Delivery Insured Mail™ Insured Mail Restricted Delivery (over \$500)

4. Signature Adult Signature Restricted Delivery Return Receipt for Merchandise Signature Confirmation™ Signature Confirmation Restricted Delivery

5. Domestic Return Receipt

6. PS F: 7016 0340 0000 8989 0236

COMPLETE THIS SECTION ON DELIVERY

A. Signature Agent Address Date of Delivery Yes No

B. Received by (Printed Name) Stevie Hess C. Date of Delivery 6-17

D. Is delivery address different from item 1? Yes No

If YES, enter delivery address below:

1. Article Addressed to:

2. Article Number (transfer from service label)

3. Service Type Priority Mail Express® Registered Mail™ Registered Mail Restricted Delivery Certified Mail® Certified Mail Restricted Delivery Collect on Delivery Restricted Delivery Insured Mail™ Insured Mail Restricted Delivery (over \$500)

4. Signature Adult Signature Restricted Delivery Return Receipt for Merchandise Signature Confirmation™ Signature Confirmation Restricted Delivery

5. Domestic Return Receipt

6. PS F: 7016 0340 0000 8989 0236

COMPLETE THIS SECTION ON DELIVERY

A. Signature Agent Address Date of Delivery Yes No

B. Received by (Printed Name) James Hess C. Date of Delivery 6-16

D. Is delivery address different from item 1? Yes No

If YES, enter delivery address below:

1. Article Addressed to:

2. Article Number (transfer from service label)

3. Service Type Priority Mail Express® Registered Mail™ Registered Mail Restricted Delivery Certified Mail® Certified Mail Restricted Delivery Collect on Delivery Restricted Delivery Insured Mail™ Insured Mail Restricted Delivery (over \$500)

4. Signature Adult Signature Restricted Delivery Return Receipt for Merchandise Signature Confirmation™ Signature Confirmation Restricted Delivery

5. Domestic Return Receipt

6. PS F: 7016 0340 0000 8989 0236

COMPLETE THIS SECTION ON DELIVERY

A. Signature Agent Address Date of Delivery Yes No

B. Received by (Printed Name) James Hess C. Date of Delivery 6-16

D. Is delivery address different from item 1? Yes No

If YES, enter delivery address below:

1. Article Addressed to:

2. Article Number (transfer from service label)

3. Service Type Priority Mail Express® Registered Mail™ Registered Mail Restricted Delivery Certified Mail® Certified Mail Restricted Delivery Collect on Delivery Restricted Delivery Insured Mail™ Insured Mail Restricted Delivery (over \$500)

4. Signature Adult Signature Restricted Delivery Return Receipt for Merchandise Signature Confirmation™ Signature Confirmation Restricted Delivery

5. Domestic Return Receipt

6. PS F: 7016 0340 0000 8989 0236

<p>COMPLETE THIS SECTION ON DELIVERY</p> <p>A. Signature <input checked="" type="checkbox"/> <i>Bob Steele</i></p> <p>B. Received by (Printed Name) <input checked="" type="checkbox"/> <i>Bob Steele</i> C. Date of Delivery <input checked="" type="checkbox"/> <i>6-17-16</i></p> <p>D. Is delivery address different from item 1? <input checked="" type="checkbox"/> Yes <input type="checkbox"/> No</p> <p>If YES, enter delivery address below:</p>	<p>3. Service Type</p> <p><input type="checkbox"/> Priority Mail Express®</p> <p><input type="checkbox"/> Adult Signature Restricted Delivery</p> <p><input type="checkbox"/> Certified Mail®</p> <p><input type="checkbox"/> Collect on Delivery Restricted Delivery</p> <p><input type="checkbox"/> Insured Mail (over \$500)</p> <p><input type="checkbox"/> Registered Mail Restricted Delivery</p> <p><input type="checkbox"/> Return Receipt for Merchandise</p> <p><input type="checkbox"/> Signature Confirmation®</p> <p><input type="checkbox"/> Signature Confirmation Restricted Delivery</p> <p><input type="checkbox"/> Registered Return Receipt</p>	<p>COMPLETE THIS SECTION ON DELIVERY</p> <p>A. Signature <input checked="" type="checkbox"/> <i>Bob Steele</i></p> <p>B. Received by (Printed Name) <input checked="" type="checkbox"/> <i>Bob Steele</i> C. Date of Delivery <input checked="" type="checkbox"/> <i>6-17-16</i></p> <p>D. Is delivery address different from item 1? <input checked="" type="checkbox"/> Yes <input type="checkbox"/> No</p> <p>If YES, enter delivery address below:</p>	<p>COMPLETE THIS SECTION ON DELIVERY</p> <p>A. Signature <input checked="" type="checkbox"/> <i>Bob Steele</i></p> <p>B. Received by (Printed Name) <input checked="" type="checkbox"/> <i>Bob Steele</i> C. Date of Delivery <input checked="" type="checkbox"/> <i>6-17-16</i></p> <p>D. Is delivery address different from item 1? <input checked="" type="checkbox"/> Yes <input type="checkbox"/> No</p> <p>If YES, enter delivery address below:</p>
<p>SENDER: COMPLETE THIS SECTION</p> <p>1. Article Addressed to:</p> <p>Bobby Steele PO Box 1153 Raven VA 24639-1153</p> <p>9590 9402 1705 6053 9820 20</p> <p>2. Article Number (Transfer from service label)</p> <p>70JL6 0340 0000 8989</p>	<p>3. Service Type</p> <p><input type="checkbox"/> Priority Mail Express®</p> <p><input type="checkbox"/> Adult Signature Restricted Delivery</p> <p><input type="checkbox"/> Certified Mail®</p> <p><input type="checkbox"/> Collect on Delivery Restricted Delivery</p> <p><input type="checkbox"/> Insured Mail (over \$500)</p> <p><input type="checkbox"/> Registered Mail Restricted Delivery</p> <p><input type="checkbox"/> Return Receipt for Merchandise</p> <p><input type="checkbox"/> Signature Confirmation®</p> <p><input type="checkbox"/> Signature Confirmation Restricted Delivery</p> <p><input type="checkbox"/> Registered Return Receipt</p>	<p>SENDER: COMPLETE THIS SECTION</p> <p>1. Article Addressed to:</p> <p>James D. Steele 181 Bearwallow Rd. Max Meadows VA 24360</p> <p>9590 9402 1705 6053 9817 71</p> <p>2. Article Number (Transfer from service label)</p> <p>70JL6 0340 0000 8989 0429</p>	<p>SENDER: COMPLETE THIS SECTION</p> <p>1. Article Addressed to:</p> <p>Sylvia McGlothlin PO Box 71 Cedar Bluff VA 24609</p> <p>9590 9402 1705 6053 9819 93</p> <p>2. Article Number (Transfer from service label)</p> <p>70JL6 0340 0000 8989 0382</p>
<p>COMPLETE THIS SECTION ON DELIVERY</p> <p>A. Signature <input checked="" type="checkbox"/> <i>John Ratliff</i></p> <p>B. Received by (Printed Name) <input checked="" type="checkbox"/> <i>John Ratliff</i> C. Date of Delivery <input checked="" type="checkbox"/> <i>6-16-16</i></p> <p>D. Is delivery address different from item 1? <input checked="" type="checkbox"/> Yes <input type="checkbox"/> No</p> <p>If YES, enter delivery address below:</p>	<p>3. Service Type</p> <p><input type="checkbox"/> Priority Mail Express®</p> <p><input type="checkbox"/> Adult Signature Restricted Delivery</p> <p><input type="checkbox"/> Certified Mail®</p> <p><input type="checkbox"/> Collect on Delivery Restricted Delivery</p> <p><input type="checkbox"/> Insured Mail (over \$500)</p> <p><input type="checkbox"/> Registered Mail Restricted Delivery</p> <p><input type="checkbox"/> Return Receipt for Merchandise</p> <p><input type="checkbox"/> Signature Confirmation®</p> <p><input type="checkbox"/> Signature Confirmation Restricted Delivery</p> <p><input type="checkbox"/> Registered Return Receipt</p>	<p>COMPLETE THIS SECTION ON DELIVERY</p> <p>A. Signature <input checked="" type="checkbox"/> <i>John Ratliff</i></p> <p>B. Received by (Printed Name) <input checked="" type="checkbox"/> <i>John Ratliff</i> C. Date of Delivery <input checked="" type="checkbox"/> <i>6-16-16</i></p> <p>D. Is delivery address different from item 1? <input checked="" type="checkbox"/> Yes <input type="checkbox"/> No</p> <p>If YES, enter delivery address below:</p>	<p>COMPLETE THIS SECTION ON DELIVERY</p> <p>A. Signature <input checked="" type="checkbox"/> <i>John Ratliff</i></p> <p>B. Received by (Printed Name) <input checked="" type="checkbox"/> <i>John Ratliff</i> C. Date of Delivery <input checked="" type="checkbox"/> <i>6-16-16</i></p> <p>D. Is delivery address different from item 1? <input checked="" type="checkbox"/> Yes <input type="checkbox"/> No</p> <p>If YES, enter delivery address below:</p>
<p>COMPLETE THIS SECTION ON DELIVERY</p> <p>A. Signature <input checked="" type="checkbox"/> <i>John Ratliff</i></p> <p>B. Received by (Printed Name) <input checked="" type="checkbox"/> <i>John Ratliff</i> C. Date of Delivery <input checked="" type="checkbox"/> <i>6-16-16</i></p> <p>D. Is delivery address different from item 1? <input checked="" type="checkbox"/> Yes <input type="checkbox"/> No</p> <p>If YES, enter delivery address below:</p>	<p>3. Service Type</p> <p><input type="checkbox"/> Priority Mail Express®</p> <p><input type="checkbox"/> Adult Signature Restricted Delivery</p> <p><input type="checkbox"/> Certified Mail®</p> <p><input type="checkbox"/> Collect on Delivery Restricted Delivery</p> <p><input type="checkbox"/> Insured Mail (over \$500)</p> <p><input type="checkbox"/> Registered Mail Restricted Delivery</p> <p><input type="checkbox"/> Return Receipt for Merchandise</p> <p><input type="checkbox"/> Signature Confirmation®</p> <p><input type="checkbox"/> Signature Confirmation Restricted Delivery</p> <p><input type="checkbox"/> Registered Return Receipt</p>	<p>COMPLETE THIS SECTION ON DELIVERY</p> <p>A. Signature <input checked="" type="checkbox"/> <i>John Ratliff</i></p> <p>B. Received by (Printed Name) <input checked="" type="checkbox"/> <i>John Ratliff</i> C. Date of Delivery <input checked="" type="checkbox"/> <i>6-16-16</i></p> <p>D. Is delivery address different from item 1? <input checked="" type="checkbox"/> Yes <input type="checkbox"/> No</p> <p>If YES, enter delivery address below:</p>	<p>COMPLETE THIS SECTION ON DELIVERY</p> <p>A. Signature <input checked="" type="checkbox"/> <i>John Ratliff</i></p> <p>B. Received by (Printed Name) <input checked="" type="checkbox"/> <i>John Ratliff</i> C. Date of Delivery <input checked="" type="checkbox"/> <i>6-16-16</i></p> <p>D. Is delivery address different from item 1? <input checked="" type="checkbox"/> Yes <input type="checkbox"/> No</p> <p>If YES, enter delivery address below:</p>
<p>COMPLETE THIS SECTION ON DELIVERY</p> <p>A. Signature <input checked="" type="checkbox"/> <i>John Ratliff</i></p> <p>B. Received by (Printed Name) <input checked="" type="checkbox"/> <i>John Ratliff</i> C. Date of Delivery <input checked="" type="checkbox"/> <i>6-16-16</i></p> <p>D. Is delivery address different from item 1? <input checked="" type="checkbox"/> Yes <input type="checkbox"/> No</p> <p>If YES, enter delivery address below:</p>	<p>3. Service Type</p> <p><input type="checkbox"/> Priority Mail Express®</p> <p><input type="checkbox"/> Adult Signature Restricted Delivery</p> <p><input type="checkbox"/> Certified Mail®</p> <p><input type="checkbox"/> Collect on Delivery Restricted Delivery</p> <p><input type="checkbox"/> Insured Mail (over \$500)</p> <p><input type="checkbox"/> Registered Mail Restricted Delivery</p> <p><input type="checkbox"/> Return Receipt for Merchandise</p> <p><input type="checkbox"/> Signature Confirmation®</p> <p><input type="checkbox"/> Signature Confirmation Restricted Delivery</p> <p><input type="checkbox"/> Registered Return Receipt</p>	<p>COMPLETE THIS SECTION ON DELIVERY</p> <p>A. Signature <input checked="" type="checkbox"/> <i>John Ratliff</i></p> <p>B. Received by (Printed Name) <input checked="" type="checkbox"/> <i>John Ratliff</i> C. Date of Delivery <input checked="" type="checkbox"/> <i>6-16-16</i></p> <p>D. Is delivery address different from item 1? <input checked="" type="checkbox"/> Yes <input type="checkbox"/> No</p> <p>If YES, enter delivery address below:</p>	<p>COMPLETE THIS SECTION ON DELIVERY</p> <p>A. Signature <input checked="" type="checkbox"/> <i>John Ratliff</i></p> <p>B. Received by (Printed Name) <input checked="" type="checkbox"/> <i>John Ratliff</i> C. Date of Delivery <input checked="" type="checkbox"/> <i>6-16-16</i></p> <p>D. Is delivery address different from item 1? <input checked="" type="checkbox"/> Yes <input type="checkbox"/> No</p> <p>If YES, enter delivery address below:</p>

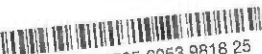
SENDER: COMPLETE THIS SECTION	COMPLETE THIS SECTION ON DELIVERY	
<ul style="list-style-type: none"> Complete items 1, 2, and 3. Print your name and address on the reverse so that we can return the card to you. Attach this card to the back of the mailpiece, or on the front if space permits. 	<p>A. Signature <i>Janet & Robert Willett</i></p> <p>B. Received by (Printed Name) <i>Janet & Robert Willett</i></p> <p>C. Date of Delivery <i>6-23-16</i></p> <p>D. Is delivery address different from item 1? <input type="checkbox"/> Yes If YES, enter delivery address below: <input type="checkbox"/> No</p>	<p><input type="checkbox"/> Agent Addressed</p>
<p>1. Article Addressed to:</p> <p>Janet & Robert Willett 1624 OSBURN RD CHICKAMAUGA GA 30707-2783</p>  <p>9590 9402 1705 6053 9818 25</p>	<p>3. Service Type</p> <p><input type="checkbox"/> Adult Signature</p> <p><input type="checkbox"/> Adult Signature Restricted Delivery</p> <p><input type="checkbox"/> Certified Mail</p> <p><input type="checkbox"/> Certified Mail Restricted Delivery</p> <p><input type="checkbox"/> Collect on Delivery</p> <p><input type="checkbox"/> Collect on Delivery Restricted Delivery</p> <p><input type="checkbox"/> Insured Mail</p> <p><input type="checkbox"/> Insured Mail Restricted Delivery</p> <p><input type="checkbox"/> Priority Mail Express</p> <p><input type="checkbox"/> Registered Mail</p> <p><input type="checkbox"/> Registered Mail Restricted Delivery</p> <p><input type="checkbox"/> Return Receipt for Merchandise</p> <p><input type="checkbox"/> Signature Confirmation</p> <p><input type="checkbox"/> Signature Confirmation Restricted Delivery</p>	<p><input type="checkbox"/> Domestic Return Receipt</p>
<p>2. Article Number (Transfer from service label)</p> <p>7016 0340 0000 8989 0474</p>	<p>PS 1</p>	

SENDER: COMPLETE THIS SECTION	COMPLETE THIS SECTION ON DELIVERY	
<ul style="list-style-type: none"> Complete items 1, 2, and 3. Print your name and address on the reverse so that we can return the card to you. Attach this card to the back of the mailpiece, or on the front if space permits. 	<p>A. Signature <i>Michael Ellis Wilkes</i></p> <p>B. Received by (Printed Name) <i>Michael Ellis Wilkes</i></p> <p>C. Date of Delivery <i>6-18-16</i></p> <p>D. Is delivery address different from item 1? <input type="checkbox"/> Yes If YES, enter delivery address below: <input type="checkbox"/> No</p>	<p><input type="checkbox"/> Agent Addressed</p>
<p>1. Article Addressed to:</p> <p>Michael Ellis Wilkes 929 Hulana Street Rossville GA 30741</p>  <p>9590 9402 1705 6053 9818 18</p>	<p>3. Service Type</p> <p><input type="checkbox"/> Adult Signature</p> <p><input type="checkbox"/> Adult Signature Restricted Delivery</p> <p><input type="checkbox"/> Certified Mail</p> <p><input type="checkbox"/> Certified Mail Restricted Delivery</p> <p><input type="checkbox"/> Collect on Delivery</p> <p><input type="checkbox"/> Collect on Delivery Restricted Delivery</p> <p><input type="checkbox"/> Insured Mail</p> <p><input type="checkbox"/> Insured Mail Restricted Delivery</p> <p><input type="checkbox"/> Priority Mail Express</p> <p><input type="checkbox"/> Registered Mail</p> <p><input type="checkbox"/> Registered Mail Restricted Delivery</p> <p><input type="checkbox"/> Return Receipt for Merchandise</p> <p><input type="checkbox"/> Signature Confirmation</p> <p><input type="checkbox"/> Signature Confirmation Restricted Delivery</p>	<p><input type="checkbox"/> Domestic Return Receipt</p>
<p>2. Article Number (Transfer from service label)</p> <p>7016 0340 0000 8989 0467</p>	<p>PS Form</p>	



USPS Tracking®

Still Have Questions?

[Browse our FAQs >](#)



[Get Easy Tracking Updates >](#)
Sign up for My USPS.

Tracking Number: 7016034000089883759

David Lee Hess

Product & Tracking Information

Postal Product:

Features:
Certified Mail™

Available Actions

[Text Updates](#)

[Email Updates](#)

DATE & TIME	STATUS OF ITEM	LOCATION
August 29, 2016 , 4:06 pm	Delivered, Left with Individual	CROZET, VA 22932

Your item was delivered to an individual at the address at 4:06 pm on August 29, 2016 in CROZET, VA 22932.

August 29, 2016 , 10:55 am	Arrived at Unit	CROZET, VA 22932
August 28, 2016 , 8:10 am	Departed USPS Facility	SANDSTON, VA 23150
August 27, 2016 , 9:34 am	Arrived at USPS Facility	SANDSTON, VA 23150
August 26, 2016 , 3:22 am	Departed USPS Facility	CHARLESTON, WV 25350
August 25, 2016 , 9:17 pm	Arrived at USPS Origin Facility	CHARLESTON, WV 25350
August 25, 2016 , 5:05 pm	Departed Post Office	POUNDING MILL, VA 24637
August 25, 2016 , 11:01 am	Acceptance	POUNDING MILL, VA 24637

Track Another Package

Tracking (or receipt) number

[Track It](#)

Manage Incoming Packages

Track all your packages from a dashboard. No tracking numbers necessary.

[Sign up for My USPS >](#)



CERTIFIED MAIL

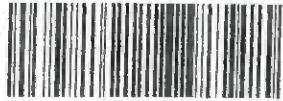

4989 0344

POSTAGE WILL BE PAID BY ADDRESSEE
FIRST CLASS PERMIT NO. 1000 JAMES CITY VA
POST OFFICE BOX 24637
\$ 007.89

Po

June 14, 2016

JNC

RE: Unite Y20

Randy Keen
49 Lakeshore Terrace Road
HARDY VA 24101

04
Crow

NIXIE 020204261-1N 07/11/16
RETURN TO SENDER
UNABLE TO FORWARD
UNABLE TO FORWARD
RETURN TO SENDER

*6/16/2
8-21/16
7-1*

SENDER: COMPLETE THIS SECTION

- Complete items 1, 2, and 3.
- Print your name and address on the reverse so that we can return the card to you.
- Attach this card to the back of the mailpiece, or on the front if space permits.

1. Article Addressed to:

Randy Keen
49 Lakeshore Terrace Road
HARDY VA 24101



9590 9402 1705 6053 9819 55

2. Article Number (Transfer from service label)

COMPLETE THIS SECTION ON DELIVERY

A. Signature Agent
X Addressee

B. Received by (Printed Name) C. Date of Delivery

D. Is delivery address different from item 1? Yes
If YES, enter delivery address below: No

3. Service Type

<input type="checkbox"/> Adult Signature	<input type="checkbox"/> Priority Mail Express®
<input type="checkbox"/> Adult Signature Restricted Delivery	<input type="checkbox"/> Registered Mail™
<input type="checkbox"/> Certified Mail®	<input type="checkbox"/> Registered Mail Restricted Delivery
<input type="checkbox"/> Certified Mail Restricted Delivery	<input type="checkbox"/> Return Receipt for Merchandise
<input type="checkbox"/> Collect on Delivery	<input type="checkbox"/> Signature Confirmation™
<input type="checkbox"/> Collect on Delivery Restricted Delivery	<input type="checkbox"/> Signature Confirmation Restricted Delivery
<input type="checkbox"/> Insured Mail	
<input type="checkbox"/> Insured Mail Restricted Delivery (over \$500)	

PSF 7016 0340 0000 8989 0344 *209-0187* Domestic Return Receipt

CERTIFIED MAIL



7016 0340 0000 8989 0160

CONSOL ENERGY



Po

Diana Asbury
1513 School Avenue
Gastonia VA 28052

VOUD 99-0418-0500-04

REFUSED
6-16-16

NIXIE 280522338-1N
RETURN TO SENDER
REFUSED
UNABLE TO FORWARD
RETURN TO SENDER

06/28/16

SENDER: COMPLETE THIS SECTION	COMPLETE THIS SECTION ON DELIVERY																
<ul style="list-style-type: none"> Complete Items 1, 2, and 3. Print your name and address on the reverse so that we can return the card to you. Attach this card to the back of the mailpiece, or on the front if space permits. 	<p>A. Signature <input checked="" type="checkbox"/> <input type="checkbox"/> Agent <input checked="" type="checkbox"/> <input type="checkbox"/> Addressee</p> <p>B. Received by (Printed Name): C. Date of Delivery:</p>																
<p>1. Article Addressed to:</p> <p>Diana Asbury 1513 School Avenue Gastonia VA 28052</p>	<p>D. Is delivery address different from item 1? <input type="checkbox"/> Yes If YES, enter delivery address below: <input type="checkbox"/> No</p>																
<p>2. Article Number (Transfer from service label)</p> <p>9590 9402 1705 6053 9824 88</p>	<p>3. Service Type</p> <table border="0"> <tr> <td><input type="checkbox"/> Adult Signature</td> <td><input type="checkbox"/> Delivery After Hours®</td> </tr> <tr> <td><input type="checkbox"/> Adult Signature Restricted Delivery</td> <td><input type="checkbox"/> Registered Mail®</td> </tr> <tr> <td><input type="checkbox"/> Certified Mail®</td> <td><input type="checkbox"/> Registered Mail Restricted Delivery</td> </tr> <tr> <td><input type="checkbox"/> Certified Mail Restricted Delivery</td> <td><input type="checkbox"/> Return Receipt for Merchandise</td> </tr> <tr> <td><input type="checkbox"/> Collect on Delivery</td> <td><input type="checkbox"/> Signature Confirmation®</td> </tr> <tr> <td><input type="checkbox"/> Collect on Delivery Restricted Delivery</td> <td><input type="checkbox"/> Signature Confirmation Restricted Delivery</td> </tr> <tr> <td><input type="checkbox"/> Insured Mail</td> <td></td> </tr> <tr> <td><input type="checkbox"/> Insured Mail Restricted Delivery</td> <td></td> </tr> </table>	<input type="checkbox"/> Adult Signature	<input type="checkbox"/> Delivery After Hours®	<input type="checkbox"/> Adult Signature Restricted Delivery	<input type="checkbox"/> Registered Mail®	<input type="checkbox"/> Certified Mail®	<input type="checkbox"/> Registered Mail Restricted Delivery	<input type="checkbox"/> Certified Mail Restricted Delivery	<input type="checkbox"/> Return Receipt for Merchandise	<input type="checkbox"/> Collect on Delivery	<input type="checkbox"/> Signature Confirmation®	<input type="checkbox"/> Collect on Delivery Restricted Delivery	<input type="checkbox"/> Signature Confirmation Restricted Delivery	<input type="checkbox"/> Insured Mail		<input type="checkbox"/> Insured Mail Restricted Delivery	
<input type="checkbox"/> Adult Signature	<input type="checkbox"/> Delivery After Hours®																
<input type="checkbox"/> Adult Signature Restricted Delivery	<input type="checkbox"/> Registered Mail®																
<input type="checkbox"/> Certified Mail®	<input type="checkbox"/> Registered Mail Restricted Delivery																
<input type="checkbox"/> Certified Mail Restricted Delivery	<input type="checkbox"/> Return Receipt for Merchandise																
<input type="checkbox"/> Collect on Delivery	<input type="checkbox"/> Signature Confirmation®																
<input type="checkbox"/> Collect on Delivery Restricted Delivery	<input type="checkbox"/> Signature Confirmation Restricted Delivery																
<input type="checkbox"/> Insured Mail																	
<input type="checkbox"/> Insured Mail Restricted Delivery																	
<p>7016 0340 0000 8989 0160</p>	<p>Domestic Return Receipt</p>																



USPS Tracking®

Still Have Questions?

[Browse our FAQs >](#)



[Get Easy Tracking Updates >](#)
Sign up for My USPS.

Tracking Number: 70160340000089890252

Carl Hale

Updated Delivery Day: Thursday, June 16, 2016

Product & Tracking Information

Available Actions

Postal Product:

Features:
Certified Mail™

DATE & TIME

STATUS OF ITEM

LOCATION

June 16, 2016 , 1:02 pm

Delivered, Left with Individual

RICHLANDS, VA 24641

Your item was delivered to an individual at the address at 1:02 pm on June 16, 2016 in RICHLANDS, VA 24641.

June 16, 2016 , 12:59 pm	Notice Left (No Authorized Recipient Available)	RICHLANDS, VA 24641
June 16, 2016 , 8:28 am	Arrived at Unit	RICHLANDS, VA 24641
June 15, 2016 , 3:47 pm	Departed USPS Facility	CHARLESTON, WV 25350
June 14, 2016 , 10:51 pm	Arrived at USPS Origin Facility	CHARLESTON, WV 25350
June 14, 2016 , 5:09 pm	Departed Post Office	POUNDING MILL, VA 24637
June 14, 2016 , 3:43 pm	Acceptance	POUNDING MILL, VA 24637

Track Another Package

Tracking (or receipt) number

[Track It](#)

Manage Incoming Packages

Track all your packages from a dashboard. No tracking numbers necessary.

[Sign up for My USPS >](#)





USPS Tracking®

Still Have Questions?

[Browse our FAQs >](#)



[Get Easy Tracking Updates >](#)
Sign up for My USPS.

Tracking Number: 70160340000089890290

Judy Horne

Product & Tracking Information

Postal Product:

Features:
Certified Mail™

DATE & TIME	STATUS OF ITEM	LOCATION
June 22, 2016 , 4:12 pm	Delivered	CEDAR BLUFF, VA 24609

Your mail was delivered at 4:12 pm on June 22, 2016 in CEDAR BLUFF, VA 24609.

June 21, 2016 , 12:31 pm	Available for Pickup	CEDAR BLUFF, VA 24609
June 16, 2016 , 11:56 am	Business Closed	CEDAR BLUFF, VA 24609
June 16, 2016 , 8:11 am	Arrived at Unit	CEDAR BLUFF, VA 24609
June 15, 2016 , 3:46 pm	Departed USPS Origin Facility	CHARLESTON, WV 25350
June 14, 2016 , 10:51 pm	Arrived at USPS Origin Facility	CHARLESTON, WV 25350
June 14, 2016 , 5:09 pm	Departed Post Office	POUNDRING MILL, VA 24637
June 14, 2016 , 3:43 pm	Acceptance	POUNDRING MILL, VA 24637

Available Actions

Track Another Package

Tracking (or receipt) number

[Track It](#)

Manage Incoming Packages

Track all your packages from a dashboard.
No tracking numbers necessary.

[Sign up for My USPS >](#)





USPS Tracking®

Still Have Questions?

[Browse our FAQs >](#)



[Get Easy Tracking Updates >](#)
Sign up for My USPS.

Tracking Number: 70160340000089890306

Jeff Jackson

Product & Tracking Information

Available Actions

Postal Product:

Features:
Certified Mail™

DATE & TIME	STATUS OF ITEM	LOCATION
June 16, 2016 , 4:45 pm	Delivered, Left with Individual	CHARLOTTE, NC 28205

Your item was delivered to an individual at the address at 4:45 pm on June 16, 2016 in CHARLOTTE, NC 28205.

June 16, 2016 , 4:39 pm	Notice Left (No Authorized Recipient Available)	CHARLOTTE, NC 28205
June 15, 2016 , 9:36 pm	Departed USPS Facility	CHARLOTTE, NC 28228
June 15, 2016 , 9:49 am	Arrived at USPS Facility	CHARLOTTE, NC 28228
June 15, 2016 , 4:56 am	Departed USPS Facility	CHARLESTON, WV 25350
June 14, 2016 , 10:49 pm	Arrived at USPS Origin Facility	CHARLESTON, WV 25350
June 14, 2016 , 5:09 pm	Departed Post Office	POUNDING MILL, VA 24637
June 14, 2016 , 3:43 pm	Acceptance	POUNDING MILL, VA 24637

Track Another Package

Tracking (or receipt) number

[Track It](#)

Manage Incoming Packages

Track all your packages from a dashboard. No tracking numbers necessary.

[Sign up for My USPS >](#)





USPS Tracking®

Still Have Questions?

[Browse our FAQs >](#)



[Get Easy Tracking Updates >](#)
Sign up for My USPS.

Tracking Number: 70160340000089890313

Jerry Jackson

Updated Delivery Day: Friday, June 17, 2016

Product & Tracking Information

Available Actions

Postal Product:

Features:
Certified Mail™

DATE & TIME	STATUS OF ITEM	LOCATION
June 17, 2016 , 12:25 pm	Delivered, Left with Individual	WILMINGTON, NC 28411

Your item was delivered to an individual at the address at 12:25 pm on June 17, 2016 in WILMINGTON, NC 28411.

June 17, 2016 , 8:42 am	Arrived at Unit	WILMINGTON, NC 28411
June 16, 2016 , 7:03 pm	Departed USPS Facility	FAYETTEVILLE, NC 28302
June 16, 2016 , 2:04 pm	Arrived at USPS Facility	FAYETTEVILLE, NC 28302
June 15, 2016 , 4:56 am	Departed USPS Facility	CHARLESTON, WV 25350
June 14, 2016 , 10:49 pm	Arrived at USPS Origin Facility	CHARLESTON, WV 25350
June 14, 2016 , 5:09 pm	Departed Post Office	POUNDING MILL, VA 24637
June 14, 2016 , 3:43 pm	Acceptance	POUNDING MILL, VA 24637

Track Another Package

Tracking (or receipt) number

[Track It](#)

Manage Incoming Packages

Track all your packages from a dashboard. No tracking numbers necessary.

[Sign up for My USPS >](#)





USPS Tracking®

Still Have Questions?

[Browse our FAQs ›](#)



[Get Easy Tracking Updates ›](#)
Sign up for My USPS.

Tracking Number: 7016034000089890368

Arnold Keene

Updated Delivery Day: Thursday, June 16, 2016

Product & Tracking Information

Available Actions

Postal Product:

Features:
Certified Mail™

DATE & TIME

STATUS OF ITEM

LOCATION

June 16, 2016 , 10:32 am

Delivered, Left with Individual

CEDAR BLUFF, VA 24609

Your item was delivered to an individual at the address at 10:32 am on June 16, 2016 in CEDAR BLUFF, VA 24609.

June 16, 2016 , 8:11 am

Arrived at Unit

CEDAR BLUFF, VA 24609

June 15, 2016 , 3:46 pm

Departed USPS Origin Facility

CHARLESTON, WV 25350

June 14, 2016 , 10:51 pm

Arrived at USPS Origin Facility

CHARLESTON, WV 25350

June 14, 2016 , 5:09 pm

Departed Post Office

POUNDING MILL, VA 24637

June 14, 2016 , 3:43 pm

Acceptance

POUNDING MILL, VA 24637

Track Another Package

Tracking (or receipt) number

[Track It](#)

Manage Incoming Packages

Track all your packages from a dashboard. No tracking numbers necessary.

[Sign up for My USPS ›](#)





USPS Tracking®

Still Have Questions?

[Browse our FAQs >](#)



[Get Easy Tracking Updates >](#)
Sign up for My USPS.

Tracking Number: 70160340000089890375

Linde Matney

Updated Delivery Day: Wednesday, June 15, 2016

Product & Tracking Information

Available Actions

Postal Product:

Features:
Certified Mail™

DATE & TIME	STATUS OF ITEM	LOCATION
June 15, 2016 , 10:00 am	Delivered	POUNDING MILL, VA 24637

Your item was delivered at 10:00 am on June 15, 2016 in POUNDING MILL, VA 24637.

June 15, 2016 , 8:20 am	Available for Pickup	POUNDING MILL, VA 24637
June 15, 2016 , 8:03 am	Arrived at Unit	POUNDING MILL, VA 24637
June 14, 2016 , 5:09 pm	Departed Post Office	POUNDING MILL, VA 24637
June 14, 2016 , 3:43 pm	Acceptance	POUNDING MILL, VA 24637

Track Another Package

Tracking (or receipt) number

[Track It](#)

Manage Incoming Packages

Track all your packages from a dashboard. No tracking numbers necessary.

[Sign up for My USPS >](#)





USPS Tracking®

Still Have Questions?

[Browse our FAQs ›](#)



Get Easy Tracking Updates ›

Sign up for My USPS.

Tracking Number: 7016034000089890405

Charlotte Robinette

Updated Delivery Day: Thursday, June 16, 2016

Product & Tracking Information

Available Actions

Postal Product:

Features:
Certified Mail™

DATE & TIME	STATUS OF ITEM	LOCATION
June 16, 2016 , 2:23 pm	Delivered, Left with Individual	DENVER, NC 28037

Your item was delivered to an individual at the address at 2:23 pm on June 16, 2016 in DENVER, NC 28037

June 16, 2016 , 8:40 am	Out for Delivery	DENVER, NC 28037
June 16, 2016 , 8:30 am	Sorting Complete	DENVER, NC 28037
June 16, 2016 , 8:03 am	Arrived at Unit	DENVER, NC 28037
June 15, 2016 , 9:36 pm	Departed USPS Facility	CHARLOTTE, NC 28228
June 15, 2016 , 9:49 am	Arrived at USPS Facility	CHARLOTTE, NC 28228
June 15, 2016 , 4:56 am	Departed USPS Facility	CHARLESTON, WV 25350
June 14, 2016 , 10:49 pm	Arrived at USPS Origin Facility	CHARLESTON, WV 25350
June 14, 2016 , 5:09 pm	Departed Post Office	POUNDING MILL, VA 24637
June 14, 2016 , 3:43 pm	Acceptance	POUNDING MILL, VA 24637

Track Another Package

Tracking (or receipt) number

[Track It](#)

Manage Incoming Packages

Track all your packages from a dashboard. No tracking numbers necessary.

[Sign up for My USPS ›](#)





USPS Tracking®

Still Have Questions?

[Browse our FAQs >](#)



Get Easy Tracking Updates >

Sign up for My USPS.

Tracking Number: 7016034000089890436

Beth Underhill

Product & Tracking Information

Available Actions

Postal Product:

Features:
Certified Mail™

DATE & TIME	STATUS OF ITEM	LOCATION
June 20, 2016 , 4:06 pm	Delivered, Individual Picked Up at Post Office	BENTONVILLE, VA 22610

Your item was picked up at the post office at 4:06 pm on June 20, 2016 in BENTONVILLE, VA 22610.

June 17, 2016 , 11:38 am	Available for Pickup	BENTONVILLE, VA 22610
June 17, 2016 , 10:24 am	Notice Left (No Authorized Recipient Available)	FRONT ROYAL, VA 22630
June 17, 2016 , 12:03 am	Departed USPS Facility	DULLES, VA 20101
June 16, 2016 , 7:51 am	Arrived at USPS Facility	DULLES, VA 20101
June 15, 2016 , 4:56 am	Departed USPS Facility	CHARLESTON, WV 25350
June 14, 2016 , 10:49 pm	Arrived at USPS Origin Facility	CHARLESTON, WV 25350
June 14, 2016 , 5:09 pm	Departed Post Office	POUNDRING MILL, VA 24637
June 14, 2016 , 3:43 pm	Acceptance	POUNDRING MILL, VA 24637

Track Another Package

Tracking (or receipt) number

[Track It](#)

Manage Incoming Packages

Track all your packages from a dashboard. No tracking numbers necessary.

[Sign up for My USPS >](#)





USPS Tracking®

Still Have Questions?

[Browse our FAQs >](#)



[Get Easy Tracking Updates >](#)

[Sign up for My USPS.](#)

Tracking Number: 7016034000089890443

Brenda Weddle

Updated Delivery Day: **Wednesday, June 15, 2016**

Product & Tracking Information

Available Actions

Postal Product:

Features:
Certified Mail™

DATE & TIME	STATUS OF ITEM	LOCATION
June 15, 2016 , 10:00 am	Delivered	POUNDING MILL, VA 24637

Your item was delivered at 10:00 am on June 15, 2016 in POUNDING MILL, VA 24637

June 15, 2016 , 8:20 am	Available for Pickup	POUNDING MILL, VA 24637
June 15, 2016 , 8:03 am	Arrived at Unit	POUNDING MILL, VA 24637
June 14, 2016 , 5:09 pm	Departed Post Office	POUNDING MILL, VA 24637
June 14, 2016 , 3:43 pm	Acceptance	POUNDING MILL, VA 24637

Track Another Package

Tracking (or receipt) number

[Track It](#)

Manage Incoming Packages

Track all your packages from a dashboard. No tracking numbers necessary.

[Sign up for My USPS >](#)





USPS Tracking®

Still Have Questions?

[Browse our FAQs >](#)



Get Easy Tracking Updates >

Sign up for My USPS.

Tracking Number: 7016034000089890450

yvonne white

Product & Tracking Information

Available Actions

Postal Product:

Features:

Certified Mail™

DATE & TIME	STATUS OF ITEM	LOCATION
June 17, 2016 , 9:32 am	Delivered	CATAWBA, NC 28609

Your item was delivered at 9:32 am on June 17, 2016 in CATAWBA, NC 28609

June 16, 2016 , 10:07 am	Notice Left (No Authorized Recipient Available)	CATAWBA, NC 28609
June 16, 2016 , 7:48 am	Arrived at Unit	CATAWBA, NC 28609
June 15, 2016 , 5:54 pm	Departed USPS Origin Facility	GREENSBORO, NC 27498
June 15, 2016 , 1:37 pm	Arrived at USPS Origin Facility	GREENSBORO, NC 27498
June 15, 2016 , 4:56 am	Departed USPS Facility	CHARLESTON, WV 25350
June 14, 2016 , 10:49 pm	Arrived at USPS Origin Facility	CHARLESTON, WV 25350
June 14, 2016 , 5:09 pm	Departed Post Office	POUNDRING MILL, VA 24637
June 14, 2016 , 3:43 pm	Acceptance	POUNDRING MILL, VA 24637

Track Another Package

Tracking (or receipt) number

[Track it](#)

Manage Incoming Packages

Track all your packages from a dashboard. No tracking numbers necessary.

[Sign up for My USPS >](#)



Exhibit J
Unit X29 Escrow Account Reconciliation
VGOB 95-0418-0500

CNX Deposit Information		
Check Date	Check Number	Total

Escrow Bank Data													Running Balance	Difference
Date	Escrow Royalty Deposits	Income	\$ Mktet Int	CDARS Int	Fees	Distributions	Audit Costs	Corrections	Gain/Loss	Royalty Bonus	Total Int. and Fees	Bank Balance		
8/31/2015	\$0.00		\$21.73	\$3.13	(\$13.77)	\$0.00	\$0.00	\$0.00			\$11.09	\$165,193.01	\$166,116.07	\$923.06
9/30/2015	\$0.00		\$22.22	\$12.20	(\$13.77)	\$0.00	\$0.00	\$0.00			\$20.65	\$165,213.66	\$166,136.72	\$923.06
10/31/2015	\$0.00		\$25.17	\$0.35	(\$13.77)	\$0.00	\$0.00	\$0.00			\$11.75	\$165,225.41	\$166,148.47	\$923.06
11/30/2015	\$0.00		\$25.91	\$0.37	(\$13.77)	\$0.00	\$0.00	\$0.00			\$12.51	\$165,237.92	\$166,160.98	\$923.06
12/31/2015	\$0.00		\$26.74	\$12.64	(\$13.77)	\$0.00	\$0.00	\$0.00			\$25.61	\$165,263.53	\$166,186.59	\$923.06
1/31/2016	\$0.00		\$2.19	\$0.00	(\$13.77)	\$0.00	\$0.00	\$0.00			-\$11.58	\$165,251.95	\$166,175.01	\$923.06
2/28/2016	\$0.00		\$27.57	\$0.00	(\$13.77)	\$0.00	\$0.00	\$0.00			\$13.80	\$165,265.75	\$166,188.81	\$923.06
3/31/2016	\$0.00		\$29.06	\$0.00	(\$13.77)	\$0.00	\$0.00	\$0.00			\$15.29	\$165,281.04	\$166,204.10	\$923.06
4/30/2016	\$0.00		\$28.03	\$0.00	(\$13.77)	\$0.00	\$0.00	\$0.00			\$14.26	\$165,295.30	\$166,218.36	\$923.06
Total											\$50,482.77			

Total Deposited	\$154,115.90
01 Disbursement	-\$38,380.31
Interest & Fees	\$50,482.77
Grand Total	\$166,218.36
April 2016 First Bank and Trust	\$165,295.30
Difference	\$923.06

AFFIDAVIT OF MAILING – COAL OWNER

COMMONWEALTH OF VIRGINIA
COUNTY OF **BUCHANAN**

Applicant: CNX Gas Company LLC
Relief Sought: Disbursement Petition for **X29**
VGOB: 95-0418-0500-02

I, Anita D. Duty, after being duly sworn upon oath, state as follows:

1. I am the Pooling Supervisor for CNX Land Resources, Inc. and am responsible for the notification process required by Va. Code Ann. §45.1-361.19 of the Code of Virginia and 4VAC25-160-40.

2. That on **November 4, 2015** a true and correct copy of the coal owner dismissal and prior order were mailed, via certified mail return receipt requested, based upon information and belief, the names and last-known addresses, where such addresses are known, of the parties owning an interest in this cause are set forth and attached hereto.

3. Notice of this cause has therefore been served by mail pursuant to the applicable statutes and rules of the Board.

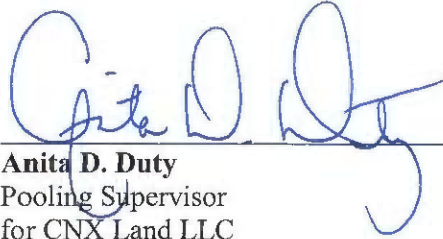

Anita D. Duty
Pooling Supervisor
for CNX Land LLC

STATE OF VIRGINIA

COUNTY OF TAZEWELL, TO-WIT:

TAKEN, SUBSCRIBED AND SWORN to before me this 16th day of June,
2016.

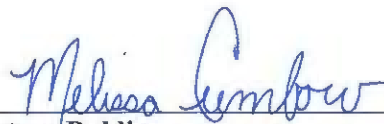

Notary Public

My commission expires: 12/31/2019

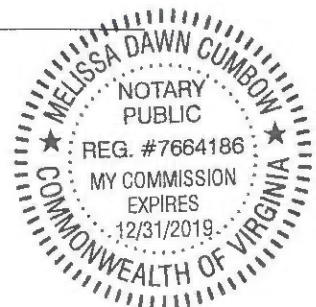

CERTIFICATION OF NOTICE
CNX Gas Company LLC

Buchanan No1 SGU1
VGOB 98-1117-0697-04
Coal Owner Dismissal

Last Name	First Name	MAILED	SGU	X29	X31	RECEIPT #	Received
Torch Oil and Gas Company (Coal Owner)		11/4/2015	x	x		70151520000353330240	11/7/2015
Coal Mountain Mining Company (Coal Owner)		11/4/2015	x		x	70151520000353330233	11/6/2015
Hugh MacRae (Coal Owner)		11/4/2015	x	x		70091680000108911298	11/9/2015
Gentry Locke (Coal Owner)		11/4/2015	x	x		70091680000108911274	11/10/2015
Chisos, LTD (Coal Owner)		11/4/2015	x	x		70091680000108911281	11/9/2015
Island Creek Coal Company (Coal Owner)		**Hand delivered**				**Hand Delivered**	
Rockport Oil & Gas		5/10/2016	X			70091680000108910567	5/18/2016



USPS Tracking®



Customer Service ›
Have questions? We're here to help.



Get Easy Tracking Updates ›
Sign up for My USPS.

Tracking Number: 70151520000353330240

Updated Delivery Day: Saturday, November 7, 2015

Product & Tracking Information

Available Actions

Postal Product:

Features:
Certified Mail™

Date & Time

Tracking Event

Location

November 7, 2015, 9:44 am

Delivered

DEMING, NM 88030

November 7, 2015, 8:33 am

Arrived at Unit

DEMING, NM 88030

November 7, 2015, 4:28 am

Departed USPS Facility

EL PASO, TX 79910

November 6, 2015, 7:24 pm

Arrived at USPS Facility

EL PASO, TX 79910

November 5, 2015, 4:26 am

Departed USPS Facility

CHARLESTON, WV 25350

November 4, 2015, 10:04 pm

Arrived at USPS Facility

CHARLESTON, WV 25350

Track Another Package

Tracking (or receipt) number

Track It

Manage Incoming Packages

Track all your packages from a dashboard.
No tracking numbers necessary.

Sign up for My USPS ›





USPS Tracking®



Customer Service ›
Have questions? We're here to help.



Get Easy Tracking Updates ›
Sign up for My USPS.

Tracking Number: 70151520000353330233

Product & Tracking Information

Available Actions

Postal Product:

Features:
Certified Mail™

Date & Time

Status of Mail

Location

November 6, 2015 , 9:52 am

Delivered

TAZEWELL, VA 24651

November 6, 2015 , 9:01 am

Available for Pickup

TAZEWELL, VA 24651

November 5, 2015 , 7:12 pm

Departed USPS Facility

CHARLESTON, WV 25350

November 4, 2015 , 10:05 pm

Arrived at USPS Facility

CHARLESTON, WV 25350

Track Another Package

Tracking (or receipt) number

Track It

Manage Incoming Packages

Track all your packages from a dashboard.
No tracking numbers necessary.

Sign up for My USPS ›



HELPFUL LINKS

- Contact Us
- Site Index
- FAQs

ON ABOUT.USPS.COM

- About USPS Home
- Newsroom
- USPS Service Updates
- Forms & Publications
- Government Services
- Careers

OTHER USPS SITES

- Business Customer Gateway
- Postal Inspectors
- Inspector General
- Postal Explorer
- National Postal Museum
- Resources for Developers

LEGAL INFORMATION

- Privacy Policy
- Terms of Use
- FOIA
- No FEAR Act EEO Data



USPS Tracking®



[Customer Service >](#)
Have questions? We're here to help.



[Get Easy Tracking Updates >](#)
Sign up for My USPS.

Tracking Number: 70091680000108910567

Product & Tracking Information

Postal Product:

Features:
Certified Mail™

DATE & TIME	STATUS OF ITEM	LOCATION
May 16, 2016 , 10:51 am	Delivered, PO Box	HOUSTON, TX 77210

Your item has been delivered and is available at a PO Box at 10:51 am on May 16, 2016 in HOUSTON, TX 77210.

May 12, 2016 , 5:34 am	Arrived at USPS Facility	HOUSTON, TX 77210
May 12, 2016 , 4:34 am	Departed USPS Facility	NORTH HOUSTON, TX 77315
May 11, 2016 , 11:03 pm	Arrived at USPS Facility	NORTH HOUSTON, TX 77315
May 11, 2016 , 5:31 am	Departed USPS Facility	CHARLESTON, WV 25350
May 10, 2016 , 8:24 pm	Arrived at USPS Facility	CHARLESTON, WV 25350

Available Actions

[Text Updates](#)

[Email Updates](#)

Track Another Package

Tracking (or receipt) number

[Track It](#)

Manage Incoming Packages

Track all your packages from a dashboard. No tracking numbers necessary.



[Sign up for My USPS >](#)

SENDER: COMPLETE THIS SECTION	COMPLETE THIS SECTION ON DELIVERY	
<ul style="list-style-type: none"> Complete items 1, 2, and 3. Also complete item 4 if Restricted Delivery is desired. Print your name and address on the reverse so that we can return the card to you. Attach this card to the back of the mailpiece, or on the front if space permits. 	A. Signature <input checked="" type="checkbox"/> <i>Chloe H</i>	<input type="checkbox"/> Agent <input type="checkbox"/> Address
1. Article Addressed to: Hugh Macrae PO BOX 830 Tazewell VA 24651	B. Received by (Printed Name) C. Date of Delivery 11/9/15	D. Is delivery address different from item 1? <input type="checkbox"/> Yes If YES, enter delivery address below: <input type="checkbox"/> No
2. Service Type <input checked="" type="checkbox"/> Certified Mail <input type="checkbox"/> Express Mail <input type="checkbox"/> Registered <input type="checkbox"/> Return Receipt for Merchandise <input type="checkbox"/> Insured Mail <input type="checkbox"/> C.O.D.		
4. Restricted Delivery? (Extra Fee) <input type="checkbox"/> Yes		
7009 1680 0001 0891 1298		
PS Form 3811, February 2004 Domestic Return Receipt 10000-02-14-11		

SENDER: COMPLETE THIS SECTION	COMPLETE THIS SECTION ON DELIVERY	
<ul style="list-style-type: none"> Complete items 1, 2, and 3. Also complete item 4 if Restricted Delivery is desired. Print your name and address on the reverse so that we can return the card to you. Attach this card to the back of the mailpiece, or on the front if space permits. 	A. Signature <input checked="" type="checkbox"/> <i>B. Jacobsen</i>	<input type="checkbox"/> Agent <input type="checkbox"/> Address
1. Article Addressed to: Chisos 670 Dona Ana Rd Deming NM 88030	B. Received by (Printed Name) C. Date of Delivery 11/9/15	D. Is delivery address different from item 1? <input type="checkbox"/> Yes If YES, enter delivery address below: <input type="checkbox"/> No
3. Service Type <input checked="" type="checkbox"/> Certified Mail <input type="checkbox"/> Express Mail <input type="checkbox"/> Registered <input type="checkbox"/> Return Receipt for Merchandise <input type="checkbox"/> Insured Mail <input type="checkbox"/> C.O.D.		
4. Restricted Delivery? (Extra Fee) <input type="checkbox"/> Yes		
7009 1680 0001 0891 1274		
PS Form 3811, February 2004 Domestic Return Receipt 99502-M-14		

SENDER: COMPLETE THIS SECTION	COMPLETE THIS SECTION ON DELIVERY	
<ul style="list-style-type: none"> Complete items 1, 2, and 3. Also complete item 4 if Restricted Delivery is desired. Print your name and address on the reverse so that we can return the card to you. Attach this card to the back of the mailpiece, or on the front if space permits. 	A. Signature <input checked="" type="checkbox"/> <i>D. M. K. B...</i>	<input type="checkbox"/> Agent <input type="checkbox"/> Address
1. Article Addressed to: Gentry Locke Attn: Kathy Wright PO BOX 40013 Roanoke VA 24022-0013	B. Received by (Printed Name) C. Date of Delivery DEANEY B... 11/9/15	D. Is delivery address different from item 1? <input type="checkbox"/> Yes If YES, enter delivery address below: <input type="checkbox"/> No
3. Service Type <input checked="" type="checkbox"/> Certified Mail <input type="checkbox"/> Express Mail <input type="checkbox"/> Registered <input type="checkbox"/> Return Receipt for Merchandise <input type="checkbox"/> Insured Mail <input type="checkbox"/> C.O.D.		
4. Restricted Delivery? (Extra Fee) <input type="checkbox"/> Yes		
7009 1680 0001 0891 1281		
PS Form 3811, February 2004 Domestic Return Receipt 10000-02-14-11		