

BEFORE THE VIRGINIA GAS AND OIL BOARD

PETITIONER: CNX Gas Company LLC

DIVISION OF GAS AND OIL

DOCKET NO: VGOB 97-0218-0563-05

RELIEF SOUGHT: (1) DISBURSEMENT FROM ESCROW REGARDING TRACT(S) A portion of 2 (2) AND AUTHORIZATION FOR DIRECT PAYMENT OF ROYALTIES (3) AND DISMISSAL OF COAL OWNERS PURSUANT TO CODE OF VIRGINIA SECTION 45.1-361.22:2.

HEARING DATE: April 19, 2016

DRILLING UNIT: U27

BUCHANAN COUNTY, VIRGINIA

PETITION FOR ORDER OF DISBURSEMENT OF ESCROW FUNDS

1. Petitioner and its counsel

Petitioner is CNX Gas Company LLC, P. O. Box 570, Pounding Mill, VA 24637, (276)596-5075. Petitioner's counsel is Mark A. Swartz, Hillard & Swartz, LLP, 122 Capital Street, Suite 201, Charleston, WV 25301.

2. Relief Sought

1) the disbursement of escrowed funds heretofore deposited with the Board's Escrow Agent, attributable to Tract 2, as depicted upon the annexed table; and (2) authorization to begin paying royalties directly to Yukon Pocahontas Coal Company, LLP, Buchanan Coal Company, LLP, Sayers-Pocahontas Coal Company, LLP, Plum Creek Timberlands, L.P., Emanuel Wade, Nick Deskins, Valmy Shannon, Eleanor Hagy, Scotty Bond, David Smith, Donald Smith, Judy Tiedemann, Paul Smith, Peggy Smith, Pauline Cole Casey, Robert Brian Casey; (3) Dismissal of Coal Owners: Yukon Pocahontas Coal Company, LLP, Buchanan Coal Company, LLP, Sayers-Pocahontas Coal Company, LLP, Plum Creek Timberlands, L.P.

3. Legal Authority

Va. Code Ann. § 45.1-361.1 et seq., 4 VAC 25-160-140., and relevant Virginia Gas and Oil Board Orders ("Board") heretofore promulgated pursuant to law.

4. Type of Well(s)

Coalbed Methane

5. Factual basis for relief requested

- a. Yukon Pocahontas Coal Company, LLP, Buchanan Coal Company, LLP, Sayers-Pocahontas Coal Company, LLP, Plum Creek Timberlands, L.P., and Nick Deskins, Valmy Shannon and Eleanor Hagy have entered into royalty split agreement(s). Said royalty split agreement(s) allow the Applicant and Designated Operator to pay royalties directly to the persons identified in Exhibit EE.
- b. Scotty Bond, David Smith, Donald Smith, Judy Tiedemann, Paul Smith, Peggy Smith, Pauline Cole Casey, Robert Brian Casey; are the gas claimants in Tract 2 As such, is entitled to 100% of the CBM royalties now in escrow and as may be hereafter payable. See Va. Code Ann. § 45.1-361.22:2.A.
- c. That CNX Gas Company LLC has given the notice(s) required by § 45.1-361.22:2.A to all conflicting claimants identified in the above referenced pooling Order and any supplemental Orders pertaining thereto.
- d. That none of the conflicting claimants noticed have provided, within 45 days of the notice(s) given as provided in b. above, the Board, its designated agent the Director of the Division of Gas and Oil, the Operator and/or the Applicant evidence of either an agreement regarding the escrowed funds/royalties or a proceeding regarding same.
- e. That a detailed accounting in accordance with the applicable provisions of § 45.1-361.22 is submitted herewith and identified as Exhibit J.
- f. That an Exhibit identified as Table 1 is annexed hereto, and it specifies how the disbursement (s) is to be calculated and paid by the escrow agent.
- g. That Va. Code Ann. § 45.1-361.22:2.A. further provides that the Operator shall pay such royalties as may hereafter be payable directly to the gas claimant and not escrow same. See Exhibit EE annexed hereto.

6. Attestation

The foregoing Petition to the best of my knowledge, information, and belief is true and correct.

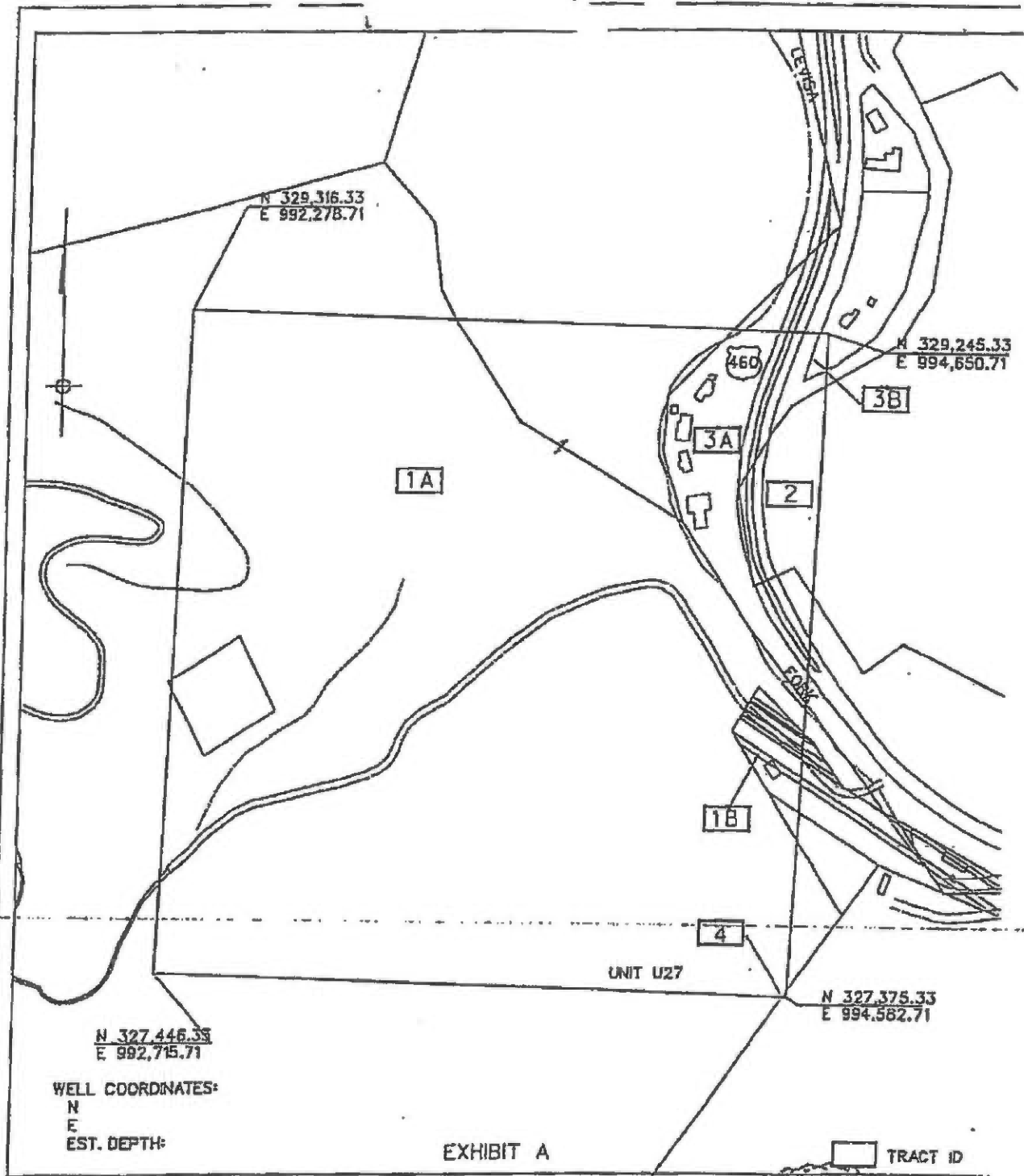

WELL COORDINATES:
 N
 E
 EST. DEPTH:

VG0B-97-0218-0563

Company CONSOL INC. Well Name and Number CLAYTON MINE D. HERRON
 Tract No. _____ Elevation _____ Quadrangle KEEN MOUNTAIN
 County BUCHANAN District _____ Scale: 1"=400' Date 01/17/2007
 This plat is a new plat xxx; an updated plat _____; or a final plat _____

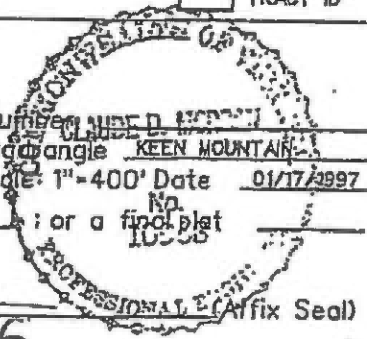

Form DGO-GO-7
 Rev. 9/01

Clayton M. Herron
 Licensed Professional Engineer 5

3

CONSOL Inc.
CBM U-27
Tract Identifications
DGO-GO-7 Attachment

1. Hugh MacRae Land Trust - Tr. 6 - Coal
Coal Lessees
Island Creek Coal Company - Pocahontas No. 3 seam
United Coal Company - Coal above drainage
Consolidation Coal Company - Coal below drainage
Buchanan Production Company - CBM Lessee
Consolidation Coal Company - Oil & Gas
Buchanan Production Company - CBM, Oil & Gas Lessee
72.52 acres - 90.6500%
- 1A. Consolidation Coal Company - Surface
- 1B. Darrell Meadows - Surface
2. 4/5 Yukon Pocahontas Coal Company, et al - Tr. 110
1/5 C. L. Ritter Lumber Company - Tr. 51
Coal
Island Creek Coal Company - Coal Below Tiller
Permac Coal Company - Coal above drainage
Buchanan Production Company - CBM Lessee
C. L. Ritter Lumber Company, et al - Oil & Gas
Yukon Pocahontas Coal Company, et al - Surface
Buchanan Production Company - CBM, Oil & Gas Lessee
2.14 acres - 2.6750%
3. Yukon Pocahontas Coal Company, et al - Tr. 99
Coal Oil & Gas
Island Creek Coal Company - Coal Below Tiller
~~Permac Coal Company - Coal above drainage~~
Buchanan Production Company - CBM Lessee
Buchanan Production Company - CBM, Oil & Gas Lessee
5.33 acres - 6.6625%
- 3A. T. R. Stump, et al - Surface
- 3B. Roscoe Deskins - Surface
4. Hugh MacRae Land Trust - Tr. 17 - Coal
Coal Lessees
Island Creek Coal Company - Pocahontas No. 3 seam
United Coal Company - Coal above drainage
Consolidation Coal Company - Coal below drainage
Buchanan Production Company - CBM Lessee
Roscoe Deskins - Surface Oil & Gas
Buchanan Production Company - CBM, Oil & Gas Lessee
0.010 acres - 0.0125%

4

Exhibit E
Unit U-27
Docket #VGOB 97-0218-0563-05
List of Respondents that require escrow

	Net Acres in Unit	Interest in Unit	Divison of Interest in		
			2 Left 3.4066%	3 Left 9.5185%	4 Left 1.2413%
<u>Tract #2, 2.14 Acre Tract</u>					
<u>COAL OWNERSHIP</u>					
Yukon Pocahontas Coal Company, et al. Tr. 110	2.14 acres	2.6750%	0.0911%	0.2546%	0.0332%
(1) Yukon Pocahontas Coal Company, et al. <i>(Only 3/5 interest conflicting)</i>	1.28 acres 3/5 of 2.14 acres	1.6050%	0.0547%	0.1528%	0.0199%
(a) Yukon Pocahontas Coal Company P.O. Box 187 Tazewell, VA 24651	0.64200 acres 1/2 of 2.14 acres	0.8025%	0.0273%	0.0764%	0.0100%
(b) Buchanan Coal Company P.O. Box 187 Tazewell, VA 24651	0.14267 acres 1/9 of 2.14 acres	0.1783%	0.0061%	0.0170%	0.0022%
(c) Sayers-Pocahontas Coal Company P.O. Box 187 Tazewell, VA 24651	0.07133 acres 1/18 of 2.14 acres	0.0892%	0.0030%	0.0085%	0.0011%
(d) Consolidation Coal Company * 10545 Riverside Dr. Oakwood, VA 24631	0.42800 acres 1/3 of 2.14 acres	0.5350%	0.0182%	0.0509%	0.0066%
<i>Note: Plum Creek Timberlands retained their CBM interest, there is no conflict. The royalty for (d) is to be paid to Plum Creek.</i>					
<u>OIL & GAS OWNERSHIP</u>					
Yukon Pocahontas Coal Co. Tr. 110, et al.	2.14 acres	2.6750%	0.0911%	0.2546%	0.0332%
(1) Yukon Pocahontas Coal Company, et al., Tr. 110					
(3) Walter Wade Heirs					
(b) Eunice Wade Baldwin Heirs, Devisees, Successors or Assigns <i>Documentation Pending</i>					
(b.1) Inez B. Kimbrell 225 Raven Circle Raven, VA 24639	0.00594 acres 1/360 of 2.14 acres	0.0074%	0.0003%	0.0007%	0.0001%
(b.2) Alice Ruth Meadows 5931 State Rt 314 Fredericktown, OH 43019-9225	0.00594 acres 1/360 of 2.14 acres	0.0074%	0.0003%	0.0007%	0.0001%
(b.3) Wanda Griffith PO Box 216 Doran, VA 24612	0.00594 acres 1/360 of 2.14 acres	0.0074%	0.0003%	0.0007%	0.0001%
(b.4) Sherman Baldwin 210 Lake Whitten Rd N. Tazewell, VA 24630-9155	0.00594 acres 1/360 of 2.14 acres	0.0074%	0.0003%	0.0007%	0.0001%
(b.5) Ted Allen Baldwin Heirs, Devisees Successors or Assigns					
(b.5.1) Pansy Deloris Baldwin 135 Indian Springs Drive Cedar Bluff, VA 24609-8837	0.00594 acres 1/360 of 2.14 acres	0.0074%	0.0003%	0.0007%	0.0001%
(b.6) Marty Baldwin <i>Address Unknown</i>	0.00594 acres 1/360 of 2.14 acres	0.0074%	0.0003%	0.0007%	0.0001%
(b.7) Ola Gay Baldwin Arnold Heirs, Devisees, Successors or Assigns	Pre-Deceased				

Exhibit E
Unit U-27
Docket #VGOB 97-0218-0563-05
List of Respondents that require escrow

	Net Acres in Unit	Interest in Unit	Divison of Interest in		
			2 Left 3.4066%	3 Left 9.5185%	4 Left 1.2413%
(b.7.1) Wanda Gay Bohon <i>Address Unknown</i>	0.00594 acres 1/360 of 2.14 acres	0.0074%	0.0003%	0.0007%	0.0001%
(b.8) D.C. Baldwin Heirs, Devisees, Successors or Assigns	Pre-Deceased				
(b.8.1) Nancy Baldwin Komp 2510 Arthur Road Springfield, OH 45502	0.00297 acres 1/720 of 2.14 acres	0.0037%	0.0001%	0.0004%	0.0000%
(b.8.2) Sandy Baldwin Cranmer 11651 SE 69th Terrace Lot #18 Bellevue, FL 34420	0.00297 acres 1/720 of 2.14 acres	0.0037%	0.0001%	0.0004%	0.0000%
(b.9) Shirley F. Baldwin Heirs, Devisees, Successors or Assigns	Pre-Deceased				
(b.9.1) Donna Foote 9942 Oak Terrace Road Mardela Springs, MD 21837-2060	0.00297 acres 1/720 of 2.14 acres	0.0037%	0.0001%	0.0004%	0.0000%
(b.9.2) Pamela Ginger Case 32 Beakon Street North Little Rock, AR 72117	0.00297 acres 1/720 of 2.14 acres	0.0037%	0.0001%	0.0004%	0.0000%
(b.10) Norman Baldwin Heirs, Devisees, Successors or Assigns	Pre-Deceased				
(b.10.1) Rufus Baldwin 208 High Street Richlands, VA 24641	0.00119 acres 1/1800 of 2.14 acres	0.0015%	0.0001%	0.0001%	0.0000%
(b.10.2) David Baldwin PO Box 803 Raven, VA 24639	0.00119 acres 1/1800 of 2.14 acres	0.0015%	0.0001%	0.0001%	0.0000%
(b.10.3) Michael Baldwin PO Box 1044 Raven, VA 24639	0.00119 acres 1/1800 of 2.14 acres	0.0015%	0.0001%	0.0001%	0.0000%
(b.10.4) Sharon K. Baldwin c/o SW VA Training Center, 160 Training Hillsville, VA 24343	0.00119 acres 1/1800 of 2.14 acres	0.0015%	0.0001%	0.0001%	0.0000%
(b.11) Bane Baldwin Heirs, Devisees, Successors or Assigns	Pre-Deceased				
(b.11.1) Eddie Baldwin 1224 Sunset Drive, PO Box 372 Richlands, VA 24641	0.00198 acres 1/1080 of 2.14 acres	0.0025%	0.0001%	0.0002%	0.0000%
(b.11.2) Kathy Whitt 8740 Swords Creek Road Swords Creek, VA 24649	0.00119 acres 1/1800 of 2.14 acres	0.0015%	0.0001%	0.0001%	0.0000%
(b.11.3) Lisa Shaver 89 Sevier Street Lebanon, VA 24266	0.00119 acres 1/1800 of 2.14 acres	0.0015%	0.0001%	0.0001%	0.0000%
(b.5.12) Marty Arnold c/o Wanda Griffith PO Box 116 Doran, VA 24612	0.00594 acres 1/360 of 2.14 acres	0.0074%	0.0003%	0.0007%	0.0001%
(c) Stella Wade Gillespie Heirs, Devisees, Successors or Assigns					

Exhibit E
Unit U-27
Docket #VGOB 97-0218-0563-05
List of Respondents that require escrow

	Net Acres in Unit	Interest in Unit	Divison of Interest in		
			2 Left 3.4066%	3 Left 9.5185%	4 Left 1.2413%
(c.1) Cecil Gillespie 439 Brown Avenue Richlands, VA 24641	0.01783 acres 1/120 of 2.14 acres	0.0223%	0.0008%	0.0021%	0.0003%
(c.2) Troy Gillespie 20307 Cleveland Road Abingdon, VA 24211	0.01783 acres 1/120 of 2.14 acres	0.0223%	0.0008%	0.0021%	0.0003%
(c.3) David Gillespie 3241 Clef Lane Lakeland, TN 380002	0.01783 acres 1/120 of 2.14 acres	0.0223%	0.0008%	0.0021%	0.0003%
(c.4) Darrell Gillespie Address Unknown	0.01783 acres 1/120 of 2.14 acres	0.0223%	0.0008%	0.0021%	0.0003%
(d) Glayds Wade Boyd Heirs, Devisees, Successors or Assigns					
(d.1) Patti Gilbert 3603 Kent Ridge Road Cedar Bluff, VA 24609	0.02378 acres 1/90 of 2.14 acres	0.0297%	0.0010%	0.0028%	0.0004%
(d.2) Michael T. Boyd 3849 Kent Ridge Road Cedar Bluff, VA 24609	0.02378 acres 1/90 of 2.14 acres	0.0297%	0.0010%	0.0028%	0.0004%
(e) Venia Wade Newberry 639 Daniel Drive Newport News, VA 23601	0.07133 acres 1/30 of 2.14 acres	0.0892%	0.0030%	0.0085%	0.0011%
(f) Sarah Eady "Edith" Wade Smith Heirs					
(f.1) Lula Smith Robins Heirs, Devisees, Successors or Assigns <i>Documentation Pending</i>	0.01783 acres 1/120 of 2.14 acres	0.0223%	0.0008%	0.0021%	0.0003%
(f.1.1) Timothy K. Martin 331 Sugar Run Road Cedar Bluff, VA 24609					
(f.1.2) Patricia Diane Taylor PO Box 2104 Honaker, VA 24260					
(f.1.3) Louise R. Smith Heirs, Devisees, Successors or Assigns <i>Heirs Unknown</i>					
(f.3) Earl Dolphus Smith Heirs, Devisees, Successors or Assigns <i>Documentation Pending</i>	0.01783 acres 1/120 of 2.14 acres	0.0223%	0.0008%	0.0021%	0.0003%
(f.3.1) Marie Carter Smith 905 Big Breek Road Richlands, V 24641					
(f.4) Raymond S. Smith Heirs, Devisees, Successors or Assigns					
(f.4.1) Virginia Edith Smith Box 335 Doran, VA 24612	0.01783 acres 1/120 of 2.14 acres	0.0223%	0.0008%	0.0021%	0.0003%
(f.5) Luther Smith Heirs, Devisees, Successors or Assigns					

Exhibit E
Unit U-27
Docket #VGOB 97-0218-0563-05
List of Respondents that require escrow

	Net Acres in Unit	Interest in Unit	Divison of Interest in		
			2 Left 3.4066%	3 Left 9.5185%	4 Left 1.2413%
(f.5.1) Geraldine Smith Heirs, Devisees, Successors or Assigns					
(f.5.1.1) Lisa Wallace	Predeceased Luther & Geraldine Smith				
(f.5.1.1.1) Anna Bond 1760 Knox Creek Road Hurley, VA 24620	0.00149 acres 1/1440 of 2.14 acres	0.0019%	0.0001%	0.0002%	0.0000%
(4) Myrta N. Ratliff Heirs, Devisees, Successors or Assigns Address Unknown	0.42800 acres 1/5 of 2.14 acres	0.5350%	0.0182%	0.0509%	0.0066%
(5) Mona Webb Heirs, Devisees, Successors or Assigns					
(d) Virginia W. Cole Heirs Devisees, Successors or Assigns					
(d.3) Melissa M. Turner 3480 Eaglebrook Rd. Christiansburg, VA 24073	0.00764 acres 1/280 of 2.14 acres	0.0096%	0.0003%	0.0009%	0.0001%
(d.4) Maura Nichole Turner 3480 Eaglebrook Rd. Christiansburg, VA 24073	0.00764 acres 1/280 of 2.14 acres	0.0096%	0.0003%	0.0009%	0.0001%
(d.5) Garrett Reid Turner 3480 Eaglebrook Rd. Christiansburg, VA 24073	0.00764 acres 1/280 of 2.14 acres	0.0096%	0.0003%	0.0009%	0.0001%
(d.6) Jordyn Noelle Turner 3480 Eaglebrook Rd. Christiansburg, VA 24073	0.00764 acres 1/280 of 2.14 acres	0.0096%	0.0003%	0.0009%	0.0001%
(g) Robert W. Casey Heirs, Devisees, Successors or Assigns					
(g.2) Chadwick Michael Casey 520 Watson Road Pounding Mill, VA 24637	0.02038 acres 1/105 of 2.14 acres	0.0255%	0.0009%	0.0024%	0.0003%
	Total tract acres	0.79			
	Total tract percent	0.9909%			

Exhibit EE
Unit U-27
Docket #VGOB 97-0218-0563-05
List of Respondents with Royalty Split Agreements/Court Orders/HB2058

		Net Acres in Unit	Interest in Unit	Division of Interest in			Percent of Escrow
				2 Left 3.4066%	3 Left 9.5185%	4 Left 1.2413%	
<u>Tract #1, 72.52 Acre Tract</u>							
<u>COAL OWNERSHIP</u>							
(1)	Hugh MacRae Land Trust Tr. 6 c/o Alan Siegel Esq Gump, Strauss, Akin LLP 1 Bryant Park New York, NY 10036-6705	72.52 acres	90.6500%	3.0881%	8.6285%	1.12524%	n/a
<u>CBM Royalty Owner (from the Coal owner):</u>							
Torch Oil and Gas Company c/o Sue Ann Craddock 670 Dona Ana Road SW Deming, NM 88030							
<u>OIL & GAS OWNERSHIP</u>							
(1)	CNX Gas Company LLC (Consolidation Coal Company) 2481 John Nash Blvd. Bluefield, WV 24701	72.52 acres	90.6500%	3.0881%	8.6285%	1.12524%	n/a
<u>Tract #2, 2.14 Acre Tract</u>							
<u>COAL OWNERSHIP</u>							
	Yukon Pocahontas Coal Company, et al. Tr. 110	2.14 acres	2.6750%	0.0911%	0.2546%	0.0332%	
(1)	Yukon Pocahontas Coal Company, et al. <i>(Only 3/5 interest conflicting)</i>	1.28 acres 3/5 of 2.14 acres	1.6050%	0.0547%	0.1528%	0.0199%	
(a)	Yukon Pocahontas Coal Company P.O. Box 187 Tazewell, VA 24651	0.64200 acres 1/2 of 2.14 acres	0.8025%	0.0273%	0.0764%	0.0100%	1.5681% (Royalty Split)
(b)	Buchanan Coal Company P.O. Box 187 Tazewell, VA 24651	0.14267 acres 1/9 of 2.14 acres	0.1783%	0.0061%	0.0170%	0.0022%	0.3485% (Royalty Split)
(c)	Sayers-Pocahontas Coal Company P.O. Box 187 Tazewell, VA 24651	0.07133 acres 1/18 of 2.14 acres	0.0892%	0.0030%	0.0085%	0.0011%	0.1742% (Royalty Split)
(d)	Consolidation Coal Company * 10545 Riverside Dr. Oakwood, VA 24631	0.42800 acres 1/3 of 2.14 acres					
<u>Royalties Paid to:</u>							
	Plum Creek Timberlands, L.P. Attn: Mineral Department Five Concourse Parkway, Suite 1650 Atlanta, GA 30328	0.42800 acres 1/3 of 2.14 acres	0.5350%	0.0182%	0.0509%	0.0066%	1.0454% (Royalty Split)
* Note: Plum Creek Timberlands retained their CBM interest, there is no conflict. The royalty for (d) is to be paid to Plum Creek.							
<u>OIL & GAS OWNERSHIP</u>							
	Yukon Pocahontas Coal Co. Tr. 110, et al.	2.14 acres	2.6750%	0.0911%	0.2546%	0.0332%	n/a
(1)	Yukon Pocahontas Coal Company, et al., Tr. 110						
(a)	Yukon Pocahontas Coal Company P.O. Box 187 Tazewell, VA 24651	0.21400 acres 1/10 of 2.14 acres	0.2675%	0.0091%	0.0255%	0.0033%	n/a
(b)	Buchanan Coal Company P.O. Box 187 Tazewell, VA 24651	0.04756 acres 1/45 of 2.14 acres	0.0594%	0.0020%	0.0057%	0.0007%	n/a
(c)	Sayers-Pocahontas Coal Company P.O. Box 187 Tazewell, VA 24651	0.02378 acres 1/90 of 2.14 acres	0.0297%	0.0010%	0.0028%	0.0004%	n/a

Exhibit EE
Unit U-27
Docket #VGOB 97-0218-0563-05
List of Respondents with Royalty Split Agreements/Court Orders/HB2058

	Net Acres in Unit	Interest in Unit	Division of Interest in			Percent of Escrow
			2 Left 3.4066%	3 Left 9.5185%	4 Left 1.2413%	
(d) Highland Resources, Inc/ North American Resource One Concourse Parkway, NE, Suite 755 Atlanta, GA 30328	0.14267 acres 1/15 of 2.14 acres	0.1783%	0.0061%	0.0170%	0.0022%	n/a
* Note: Plum Creek Timberlands retained their CBM interest, there is no conflict. The royalty for (d) is to be paid to Plum Creek. Highland Resources, Inc. / North American Resources, Corp. is owner of the Oil & Gas Only.						
(2) C. L. Ritter Lumber Co. Tr. 51 P. O. Box 700 Huntington, WV 25711	0.42800 acres 1/5 of 2.14 acres	0.5350%	0.0182%	0.0509%	0.0066%	n/a
(3) Walter Wade Heirs						
(a) Carl Wade Heirs, Devisees, Successors or Assigns						
(a.1) Emanuel Wade 226 Adam Street Blountville, TN 37617	0.03567 acres 1/60 of 2.14 acres	0.0446%	0.0015%	0.0042%	0.0006%	3.7635% HB2058
(a.2) Gaylene Deskins Heirs, Devisees, Successors or Assigns						
(a.2.1) Nick Deskins 720 Skyview Drive Chilhowie, VA 24319-4527	0.01783 acres 1/120 of 2.14 acres	0.0223%	0.0008%	0.0021%	0.0003%	0.9409% (Royalty Split)
(a.2.2) Valmy Shannon 103 Blanton Drive Seaford, VA 23696-2522	0.01783 acres 1/120 of 2.14 acres	0.0223%	0.0008%	0.0021%	0.0003%	0.9409% (Royalty Split)
(d) Glayds Wade Boyd Heirs, Devisees, Successors or Assigns						
(d.3) Eleanor Hagy 14475 Rainbow Road, Lot #31 Bristol, VA 24202	0.02378 acres 1/90 of 2.14 acres	0.0297%	0.0010%	0.0028%	0.0004%	1.2545% (Royalty Split)
(f) Sarah Eady "Edith" Wade Smith Heirs						
(f.5) Luther Smith Heirs, Devisees, Successors or Assigns						
(f.5.1) Geraldine Smith Heirs, Devisees, Successors or Assigns						
(f.5.1.1) Lisa Wallace	Predeceased Luther & Geraldine Smith					
(f.5.1.1.2) Scotty Bond Box 82 Swords Creek, VA 24649	0.00149 acres 1/1440 of 2.14 acres	0.0019%	0.0001%	0.0002%	0.0000%	0.1568% HB2058
(f.5.2.1) David Smith 84 Poison Ivy Drive Taylorsville, NC 28681	0.00297 acres 1/720 of 2.14 acres	0.0037%	0.0001%	0.0004%	0.0000%	0.3136% HB2058
(f.5.2.2) Donald Smith 84 Poison Ivy Drive Taylorsville, NC 28681	0.00297 acres 1/720 of 2.14 acres	0.0037%	0.0001%	0.0004%	0.0000%	0.3136% HB2058
(f.5.2.3) Judy Tiedemann 530 150th Street Amery, WI 54001-2805	0.00297 acres 1/720 of 2.14 acres	0.0037%	0.0001%	0.0004%	0.0000%	0.3136% HB2058
(f.5.2.4) Paul Thomas Smith, Sr. Heirs, Devisees Successors or Assigns						
(f.5.2.4.1) Jo-Ann Perkins Smith PO Box 1143 Claremont, NC 28610	0.00297 acres 1/720 of 2.14 acres	0.0037%	0.0001%	0.0004%	0.0000%	0.3136% HB2058
(f.5.2.5) Peggy Smith 84 Poison Ivy Drive Taylorsville, NC 28681	0.00297 acres 1/720 of 2.14 acres	0.0037%	0.0001%	0.0004%	0.0000%	0.3136% HB2058
(5) Mona Webb Heirs, Devisees, Successors or Assigns						

Exhibit EE
Unit U-27
Docket #VGOB 97-0218-0563-05
List of Respondents with Royalty Split Agreements/Court Orders/HB2058

	Net Acres in Unit	Interest in Unit	Division of Interest in			Percent of Escrow
			2 Left 3.4066%	3 Left 9.5185%	4 Left 1.2413%	
(a) Harold Webb Heirs, Devisees, Successors or Assigns						
(a.1) Mary Lou Webb 298 Morrell Town Road Bristol, TN 37620	0.06114 acres 1/35 of 2.14 acres	0.0764%	0.0026%	0.0073%	0.0009%	n/a
(b) Harman Webb Heirs, Devisees, Successors or Assigns						
(b.1) Estate of Harman M. Webb PO Box 1029 Richlands, VA 24641	0.06114 acres 1/35 of 2.14 acres	0.0764%	0.0026%	0.0073%	0.0009%	n/a
(c) John Webb P. O.Box 577 Keen Mountain, VA 24624	0.06114 acres 1/35 of 2.14 acres	0.0764%	0.0026%	0.0073%	0.0009%	n/a
(d) Virginia W. Cole Heirs Devisees, Successors or Assigns						
(d.1) Carol Cole Ownbey 2908 Valley Farm Road Waxhaw, North Carolina 28173	0.01529 acres 1/140 of 2.14 acres	0.0191%	0.0007%	0.0018%	0.0002%	n/a
(d.2) Barbara Cole Maxwell 5780 Chicwood Drive Puiaski, VA 24301	0.01529 acres 1/140 of 2.14 acres	0.0191%	0.0007%	0.0018%	0.0002%	n/a
(e) Emma R. Hurbert Heirs, Devisees, Successors, or Assigns						
(e.1) Bill Chambers 8940 Mill Creek Road Millboro, VA 24460	0.02038 acres 1/105 of 2.14 acres	0.0255%	0.0009%	0.0024%	0.0003%	n/a
(e.2) Sherri Collins 10652 Stafford Road Chargin Falls, OH 44023	0.02038 acres 1/105 of 2.14 acres	0.0255%	0.0009%	0.0024%	0.0003%	n/a
(e.3) Wanda Waite 10652 Stafford Road Chargin Falls, OH 44023	0.02038 acres 1/105 of 2.14 acres	0.0255%	0.0009%	0.0024%	0.0003%	n/a
(f) Ruby W. Wells 5980 Pearl Road Parma Heights, OH 44130	0.06114 acres 1/35 of 2.14 acres	0.0764%	0.0026%	0.0073%	0.0009%	n/a
(g) Robert W. Casey Heirs, Devisees, Successors or Assigns						
(g.1) Pauline Cole Casey 1279 Hilltop Road Jewell Ridge, VA 24622	0.02038 acres 1/105 of 2.14 acres	0.0255%	0.0009%	0.0024%	0.0003%	2.1506% HB2058
(g.3) Robert Brian Casey 798 Pond Street Pounding Mill, VA 24637	0.02038 acres 1/105 of 2.14 acres	0.0255%	0.0009%	0.0024%	0.0003%	2.1506% HB2058
	Total tract acres	1.34				
	Total tract percent	1.6806%				

Tract #4, 0.01 Acre Tract

COAL OWNERSHIP

(1) Hugh MacRae Land Trust Tr. 6 c/o Alan Siegel Esq Gump, Strauss, Akin LLP 1 Bryant Park New York, NY 10036-6705	0.01 acres	0.0125%	0.0004%	0.0012%	0.0002%	n/a
--	------------	---------	---------	---------	---------	-----

Exhibit EE
Unit U-27
Docket #VGOB 97-0218-0563-05
List of Respondents with Royalty Split Agreements/Court Orders/HB2058

		Net Acres in Unit	Interest in Unit	Division of Interest in			Percent of Escrow
				2 Left 3.4066%	3 Left 9.5185%	4 Left 1.2413%	
<u>CBM Royalty Owner (from the Coal owner):</u>							
Torch Oil and Gas Company c/o Sue Ann Craddock 670 Dona Ana Road SW Deming, NM 88030							
<u>OIL & GAS OWNERSHIP</u>							
(1)	Roscoe Reuben Deskins Sr. Heirs, Devisees, Successors or Assigns	0.010 acres	0.0125%	0.0004%	0.0012%	0.0002%	
(a)	Roscoe Deskins, Jr. 1728 Wardell Rd. Cedar Bluff, VA 24609	0.005 acres 1/2 of 0.010 acres	0.0063%	0.0002%	0.0006%	0.0001%	n/a
(b)	Calvin Eddie Deskins 6972 Riverside Raven, VA 24639	0.005 acres 1/2 of 0.010 acres	0.0063%	0.0002%	0.0006%	0.0001%	n/a
				Acreage in Unit Percentage of Unit		73.87	92.3431%

AFFIDAVIT OF MAILING – COAL OWNER

COMMONWEALTH OF VIRGINIA
COUNTY OF **BUCHANAN**

Applicant: CNX Gas Company LLC
Relief Sought: Disbursement Petition for U27
VGOB: 97-0218-0563-05

I, Anita D. Duty, after being duly sworn upon oath, state as follows:

1. I am the Pooling Supervisor for CNX Land Resources, Inc. and am responsible for the notification process required by Va. Code Ann. §45.1-361.19 of the Code of Virginia and 4VAC25-160-40.

2. That on **March 17, 2016** a true and correct copy of the coal owner dismissal and prior order were mailed, via certified mail return receipt requested, based upon information and belief, the names and last-known addresses, where such addresses are known, of the parties owning an interest in this cause are set forth and attached hereto.

3. Notice of this cause has therefore been served by mail pursuant to the applicable statutes and rules of the Board.

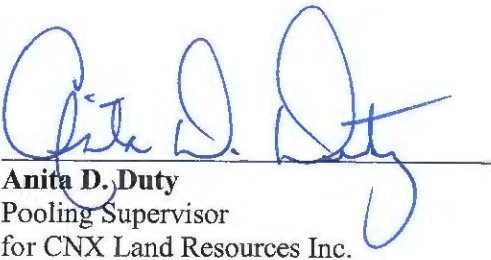

Anita D. Duty
Pooling Supervisor
for CNX Land Resources Inc.

STATE OF VIRGINIA

COUNTY OF TAZEWELL, TO-WIT:

TAKEN, SUBSCRIBED AND SWORN to before me this 1st day of April,
2016.

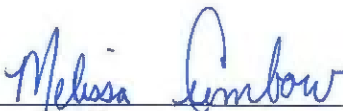

Notary Public

My commission expires: 12/31/2019

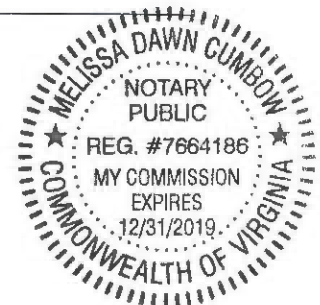

CERTIFICATION OF NOTICE
CNX Gas Company LLC

Unit U27
VGOB 97-0218-0563-05
Disbursement

Buchanan

Last Name	First Name	MAILED	RECEIPT #		Received
Bond	Scotty	3/17/16	7015301000011354	0225	3/21/2016 1
Casey	Pauline Cole	3/17/16	7015301000011354	0232	3/22/2016 2
Casey	Robert Brian	3/17/16	7015301000011354	0249	3/18/2016 3
Deskins	Nick	3/17/16	7015301000011354	0256	3/19/2016 4
Hagy	Eleanor	3/17/16	7015301000011354	0263	3/22/2016 5
Plum Creek Timberlands LP		3/17/16	7015301000011354	0270	3/21/2016 6
Shannon	Valmy	3/17/16	7015301000011354	0287	3/21/2016 7
Smith	David	3/17/16	7015301000011354	0294	3/22/2016 8
Smith	Donald	3/17/16	7015301000011354	0300	3/22/2016 9
Smith	Jo-Ann Perkins	3/17/16	7015301000011354	0317	3/21/2016 10
Smith	Peggy	3/17/16	7015301000011354	0324	3/22/2016 11
Tiedemann	Judy	3/17/16	7015301000011354	0331	3/26/2016 12
Wade	Emanuel	3/17/16	7015301000011354	0348	3/28/2016 13
Yukon, Buchanan, Sayers Coal Company, LLP		3/17/16	7015301000011354	0355	3/21/2016 14

SENDER: COMPLETE THIS SECTION

- Complete items 1, 2, and 3.
- Print your name and address on the reverse so that we can return the card to you.
- Attach this card to the back of the mailpiece, or on the front if space permits.

1. Article Addressed to:
 Pauline Cole Casey
 1279 HILLTOP RD
 JEWELL RIDGE VA 24622-9301



9590 9402 1427 5329 8654 75

2. Article Number (Transfer from service label)
 P 7015 3010 0001 1354 0232

PS 7015 3010 0001 1354 0232 Domestic Return Receipt
 437-0150

COMPLETE THIS SECTION ON DELIVERY

- Complete items 1, 2, and 3.
- Print your name and address on the reverse so that we can return the card to you.
- Attach this card to the back of the mailpiece, or on the front if space permits.

1. Article Addressed to:
 Pauline Casey
 3/29/10
 Pauline Casey

3. Service Type
 Priority Mail Express®
 Adult Signature
 Registered Mail™
 Certified Mail®
 Return Receipt for Merchandise
 Collect on Delivery
 Signature Confirmation™
 Insured Mail
 Insured Mail Restricted Delivery

437-0150 Domestic Return Receipt

SENDER: COMPLETE THIS SECTION

- Complete items 1, 2, and 3.
- Print your name and address on the reverse so that we can return the card to you.
- Attach this card to the back of the mailpiece, or on the front if space permits.

Article Addressed to:
 Nick Deskins
 720 Skyview Dr
 Chilhowie VA 24319-4527



9590 9402 1427 5329 8654 99

Article Number (Transfer from service label)
 SI 7015 3010 0001 1354 0256

PS 7015 3010 0001 1354 0256 Domestic Return Receipt
 437-0150

SENDER: COMPLETE THIS SECTION

- Complete items 1, 2, and 3.
- Print your name and address on the reverse so that we can return the card to you.
- Attach this card to the back of the mailpiece, or on the front if space permits.

1. Article Addressed to:
 Scotty Bond
 Box 82
 Swords Creek VA 24649



9590 9402 1427 5329 8654 68

2. Article Number (Transfer from service label)
 PS 7015 3010 0001 1354 0225

PS 7015 3010 0001 1354 0225 Domestic Return Receipt
 437-0150

COMPLETE THIS SECTION ON DELIVERY

- Signature: *Pauline Casey*
- Received by (Printed Name): *Pauline Casey*
- Date of Delivery: *3/29/10*

1. Is delivery address different from item 1? Yes No
 If YES, enter delivery address below:

3. Service Type
 Priority Mail Express®
 Adult Signature
 Registered Mail™
 Certified Mail®
 Return Receipt for Merchandise
 Collect on Delivery
 Signature Confirmation™
 Insured Mail
 Insured Mail Restricted Delivery

437-0150 Domestic Return Receipt

COMPLETE THIS SECTION ON DELIVERY

- Signature: *Pauline Casey*
- Received by (Printed Name): *Pauline Casey*
- Date of Delivery: *3-19*

1. Is delivery address different from item 1? Yes No
 If YES, enter delivery address below:

3. Service Type
 Priority Mail Express®
 Adult Signature
 Registered Mail™
 Certified Mail®
 Return Receipt for Merchandise
 Collect on Delivery
 Signature Confirmation™
 Insured Mail
 Insured Mail Restricted Delivery

437-0150 Domestic Return Receipt

SENDER: COMPLETE THIS SECTION

- Complete items 1, 2, and 3.
- Print your name and address on the reverse so that we can return the card to you.
- Attach this card to the back of the mailpiece, or on the front if space permits.

Article Addressed to:
 Robert Brian Casey
 798 Pond Street
 Pounding Mill VA 24637

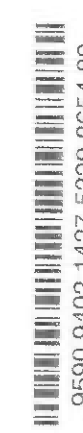

9590 9402 1427 5329 8654 82

2. Article Number (Transfer from service label)
 PS Form 3811 7015 3010 0001 1354 0249

PS Form 3811 7015 3010 0001 1354 0249 Domestic Return Receipt
 437-0150

COMPLETE THIS SECTION ON DELIVERY

- Signature: *Robert Brian Casey*
- Received by (Printed Name): *Robert Brian Casey*
- Date of Delivery: *3/18/10*

1. Is delivery address different from item 1? Yes No
 If YES, enter delivery address below:

3. Service Type
 Priority Mail Express®
 Adult Signature
 Registered Mail™
 Certified Mail®
 Return Receipt for Merchandise
 Collect on Delivery
 Signature Confirmation™
 Insured Mail
 Insured Mail Restricted Delivery

437-0150 Domestic Return Receipt

REC: COMPLETE THIS SECTION

Complete items 1, 2, and 3.
Print your name and address on the reverse so that we can return the card to you.
Attach this card to the back of the mailpiece, front on the front if space permits.

Article Addressed to:
Eleanor Sue Hagy
14475 RAINBOW RD # 31
Bristol VA 24202-4237



9590 9402 1427 5329 8655 05

Article Number (Transfer from service label)
7015 3010 0001 1354 0263

REC: COMPLETE THIS SECTION

Complete items 1, 2, and 3.
Print your name and address on the reverse so that we can return the card to you.
Attach this card to the back of the mailpiece, front on the front if space permits.

Article Addressed to:
Plum Creek Timberlands, LP
Five Concourse Pkwy, Suite 1650
Atlanta GA 30328



9590 9402 1427 5329 8650 17

Article Number (Transfer from service label)
7015 3010 0001 1354 0270

COMPLETE THIS SECTION ON DELIVERY

A. Signature Agent
B. Received by (Printed Name) Addressee
C. Date of Delivery 5-22-16
D. Is delivery address different from item 1? Yes
If YES, enter delivery address below: No

3. Service Type
 Adult Signature
 Adult Signature Restricted Delivery
 Certified Mail®
 Certified Mail Restricted Delivery
 Collect on Delivery
 Collect on Delivery Restricted Delivery
 Insured Mail
 Insured Mail Restricted Delivery
 Priority Mail Express®
 Registered Mail™
 Registered Mail Restricted Delivery
 Return Receipt for Merchandise
 Signature Confirmation™
 Signature Confirmation Restricted Delivery

7015 3010 0001 1354 0263
457-Disb Domestic Return Receipt

COMPLETE THIS SECTION ON DELIVERY

A. Signature Agent
B. Received by (Printed Name) Addressee
C. Date of Delivery 3-21-16
D. Is delivery address different from item 1? Yes
If YES, enter delivery address below: No

3. Service Type
 Adult Signature
 Adult Signature Restricted Delivery
 Certified Mail®
 Certified Mail Restricted Delivery
 Collect on Delivery
 Collect on Delivery Restricted Delivery
 Insured Mail
 Insured Mail Restricted Delivery
 Priority Mail Express®
 Registered Mail™
 Registered Mail Restricted Delivery
 Return Receipt for Merchandise
 Signature Confirmation™
 Signature Confirmation Restricted Delivery

7015 3010 0001 1354 0270
457-Disb Domestic Return Receipt

SENDER: COMPLETE THIS SECTION

Complete items 1, 2, and 3.
Print your name and address on the reverse so that we can return the card to you.
Attach this card to the back of the mailpiece, or on the front if space permits.

Article Addressed to:
Valmy R. Shannon
103 BLANTON DR
SEAFORD VA 23696-2522



9590 9402 1427 5329 8650 24

Article Number (Transfer from service label)
7015 3010 0001 1354 0267

SENDER: COMPLETE THIS SECTION

Complete items 1, 2, and 3.
Print your name and address on the reverse so that we can return the card to you.
Attach this card to the back of the mailpiece, or on the front if space permits.

Article Addressed to:
David Smith
84 Poison Ivy Dr
Taylorsville NC 28681



9590 9402 1427 5329 8650 31

Article Number (Transfer from service label)
7015 3010 0001 1354 0294

COMPLETE THIS SECTION ON DELIVERY

A. Signature Agent
B. Received by (Printed Name) Addressee
C. Date of Delivery 5-27-16
D. Is delivery address different from item 1? Yes
If YES, enter delivery address below: No

3. Service Type
 Adult Signature
 Adult Signature Restricted Delivery
 Certified Mail®
 Certified Mail Restricted Delivery
 Collect on Delivery
 Collect on Delivery Restricted Delivery
 Insured Mail
 Insured Mail Restricted Delivery
 Priority Mail Express®
 Registered Mail™
 Registered Mail Restricted Delivery
 Return Receipt for Merchandise
 Signature Confirmation™
 Signature Confirmation Restricted Delivery

7015 3010 0001 1354 0267
457-Disb Domestic Return Receipt

COMPLETE THIS SECTION ON DELIVERY

A. Signature Agent
B. Received by (Printed Name) Addressee
C. Date of Delivery 5-27-16
D. Is delivery address different from item 1? Yes
If YES, enter delivery address below: No

3. Service Type
 Adult Signature
 Adult Signature Restricted Delivery
 Certified Mail®
 Certified Mail Restricted Delivery
 Collect on Delivery
 Collect on Delivery Restricted Delivery
 Insured Mail
 Insured Mail Restricted Delivery
 Priority Mail Express®
 Registered Mail™
 Registered Mail Restricted Delivery
 Return Receipt for Merchandise
 Signature Confirmation™
 Signature Confirmation Restricted Delivery

7015 3010 0001 1354 0294
457-Disb Domestic Return Receipt

SENDER: COMPLETE THIS SECTION

1. Complete items 1, 2, and 3.
Print your name and address on the reverse so that we can return the card to you.
Attach this card to the back of the mailpiece, or on the front if space permits.
Article Addressed to:

Donald Smith
84 Poison Ivy Dr
Taylorsville NC 28681



9590 9402 1427 5329 8650 48

2. Article Number (Transfer from service label)

7015 3010 0001 1354 0300

SENDER: COMPLETE THIS SECTION

1. Complete items 1, 2, and 3.
Print your name and address on the reverse so that we can return the card to you.
Attach this card to the back of the mailpiece, or on the front if space permits.
Article Addressed to:

JoAnn P. Smith
PO Box 1143
CLAREMONT NC 28610-1143



9590 9402 1427 5329 8650 55

2. Article Number (Transfer from service label)

7015 3010 0001 1354 0317

COMPLETE THIS SECTION ON DELIVERY

A. Signature
Donald Smith
B. Received by (Printed Name)
C. Date of Delivery
MAY 22 2015
D. Is delivery address different from item 1? Yes
If YES, enter delivery address below: No

3. Service Type
 Adult Signature
 Adult Signature Restricted Delivery
 Certified Mail®
 Certified Mail Restricted Delivery
 Collect on Delivery
 Collect on Delivery Restricted Delivery
 Insured Mail
 Insured Mail Restricted Delivery
 Priority Mail Express®
 Registered Mail™
 Registered Mail Restricted Delivery
 Return Receipt for Merchandise
 Signature Confirmation™
 Signature Confirmation Restricted Delivery

7015 3010 0001 1354 0300
427-D-15b Domestic Return Receipt

COMPLETE THIS SECTION ON DELIVERY

A. Signature
JoAnn P. Smith
B. Received by (Printed Name)
JoAnn P. Smith
C. Date of Delivery
5/22/15
D. Is delivery address different from item 1? Yes
If YES, enter delivery address below: No

3. Service Type
 Adult Signature
 Adult Signature Restricted Delivery
 Certified Mail®
 Certified Mail Restricted Delivery
 Collect on Delivery
 Collect on Delivery Restricted Delivery
 Insured Mail
 Insured Mail Restricted Delivery
 Priority Mail Express®
 Registered Mail™
 Registered Mail Restricted Delivery
 Return Receipt for Merchandise
 Signature Confirmation™
 Signature Confirmation Restricted Delivery

7015 3010 0001 1354 0317
427-D-15b Domestic Return Receipt

SENDER: COMPLETE THIS SECTION

1. Complete items 1, 2, and 3.
Print your name and address on the reverse so that we can return the card to you.
Attach this card to the back of the mailpiece, or on the front if space permits.
Article Addressed to:

Peggy Smith
84 Poison Ivy Dr
Taylorsville NC 28681

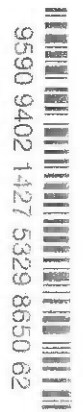

9590 9402 1427 5329 8650 62

2. Article Number (Transfer from service label)

7015 3010 0001 1354 0324

SENDER: COMPLETE THIS SECTION

1. Complete items 1, 2, and 3.
Print your name and address on the reverse so that we can return the card to you.
Attach this card to the back of the mailpiece, or on the front if space permits.
Article Addressed to:

Judy Tiedemann
530 150th St
Amery WI 54001-2805



9590 9402 1427 5329 8650 79

2. Article Number (Transfer from service label)

7015 3010 0001 1354 0331

COMPLETE THIS SECTION ON DELIVERY

A. Signature
Judy Tiedemann
B. Received by (Printed Name)
Judy Tiedemann
C. Date of Delivery
MAY 22 2015
D. Is delivery address different from item 1? Yes
If YES, enter delivery address below: No

3. Service Type
 Adult Signature
 Adult Signature Restricted Delivery
 Certified Mail®
 Certified Mail Restricted Delivery
 Collect on Delivery
 Collect on Delivery Restricted Delivery
 Insured Mail
 Insured Mail Restricted Delivery
 Priority Mail Express®
 Registered Mail™
 Registered Mail Restricted Delivery
 Return Receipt for Merchandise
 Signature Confirmation™
 Signature Confirmation Restricted Delivery



7015 3010 0001 1354 0324
427-D-15b Domestic Return Receipt

COMPLETE THIS SECTION ON DELIVERY

A. Signature
Judy Tiedemann
B. Received by (Printed Name)
Judy Tiedemann
C. Date of Delivery
5/22/15
D. Is delivery address different from item 1? Yes
If YES, enter delivery address below: No

3. Service Type
 Adult Signature
 Adult Signature Restricted Delivery
 Certified Mail®
 Certified Mail Restricted Delivery
 Collect on Delivery
 Collect on Delivery Restricted Delivery
 Insured Mail
 Insured Mail Restricted Delivery
 Priority Mail Express®
 Registered Mail™
 Registered Mail Restricted Delivery
 Return Receipt for Merchandise
 Signature Confirmation™
 Signature Confirmation Restricted Delivery

7015 3010 0001 1354 0331
427-D-15b Domestic Return Receipt

SENDER: COMPLETE THIS SECTION	COMPLETE THIS SECTION ON DELIVERY																
<ul style="list-style-type: none"> Complete items 1, 2, and 3. Print your name and address on the reverse so that we can return the card to you. Attach this card to the back of the mailpiece, or on the front if space permits. 	<p>A. Signature <input checked="" type="checkbox"/> <i>Sayer</i> <input type="checkbox"/> Agent <input type="checkbox"/> Addressee</p> <p>B. Received by (Printed Name) C. Date of Delivery</p>																
<p>1. Article Addressed to:</p> <p style="text-align: center;">Yukon Poca/ Buch/Sayers Coal Co c/o Charles Hart PO Box 187 Tazewell VA 24651</p>  <p>9590 9402 1427 5329 8650 93</p>	<p>D. Is delivery address different from item 1? <input type="checkbox"/> Yes If YES, enter delivery address below: <input checked="" type="checkbox"/> No</p> 																
<p>2. Article Number (Transfer from service label)</p>	<p>3. Service Type</p> <table border="0"> <tr> <td><input type="checkbox"/> Adult Signature</td> <td><input type="checkbox"/> Priority Mail Express®</td> </tr> <tr> <td><input type="checkbox"/> Adult Signature Restricted Delivery</td> <td><input type="checkbox"/> Registered Mail™</td> </tr> <tr> <td><input type="checkbox"/> Certified Mail®</td> <td><input type="checkbox"/> Registered Mail Restricted Delivery</td> </tr> <tr> <td><input type="checkbox"/> Certified Mail Restricted Delivery</td> <td><input type="checkbox"/> Return Receipt for Merchandise</td> </tr> <tr> <td><input type="checkbox"/> Collect on Delivery</td> <td><input type="checkbox"/> Signature Confirmation™</td> </tr> <tr> <td><input type="checkbox"/> Collect on Delivery Restricted Delivery</td> <td><input type="checkbox"/> Signature Confirmation Restricted Delivery</td> </tr> <tr> <td><input type="checkbox"/> Insured Mail</td> <td></td> </tr> <tr> <td><input type="checkbox"/> Insured Mail Restricted Delivery (over \$500)</td> <td></td> </tr> </table>	<input type="checkbox"/> Adult Signature	<input type="checkbox"/> Priority Mail Express®	<input type="checkbox"/> Adult Signature Restricted Delivery	<input type="checkbox"/> Registered Mail™	<input type="checkbox"/> Certified Mail®	<input type="checkbox"/> Registered Mail Restricted Delivery	<input type="checkbox"/> Certified Mail Restricted Delivery	<input type="checkbox"/> Return Receipt for Merchandise	<input type="checkbox"/> Collect on Delivery	<input type="checkbox"/> Signature Confirmation™	<input type="checkbox"/> Collect on Delivery Restricted Delivery	<input type="checkbox"/> Signature Confirmation Restricted Delivery	<input type="checkbox"/> Insured Mail		<input type="checkbox"/> Insured Mail Restricted Delivery (over \$500)	
<input type="checkbox"/> Adult Signature	<input type="checkbox"/> Priority Mail Express®																
<input type="checkbox"/> Adult Signature Restricted Delivery	<input type="checkbox"/> Registered Mail™																
<input type="checkbox"/> Certified Mail®	<input type="checkbox"/> Registered Mail Restricted Delivery																
<input type="checkbox"/> Certified Mail Restricted Delivery	<input type="checkbox"/> Return Receipt for Merchandise																
<input type="checkbox"/> Collect on Delivery	<input type="checkbox"/> Signature Confirmation™																
<input type="checkbox"/> Collect on Delivery Restricted Delivery	<input type="checkbox"/> Signature Confirmation Restricted Delivery																
<input type="checkbox"/> Insured Mail																	
<input type="checkbox"/> Insured Mail Restricted Delivery (over \$500)																	
<p>PS 7015 3010 0001 1354 0355</p>	<p>457-Dish Domestic Return Receipt</p>																

SENDER: COMPLETE THIS SECTION	COMPLETE THIS SECTION ON DELIVERY																
<ul style="list-style-type: none"> Complete items 1, 2, and 3. Print your name and address on the reverse so that we can return the card to you. Attach this card to the back of the mailpiece, or on the front if space permits. 	<p>A. Signature <input checked="" type="checkbox"/> <i>Emmanuel Wade</i> <input type="checkbox"/> Agent <input type="checkbox"/> Addressee</p> <p>B. Received by (Printed Name) C. Date of Delivery <i>EMMANUEL WADE</i></p>																
<p>1. Article Addressed to:</p> <p style="text-align: center;">Emmanuel Wade 226 ADAMS St BLOUNTVILLE TN 37617-3920</p>  <p>9590 9402 1427 5329 8650 86</p>	<p>D. Is delivery address different from item 1? <input type="checkbox"/> Yes If YES, enter delivery address below: <input type="checkbox"/> No</p>																
<p>2. Article Number (Transfer from service label)</p>	<p>3. Service Type</p> <table border="0"> <tr> <td><input type="checkbox"/> Adult Signature</td> <td><input type="checkbox"/> Priority Mail Express®</td> </tr> <tr> <td><input type="checkbox"/> Adult Signature Restricted Delivery</td> <td><input type="checkbox"/> Registered Mail™</td> </tr> <tr> <td><input type="checkbox"/> Certified Mail®</td> <td><input type="checkbox"/> Registered Mail Restricted Delivery</td> </tr> <tr> <td><input type="checkbox"/> Certified Mail Restricted Delivery</td> <td><input type="checkbox"/> Return Receipt for Merchandise</td> </tr> <tr> <td><input type="checkbox"/> Collect on Delivery</td> <td><input type="checkbox"/> Signature Confirmation™</td> </tr> <tr> <td><input type="checkbox"/> Collect on Delivery Restricted Delivery</td> <td><input type="checkbox"/> Signature Confirmation Restricted Delivery</td> </tr> <tr> <td><input type="checkbox"/> Insured Mail</td> <td></td> </tr> <tr> <td><input type="checkbox"/> Insured Mail Restricted Delivery</td> <td></td> </tr> </table>	<input type="checkbox"/> Adult Signature	<input type="checkbox"/> Priority Mail Express®	<input type="checkbox"/> Adult Signature Restricted Delivery	<input type="checkbox"/> Registered Mail™	<input type="checkbox"/> Certified Mail®	<input type="checkbox"/> Registered Mail Restricted Delivery	<input type="checkbox"/> Certified Mail Restricted Delivery	<input type="checkbox"/> Return Receipt for Merchandise	<input type="checkbox"/> Collect on Delivery	<input type="checkbox"/> Signature Confirmation™	<input type="checkbox"/> Collect on Delivery Restricted Delivery	<input type="checkbox"/> Signature Confirmation Restricted Delivery	<input type="checkbox"/> Insured Mail		<input type="checkbox"/> Insured Mail Restricted Delivery	
<input type="checkbox"/> Adult Signature	<input type="checkbox"/> Priority Mail Express®																
<input type="checkbox"/> Adult Signature Restricted Delivery	<input type="checkbox"/> Registered Mail™																
<input type="checkbox"/> Certified Mail®	<input type="checkbox"/> Registered Mail Restricted Delivery																
<input type="checkbox"/> Certified Mail Restricted Delivery	<input type="checkbox"/> Return Receipt for Merchandise																
<input type="checkbox"/> Collect on Delivery	<input type="checkbox"/> Signature Confirmation™																
<input type="checkbox"/> Collect on Delivery Restricted Delivery	<input type="checkbox"/> Signature Confirmation Restricted Delivery																
<input type="checkbox"/> Insured Mail																	
<input type="checkbox"/> Insured Mail Restricted Delivery																	
<p>PS F 7015 3010 0001 1354 0348</p>	<p>457-Dish Domestic Return Receipt</p>																

**Exhibit J
Unit U27 Escrow Account Reconciliation
VGOB 97-0218-0563**

CNN Deposit Information		
Check Date	Check Number	Total
04 Disbursement		-\$5.68
Error per DGO correction		\$294.92
Interest and Fees		\$169.69
Total		\$533.46
January 2016 First Bank and Trust balance		\$539.44
Difference		-\$5.98

Escrow Bank Data													Running Balance	Difference
Date	Escrow Royalty Deposits	Income	\$ Mktet Int	CDARS Int	Fees	Distributions	Audit Costs	Corrections	Gain/Loss	Royalty Bonus	Total Int. and Fees	Bank Balance		

AFFIDAVIT OF MAILING – COAL OWNER

COMMONWEALTH OF VIRGINIA
COUNTY OF **BUCHANAN**

Applicant: CNX Gas Company LLC
Relief Sought: Disbursement Petition for U27
VGOB: 97-0218-0563-04

I, Anita D. Duty, after being duly sworn upon oath, state as follows:

1. I am the Pooling Supervisor for CNX Land Resources, Inc. and am responsible for the notification process required by Va. Code Ann. §45.1-361.19 of the Code of Virginia and 4VAC25-160-40.
2. That on **October 2, 2015** a true and correct copy of the coal owner dismissal and prior order were mailed, via certified mail return receipt requested, based upon information and belief, the names and last-known addresses, where such addresses are known, of the parties owning an interest in this cause are set forth and attached hereto.
3. Notice of this cause has therefore been served by mail pursuant to the applicable statues and rules of the Board.



Anita D. Duty
 Pooling Supervisor
 for CNX Land Resources Inc.

STATE OF VIRGINIA

COUNTY OF TAZEWELL, TO-WIT:

TAKEN, SUBSCRIBED AND SWORN to before me this 16th day of March, 2016.

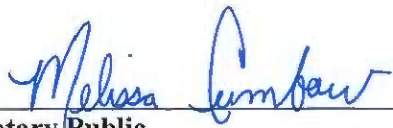

 Notary Public

My commission expires: 12/31/2019



CERTIFICATION OF NOTICE
CNX Gas Company LLC

Unit U27 & U28 part of VP2SGU1
 VGOB 97-0218-0563-04 & 97-0218-0564-03
Coal owner dismissal

Last Name	First Name	U27	U28	MAILED	RECEIPT #	RECEIVED
Chisos, LTD (coal owner)			x	10/2/15	7015152000035333 4521	
Gentry Locke (coal owner)			x	10/2/15	7015152000035333 4538	
Hugh MacRae Land Trust (coal owner)			x	10/2/15	7015152000035333 4507	10/5/2015
Yukon Pocahontas/Buchanan/Sayers (coal owner)		x	x	10/2/15	7014349000018926 2727	10/5/2015
Consolidation Coal Co.(coal owner)		x	x	**hand delivered**		

SENDER: COMPLETE THIS SECTION

- Complete items 1, 2, and 3. Also complete item 4 if Restricted Delivery is desired.
- Print your name and address on the reverse so that we can return the card to you.
- Attach this card to the back of the mailpiece, or on the front if space permits.

1. Article Addressed to:

Yukon Pacer / Buch / Sayers Co
c/o Charles Hart
PO Box 187
Tazewell, VA 24651

2. Article
(Trace)

7014 3490 0001 8926 2727

PS Form 3811, July 2013

COMPLETE THIS SECTION ON DELIVERY

A. Signature

William K. ...

- Agent
- Addressee

B. Received by (Printed Name)

K. ...

C. Date of Delivery



D. Is delivery address different from item 1? Yes
if YES, enter delivery address below: No

3. Service Type

- Certified Mail®
- Priority Mail Express™
- Registered
- Return Receipt for Merchandise
- Insured Mail
- Collect on Delivery

4. Restricted Delivery? (Extra Fee)

- Yes

U271U28 HB