

BEFORE THE VIRGINIA GAS AND OIL BOARD

PETITIONER: Range Resources-Pine Mountain,

DIVISION OF GAS AND OIL

DOCKET NO: VGOB 08-0617-2250-01

RELIEF SOUGHT: (1) DISBURSEMENT FROM  
ESCROW REGARDING TRACT(S) 2, 3, 4  
(2) AND AUTHORIZATION FOR DIRECT  
PAYMENT OF ROYALTIES

HEARING DATE: May 26, 2015

DRILLING UNIT: VC-537876

DICKENSON COUNTY, VIRGINIA

PETITION FOR ORDER OF DISBURSEMENT OF ESCROW FUNDS

**1. Petitioner and its counsel**

Petitioner is Range Resources-Pine Mountain,, P. O. Box 2136, Abingdon, VA 24212, (276)628-9001. Petitioner's counsel is James Kaiser, Wilhoit and Kaiser Law Firm, 220 Broad Street, Suite 210, Kingsport, TN 37660 .

**2. Relief Sought**

Disbursement of funds in escrow. 08/06/17-2250

**3. Legal Authority**

Va. Code Ann. § 45.1-361.1 et seq., 4 VAC 25-160-140., and relevant Virginia Gas and Oil Board Orders ("Board") heretofore promulgated pursuant to law.

**4. Type of Well(s)**

Coalbed Methane

**5. Factual basis for relief requested**

Petition to disburse funds from the escrow account for Well VC-537876, to the owner(s) in tract(s) 2,3 & 4. VGOB 08/06/17-2250-01, Dickenson County, Virginia.

**6. Attestation**

The foregoing Petition to the best of my knowledge, information, and belief is true and correct.

← 1906' →

TOTAL UNIT AREA  
= 58.77 ACRES

--- DENOTES MINERAL LINE  
- - - - DENOTES SURFACE LINE  
- - - - DENOTES SURFACE & MINERAL LINES

Lease No.  
THEO McFALL, et al - oil, gas (CBM)  
52.72 ACRES  
Lease No. 906889 / TC-183  
H.H.FULLER  
176.30 ACRES  
DICKENSON-RUSSELL COAL COMPANY, LLC/ALPHA LAND &  
RESERVES, LLC/ACIN, LLC/WBRD, LLC - Coal  
RANGE RESOURCES-PINE MOUNTAIN, INC. - (CBM)  
GAS 11.78 AC. - 20.05%

LATITUDE 37°10'00"

TRUE LONGITUDE 82°15'00"

4383'

Lease No. 243401  
RICHARD EDWARDS, et al - Surface, Oil, Gas (CBM)  
Lease No. 906889 / TC-182  
C.A. WILLIS  
128.00 ACRES  
DICKENSON-RUSSELL COAL COMPANY, LLC/ALPHA  
LAND & RESERVES, LLC/ACIN, LLC/WBRD, LLC - Coal  
RANGE RESOURCES-PINE MOUNTAIN, INC. - (CBM)  
GAS 30.26 AC. - 51.49%

AS-DRILLED  
CCC COORDINATES  
OF WELL VC-537876  
N 19910.54  
E 37013.50

**FINAL PLAT**

The undersigned hereby certifies that the final location is within ten (10) feet of the location shown on the well plat dated April 29, 2008.

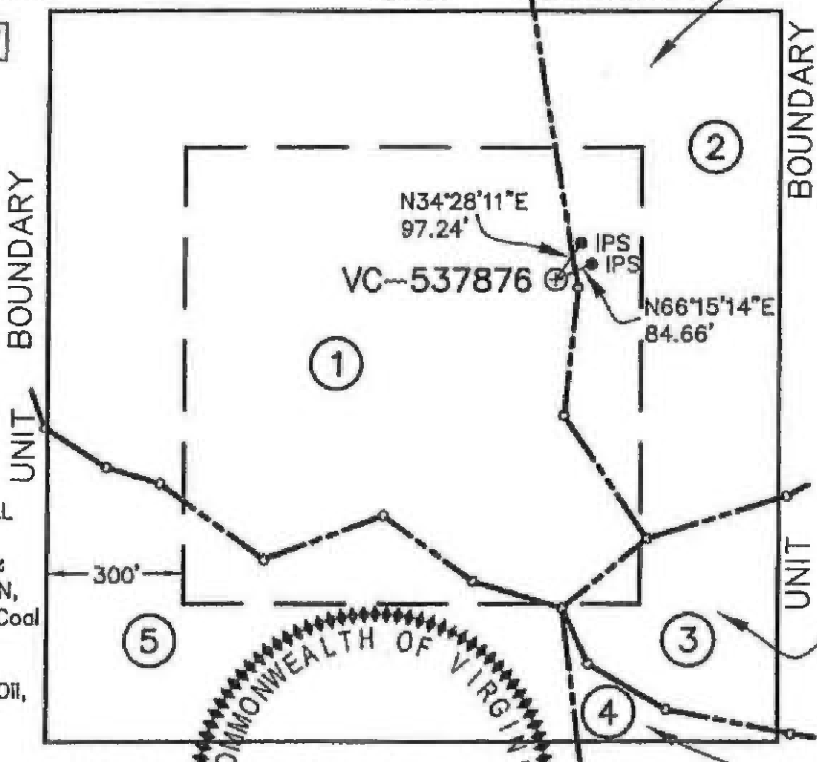

AS-DRILLED  
STATE PLANE  
NAD 27 COORDINATES  
OF WELL VC-537876  
N 320798.01  
E 905509.77  
LAT 37.154635  
LON -82.256535  
NAD 83 COORDINATES  
N 3801675.89  
E 10388494.48

Lease No.  
906889/T-283  
B.H. EDWARDS  
274.37 ACRES  
DICKENSON-RUSSELL  
COAL COMPANY,  
LLC/ALPHA LAND &  
RESERVES, LLC/ACIN,  
LLC/WBRD, LLC - Coal  
RANGE  
RESOURCES-PINE  
MOUNTAIN, INC. - Oil,  
Gas & CBM  
GAS 12.13 AC. -  
20.63%

Lease No.  
LOIS ANN WALLACE, et al -  
surface, oil, gas (CBM)  
37.00 ACRES  
Lease No. 906889 / TC-183  
H.H.FULLER  
176.30 ACRES  
DICKENSON-RUSSELL COAL  
COMPANY, LLC/ALPHA LAND  
& RESERVES, LLC/ACIN,  
LLC/WBRD, LLC - Coal  
RANGE RESOURCES-PINE  
MOUNTAIN, INC. - (CBM)  
GAS 3.70 AC. - 6.30%

COORDINATES  
OF BENCH MARK  
S 77498.41  
E 22826.48  
ELEV. = 1754.09

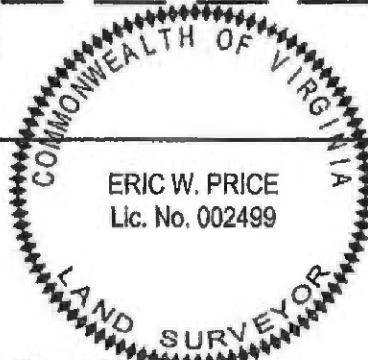

Lease No.  
DELMON RAMEY, et al - surface, oil, gas (CBM)  
30.00 ACRES  
Lease No. 906889 / TC-183  
H.H.FULLER  
176.30 ACRES  
DICKENSON-RUSSELL COAL COMPANY, LLC/ALPHA  
LAND & RESERVES, LLC/ACIN, LLC/WBRD, LLC -  
Coal  
RANGE RESOURCES-PINE MOUNTAIN, INC. - (CBM)  
GAS 0.90 AC. - 1.53%

NOTE !!!  
WELL COORDINATES ARE BASED ON CLINCHFIELD COAL COMPANY'S  
COORDINATE SYSTEM  
CLINCHFIELD COAL COMPANY COORDINATES ARE CALCULATED FROM  
STATE PLANE WELL COORDINATES.  
PROPERTY INFORMATION PROVIDED BY EQUITABLE PRODUCTION COMPANY.  
ELEVATIONS ARE BASED ON NGS CONTROL ST. PAUL 2.

**WELL LOCATION PLAT**

COMPANY Equitable Production Company WELL NAME AND NUMBER VC-537876(AO-60)  
TRACT No. LEASE NO. 243401 ELEVATION 1960.05 (GPS) QUADRANGLE HAYSI  
COUNTY DICKENSON DISTRICT SANDLICK SCALE: 1" = 400' DATE SEPTEMBER 9, 2008  
THIS PLAT IS A NEW PLAT    ; AN UPDATED PLAT    ; OR A FINAL LOCATION PLAT x  
PROPOSED TOTAL DEPTH OF WELL =           

+ DENOTES THE LOCATION OF A WELL ON UNITED STATES TOPOGRAPHIC MAPS, SCALE 1 TO 24,000, LATITUDE AND LONGITUDE LINES BEING REPRESENTED BY BORDER LINES AS SHOWN.

*Eric W. Price*

9-9-08

(AFFIX SEAL)

T&L

LICENSED PROFESSIONAL ENGINEER OR LICENSED LAND SURVEYOR

8137 AS-D.DWG



**EXHIBIT "B"**  
**VC-537876**  
**VGOB 08/06/17-2250**  
**REVISED as of 04/20/2015**

<u>TRACT</u>	<u>LESSOR</u>	<u>LEASE STATUS</u>	<u>INTEREST WITHIN UNIT</u>	<u>GROSS ACREAGE IN UNIT</u>
<b><u>Gas Estate Only</u></b>				
<b>1</b>	Richard Wade Edwards & Rita Owens Edwards P.O. Box 127 Birchleaf, VA 24220	Leased 243401	25.745000%	15.1300
<b>TAX ID 6988</b>	Rebecca Gaylon & Edward Gaylon 12113 South Piney Point Bishopville, MD 21813	Leased 243401	25.745000%	15.1300
<b>Tract 1 Totals</b>			<b>51.490000%</b>	<b>30.2600</b>
<b>2</b>	Theo F. McFall, widow P.O. Box 581 Abingdon, VA 24212	Unleased Leased to Appalachian Energy, Inc.	10.025000%	5.8900
<b>TAX ID 8048</b>	Carma Fleming, widow 5812 Wainwright Avenue Rockville, MD 20851	Unleased Leased to Appalachian Energy, Inc.	10.025000%	5.8900
<b>Tract 2 Totals</b>			<b>20.050000%</b>	<b>11.7800</b>
<b>3</b>	Lois Wallace, widow P.O. Box 172 Haysi, VA 24256	Unleased Leased to Appalachian Energy, Inc.	3.150000%	1.8500
<b>TAX ID 4071</b>	Theo F. McFall, widow P.O. Box 581 Abingdon, VA 24212	Unleased Leased to Appalachian Energy, Inc.	1.575000%	0.9250
<b>Tract 3 Totals</b>			<b>6.300000%</b>	<b>3.7000</b>
<b>4</b>	Delmon Ramey & Brenda Ramey, h/w 672 Ramey Getaway Drive Birchleaf, VA 24220	Unleased Leased to Appalachian Energy, Inc.	0.765000%	0.4500
<b>TAX ID 17329</b>	Theo F. McFall, widow P.O. Box 581 Abingdon, VA 24212	Unleased Leased to Appalachian Energy, Inc.	0.382500%	0.2250
<b>Tract 4 Totals</b>			<b>1.530000%</b>	<b>0.9000</b>

<u>5</u>	Range Resources-Pine Mountain, Inc*	Leased-Range Resources-Pine Mountain, Inc.	20.630000%	12.1300
	Attn: Jerry Grantham	906889		
<b>TAX ID</b>	PO Box 2136	T-283		
<b>20464</b>	Abingdon, VA 24212			
	<b>Tract 5 Totals</b>		<b>20.630000%</b>	<b>12.1300</b>
	<b>TOTAL GAS ESTATE</b>		<b>100.000000%</b>	<b>58.7700</b>
	Percentage of Unit Leased		72.120000%	
	Percentage of Unit Unleased		27.880000%	
	Acreage in Unit Leased			42.3900
	Acreage in Unit Unleased			16.3800

COAL ESTATE ONLY

<u>1</u>	Range Resources-Pine Mountain, Inc*	Leased	51.490000%	30.2600
	Attn: Jerry Grantham	906889		
<b>TAX ID</b>	PO Box 2136	TC-182		
<b>Minerals</b>	Abingdon, VA 24212			
	<b>Tract 1 Totals</b>		<b>58.320000%</b>	<b>40.1500</b>
<u>2</u>	Range Resources-Pine Mountain, Inc*	Leased	20.050000%	11.7800
	Attn: Jerry Grantham	906889		
<b>TAX ID</b>	PO Box 2136	TC-183		
<b>Minerals</b>	Abingdon, VA 24212			
	<b>Tract 2 Totals</b>		<b>20.050000%</b>	<b>11.7800</b>
<u>3</u>	Range Resources-Pine Mountain, Inc*	Leased	6.300000%	3.7000
	Attn: Jerry Grantham	906889		
<b>TAX ID</b>	PO Box 2136	TC-183		
<b>Minerals</b>	Abingdon, VA 24212			
	<b>Tract 3 Totals</b>		<b>6.300000%</b>	<b>3.7000</b>
<u>4</u>	Range Resources-Pine Mountain, Inc*	Leased	1.530000%	0.9000
	Attn: Jerry Grantham	906889		
<b>TAX ID</b>	PO Box 2136	TC-183		
<b>Minerals</b>	Abingdon, VA 24212			
	<b>Tract 4 Totals</b>		<b>1.530000%</b>	<b>0.9000</b>
<u>5</u>	Range Resources-Pine Mountain, Inc*	Leased	20.630000%	12.1300
	Attn: Jerry Grantham	906889		
<b>TAX ID</b>	PO Box 2136	T-283		
<b>Minerals</b>	Abingdon, VA 24212			
	<b>Tract 5 Totals</b>		<b>20.630000%</b>	<b>12.1300</b>
	<b>TOTAL COAL ESTATE</b>		<b>100.000000%</b>	<b>58.7700</b>

\*Formerly:  
Pine Mountain Oil & Gas, Inc.  
Attn: Richard Brillhart  
PO Box 2136  
Abingdon, VA 24212

NOTE: Pursuant to that certain Purchase and Sales Agreement, effective January 1, 2014, Range Resources-Pine Mountain, Inc. obtained ownership in this well, and the above noted Leases, from EQT Production Company.

**EXHIBIT "E"**  
**VC-537876**  
**VGOB 08/06/17-2250**  
REVISED as of 04/20/2015

<u>TRACT</u>	<u>LESSOR</u>	<u>LEASE STATUS</u>	<u>INTEREST WITHIN UNIT</u>	<u>GROSS ACREAGE IN UNIT</u>
N/A		N/A		

**EXHIBIT "EE"**  
**VC-537876**  
**VGOB 08/06/17-2250**  
**REVISED as of 05/08/2015**

<u>TRACT</u>	<u>LESSOR</u>	<u>LEASE STATUS</u>	<u>INTEREST WITHIN UNIT</u>	<u>GROSS ACREAGE IN UNIT</u>	
<b>1</b>	Richard Wade Edwards & Rita Owens Ed P.O. Box 127 Birchleaf, VA 24220	Leased 243401	25.745000%	15.1300	100%
<b>TAX ID 6988</b>	Rebecca Gaylon & Edward Gaylon 12113 South Piney Point Bishopville, MD 21813	Leased 243401	25.745000%	15.1300	100%
<b>Tract 1 Totals</b>			<b>51.490000%</b>	<b>30.2600</b>	

Range is paying royalties direct on tract 1 , no payments have been made to escrow on this tract.

**Disbursement -01**

<b>2</b>	Theo F. McFall, widow P.O. Box 581 Abingdon, VA 24212	Unleased Leased to Appalachian Energy, Inc.	10.025000%	5.8900	100%
<b>TAX ID 8048</b>	Carma Fleming, widow 5812 Wainwright Avenue Rockville, MD 20851	Unleased Leased to Appalachian Energy, Inc.	10.025000%	5.8900	100%
Appalachian Energy, Inc. Attn: Frank Henderson, President P.O.Box 2406 Abingdon, VA 24212					
<b>Tract 2 Totals</b>			<b>20.050000%</b>	<b>11.7800</b>	
<b>3</b>	Lois Wallace, widow P.O. Box 172 Haysi, VA 24256	Unleased Leased to Appalachian Energy, Inc.	3.150000%	1.8500	100%
<b>TAX ID 4071</b>	Theo F. McFall, widow P.O. Box 581 Abingdon, VA 24212	Unleased Leased to Appalachian Energy, Inc.	1.575000%	0.9250	100%
	Carma Fleming, widow 5812 Wainwright Avenue Rockville, MD 20851	Unleased Leased to Appalachian Energy, Inc.	1.575000%	0.9250	100%

Appalachian Energy, Inc.  
 Attn: Frank Henderson, President  
 P.O.Box 2406  
 Abingdon, VA 24212

		<b>Tract 3 Totals</b>	<b>6.300000%</b>	<b>3.7000</b>	
<b>4</b>	Delmon Ramey & Brenda Ramey, h/w 672 Ramey Getaway Drive Birchleaf, VA 24220	Unleased Leased to Appalachian Energy, Inc.	0.765000%	0.4500	100%
<b>TAX ID</b> <b>17329</b>	Theo F. McFall, widow P.O. Box 581 Abingdon, VA 24212	Unleased Leased to Appalachian Energy, Inc.	0.382500%	0.2250	100%
	Carma Fleming, widow 5812 Wainwright Avenue Rockville, MD 20851	Unleased Leased to Appalachian Energy, Inc.	0.382500%	0.2250	100%
		<b>Tract 4 Totals</b>	<b>1.530000%</b>	<b>0.9000</b>	

Appalachian Energy, Inc.  
 Attn: Frank Henderson, President  
 P.O.Box 2406  
 Abingdon, VA 24212

BEFORE THE VIRGINIA GAS AND OIL BOARD

Applicant: Range Resources-Pine Mountain Inc. )  
Relief Sought: Well No. VC-537876 ) Docket No.  
Supplemental Order for Disbursement of Escrowed Funds ) VGOB-08/06/17-2250-01  
on behalf of all known owners in tracts: 2, 3 & 4 )

AFFIDAVIT OF MAILING  
(CERTIFICATE OF SERVICE)

STATE OF TENNESSEE )  
COUNTY OF SULLIVAN )

James E. Kaiser, of lawful age, being duly sworn, upon oath, deposes and says:

- (1) He is a partner with WILHOIT & KAISER, Agent for Range Resources-Pine Mountain Inc. ("RR") and makes this affidavit on behalf of RR.
- (2) Based upon information and belief, the names and last-known addresses, where such addresses are known, of the parties owning an interest in the oil and gas in this cause are set forth and attached hereto.
- (3) On the 24th day of April, 2015, true and correct copies of the Application and the Notice of Hearing in this matter were placed in the United States mail in Kingsport, TN, certified mail, return receipt requested, postage prepaid, duly addressed to the parties at their respective addresses as set forth in the attached Exhibit B which is hereby made a part of this Affidavit.
- (4) Notice of this cause has therefore been served by mail pursuant to the applicable statutes and rules of the Board.

  
James E. Kaiser

SUBSCRIBED AND SWORN TO before me this 19th day of May, 2016.

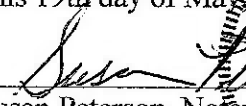
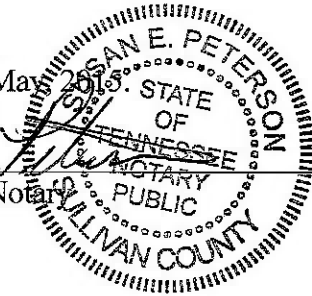
  
Susan Peterson, Notary Public  

My commission expires: August 24, 2016.

**SENDER: COMPLETE THIS SECTION**

- Complete items 1, 2, and 3. Also complete item 4 if Restricted Delivery is desired.
- Print your name and address on the reverse so that we can return the card to you.
- Attach this card to the back of the mailpiece, or on the front if space permits.

1. Article Addressed to:

Carma Fleming  
5812 Wainwright Avenue  
Rockville, MD 20851

**COMPLETE THIS SECTION ON DELIVERY**

A. Signature  
 *Carma Fleming*  Agent  
 Addressee

B. Received by (Printed Name)  C. Date of Delivery  
 \_\_\_\_\_ 4-27-15

D. Is delivery address different from item 1?  Yes  
 If YES, enter delivery address below:  No

3. Service Type  
 Certified Mail®  Priority Mail Express™  
 Registered  Return Receipt for Merchandise  
 Insured Mail  Collect on Delivery

4. Restricted Delivery? (Extra Fee)  Yes

2. Article Number **7013 3020 0001 8823 6930**  
 (Transfer from service label)

PS Form 3811, July 2013 Domestic Return Receipt

**SENDER: COMPLETE THIS SECTION**

- Complete items 1, 2, and 3. Also complete item 4 if Restricted Delivery is desired.
- Print your name and address on the reverse so that we can return the card to you.
- Attach this card to the back of the mailpiece, or on the front if space permits.

1. Article Addressed to:

Theo F. McFall  
P.O. Box 581  
Abingdon, VA 24212

**COMPLETE THIS SECTION ON DELIVERY**

A. Signature  
 *Theo McFall*  Agent  
 Addressee

B. Received by (Printed Name)  C. Date of Delivery  
 Theo McFall 4/27/15

D. Is delivery address different from item 1?  Yes  
 If YES, enter delivery address below:  No

3. Service Type  
 Certified Mail®  Priority Mail Express™  
 Registered  Return Receipt for Merchandise  
 Insured Mail  Collect on Delivery

4. Restricted Delivery? (Extra Fee)  Yes

2. Article Number **7013 3020 0001 8823 6947**  
 (Transfer from service label)

PS Form 3811, July 2013 Domestic Return Receipt

**SENDER: COMPLETE THIS SECTION**

- Complete items 1, 2, and 3. Also complete item 4 if Restricted Delivery is desired.
- Print your name and address on the reverse so that we can return the card to you.
- Attach this card to the back of the mailpiece, or on the front if space permits.

1. Article Addressed to:

Lois Wallace  
P.O. Box 172  
Haysi, VA 24256

**COMPLETE THIS SECTION ON DELIVERY**

A. Signature  
 *Lois Wallace*  Agent  
 Addressee

B. Received by (Printed Name)  C. Date of Delivery  
 LOIS WALLACE 4-27-15

D. Is delivery address different from item 1?  Yes  
 If YES, enter delivery address below:  No

3. Service Type  
 Certified Mail®  Priority Mail Express™  
 Registered  Return Receipt for Merchandise  
 Insured Mail  Collect on Delivery

4. Restricted Delivery? (Extra Fee)  Yes

2. Article Number **7013 3020 0001 8823 6930**  
 (Transfer from service label)

SENDER: COMPLETE THIS SECTION	COMPLETE THIS SECTION ON DELIVERY
<ul style="list-style-type: none"> <li>Complete items 1, 2, and 3. Also complete item 4 if Restricted Delivery is desired.</li> <li>Print your name and address on the reverse so that we can return the card to you.</li> <li>Attach this card to the back of the mailpiece, or on the front if space permits.</li> </ul>	<p>A. Signature  <input checked="" type="checkbox"/> Agent  <input checked="" type="checkbox"/> Addressee</p> <p>B. Received by (Printed Name) C. Date of Delivery            4/30/15</p>
<p>1. Article Addressed to:</p> <p style="text-align: center;">Delmon Ramey &amp;            Brenda Ramey            672 Ramey Getaway Drive            Birchleaf, VA 24220</p>	<p>D. Is delivery address different from item 1? <input type="checkbox"/> Yes            If YES, enter delivery address below: <input type="checkbox"/> No</p> <p style="text-align: center;">APR 30 2015</p> <p>3. Service Type  <input type="checkbox"/> Certified Mail® <input type="checkbox"/> Priority Mail Express™  <input type="checkbox"/> Registered <input type="checkbox"/> Return Receipt for Merchandise  <input type="checkbox"/> Insured Mail <input type="checkbox"/> Collect on Delivery</p> <p>4. Restricted Delivery? (Extra Fee) <input type="checkbox"/> Yes</p>

2. Article Number (Transfer from service label)      7013 3020 0001 8823 6954

PS Form 3811, July 2013      Domestic Return Receipt

SENDER: COMPLETE THIS SECTION	COMPLETE THIS SECTION ON DELIVERY
<ul style="list-style-type: none"> <li>Complete items 1, 2, and 3. Also complete item 4 if Restricted Delivery is desired.</li> <li>Print your name and address on the reverse so that we can return the card to you.</li> <li>Attach this card to the back of the mailpiece, or on the front if space permits.</li> </ul>	<p>A. Signature  <input checked="" type="checkbox"/> Agent  <input type="checkbox"/> Addressee</p> <p>B. Received by (Printed Name) C. Date of Delivery            Beth Testerman 4/27/15</p>
<p>1. Article Addressed to:</p> <p style="text-align: center;">Appalachian Energy, Inc.            Attn: Frank Henderson, President            P.O.Box 2406            Abingdon, VA 24212</p>	<p>D. Is delivery address different from item 1? <input type="checkbox"/> Yes            If YES, enter delivery address below: <input type="checkbox"/> No</p> <p>3. Service Type  <input type="checkbox"/> Certified Mail® <input type="checkbox"/> Priority Mail Express™  <input type="checkbox"/> Registered <input type="checkbox"/> Return Receipt for Merchandise  <input type="checkbox"/> Insured Mail <input type="checkbox"/> Collect on Delivery</p> <p>4. Restricted Delivery? (Extra Fee) <input type="checkbox"/> Yes</p>

2. Article Number (Transfer from service label)      7013 3020 0001 8823 6923

PS Form 3811, July 2013      Domestic Return Receipt

Exhibit J  
VC-537876  
VGOB 08/06/17-2250

Payment Date	Amount
1/17/2012	\$99.19
1/17/2012	\$150.55
1/17/2012	\$152.61
1/17/2012	\$122.23
1/17/2012	\$71.91
1/17/2012	\$63.56
1/17/2012	\$42.83
1/17/2012	\$41.99
1/17/2012	\$43.23
1/17/2012	\$44.76
1/17/2012	\$37.25
1/17/2012	\$27.81
1/17/2012	\$42.06
1/17/2012	\$51.23
1/17/2012	\$49.66
1/17/2012	\$65.15
1/17/2012	\$77.59
1/17/2012	\$79.16
1/17/2012	\$59.79
1/17/2012	\$76.62
1/17/2012	\$76.56
1/17/2012	\$91.97
1/17/2012	\$94.66
1/17/2012	\$64.62
1/17/2012	\$70.16
1/17/2012	\$71.56
1/17/2012	\$93.70
1/17/2012	\$95.12
1/17/2012	\$93.17
1/17/2012	\$110.84
1/17/2012	\$114.21
1/17/2012	\$112.93
1/17/2012	\$113.51
1/17/2012	\$116.08
1/17/2012	\$115.70
1/17/2012	\$94.80
1/17/2012	\$93.95
6/12/2012	\$85.89
6/12/2012	\$79.60
6/12/2012	\$76.50
6/12/2012	\$55.58
6/12/2012	\$52.88
6/12/2012	\$37.60
7/11/2012	\$37.77
8/10/2012	\$48.50
9/12/2012	\$60.37
10/10/2012	\$64.86
11/9/2012	\$51.11

12/12/2012	\$64.77
1/10/2013	\$76.94
2/11/2013	\$84.75
3/13/2013	\$71.14
4/10/2013	\$61.43
5/10/2013	\$77.50
6/10/2013	\$85.18
7/8/2013	\$95.29
8/12/2013	\$91.09
9/13/2013	\$68.46
10/10/2013	\$82.33
11/13/2013	\$81.07
12/11/2013	\$80.42
1/10/2014	\$79.59
2/11/2014	\$93.76
3/12/2014	\$151.34
4/10/2014	\$150.84
5/14/2014	\$119.40
6/13/2014	\$106.31
7/9/2014	\$113.34
8/14/2014	\$102.12
9/30/2014	\$109.62
10/31/2014	\$91.53
11/28/2014	\$94.24
12/31/2014	\$85.00

**TOTAL PAYMENTS** \$5,990.84

**Escrow Agent Summary January 2015**

<u>Unit Name</u>	<u>Docket #</u>	<u>Operator</u>	<u>Beginning Market Value</u>	<u>Deposits</u>	<u>Money Mkt Interest</u>	<u>Fees for 12/31</u>	<u>Ending Market Value</u>
VC537876	2250	EQT	\$5,909.85	\$94.24	\$1.46	\$0.49	\$6,005.06

**TOTAL PAYMENTS** \$5,990.84

**Escrow Agent Summary January 2015** \$6,005.06

**Difference** \$14.22