

BEFORE THE VIRGINIA GAS AND OIL BOARD

Applicant: Range Resources-Pine Mountain, Inc.)
)
Relief Sought: Well Location Exception)
Well Number 900108)Docket Number
)VGOB-13-0521-4013
)
Legal Description: Big Sandy Fuel Corporation Tract)
12,627.34-Acre Tract)
Harman Quadrangle)
Prater District)
Buchanan County, Virginia)

REVISED APPLICATION

1. Parties:

1.1 Applicant herein is Range Resources-Pine Mountain, Inc., whose address for the purposes hereof is 406 West Main Street, Abingdon, Virginia 24210, Telephone: (276) 628-9001. The attorney for Applicant is Timothy E. Scott, McKinnis & Scott, whose address is 135 West Main Street, Suite 200, Kingsport, Tennessee, 37660, Telephone: (423) 247-9376.

1.2 Applicant is the owner of the right to develop and produce oil and gas from all formations, from surface to total depth drilled in accordance with the permit submitted by applicant and located within the Prater District of Buchanan County, Virginia, and underlying the lands depicted at Exhibit "A" attached hereto and made a part hereof and to appropriate the oil and gas produced therefrom.

2. Allegation of Facts:

2.1 Applicant has proposed a plan of development and operation of the formations underlying the drilling unit involved herein and depicted at Exhibit "A" and has proposed to commence such plan of development and operation of such unit by a conventional gas well, designated as Well Number 900108, to be drilled upon the lands involved herein so as to produce oil and gas from such unit.

2.2 That the unit depicted at Exhibit "A" hereof is subject to statewide spacing as provided under Virginia Code Annotated Section 45.1-361.17 (A) (2). This section provides that "wells drilled in search of gas shall not be located closer than 2500 feet to any other well completed in the same pool." In consideration of all known conditions, it

is the opinion of the Applicant that such distance limitation is not feasible for the unit described in Exhibit "A," because there is no legal location.

2.3 That to prevent waste, protect correlative rights, and provide for the maximum safe recovery of the mineral resources underlying the Commonwealth, the Board should allow for an exception to the distance limitation and statewide spacing.

2.4 That the proposed well, at the location requested by Applicant, is necessary to effectively and efficiently drain a portion of the common sources of supply (reservoir) underlying the unit described at Exhibit "A" which cannot be adequately and efficiently drained without an exception to the distance limitations and spacing rules.

2.5 The drilling unit involved herein is a circle having a radius of 1250 feet from the proposed well bore to be located 7,885 feet West of Longitude Line 82 degrees minutes 10 seconds and 14,700 feet South of Latitude Line 37 degrees 17 minutes 30 seconds (Virginia State Plane South Zone Coordinates North 3,636,146.83 and East 10,408,111.10) in the Harman Quadrangle, Buchanan County, Virginia.

2.6 That Range Resources-Pine Mountain, Inc. Well No. **821906** lies 2,490 feet South 81 degrees 18 minutes West of proposed Well No. 900108; Range Resources-Pine Mountain, Inc. Well No. **900067** lies 992.07 feet North 07 degrees 10 minutes East of proposed Well No. 900108; and Range Resources-Pine Mountain, Inc. Well No. **809586** lies 1,711 feet South 34 degrees 23 minutes East of proposed Well No. 900108.

2.7 That proposed Well No. 900108 is located on the Big Sandy Fuel Corporation 12,627.34-acre Tract and Applicant anticipates producing all the Mississippian and Devonian Age formations including, but not limited to, Ravencliff, Maxton, Big Lime, Weir, Berea and Devonian Shale, from surface to total depth drilled, 5,770 feet.

3. Legal Authority: The relief sought by this Application is authorized by Virginia Code Annotated § 45.1-361.17.

4. Relief Sought: Applicant requests the Virginia Gas and Oil Board to enter an order to enable Well No. 900108 to be drilled as depicted on the plat attached as Exhibit "A" and that Applicant be granted the right to produce these formations which appear on the well work permit submitted to the Inspector.

DATED this the 23rd day of April, 2013.

RANGE RESOURCES-PINE MOUNTAIN, INC.

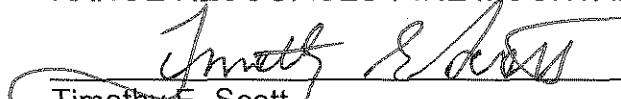
Timothy E. Scott
McKinnis & Scott

VERIFICATION

The foregoing Application to the best of my knowledge, information and belief is true and correct.

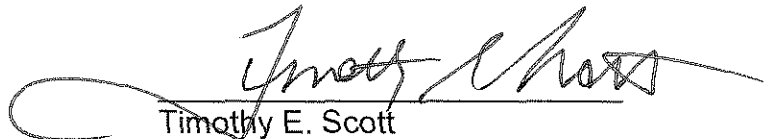
Timothy E. Scott
McKinnis & Scott

[c:\msword\pmog\well.location.exception.application.900108 revised]

VIRGINIA

VIRGINIA GAS AND OIL BOARD
DEPARTMENT OF MINES, MINERALS, AND ENERGY
LEBANON, VIRGINIA

DOCKET NUMBER: VGOB-13-0521-4013
APPLICANT: Range Resources-Pine Mountain, Inc.
RELIEF SOUGHT: WELL LOCATION EXCEPTION
Va. Code Ann. § 45.1-361.17
WELL NO.: 900108
LEGAL DESCRIPTION: Big Sandy Fuel Corporation Tract)
12,627.34-Acre Tract)
Harman Quadrangle)
Rock Lick District)
Buchanan County, Virginia)

NOTICE OF HEARING

TO: See Exhibit B

Notice is hereby given that the Applicant in this cause is requesting the Virginia Gas and Oil Board to authorize the drilling of the proposed well to produce formations from surface to total depth drilled as set forth in the attached application.

Notice is further given that this matter is set for hearing before the Virginia Gas and Oil Board on the 21st day of May, 2013, at 9:00 a.m. at the Russell County Office Building, Highland Drive, Lebanon, Virginia, at which time and place all interested persons may appear and be heard. Any questions concerning said hearing may be directed to the Virginia Gas and Oil Board, State Gas and Oil Inspector, Department of Mines, Minerals and Energy, 135 Highland Drive, Lebanon, Virginia 24266 (276) 415-9650.

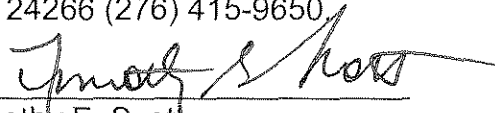
Timothy E. Scott
McKinnis & Scott
135 West Main Street, Suite 200
Kingsport, Tennessee 37660
(423) 247-9376

CERTIFICATE OF SERVICE

I, Timothy E. Scott, counsel for Range Resources-Pine Mountain, Inc., hereby certify that I have this day caused the foregoing notice and application to be served upon the parties listed herein, at their address, by certified mail, return receipt requested.

Dated this the 19th day of April, 2013.



Timothy E. Scott
McKinnis & Scott

[c:\msword\pmog\well.location.exception.notice.900108]

Latitude 37° 17' 30"

Longitude 82° 10' 00"

Distance to Offsetting Huron Producing Wells			
Offset Well / Lateral Number	Distance	Bearing	Measured From
900059 Proposed Production Packer	579'	S 54°08' E	900108 Proposed Production Packer
821908 (Approx.)	1,871'	S 40°00' W	900108 Lateral
821781 (Approx.)	856'	N 40°00' E	900108 Lateral

Distance to Offsetting Wells (Non Huron)			
Offset Well / Lateral Number	Distance	Bearing	Measured From
802586 (Approx.)	1,578'	S 35°30' E	900108 Proposed Production Packer
B20471	1,610'	S 51°00' W	900108 ID
900067	833'	N 40°00' E	900108 Lateral

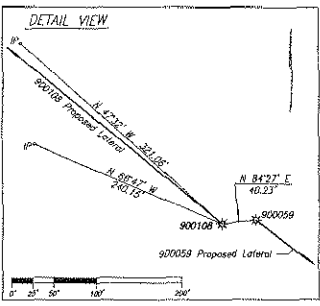
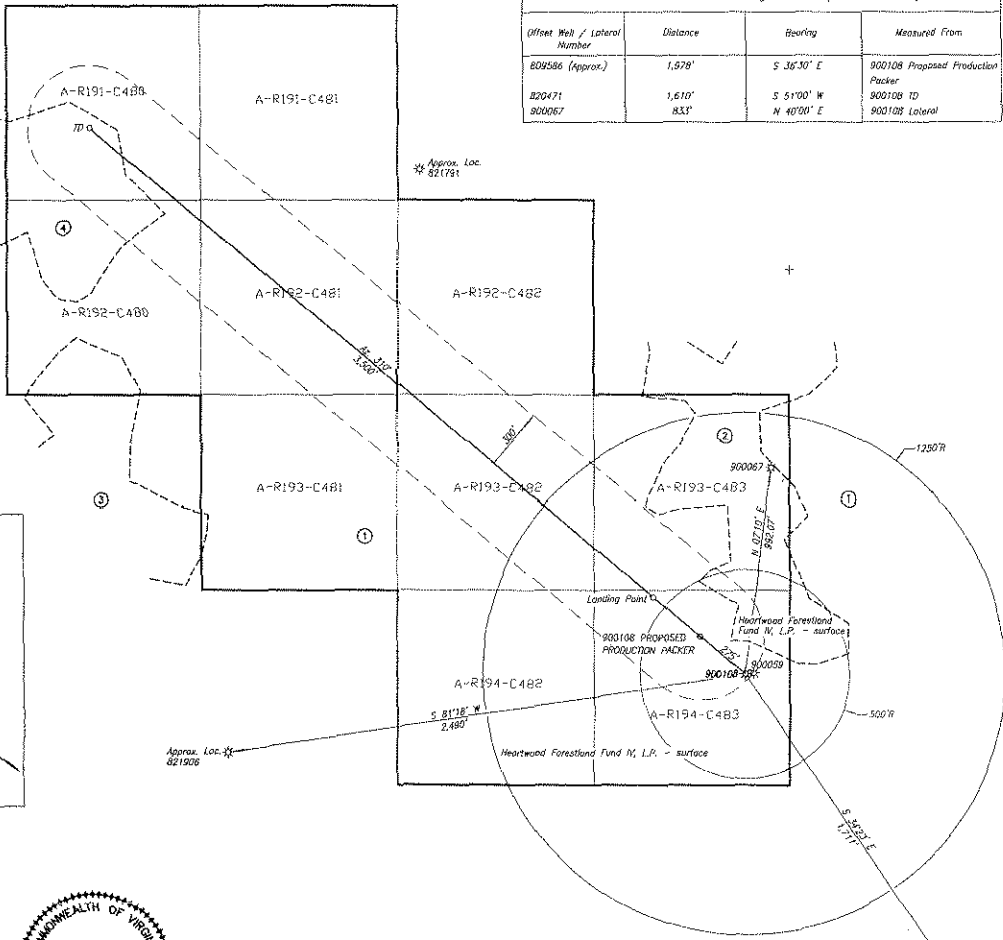

- Mineral Line
- Surface Line
- Unit Grid Exterior
- Base Drainage Area
- ⊙ Existing CBM Well
- ⊙ Existing Conventional Well



Note: The boundary lines shown herein are based on deeds, plats and maps of record and do not depict a current boundary survey.
 The undersigned hereby certifies that the final location is within ten (10) feet of the location shown on the well plot dated 3-23-2012.

Note: See Attached Tract Ownership Information Schedule and Grid Corner Coordinates Chart

FINAL PLAT

Area of Horizontal Unit = 200 Ac. / Area of Conventional Unit = 112.69 Ac.

Estimated Landing Point Vertical Depth: 5,770'
 Estimated Total Measured Depth of Lateral: 9,637'

Approx. Loc. 802586
 Surface Coordinates
 Well Coordinates: (VA St. Plane S. Zone, NAD 83 (93))
 N 5,636,146.83 E 10,408,111.10
 Well Coordinates: (VA St. Plane S. Zone, NAD 27 Calculated from NAD 83 (93))
 N 555,968.96 E 925,125.57
 Well Coordinates: (ESRI/World Geoid Co.)
 N 55,131.73 E 35,280.72
 Well Coordinates: (Geographic NAD 27)
 37,251,363 -82,19,305

HORIZONTAL WELL LOCATION PLAT (UNIT NAME: SWH-1_A-R194-C483_HR) / CONVENTIONAL WELL LOCATION PLAT NORA GRID S-72 DGO FILE 00. 00-0000

COMPANY Rage Resources-Pine Mountain, Inc. WELL NAME AND NUMBER 900108
 TRACT NO. Big Sandy Fuel Corp. ELEVATION 1,932.67 QUADRANGLE Harman
 COUNTY Buchanan DISTRICT Prater SCALE "See Bar Scale" DATE 3-11-2013
 This Plat is a new plat; an updated plat; or a final location plat.

+ Denotes the location of a well on United States topographic Maps, scale 1 in 24,000, latitude and longitude lines being represented by border lines as shown.

Glenn F. Phillips
 Licensed Professional Engineer of Licensed Land Surveyor

Exhibit A

900108 HORIZONTAL WELL PLAT
Unit SWVH-1_A-R194-C483_HR
TRACT OWNERSHIP INFORMATION SCHEDULE
4/15/2012

- 1 . Big Sandy Fuel Corporation
12,627.34 Acres
Heartwood Forestland Fund IV, L.P. - surface
ACIN LLC - coal
Alpha Land & Reserves LLC - coal lessee
WBRD LLC - coal
Paramont Coal Company Virginia LLC - coal lessee
Range Resources-Pine Mountain, Inc - oil & gas
Gas 176.35 Ac. 88.17%

- 2 . Big Sandy Fuel Corporation
12,627.34 Acres
ACIN LLC - coal (except Clintwood seam)
Alpha Land & Reserves LLC - coal lessee
WBRD LLC - coal (except Clintwood seam)
Paramont Coal Company Virginia LLC - coal lessee
Penn Virginia Operating Company - coal (Clintwood seam only)
Wellmore Coal Company - coal lessee
Range Resources-Pine Mountain, Inc - oil & gas
Gas 10.74 Ac. 5.37%

- 3 . Big Sandy Fuel Corporation
12,627.34 Acres
ACIN LLC - coal (except Clintwood seam)
Alpha Land & Reserves LLC - coal lessee
WBRD LLC - coal (except Clintwood seam)
Paramont Coal Company Virginia LLC - coal lessee
Penn Virginia Operating Company - coal (Clintwood seam only)
Range Resources-Pine Mountain, Inc - oil & gas
Gas 2.28 Ac. 1.14%

- 4 . Big Sandy Fuel Corporation
12,627.34 Acres
ACIN LLC - coal (except Clintwood seam)
Alpha Land & Reserves LLC - coal lessee
WBRD LLC - coal (except Clintwood seam)
Paramont Coal Company Virginia LLC - coal lessee
Penn Virginia Operating Company - coal (Clintwood seam only)
Range Resources-Pine Mountain, Inc - oil & gas
Gas 10.63 Ac. 5.32%

**900108 CONVENTIONAL WELL PLAT
TRACT OWNERSHIP INFORMATION SCHEDULE
4/15/2013**

- 1 . Big Sandy Fuel Corporation
12,627.34 Acres
Heartwood Forestland Fund IV, L.P. - surface
ACIN LLC - coal
Alpha Land & Reserves LLC - coal lessee
WBRD LLC - coal
Paramont Coal Company Virginia LLC - coal lessee
Range Resources-Pine Mountain, Inc - oil & gas
Gas 100.71 Ac. 89.37%

- 2 . Big Sandy Fuel Corporation
12,627.34 Acres
ACIN LLC - coal (except Clintwood seam)
Alpha Land & Reserves LLC - coal lessee
WBRD LLC - coal (except Clintwood seam)
Paramont Coal Company Virginia LLC - coal lessee
Penn Virginia Operating Company - coal (Clintwood seam only)
Wellmore Coal Company - coal lessee
Range Resources-Pine Mountain, Inc - oil & gas
Gas 11.98 Ac. 10.63%

Exhibit "B"
Well No. 900108

DEPTH - 4,756'

Dickenson-Russell Coal Company
Maxxim Shared Services, LLC
Attn: Steve Smith
5703 Crutchfield Drive
Norton, VA 24273

ALPHA Land & Reserves, LLC
Attn: Steve Smith
5703 Crutchfield Drive
Norton, VA 24273

WBRD LLC
John Mooney
5260 Irwin Road
Huntington, WV 25705-3247

ACIN LLC
John Mooney
5260 Irwin Road
Huntington, WV 25705-3247

Penn Virginia Operating Company, LLC
Mr. John Keith
Seven Sheridan Square, Suite 400
Kingsport, TN 37660

Wellmore Energy Company
Attn: Robert Brendlinger
P.O. Box 2860
Grundy, VA 24614-2860

Paramont Coal Co Virginia LLC
Attn: Steve Smith
5703 Crutchfield Dr
Norton, VA 24273